

IMPORTANT: THIS IS DATED INFORMATION. Parts must be ordered from a dealer or distributor. **Hearth and Home Technologies does not sell directly to consumers.** Provide model number and serial number when requesting service parts from your dealer or distributor.



Stocked
at Depot

ITEM	DESCRIPTION	COMMENTS	PART NUMBER	
1	Damper Blade Assembly		SRV34487	
	Damper Weight		SRV19785	
2	Starter Section Assembly		22072B	Y
3	Top Standoffs	Qty 4 req	SRV4044-111	
4	Smoke Shield	Qty 2 req	16829F	
5	Side Refractory	Qty 2 req	27069	
6	Corner Refractory	Qty 4 req	27070	
7	**Firescreen Assembly	Qty 4 req	26053	Y
	Firescreen Handle	1 ea.	SRV10002	
8	Door Support	Qty 2 req	16697	
9	Ashlip	Qty 2 req	16674B	
10	Hearth Refractory		16673A	
11	Grate		GR11	Y
12	Damper Control		16663	

**Firescreen length changed from 21.69 " to 22.12"

Additional service parts on following page.

No one builds a better fire

Beginning Manufacturing Date: Aug 2001
Ending Manufacturing Date: Mar 2021

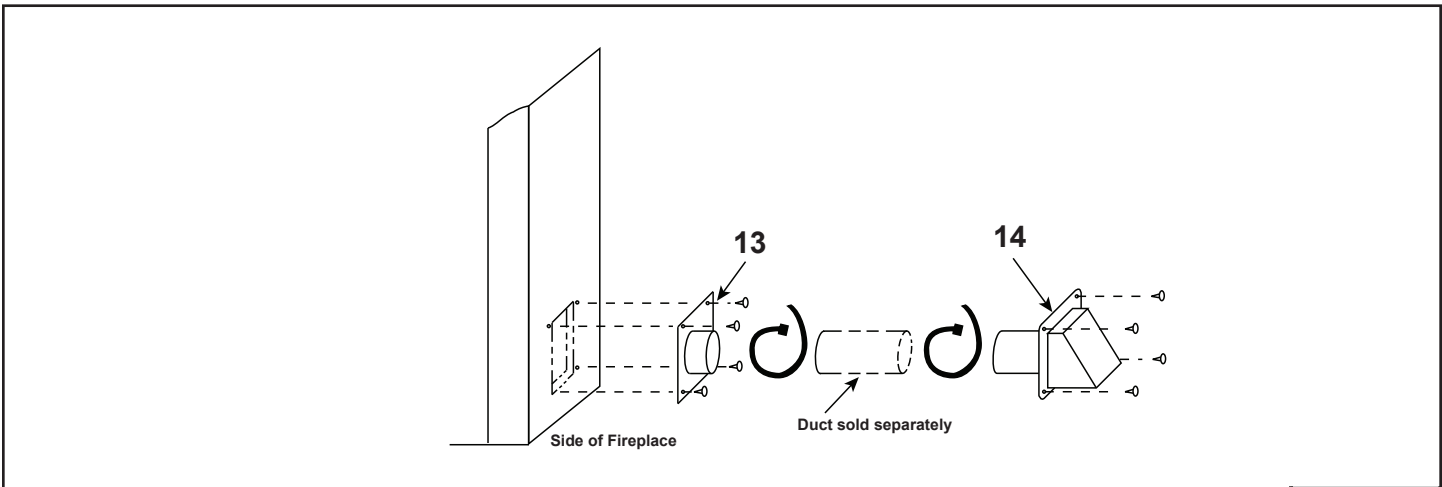

IMPORTANT: THIS IS DATED INFORMATION. Parts must be ordered from a dealer or distributor. **Hearth and Home Technologies does not sell directly to consumers.** Provide model number and serial number when requesting service parts from your dealer or distributor.



Stocked at Depot

ITEM	DESCRIPTION	COMMENTS	PART NUMBER	
13	Outside Air Plate Assembly		19081A	
14	Outside Air Shield		SRV33271	Y
	Air Kit Fastener Pack		13580	
	Door Pivot Clip	Qty 2 req	SRV31527	
	Door Track (used for upper)	Qty 2 req	SRV15427	
	Door Track (used for lower)	Qty 2 req	4012-001	
	Firescreen Rod	Qty 4 req	SRV12052	
	Gas Access Panel (for use with Air Kit)		31636	
	Grate Retainer	Qty 2 req	SRV17365	
	Nailing Flange	Qty 8 req	31190	
	Refractory Bracket	No longer available	23959A	
	Refractory Retainer	No longer available	16675B	
	Refractory Retainer	Qty 4 req	SRV11847	
	Refractory Standoff	Qty 6 req	16678	
	Smoke Shelf	Qty 2 req	16676	
	Smoke Shield Kit		SRV4012-036	
	Strip Protector	Qty. 4 req.	SRV18320	
	Touch-Up Paint		71479	
	Insallation Manual		4012-056	
	Owner's Manual		4012-055	