

- 6KX-BL(Black Glass NG)(Active)
- 6KX-BL-BIR(Black Glass NG Birch)(Active)
- 6KX-CU(Calm Umber NG)(Active)
- 6KX-LP-SJ(Serene Jute Propane)(Active)
- 6KX-LP-TG(Tranquil Greige Propane)(Active)
- 6KX-SJ(Serene Jute NG)(Active)
- 6KX-TG(Tranquil Greige NG)(Active)
- 6KX-TG-BIR(Tranquil Greige NG Birch)(Active)

LOGS-6KX Log Set Assembly

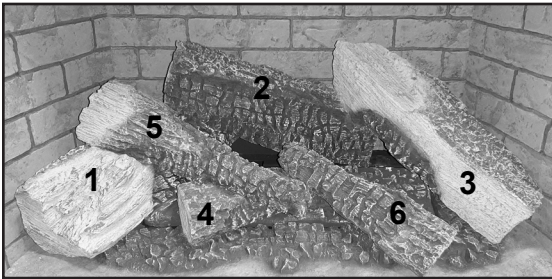

LOGS-6-BIR Log Set Assembly

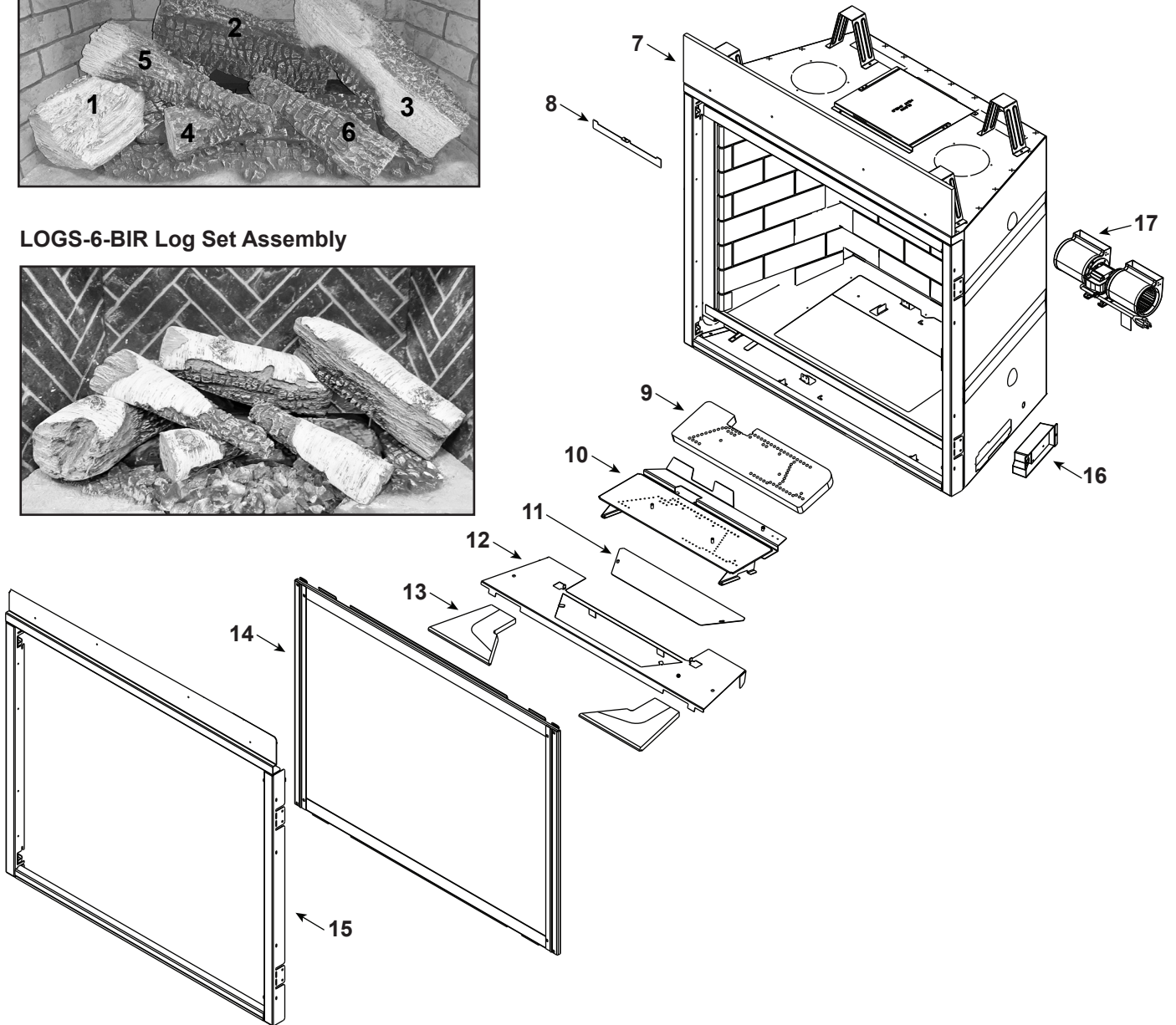

Part number list on following page.

No one builds a better fire

Beginning Manufacturing Date: Jun 2023
Ending Manufacturing Date: Active

IMPORTANT: THIS IS DATED INFORMATION. Parts must be ordered from a dealer or distributor. **Hearth and Home Technologies does not sell directly to consumers.** Provide model number and serial number when requesting service parts from your dealer or distributor.



Stocked
at Depot

ITEM	DESCRIPTION	COMMENTS	PART NUMBER	
	Log Assembly	Premium	LOGS-6KX	Y
1	Log #1	Premium	SRV2582-720	
2	Log #2	Premium	SRV2582-721	
3	Log #3	Premium	SRV2582-722	
4	Log #4	Premium	SRV2582-723	
5	Log #5	Premium	SRV2582-724	
6	Log #6	Premium	SRV2582-725	
	Log Assembly (Complete Set Only)	Birch	LOGS-6-BIR	Y
7	Non-combustible board		2583-137	
8	Curtain, Flue Light		2583-179	
9	Burner Overlay		SRV2583-127	Y
10	Burner Assembly		2583-007	Y
	Pilot Shield	NG Only	2583-234	
11	Mesh, Ember Bed		2583-157	
12	Basket, Ember Bed		2583-156	
	Glass Liner Kit (Back, Left, Right, Bases, Top, & Insulation Boards)		GL-36MX	
	Magic Glass Assembly (Back, Left, & Right)	Black Glass	2592-079	
	Refractory Brackets BK (Right and Left)		SRV2583-747	
	Brick Kit (Back, Left, Right, Bases & Top)	Calm Umber	BRICK-6KX-CU	
		Serene Jute	BRICK-6KX-SJ	
		Tranquil Geige	BRICK-6KX-TG	
13	Refractory Base (Right and Left)	Black Glass	SRV2583-076-BK	
		Calm Umber	SRV2583-076-CU	
		Serene Jute	SRV2583-076-SJ	
		Tranquil Geige	SRV2583-076-TG	
14	Glass Assembly		GLA-6KX	Y
	Finishing Strips	Sold as set only	SRVFS-6K	
15	Surround		SRV2583-019	
	Surround Bottom		SRV2583-193-1	
16	Junction box		SRV2583-009	Y
17	Blower		GFK-160A	Y
	Elbow Heat Shield		385-290	
	Flue Restrictor		385-128	
	Gasket Assembly (Vent, seal cap, cover, drawn neck, shutter, valve, & bulkhead)		2583-080	
	Glass Clip Assembly (Top)	Qty 2 req	2155-047	Y
	Glass Clip Assembly (Bottom)	Qty 2 req	2155-045	Y
	Seal Cap	Qty 2 req	4031-221	
	Illuminated Embers Glass Media	4lbs.	2680-753	

No one builds a better fire

Beginning Manufacturing Date: Jun 2023
Ending Manufacturing Date: Active

IMPORTANT: THIS IS DATED INFORMATION. Parts must be ordered from a dealer or distributor. **Hearth and Home Technologies does not sell directly to consumers.** Provide model number and serial number when requesting service parts from your dealer or distributor.



Stocked at Depot

ITEM	DESCRIPTION	COMMENTS	PART NUMBER	
#18 Valve Assembly				
18.1	Pilot Assembly	NG	2106-169	Y
		Propane	2106-170	Y
	Pilot Tube		SRV485-301	Y
18.2	3-Hole Grommet		SRV2118-420	
18.3	Bulkhead W/Flex tube		SRV7000-156	Y
18.4	Flex Ball Valve Assembly		SRV303-330	Y
18.5	Glass, Ember		2583-173	
18.6	Kapton, Ember		2583-171	
18.7	LED Assembly, Ember Bed		2583-061	Y
18.8	Valve	NG	SRV2166-302	Y
		Propane	2166-303	Y
18.9	Male Connector	Pkg of 5	303-315/5	Y
18.10	Battery Holder**		SRV2326-142	Y
18.11	Component Tray Assembly		See following page	
18.12	Shutter Assembly		2583-011	
18.13	LED Wire		2589-160	Y
18.14	REB Accent Light		2583-236	Y
18.15	Kapton, Accent	Qty 2 req	2583-170	
18.16	Glass, Accent	Qty 2 req	2583-172	
	Orifice, NG (#31C)		SRV582-831	Y
	Orifice, Propane (#49C)		SRV582-849	Y

**Fuse for battery pack can be sourced locally, not a warranty item. Specs are 250v, 3A fuse, 3/4" long

Additional service part numbers on following page.

IMPORTANT: THIS IS DATED INFORMATION. Parts must be ordered from a dealer or distributor. **Hearth and Home Technologies does not sell directly to consumers.** Provide model number and serial number when requesting service parts from your dealer or distributor.



**Stocked
at Depot**

ITEM	DESCRIPTION	COMMENTS	PART NUMBER	
#18.11 Component Tray				
18.11a	Module, IFT Control		SRV2326-130	Y
18.11b	Module, RF FCC		SRV2326-120	Y
18.11c	Harness, IFT 6 Pin Wiring		SRV2583-063	Y
18.11d	Component Tray		2279-185	
18.11e	LED Controller		2166-336	Y
18.11f	Module, B Type AC		SRV2326-150	Y
18.11g	Cable, B Type AC Module		SRV2326-152	Y
18.11h	Transformer, 6 Volt Wall		SRV2326-131	Y
	RC400 Remote		SRV2326-110	Y
	Touch Up Paint		TUP-GBK-12	
	Mineral Wool		050-721	
Conversion Kits				
	Conversion Kit NG		NGK-MID	Y
	Conversion Kit Propane		LPK-MID	Y
	Pilot Orifice, NG		SRV593-528	Y
	Pilot Orifice, Propane		SRV593-527	Y
	Regulator, NG		NGK-DXV-50	Y
	Regulator, Propane		SRVLPK-DXV-50	Y