

Log Set Assembly

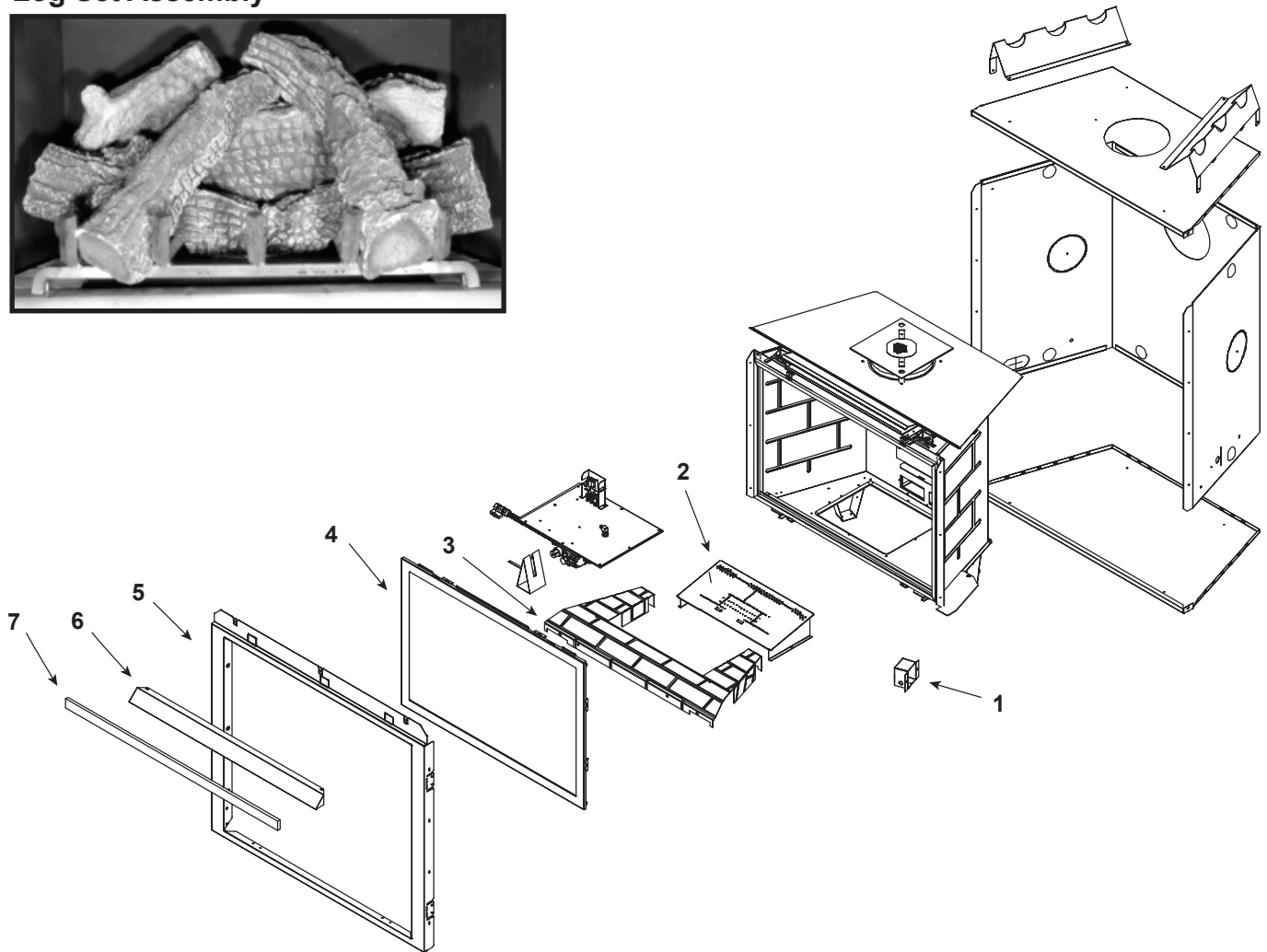

IMPORTANT: THIS IS DATED INFORMATION. Parts must be ordered from a dealer or distributor. **Hearth and Home Technologies does not sell directly to consumers.** Provide model number and serial number when requesting service parts from your dealer or distributor.

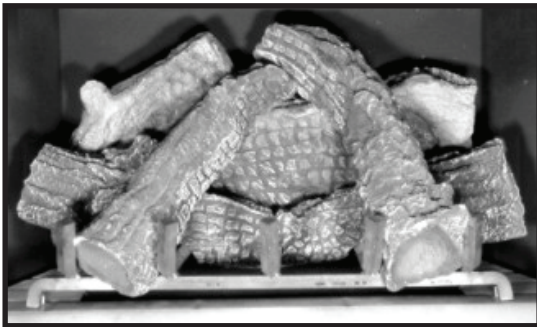

Stocked at Depot

ITEM	DESCRIPTION	COMMENTS	PART NUMBER	
	Log Set Assembly	No longer available	LOGS-6CAMP	
1	Junction Box		100-250A	Y
2	Burner NG	No longer available	382-175A	
	Burner LP	No longer available	382-176A	
3	Base Refractory	No longer available	382-129	
4	Glass Door Assembly		GLA-6TRXI	Y
5	Surround	No longer available	385-130	
6	Hood		SRV60-143-BK	
7	Non-combustible Board	No longer available	385-401	

No one builds a better fire

Beginning Manufacturing Date: May 2001
Ending Manufacturing Date: Feb 2003

IMPORTANT: THIS IS DATED INFORMATION. Parts must be ordered from a dealer or distributor. **Hearth and Home Technologies does not sell directly to consumers.** Provide model number and serial number when requesting service parts from your dealer or distributor.



Stocked at Depot

ITEM	DESCRIPTION	COMMENTS	PART NUMBER	Stocked at Depot
	Burner Tube		477-301A	Y
	Decorative front		DF-6000	
	Fan Kit		GFK-160A	
	Flex Ball Valve Assembly		SRV302-320	Y
	High Temp Limit Switch		107-531A	Y
	On/Off Rocker Switch		060-521A	Y
	Orifice NG (#32C)		SRV582-832	Y
	Orifice (1.8mmC)		582-818	Y
	Piezo Ignitor		291-513	Y
	Pilot Assembly NG		4021-736	Y
	Pilot Assembly LP		4021-737	Y
	Thermocouple		446-511	Y
	Thermopile		2103-512	Y
	Pilot Tube		SRV485-301	Y
	Remote		SMART-STAT-HHT	
	Touch Up Paint		TUP-GBK-12	
	Valve NG		060-522	Y
	Valve LP		060-523	Y
	Grate	No longer available	382-360A	
	Conversion Kit NG	No longer available	NGK-6CAMP	
	Conversion Kit LP	No longer available	LPK-6CAMP	
	Pilot Orifice NG		SRV446-505	Y
	Pilot Orifice LP		SRV446-517	Y
	Regulator NG		SRV060-518	Y
	Regulator LP		060-519	Y