

ALK-36, ALK-48, ALK-60, ALK-72
Models: Models: CRAVE/CRAVE-B
Installation Instructions



Leave this instruction with party responsible for use and operation.

DANGER



**HOT GLASS WILL
CAUSE BURNS.**

**DO NOT TOUCH GLASS
UNTIL COOLED.**

**NEVER ALLOW CHILDREN
TO TOUCH GLASS.**

A barrier designed to reduce the risk of burns from the hot viewing glass is provided with this appliance and shall be installed for the protection of children and other at-risk individuals.

CAUTION! Risk of Burns! The fireplace should be turned off and cooled before servicing.

CAUTION! Risk of Cuts or Abrasions. Wear protective gloves and safety glasses during installation. Sheet metal edges are sharp.

CAUTION! Do not install damaged components. If you received components that are damaged, contact your dealer for assistance.

KIT CONTENTS:

- LED 12 Volt Power Supply
- LED/Wire/Tray Assembly
- AUX300 Module
- Sheet metal screws (2)
- Velcro (1 inch)

Preparation

1. Remove the decorative front.
2. Remove the vanity panel from bottom of glass frame.

WARNING! Risk of Injury! Turn off gas supply and disconnect electrical power before accessing electrical components inside appliance.

3. Remove screws on left and right sides of component heat shield and lift it out of the control cavity.
4. Unplug the 6V transformer from the junction box. This will turn the power off to the appliance.

Note: This appliance does include a manual gas shutoff valve that is located in the valve compartment. This manual gas shutoff valve is accessible for service by removing the decorative front and the vanity panel. Depending upon local code, an additional manual gas shutoff, in a readily accessible area may be required and located upstream from the appliance.

5. Turn the gas shutoff handle to the "OFF" position to shut off the gas supply.
6. Remove lower access cover panel if finishing is not completed.
7. To remove the glass assembly:
Locate the spring latches that are on the upper edge of the glass frame of the appliance.
Use both index fingers to release spring latches.
Allow glass to tilt forward. Grasp glass on the upper return lip of glass frame and lift up and out. The glass should lift easily out of the bottom retaining lip.
8. Remove interior media and refractory from the unit if already installed.
9. Remove the media tray. It is attached to the interior firebox bottom with screws.
10. Remove the two screws that attach the pilot to the burner. See Figure 1.
11. Remove the four screws securing the burner to the firebox sides and disengage burner from orifice. Remove burner.
12. Remove the eight screws that secure the glass window. Remove the bottom glass. See Figure 2 and Figure 3. Handle with care.
13. Remove tray from appliance and discard.

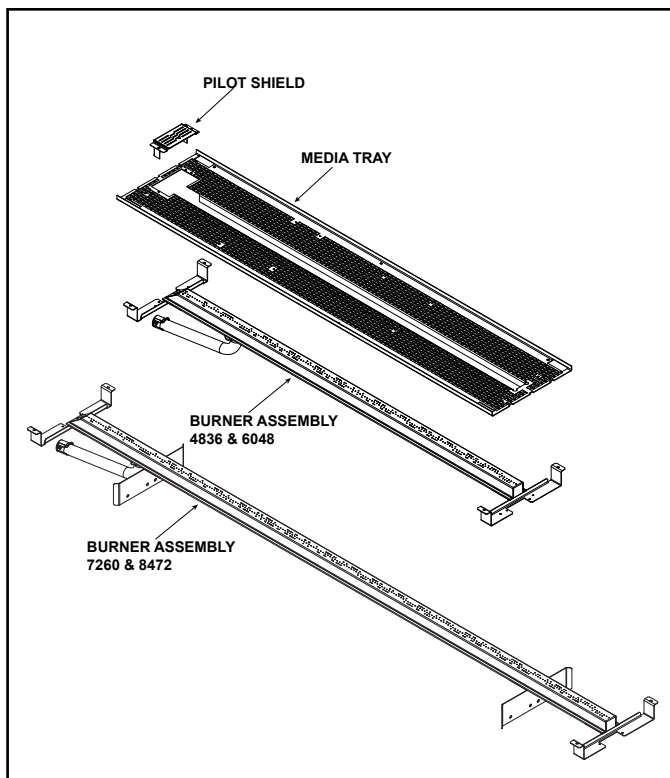

Figure 1. Base Pan with Burner and Pilot Cover

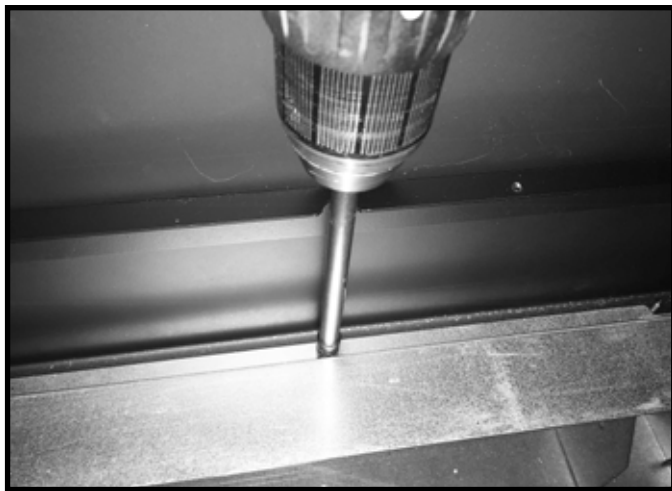

Figure 2. Remove Screws on Bottom Glass

INSTALLATION

1. Place LED Tray Assembly into appliance through the bottom glass opening.
 2. Secure the LED power supply with two screws.
 3. Attach the AUX to the component tray with velcro.
- Refer to Figure 4 and Figure 5 for the following steps:
4. Plug the light wire harness into the LED power supply.
 5. Plug the LED power supply into AUX2 on the AUX module.
 6. Using self-tapping screws, secure green ground wire of cord assembly to component tray.
 7. Plug the AUX module into the junction box and control module.
 8. Place wires in wire management clips to prevent touching the firebox.
 9. Reinstall the bottom glass, burner, pilot and media tray.
 10. Place media according to instructions include with media kit.
 11. Reinstall glass assembly.
 12. Plug the 6V transformer into the junction box.
 13. Reinstall component heat shield.

CAUTION! Risk of Overheating! Component heat shield *MUST* be installed before operating appliance. Electrical components will be damaged.

14. Turn on gas and electric power to appliance.

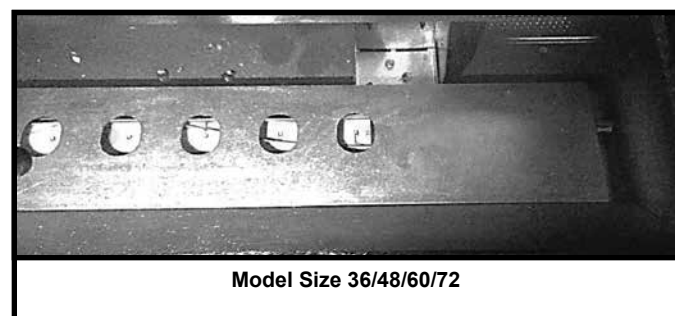

Figure 3. LED Tray Assembly in Position

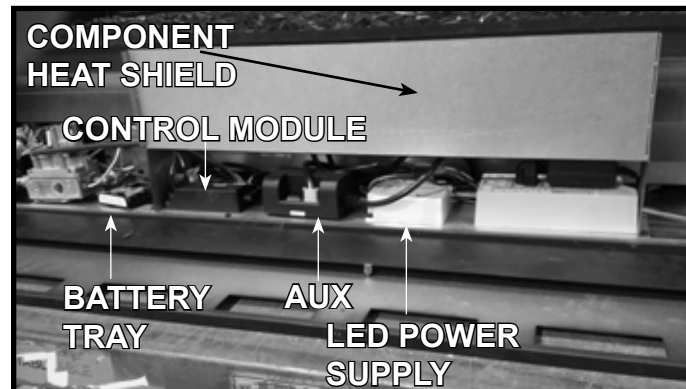

Figure 4. Electrical Components in Position

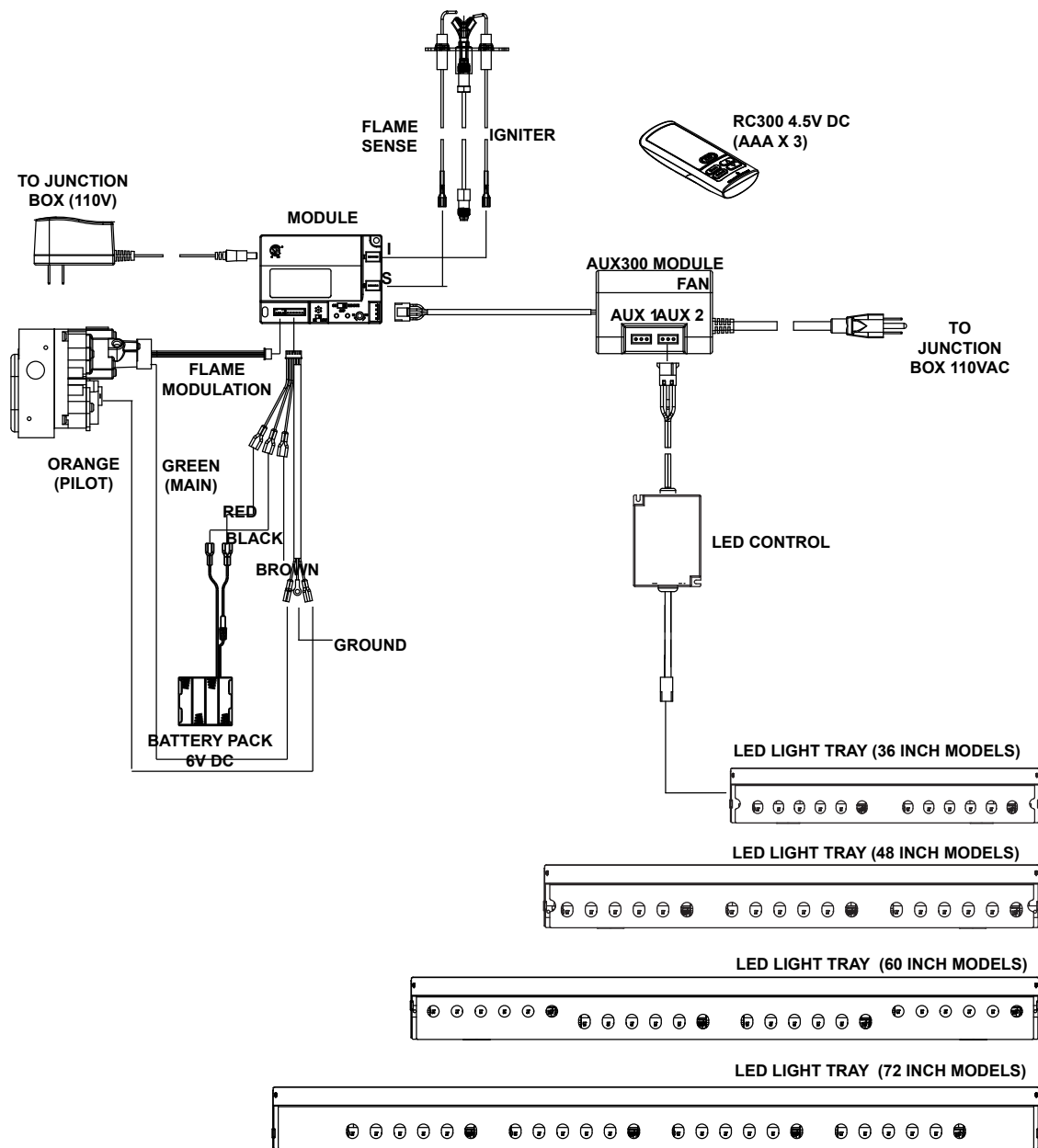

Figure 5. LED Wiring Diagram

LED Operation

The LED lights are operated using the auxiliary (AUX2) function on the remote control. See Figure 6.

AUX2 Function

- Press the **MENU** button to activate the menu.
- Using the **UP** and **DOWN** arrows highlight the **AUX2** icon and press **SELECT**.
- Use the **UP** and **DOWN** arrows to turn the **AUX2 ON** or **OFF**, then press **SELECT**. The **AUX2** function can be either be turned **ON** or **OFF**.

NOTICE: The system will remember the previous AUX1 and AUX2 setting from the menu. However, when the fireplace is turned OFF both AUX1 and AUX2 will be turned off. AUX and AUX2 can be activated when the flame is off from the remote's OFF mode. When the fireplace is turned back ON the AUX1 and AUX2 settings will be restored to the previous ON setting.

Service Parts

PART NUMBER	DESCRIPTION
2273-308	LED Power Supply
2300-014	LED Strips/Wire Assembly
2166-335	AUX300

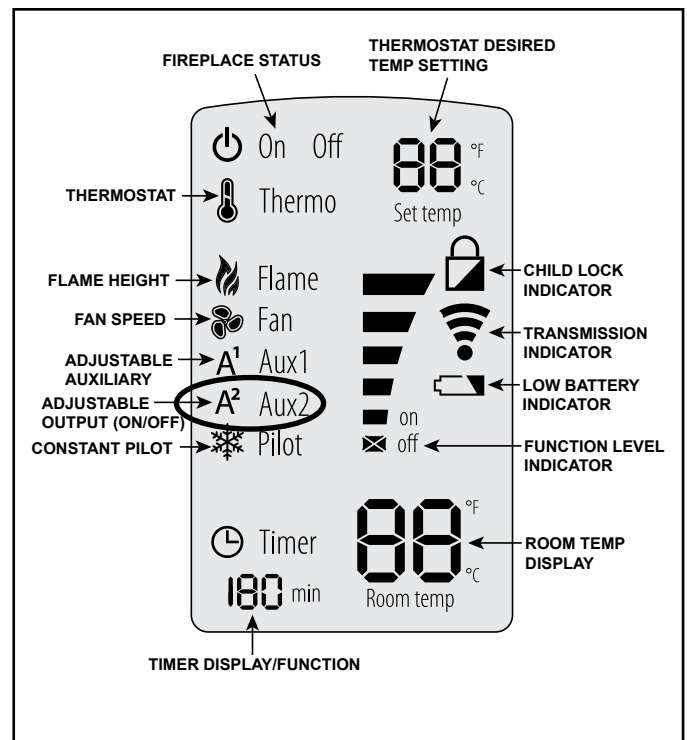

Figure 6. RC300 Display Screen - Aux2 Function Highlighted

Heatilator, a brand of Hearth & Home Technologies
 7571 215th Street West, Lakeville, MN 55044
www.heatilator.com

Please contact your Heatilator dealer with any questions or concerns.
 For the location of your nearest Heatilator dealer, please visit www.heatilator.com.