

AMB-LIGHTS

Models: FRAME-V12, FRAME-S21, FRAME-H31

STUDIO-V12, STUDIO-S21, STUDIO-H31, DF-FSV7, DF-FSS7, DF-FSH7

Installation Instructions

Note: The AMB-LIGHTS kit is not approved for use with the Radius door.



Leave this instruction with party responsible for use and operation.

⚠ WARNING



HOT SURFACES!

Glass and other surfaces are hot during operation AND cool down.

Hot glass will cause burns.

- Do not touch glass until it is cooled
- NEVER allow children to touch glass
- Keep children away

- CAREFULLY SUPERVISE children in same room as fireplace.
- Alert children and adults to hazards of high temperatures.

High temperatures may ignite clothing or other flammable materials.

- Keep clothing, furniture, draperies and other flammable materials away.

This appliance has been supplied with an integral barrier to prevent direct contact with the fixed glass panel. Do NOT operate the appliance with the barrier removed.

Contact your dealer or Hearth & Home Technologies if the barrier is not present or help is needed to properly install one.

CAUTION! Risk of Cuts or Abrasions. Wear protective gloves and safety glasses during installation. Sheet metal edges are sharp.

CAUTION! Do not install damaged components. If you received components that are damaged, contact your dealer for assistance.

KIT CONTENTS:

- LED 12 Volt Power Supply
- Wire Clip, 1/4 in. diameter (10)
- Wire Tie, 6 in. (10)
- LED Switch Box
- 1 X 1 Velcro Assembly (3)
- Nut, Keps #10-32 (4)
- LED Strips/Wire Assembly
- Extension Wire (Optional)
- LED Brackets (2)

INSTALLATION

1. All steps to install the AMB-LIGHTS Kit will be done on the lower back side of the decorative front. Figure 1 shows the features used to determine the top and bottom of the decorative front.

2. Place the LED switch box on the lower stud of the decorative front. See Figure 2. For top mounting of the LED switch bracket, see page 3.

Note: Exact position of LED switch box may vary depending on appliance model.

3. Place LED brackets onto top and bottom studs. The bottom of the LED bracket will share the stud with the LED switch box and the 12V power supply ground. See Figure 2, Figure 3 and Figure 8. Bend LED brackets to achieve the desired angle for light distribution. A 45 degree angle may achieve the optimum lighting effect. The brackets will be secured with keps nuts in Step 9.

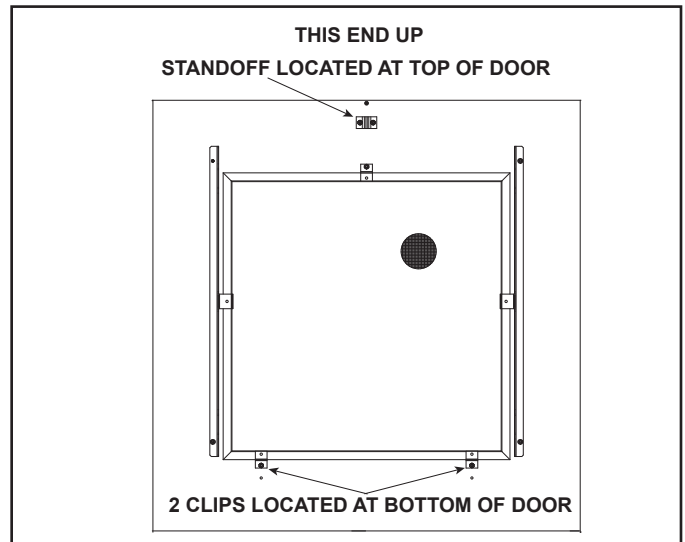

Figure 1. Decorative Front - Rear View

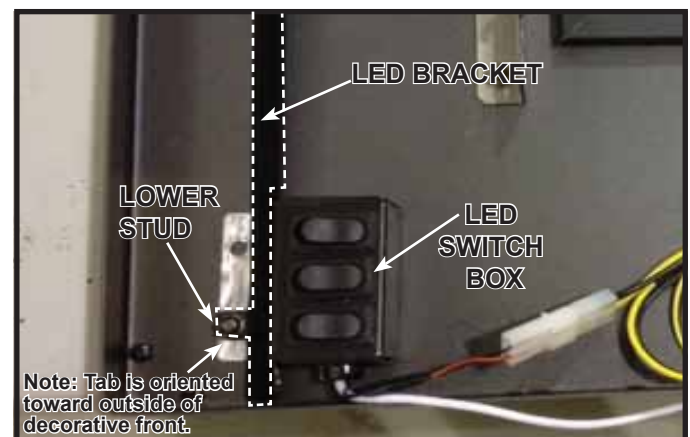

Figure 2. View from Back Side of Decorative Front (H31 Decorative Front Shown)

4. Remove the adhesive backing from the LED strips and adhere the LED strips in place on the LED brackets. See Figure 3.
5. Secure each LED Strip with five zip ties. Place zip ties in the "white" areas of the LED strips. Do not allow zip ties to cover the light emitters on the LED strips. Trim ends of zip ties. See Figure 3. **Note:** Only four of the five zip ties are visible.

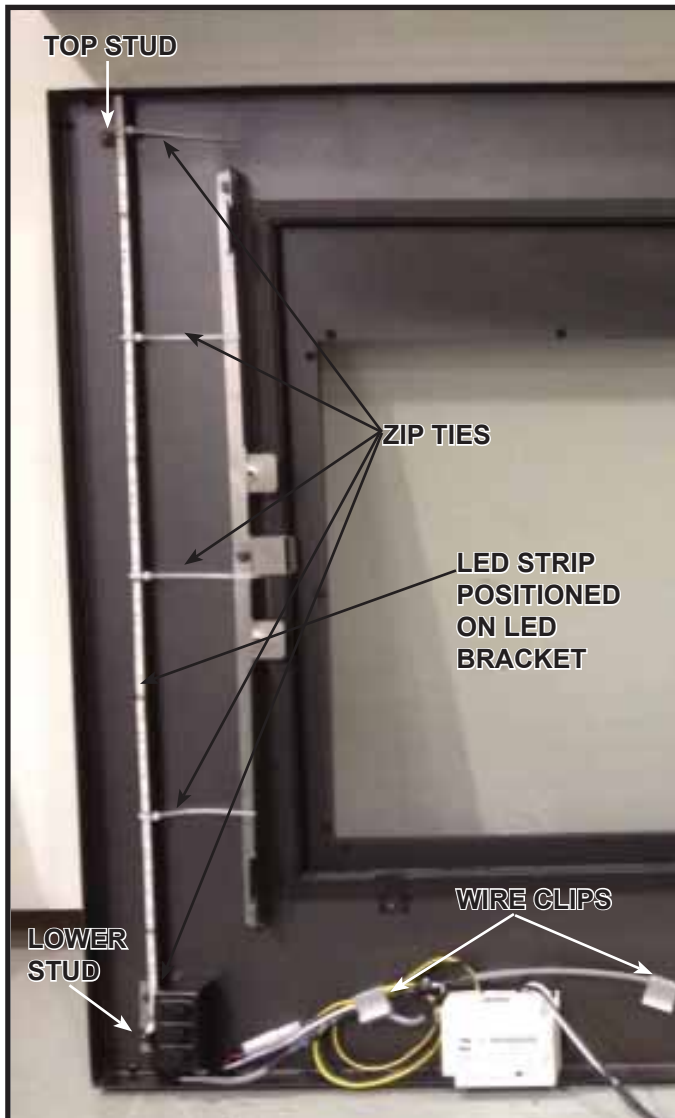

Figure 3. LED Strips Installed with Zip Ties

6. Connect the yellow and black 12V power supply wires to the red and black wires from the LED switch box. See Figure 4 and Figure 7.
7. Connect the LED switch box to the LED strips/wire assembly. See Figure 4 and Figure 7.
8. Position the 12 volt power supply box at least six inches from the outer edge of the door to allow for clearance for the outer wrap. Secure with velcro piece(s). The 12 volt power supply should rest on the bottom return bend of the door. See Figure 5.
9. Secure the ground wire from the 12V power supply. The ground terminal should come into contact with the unpainted portion of the LED switch box. See Figure 8. Secure top and bottom studs with keps nuts.

10. Wrap excess wire neatly using the provided plastic clips. Keep it away from the mesh area and secure it tight to the door. See Figure 3 and Figure 5.

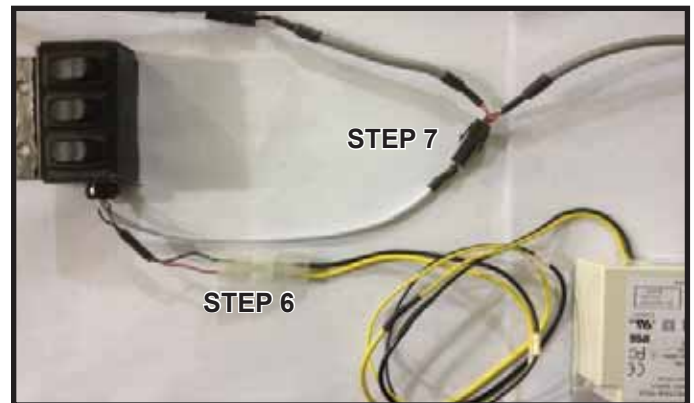

Figure 4.

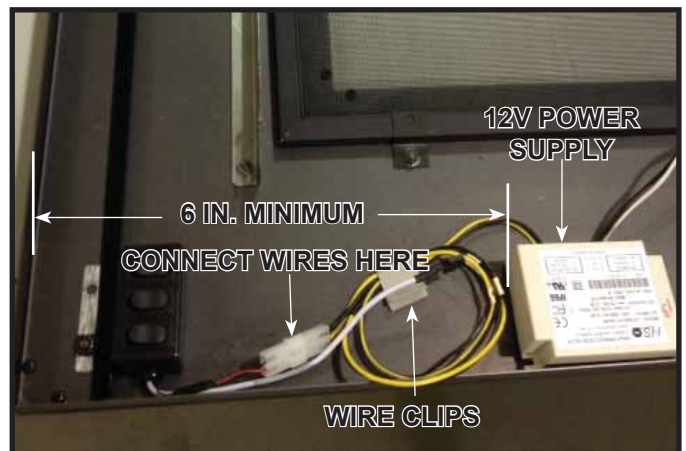

Figure 5.

Optional Top Mounting of LED Switch Box

If desired the LED switch box may be installed using the top stud. See Figure 3 for top stud location. In this case, the extension wire, included in the AMB-LIGHTS Kit, must be used between the LED switch box and the LED strips/ wire assembly. See Figure 7. This will allow for enough length to install the LED switch box on the top stud.

LED Switch Operation

Three black switches are used to operate the exterior lighting control for the fireplace. There are seven color options. See Figure 6. Flipping a combination of these three buttons activates the desired color. The chart in Figure 6 shows the combinations for each of the seven colors.

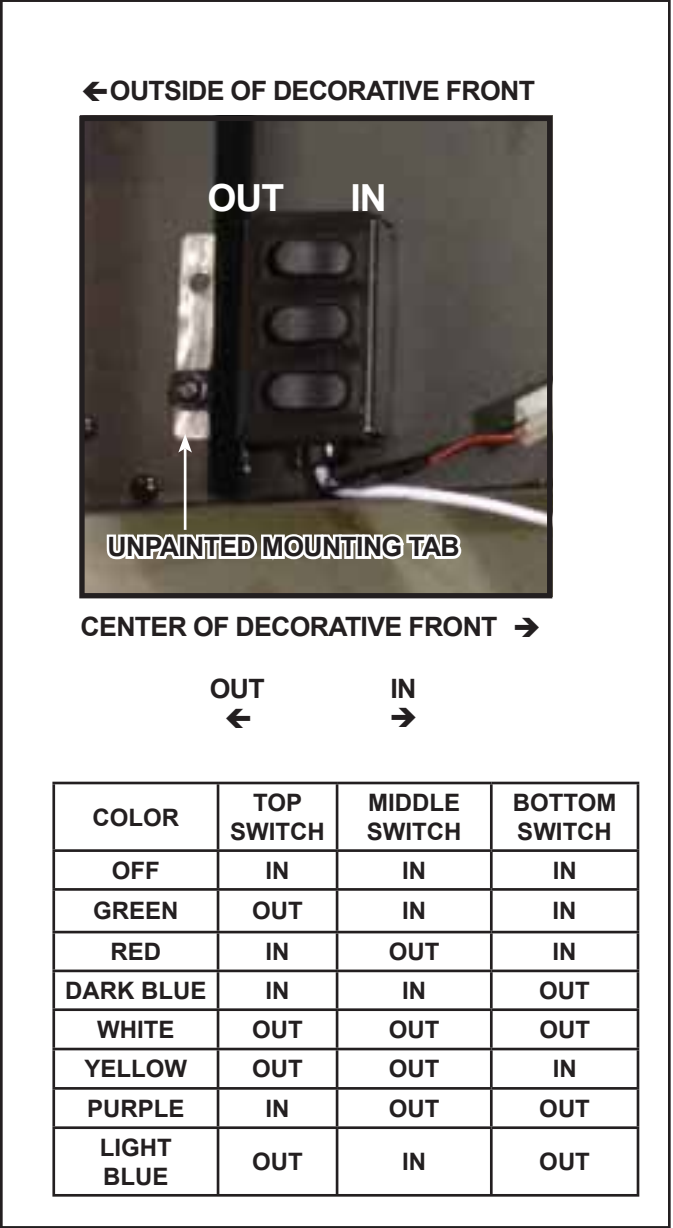

Figure 6. LED Color Combinations

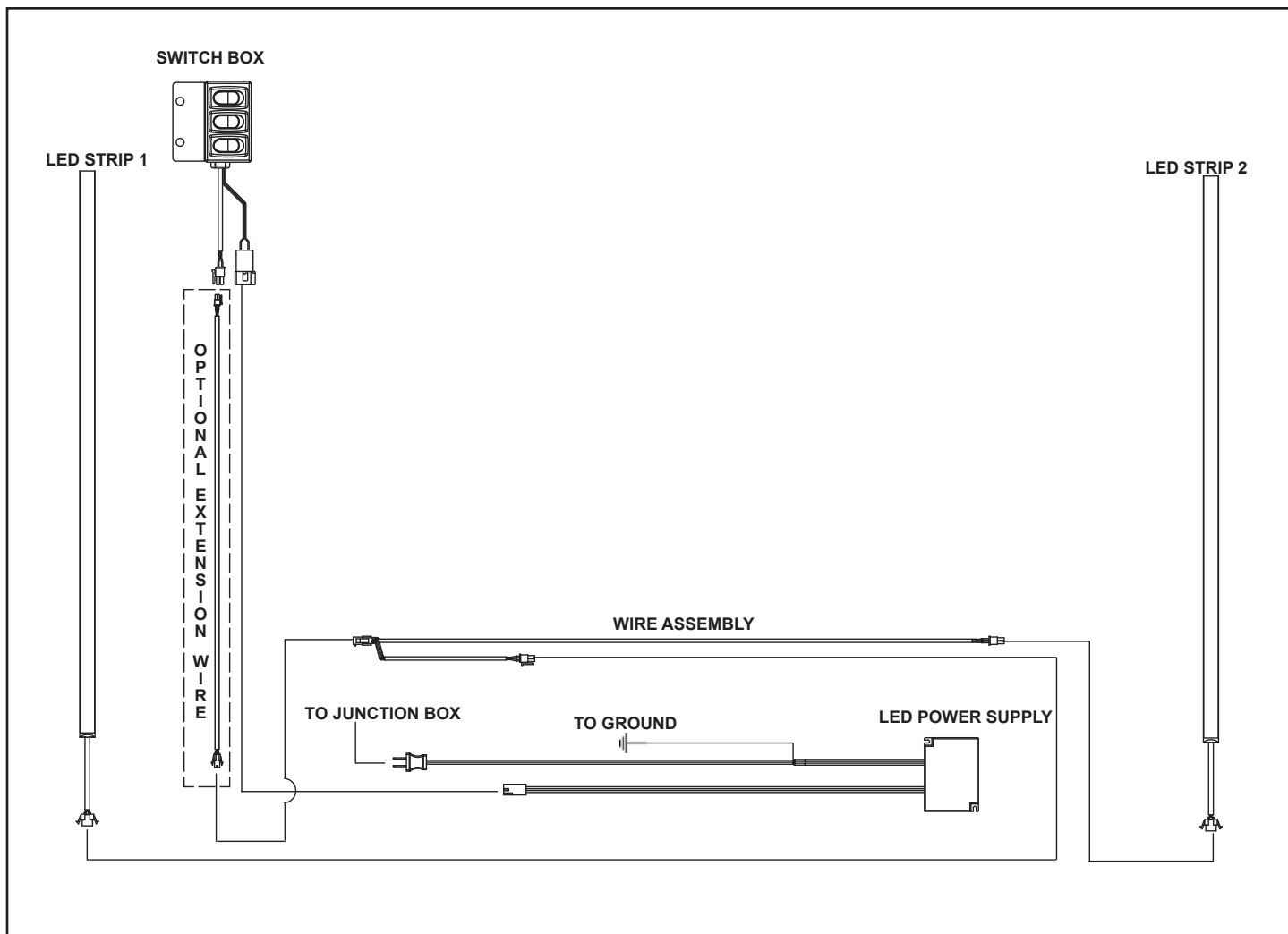

Figure 7. LED Wiring Diagram

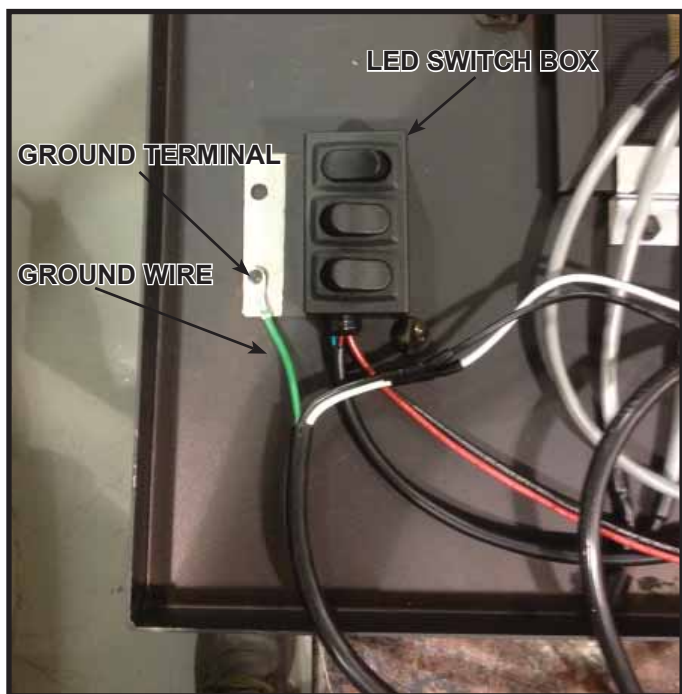

Figure 8. Location of Ground Wire (V12 Decorative Front Shown)

Service Parts

PART NUMBER	DESCRIPTION
2273-308	LED Power Supply
2273-014	LED Switch Box
2273-270	Extension Wire
2273-313	LED Strips/Wire Assembly

Please contact your Hearth & Home Technologies dealer with any questions or concerns.

For the location of your nearest Hearth & Home Technologies dealer, please visit www.hearthnhome.com.

Hearth & Home Technologies
7571 215th Street West, Lakeville, MN 55044
www.hearthnhome.com