

heatilator®

THE WOODBURNING SPECIALISTS

Heatilator Inc.
1915 W. Saunders Street
Mt. Pleasant, IA 52641
Division, HON INDUSTRIES

G160 INSTALLATION & OPERATING INSTRUCTIONS FOR RESIDENTIAL USE

I. LISTINGS AND CODE APPROVALS

This gas fireplace has been tested in accordance with National Safety Standards, and has been LISTED by Underwriters Laboratories Inc. for installation and operation as described in these Installation & Operating Instructions.

Check with your local building code agency before you begin installation to ensure compliance with local codes, including the need for "permits" and follow-up inspections. If any problems are encountered regarding code approvals, or if you wish clarification of any of the instructions contained here, contact: Technical Services, Heatilator Inc., 1915 W. Saunders Street, Mt. Pleasant, Iowa 52641. HEATILATOR® is a registered trademark of Heatilator Inc., Division, HON INDUSTRIES.

FOR YOUR SAFETY

IF YOU SMELL GAS:

1. OPEN WINDOWS.
2. DON'T TOUCH ELECTRICAL SWITCHES.
3. EXTINGUISH ANY OPEN FLAMES.
4. IMMEDIATELY CALL YOUR GAS SUPPLIER.

FOR YOUR SAFETY

DO NOT STORE OR USE GASOLINE
OR OTHER FLAMMABLE VAPORS
AND LIQUIDS IN THE VICINITY OF
THIS OR ANY OTHER APPLIANCE.

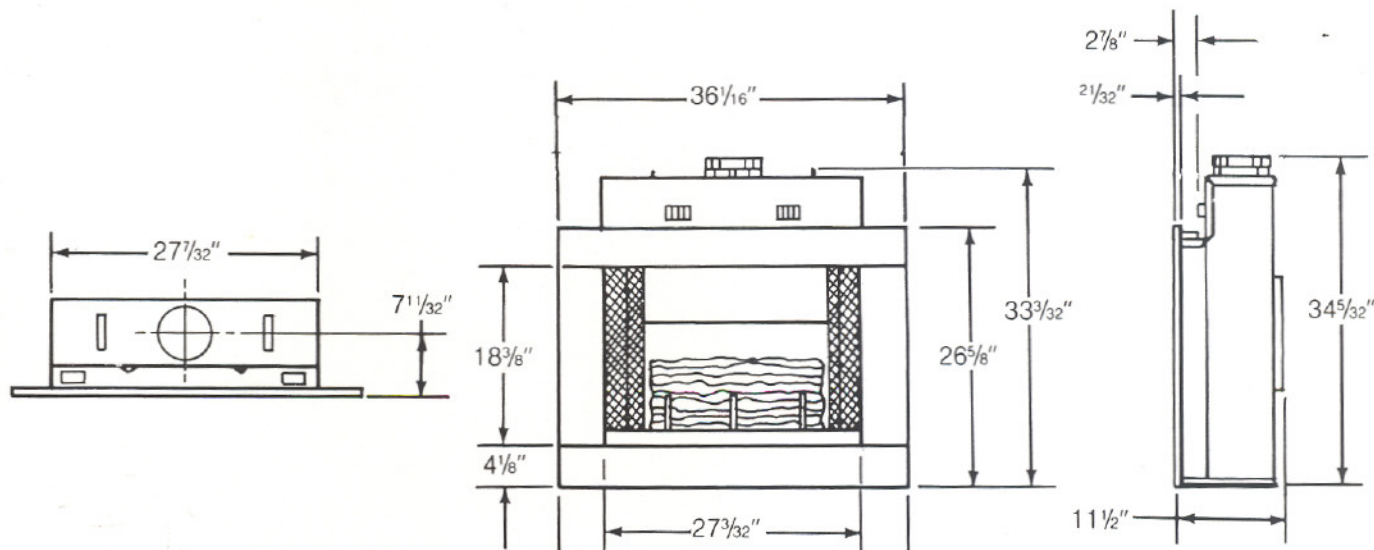

II. GENERAL INFORMATION

This installation must conform with local codes or, in the absence of local codes, with the National Fuel Gas Code, ANSI Z223.1-1984.

INSTALLATION AND REPAIR SHOULD BE DONE BY A QUALIFIED SERVICE PERSON. THE APPLIANCE SHOULD BE INSPECTED BEFORE USE AND AT LEAST ANNUALLY BY A QUALIFIED SERVICE PERSON. MORE FREQUENT CLEANING MAY BE REQUIRED DUE TO EXCESSIVE LINT FROM CARPETING, BEDDING MATERIAL, ETC. IT IS IMPERATIVE THAT CONTROL COMPARTMENTS, BURNERS AND CIRCULATING AIR PASSAGEWAYS OF THE APPLIANCE BE KEPT CLEAN.

Provide adequate clearances around the air openings into the combustion chamber and adequate accessibility clearances for servicing and proper operation.

Minimum clearances to combustibles are: Floor 0", Back 0", Sides 0", Vent Surfaces 1".

When the fireplace is installed directly on carpeting, tile or other combustible material other than wood flooring, the appliance shall be installed on a metal or wood panel extending the full width and depth of the fireplace.

Provide for adequate combustion and ventilation air.

The minimum inlet gas supply pressure is 4.5 inches water column, for the purpose of input adjustment. Input rate is 16,000 BTU/HR. The maximum inlet gas pressure is 7.0 inches water column. For use with natural gas only.

A 1/8" NPT plugged tapping is provided on the gas control, near the outlet to the main burner, for a test gage connection.

DUE TO HIGH TEMPERATURES, THE APPLIANCE SHOULD BE LOCATED OUT OF TRAFFIC AND AWAY FROM FURNITURE AND DRAPERIES.

III. FIREPLACE LOCATIONS, SPACE AND CONSTRUCTION REQUIREMENTS

The G160 gas fireplace can be installed in a wide variety of ways and will fit nearly any room layout. It may be installed in a recessed position or it can be framed out into the room. Locating the unit across a corner is another possibility. The unit may be installed at a height level with the floor, or it can be raised up from the floor to enhance its visual impact. Figure 1 illustrates a variety of ways the fireplace may be located in a room.

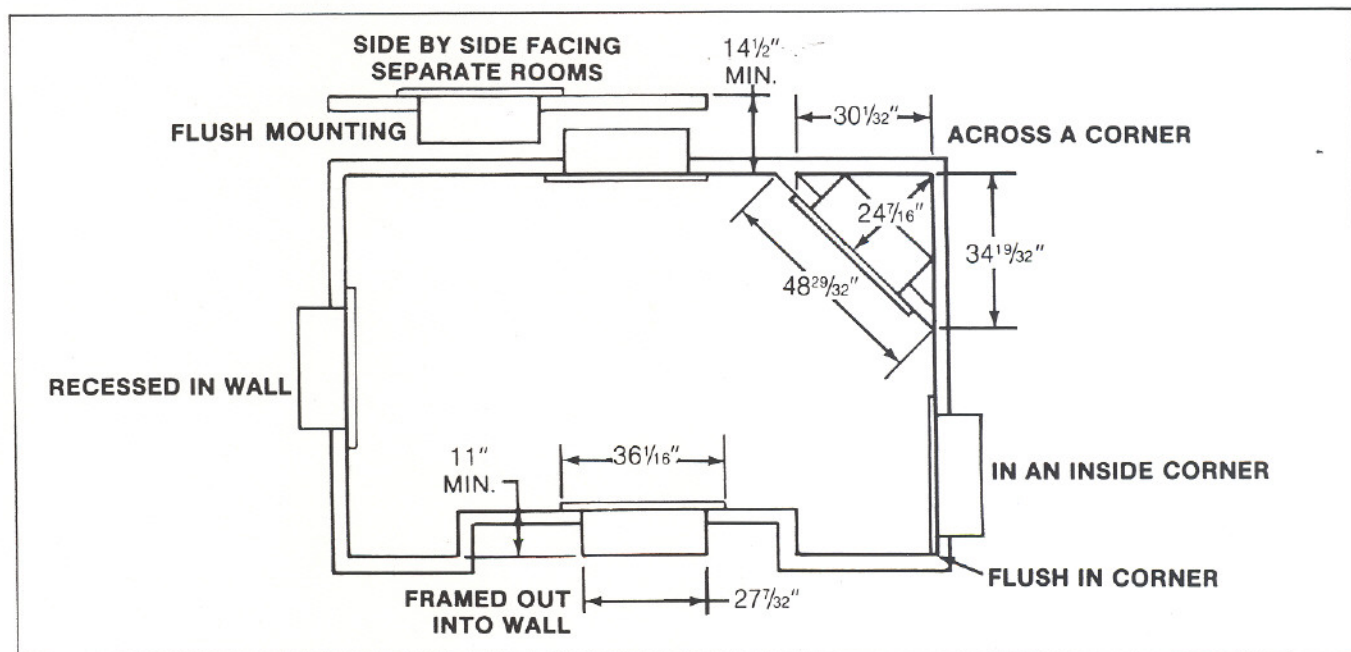

Figure 1

Proper clearances to combustible sidewalls, as illustrated in Figure 1, must be maintained.

IV. STEP-BY-STEP INSTALLATION

□ STEP 1

This gas fireplace fits standard 16" on center wood stud spacing. Omit the center stud, leaving a framing width of 30½" between studs. The top header cannot be installed until after the fireplace assembly has been set.

□ STEP 2

Cut (2) dummy studs 26" long and nail them to the inside of the regular studs in the opening where the fireplace will be located. The dummy studs should be offset forward the thickness of the finish wall (i.e., if wall will be finished with 1/2" drywall, the dummy studs should be offset 1/2" forward). **NOTE: The maximum finish wall thickness is 1".**

□ STEP 3

The fireplace cavity must have a minimum depth of 11", measured from the front of the dummy studs.

□ STEP 4

Install the gas line piping up to the back of fireplace. A 1/2" NPT gas connection should be positioned 3" above the floor and 6⅝" from either side of the unit. A separate shut-off gas valve (not supplied) should always be installed. Plan ahead for easy access.

□ STEP 5

Position the fireplace into the opening between the (2) dummy studs and use (4) nails to secure it in place.

□ STEP 6

Connect 4" Type B-1 vent to the vent collar of the fireplace.

CAUTION

THIS FIREPLACE SHOULD NOT BE CONNECTED TO A CHIMNEY FLUE SERVING A SEPARATE SOLID-FUEL BURNING APPLIANCE.

□ STEP 7

Cut a header board 30½" in length and also cut the center stud to the appropriate size.

Install the header board and center stud, flat, as shown in Figure 2.

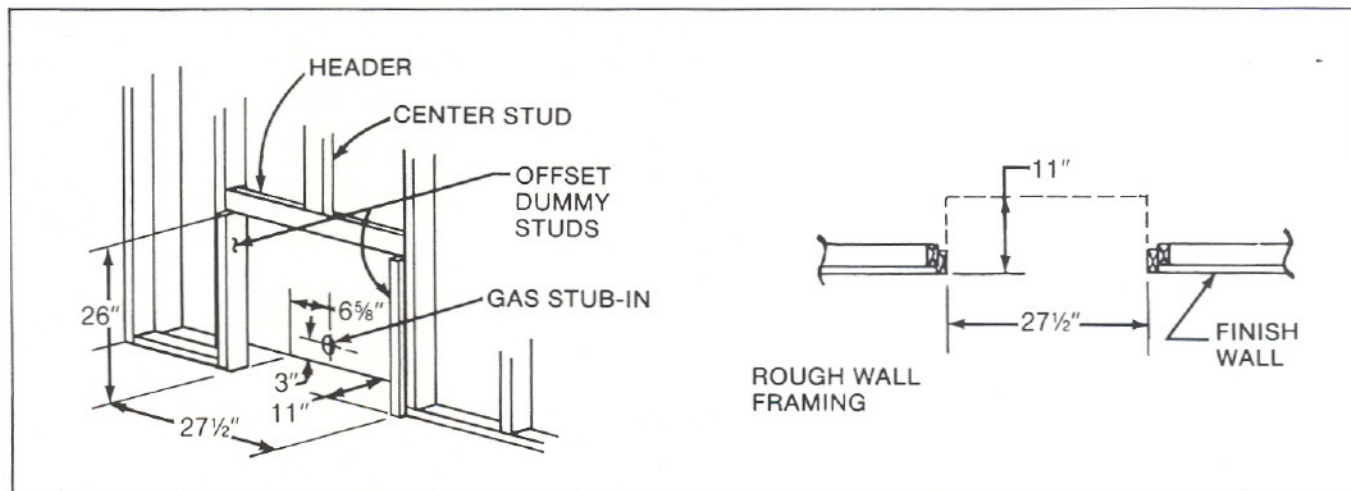

Figure 2

□ STEP 8

If an optional remote wall switch is desired, install it in a convenient location and run 18 AWG millivolt wire to the fireplace box. **NOTE: Maximum length is 40 feet.**

□ STEP 9

Finish walls and facing of the fireplace enclosure.

□ STEP 10

Install the Screen onto the front face of the fireplace. Slip the Rod through the hog rings on the Screen sections, positioning the Screen pulls in the center. Slide the Screen Rod through the hole above the opening of the front face on one side and push it through until the Rod can be slid into the hole on the other side of the opening. Install the Rod caps on both ends of the Rod to secure it in position.

□ STEP 11

Attach the front face to the fireplace, by fastening it to the sides with the (6) screws provided in the fastener package. Be sure to press the front face back against the facing wall of the enclosure.

□ STEP 12

Place the Burner assembly into the fireplace, locating it against the back wall of the firebox and onto the brackets. See Figure 3.

□ STEP 13

Connect the gas line to the fireplace valve inlet, using pipe or a listed flexible Connector. Check for gas leaks with a soap and water solution.

NOTE: During any pressure testing of the gas supply piping system that exceeds test pressures of 1/2 psig, this appliance and its individual shut-off valve must be disconnected from the piping system. If test pressures equal to or less than 1/2 psig are used in pressure testing the gas supply piping system, this appliance must be isolated from the piping system by closing its individual manual shut-off valve during the testing.

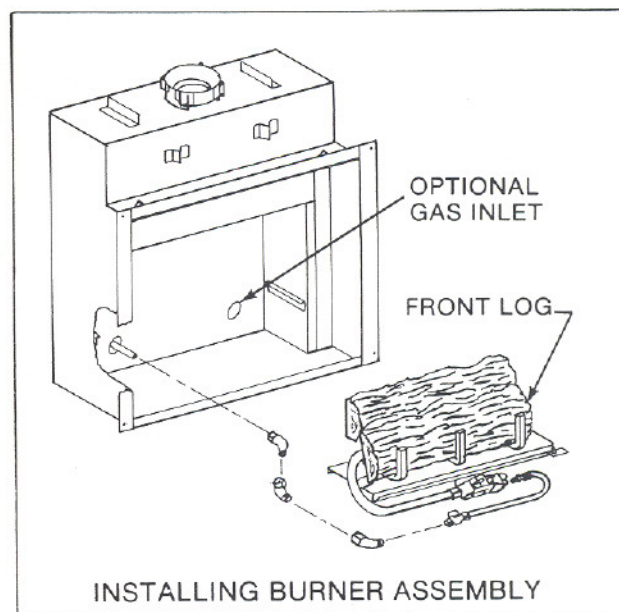

Figure 3

□ STEP 14

If the standard built-in Push-button Switch is to be used, the wiring must be completed. Attach one wire from the Limit Switch to the "TH-TP" terminal on the gas Control Valve; the other wire from the Limit Switch to the stripped lead from the Push-button Switch - secure together with the wire nut provided. See Figure 4.

□ STEP 15

For an optional wall switch only, attach one wire from the switch to the "TH" terminal on the gas Control Valve. Connect the other wire from the wall switch to the second wire from the Limit Switch - secure together with the wire nut provided. Refer to Figure 4 for wiring diagram. **NOTE:** Wiring should be type AWM-125°C or equivalent.

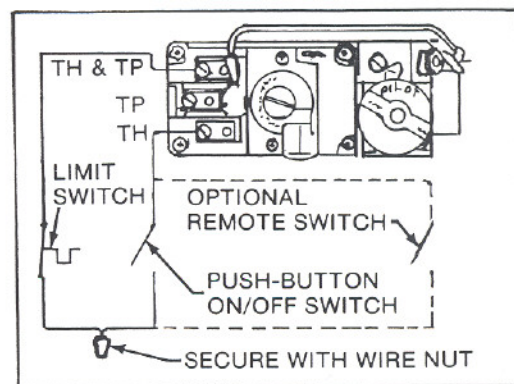

Figure 4

STEP 16

Install the front cover.

STEP 17

Place the Front Log in position on the log rests. See Figure 3.

OPTIONAL INSTALLATIONS

If you prefer, the fireplace can be installed in a raised position or recessed into the wall, to be flush with the facing material.

To install in a raised position, the fireplace opening should be framed as illustrated in Figure 5. Follow the Step-By-Step Instructions to complete the installation.

If it is desired to have the front of the unit flush with the finished wall, so that marble, slate, brick or other trim materials can be applied, the following framing instructions should be followed:

STEP A

Frame the opening $36\frac{1}{8}"$ wide by $26\frac{3}{4}"$ high. **NOTE:** The header and center studs should not be installed until after the fireplace has been placed in position.

STEP B

Cut dummy floor plates $4\frac{1}{4}"$ in length, and also dummy studs tall enough to reach the header.

STEP C

Offset the dummy studs and floor plates as shown in Figure 6. The face of the dummy studs must be $11/16"$ back from the finished wall surface. **NOTE:** In some instances, the dummy studs may end up offset forward of the regular stud face, if the finish wall material is greater than $11/16"$.

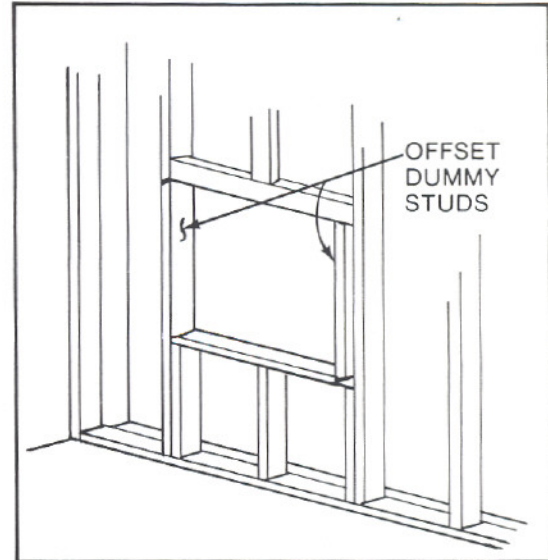

Figure 5

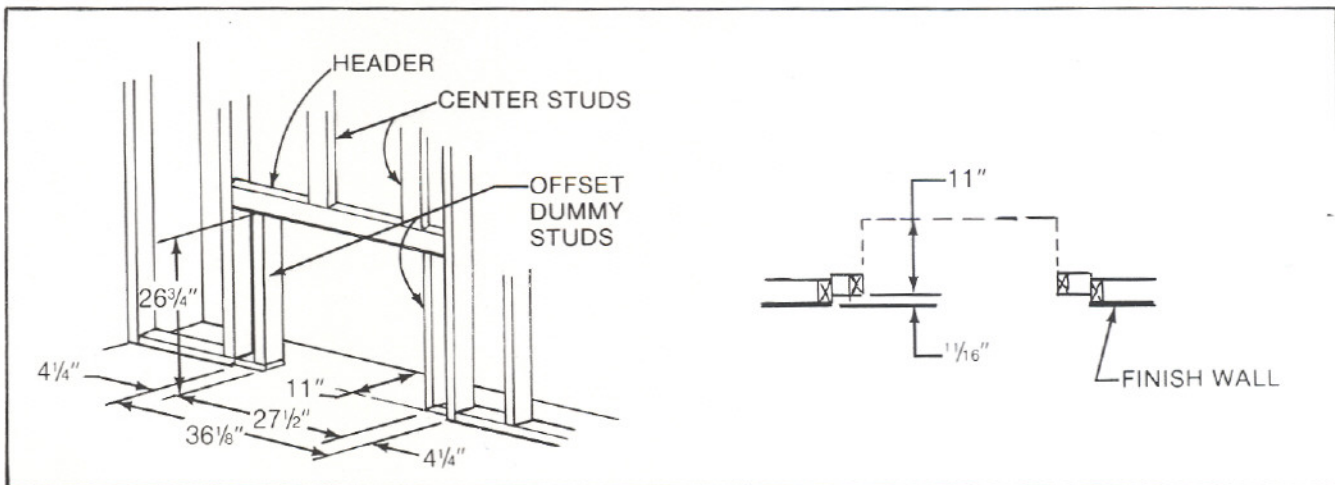

Figure 6

STEP D

Proceed to Step 3 of the Step-By-Step Instructions and follow through to complete the installation.

V. OPERATING INSTRUCTIONS

This gas fireplace uses a low voltage (millivolt) control system, consisting of a Pilot Burner, Thermopile, Gas Control Valve, Limit Switch and an on/off Push-button Switch.

LIGHTING PROCEDURE

1. If an optional wall switch is installed, turn to the "Off" position.
2. Turn the gas knob to the "Off" position.
3. Wait five minutes to allow gas, that may have accumulated in the Main Burner compartment, to escape.
4. Turn the gas knob to the "Pilot" position.
5. Depress and hold the gas knob while applying a lighted match to the Pilot Burner. Allow the Pilot to burn 1½ minutes before releasing the gas knob.
6. Turn the gas knob to the "On" position.
7. Turn on the Main Burner by pressing the Push-button Switch or using the wall switch.

SHUTDOWN PROCEDURE

1. To shut off the Main Burner, press the Push-button Switch or wall switch.
2. Turn the gas knob to "Pilot" to turn off the gas to the Main Burner.
3. Depress and turn the gas knob to "Off" to shut off the Pilot.

REPLACEMENT PARTS

<u>PART NO.</u>	<u>DESCRIPTION</u>
12336	Installation Instructions
12246	Limit Switch
12380	Front Log
12381	Rear Log
12245	Push-button Switch
12195	Pilot Burner
12196	Thermopile
12191	Control Valve
12194	Main Burner Orifice
12364	Pilot Tubing
12170	Burner
12378	Screen Panel
12379	Screen Rod
12303	Gas Appliance Connector

Replacement parts are available from your distributor/dealer, or through Heatilator Inc., 1915 W. Saunders Street, Mt. Pleasant, Iowa 52641.

PILOT BURNER ADJUSTMENT

1. Remove the Pilot adjustment cap.
2. Adjust the Pilot key to provide properly sized flame. See Figure 7.
3. Replace the Pilot adjustment cap.

MAINTENANCE INSTRUCTIONS

Keep the Burner and Control compartment clean by brushing and vacuuming at least once a year. Always turn off the Pilot before cleaning.

Periodically visually check the flame of the Pilot and Burner, making sure the flames are steady; not lifting or floating. The flame color should be blue. The top 3/8" of the Pilot Thermopile should be covered with flame. See Figure 7.

The appliance and venting system should be inspected before use, or at least annually, by a qualified field service person.

Keep the area near the appliance clear and free from combustible materials, gasoline and other flammable vapors and liquids.

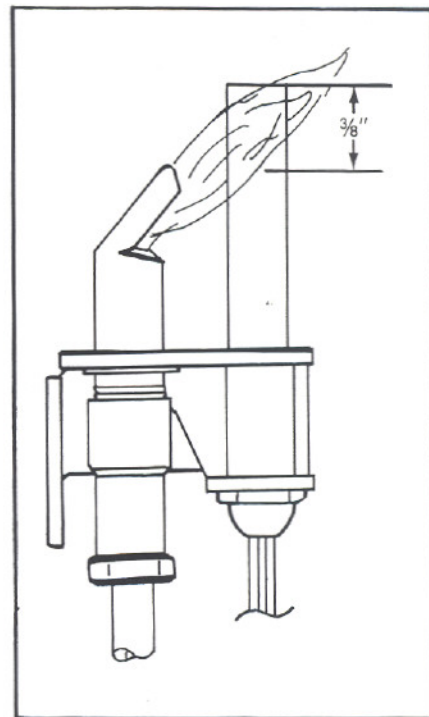

Figure 7

WARNING

CHILDREN AND ADULTS SHOULD BE ALERTED TO THE HAZARDS OF HIGH SURFACE TEMPERATURE AND SHOULD STAY AWAY TO AVOID BURNS OR CLOTHING IGNITION. YOUNG CHILDREN SHOULD BE CAREFULLY SUPERVISED WHEN THEY ARE IN THE SAME ROOM AS THE APPLIANCE.

CAUTION

ANY SAFETY SCREEN OR GUARD REMOVED FOR SERVICING AN APPLIANCE MUST BE REPLACED PRIOR TO OPERATING THE APPLIANCE.

CLOTHING OR OTHER FLAMMABLE MATERIAL SHOULD NOT BE PLACED ON OR NEAR THE APPLIANCE.



Attention **Fireplace Installer:**

*Please return operating
and installation
instructions to the firebox
for consumer use.*

heatilator[®]
THE WOODBURNING SPECIALISTS