

## Allusion Edge

### Slide-In Linear Electric Fireplaces

#### Model(s):

SF-ALLE50  
SF-ALLE60  
SF-ALLE78  
SF-ALLE100

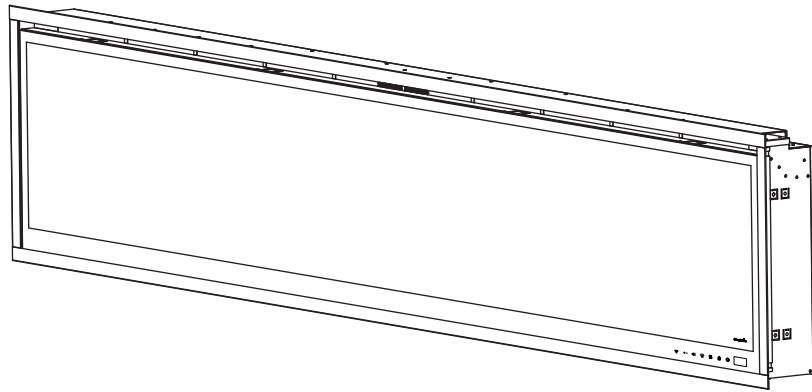

#### NOTICE



##### DO NOT DISCARD THIS MANUAL

- Important operating and maintenance instructions included.
- Read, understand and follow these instructions for safe installation and operation.
- Leave this manual with party responsible for use and operation.

**DO NOT  
DISCARD**

#### Congratulations!

Congratulations on selecting a SimpliFire Electric Fireplace, an elegant and clean alternative to wood & gas burning fireplaces. The SimpliFire electric fireplace you have selected is designed to provide the utmost in safety, reliability, and efficiency.

**READ CAREFULLY BEFORE ATTEMPTING TO ASSEMBLE, INSTALL, OPERATE, OR MAINTAIN THIS PRODUCT.**

**PROTECT YOURSELF AND OTHERS BY OBSERVING ALL SAFETY INFORMATION. FAILURE TO COMPLY WITH INSTRUCTIONS COULD RESULT IN PERSONAL INJURY AND/OR PROPERTY DAMAGE.**

**⚠ WARNING: To reduce risk of fire, electrical shock, or personal injury, read and understand all instructions, including safety information before connecting power and using appliance.**

Please contact your SimpliFire dealer with any questions or concerns.  
For the location of your nearest SimpliFire dealer,  
please visit [www.hearthnhome.com](http://www.hearthnhome.com).

# 1 Important Instructions

## IMPORTANT SAFETY INSTRUCTIONS

### **WARNING! Risk of Fire! Risk of Burns! Risk of Electrical Shock!**

*This electrical appliance includes an electric heater.*

#### **DO NOT:**

- Install or operate damaged heater
- Modify heater
- Operate the heater without fully assembling all components

*Hearth & Home Technologies disclaims any responsibility for, and the warranty and agency listing will be voided by, the above actions.*

**WARNING! DO NOT operate appliance before reading and understanding operating instructions.** Failure to operate appliance according to operating instructions could cause fire or injury.

**WARNING! Improper installation, adjustment, alteration, service or maintenance can cause injury or property damage.** Failure to install appliance according to Owner's Manual could cause property damage or injury.

**NOTICE!** This appliance is not intended for use as a primary heat source and should not be factored as such in residential heating calculations.

When using electrical heaters/appliances, basic precautions should always be followed to reduce the risk of fire, electric shock, and injury to persons, including but not limited to the following:

- Read all instructions before installing this appliance.
- Use this appliance only as described in this manual. Any other use not recommended by the manufacturer may cause fire, electric shock, or injury to persons.
- The heater is hot when in use. To avoid burns, do not let bare skin touch hot surfaces. Keep combustible materials such as furniture, pillows, bedding, papers, clothes, decorations, and/or curtains, etc. at least 3 ft. (0.9 m) from the front of the appliance.
- Extreme caution is necessary when any heater is used by or near children or other at risk individuals and whenever the heater is left operating and unattended.
- Do not operate any heater if it malfunctions. Disconnect power at service panel and have appliance inspected by a certified electrician before reusing.
- Do not insert or allow foreign objects to enter any ventilation or exhaust opening as this may cause an electric shock or fire, or damage the appliance.
- Do not block appliance fan air intakes or exhaust in any manner to prevent damage or possible fire.
- A heater has hot and arcing or sparking parts inside. Do not use it in areas where gasoline, paint, flammable vapors or liquids are used or stored.
- Do not use outdoors.
- Do not operate any appliance that has been dropped or damaged in any manner or that has a damaged cord/plug. Return appliance to authorized service facility for examination, electrical or mechanical adjustment, or repair.
- Do not run cord under carpeting. Do not cover cord with throw rugs, runners, or the like. Arrange cord away from traffic areas and where it will not be tripped over. Do not tightly coil cord.
- Never use an extension cord or relocatable power strip to power the appliance.
- Always use properly grounded, fused, and polarized outlets.
- Always use ground fault protection where required by electrical code.
- Always use a certified electrician should the appliance require a new circuit.
- Always disconnect power to the appliance by removing the plug from electrical outlet and disconnecting power at the service panel before performing any cleaning, maintenance, or relocation of the appliance.
- When transporting or storing the appliance, keep in a dry place free from excess vibration to avoid damage.
- Never locate appliance where it may fall into a bathtub or water container.

**SAVE THESE INSTRUCTIONS**

## Safety Alert Key:

- **DANGER!** Indicates a hazardous situation which, if not avoided will result in death or serious injury.
- **WARNING!** Indicates a hazardous situation which, if not avoided could result in death or serious injury.
- **CAUTION!** Indicates a hazardous situation which, if not avoided, could result in minor or moderate injury.
- **NOTICE:** Used to address practices not related to personal injury.

## Table of Contents

Congratulations! .....	1
------------------------	---

### 1 Important Instructions

A. Warranty .....	4
-------------------	---

### 2 General Information

A. Appliance Certification .....	6
B. Unpacking and Inspecting Appliance .....	6
C. Model and Serial Number Information .....	6
D. Radio Frequency Compliance .....	7

### 3 Getting Started

A. Parts and Hardware .....	8
B. Tools and Supplies Needed .....	8
C. Optional Accessories .....	8
D. Appliance Dimensions .....	9
E. Location .....	10
F. Clearance to Combustibles .....	10
G. Electrical Supply Circuit Requirements .....	10

### 4 Installation

A. Framing .....	11
B. Electrical Connection .....	12
C. Heater Enable/Disable Switch .....	13
D. Finishing .....	13
E. Appliance Preparation .....	14
F. Wall Installation .....	14
G. Appliance Final Setup .....	15
H. Front Glass .....	17

### 5 Operating Instructions

A. Operation Using Appliance Buttons .....	18
B. Operating by Remote Control. ....	19
C. Room Temperature and Thermostat Function .....	20
D. Resetting Temperature Cutoff Switch. ....	20
E. Operation with Wall Switch. ....	20

### 6 Wi-Fi Setup and Use

A. Add Device - Primary Method .....	21
B. Wi-Fi Operation .....	22
C. Wi-Fi Settings .....	23
D. Add Device - Secondary Method .....	24

### 7 Maintenance

A. Servicing .....	26
B. Cleaning .....	26
C. Troubleshooting Guide .....	27
D. Wiring Schematic .....	29
E. Service Parts Lists .....	30
F. Contact Information .....	34

## A. Warranty

### Hearth & Home Technologies LLC LIMITED WARRANTY

Hearth & Home Technologies LLC (“HHT”) extends the following warranty for HHT gas, wood, pellet and electric hearth appliances (each a “Product” and collectively, the “Product(s)”) and certain component parts set forth in the table below (“Component Part(s)”) that are purchased from a HHT authorized dealer or distributor.

#### **WARRANTY COVERAGE:**

HHT warrants that the Products and their Component Parts will be free from defects in materials and workmanship for the applicable period of Warranty coverage set forth in the table below (“Warranty Period”). If a Product or Component Parts are found to be defective in materials or workmanship during the applicable Warranty Period, HHT will, at our discretion, repair the applicable Component Part(s), replace the applicable Component Part(s), or refund the purchase price of the applicable Product(s). The maximum amount recoverable under this Warranty is limited to the purchase price of the Product. This Warranty is transferable from the original purchaser to subsequent owners, but the Warranty Period will not be extended in duration or expanded in coverage for any such transfer. This Warranty is subject to conditions, exclusions, and limitations as described below.

#### **WARRANTY PERIOD:**

Warranty coverage begins at the date of installation. In the case of new home constructions, Warranty coverage begins six months after invoice of the final sale of the Product(s) by an independent, authorized HHT dealer or distributor. However, the Warranty coverage shall commence no later than 24 months following the date of Product shipment from HHT, regardless of the installation or purchase date.

Warranty Period		HHT Manufactured Appliances and Venting				
Component Parts	Labor	Gas	Pellet	Wood	Electric	Component Parts Covered by this Warranty
1 Year		X	X	X		All parts including handles, external enameled components and other material except as covered by Warranty Conditions, Warranty Exclusions, and Warranty Limitations listed
2 Years					X	All parts except as covered by Warranty Conditions, Warranty Exclusions, and Warranty Limitations listed
			X	X		Glass, Electrical components limited to heating element/igniters, Top feed auger assembly, Blowers, Junction Box, Remotes/Wall switches, linear actuator, power cord, vacuum switch, snap disc, wire harnesses and thermocouple
		X				Electrical components limited to modules, remotes/wall switches, valves, pilots, blowers, junction boxes, wire harnesses, transformers and lights (excluding light bulbs)
		X		X		Cement Refractory Panels, Glass Liner Panels
3 years			X			Firepots, burnpots, Harman mechanical feeders
5 years		X		X		Catalysts, Vented and Vent Free burners and logs
10 years	1 year	X				Burners, logs and metal/fiber refractory components of HHT manufactured fireplaces or stoves, venting due to poor workmanship
10 years	3 years		X	X		Castings, Medallions & Baffles, FlexBurn® System (engine, inner cover, access cover and fireback), Firebox and heat exchanger, HHT Chimney & Terminations, Manifolds
20 years	3 years	X				Firebox and heat exchanger
All purchased replacement parts and optional accessories						
1 Year	None	X	X	X	X	All purchased replacement parts and optional accessories

### **WARRANTY CONDITIONS:**

- Because HHT cannot control the quality of any Products sold by unauthorized sellers, this Warranty only covers Products that are purchased through an HHT authorized dealer or distributor unless otherwise prohibited by law; a list of HHT authorized dealers is available on the HHT branded websites.
- This Warranty is only valid while the applicable Product remains at the site of original installation.
- This Warranty is only valid in the country in which the HHT authorized dealer or distributor that sold the applicable Product is authorized to sell applicable Product.
- Contact your installing distributor or dealer for Warranty service. If the installing dealer or distributor is unable to provide necessary parts, contact the nearest HHT authorized dealer or supplier. Additional service fees may apply if you are seeking Warranty service from a dealer other than the dealer from whom you originally purchased the applicable Product.
- No HHT consumer should bear cost of warranty service or costs incurred while servicing warranty claims (i.e., travel, gas, or mileage) when the service is performed within the terms of this Warranty. Check with your dealer or distributor in advance for any costs to you when arranging a warranty call. Travel and shipping charges for parts are not covered by this Warranty.

### **WARRANTY EXCLUSIONS:**

This Warranty does not cover the following:

- Changes in surface finishes as a result of normal use. As a heating appliance, some changes in color of interior and exterior surface finishes may occur. This is not a flaw and is not covered under the Warranty.
- Damage to printed, plated, or enameled surfaces caused by fingerprints, accidents, misuse, scratches, melted items or other external sources and residues left on the plated surfaces from the use of abrasive cleaners or polishes.
- Repair or replacement of parts that are subject to normal wear and tear during the Warranty Period are not covered. These parts include: paint, wood and pellet gaskets, firebricks, wood grates, flame guides, batteries and the discoloration of glass.
- Minor expansion, contraction, or movement of certain parts causing noise. These conditions are normal and complaints related to this noise are not covered by this Warranty.
- Damages resulting from: (1) failure to install, operate, or maintain the applicable Product in accordance with the installation instructions, operating instructions, and listing agent identification label furnished with the applicable Product; (2) failure to install the applicable Product in accordance with local building codes; (3) shipping or improper handling; (4) improper operation, abuse, misuse, continued operation with damaged, corroded or failed components, accident, or improperly/incorrectly performed repairs; (5) environmental conditions, inadequate ventilation, negative pressure, or drafting caused by tightly sealed constructions, insufficient make-up air supply, or handling devices such as exhaust fans or forced air furnaces or other such causes; (6) use of fuels other than those specified in the operation instructions; (7) installation or use of components not supplied with the applicable Product or any other components not expressly authorized and approved by HHT; (8) modification of the appliance not expressly authorized and approved by HHT in writing; and/or (9) interruptions or fluctuations of electrical power supply to the applicable Product.
- Non-HHT venting components, hearth connections or other accessories used in conjunction with the applicable Product.
- Any part of a pre-existing fireplace system in which an insert or a decorative gas applicable Product is installed.
- HHT's obligation under this Warranty does not extend to the Product's capability to heat the desired space. Information is provided to assist the consumer and the dealer in selecting the proper Product for the application. Consideration must be given to the Product location and configuration, environmental conditions, insulation and air tightness of the structure.

### **This warranty is void if:**

- The applicable Product has been over-fired, operated in atmospheres contaminated by chlorine, fluorine, or other damaging chemicals. Over-firing can be identified by, but not limited to, warped plates or tubes, deformation/warping of interior cast iron structure or components, rust colored cast iron, bubbling, cracking and discoloration of steel or enamel finishes.
- The applicable Product is subjected to prolonged periods of dampness or condensation.
- There is any damage to the applicable Product due to water or weather damage which is the result of, but not limited to, improper chimney or venting installation.

### **LIMITATIONS OF REMEDIES AND LIABILITY:**

- **EXCEPT TO THE EXTENT PROVIDED BY LAW, HHT MAKES NO EXPRESS WARRANTIES OTHER THAN THE WARRANTY SPECIFIED HEREIN. The owner's exclusive remedy and HHT's sole obligation under this Warranty or in contract, tort or otherwise, shall be limited to, at HHT's sole option, replacement of the Component Part(s), repair of the Component Part(s), or refund of the original purchase price of the applicable Product(s). In no event will HHT be liable for any incidental or consequential damages caused by defects in the applicable Product. Some States do not allow the exclusion or limitation of incidental or consequential damages, so the above limitation or exclusion may not apply to you. This Warranty gives you specific legal rights and you may also have other rights which vary from State to State. THE DURATION OF ANY IMPLIED WARRANTY IS LIMITED TO DURATION OF THE EXPRESSED WARRANTY SPECIFIED ABOVE FOR THE APPLICABLE PRODUCT. Some States do not allow limitations on how long an implied warranty lasts, so the above limitation may not apply to you.**

## 2 General Information

### A. Appliance Certification

**MODELS:** SF-ALLE50, SF-ALLE60, SF-ALLE78, SF-ALLE100

**LABORATORY:** CSA International

**TYPE:** Electric Air-Heaters; Fixed and Location-Dedicated  
Electric Room Heaters

**STANDARD:** CSA C22.2 No 46-13; UL 2021 (4<sup>th</sup> Edition)

**NOTICE:** This installation must conform with local building and electrical codes.

**NOT INTENDED FOR USE AS A PRIMARY HEAT SOURCE.**

This appliance is tested and approved as either supplemental room heat or as a decorative appliance. It should not be factored as primary heat in residential heating calculations.



**WARNING:** This product can expose you to Di-(2-ethylhexyl) phthalate, which is known to the State of California to cause cancer and reproductive harm. For more information go to: [www.P65Warnings.ca.gov](http://www.P65Warnings.ca.gov).

### B. Unpacking and Inspecting Appliance

**WARNING! DO NOT use this Electric Fireplace if any part has been under water.** Immediately call your SimpliFire dealer to schedule a qualified service technician to inspect and to replace any part of the electrical system, as needed.

**WARNING! Keep plastic wrapping away from children.**

- Carefully remove the appliance and components from the packaging. Discard packaging.
- Carefully inspect components for any damage.
- Reference parts list to verify all parts have been received.
- Read all the instructions before starting the installation. Follow these instructions carefully during the installation to ensure maximum safety and benefit.

### C. Model and Serial Number Information

The model and serial number information is located on the rating plate. The rating plate is located on the bottom left of the appliance front, behind the glass.

**ELECTRIC FIREPLACE**

MODEL SF-ALLEXX  
VOLTAGE 120V AC  
FREQUENCY 60 Hz  
AMPERAGE 12.5 A  
WATTS 1500 W  
SERIAL No.: \_\_\_\_\_



WIFI Module  
FCC ID: 2ANDL-WBR3  
IC: 23243-WBR3

Hearth & Home Technologies

MADE IN CHINA

### Homeowner Reference Information

*We recommend that you record the following pertinent information about your fireplace.*

Model Name: \_\_\_\_\_ Date purchased/installed: \_\_\_\_\_

Serial Number: \_\_\_\_\_ Location of fireplace: \_\_\_\_\_

Dealership purchased from: \_\_\_\_\_ Dealer Phone: \_\_\_\_\_

Notes: \_\_\_\_\_

## D. Radio Frequency Compliance

This device complies with part 15 of the FCC Rules. Operation is subject to the following two conditions:  
(1) This device may not cause harmful interference, and  
(2) this device must accept any interference received, including interference that may cause undesired operation.

### **FCC warning:**

Any Changes or modifications not expressly approved by the party responsible for compliance could void the user's authority to operate the equipment.

**Note:** This equipment has been tested and found to comply with the limits for a Class B digital device, pursuant to part 15 of the FCC Rules. These limits are designed to provide reasonable protection against harmful interference in a residential installation. This equipment generates uses and can radiate radio frequency energy and, if not installed and used in accordance with the instructions, may cause harmful interference to radio communications. However, there is no guarantee that interference will not occur in a particular installation. If this equipment does cause harmful interference to radio or television reception, which can be determined by turning the equipment off and on, the user is encouraged to try to correct the interference by one or more of the following measures:

- Reorient or relocate the receiving antenna.
- Increase the separation between the equipment and receiver.
- Connect the equipment into an outlet on a circuit different from that to which the receiver is connected.
- Consult the dealer or an experienced radio/TV technician for help.

The device has been evaluated to meet general RF exposure requirement. The device can be used in portable exposure condition without restriction.

### **IC warning**

This device contains licence-exempt transmitter(s)/ receiver(s) that comply with Innovation, Science and Economic Development Canada's licence-exempt RSS(s). Operation is subject to the following two conditions: (1) this device may not cause interference, and (2) this device must accept any interference, including interference that may cause undesired operation of the device.

Le présent appareil est conforme aux CNR d'Innovation, Sciences et Développement économique Canada applicables aux appareils radio exempts de licence. L'exploitation est autorisée aux deux conditions suivantes: (1) l'appareil ne doit pas produire de brouillage, et (2) l'utilisateur de l'appareil doit accepter tout brouillage radioélectrique subi, même si le brouillage est susceptible d'en compromettre le fonctionnement.

The device has been evaluated to meet general RF exposure requirement. The device can be used in portable exposure condition without restriction.

L'appareil a été évalué pour répondre aux exigences générales d'exposition aux RF. Le dispositif peut être utilisé dans des conditions d'exposition portatives sans restriction.

# 3 Getting Started

## A. Parts and Hardware

Parts and Hardware List				
Part	Quantity			
	SF-ALLE50	SF-ALLE60	SF-ALLE78	SF-ALLE100
Appliance	1	1	1	1
Remote Control	1	1	1	1
AAA Battery	2	2	2	2
Black Glass Embers	4 bags	5 bags	6 bags	8 bags
Black Crystals	1 bag	1 bag	1 bag	1 bag
Small Clear Crystals	2 bags	2 bags	2 bags	3 bags
Medium Clear Crystals	1 bag	1 bag	1 bag	1 bag
Large Clear Crystals	1 bag	1 bag	2 bags	2 bags
Timber Log Set	9 pieces	11 pieces	14 pieces	20 pieces
ST4X40 Screw (appliance to framing)	4	4	4	4
ST4X8 Screw (glass to appliance)	2	2	3	3
Glass Screw Vanity Cover	2	2	3	3
Power Cord	1	1	1	1
Suction Cup	1	1	1	1

## B. Tools and Supplies Needed

Before beginning the installation be sure that the following tools and building supplies are available.

- Safety glasses
- Gloves
- Tape measure
- Hammer
- Level
- Square
- Phillips screwdriver (magnetic)
- Drill
- Pliers
- Type NM-B Wire Strain Relief

## C. Optional Accessories

These optional accessories must be ordered separately. Refer to the instructions included with the accessory for their installations.

ACCESSORY	PART NUMBER
Boyd Build-Out Kit (Modern Farmhouse)	BOK-MF-ALLP50
Boyd Build-Out Kit (Ready-to-Finish)	BOK-RTF-ALLP50
Lighted Birch Log Set	SF-ALLE-BIRCH
Decorative Spheres	SF-SPHERES

## D. Appliance Dimensions

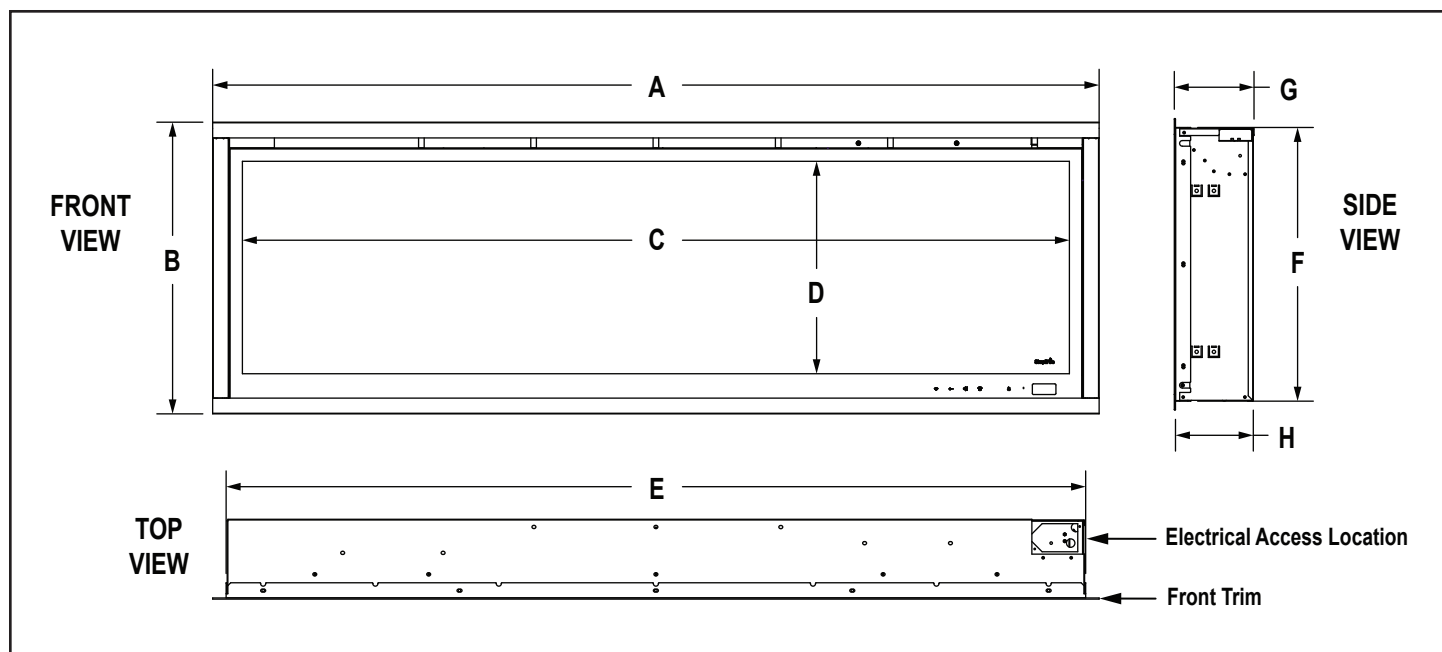

Figure 3.1 Appliance Dimensions

MODEL	UNIT	A	B	C	D	E	F	G*	H
SF-ALLE50	in.	52-5/16	20-3/8	48	15	50-1/2	19-3/8	5-5/8	5-9/16
	mm	1329	518	1219	381	1283	492	143	141
SF-ALLE60	in.	62-5/16	20-3/8	58	15	60-1/2	19-3/8	5-5/8	5-9/16
	mm	1583	518	1474	381	1537	492	143	141
SF-ALLE78	in.	79-5/8	20-3/8	75-1/2	15	77-3/4	19-3/8	5-5/8	5-9/16
	mm	2022	518	1918	381	1975	492	143	141
SF-ALLE100	in.	101-5/8	20-3/8	95-1/2	15	99-7/8	19-3/8	5-5/8	5-9/16
	mm	2582	518	2426	381	2537	492	143	141

\*G depth dimension includes the front trim of the appliance.

## E. Location

When choosing a location for your fireplace ensure that the following general rules are followed:

- For best results, install out of direct sunlight.
- Power supply service must be installed within proximity of electric fireplace prior to finishing to avoid reconstruction.
- Appliance should be installed so the front glass panel is located outside the swing arc of adjacent door.
- See Figure 3.2 and 3.3 to determine location of appliance installation.

**NOTE:** If this unit is installed in a bathroom, it must be protected by a GFCI receptacle or circuit. If receptacle is used, it must be readily accessible. This electrical appliance is not water tight. To prevent electrical shock, it must be installed as to prevent water from entering unit. It must be installed away from showers, tubs, or other water sources. Never locate the appliance where it may fall into a bathtub or other water container.

## F. Clearance to Combustibles

The front of the fireplace requires a 3 ft. (0.9 m) minimum to combustible furniture, curtains and/or decorations, and also for ease of any future service.

See Figure 3.2 for illustrated diagrams of the required clearance minimums.

### Construction Minimums

Front.....36 in.  
Floor.....0 in.  
Ceiling.....4 in.  
Wall.....0 in.  
Mantel.....0 in.

### Framing Minimums

Sides.....0 in.  
Top.....0 in.  
Bottom.....0 in.  
Back.....0 in.

## G. Electrical Supply Circuit Requirements

Plan the location of the appliance so that it will have adequate electric power. A minimum 15 AMP, 120V/60Hz circuit is required. Appliances have been tested to be compatible with AFCI / GFCI breakers.

Additional appliances on the same circuit as this appliance may exceed the current rating of that circuit. A dedicated circuit is not required, but is recommended to prevent circuit breaker trips or fuse failure.

The product is designed to operate safely under the minimum installation conditions when installed and operated properly.

**NOTE:** If using the supplied power cord, choose a location near an outlet. Never use an extension cord or relocatable power strip to power the appliance

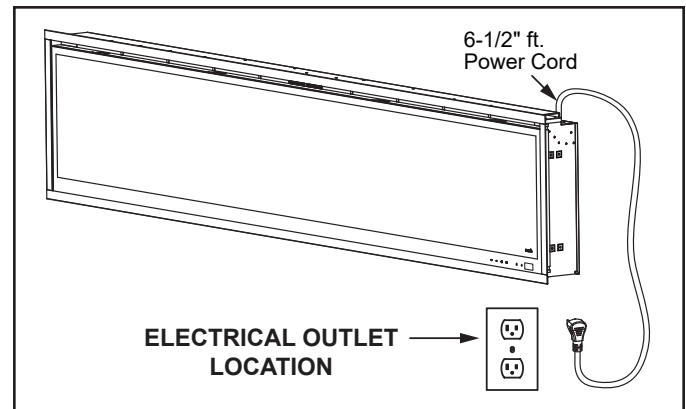

Figure 3.3 Electrical Outlet Location

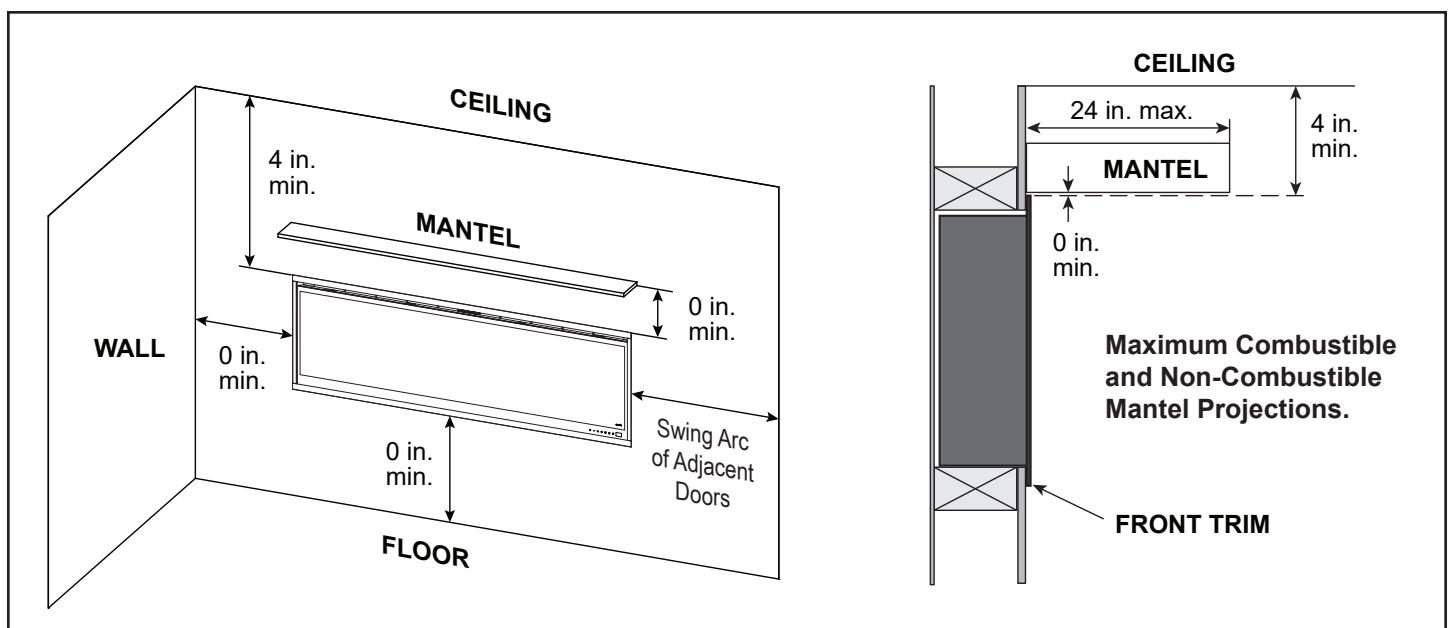

Figure 3.2 Location and Clearances Requirements

# 4 Installation

**WARNING! Risk of Personal Injury or Property Damage!** Failure to install the appliance as instructed below may result in damage to the equipment and or may expose the user to the risk of fire, serious injury, illness or death.

**NOTICE:** These instructions are not substitutes for the requirements of local building and electrical codes.

There are two options for the appliance installation:

- Installed into a framed and finished wall (Section 4.F).
- Installed with an optional Boyd Build-Out Kit onto an existing wall (50" appliance only).

**NOTE:** The optional Boyd Build-Out Kit must be ordered separately (BOK-MF-ALLP50, BOK-RTF-ALLP50). Refer to the instructions included with the accessory kit for these installations.

A chase may be required by local building codes to accommodate insulation when the appliance is installed in a recessed opening on an exterior wall. The chase should be constructed in a manner of all outside walls of the home to prevent cold air drafting problems. The chase should not break the outside building envelope in any manner. Walls, ceiling, baseplate, and cantilever floor of the chase should be insulated. Vapor and air infiltration barriers should be installed in the chase as per local building codes for the rest of the home. Additionally, in regions where cold air infiltration may be an issue, the inside surfaces may be drywalled and taped (or equivalent method may be used) to achieve maximum air tightness.

**NOTICE:** Insulation and other loose materials must be secured to maintain the air clearance between the appliance and interior envelope of the wall opening. This will ensure that the appliance can circulate air to its room temperature sensor for maximum performance of the thermostat function.

## A. Framing

The appliance requires a minimum framing depth of 5-1/2 inches, such as a 2x6 framed wall.

### Framing Dimensions

MODEL		HEIGHT	WIDTH	DEPTH
SF-ALLE50	in.	19-5/8	51	5-1/2
	mm	499	1295	140
SF-ALLE60	in.	19-5/8	61	5-1/2
	mm	499	1549	140
SF-ALLE78	in.	19-5/8	78-1/4	5-1/2
	mm	499	1988	140
SF-ALLE100	in.	19-5/8	100-3/8	5-1/2
	mm	499	2550	140

**NOTE:** See the Finishing section (4.D) for finishing material guidance.

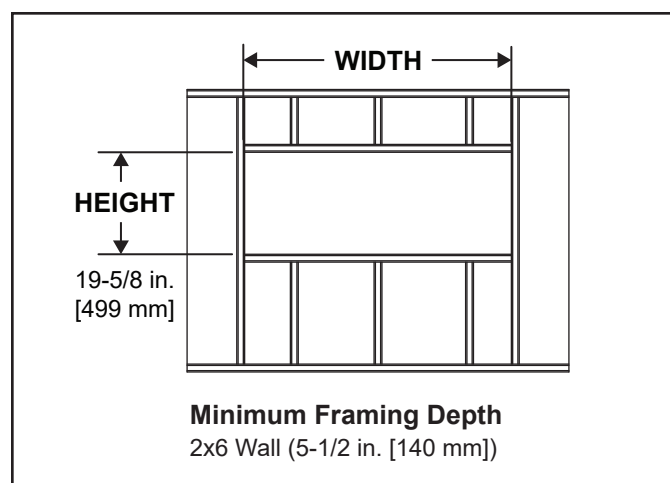

Figure 4.1 Framing Dimensions

## B. Electrical Connection

All electrical connections shall be performed by a qualified electrician.

**WARNING! Risk of Fire, Electrical Shock and Injury!**

Electrical wiring must comply with local building and electrical codes, the latest edition of the NFPA 70 National Electric Code (NEC), and all other applicable regulations.

**NOTE:** All wiring must be completed prior to appliance installation into the prepared wall.

**WARNING! Risk of Shock! Label all wires prior to disconnection when servicing the appliance. Wiring errors can cause improper and dangerous operation. Verify proper operation after servicing.**

This appliance has been designed to be hard-wired for 120VAC. A supplied plug-in kit is also available for use with a properly grounded electrical outlet.

A minimum 15 AMP, 120V/60Hz circuit is required for hard-wired and power cord installations. A dedicated circuit is recommended to prevent circuit breaker trips or fuse failure.

**NOTE:** Appliances have been tested to be compatible with AFCI/GFCI breakers. If the connected breaker trips, consult a qualified electrician, reference the breaker manufacturer's instruction for guidance, reference National Electric Code (NEC).

### Hard-Wired Installation:

Appliance comes hard-wire ready. An electrical service loop is recommended for hard-wired installations to allow easy removal from the wall for service.

**NOTE:** The appliance must be connected and grounded in accordance with local building and electrical codes and / or the current ANSI/ NFPA 70 National Electric Code or CSA C22.1 Canadian Electrical Code.

1. Remove terminal block cover plate located on the right end of the appliance. Keep screws for cover plate reassembly.
2. Install a wire strain relief bushing into the cover plate.
3. Terminate type NM-B wire to the terminal block, ensure connections are secure, and tighten the strain relief. To load wire conductors into the junction block, depress the spring-loaded terminals on the junction block by hand or use a screwdriver. See Figure 4.2.
4. Replace terminal block cover plate and retaining screws.

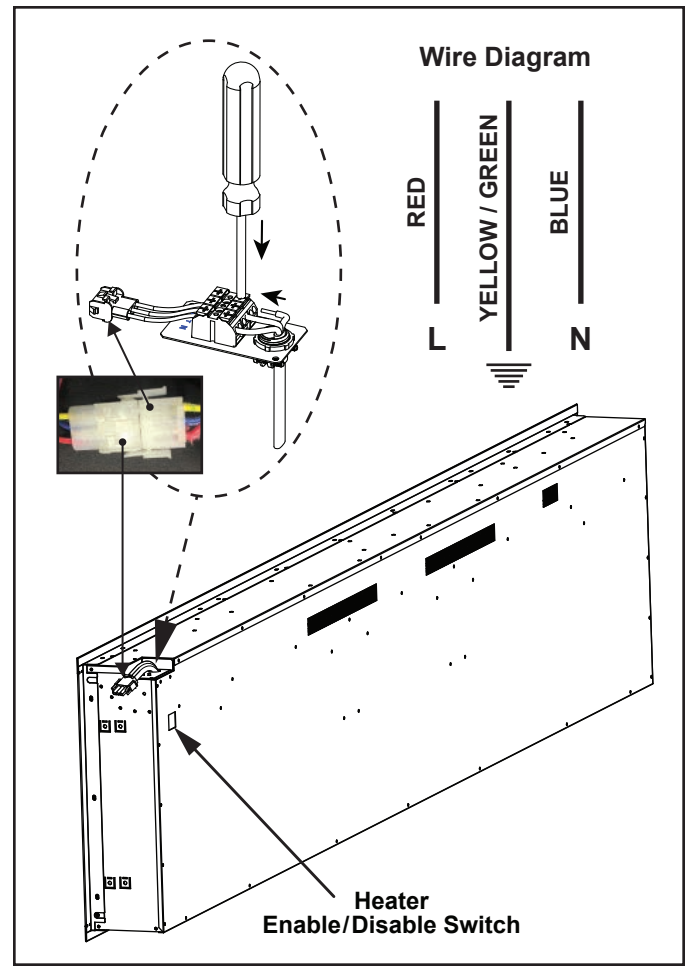

Figure 4.2 Hard-Wired Installation

## Power Cord Installation

The optional appliance power cord is included in the accessory box and has a three pin NEMA-5-15P plug. The power cord should not be used unless a properly grounded electrical outlet is available.

1. Remove the terminal block cover plate located on the right end of the appliance. Keep screws for cover plate reassembly.
2. Disconnect the terminal block from the three wires inside the appliance. Wires are released by disconnecting the three conductor wire connector. Discard the terminal block cover plate.
3. Connect the three conductor wire connector to the connector on the block supplied with the power cord kit. See Figure 4.3.
4. Replace cord kit terminal block cover plate and retaining screws.

**WARNING! Risk of Fire, Electrical Shock and Injury!**  
Ensure the power cord is not installed so that it is pinched or against a sharp edge and ensure that the power cord is stored or secure to avoid tripping and snagging.

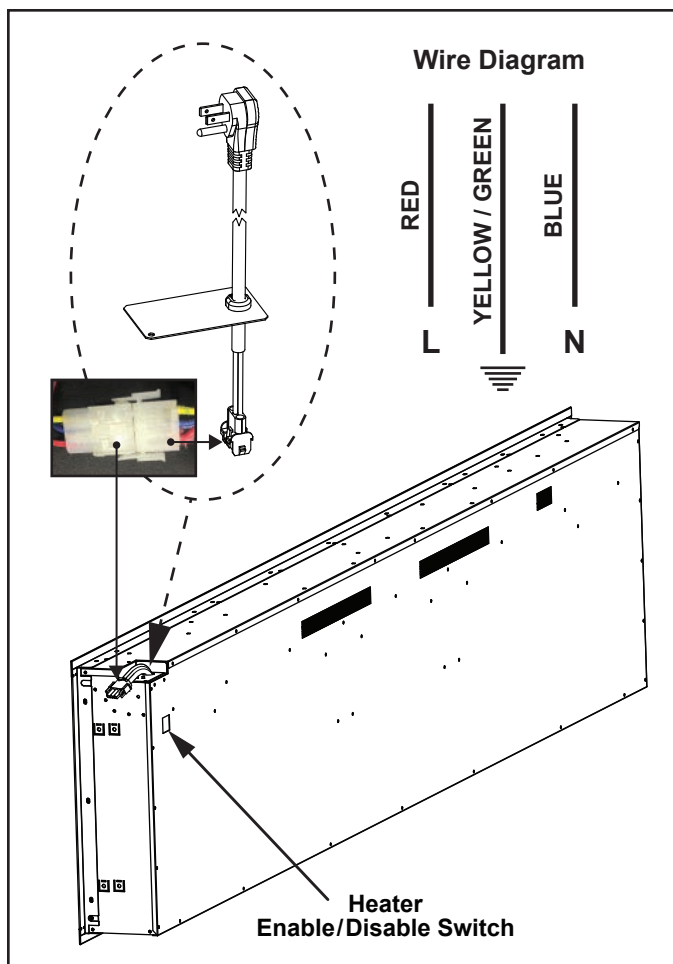

Figure 4.3 Optional Power Cord Assembly

## C. Heater Enable/Disable Switch

The heater enable/disable switch is located on the back of the appliance. When the switch is toggled to the heater enabled position, the appliance's heater and thermostat will operate as outlined in this manual.

When the switch is toggled to the heater disabled position, the appliance's heater and thermostat will not function.

The appliance ships with the heater enabled, before installing the appliance ensure that the heater enable/disable switch is toggled to the desired position.

## D. Finishing

The Allusion Edge slides into a framed and finished wall and is compatible with finishing materials such as painted drywall, tile, and other smooth finishes such as porcelain and granite.

The drywall/finishing material must be installed before installation of the appliance into the wall. Drywall/finishing material must be brought to the edge of the framing opening to ensure that the front trim of the appliance overlaps the finishing material on all sides.

The appliance requires a minimum combined wall framing and drywall/finishing material thickness of 5-3/4 inches, such as a 2x6 framed wall with a minimum of a 1/4 inch of drywall/finishing material. See Figure 4.4.

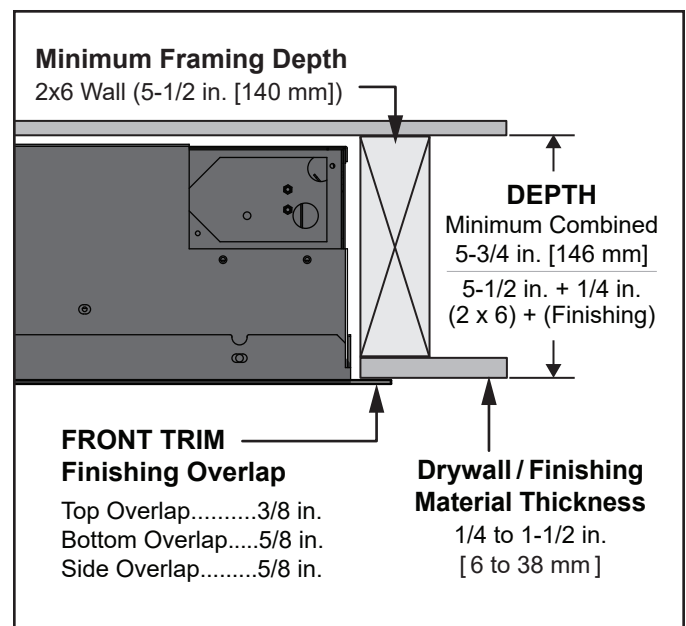

Figure 4.4 Finishing Requirements

The maximum thickness of drywall/finishing material is 1-1/2 inches, making the accepted range 1/4 to 1-1/2.

## E. Appliance Preparation

After completing the wall framing, electrical connection wiring, and finishing of the wall, the appliance must be prepared for installation.

1. Move the appliance into position near the prepared wall opening.
2. Confirm the electrical connection of the appliance (Section 4.B).
3. Confirm the heater enable/disable switch is positioned as desired (Section 4.C).
4. Remove the front glass, if attached (Section 4.H).
5. Continue with Section 4.F to install the appliance into the prepared wall.

## F. Wall Installation

1. Confirm the prepared wall is properly framed (Section 4.A) and that it has the intended finishing material (Section 4.D) up to the edge of the framing.

**NOTE:** Refer to the *Finishing* section (4.D) for finishing material guidance before installation.

2. Level and plum the framing if necessary. This must be done before the appliance is installed.
3. Remove interior side panels on left and right of the appliance by removing two (2) screws. See Figure 4.5.
4. Slide the appliance into the opening so the weight of the appliance is supported by the bottom framing.

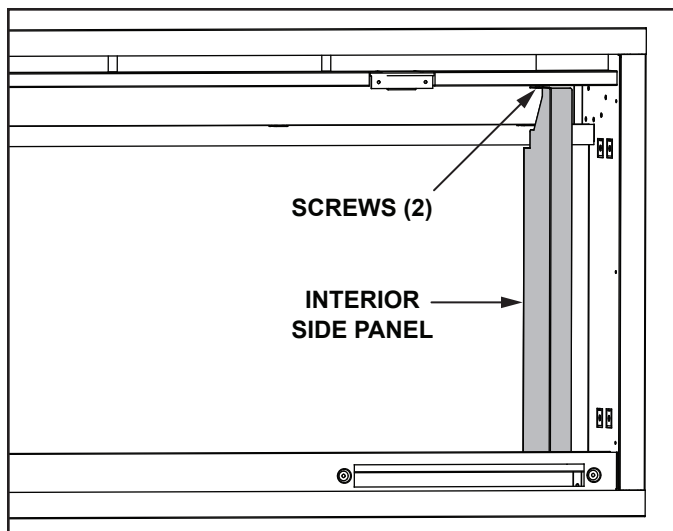

Figure 4.5 Interior Side Panel Removal

5. Ensure front trim is flush with the finishing material.
6. Attach the appliance to the framing with four (4) ST4X40 wood screws at the tabbed, framing attachment hole locations. See Figure 4.6.

**NOTE:** Two sets of framing attachment holes are provided. Use the holes closer to the front of the appliance for applications with less than 1 inch of combined drywall/finishing material, and use the holes closer to the back for 1 to 1-1/2 inches of combined drywall/finishing material.

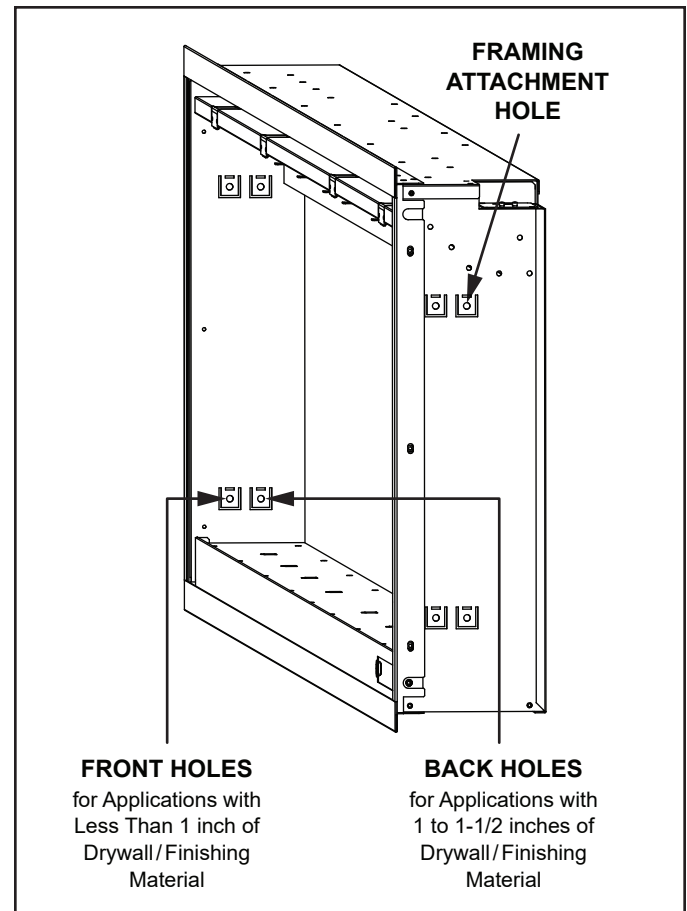

Figure 4.6 Framing Attachment Hole Locations

7. Reattach side panel covers.
8. See Section 4.G for Appliance Final Setup.

G. Appliance Final Setup

The following placement instructions provide guidance for recommended log and media setups. These items may be installed to the owner’s preference.

See Section 3.A for a list of the lighted timber logs and media included with the appliance.

Clear Crystal Media Placement

The small, medium, and large clear crystals are one of several options when deciding on the look of the appliance. The following instructions are provided as a recommended setup method, but media can be setup as desired, or mixed with the black embers, black crystals, and lighted timber logs if desired.

- 1. Carefully spread the small clear crystals across the ember bed.
- 2. Then evenly arrange the large clear crystals on top of or within the small crystal media.
- 3. Distribute the medium clear crystals evenly across the ember bed. See Figure 4.7.



Figure 4.7 Clear Crystal Media Placement

Lighted Log and Black Media Placement

The lighted timber logs, black glass embers, and black crystals can be set up to the owner’s preference, but always consider the following:

- Lighted logs were designed to be used with companion pieces that help conceal the wiring.  
**NOTE:** Reference Figures 4.9 - 4.12 for lighted log and companion piece recommendations.
- The charred portion of the logs should be facing out of the appliance so that the glowing feature is visible when turned on.
- Black glass embers are the primary coverage media, with black crystals filling in gaps in the ember bed.

**NOTE:** The optional Lighted Birch Log Set (SF-ALLE-BIRCH) and optional Decorative Spheres (SF-SPHERES) must be ordered separately. Refer to the instructions included with the accessories for these installations.

Lighted Logs and Companion Pieces

Before beginning installation, confirm that all log pieces are included. See Figure 4.8 and the below table.

Piece	50"	60"	78"	100"
A	1	2	1	2
B	1	1	1	2
C	1	1	2	2
D	1	1	2	2
E	1	1	2	2
F	2	2	2	4
G	1	1	1	2
H	1	2	3	4

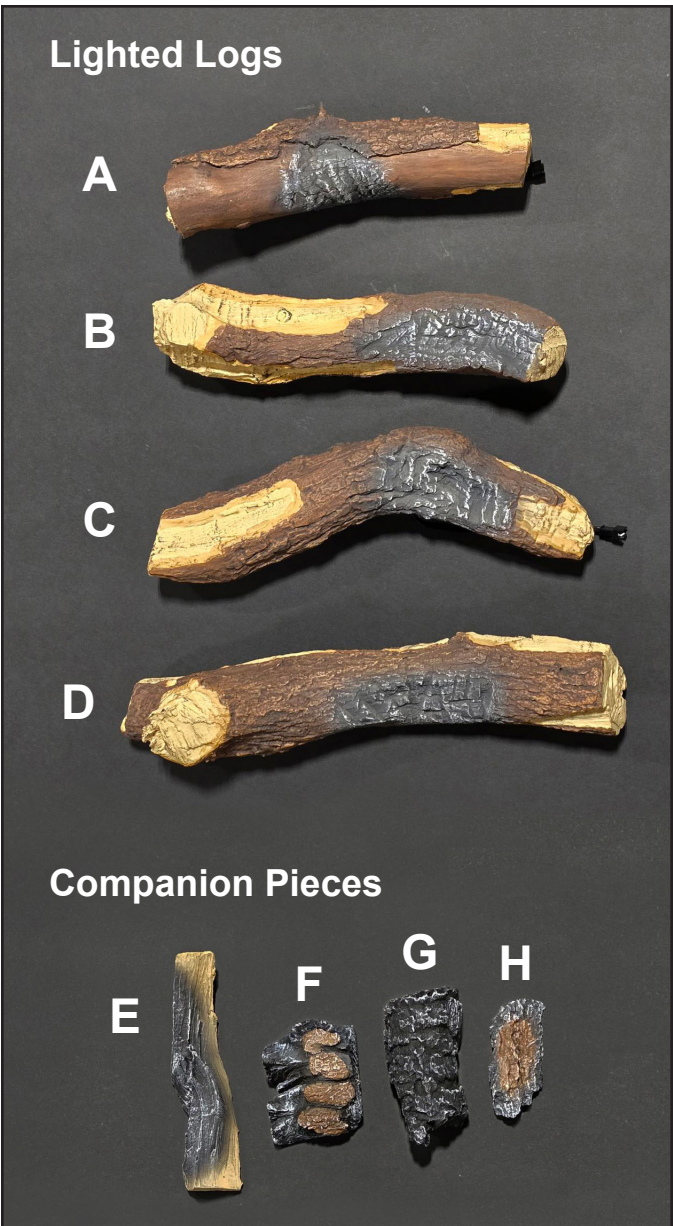

Figure 4.8 Lighted Timber Logs and Companion Pieces

(Continued)

## Lighted Log and Glass Media Placement

Follow the instructions below as the recommended setup for the lighted timber logs, companion pieces, black glass embers, and black crystals. Figures 4.9 - 4.12 show recommended log positioning for each appliance length.

**NOTE:** The recommended log placement is slightly different for each of the appliance sizes. Make sure to reference the correct figures based on your appliance.

1. Cover the ember bed with a thin layer of black glass embers, making sure not to cover the plug locations for the lighted timber logs.
2. Plug in and place each lighted timber log across the ember bed as shown in Figures 4.9 - 4.12. Position the logs with the charred portion facing outward, so the glowing feature is visible when turned on.
3. Place companion pieces E, F, and G as shown in Figures 4.9 - 4.12.
  - a. Move black glass embers as needed to allow the companion pieces to sit directly on the ember bed, so the ember bed lighting can glow through them.
  - b. Companion pieces are designed to conceal the wires and plugs, while also changing the elevation of the lighted timber logs.
  - c. Companion piece E is designed to go specifically with lighted log C. Companion pieces F and G are more interchangeable and are used with lighted logs A, B, and D. See Figures 4.9 - 4.12.
4. After all logs and companion pieces are in place, use the remaining black glass embers and black crystal media to fill in any gaps.
5. Place bark pieces H to conceal any remaining exposed wire.



Figure 4.9 Allusion Edge 50" Log Positioning



Figure 4.10 Allusion Edge 60" Log Positioning



Figure 4.11 Allusion Edge 78" Log Positioning



Figure 4.12 Allusion Edge 100" Log Positioning

## H. Front Glass

**CAUTION!** *Two adults are recommended for the installation and removal of the glass front. Use caution when handling glass. Failure to do so could result in personal injury or property damage.*

Follow the instructions below to install the front glass of the appliance. Reverse the steps for glass removal.

1. Angle the glass to place the bottom edge into the channel behind the outer trim. See Figure 4.13.

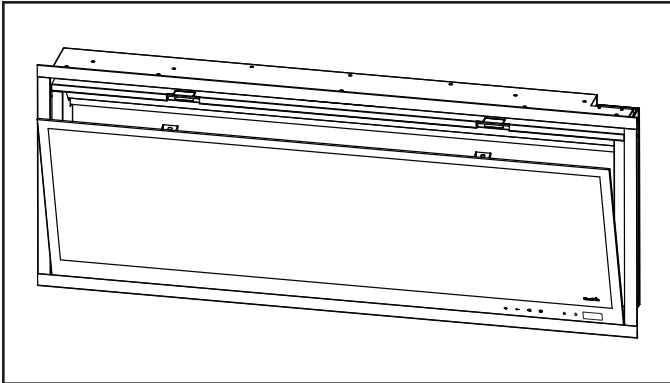

Figure 4.13 Glass Front Installation

2. Place the top edge of the glass against the appliance and secure with two (2) ST4X8 screws on a 50" and 60", or three (3) ST4x8 screws on a 78" and 100".
3. Place glass bracket covers into place over the screws. See Figure 4.14.

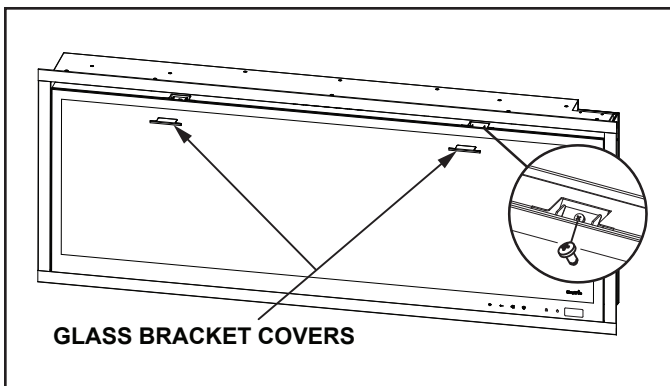

Figure 4.14 Glass Front Attachment

# 5 Operating Instructions

**WARNING! Risk of Fire, Electrical Shock, and Injury!** Do not operate the appliance if it is damaged or has malfunctioned. If damage is suspected, call your SimpliFire dealer to schedule a qualified service technician to inspect and replace any part of the electrical system, as needed.

**CAUTION!** The unit's power cord must be connected to a properly grounded and protected 120VAC outlet. Always use ground fault protection where required by the electrical code.

The appliance can be operated with the buttons on the appliance (Section 5.A), remote control (Section 5.B), or with Wi-Fi (Section 6).

## A. Operation Using Appliance Buttons

Once the circuit breaker is switched ON, the power button can be pressed to turn ON the appliance. See Figure 5.1. The appliance should beep when powered ON.

**NOTE:** The appliance can take up to 30-60 seconds to be ready to operate after an AC power cycle. During this time the SimpliFire logo may turn on and off a few times, while the ember bed blinks green.

**NOTICE:** The heater function is determined by the heater enable/disable switch being in the desired position. Refer to Section 4.C for additional details.

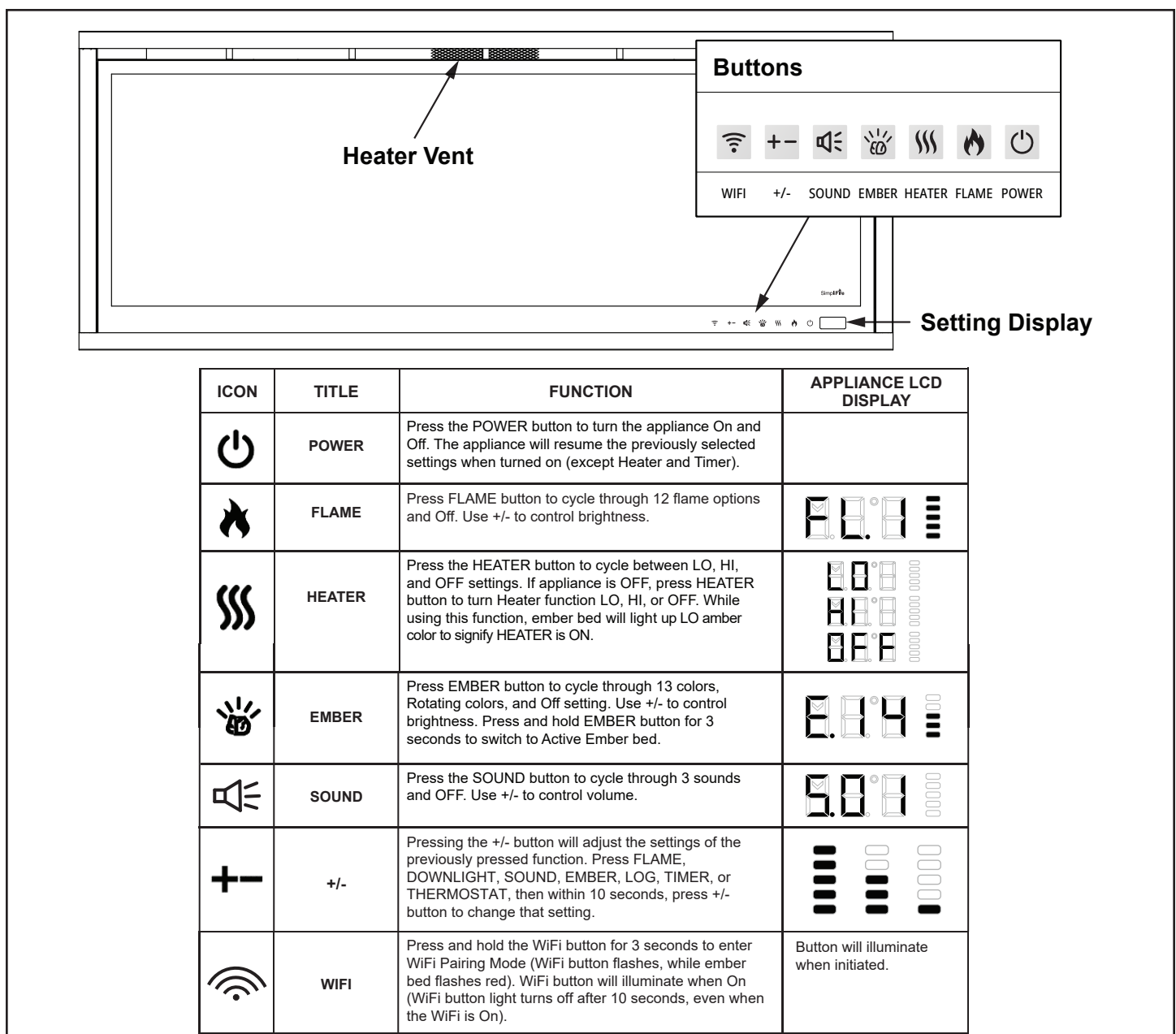

Figure 5.1 Appliance Button Operation

## B. Operating by Remote Control

- Make sure batteries are properly installed in the remote control. 2x AAA batteries (included).
- The remote control has an effective range of 16 ft.
- The remote control uses radio frequency, and does not have a specific field-of-view requirement.
- See Figure 5.2 for remote control operation.



ICON	TITLE	FUNCTION	Appliance LCD Display
	POWER	Press the POWER button to turn the appliance On and Off. The appliance will resume the previously selected settings when turned on (except Thermostat and Timer).	
	PRESET	Press the PRESET button to turn On/Off the preset function. To save your favorite lighting effect as the present, press and hold the PRESET button for 3 seconds.	
	+/-	Press + or - to adjust the settings for each of the separate functions. After pressing FLAME, DOWNLIGHT, SOUND, EMBER, LOG, TIMER, or THERMOSTAT buttons (within 10 seconds) use +/- to change the settings to your personal preference.	
	HEATER	Press the HEATER button to cycle between Low, Hi, and Off settings. If appliance is Off, press HEATER button to turn Heater function Lo, Hi, or Off. While using this function, ember bed will light up LO amber color to signify HEATER is ON.	
	FLAME	Press the FLAME button to cycle through 12 flame options and Off. Use +/- to control brightness.	
	EMBER	Press EMBER button to cycle through 13 colors, plus Rotating colors, and Off setting. Use +/- to control brightness.	
	ACTIVE EMBER BED	Press EMBER button to cycle through 13 colors, plus Rotating colors, and Off setting. Use +/- to control brightness.	
	LOG	Press the LOG button to cycle through 4 colors, and Off setting. Use +/- to control brightness.	
	DOWNLIGHT	Press the DOWNLIGHT button to cycle through Warm, Cool, and Off setting. Use +/- to control brightness.	
	SOUND	Press the SOUND button to cycle through 3 sounds and Off. Use +/- to control volume.	
	TIMER	Press the TIMER button to turn timer On and Off. Initial setting when turned on is 0.5H. Use +/- to control timer settings up and down.	
	THERMOSTAT	Press the THERMOSTAT button to toggle between On and Off options. Use +/- to increase or decrease the temperature set point. Press and hold the THERMOSTAT button for 3 seconds to switch between Celsius and Fahrenheit.	

Figure 5.2 Remote Control Operation

## C. Room Temperature and Thermostat Function

The temperature display on the remote control is a set point for the desired temperature of the room in which the appliance is installed. The Thermostat button on the remote can be used to set the desired room temperature. The heater will only operate if the remote control temperature set point is higher than the actual room temperature. The heater will not operate if the actual temperature is greater than the remote control temperature set point. To exit Thermostat mode, toggle Temperature button until no temperature is displayed.

This function can also be used as a thermostat, under the following conditions:

- When the remote control display is set to a desired room temperature using the thermostat button, the appliance heater will turn OFF automatically when the room temperature reaches the set point.
- The heater will turn ON automatically if the room temperature falls below the set point.

**Note:** *The actual room temperature is measured by a hidden sensor in the remote control. The temperature reading could vary slightly depending on the location of the remote.*

## D. Resetting Temperature Cutoff Switch

The heater is protected with a safety device to prevent overheating. Should the heater overheat, an automatic cutoff will turn the heater OFF. It will not turn ON automatically without being reset. If it overheats for any reason, it can be reset by:

1. Turn appliance OFF.
2. Turn off power at the circuit breaker.
3. Let appliance cool for 30 minutes.
4. Turn on power at the circuit breaker.
5. Turn on appliance with touch power button or remote control.

**CAUTION:** *If you need to continuously reset the heater, or if appliance overheats repeatedly, contact your SimpliFire dealer for service.*

## E. Operation with Wall Switch

This appliance is designed to retain settings when the power is disconnected or disrupted. This means the appliance can be operated using a wall switch if desired. If the power is removed while the appliance is operating, the appliance will return to the same settings and operating modes once the power is restored.

# 6 Wi-Fi Setup and Use

## A. Add Device - Primary Method

**NOTE:** Make sure to select a 2.4 GHz Wi-Fi network. The Wi-Fi router should not be too close to the appliance. If the router is less than 2 inches (50 cm), it may cause issues with pairing.

**NOTE:** Visuals in the Smart Life app may periodically change due to application updates. General process will remain the same.

Scan QR code to download the Smart Life app.



1. Download the **Smart Life - Smart Living** app .
2. Navigate to the Smart Life app and Log In. The Smart Life app is available from the Apple App Store or the Google Play Store. Use the QR code for a link to download the app.
3. Press the **+** icon and select **Add Device** from the Smart Life app Home screen.
4. Turn ON the appliance (1), and then press and hold the **WIFI** button (2) until **3 beeps** are heard. The ember bed (3) turns red and starts blinking quickly.

**NOTE:** Ember bed will turn blue if Wi-Fi pairing mode times out. Repeat step 4 to restart the pairing process.

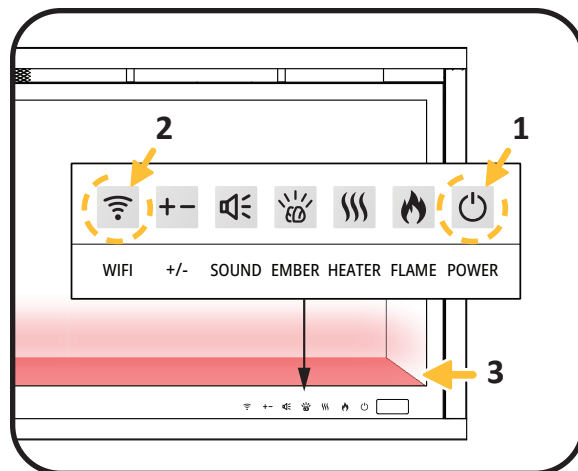
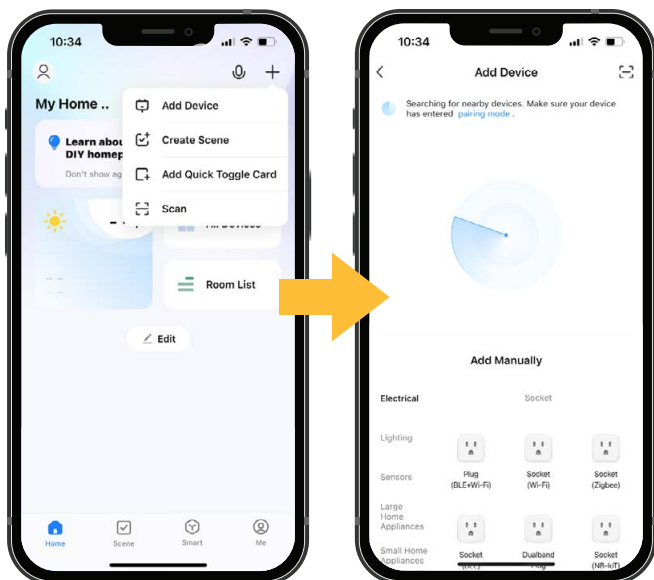

5. Press the **Appliance** icon (1), once it appears on the screen.
6. Confirm the selected Wi-Fi network (1), enter the password (2), and then press **Next** (3). Application begins connecting to the appliance.

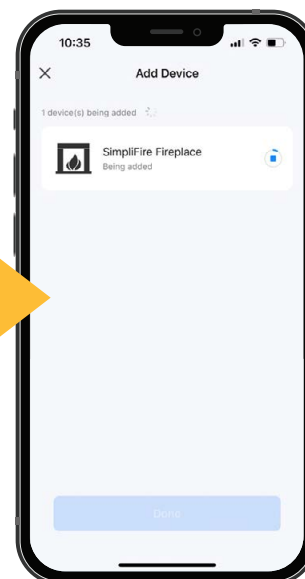
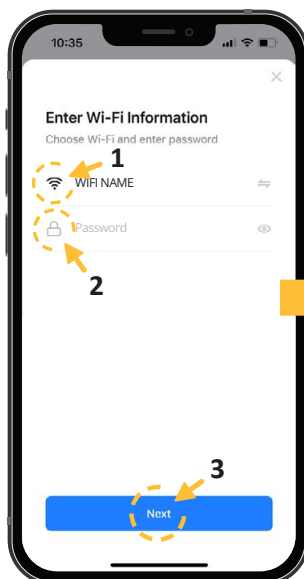
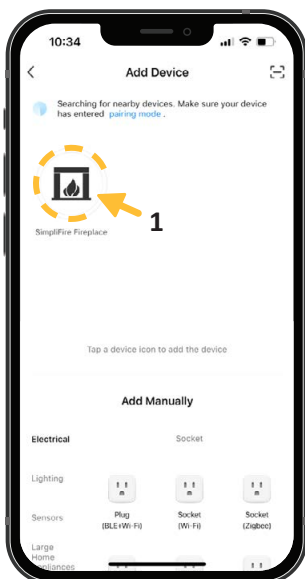

7. Confirm a green check mark (1) appears, and press **Done** (2). The ember bed also turns a solid green.

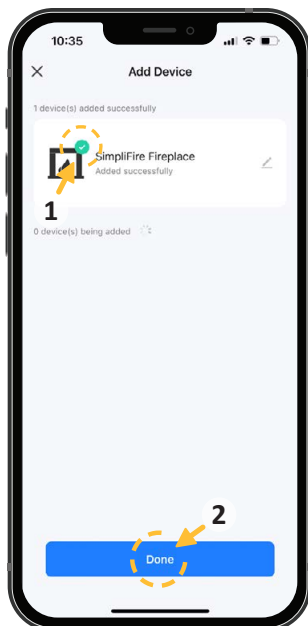

8. See the *Wi-Fi Operation* section for details on using the SimpliFire screen for wireless and remote control of the appliance.

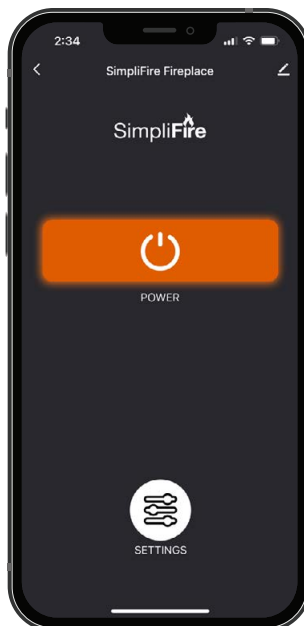

**NOTE:** If the application is unable to connect to the appliance, see the *Add Device - Bluetooth Mode* and *Add Device - Wi-Fi Mode* sections for alternative methods to pair the appliance.

## B. Wi-Fi Operation

1. Navigate to the **Smart Life** app .
2. Select a paired appliance from the Home screen or the All Devices menu.

*NOTE: See the Add Device section to pair appliances with the Smart Life app.*

3. Operate the selected appliance using the app.

- Press the **Power** button (1) to turn the appliance On/Off.
- Press the **Back** icon (2) to go back to the Smart Life app Home screen.
- Press the **Pencil** icon (3) to view and edit the appliance details.
- Press the **Settings** button (4) to view and edit the appliance's settings.

*NOTE: See the Wi-Fi Settings section for a complete list of the available options and the associated voice commands.*



## C. Wi-Fi Settings

All of the appliance settings are adjustable for paired appliances on the Settings screen of the app. A Wi-Fi connection allows for wireless and remote control of the appliance settings using the app.

## Voice Commands

Voice commands are available for paired appliances by connecting the Smart Life app to Alexa or Google Home. Navigate to **Third-Party Services** in the **Me** menu to operate a paired appliance with voice commands.

Use commands like “Alexa /OK Google: Turn on/off <SimpliFire Fireplace>”.

**NOTE:** <SimpliFire Fireplace> is the default name assigned to added devices. Press the Pencil icon in the upper right to edit the name, as desired. Use the name of the appliance when using the voice commands.

[Square Brackets] are used in the table below to indicate the desired option and can be any of the options listed for that setting when using the corresponding voice command.

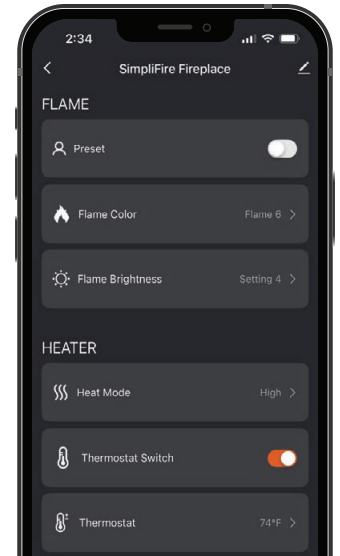

Icon	Name	Options	Voice Command
	Preset	Toggle On/Off	N/A, mirrors the Preset button on the remote control
	Flame Color	Off, Flame 1 – 12	“Alexa /OK Google: Set flame color on <SimpliFire Fireplace> to [Flame 1]”
	Flame Brightness	Setting 1 – 5	“Alexa /OK Google: Set flame brightness on <SimpliFire Fireplace> to [1]”
	Heat Mode	Off, Low, High	“Alexa /OK Google: Set heat mode on <SimpliFire Fireplace> to [High]”
	Thermostat Switch	Toggle On/Off	“Alexa: Turn [On/Off] thermostat on <SimpliFire Fireplace>” “OK Google: [Activate /Cancel] thermostat for the <SimpliFire Fireplace>”
	Thermostat	16–28°C or 60–84°F	N/A, use app to control this setting
	Temperature Unit	°C, °F	N/A, use app to control this setting
	Ember Bed Color	Off, White, Red, Orange, Gold, Green, Emerald, Aqua, Light Blue, Ice Blue, Royal Blue, Purple, Pink, Flamingo, Rotating	“Alexa: Set ember bed color on <SimpliFire Fireplace> to [Off/White]” N/A for Google, use app to control this setting
	Ember Bed Brightness	Setting 1 – 5	“Alexa: Set ember bed brightness on <SimpliFire Fireplace> to [1]” N/A for Google, use app to control this setting
	Active Ember Bed	Toggle On/Off	“Alexa: Turn [On/Off] active ember bed on <SimpliFire Fireplace>” N/A for Google, use app to control this setting
	Down Light Color	Off, Warm, Cool	“Alexa: Turn [On/Off] down light on <SimpliFire Fireplace>” “OK Google: [Activate /Cancel] down light for the <SimpliFire Fireplace>” “Alexa /OK Google: Set down light color on <SimpliFire Fireplace> to [Warm/Cool]”
	Down Light Brightness	Setting 1 – 5	“Alexa: Set down light brightness on <SimpliFire Fireplace> to [1]” N/A for Google, use app to control this setting
	Log Color	Off, Red, Orange, Yellow, White	“Alexa /OK Google: Set log color on <SimpliFire Fireplace> to [Red]” “OK Google: [Activate /Cancel] log for the <SimpliFire Fireplace>”
	Log Brightness	Setting 1 – 5	“Alexa: Set log brightness on <SimpliFire Fireplace> to [1]” N/A for Google, use app to control this setting
	Sound Effect	Off, Mature Fire, Rain, Summer Night	“Alexa /OK Google: Set sound effect on <SimpliFire Fireplace> to [Off/Mature Fire]” “OK Google: [Activate /Cancel] sound for the <SimpliFire Fireplace>”
	Sound Level	Setting 1 – 5	“Alexa: Set sound level on <SimpliFire Fireplace> to [1]” N/A for Google, use app to control this setting
	Timer	Off, 30 min, 1–9 Hours	N/A, use app to control this setting

## D. Add Device - Secondary Method

**NOTE:** Use this alternate pairing method if the application is unable to connect to the appliance using the primary method provided in the Add Device section.

**NOTE:** Make sure to select a 2.4 GHz Wi-Fi network. The Wi-Fi router should not be too close to the appliance. If the router is less than 2 inches (50 cm), it may cause issues with pairing.

1. Navigate to the **Smart Life - Smart Living** app .
2. Press the **+** icon (1) and select **Add Device** (2).
3. Scroll down and press **Small Home Appliance** (1), and then select **Electric Fireplace (BLE+Wi-Fi)** (2).

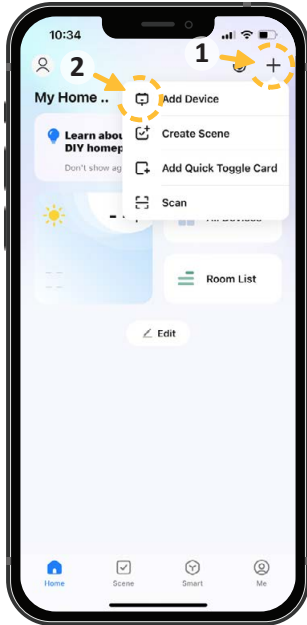

4. Turn ON the appliance (1), and then press and hold the **WIFI** button (2) until **8 beeps** are heard (3 beeps, then 5 beeps). The ember bed (3) turns red and starts blinking slowly.
5. Select **Wi-Fi Mode** from the Mode drop-down menu (1), confirm the ember bed is slowly blinking red (2), and then press **Next** (3).

**NOTE:** Ember bed will turn blue if Wi-Fi pairing mode times out. Repeat step 4 to restart the pairing process.

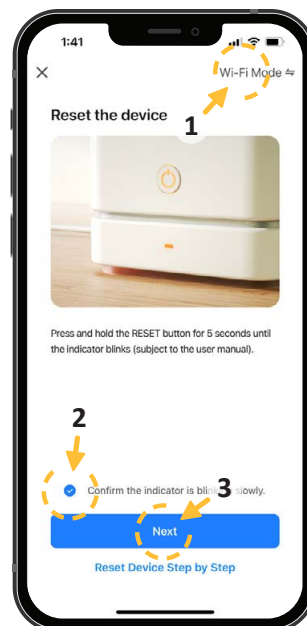
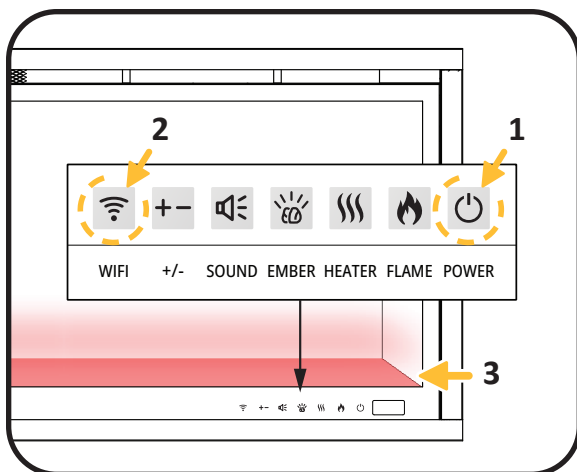

6. Confirm the selected Wi-Fi network (1), enter the password (2), and then press **Next** (3).

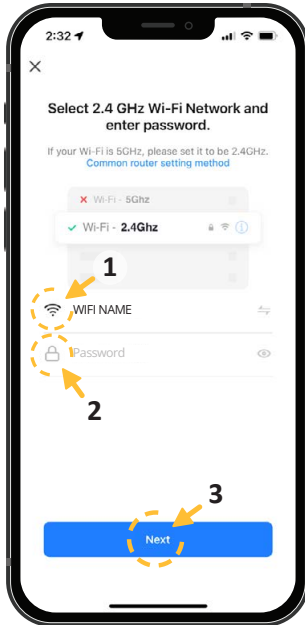

7. Confirm Wi-Fi information (1) and press **Confirm and Proceed** (2).

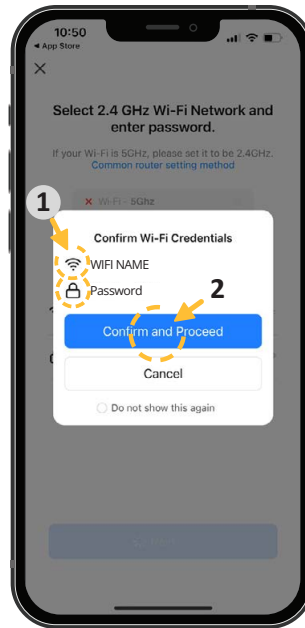

8. Press **Add** (1), once it appears on the screen. Application begins connecting to the appliance.

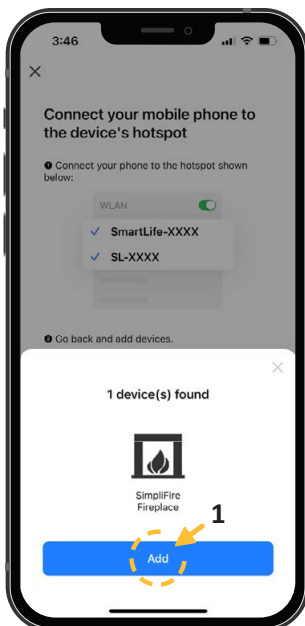

9. Confirm a green check mark (1) appears, and press **Done** (2). The ember bed also turns a solid green.



10. See the *Wi-Fi Operation* section for details on using the SimpliFire screen for wireless and remote control of the appliance.



# 7 Maintenance

---

**WARNING! Risk of Electrical Shock!** Always turn heater off and disconnect power before performing maintenance, service, or removal from the framed wall opening.

**WARNING! Risk of Fire!** To reduce risk of fire, do not store or use gasoline or any other flammable vapors or liquids in the vicinity of the appliance.

## A. Servicing

Except for cleaning, an authorized service technician should perform any and all service.

**DO NOT OPEN!** No user serviceable parts inside. Service must be performed by an authorized service technician. Do not attempt to service the appliance.

Contact your SimpliFire dealer to arrange service.

## B. Cleaning

**WARNING! Risk of Electrical Shock!** Always turn off appliance and disconnect power, by shutting off circuit breaker before cleaning.

- Light accumulated dust may be removed from the appliance exterior with a soft cloth or vacuum cleaner.
- The heater must be inspected regularly, and cleaned at least once per year or more often depending on conditions.
- Wipe the exterior surfaces of the appliance occasionally with a slightly damp micro fiber cloth using a solution of mild detergent and water. Dry thoroughly before operating the appliance.
- The fan motor is factory lubricated for life and will not require further lubrication.
- Store appliance in a clean dry place when not in use.

**CAUTION!** Do not allow water to run into the interior of the appliance as this could create a fire or electric shock. Always remove power before moving or servicing.

**WARNING!** Do not immerse appliance in water.

### Glass Surfaces

Dust particles can be removed by buffing lightly with a clean dry cloth. Fingerprints and other marks can be cleaned with a cloth dampened with a quality household glass cleaner. The glass should be completely dried with a lint free cloth or paper towel. Do not use abrasive cleaners on glass surface. Do not spray liquids directly onto any surface.

### Metal Surfaces

Dust particles can be removed by buffing lightly with a clean dry cloth. A damp cloth can be used to clean painted surfaces. Do not use abrasive cleaners or chemical household cleaners. Do not spray liquids directly on to any surface.

### Vents

Use a vacuum cleaner to remove dirt and dust from heater and vent areas.

## C. Troubleshooting Guide

Symptom	Possible Cause	Corrective Action
Circuit breaker trips or fuse blows when appliance is turned on	Exceeding current rating of the circuit breaker or fuse, perhaps from operating other appliances on the same circuit as the fireplace	Confirm amp draw on circuit is not exceeding electrical code requirements.
Lights in room dim while the appliance is on	Appliance is drawing close to circuit current rating	Confirm amp draw on circuit is not exceeding electrical code requirements.
Fireplace will not come on when using the manual controls on the appliance	Appliance is not plugged into an electrical outlet, if applicable	Ensure plug is connected to a working outlet.
	Hard-wire connections not correct	Review wiring instructions to ensure correct connection.
	No incoming power from the electrical outlet or electrical box	Check fuse/breaker panel.
	Defect in control board (PCB)	Replace the control board (PCB).
Remote control does not work	Low/dead batteries	Replace batteries in the remote.
	Remote receiver is blocked	Ensure receiver is not blocked. Move closer to the appliance.
	Control board (PCB) malfunction	Replace control board (PCB).
Heater will not turn on, but flame is functioning	Remote is in thermostat mode and room temperature (temperature at remote thermistor) is higher than the set point on the remote	Increase thermostat set point on the remote, or exit thermostat mode (press the thermostat button until no temperature set point is displayed on the remote). See "Room Temperature and Thermostat Function" section of the manual.
	Appliance has overheated and safety thermal switch has tripped	Unplug or turn off power at circuit breaker and allow appliance to cool for 30 minutes. Then plug in the appliance or turn power back on at circuit breaker and turn appliance back on.
	Heater enable/disable switch is set to the Off position	If heater functionality is desired, set the heater enable/disable switch to the On position.
	Defective control board (PCB)	Replace control board (PCB).
	Defective heater assembly	Replace heater assembly.
Heater shuts off automatically or won't stay on	Room temperature (temperature at the remote thermistor) is higher than the set point on the remote	Increase thermostat set point on the remote, or exit thermostat mode (toggle the thermostat button until no temperature set point is displayed on the remote). See "Room Temperature and Thermostat Function" section of the manual.
	Appliance has overheated and safety thermal switch has tripped	Unplug or turn off power at circuit breaker and allow appliance to cool for 30 minutes. Then plug in the appliance or turn power back on at circuit breaker and turn appliance back on.
Heater emits an odor	Normal operation	It is normal for the heater to emit an odor for a brief amount of time after turning on. It is burning off dust that has accumulated on the heater.
Ember bed does not light up	Ember bed is turned off	Refer to operation section of the user manual.
	Loose wiring	Check wiring to ember bed LEDs.
	Defective control board (PCB)	Replace control board (PCB).
	Defective LED lights	Replace ember bed LED lights.

## Troubleshooting Guide (continued)

Symptom	Possible Cause	Corrective Action
Fireplace turns on by itself	Defective control board (PCB)	Replace control board (PCB).
Excessive noise with heater on	Interference with fan blade	Inspect heater assembly and fan for obstructions or interference.
	Defective blower motor	Replace heater assembly.
Sound not working	Bad connection to speaker	Replace control board (PCB).
	Defective speaker	Replace speaker.
Speaker buzzing	Control board (PCB) issue	Replace control board (PCB).
AFCI / GFCI breaker trips	AFCI / GFCI breaker wired incorrectly	Verify breaker neutral pigtail is correctly wired per the breaker component manufacturer's installation instructions and National Electric Code (NEC). Verify all wiring is correct, consult a qualified electrician, reference the breaker manufacturer's instruction for guidance, reference NEC.
ER2 Code	Heater enable/disable switch issue	Power cycle appliance and verify heater enable/disable switch is in the correct position. Press heater button when power is returned to clear the ER2 code.

## D. Wiring Schematic

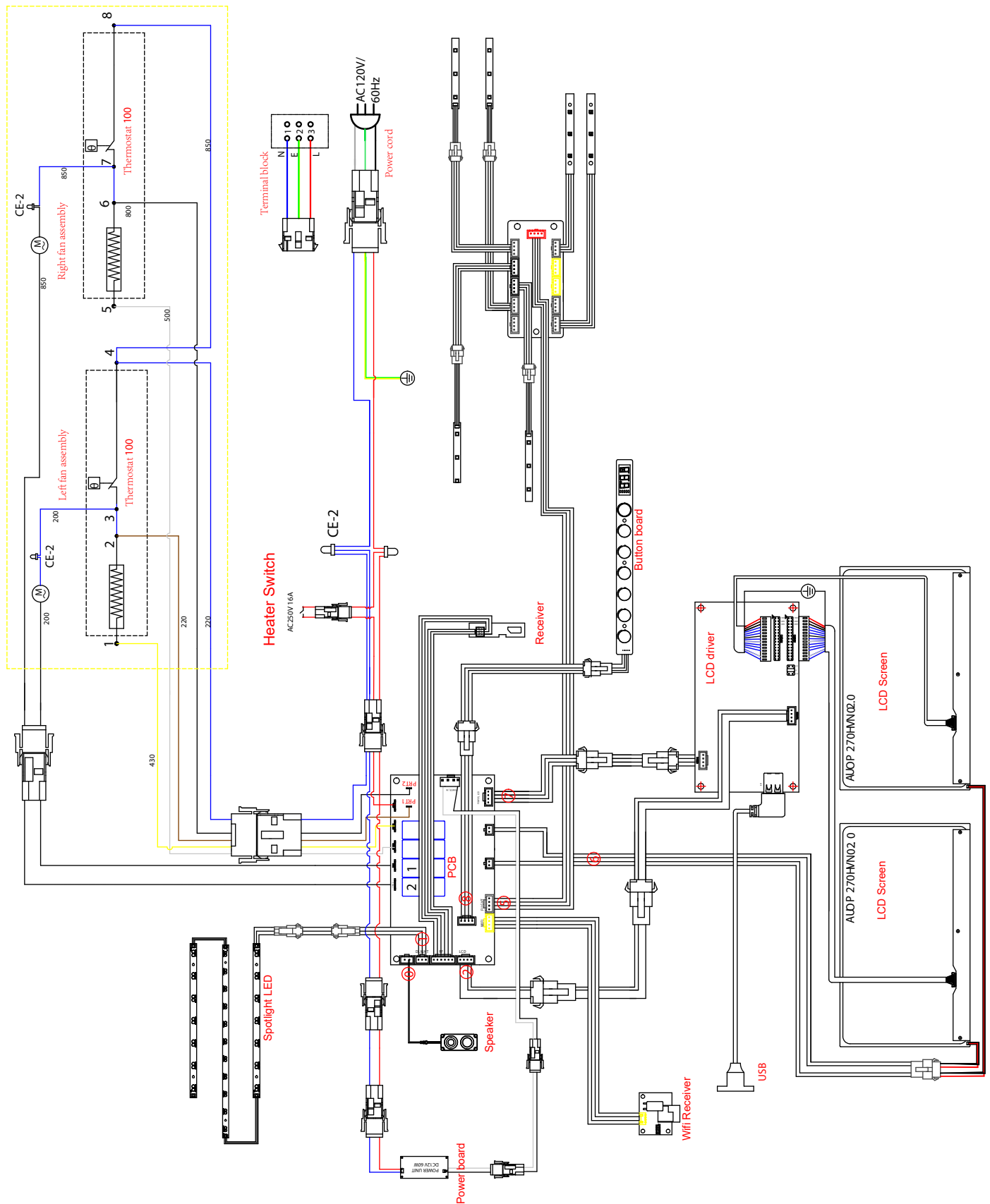

## E. Service Parts Lists



### Service Parts

**SF-ALLE50**

Beginning Manufacturing Date: Oct 2025

Ending Manufacturing Date: Active



IMPORTANT: THIS IS DATED INFORMATION. Parts must be ordered from a dealer or distributor. **Hearth and Home Technologies does not sell directly to consumers.** Provide model number and serial number when requesting service parts from your dealer or distributor.

**Stocked  
at Depot**

ITEM	DESCRIPTION	COMMENTS	PART NUMBER	
1	Crystal Media (Large, Medium and Small)		CRYSTAL-ALLE	Y
2	Black Glass Ember and Crystals		EMBER-ALLE	Y
3	Heater Assembly		HEATER-ALLE50	Y
4	13 Button Radio Frequency Remote Control		RC-SFRF13	Y
5	PCB Board Assembly		PCB-ALLE50	Y
6	Computer/Video Driver PCB Assembly		COMP-ALLE50	Y
7	LCD Display		LCD-ALLE50	Y
8	Glass Assembly		GLASS-ALLE50	Y
9	Ember Bed & Downlight LEDS		LEDS-ALLE50	Y
10	Button Assembly with LCD Readout		BUTTONS-ALLE	Y
11	120V J-block		SF-JBLOCK	Y
12	Side Panels		PANELS-ALLE	Y
13	Front Trim		FRONT-ALLE50	Y
14	Speaker System		SF-SPKR	Y
15	Flame Screen Glass		FLAME-ALLE50	Y
	Hardware Kit (Includes Trinity Glass Brackets, Thumb Screws, Glass Bracket covers, ST4x8, Mounting Brackets)		HDWR-LINEAR	Y
	Log Assembly (Includes 100" quantity of logs)		LOGS-ALLE	Y



IMPORTANT: THIS IS DATED INFORMATION. Parts must be ordered from a dealer or distributor. **Hearth and Home Technologies does not sell directly to consumers.** Provide model number and serial number when requesting service parts from your dealer or distributor.

**Stocked  
at Depot**

ITEM	DESCRIPTION	COMMENTS	PART NUMBER	
1	Crystal Media (Large, Medium and Small)		CRYSTAL-ALLE	Y
2	Black Glass Ember and Crystals		EMBER-ALLE	Y
3	Heater Assembly		HEATER-ALLE50	Y
4	13 Button Radio Frequency Remote Control		RC-SFRF13	Y
5	PCB Board Assembly		PCB-ALLE50	Y
6	Computer/Video Driver PCB Assembly		COMP-ALLE50	Y
7	LCD Display		LCD-ALLE50	Y
8	Glass Assembly		GLASS-ALLE60	Y
9	Ember Bed & Downlight LEDS		LEDS-ALLE60	Y
10	Button Assembly with LCD Readout		BUTTONS-ALLE	Y
11	120V J-block		SF-JBLOCK	Y
12	Side Panels		PANELS-ALLE	Y
13	Front Trim		FRONT-ALLE60	Y
14	Speaker System		SF-SPKR	Y
15	Flame Screen Glass		FLAME-ALLE60	Y
	Hardware Kit (Includes Trinity Glass Brackets, Thumb Screws, Glass Bracket covers, ST4x8, Mounting Brackets)		HDWR-LINEAR	Y
	Log Assembly (Includes 100" quantity of logs)		LOGS-ALLE	Y



IMPORTANT: THIS IS DATED INFORMATION. Parts must be ordered from a dealer or distributor. **Hearth and Home Technologies does not sell directly to consumers.** Provide model number and serial number when requesting service parts from your dealer or distributor.

**Stocked  
at Depot**

ITEM	DESCRIPTION	COMMENTS	PART NUMBER	
1	Crystal Media (Large, Medium and Small)		CRYSTAL-ALLE	Y
2	Black Glass Ember and Crystals		EMBER-ALLE	Y
3	Heater Assembly		HEATER-ALLE78	Y
4	13 Button Radio Frequency Remote Control		RC-SFRF13	Y
5	PCB Board Assembly		PCB-ALLE78	Y
6	Computer/Video Driver PCB Assembly		COMP-ALLE78	Y
7	LCD Display		LCD-ALLE78	Y
8	Glass Assembly		GLASS-ALLE78	Y
9	Ember Bed & Downlight LEDS		LEDS-ALLE78	Y
10	Button Assembly with LCD Readout		BUTTONS-ALLE	Y
11	120V J-block		SF-JBLOCK	Y
12	Side Panels		PANELS-ALLE	Y
13	Front Trim		FRONT-ALLE78	Y
14	Speaker System		SF-SPKR	Y
15	Flame Screen Glass		FLAME-ALLE78	Y
	Hardware Kit (Includes Trinity Glass Brackets, Thumb Screws, Glass Bracket covers, ST4x8, Mounting Brackets)		HDWR-LINEAR	Y
	Log Assembly (Includes 100" quantity of logs)		LOGS-ALLE	Y

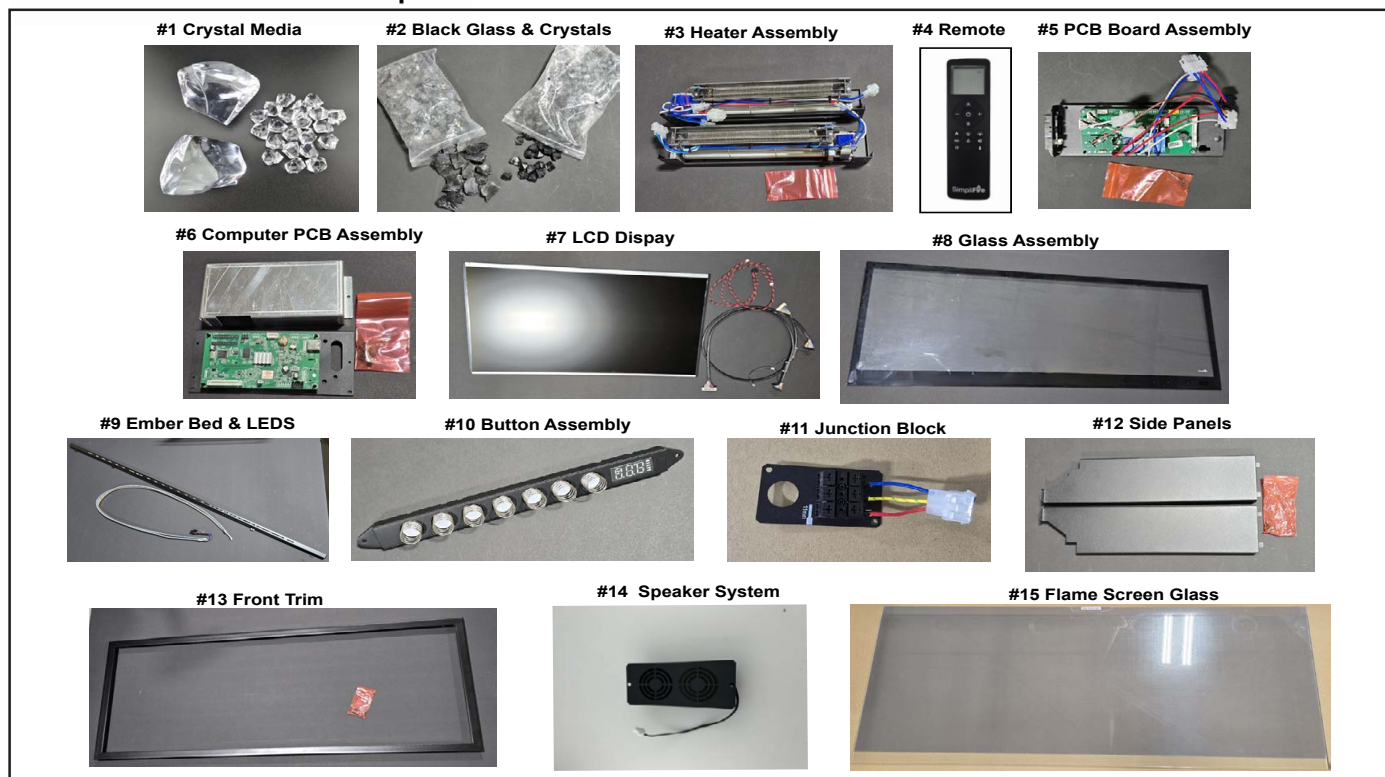

IMPORTANT: THIS IS DATED INFORMATION. Parts must be ordered from a dealer or distributor. **Hearth and Home Technologies does not sell directly to consumers.** Provide model number and serial number when requesting service parts from your dealer or distributor.

**Stocked  
at Depot**

ITEM	DESCRIPTION	COMMENTS	PART NUMBER	
1	Crystal Media (Large, Medium and Small)		CRYSTAL-ALLE	Y
2	Black Glass Ember and Crystals		EMBER-ALLE	Y
3	Heater Assembly		HEATER-ALLE78	Y
4	13 Button Radio Frequency Remote Control		RC-SFRF13	Y
5	PCB Board Assembly		PCB-ALLE100	Y
6	Computer/Video Driver PCB Assembly		COMP-ALLE78	Y
7	LCD Display		LCD-ALLE100	Y
8	Glass Assembly		GLASS-ALLE100	Y
9	Ember Bed & Downlight LEDS		LEDS-ALLE100	Y
10	Button Assembly with LCD Readout		BUTTONS-ALLE	Y
11	120V J-block		SF-JBLOCK	Y
12	Side Panels		PANELS-ALLE	Y
13	Front Trim		FRONT-ALLE100	Y
14	Speaker System		SF-SPKR	Y
15	Flame Screen Glass		FLAME-ALLE100	Y
	Hardware Kit (Includes Trinity Glass Brackets, Thumb Screws, Glass Bracket covers, ST4x8, Mounting Brackets)		HDWR-LINEAR	Y
	Log Assembly (Includes 100" quantity of logs)		LOGS-ALLE	Y

## F. Contact Information



SimpliFire®, a brand of Hearth & Home Technologies®  
7571 215<sup>th</sup> Street West, Lakeville, MN 55044  
[www.hearthnhome.com](http://www.hearthnhome.com)

Please contact your SimpliFire dealer with any questions or concerns.  
For the location of your nearest SimpliFire dealer,  
please visit [www.hearthnhome.com](http://www.hearthnhome.com).

### - NOTES -

---

---

---

---

---

---

---

---

---

---

### NOTICE



#### DO NOT DISCARD THIS MANUAL

- Important operating and maintenance instructions included.
- Read, understand and follow these instructions for safe installation and operation.
- Leave this manual with party responsible for use and operation.

