

Custom Fireplace Program

Co-linear Direct Vent Powervented Gas Fireplaces

Installation and Operating Manual

Round Models:
3-RD-24-G & 3-RD-36-G

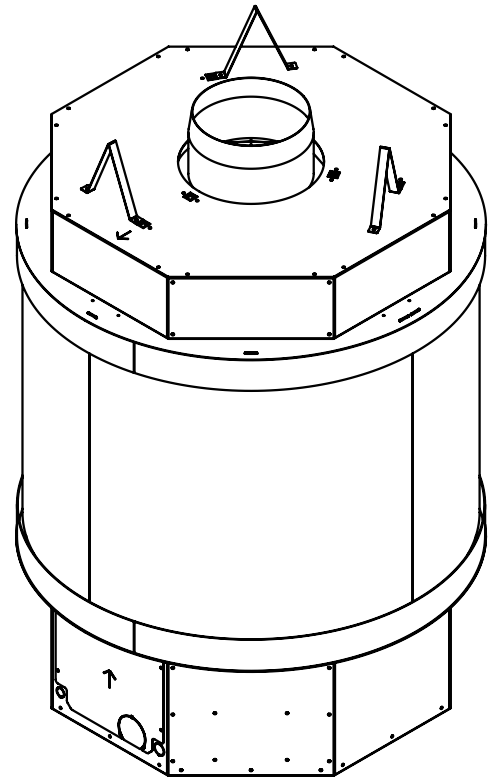

Installer: Leave this manual with the appliance.
Consumer: Retain this manual for future reference.



WARNING:
FIRE OR EXPLOSION HAZARD.

Failure to follow safety warnings exactly could result in serious injury, death, or property damage.

- Do not store or use gasoline or other flammable vapors and liquids in the vicinity of this or any other appliance.
- **WHAT TO DO IF YOU SMELL GAS**
 - Do not try to light any appliance.
 - Do not touch any electrical switch; do not use any phone in your building.
 - Leave the building immediately.
 - Immediately call your gas supplier from a neighbor's phone. Follow the gas supplier's instructions.
 - If you cannot reach your gas supplier, call the fire department.
- Installation and service must be performed by a qualified installer, service agency or the gas supplier.

DO NOT DISCARD

IMPORTANT:

This appliance is only for use with Natural Gas



DANGER



HOT GLASS WILL CAUSE BURNS.

DO NOT TOUCH GLASS UNTIL COOLED.

NEVER ALLOW CHILDREN TO TOUCH GLASS.

NATIONAL FIREPLACE INSTITUTE



CERTIFIED
www.nficertified.org

We recommend that our gas hearth products be installed and serviced by professionals who are certified in the U.S. by the National Fireplace Institute (NFI) as NFI Gas Specialists.

**Read this manual before installing or operating this appliance.
Please retain this owner's manual for future reference.**

***Congratulations on selecting a
Stellar by Heat & Glo gas fireplace.***

Your custom fireplace is crafted to elevate even the most unique spaces. The fireplace sets the stage with the most robust flames in its class and with commercial grade components providing the utmost in safety and reliability.

As the owner of a new fireplace, you'll want to read and carefully follow all of the instructions contained in this owner's manual.

Pay special attention to all cautions and warnings.

DO NOT DISCARD.

This owner's manual should be retained for future reference. We suggest that you keep it with your other important documents and product manuals.

Installation Team: At the time of install, please record the following pertinent information about the fireplace for the homeowners reference:

Model Name: _____

Serial Number: _____ Date Installed: _____

Dealer Purchased From: _____

Dealer City/State: _____ Dealer Phone: _____

Notes: _____

If your model number has not been filled out above, please contact your dealer the fireplace purchased through directly for assistance identifying your model number by the serial number.



STELLAR

by Heat & Glo

stellar.heatnglo.com

Stellar by Heat&Glo, a division of Hearth & Home Technologies, Inc.

22160 Cedar Avenue S.

Lakeville, MN 55044

(P) 952-224-4072

(E) StellarInfo@hearthnhome.com

UL RATING PLATE LOCATION & MODEL NUMBER IDENTIFICATION

The rating plate is used for multiple designs and multiple collections, and custom fireplaces. The generic nomenclature listed on the rating plate will not identically match the model of custom fireplace you have.

The rating plate must stay with the fireplace and is located below the burner in an area that will only be reachable while servicing.

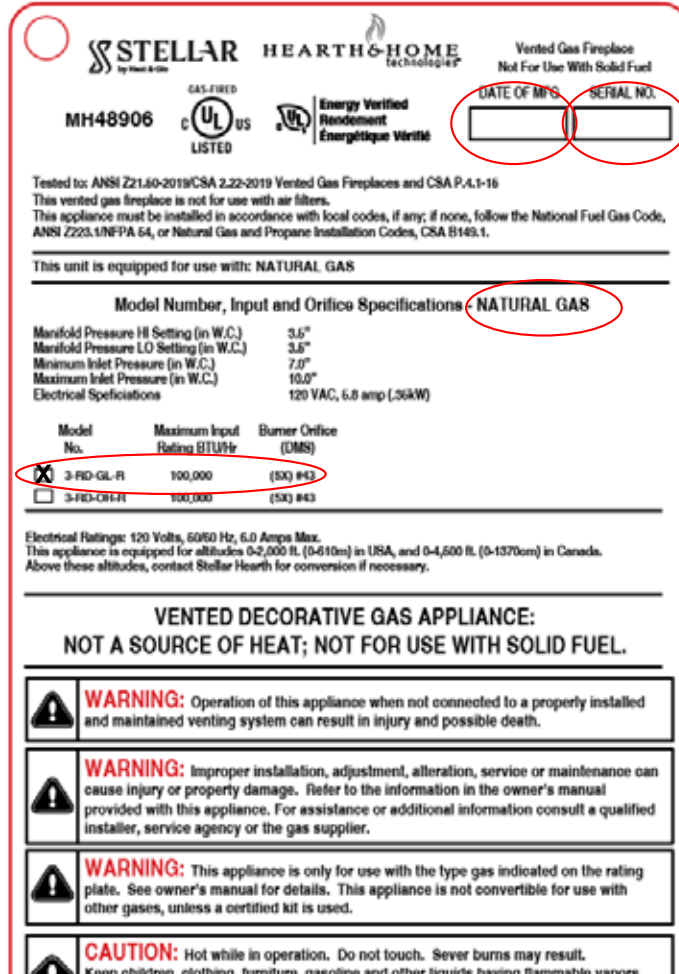

MODEL NUMBER IDENTIFICATION

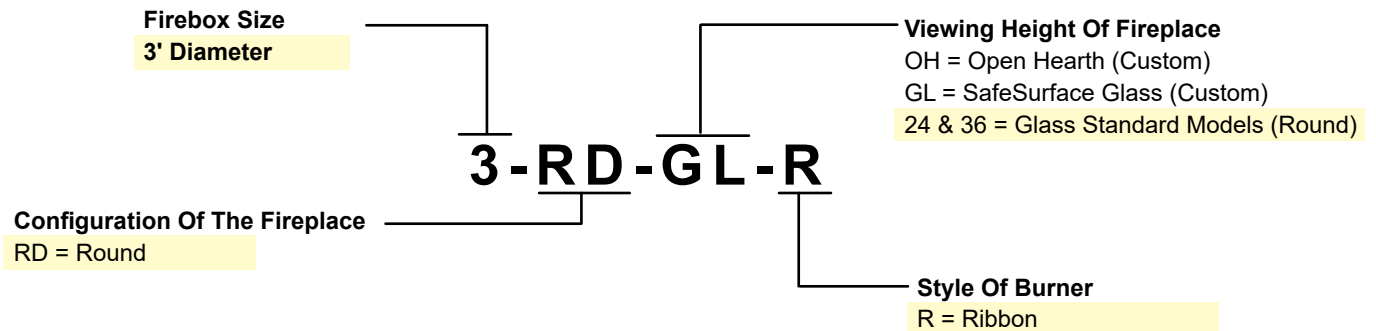

TABLE OF CONTENTS

	Section Description	Page
	Introduction & Homeowner Reference	2
	UL Rating Place & Fireplace Model Identification	3
	Table Of Contents	5
1	Safety Information	6
	A. Safety Icon Designations	6
	B. Important Safety Considerations	6
2	Commonwealth of Massachusetts Requirements	7
3	Specifications	8-11
	A. Fireplace Dimensions	8
	B Gas & Electric Access Locations	9
	C. Clearances	10
	D. Placement Clearance Requirements	11
	E. Installation Overview	11
4	Prepare The Fireplace	12-17
	A. Fireplace Orientation	13
	B. Shipping Support Brackets	14-15
	C. Threaded Rods	16
	D. Threaded Rod Installation (Example)	17
5	Framing	18
	Framing Dimensions	18
6	Mantel Requirements	19
	Non-Combustible Zone & Finishing	19
7	Glass Frame Assembly & Installation	20-25
8	Gas Line Specifications & Connection	26
9	Venting	27-39
	A. Approved Venting & Powervent Systems	27
	B. Powervent Supply Voltage Chart	27
	C. System Supply Voltage Chart	27
	D. RS Series Powervent Specifications	28
	E. Chimney Collar Dimensions	28
	F. RSIF Series Powervent Specifications	29
	G. In-line Powervent Preparations - RSIF 180	30
	H. Horizontal Vent System Clearance	31
	I. Wall Pass Through	31
	J. Pitot Tube Information	31

9	Venting - Continued	
	K. Vertical Terminations	32
	L. Horizontal Cap Location & Clearances	32
	M. Horizontal Termination	33
	N. Powervent & Air-intake Placement Clearances	34
	O. Vertical Cap Location & Clearances	35
	P.1. Roof Termination Cap Installation With Damper	36
	P.2 Roof Termination Cap Installation Without Damper	36
	Q.2 Wall Termination Cap Installation Without Damper	37
	Q.1. Wall Termination Cap Installation With Damper	37
	R. Outside Air Intake	38
	S. Outside Air-Intake Collar Assembly	39
	T. Optional Universal Exhaust & Intake Louver	39
10	Electrical	40-49
	A. PDS-01 Switch Installation - REQUIRED	40-41
	B.1 Tethered Control Electrical Overview	42
	B.2 Electrical Schematic - Install	43
	B.3 Electrical Schematic - Service	44
	B.4 Junction Box & Capacitor	45
	C.1 Terminals 1 & 2 - LED Lights	45
	C.2 Terminals 3 & 4 - Main Flame	46
	C.3 Terminals 5 & 6 - Fireplace Power	47
	C.4 Terminals 7 & 8 - Powervent Connection	47
	C.5 Terminals 9 & 10 - Flue Damper Connection	48
	C.6 Terminals 11 & 12 - Flue Damper Prove	48
	C.7 Terminals 13 & 14 - Pressure Switch (PDS-01)	49
11	Finishing	50
	Refer To Section 6	17
12	Lighting & Shutdown	50-51
	A. Lighting The Fireplace	50-51
	B. If The Fireplace Does Not Light	51
13	Pressure Testing	52
14	Finalizing The Installation	52
	A. Installing The Media	52
	B. Flame Appearance	52
15	Maintenance	53
	A. Valve & Electric Access Locations	53
	B. Vent System	53
	C. Glass Cleaning & Replacement	53
16	Replacement Parts	54
	Hearth & Home Technologies Warranty	55-56

1 - SAFETY INFORMATION

This fireplace complies with ANSI Z21.50-2019 / CSA 2.22-2019 "VENTED GAS FIREPLACE" and CAN/CSA P.4.1-15
Installation must conform with local building codes or in the absence of local building codes,
with the National Fuel Gas Code, ANSI Z223.1/NFPA 54 - Current Edition, or the Natural or Propane Installation Code, CSAB149.1

A. SAFETY ICON DESIGNATIONS

Various safety icons appear throughout this installation manual. Please familiarize yourself with the icons making sure you understand the serious consequences that may occur if ignored or of handling the products inappropriately.



IMPORTANT NOTE

This indicates additional instructions that you should consider during the installation.



HOT GLASS WARNING

This indicates danger of serious bodily injury or property damage if glass is handled while still hot.



DO NOT

This indicates something that you must never do.



CAUTION

This indicates danger of serious bodily injury or property damage



RISK OF FIRE

This designates a danger of risk of fire or damage to property.



STOP!

This indicates notes that may include reviewing warnings on other pages throughout the manual

B. IMPORTANT SAFETY CONSIDERATIONS

- Installation and repair should be done only by a qualified service person. The appliance should be inspected by a qualified service person before use. Annual inspection by a qualified service person is required to maintain warranty. More frequent cleaning may be required due to excessive lint from carpeting, bedding materials, etc. It is imperative that control compartments, burners and circulation air passageways of the appliance be kept clean.
- Children and adults should be alerted to the hazards of high surface temperatures and should stay away to avoid burns or clothing ignition.
- Young children should be carefully supervised when they are in the same room as the appliance. Toddlers, young children and others may be susceptible to accidental contact burns. A physical barrier is recommended if there are at risk individuals in the house. To restrict access to a fireplace or stove, install an adjustable safety gate to keep toddlers, young children and other at risk individuals out of the room and away from hot surfaces.
- Clothing or other flammable material should not be placed on or near the appliance.
- Adequate accessibility clearances for servicing and proper operation must be maintained.
- This appliance must not share or be connected to a chimney flue serving any other appliance.
- Keep area around the appliance clear of combustible materials, gasoline and other flammable vapor and liquids.
- The flow of combustion and ventilation air must not be obstructed.
- Due to high temperatures the appliance should be located out of traffic and away from furniture and draperies.
- The glass front or any part removed for servicing the appliance must be replaced prior to operating the appliance. Work should be done by a qualified service technician.
- Clean glass only when cool and only with non-abrasive cleansers.
- Do not operate this appliance with the glass/frame assembly removed, cracked or broken. Replacement of the glass assembly must only be performed by a licensed or qualified service person. **DO NOT SUBSTITUTE MATERIALS.**
- Do not strike or slam glass assembly.
- Keep burner and control compartment clean.
- Do not use this fireplace if any part has been under water. Immediately call a qualified service technician to inspect this appliance and to replace any part of the control system and any gas control which has been under water.
- **DANGER:** Under no circumstances should any solid fuel (wood, coal, paper or cardboard etc.) be used in this appliance.
- **STATE OF CA WARNING:** This product and the fuels used to operate this product (liquid propane or natural gas), and the combustion of such fuels, can expose you to chemicals including benzene, which is known to the State of California to cause cancer and reproductive harm.

For more information go to: www.P65Warnings.ca.gov.

2 - COMMONWEALTH OF MASSACHUSETTS REQUIREMENTS



NOTE: THE FOLLOWING REQUIREMENTS REFERENCE VARIOUS MASSACHUSETTS AND NATIONAL CODES NOT CONTAINED IN THIS MANUAL.

For all sidewall horizontally vented gas fueled equipment installed in every dwelling, building or structure used in whole or in part for residential purposes, including those owned or operated by the Commonwealth and where the side wall exhaust vent termination is less than (7) feet above finished grade in the area of the venting, including but not limited to decks and porches, the following requirements shall be satisfied:

INSTALLATION OF CARBON MONOXIDE DETECTORS

At time of installation of side wall horizontally vented gas fueled equipment, the installing plumber or gas-fitter shall observe that a hard wired carbon monoxide detector with an alarm and battery back-up is installed on the floor level where the gas equipment is to be installed. In addition, the installing plumber or gas-fitter shall observe that a battery operated or hard wired carbon monoxide detector is installed on each additional level of the dwelling, building or structure served by the side wall horizontal vented gas fueled equipment. It shall be the responsibility of the property owner to secure the services of qualified licensed professionals for the installation of hard wired carbon monoxide detectors.

In the event that the side wall horizontally vented gas fueled equipment is installed in a crawl space or attic, the hard wired carbon monoxide detector with alarm and battery back-up may be installed on the next adjacent floor level.

In the event that the requirements of this subdivision can not be met at the time of completion of installation, the owner shall have a period of thirty (30) days to comply with the above requirements; provided, however, that during said thirty (30) day period, a battery operated carbon monoxide detector with an alarm shall be installed.

APPROVED CARBON MONOXIDE DETECTORS

Each carbon monoxide detector as required in accordance with the above provisions shall comply with NFPA 720 and be ANSI/UL 2034 listed and IAS certified.

SIGNAGE

A metal or plastic identification plate shall be permanently mounted to the exterior of the building at a minimum of eight (8) feet above grade directly in line with the exhaust vent terminal for the horizontally vented gas fueled heating appliance or equipment. The sign shall read, in print no less the one-half inch (1/2) in size, "GAS VENT DIRECTLY BELOW. KEEP CLEAR OF ALL OBSTRUCTIONS".

INSPECTION

The state or local gas inspector of the side wall horizontally vented gas fueled equipment shall not approve the installation unless, upon inspection, the inspector observes carbon monoxide detectors and signage installed in accordance with the provisions of 248 CMR 5.08 (2) (a) 1 through 4.

EXEMPTIONS

The following equipment is exempt from 248 CMR 5.08 (2) (a) 1 through 4: The equipment listed in Chapter 10 entitled "Equipment Not Required To Be Vented" in the most current edition of NFPA 54 as adopted by the Board; and Product Approved side wall horizontally vented gas fueled equipment installed in a room or structure separate from the dwelling, building or structure used in whole or in part for residential purposes.

MANUFACTURES REQUIREMENTS GAS EQUIPMENT VENTING SYSTEM PROVIDED

When the manufacturer of Product Approved side wall horizontally vented gas equipment provides a venting system design or venting system components with the equipment, the instructions provided by the manufacturer for installation of the equipment and the venting system shall include:

Detailed instructions for the installation of the venting system design or the venting system components; and a complete parts list for the venting system design or venting system.

MANUFACTURES REQUIREMENTS GAS EQUIPMENT VENTING SYSTEM NOT PROVIDED

When the manufacturer of Product Approved side wall horizontally vented gas equipment does not provide the parts for venting the flue gases, but identifies "special venting systems", the following requirements shall be satisfied by the manufacturer:

The referenced "special venting systems" instructions shall be included with the appliance or equipment installation instructions and; the "special venting systems" shall be Product Approved by the Board, and the instructions for that system shall include a parts list and detailed Installation instructions.

A copy of all installation instructions for all Product Approved side wall horizontally vented gas fueled equipment, all venting instructions, all parts lists for venting instructions, and/or all venting design instructions shall remain with the appliance or equipment at the completion of the installation.

3 - SPECIFICATIONS

A. FIREPLACE DIMENSIONS

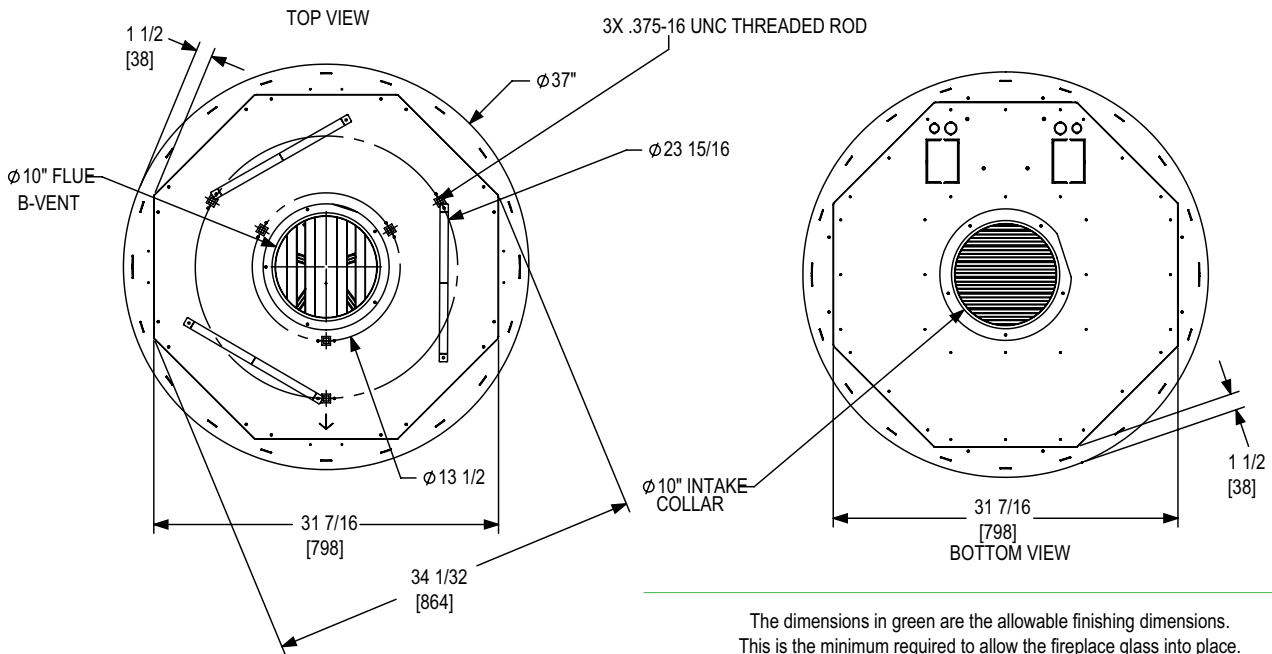

The dimensions in green are the allowable finishing dimensions. This is the minimum required to allow the fireplace glass into place. Finishing materials must not overlap these dimensions.

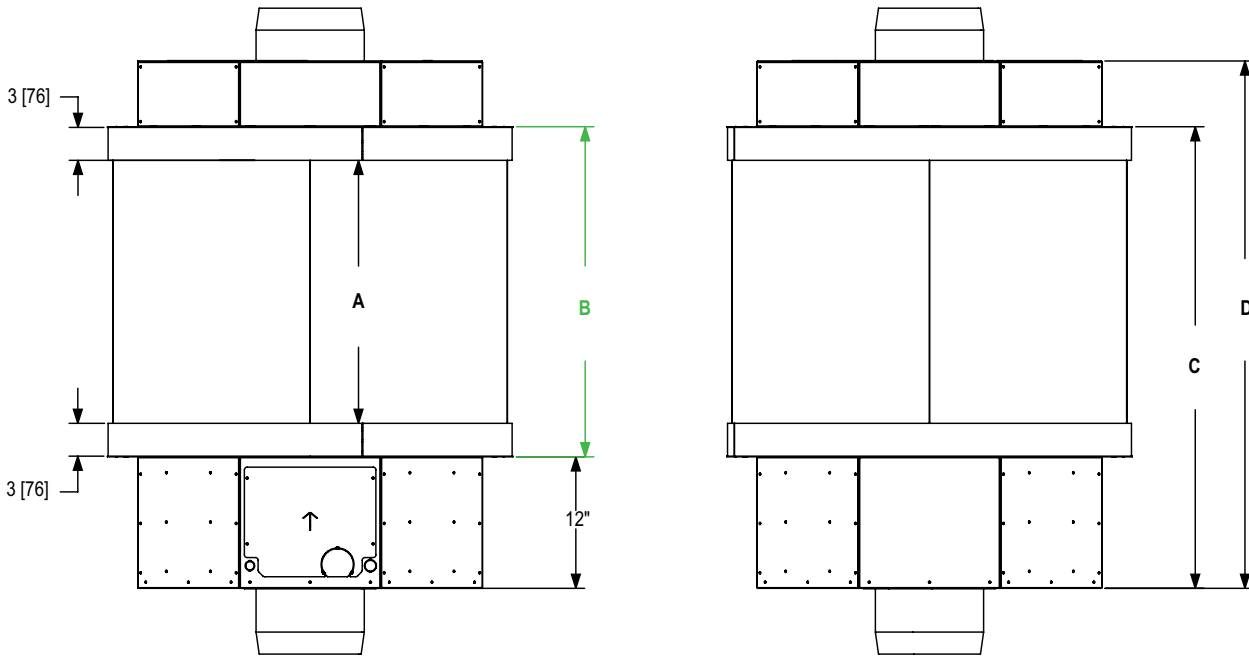

Model #	SPECIFICATIONS		DIMENSIONS - INCHES [MILLIMETERS]			
	B-VENT	OA	A	B	C	D
3RD-24GL	10"	10"	24 [610]	30-1/8 [791]	42-1/8 [1,070]	48-1/8 [1,222]
3RD-36GL	10"	10"	36 [914]	42-1/8 [1,070]	54-1/8 [1,375]	60-1/8 [1,527]

Figure 3A

3 - SPECIFICATIONS

B. GAS & ELECTRICAL ACCESS LOCATIONS

Top View

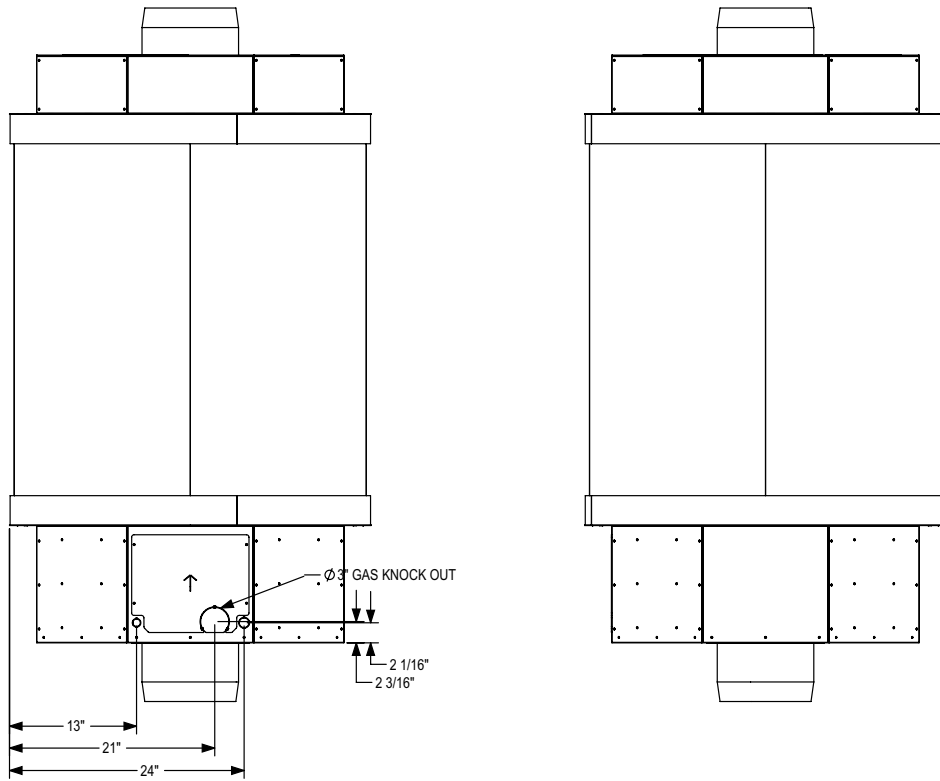
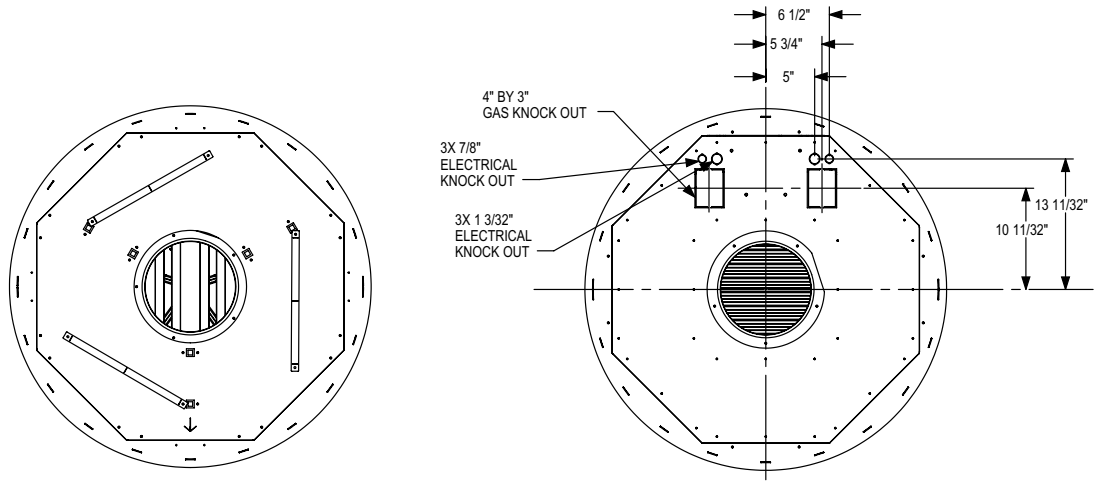

TETHERED CONTROL PANEL BOX

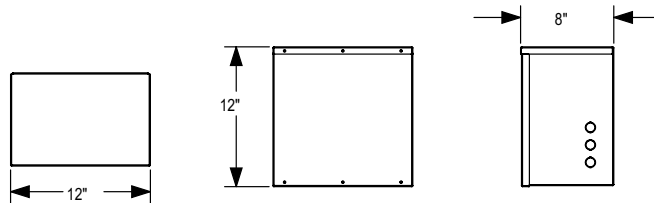

Figure 3B

3 - SPECIFICATIONS



WARNING: NON-COMBUSTIBLE ZONE: USE ONLY NON-COMBUSTIBLE MATERIAL IN THIS AREA FOR ENTIRE WIDTH OF FIREPLACE. DO NOT USE WOOD, SHEETROCK, ETC., IN THIS ZONE.



NOTE: OTHER CLEARANCES APPLY. ALL CLEARANCES MUST BE MAINTAINED. REFER TO SPECIFICATIONS 3C FOR MORE INFORMATION.

12" [305] CLEARANCE TO COMBUSTIBLES ALL THE WAY AROUND FIREPLACE GLASS AND TOP AND BOTTOM 3" [76] TRIM TO BE ABLE TO GET THE GLASS OFF

Figure 3C

3X .375-16 UNC THREADED ROD

FIREPLACE IS NOT LOAD BEARING



THE HOOD SHALL BE SUPPORTED USING QTY 3, .375-16 UNC THREADED RODS

TEMPORARY SUPPORTS SHALL BE PROVIDED FOR INSTALLATION

NO COMBUSTIBLE MATERIAL WITHIN 6" [152] OF THE TOP OF THE FIREPLACE

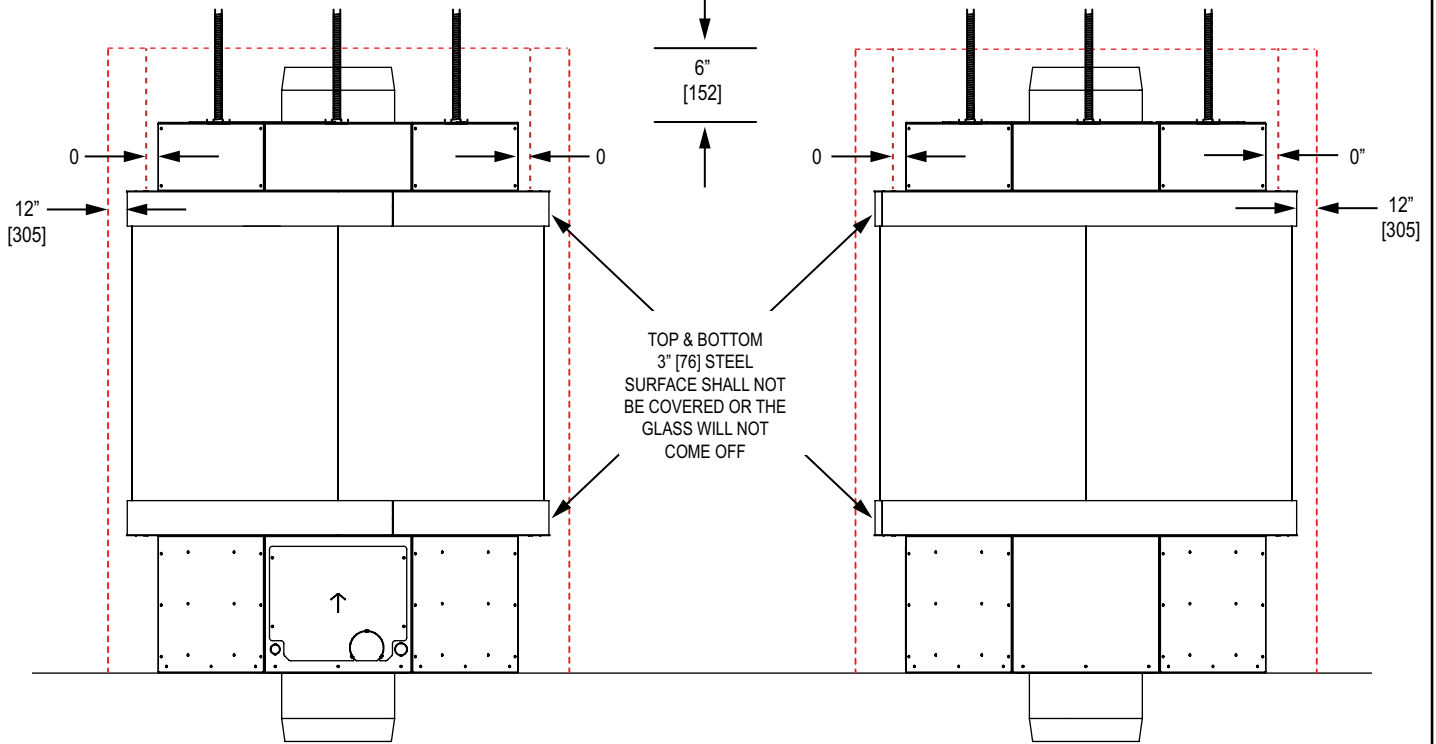

OTHER CLEARANCE NOTES:

DO NOT PLACE ON CARPET, VINYL OR SOFT SURFACES.

COMBUSTIBLE FRAMING AND FINISHING MAY BE PLACED ON THE FIREPLACE ANYWAY BELOW THE BOTTOM OF GLASS VIEWING

PLEASE PLAN FOR THE FINISHING OF THE ELECTRIC ACCESS PRIOR TO ANY FRAMING

TOP & BOTTOM 3" [76] STEEL SURFACE SHALL NOT BE COVERED. TRIM MUST BE REMOVABLE TO INSTALL AND REMOVE GLASS.

3 - SPECIFICATIONS



NOTE: The qualified installer should follow the procedure best suited for the installation.

C. CLEARANCES TO COMBUSTIBLES

From unit left & right sides	1"	25.4mm
To flooring under fireplace	0	0
Unit top to ceiling	48"	121.9cm
Unit side to adjacent sidewall	1"	25.4mm

D. PLACEMENT CLEARANCE REQUIREMENTS

- This fireplace must be installed on a level surface capable of supporting the fireplace and venting.
- Fireplace must be placed directly on wood or non-combustible surface (not linoleum or carpet) extending entire depth and width of fireplace.
- Due to high surface temperatures, fireplace should be located out of traffic and away from furniture and draperies.
- This fireplace may be installed in a bedroom.
- Please be aware of the large amount of heat this fireplace will produce when determining a location.

E. INSTALLATION OVERVIEW

1. Frame an opening for fireplace, allowing for vent installation.
2. If masonry (optional) will be used, prepare foundation for the masonry load. A lintel is required to support the added weight above the fireplace.
3. Install hearth if desired.
4. Insert fireplace into framing.
5. Double check clearances to combustibles.
6. Complete gas line installation.
7. Complete electrical hook-up.
8. Complete venting installation.
9. Install facing material, mantel or cabinetry.
10. Install logs or glass and ember material or media.
11. Verify proper operation of fireplace and all components.

IMPORTANT NOTE:

- Wood may be used as a hearth extension.

Non-Combustible Materials Specifications

Material which will not ignite and burn.

Such materials are those consisting entirely of steel, iron, brick, tile, concrete, slate, glass or plasters, or any combination thereof.

Materials that are reported as passing **ASTM E 136, Standard Test Method for Behavior of Materials in a Vertical Tube Furnace at 750 °C** shall be considered non-combustible materials.

Combustible Materials Specifications

Materials made of or surfaced with wood, compressed paper, plant fibers, plastics, or other material that can ignite and burn, whether flame proofed or not, or plastered shall be considered combustible materials.

4 - PREPARE THE FIREPLACE



CAUTION: FIREPLACE IS NOT LOAD-BEARING.



NOTE: OTHER CLEARANCES APPLY. ALL CLEARANCES MUST BE MAINTAINED.

4 - PREPARE THE FIREPLACE

A. ORIENTATION OF FIREPLACE

TEMPORARY SUPPORT BRACKETS

The four (4) temporary support brackets are not shipped in place on the fireplace. You will be required to assemble them at the jobsite to support the hood prior to installing the required threaded rods that support the hood. Once the hood is properly supported with the required threaded rods using either the inner circle or outer circle threaded rod locations and the fireplace is confirmed to be level, the temporary supports may be taken off and the glass panels installed. Refer to Threaded Rod Requirements for more information on placement.

NOTE: If using our optional aluminum hood and cladding, the inner bolt circle must be used.

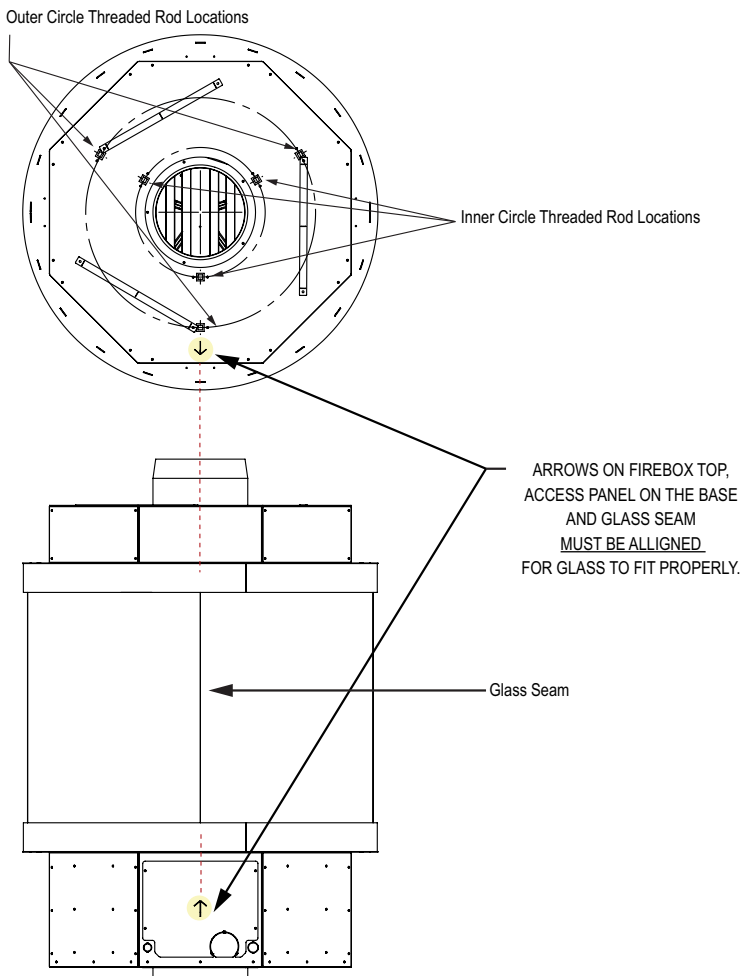

Figure 4A.1

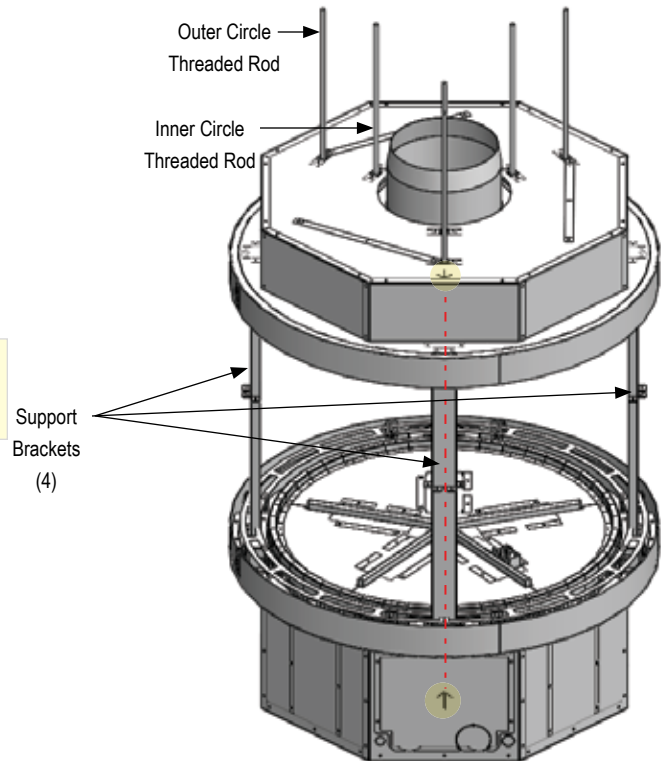

Figure 4A.2

- IMPORTANT: FIREPLACE ORIENTATION -

Prior to installing the temporary support brackets, it is important to orient your fireplace base and hood properly. Take into consideration there are four (4) glass seams total, and one seam will need to be fully aligned with the arrows found on the hood and the base access panel. Visualize the full room around the fireplace and where you may want the glass seams to be placed in relation to any furniture or sitting area.

Once you have the orientation finalized, you can install the temporary support brackets according to the installation instructions found on the following pages.

Again, it is imperative that the top hood arrow, a glass seam and the arrow on the base access panel are aligned or the glass will not fit properly.

After support bracket installation, you can continue on to installing the three (3) required threaded rods.

4 - PREPARE THE FIREPLACE

B. SUPPORT BRACKET INSTALLATION

The hood must be supported at specific locations using 3/8-16 UNC threaded rods. Temporary support brackets are put in place for shipping and installation support and must stay in place until fireplace hood is fully supported.

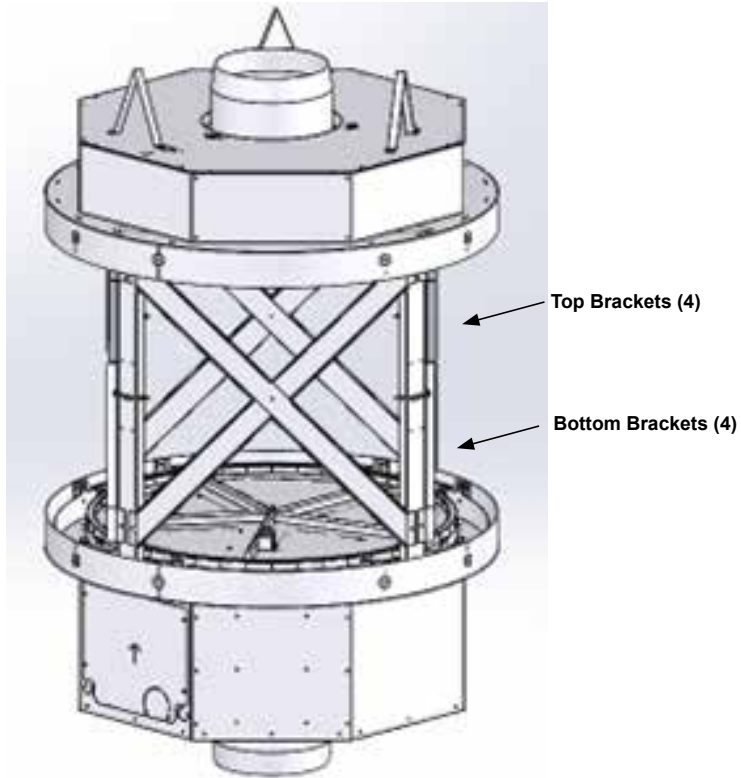
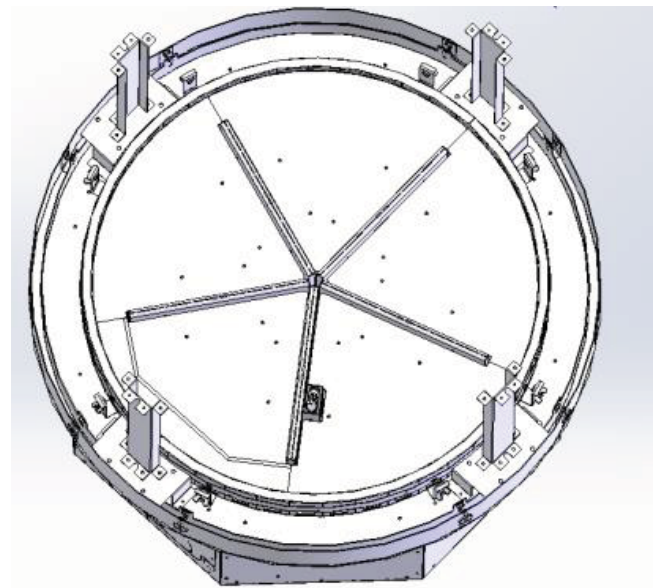
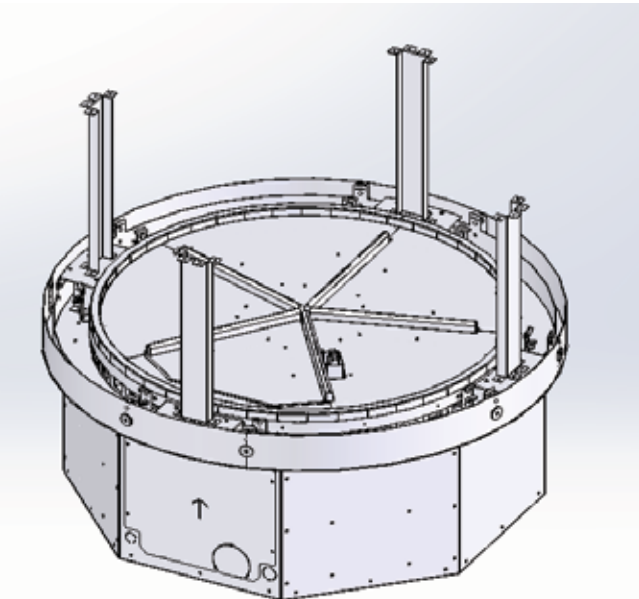

Figure 4B.1

Figure 4B.2 Attach the four bottom brackets to the base in the orientation shown.

Figure 4B.3 Attach screws in this area to all four brackets.



4 - PREPARE THE FIREPLACE

B. SUPPORT BRACKET INSTALLATION

Figure 4B.4

Attach top brackets to bottom as shown with screws.

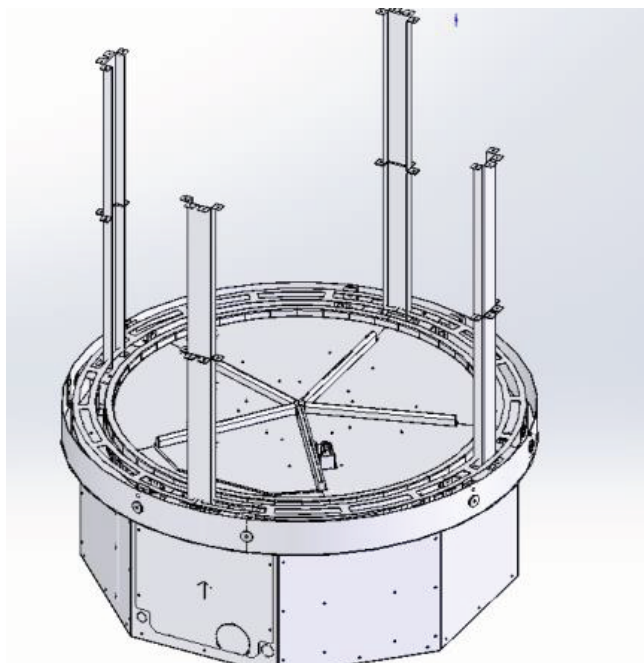

Figure 4B.5

Carefully place hood on top of the brackets.

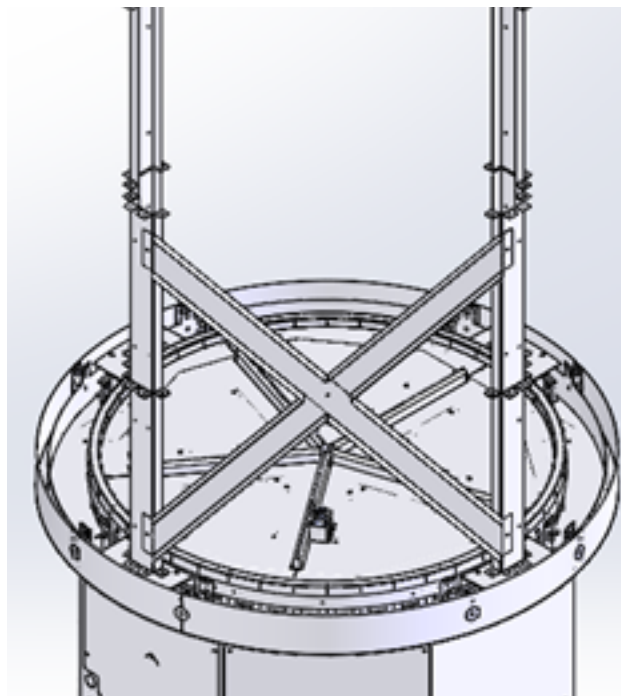
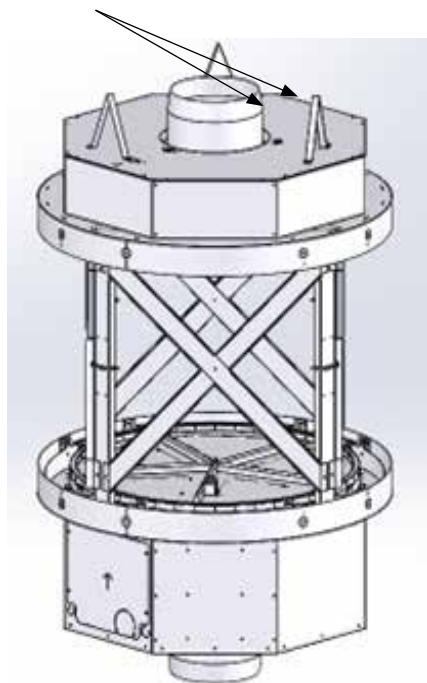

Figure 4B.6

Attach screws in this area on all four brackets.



4 - PREPARE THE FIREPLACE

C. THREADED ROD REQUIREMENTS

The fireplace requires 3 threaded rods to be placed at certain locations to support the hood (3/8-16 UNC)
You can choose to use all three outer circle threaded rod locations or all three inner circle threaded rod locations shown below.
DO NOT USE a mix of outer and inner locations.

NOTE: If using our optional aluminum hood and cladding, the inner bolt circle must be used.

Example of parts needed and threaded rod installation shown on the following pages.

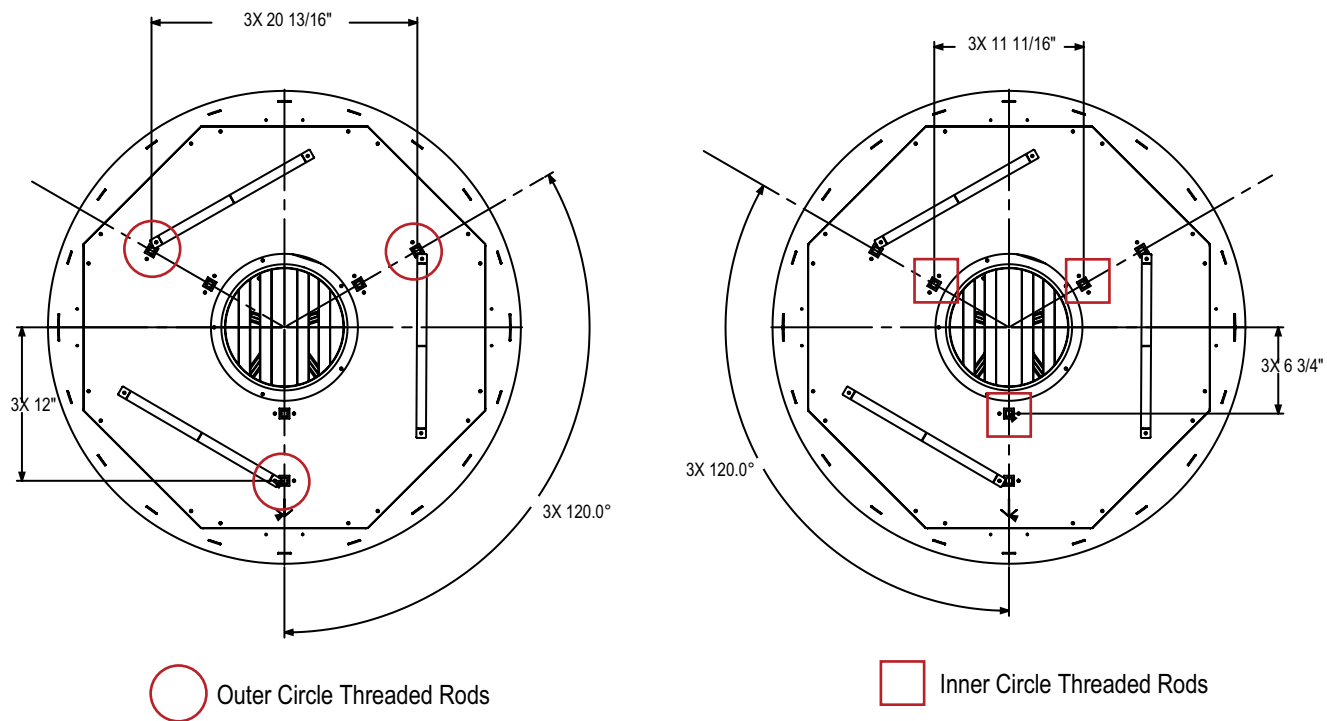

Figure 4C

4 - PREPARE THE FIREPLACE

D. THREADED RODS INSTALLATION (EXAMPLE)

There are several different ways to support the fireplace top and one option is to use a Uni-strut installed over the fireplace that is secured to structurally sound framing.

For each threaded rod installation you may need:



Super Strut
or Uni-Strut



Qty 1
3/8-16
Eyebolt



Qty
1 Threaded
Quick Link



Qty 1
3/8-16
Turnbuckle



Qty 1
3/8-16
Threaded Rod
or All Thread



Qty 1
Fender
Washer



Up To Qty 3
3/8-16
Nut

Parts Needed Per Threaded Rod Used

Figure 4D.1



Figure 4D.2

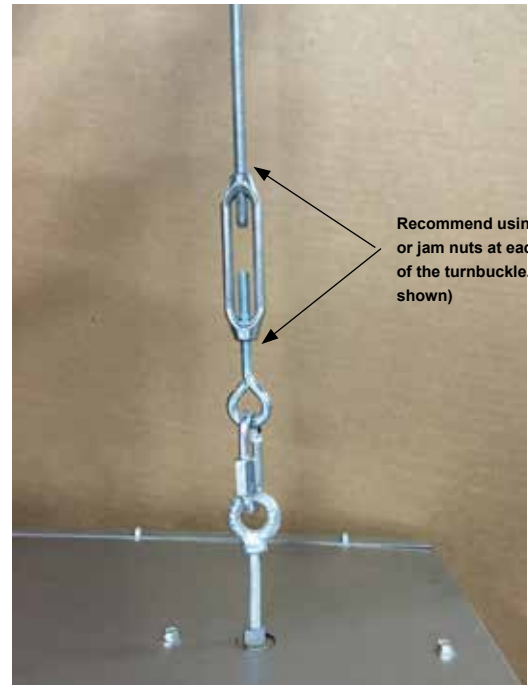

Figure 4D.3

- Install the threaded rod fully into the threaded fastener located on top of the fireplace.
- Insert the threaded rod into a hole in the Uni-strut straight above the threaded fastener located on top the fireplace.
- Use a fender washer and nut on the top end of the threaded rod to adjust the height of the fireplace opening. Make sure the opening dimension is exact all the way around. Use Loctite to secure the nut from loosening (not shown).
- If the top of the threaded rod is to be secured into blind threaded fastener or if there isn't clearance above to adjust the rod, you can use a turnbuckle to adjust the height.
- Install an eye bolt fully into the threaded nut located on top of the fireplace.
- Use a quick link to connect the eye bolt to the reverse thread side of the turnbuckle.
- Thread the threaded rod into the normal side of the turnbuckle.
- Use the locktight or jam nuts to secure the turnbuckle from loosening.

5 - FRAMING

WALL ENCLOSURE ROUGH OPENING



NOTE: Framing dimensions should allow for wall covering thickness and fireplace facing materials. When using a hearth, adjust rough opening size as necessary to maintain at least minimum clearance requirements.

Model #	A	B
3-RD-24-G	48-1/8" [1,222]	54-1/8" [1375]
3-RD-36-G	60-1/8" [1,527]	66-1/8" [1,680]

THESE DIMENSIONS REPRESENT THE FRAMING DIMENSIONS FOR COMBUSTIBLE MATERIAL.
NON-COMBUSTIBLE FRAMING AND FINISHING MATERIALS MAY BE USED WITHIN THESE DIMENSIONS RIGHT UP THE UNIT.

MUST MAINTAIN 1" [25] MINIMUM CLEARANCE
AROUND B-VENT PIPE

FRAMING DIMENSIONS ASSUMING
1/2" [13] NON-COMBUSTIBLE BOARD USED

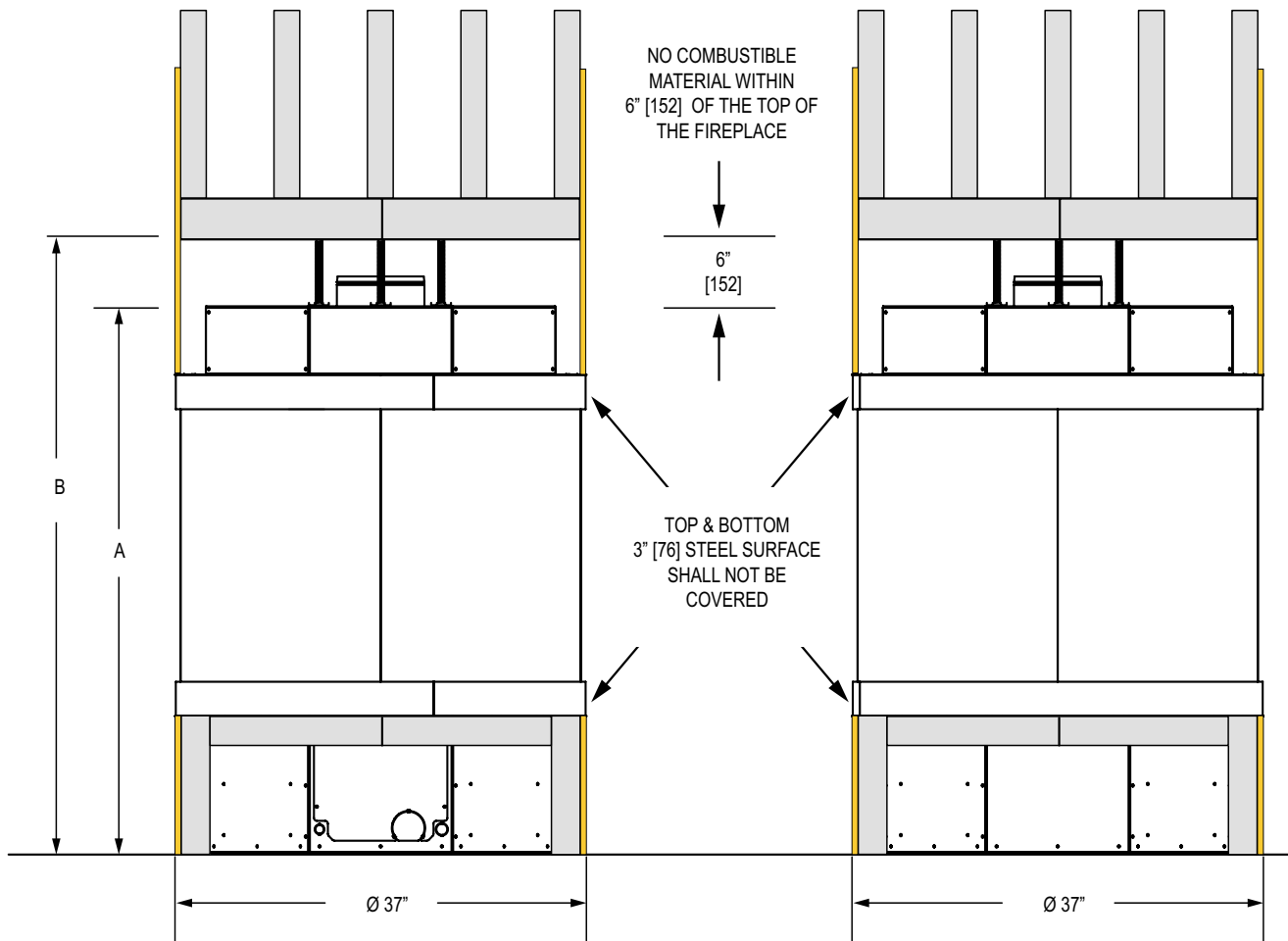

CLEARANCES ARE MINIMUM CLEARANCES TO COMBUSTIBLES.
NON-COMBUSTIBLE FRAMING AND FINISHING MATERIALS ARE ALLOWED RIGHT UP TO THE FIREPLACE.
IT IS RECOMMENDED TO SET THE FIREPLACE IN PLACE FIRST AND THEN FRAME.
DIMENSIONS SHOWN ASSUME A 1/2" [13] NON-COMBUSTIBLE BOARD USED. RECALCULATE DIMENSIONS FOR THE THICKNESS OF FRAMING AND FINISHING MATERIALS IF DIFFERENT IN YOUR OWN INSTALLATION.

Figure 5

If masonry is to be used (optional), prepare the necessary foundation for the masonry load. When masonry construction is being used, a lintel must be used over top of fireplace to support the added weight. Build hearth to desired size and height. If a hearth extension is desired, combustible material may be used.



CAUTION: Install fireplace on metal, concrete or hard wood surface extending the full width and depth of fireplace.

6 - MANTEL REQUIREMENTS

NON-COMBUSTIBLE ZONE & FINISHING SCHEMATIC

WARNING! Risk of Fire

Comply with all the minimum clearances as specified in Specifications - Clearances section.

Notes About TV Placement:

A mantel is not required if you are placing a TV above the opening.

No minimum clearance requirement for placement of TV if using a mantel.

12" [305] minimum clearance is recommended for placement of a TV above the opening if NOT using a mantel.

Note About Mantel Depth:

There are no minimum or maximum depth requirements for the mantel.

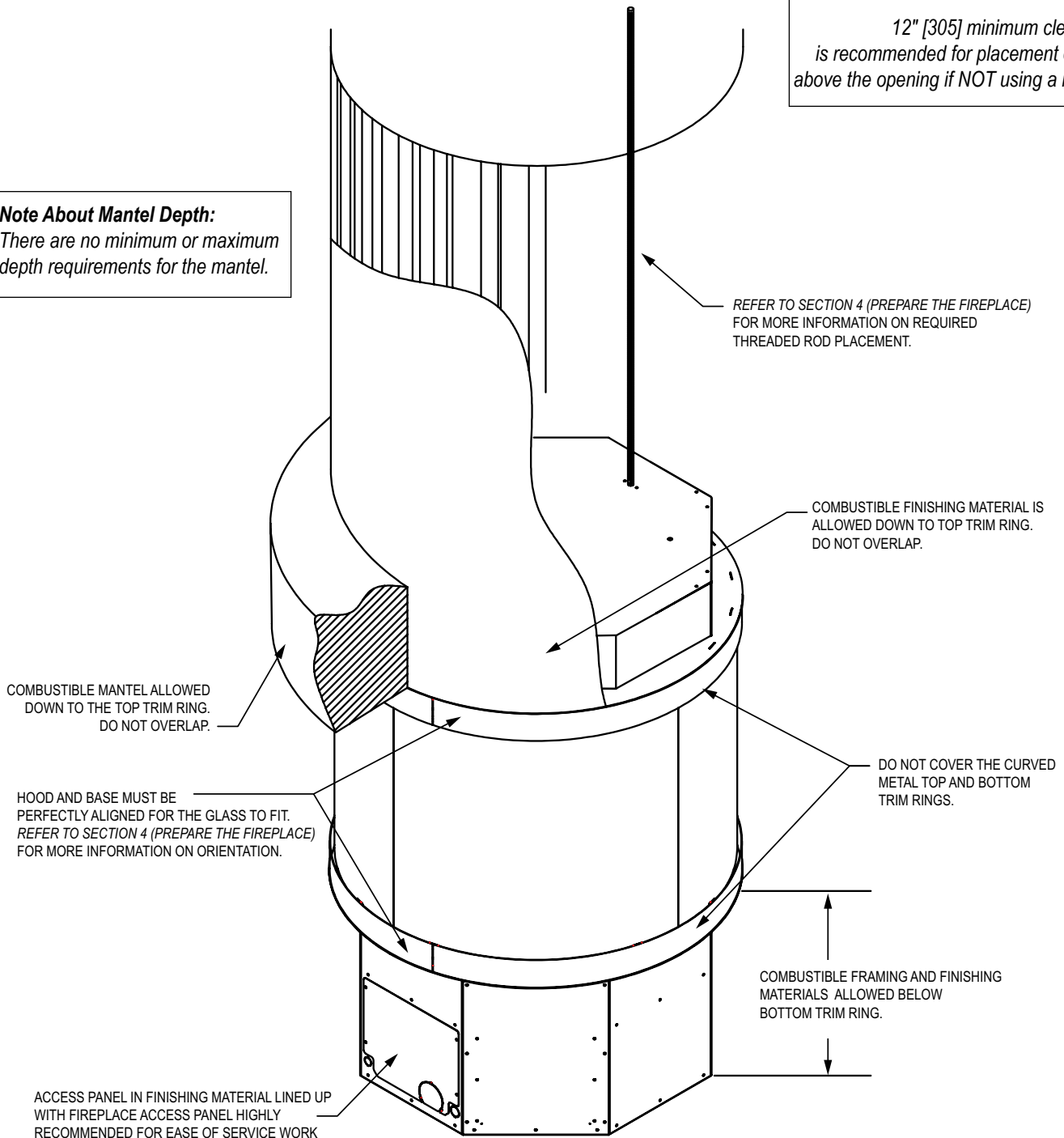

Figure 6

7 - GLASS FRAME ASSEMBLY



CAUTION: TO PREVENT GLASS FRAME ASSEMBLY FROM FALLING FROM FIREPLACE AND BECOMING DAMAGED, FOLLOW THE INSTRUCTIONS EXACTLY WHEN REMOVING AND INSTALLING GLASS FRAME ASSEMBLY.



STOP: DO NOT OPERATE THIS FIREPLACE WITH THE GLASS REMOVED, CRACKED OR BROKEN. REPLACEMENT OF GLASS ASSEMBLY SHOULD BE DONE BY A LICENSED OR QUALIFIED SERVICE PERSON.



WARNING: RISK OF INJURY!

DO NOT remove glass until unit is cooled to room temperature. Glass breakage could occur.



NOTE: GLASS REMOVAL AND INSTALLATION MUST BE PERFORMED WITH TWO PEOPLE.



**NOTE: Glass must be removed using quality suction cups.
DO NOT attempt to remove the glass without using proper suction cups.**



**NOTE: IN CASE OF CHIPPED OR BROKEN GLASS
Have your local dealer assist you with contacting Stellar Hearth Products directly for glass replacement.**

7 - GLASS FRAME ASSEMBLY

ROUND GLASS INSTALLATION

Align top and base using a plumb bob to line the bolts on top and the bolts on the bottom up with each other.

Top must be exactly above the base in order for the glass to fit properly.

NOTE

When placing the glass, keep the wing nuts loose until all four pieces of glass are in place.

After lining the edges up, gently and evenly tighten the wing nuts.

ONLY TIGHTEN UNTIL SNUG.
Do not over-tighten.

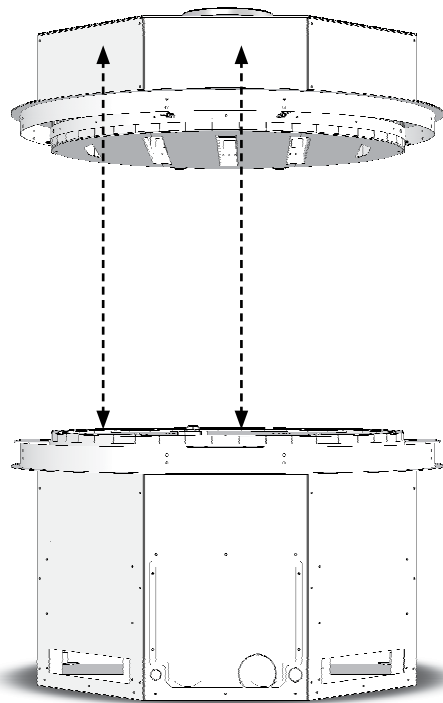

Figure 7.1

Glass Place

Install the smaller inner glass by placing evenly across half of the support with rubber pads.
DON'T LET GO - glass will tip out!

Secure with clips and wing nuts.
Do not over-tighten wing nuts.

Repeat for the other three panels.

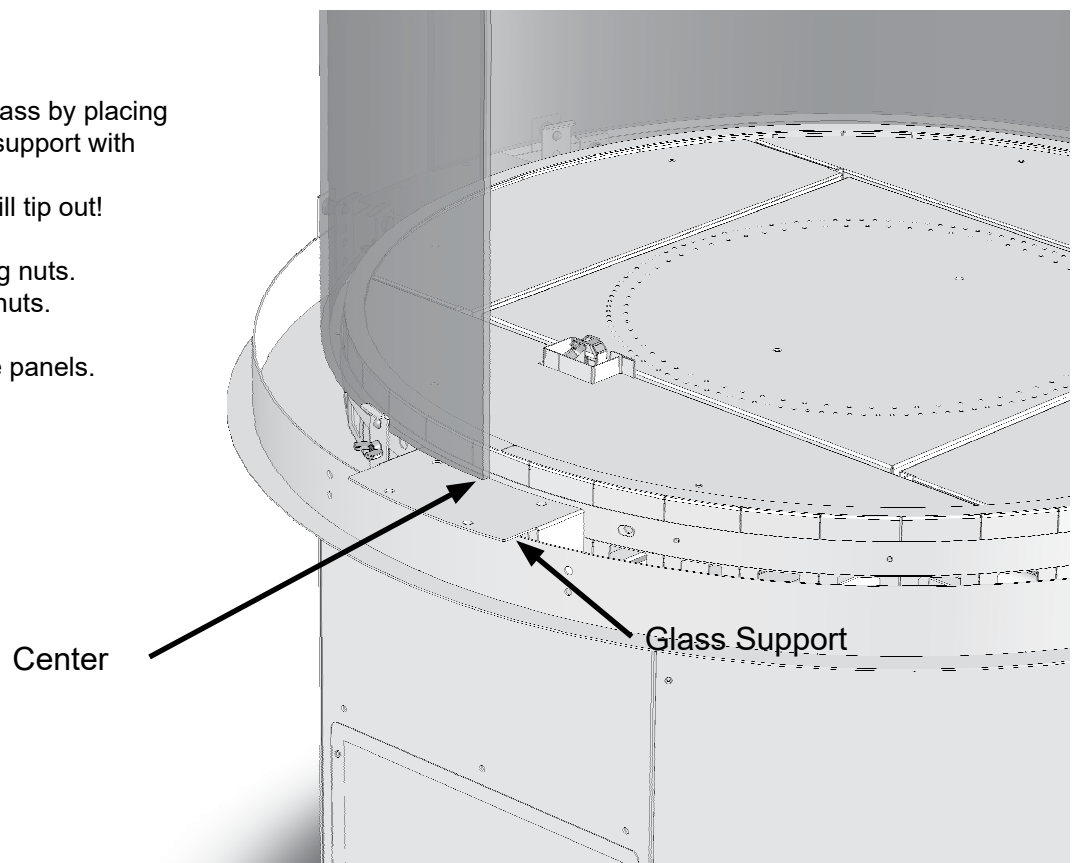

Figure 7.2

7 - GLASS FRAME ASSEMBLY

ROUND GLASS INSTALLATION

Inside Glass & Clip
View - Top

Clip

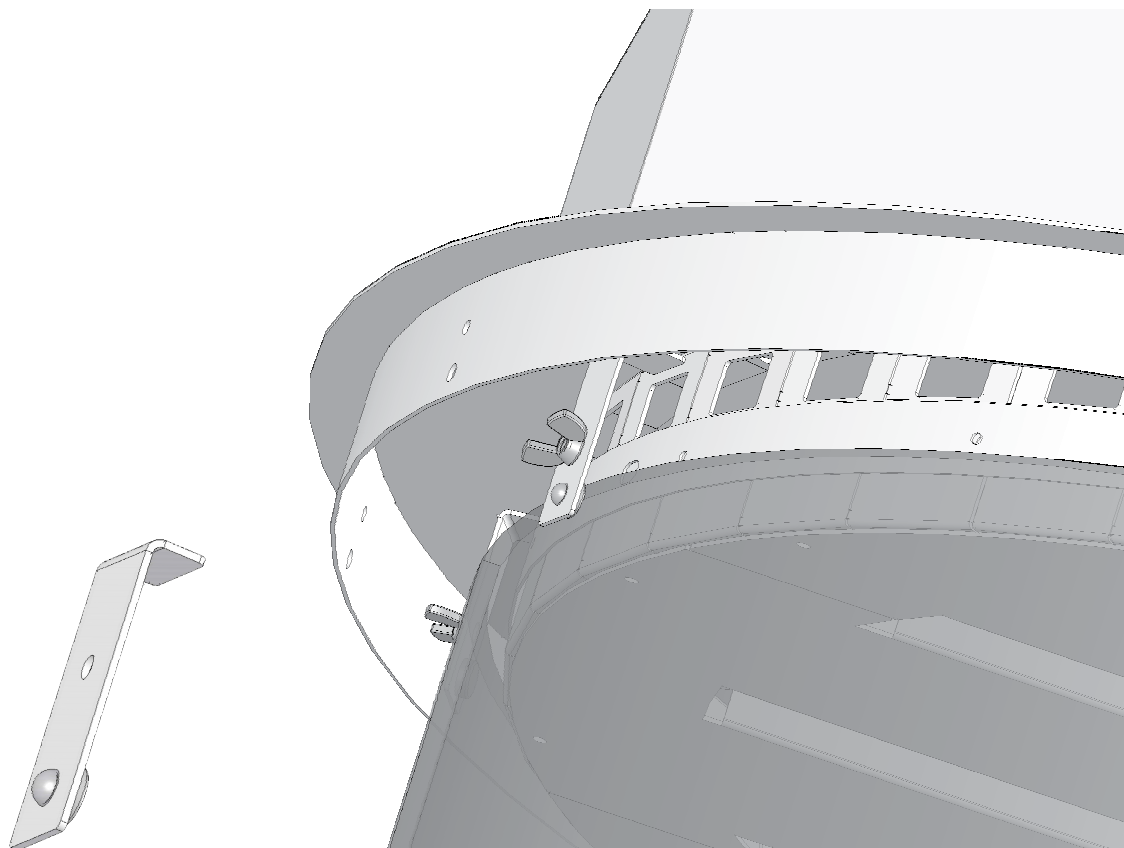

Figure 7.3

Inside Glass & Clip
View - Bottom

Clip

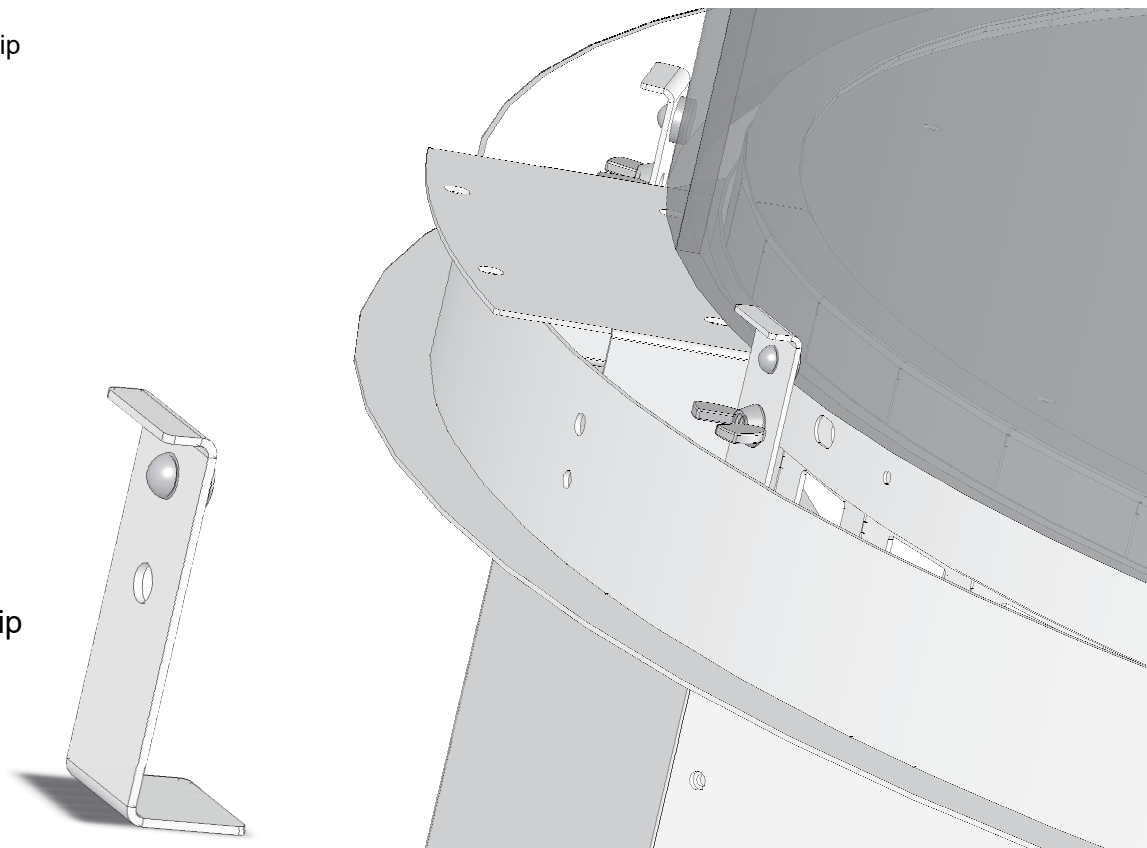

Figure 7.4

7 - GLASS FRAME ASSEMBLY

ROUND GLASS INSTALLATION

Install the lower and upper glass clips with a #8 pan head.

NOTE:

On most models these clips are built into the fireplace. You can skip to the trim ring step.

Clip

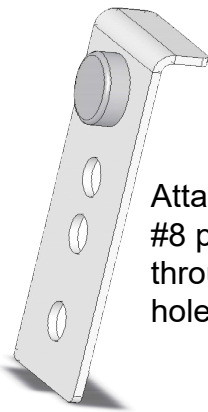

Attach with #8 pan head through this hole.

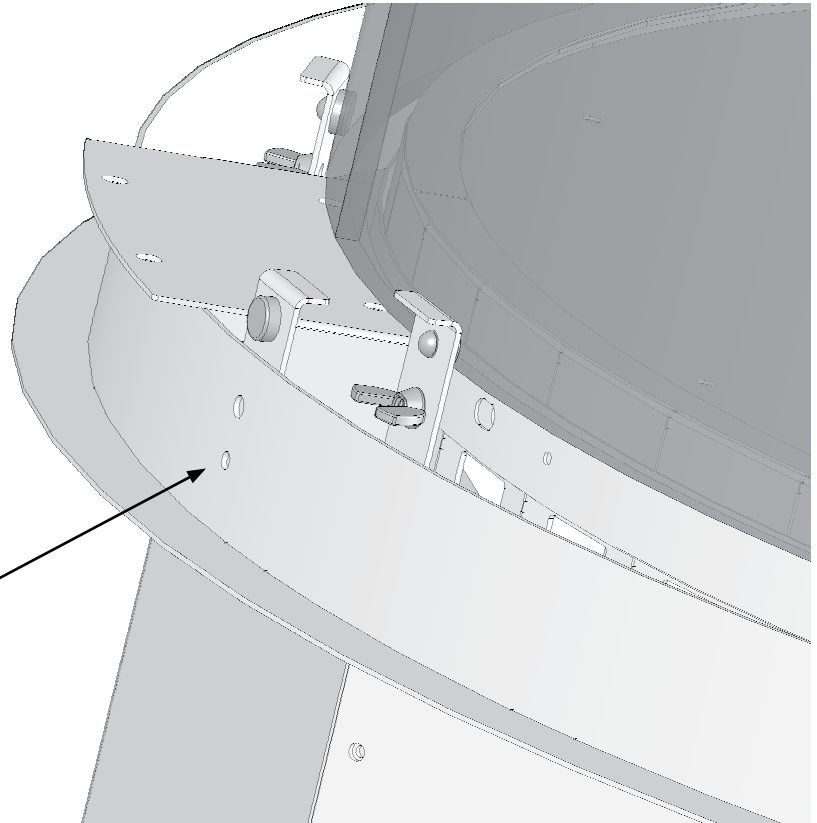

Figure 7.5

Top Inside Glass & Clip
View - Bottom

NOTE:

On most models these clips are built into the fireplace. You can skip to the trim ring step.

Clip

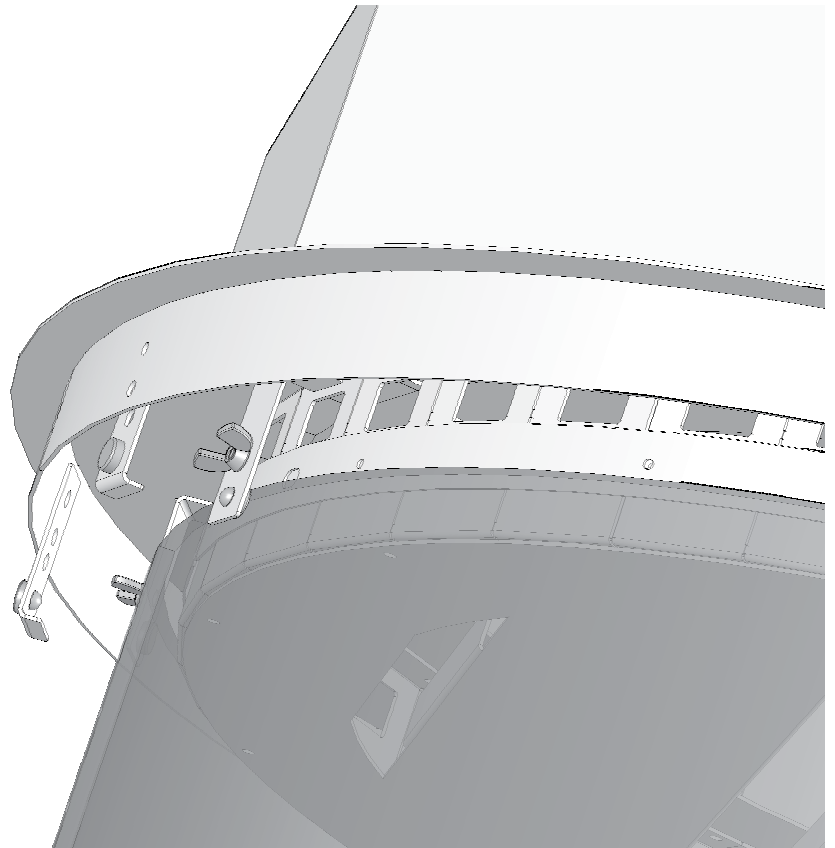
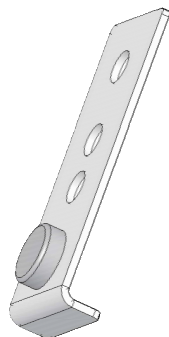

Figure 7.6

7 - GLASS FRAME ASSEMBLY

ROUND GLASS INSTALLATION

Place trim rings between glass on glass supports.

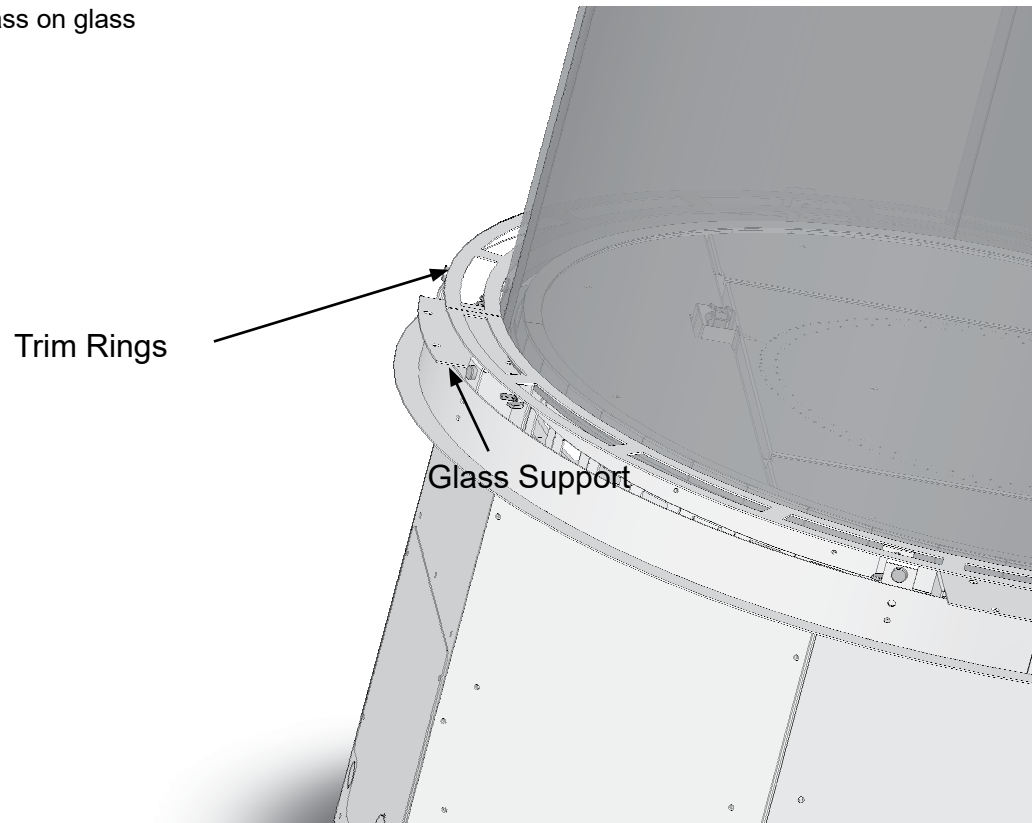

Figure 7.7

Outer Glass - Bottom

Install the outer glass by placing evenly across half of the support with rubber pads.

DON'T LET GO - glass will tip out!

Secure with #8 flat head through magnet. Tighten loosely until pad just touches the glass.

Glass will need adjusting to get last piece installed.

After last piece is installed, gently snug each screw a little at a time going around the fireplace until all are gently holding the glass.

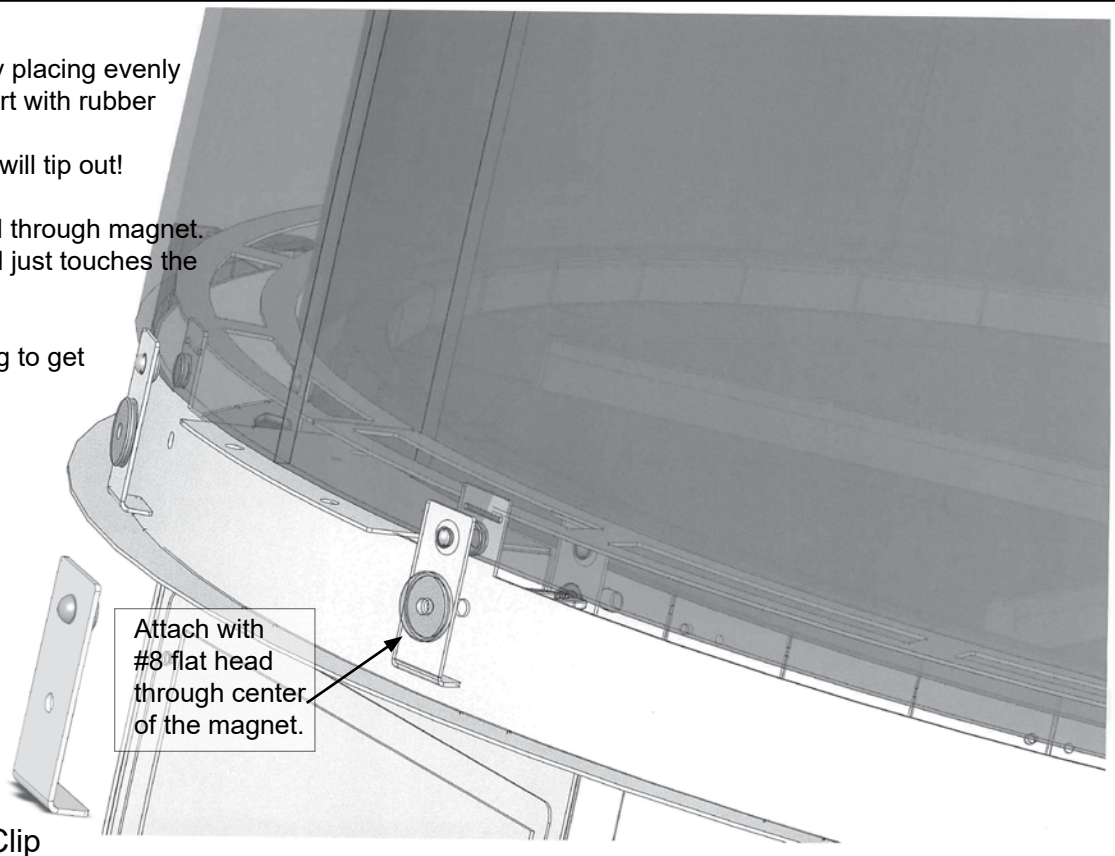

Figure 7.8

7 - GLASS FRAME ASSEMBLY

ROUND GLASS INSTALLATION

Outer Glass - Top

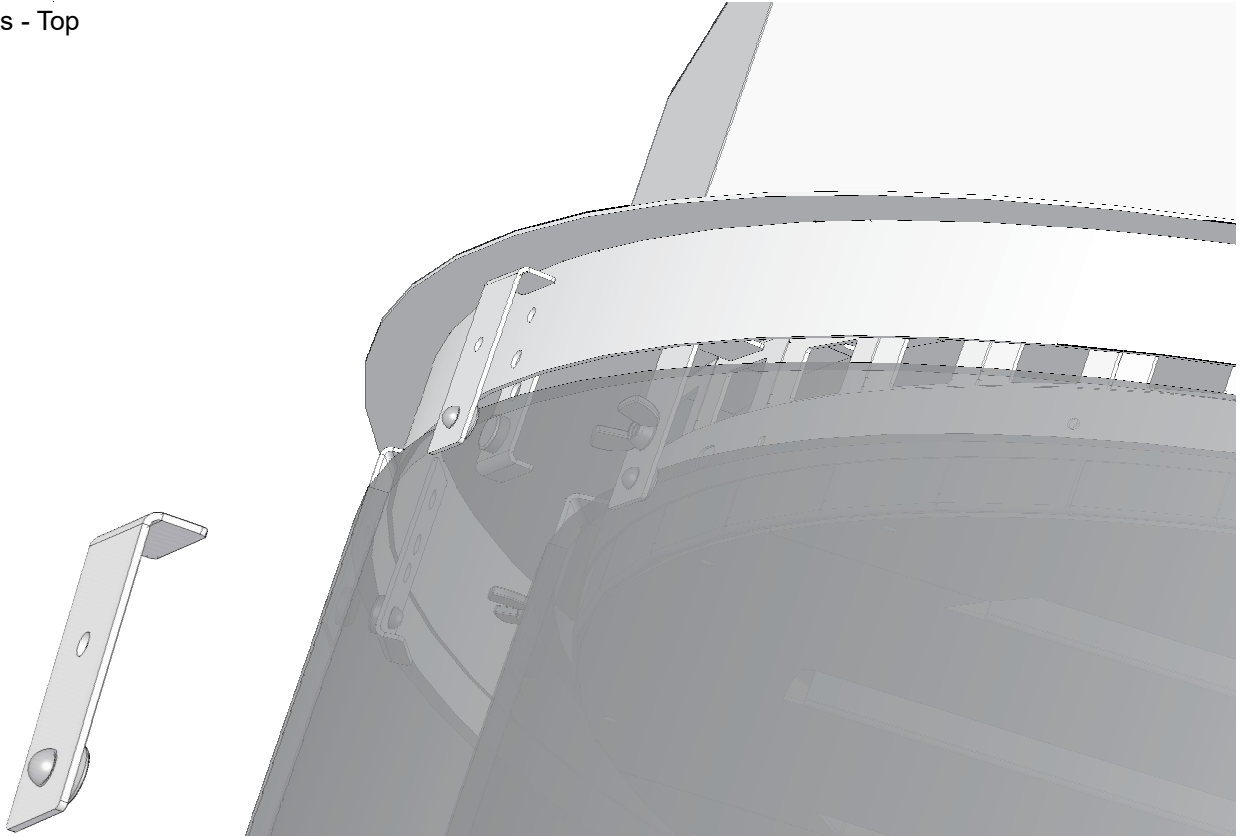

Figure 7.9

Top and Bottom 3" Trim

Install trim bands.

Start by attaching one band across the center of a magnet. Continue around and you will end up at a center of a magnet.

Do the rest of the bands in a similar way.

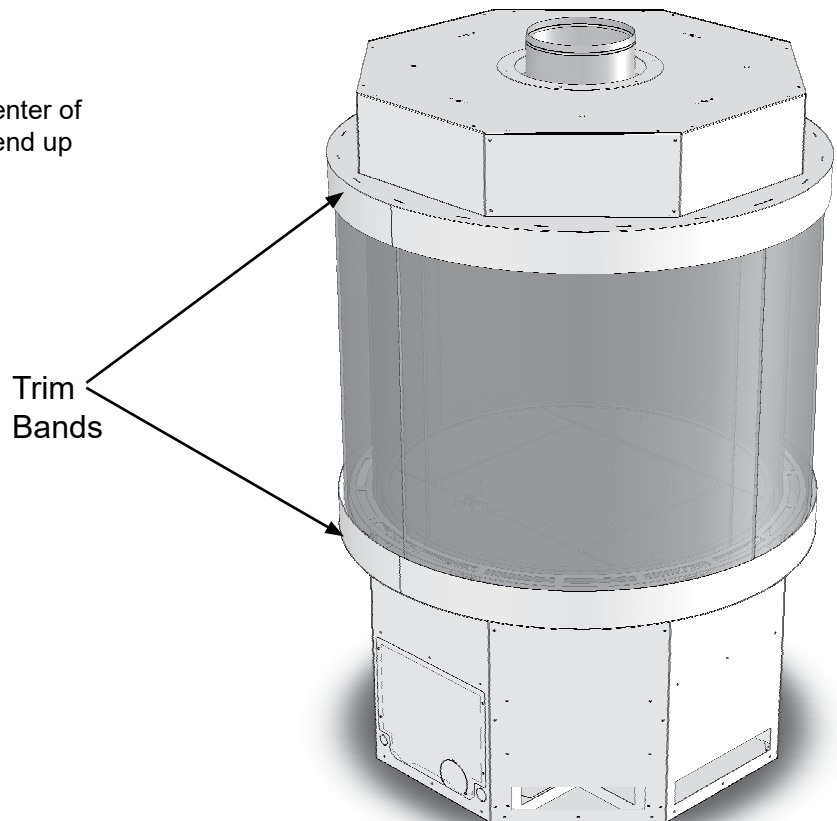

Figure 7.10

8 - GAS LINE SPECIFICATIONS

This fireplace is manufactured for use with Natural or Propane Gas.



CAUTION: Installation of the gas line must only be done by a qualified person in accordance with local building codes, if any. If not, follow ANSI Z223.1.



NOTE: The appliance and its individual shutoff valve must be disconnected from the gas supply piping system during any pressure testing of that system at pressures in excess of ½ psi. (3.5 kPA).



NOTE: The appliance must be isolated from the gas supply piping system by closing its individual manual shut-off valve during any pressure testing of the gas line at test pressures equal to or less than ½ psi (3.5 kPA).



NOTE: For high altitude installations, consult Stellar Hearth Products directly for proper rating methods.

GAS LINE CONNECTION	Propane	NG
MINIMUM INLET GAS PRESSURE	11.0 inches W.C. (recommended)	7.0 inches W.C. (recommended)
MAXIMUM INLET GAS PRESSURE	14.0 inches W.C.	10.0 inches W.C.
MANIFOLD PRESSURE (HI)	10.0 inches W.C.	3.5 inches W.C.
ORIFICE SIZE	(5X) 55	(5X) 43
INPUT BTU/HR	100,000	100,000

NOTE: Have the gas supply line installed in accordance with local codes. If not, follow ANSI Z223.1. Installation should be done by a qualified installer approved and/or licensed as required by the locality. In the Commonwealth of Massachusetts installation must be performed by a licensed plumber or gas fitter.

NOTE: A listed (and Commonwealth of Massachusetts approved) 1/2 in. T-handle manual shut-off ball valve is connected to the 1/2 in control valve inlet.

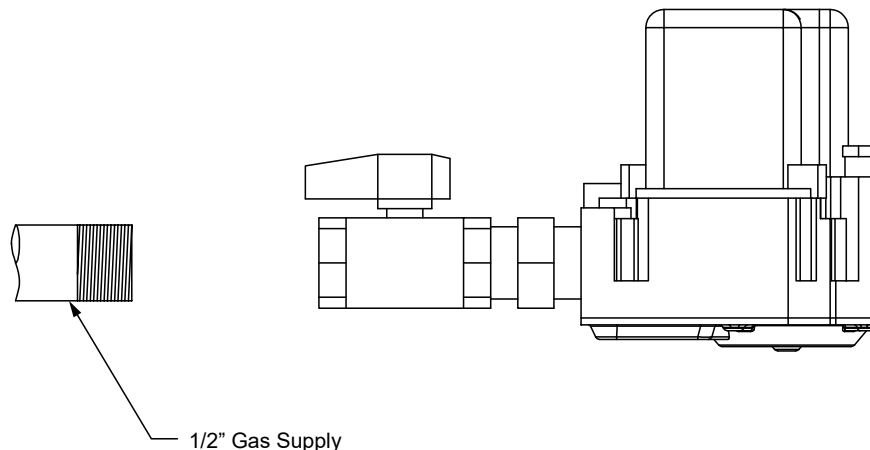

Figure 8

1/2" Gas Supply

9 - VENTING



CAUTION: Consult the local and national installation codes to assure adequate combustion and ventilation air is available.



NOTE: Flame height and appearance will vary depending upon venting configuration and type of fuel used. Venting requirements apply to both Natural and Propane gas.



STOP: MAINTAIN ALL CLEARANCES AS STATED IN THIS INSTALLATION MANUAL.

A. APPROVED VENTING

Model #	DESCRIPTION	B-VENT	OUTSIDE AIR	STANDARD POWERVENT	IN-LINE POWERVENT
3-RD-24-G		10"	10"	RS12	RSIF180
3-RD-36-G		10"	10"	RS12	RSIF180

B. POWERVENT SUPPLY VOLTAGE

POWERVENT MODEL NUMBER	VAC	AMP	H/P
RS12	120	1.2	1/9
RSIF180	120	2.9	3/7

C. SYSTEM SUPPLY VOLTAGE

POWERVENT MODEL NUMBER	VAC	AMPS
RS12	120	3.2
RSIF180	120	4.9

*Amperage listed is the maximum required for the appliance with all options.

Refer to the vent systems manufacturer's installation manual for complete installation instructions. Installation must conform with the venting requirements and restrictions as outlined in this manual. SEE CHART ABOVE FOR SIZE diameter B-Type Venting that must be used. UL/CSA approved B-Vent only. **DO NOT** decrease the vent size.

Vent runs are approved for up to 110 feet with quantity of eleven 90 degree elbows.

Vent runs may also contain a downward component. The downward component may be a maximum of 6 feet plus the distance to the center line of the elbow. See Figure 8A.1. This will be about 87" for 8" diameter pipe and 92" for 10" diameter pipe. Due to natural buoyancy of flue gas products, venting downward increases restriction. Every inch of vertical drop counts as triple inches subtracted off the total vent run.

Example: a maximum drop of 92" means the total allowed vent run is decreased by 276" (23')

Once a downward component has been utilized, the vent cannot go upwards again. Moisture may get trapped in the vent pipe.

Important: Be sure to do your own calculations based on the center line dimension given from the pipe manufacture you are using for your installation.

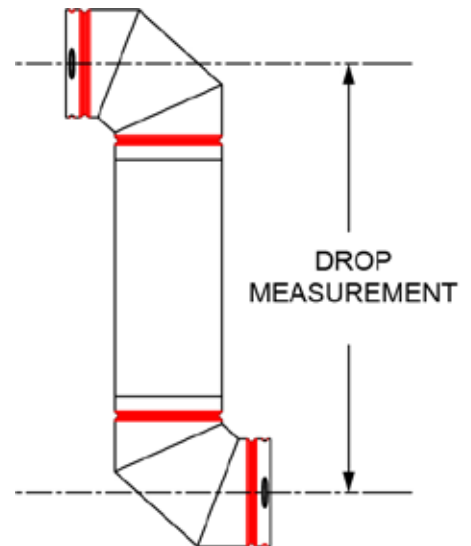

Figure 9A



NOTE: All pipe and elbow joints must be sealed. This includes the longitudinal seam on the pipe. High Temp RTV Silicone and/or foil tape **MUST** be used on each joint/seam. Failure to do so may cause lack of vacuum and may not trigger the vacuum switch.

9 - VENTING

D. RS SERIES POWERVENT SPECIFICATIONS

Available Power Venting

A power vent (RS12 & RS14) is approved for use with this appliance. It is crucial that all B-Vent pipe and elbow joints, and the longitudinal seam are sealed using a high temperature RTV Silicone and/or foil tape.

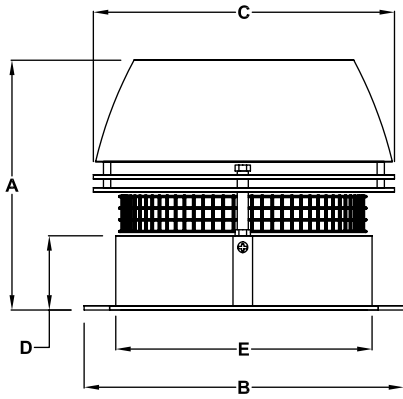

Figure 9D

MODEL	RS12	RS14
Fan Type	Axial vane	Axial vane
Motor Type	Totally enclosed, variable speed, Class F	Totally enclosed, variable speed, Class F
Voltage (VAC)	1 x 120	1 x 120
RPM	1600	1600
CFM	950	1400
Amperage (Amps)	1.2	1.4
Motor Output HP (kW)	1/9 (0.08)	1/7 (0.1)
Weight lbs (kg)	37 (17)	47 (21)
Dimension A in. (mm)	11.5 (292)	13.1 (334)
Dimension B x B in.(mm)	14.3 (364)	16.6 (422)
Dimension C in. (mm)	13.5 (344)	15.5 (395)
Dimension D in. (mm)	3.3 (85)	3.9 (100)
Dimension E in. (mm)	11.6 (294)	13.5 (342)
Temperature Rating-Intermittent	575 °F / 300 °C	575 °F / 300 °C
Temperature Rating-Continuous	482 °F / 250 °C	482 °F / 250 °C

E. CHIMNEY COLLAR DIMENSIONS

Chimney Collar Dimensions

A chimney collar is included for use with the RS12 and RS14. The chimney collar is used to attach the RS power vent.

Figures 9E.1 and 9E.2 show the dimensions of the chimney collar.

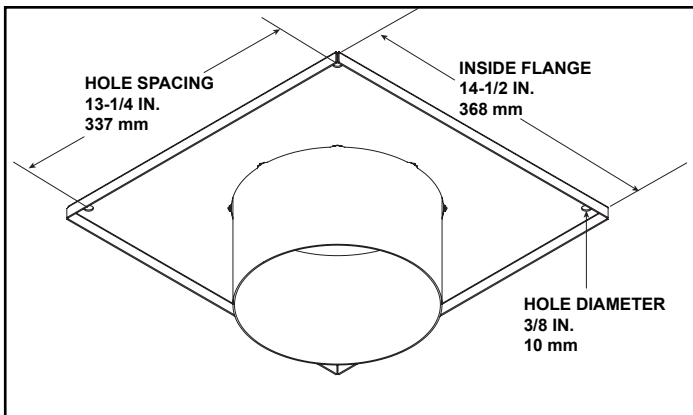

Figure 9E.1 8 Inch Chimney Collar Dimensions (RS12)

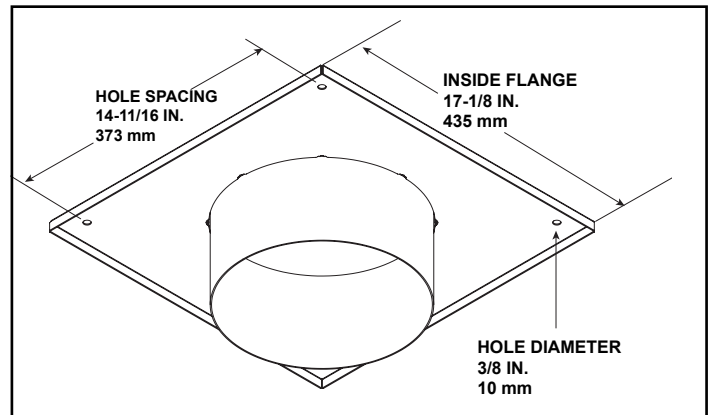

Figure 9E.2 10 Inch Chimney Collar Dimensions (RS14)

9 - VENTING

F. RSIF SERIES POWERVENT SPECIFICATIONS

Available In-Line Power Venting

An in-line power vent (RSIF180 only for the Round) is approved for use with this appliance. It is crucial that all B-Vent pipe and elbow joints, and the longitudinal seam are sealed using a high temperature RTV Silicone and/or foil tape.

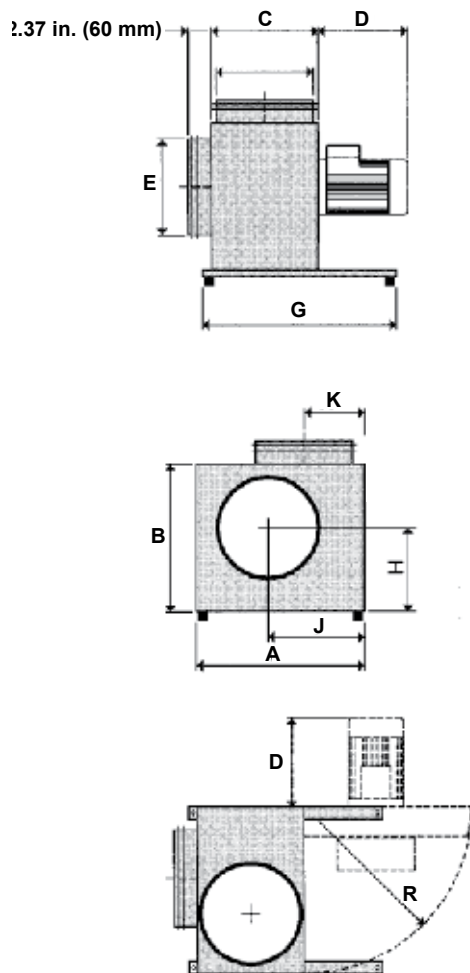

Figure 9F

MODEL		RSIF180
Fan Type		Centrifugal Impeller (F-Wheel)
Motor Type		TEFC
Voltage	(VAC)	1 x 120
Amperage	Amps	2.9
Motor Output	hp (kW)	3/7 (.32)
RPM		1600
Weight	lbs (kg)	38 (17)
Duct Connection (E)	in. (mm)	8 (203)
Dimension A	in. (mm)	14.57 (370)
Dimension B	in. (mm)	12.60 (320)
Dimension C	in. (mm)	9.26 (235)
Dimension D	in. (mm)	5.52 (140)
Dimension E	in. (mm)	7.9 (200)
Dimension G	in. (mm)	15.75 (400)
Dimension H	in. (mm)	7.10 (180)
Dimension J	in. (mm)	8.27 (210)
Dimension K	in. (mm)	5.12 (130)
Dimension R	in. (mm)	14.57 (370)

G. IN-LINE POWERVENT PREPARATIONS- RSIF 180

Perform the following steps when installing the RSIF180.

1. Attach the provided 10 inch B-Vent collar to the intake side of the powervent. The intake side is located opposite the fan motor as shown in Figure 9G.1. The 10 inch B-Vent collar is packaged separately from the powervent. See Figure 9G.2.
2. Note the silhouette circle printed on the intake side of the powervent. The pre-drilled screw holes within the circle will be matched with the holes on the intake collar of the base plate. See Figure 9G.3.
3. Place the intake collar base plate onto the silhouette, matching up the holes as shown in Figure 9G.4. Fasten the base plate to the silhouette using five self-tapping screws.
4. Add the rope gasket included with the kit to the outlet side of the in-line powervent.
5. An adapter to increase from eight inch pipe to ten inch pipe is required on the outlet side of the in-line powervent. The adapter is included in the RSIF180 kit. See Figure 9G.5. Connect the adapter directly to the eight inch outlet collar of the in-line powervent. Connect the ten inch exhaust B-Vent to the collar and continue the vent run.

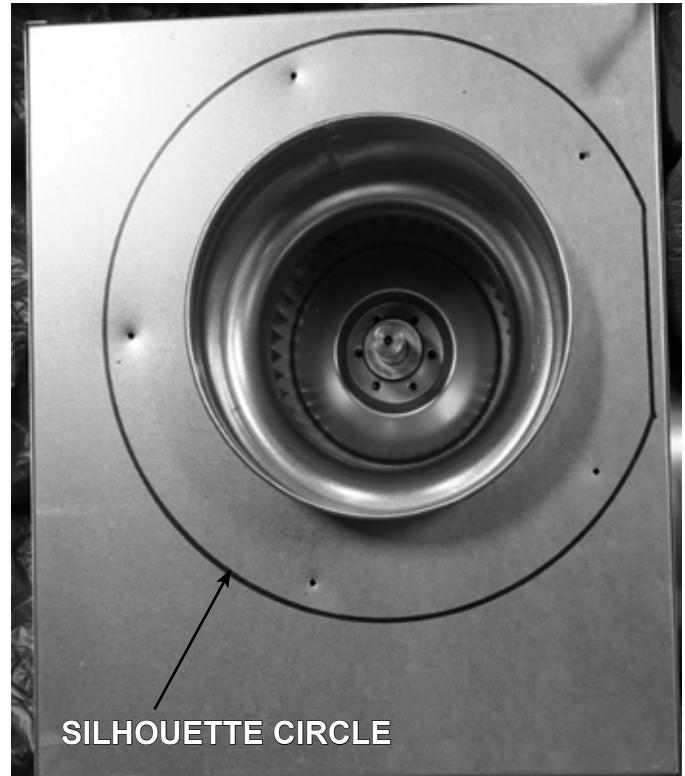

Figure 9G.3 Silhouette Circle on Intake

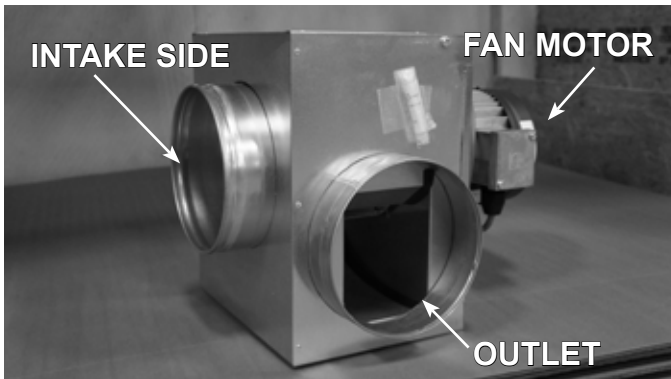

Figure 9G.1 In-Line Powervent (RSIF180)

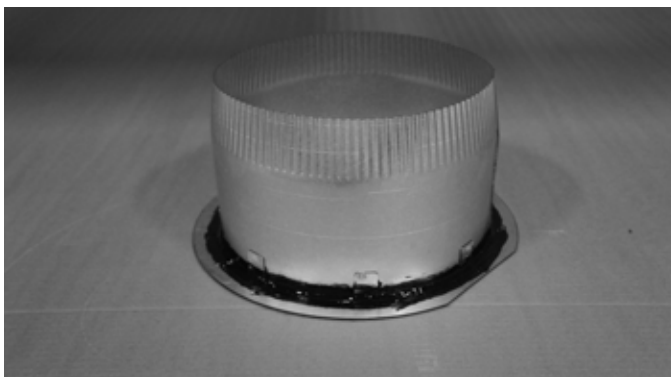

Figure 9G.2 Ten Inch B-Vent Collar

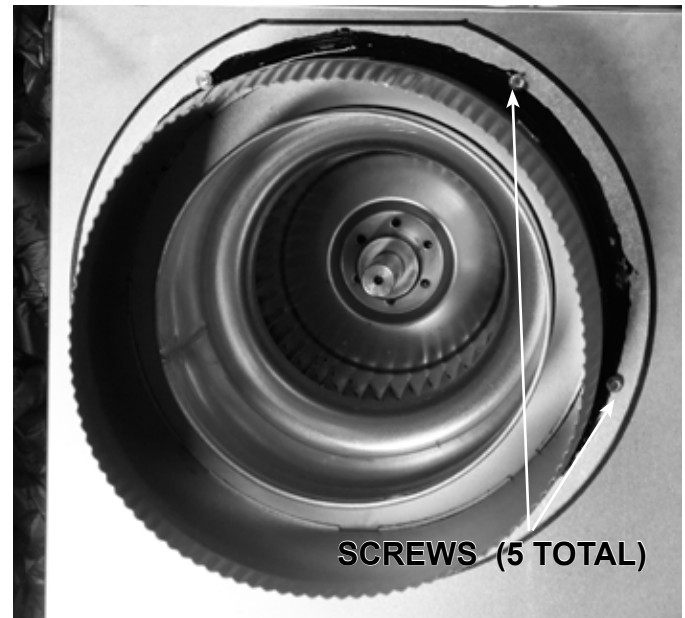

Figure 9G.4 Base Plate Fastened to Intake



Figure 9G.5

9 - VENTING

H. HORIZONTAL VENT SYSTEM CLEARANCES

ALL APPROVED VENTING	TOP	BOTTOM	SIDES
HORIZONTAL	1 inch [25mm]	1 inch [25mm]	1 inch [25mm]

I. WALL PASS-THROUGH - Follow all local codes for requirement of firestops.

8 - VENTING

J. PITOT TUBE INFORMATION (NA for Round)

9 - VENTING

K. VERTICAL TERMINATIONS

- The fireplace must terminate with the included approved powered termination cap.
- **NO SUBSTITUTION IS ACCEPTABLE.**
- Carefully follow the instructions included with the approved powered termination cap.
- **DO NOT** use an additional speed control on this powervent.
- You must use the included Capacitor.

L. HORIZONTAL TERMINATION VENT CAP LOCATION & CLEARANCES

This gas appliance must not be connected to a chimney serving any other appliance.

- **DO NOT RECESS TERMINATION KIT INTO OUTSIDE BUILDING MATERIALS** - i.e.: brick, stone, siding, etc. If necessary, extend framing so that termination kit will be exposed once building materials are installed.
- Vent termination must not be located where it will become plugged by snow or other material. The flow of combustion and ventilation air must not be obstructed.

LOCATION CLEARANCES:

- A. Above grade, veranda, porch, deck, balcony - 12 inches [305 mm].
- B. Operable window or door - 12 inches [305 mm]; 48 inches [1219 mm] required for non-direct vent appliances using room air.
- C. Permanently closed window* - 12 inches [305 mm] (recommended to prevent condensation on window).
- D. Ventilated soffit* - 24 inches [610 mm].
- E. Unventilated soffit* - 12 inches [305 mm].
- F. Outside corner* - 6 inches [152 mm].
- G. Inside corner* to non-combustibles - 12 inches [305 mm]. Inside corner* to combustibles - 24 inches [610 mm].
- H. Meter / Regulator: Not to be installed above a gas meter/regulator assembly within 3 ft. [914 mm] horizontally from the center-line of the regulator.
- I. Gas Service regulator vent outlet - 3 ft. [914 mm].
- J. Non-mechanical air supply inlet to building or the combustion air inlet to any other appliance.
US: 9" [229 mm] CANADA: 12 inches [305 mm].
- K. Mechanical air supply inlet.
US: 3 ft. [914 mm] above if within 10 ft. [3.05 m] horizontal. Massachusetts installations: 10 ft. [3.05 m].
CANADA: 6 ft. [1.83 m].
- L. Above paved side-walk or paved driveway located on public property - 7 ft. [2.13 m].
- M. Under veranda, porch, deck, or balcony [must be fully opened on a minimum of 2 sides] - Combustible - 24 inches [610 mm],
Non-Combustible - 12 inches [305 mm].
- N. Between two horizontal terminations - 12 inches [305 mm]. (Not shown in Figure 9L).
- O. Between two vertical terminations - 12 inches [305 mm]. Terminations may be same height (Not shown in Figure 8I).
N & O: Minimum of 12 inches [305 mm] required when two exhaust termination caps are placed next to each other. Measurement must be taken from inside edge of one steel chimney adapter to the inside edge of the other steel chimney adapter. A metal divider plate with same length and height as termination cap is required to be installed between the caps. Divider plate is not required if caps are at least 24 inches [610 mm] apart, measured edge to edge.
- P. Above furnace exhaust or inlet - 12 inches [305 mm]. (Not shown in Figure 9I).

*Clearance must be in accordance with local installation codes & the requirements of the gas supplier.



NOTE: A vent cannot be located directly above a side-walk or paved driveway that is located between two single family dwellings and serves both dwellings.

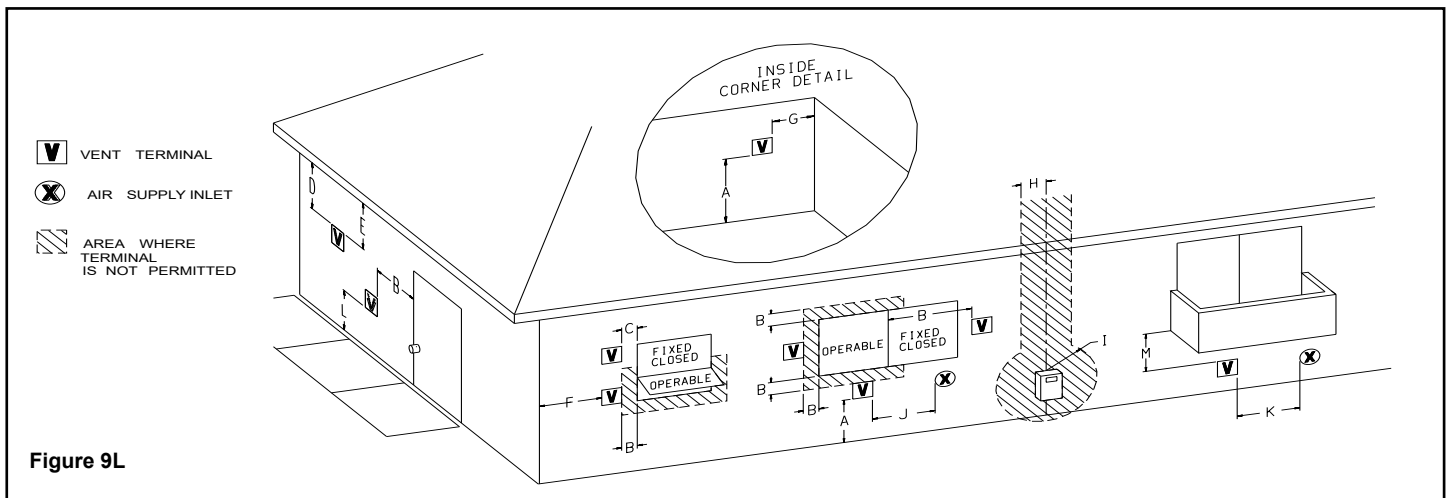
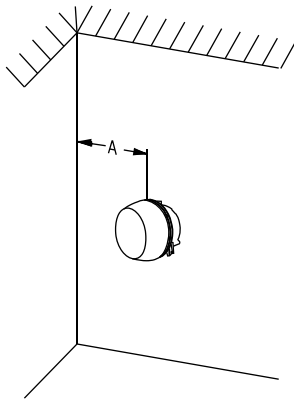

Figure 9L

9 - VENTING

M. HORIZONTAL TERMINATION VENT CAP LOCATION & CLEARANCES

Inside Corner



A = Combustible 24" (609.6mm)
= Non-combustible 12" (304.8mm)

Outside Corner

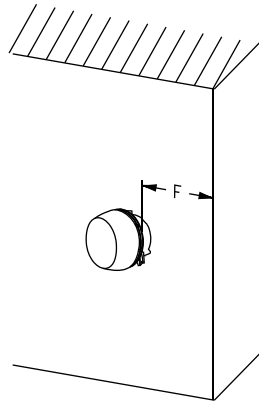

F = Combustible 6" (152mm)
= Non-combustible 6" (152mm)

Recessed Location

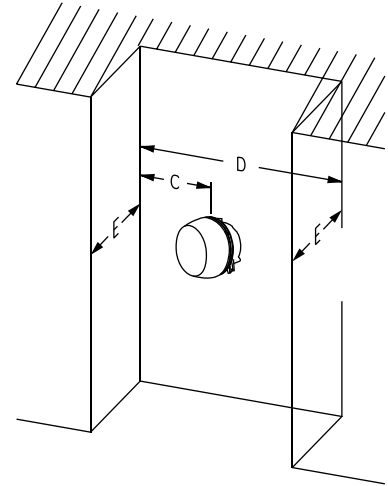

C = Clearance from corner in recessed location
= Combustible 24" (609.6mm)
= Non-combustible 12" (304.8mm)

D = Minimum width for back wall of a recessed location
= Combustible 64" (1,625.6mm)
= Non-combustible 40" (1,016mm)

E = Maximum depth of 48" (1,219mm) for recessed location

Balcony with perpendicular side wall

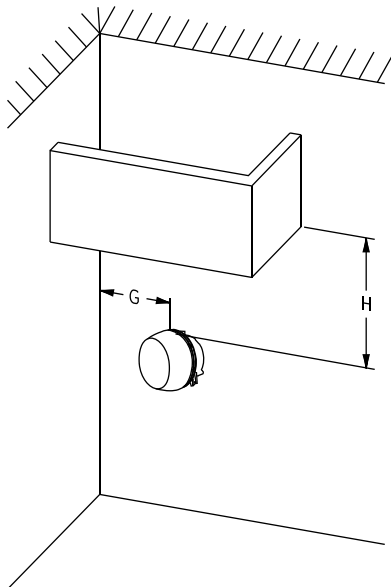

G = Combustible 24" (609.6mm)
= Non-combustible 12" (304.8mm)

H = Combustible 24" (609.6mm)
= Non-combustible 12" (304.8mm)

Balcony with no side wall

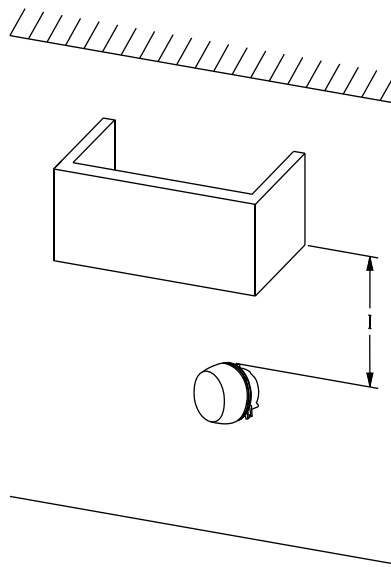

I = Combustible 24" (609.6mm)
= Non-combustible 12" (305mm)

IMPORTANT:
All dimensions are from the edge of the cap.

NOTE: Vinyl sided needs additional clearanced. Add 12" (305mm) to combustible clearances for vinyl siding.

Figure 9M

9 - VENTING

N. POWERVENT AND AIR-INTAKE PLACEMENT CLEARANCES

RS SERIES POWERVENT

X = Intake
PV = Vent

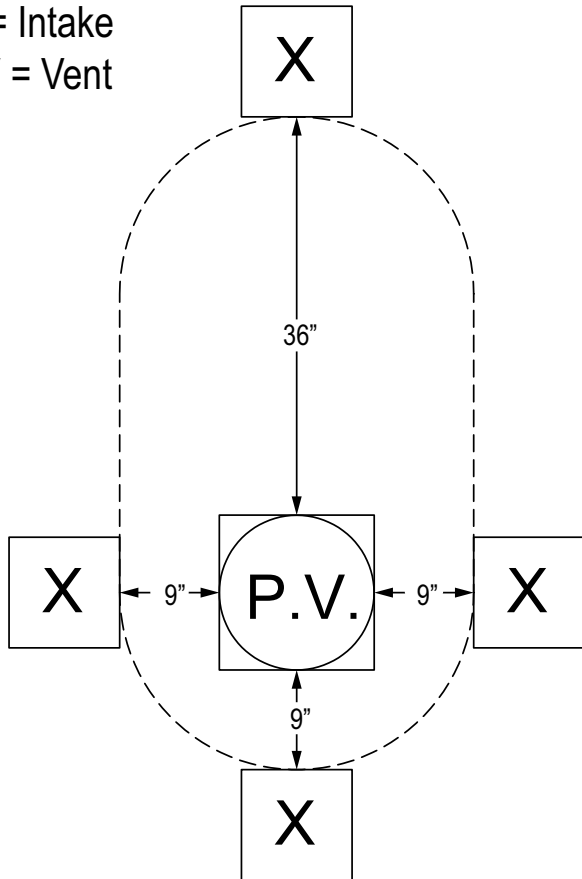

Minimum Clearance Using a RS Series Powervent
Intake Placed Above Vent = 36"
Intake Place To Left Side, Right Side or Below Vent = 9"

Figure 9N.1

IN-LINE POWERVENT (LOUVER 8/10)

X = Intake
PV = Vent

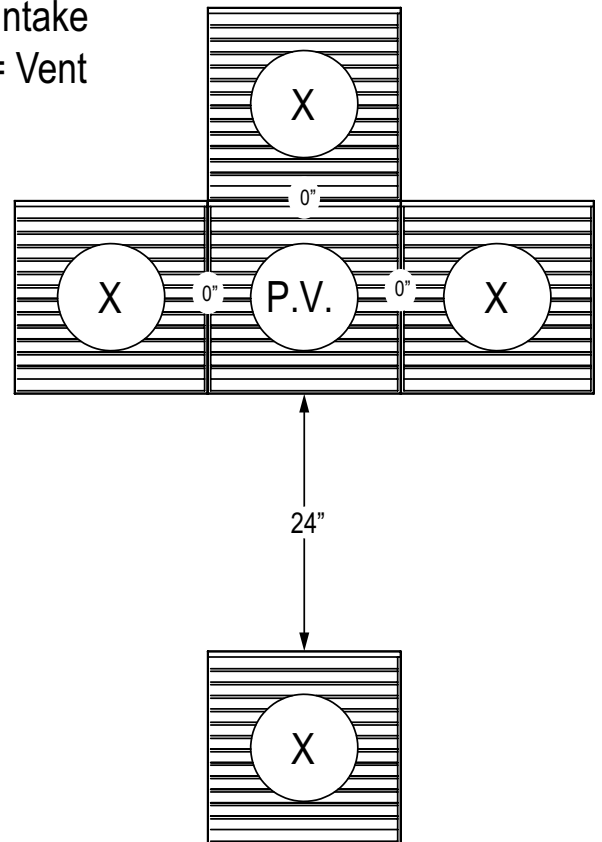

Minimum Clearance Using an In-Line Powervent
Intake Placed Below Vent = 24"
Intake Place To Left Side, Right Side or Above Vent = 0"

Figure 9N.2

9 - VENTING

O. VERTICAL VENT CAP LOCATION AND CLEARANCES

ROOF PITCH	H (Min.) Ft.	H (Min.) M.
FLAT TO 6/12	1.0*	0.30
OVER 6/12 TO 7/12	1.25*	0.38
OVER 7/12 TO 8/12	1.5*	0.46
OVER 8/12 TO 9/12	2.0*	0.61
OVER 9/12 TO 10/12	2.5*	0.76
OVER 10/12 TO 11/12	3.25*	0.99
OVER 11/12 TO 12/12	4.0	1.22
OVER 12/12 TO 14/12	5.0	1.52
OVER 14/12 TO 16/12	6.0	1.83
OVER 16/12 TO 18/12	7.0	2.13
OVER 18/12 TO 20/12	7.5	2.27
OVER 20/12 TO 21/12	8.0	2.44

* = 3 foot minimum in snowy regions

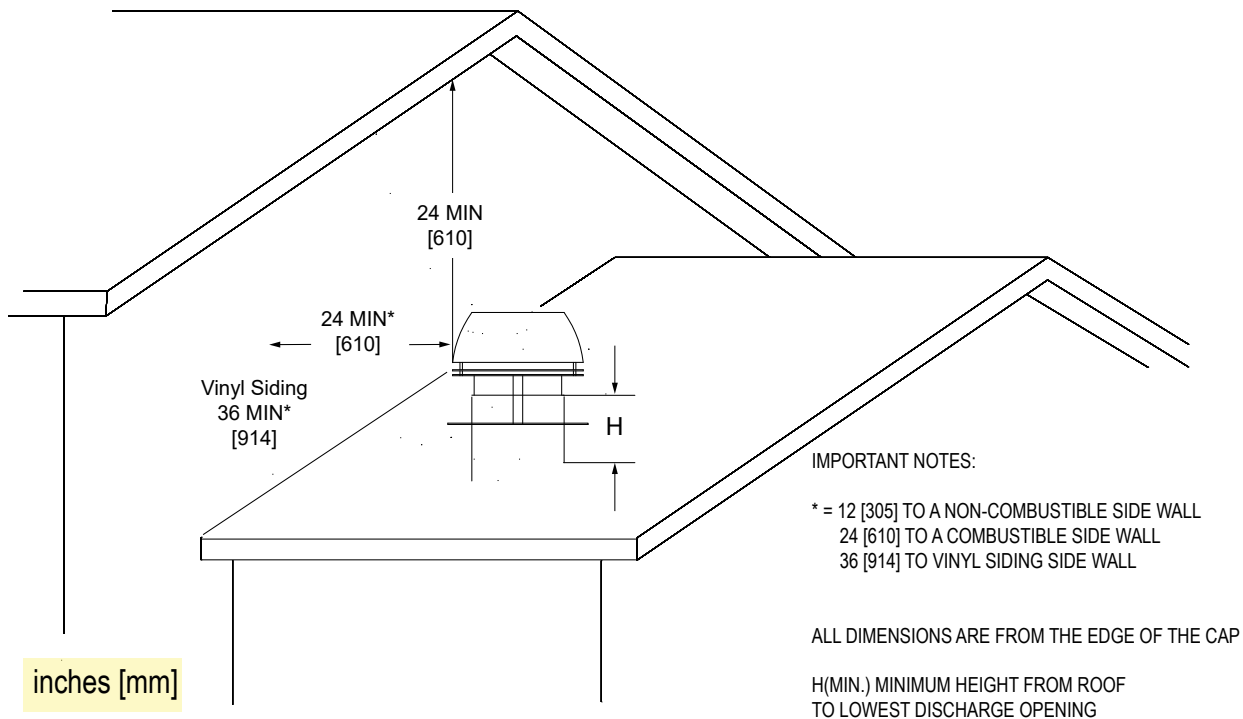

Figure 90

9 - VENTING

P. ROOF TERMINATION CAP INSTALLATION - WITH AND WITHOUT DAMPER

Roof Termination Without Optional Mechanical Damper

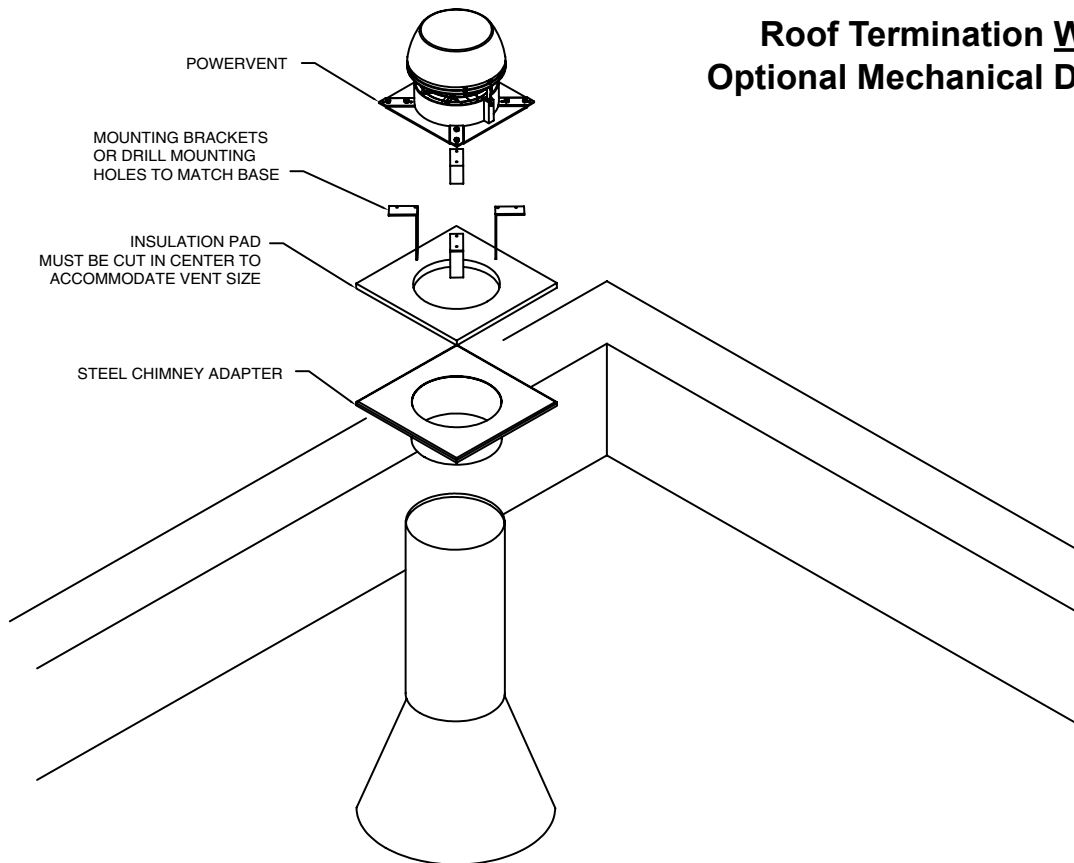

Figure 9P.1

Roof Termination With Optional Mechanical Damper

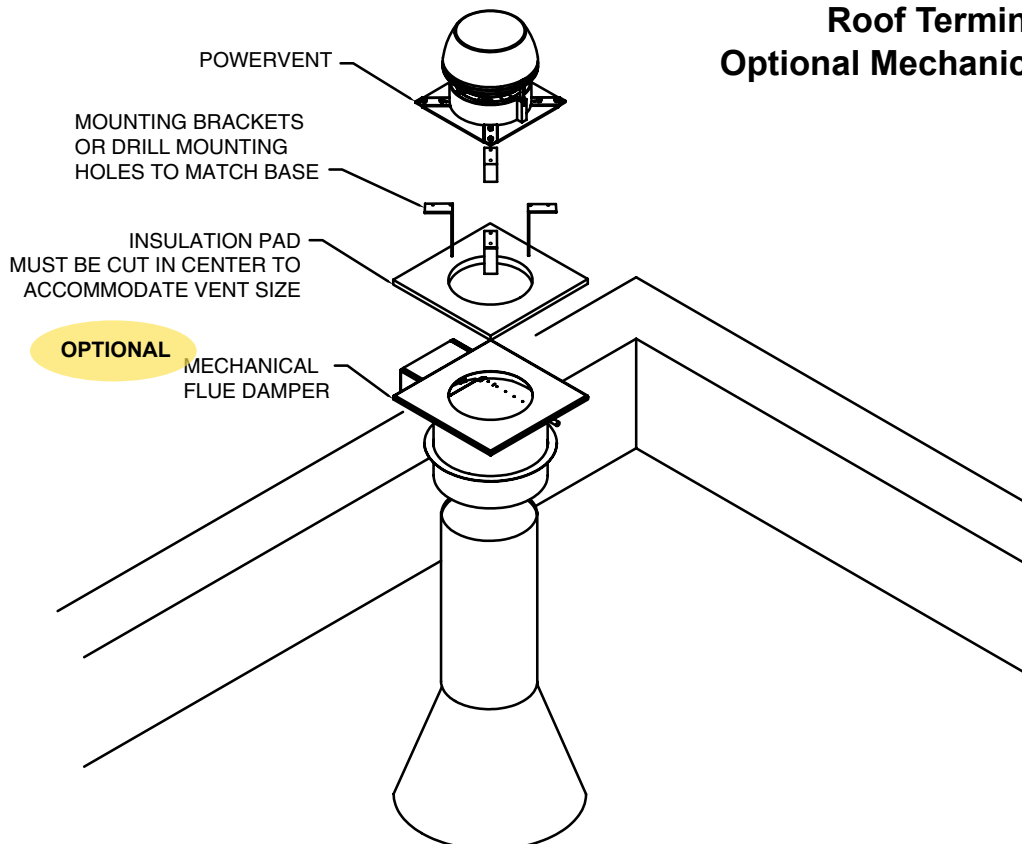

Figure 9P.2

9 - VENTING

Q. WALL TERMINATION - WITH AND WITHOUT DAMPER

Wall Termination Without Optional Mechanical Damper

FRAMING:

8" = 11-3/4" W X 11-3/4" H

10" = 13-1/4" W X 13-1/4" H

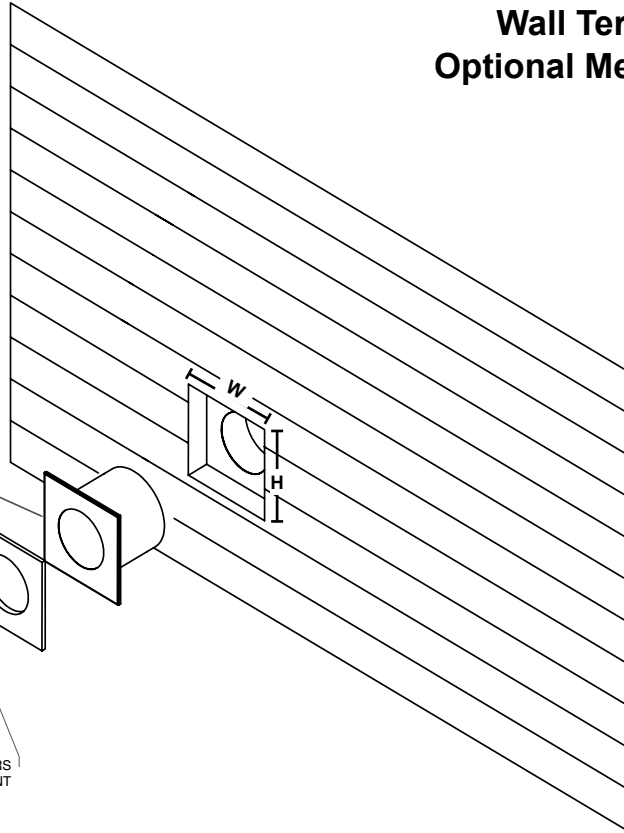
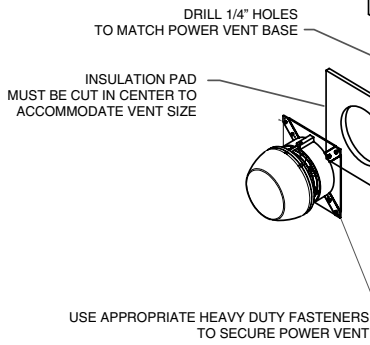
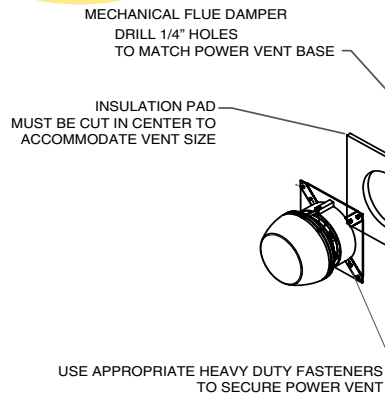

Figure 9Q.1

Wall Termination With Optional Mechanical Damper

OPTIONAL



ACCESS PANEL NEEDED FOR FUTURE DAMPER SERVICE

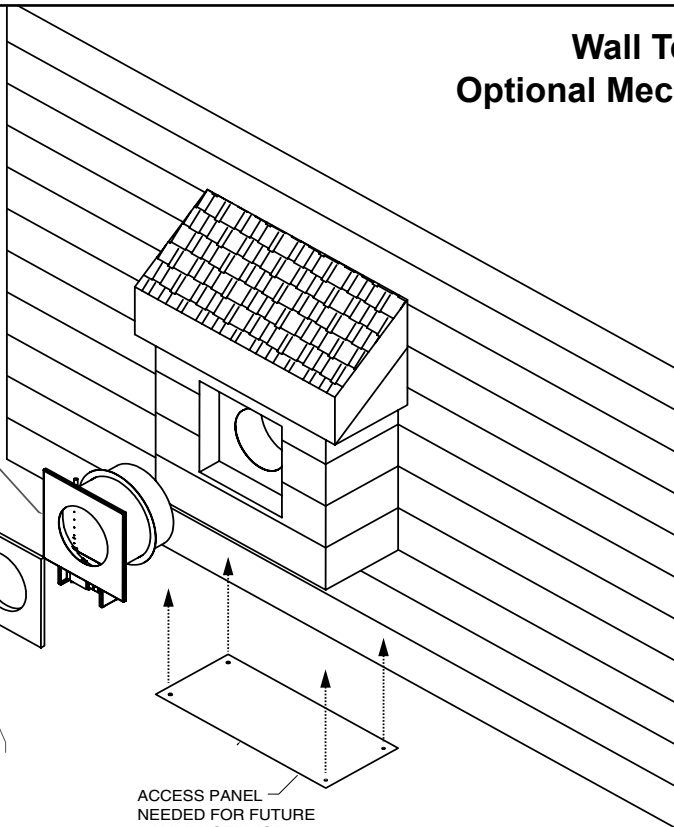

Figure 9Q.2

9 - VENTING

R. OUTDOOR AIR INTAKE

This fireplace has an air intake at the bottom of the fireplace.

The collar is not shipped in place. See assembly instructions below.

This fireplace is approved for use with 10 inch rigid metal pipe or UL approved 10 inch Class 0 or Class 1 flex for intake air.

Use Table 9R.1 for venting requirements if using UL approved 10 inch flex for intake air.

Vent runs utilizing 10 inch rigid metal pipe may be 110 feet with 11 elbows. We recommend insulating the intake air duct or using UL approved Class 1 insulated flex in hot, humid or cold climates.

The intake pipe must maintain 1.5X the square inches of the flue pipe in free area. Intake screen/vent must be sized appropriately.

Failure to do so will result in higher operating temperatures.

The fireplace may also take room air for combustion. Intake screen/vent must be sized appropriately. You must plan for the replacement air that is consumed from the room by the fireplace. Do not draw intake air from a crawl space or an attic (ventilated or not ventilated). If room air is used for combustion, the product does not meet the definition of a DIRECT VENT APPLIANCE. Consult local codes for the impact on the installation in this case.

WARNING! Risk of Fire! DO NOT draw intake air from an attic or crawl space. Appliance could overheat.

Use Table 9R.2 for reference on CFM replacement air if drawing intake air from inside the house and open air requirements for intake screen/vent or consult Hearth & Home Technologies for more information.

Recommended to prop the fireplace up off the floor at least 2.5".

You have to make sure there is 78 sq. inch of area in a pathway, intake grill, toe-kick breather, etc. to get under the fireplace.

Figure 9R.1						
UL Approved Class 1, 10 Inch Insulated Flex Intake Air Venting Requirements						
		Number of Offsets FEET [METERS]				
Fireplace Size	Length Of Run Feet	0-3	4	5	6	7
3'		45 [13.7]	35 [10.7]	25 [7.6]	15 [4.6]	5 [1.5]

Figure 9R.2		
CFM Replacement Air		
Fireplace Size	Required CFM	Open Air Requirement
3'	800 CFM	78 Sq. Inches



NOTE: GLASS TEMPERATURES

Stellar fireplaces use large amount of outside air for combustion and to cool the viewing glass.

When operating the fireplace in the summer, the incoming air will be warmer therefore the glass will be warmer.

When operating the fireplace in the winter, the glass will be cooler. This is not a safety concern, but something to note.



POWERVENT AND AIR-INTAKE CAP PLACEMENT CLEARANCES

For horizontal installation clearances refer to *Section 8 - Venting (K, L & M)*.

For vertical installation clearances refer to *Section 8 - Venting (J, N, O & P)*.

9 - VENTING

S. OUTDOOR AIR INTAKE COLLAR ASSEMBLY

Carefully tip the base over and attach the collar to the bottom of the fireplace.

Use two people to lift the base up and into place.

Do not sit base down on the collar.

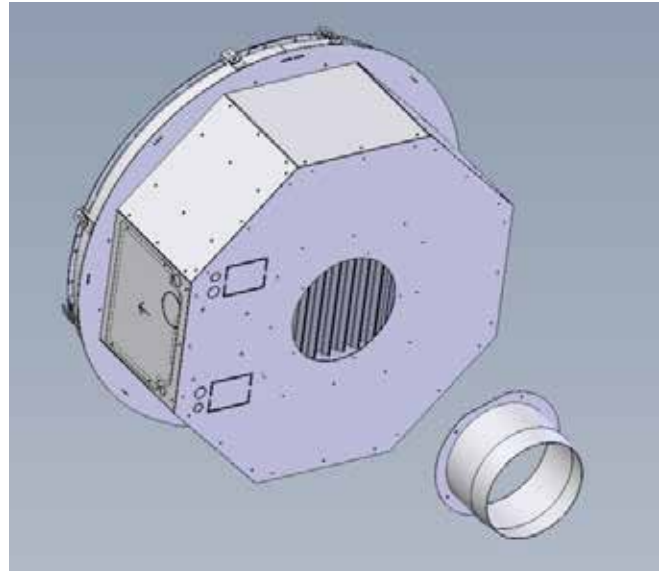

Figure 9S

T. OPTIONAL UNIVERSAL EXHAUST IN AIR-INTAKE LOUVER

MODEL	UNITS	USE
LOUVER-10		Exhaust and Air-Intake



Figure 9T.1

This kit is an optional method of terminating the fresh air and/or exhaust for the appliance.

Exhaust terminations must be installed with an in-line powervent.

**FOLLOW COMPLETE
INSTALLATION INSTRUCTIONS
PROVIDED WITH THE LOUVER KIT**

LOUVER-10

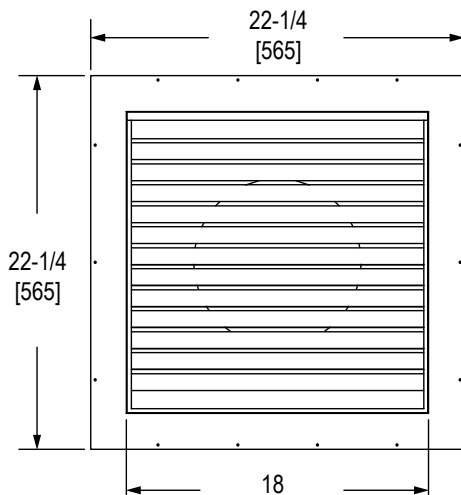

Figure 9T.2

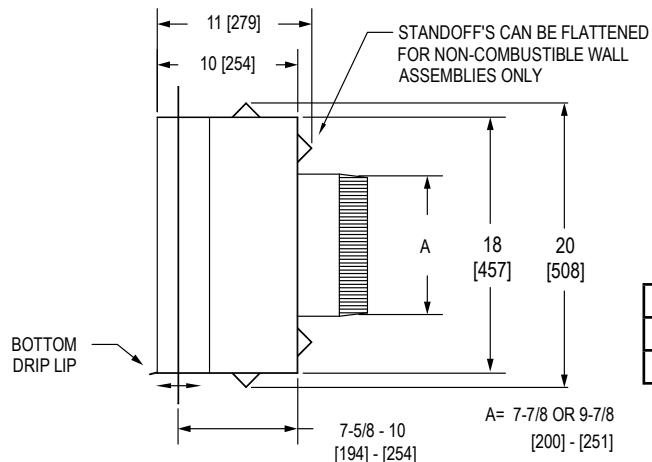

Figure 9T.3

	A
LOUVER-8	7-7/8 IN.
LOUVER-10	9-7/8 IN.

10 - ELECTRIC

A. PDS-1 INSTALLATION - MUST BE INSTALLED



NOTE: The four sided fireplace utilizes an external draft switch (PDS-1). This needs to be installed at the time the venting is installed. The installation instructions are included in the box with the PDS-1 kit. Please read fully prior to installation. Additional wiring information can be found on Page 38-39.

PDS-1 Proven Draft Switch Complete Installation Instructions Provided In The PDS-1 Box

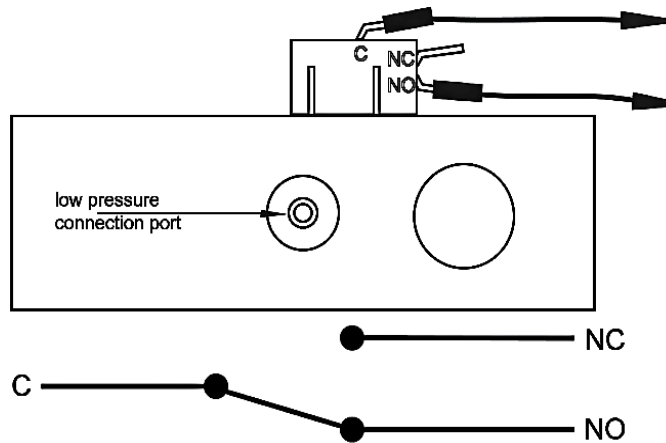
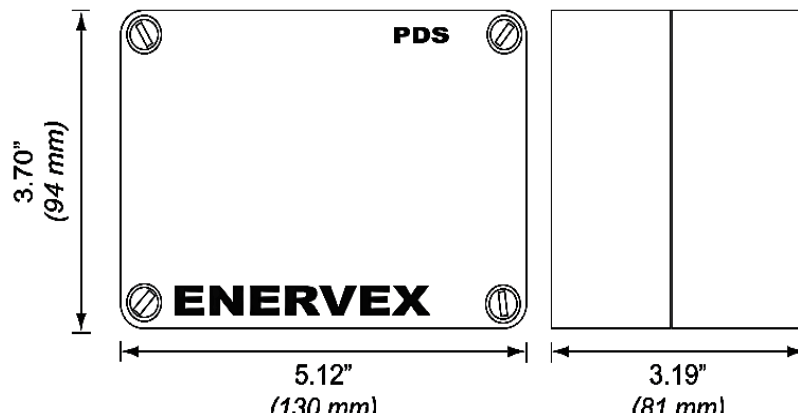

Figure 10A

10 - ELECTRIC

GENERAL

The PDS 1 is for indoor installation only. The PDS 1 must be installed in a vertical position with the pressure connection pointing down. Secure the switch by using the mounting holes as shown on the figure. After installation connect the tubing from the probe onto the port marked accessible through the small of the plastic enclosure. Connect tubing to the NEGATIVE (-) port on the PDS.

Factory wiring comes with three wires that are already crimped onto the PDS. The purpose of these wires is to provide a point in which you can extend the length of the wire by using wire nuts and additional wire (not provided).

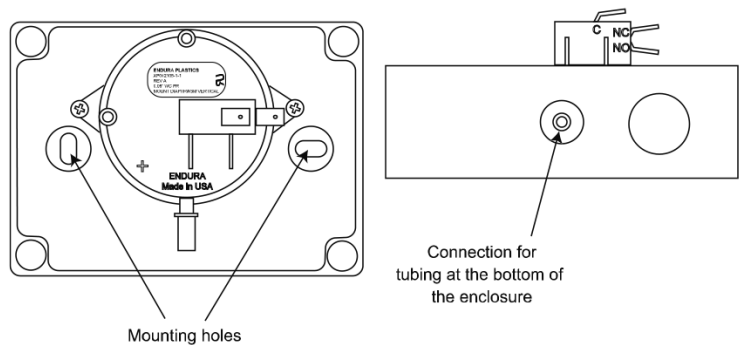

Figure 10A.2

INSTALLATION OF STACK PROBE FOR PDS 1

A stack probe is used with ENERVEX Proven Draft Switches (PDS). The PDS 1 monitors the pressure inside the stack and signals the control to shut down the appliance if insufficient draft exists inside the stack. The probe must be installed between the appliance and the exhaust fan.

If a flue damper is used, the probe must be between the appliance and the flue damper.

For all installations, the stack must be placed so the flow through the stack is perpendicular to the tip of the probe. Locate the probe at least the distance "A" away from any elbows or tees in the stack. The distance "A" is defined as at least three (3) vent diameters; $A \geq 3 * V$ (see figure below). To prevent condensation from entering the probe or PDS when installed on a horizontal stack, the probe must be installed above the centerline of the stack. For fireplace installations, the stack probe should be installed as close to the exhaust fan as possible.

For the PDS to function properly, the probe must be placed in a location that can produce at least 0.05 in WC in the stack. In order to produce an accurate pressure reading, the tip of the probe must be mounted flush with the inside of the stack wall (it should never extend more than 1/16" beyond the wall). For a double walled stack, the tip should be flush with the inner most wall.

To mount the probe, drill a 1/4" clearance hole through the stack wall(s). Insert the probe and attach the bracket to the stack using (2) custom provided self-tapping machine screws. Tighten the end cap to compress the ferrule and permanently install the stack probe. Attach the supplied silicon tubing at the other end of the probe.

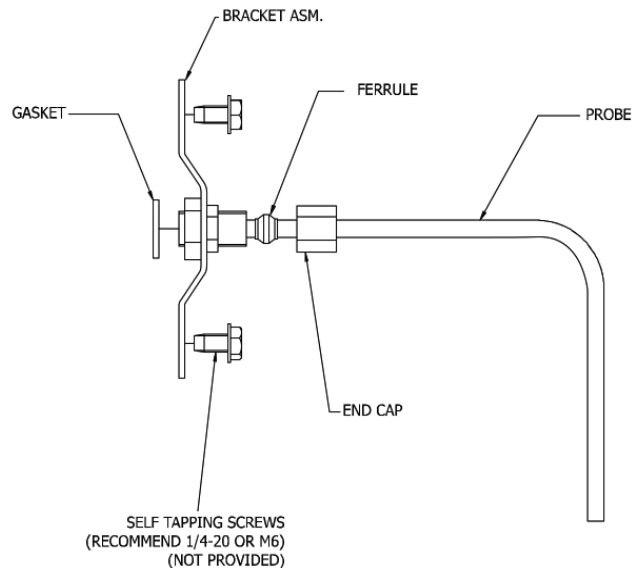

Figure 10A.3

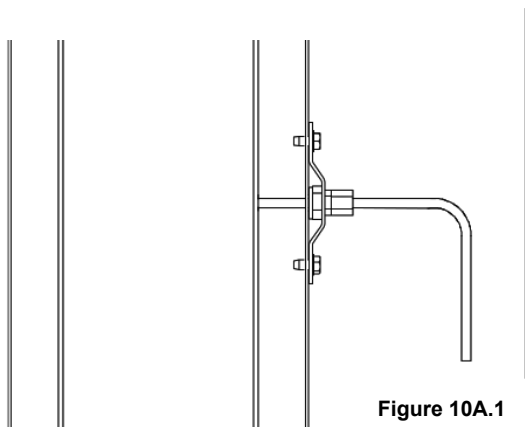

Figure 10A.1

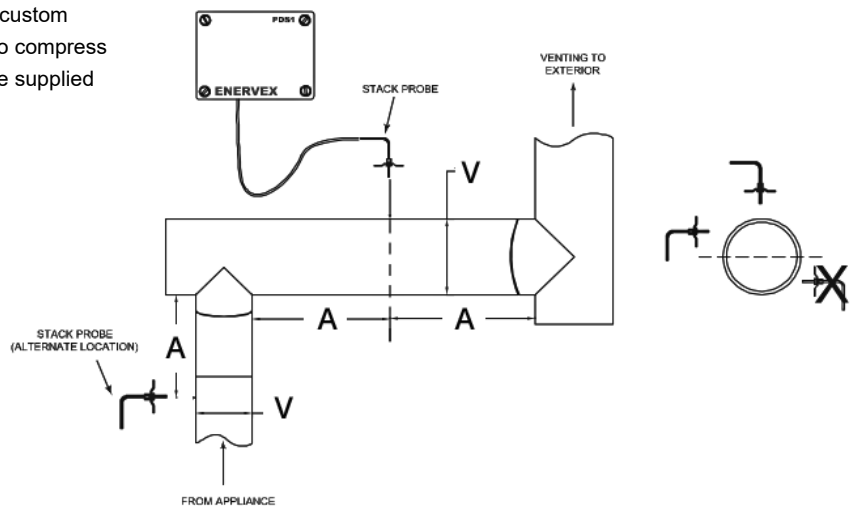

Figure 10A.4

10 - ELECTRIC

B. 1 TETHERED CONTROL PANEL INSTALLATION OVERVIEW

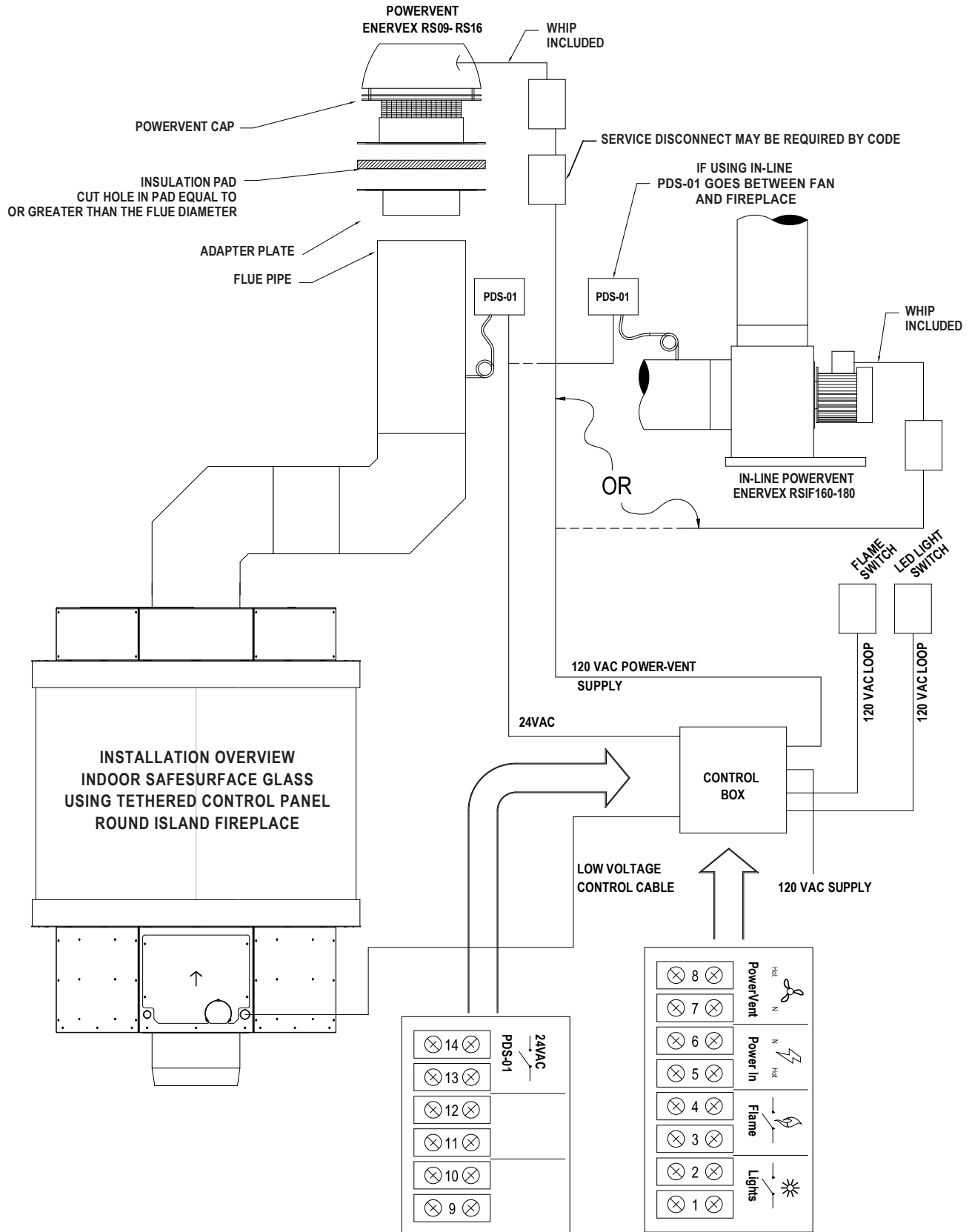

Figure 10 D

10 - ELECTRICAL

B.2 ELECTRICAL WIRING SCHEMATIC- AT INSTALL

SYSTEM G - LIGHTS

RS SERIES
POWERVENT SHOWN

Figure 10B.1

Powervent Voltage Chart

CAP	VAC	AMP	HP
RS12	120	1.2	1/9
RS14	120	1.4	1/7
RSIF160	120	2.9	3/7
RSIF180	120	5.3	3/16

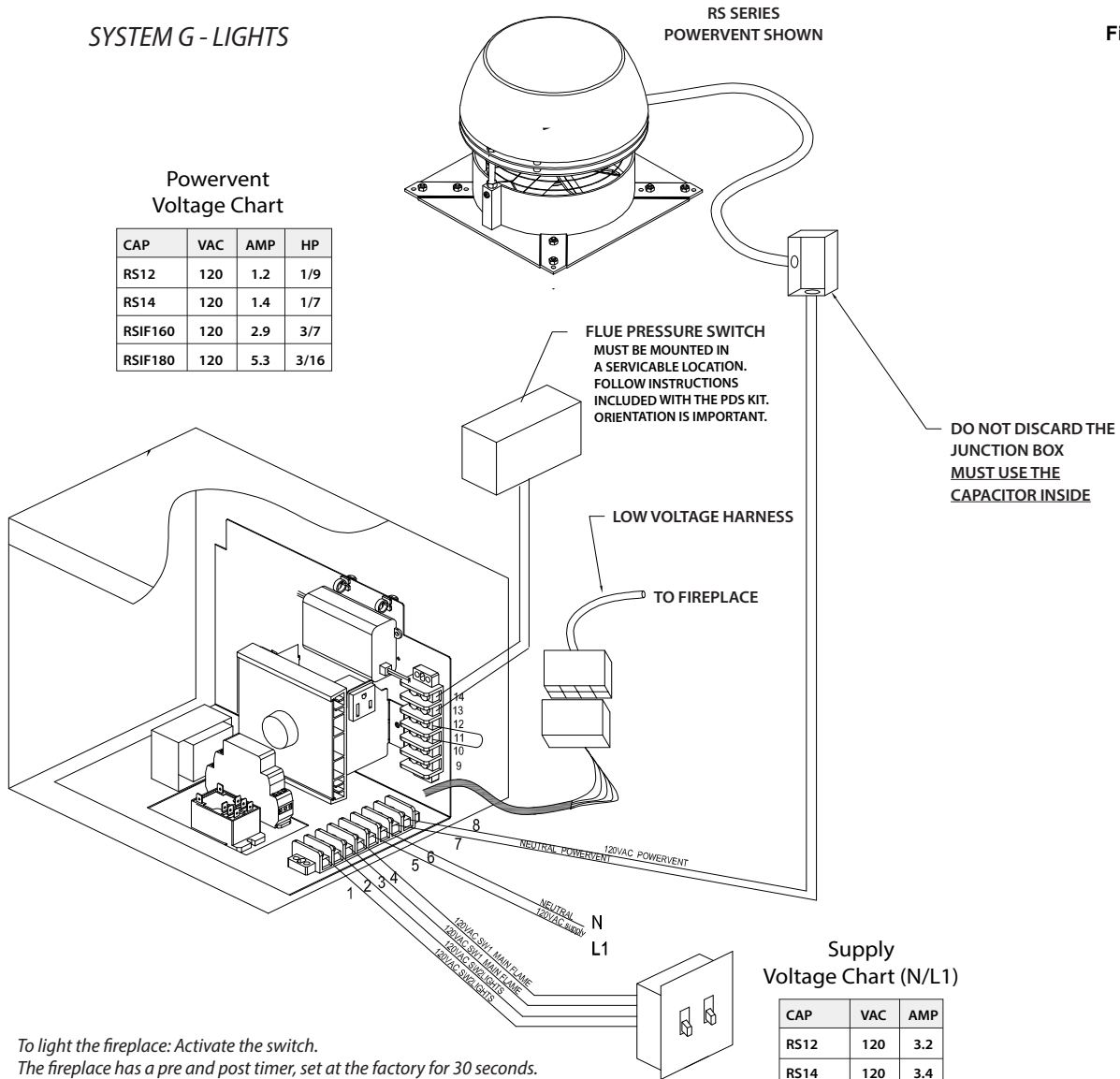

Supply Voltage Chart (N/L1)

CAP	VAC	AMP
RS12	120	3.2
RS14	120	3.4
RSIF160	120	4.9
RSIF180	120	7.3

To light the fireplace: Activate the switch.
The fireplace has a pre and post timer, set at the factory for 30 seconds.
The powervent will start after the switch is activated.
The flame will not turn on for 30-60 seconds after switch is activated
and the powervent will run for 30 seconds after it has been shut off.

#	FUNCTION	NOTES:
1	120 VAC SW2 LIGHTS	120 VOLT LOOP
2	120VAC SW2 LIGHTS	120 VOLT LOOP
3	120VAC SW1 MAIN FLAME	120 VOLT LOOP
4	120 VAC SW1 MAIN FLAME	120 VOLT LOOP
5	120 VAC SUPPLY	CONNECT TO CONSTANT POWER SOURCE
6	NEUTRAL	CONNECT TO CONSTANT POWER SOURCE
7	NEUTRAL POWERVENT	DO NOT SHARE NEUTRAL
8	120VAC POWERVENT	FROM SPEED CONTROL
9	24VAC FLUE DAMPER POWER	OPTIONAL
10	24VAC FLUE DAMPER NEUTRAL	OPTIONAL
11	SW3 FLUE DAMPER PROVE	OPTIONAL. USE PURPLE AND WHITE, NOT RED
12	SW3 DAMPER PROVE	OPTIONAL. USE PURPLE AND WHITE, NOT RED
13	CONNECTION FOR EXTERNAL FLUE PRESSURE SWITCH	REQUIRED
14	CONNECTION FOR EXTERNAL FLUE PRESSURE SWITCH	REQUIRED

10 - ELECTRICAL

B.3 ELECTRICAL WIRING SCHEMATIC- FOR SERVICE AND TROUBLESHOOTING



NOTE: The appliance, when installed, must be electrically grounded in accordance with local codes or, in the absence of local codes, with the *National Electrical Code, ANSI/NFPA 70, or the Canadian Electrical Code, Part 1, CSA C22.1.*

Figure 10B.2 SYSTEM: TB1P111SYS

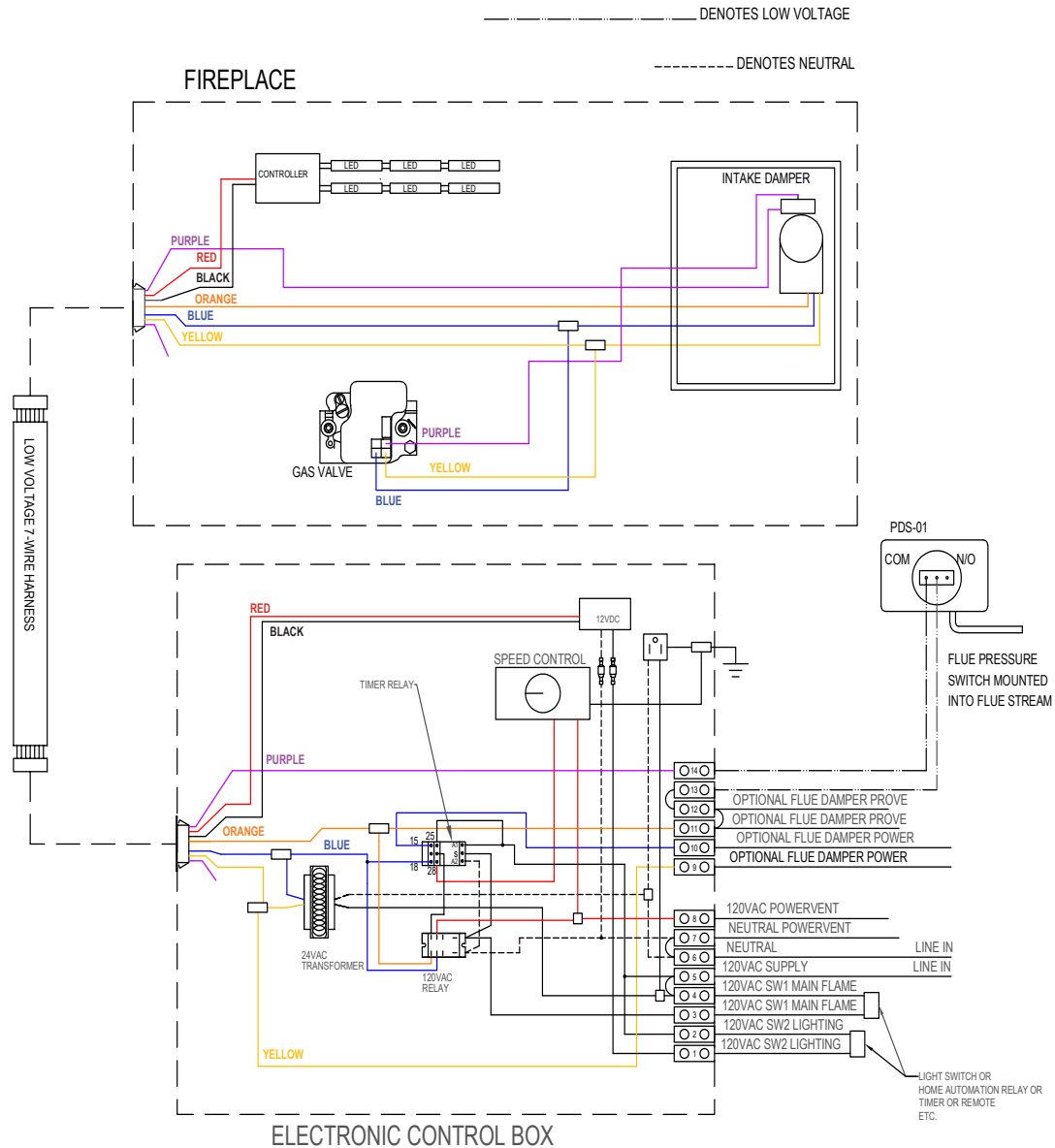

#	FUNCTION	NOTES
1	SW2 LIGHTS (IF EQUIPPED) 120VAC LOOP	120 VOLT LOOP
2	SW2 LIGHTS (IF EQUIPPED) 120VAC LOOP	120 VOLT LOOP
3	SW1 MAIN FLAME- 120VAC LOOP	120 VOLT LOOP
4	SW1 MAIN FLAME- 120VAC LOOP	120 VOLT LOOP
5	120VAC SUPPLY	120vac 15amp MIN DEDICATED CIRCUIT
6	NEUTRAL	120vac 15amp MIN DEDICATED CIRCUIT
7	NEUTRAL TO POWERVENT	
8	120VAC TO POWERVENT	
9	24VAC FLUE DAMPER POWER (IF EQUIPPED)	BLACK WIRE IN PAIR
10	24VAC FLUE DAMPER NEUTRAL (IF EQUIPPED)	RED WIRE IN PAIR
11	SW3 FLUE DAMPER PROVE (ONLY IF DAMPER IS USED)	USE PURPLE AND WHITE, NOT RED
12	SW3 FLUE DAMPER PROVE (ONLY IF DAMPER IS USED)	USE PURPLE AND WHITE, NOT RED
13	FLUE PRESSURE SWITCH	FACTORY
14	FLUE PRESSURE SWITCH	FACTORY

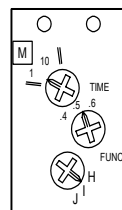

RELAY TOP;
FIRST DIAL-SET TO "1"
SECOND DIAL- SET TO ".5"
THIRD DIAL- SET TO "1"

LED STATUS: GREEN =POWER APPLIED, POWERVENT OFF
RED FLASHING= TIMING PERIOD, PRE OR POST PURGE
RED SOLID= CLOSED STATE, POWERVENT ON

10 - ELECTRIC

B.4 JUNCTION BOX & CAPACITOR

**DO NOT DISCARD
JUNCTION BOX - CAPACITOR INSIDE**

JUNCTION BOX PRE-WIRED FROM STELLAR

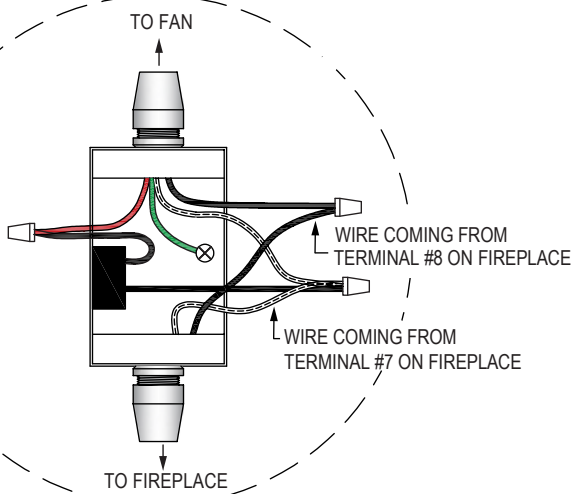
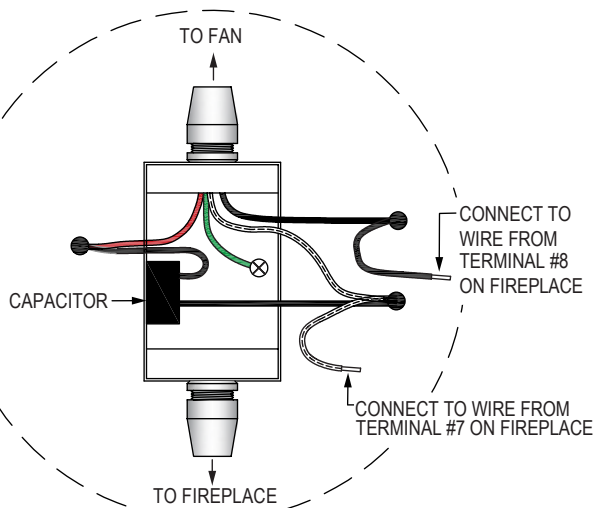

JUNCTION BOX WIRING FROM ENERVEX

Figure 10B.3

C.1 TERMINALS 1 & 2 - LED LIGHTING

TERMINAL 1 & 2: LED LIGHTING

TERMINAL #2	HAS 120VAC POWER TO SUPPLY A SWITCH, RELAY, TIMER, REMOTE, ETC.
TERMINAL #1	RETURNS 120VAC POWER TO ACTIVATE THE LED DRIVER.

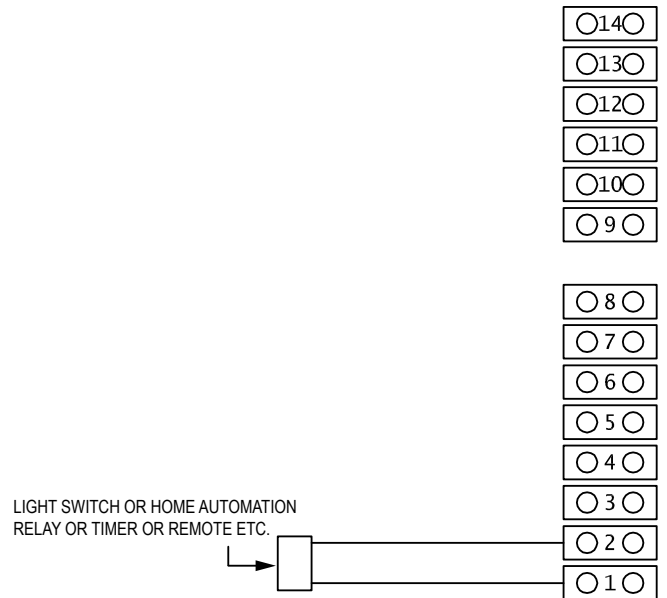

Figure 10C.1

**NOTE FOR THE ELECTRICIAN:
FIELD WIRING SHOULD BE LABELED
FOR EASY IDENTIFICATION.**

10 - ELECTRIC

C.2 TERMINALS 3 & 4 - MAIN FLAME

TERMINAL 3 & 4 : MAIN FLAME

TERMINAL #4	TERMINAL #4 HAS 120VAC POWER TO SUPPLY A SWITCH, RELAY, TIMER,
TERMINAL #3	REMOTE, ETC. TERMINAL #3 RETURNS 120VAC POWER TO ACTIVATE TO MAIN FLAMES.

IF USING STANDARD ROMEX, CONNECT BLACK TO TERMINAL #4 AND WHITE TO TERMINAL #3.
SINCE 120 VOLTS WILL TRAVEL ON WHITE, MARK THE WHITE WIRE ACCORDING TO CODE.

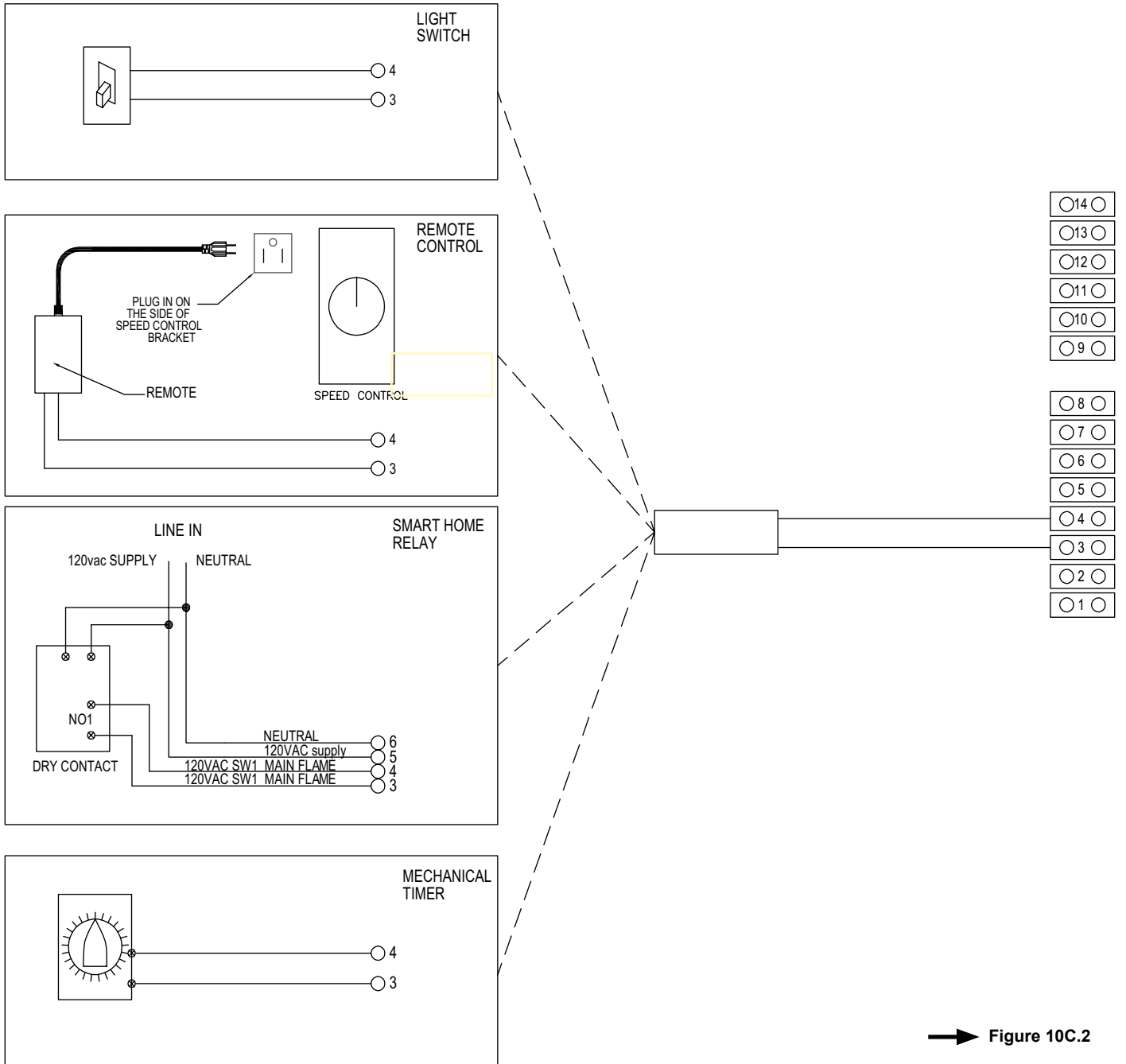

➔ Figure 10C.2

SMART HOME RELAY NOTE: Generic diagram, follow specific relay manufactures instructions.

10 - ELECTRIC

C.3 - TERMINALS 5 & 6 FIREPLACE POWER

TERMINAL 5 & 6: FIREPLACE POWER

GROUND - LOCATE THE GREEN WIRE CLUSTER
CONNECT THE GREEN WIRE TAIL TO BUILDING GROUND

TERMINAL #5	IS THE 120VAC POWER SUPPLY FOR THE FIREPLACE. THIS IS A CONSTANT POWER SUPPLY AND SHOULD NOT BE SWITCHED. A SERVICE DISCONNECT MAY BE DESIRED.
TERMINAL #6	IS THE NEUTRAL CONNECTION

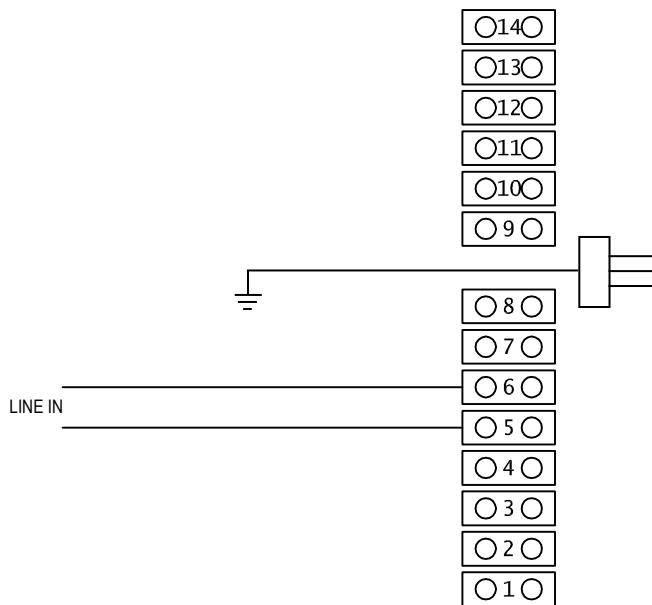

→ Figure 10C.3

**WIRE THE FIREPLACE TO A 15 AMP MIN
DEDICATED CIRCUIT.**

C.4 - TERMINALS 7 & 8 POWERVENT MOTOR

TERMINAL 7 & 8: POWERVENT CONNECTION

POWERVENT POWER MUST COME FROM THE TERMINAL BLOCK AND
NOT ANY OTHER POWER SOURCE.

TERMINAL #8	IS THE HOT CONNECTION FOR THE POWERVENT MOTOR FROM THE SPEED CONTROL.
TERMINAL #7	IS THE NEUTRAL CONNECTION FOR THE POWERVENT MOTOR.

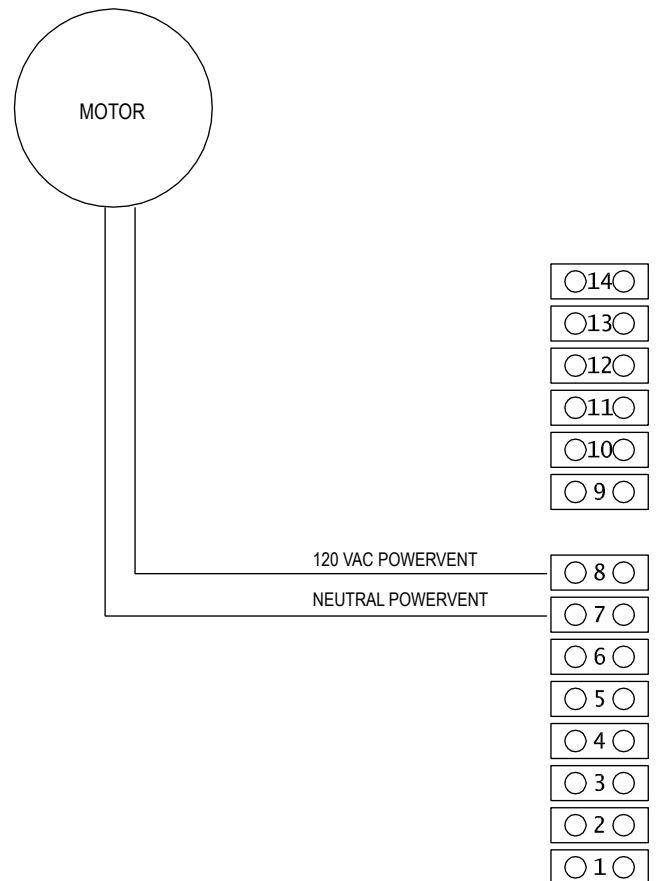

→ Figure 10C.4

10 - ELECTRIC

C.5 - TERMINALS 9 & 10 FLUE DAMPER CONNECTION

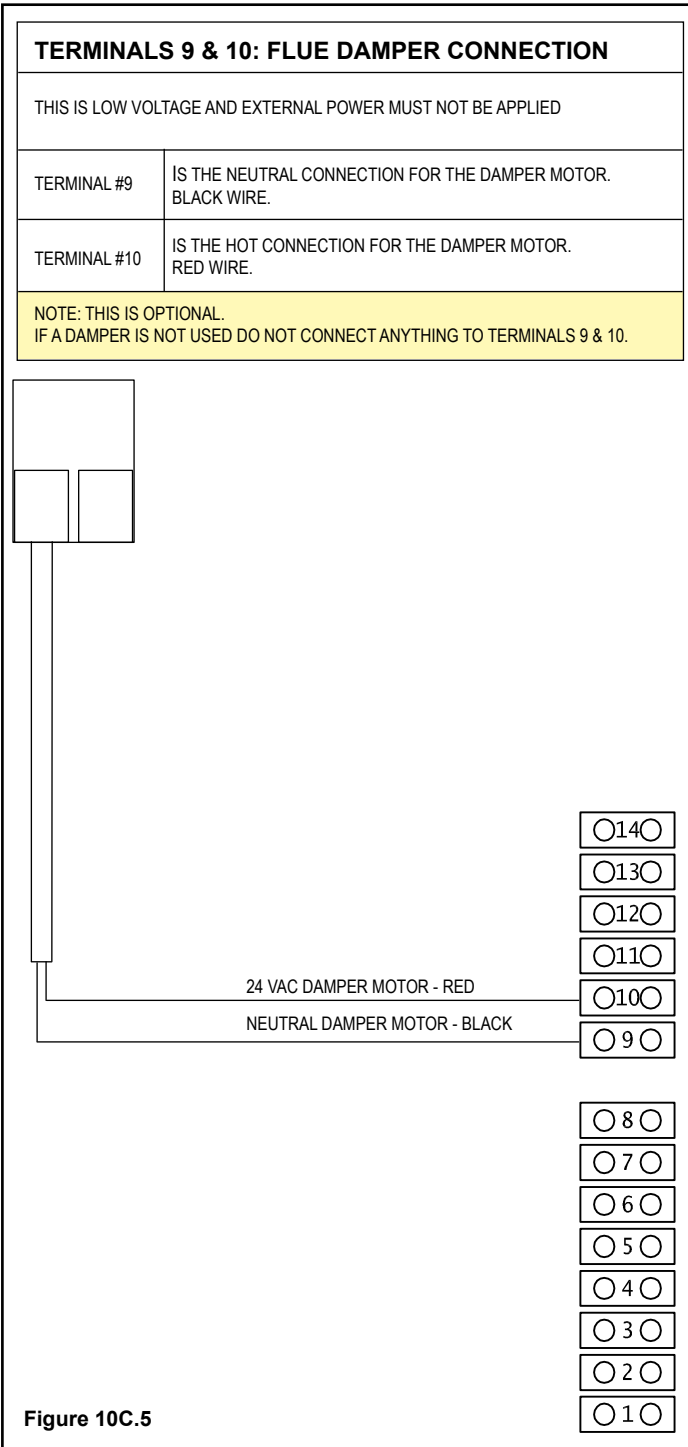

C. 6 - TERMINALS 11 & 12 FLUE DAMPER PROVE

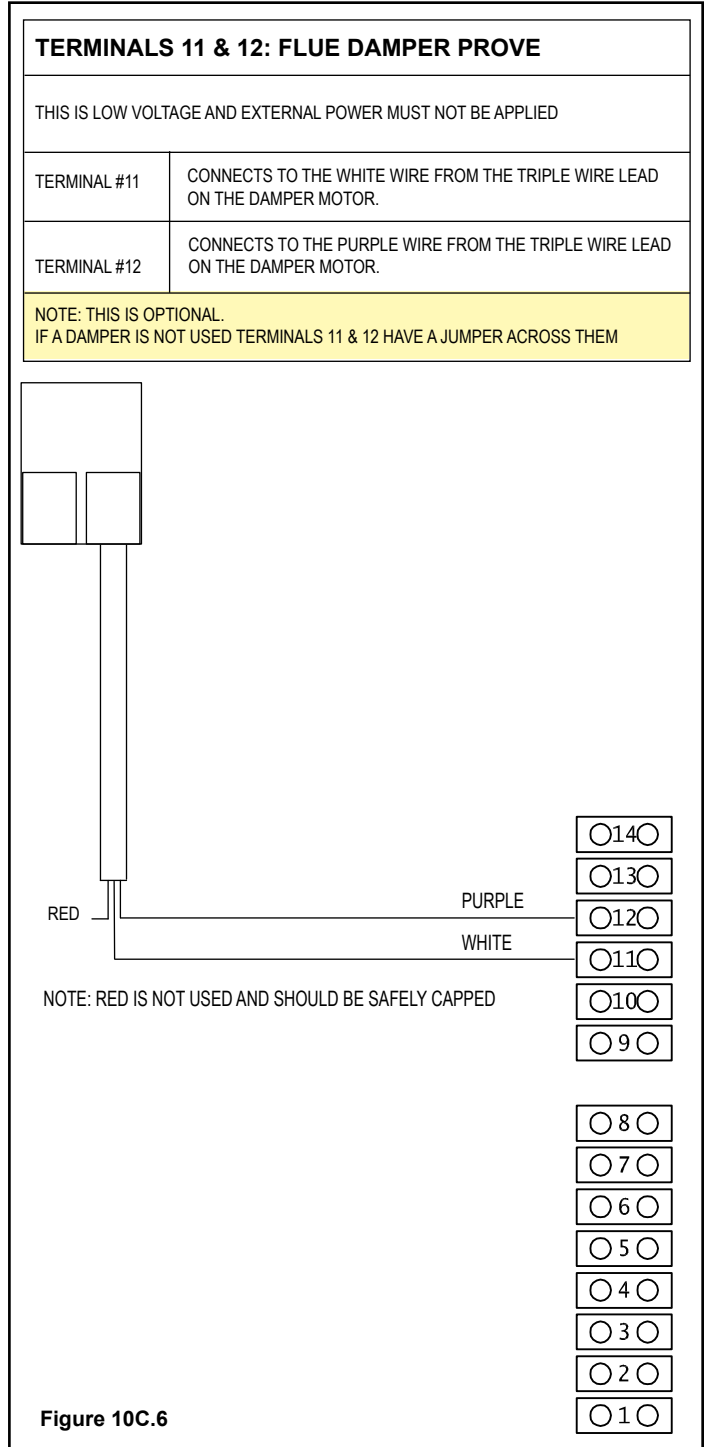

Low Voltage Wire Gauge - Max Length

Feet [Meters]

Transformer Output	12 awg	14 awg	16 awg	18 awg
40VA(W)	453 [138]	285 [86.9]	179 [54.56]	113 [34.4]

Use a minimum of 18 awg wire

10 - ELECTRIC

C. 7 - TERMINALS 13 & 14 FLUE PRESSURE SWITCH

**INSTALLATION INSTRUCTIONS OF
PDS-01 SWITCH CAN BE FOUND ON
PAGE 44 & 45**

TERMINALS 13 & 14: PRESSURE SWITCH

FOUR SIDED UNITS ONLY. FACTORY WIRED FOR ALL OTHERS.

TERMINAL #13	CONNECTS TO THE "COM" OR "NO" TERMINALS ON THE PDS-01 VACUUM SWITCH FOR FIREPLACE 1.
--------------	--

TERMINAL #14	CONNECTS THE "COM" OR "NO" TERMINALS IN THE PDS-01 VACUUM SWITCH FOR FIREPLACE 1.
--------------	---

NOTE: THIS IS REQUIRED

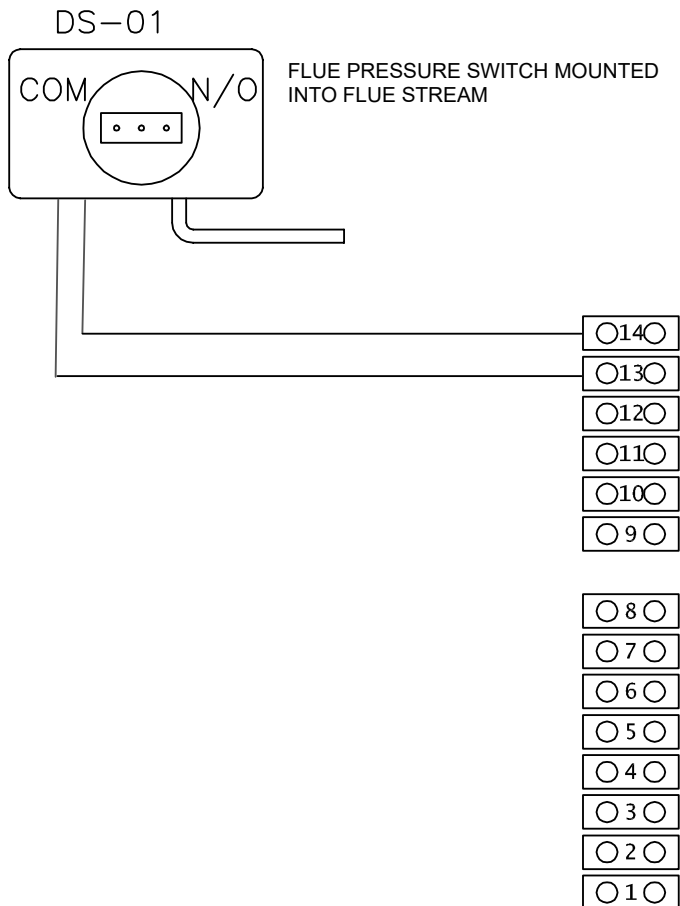

Figure 10C.7

11 - FINISHING

REFER TO SECTION 6 - MANTEL REQUIREMENTS

12 - LIGHTING & SHUTDOWN

FOR YOUR SAFETY - READ BEFORE LIGHTING



STOP: IF YOU DO NOT FOLLOW THESE INSTRUCTIONS EXACTLY, A FIRE OR EXPLOSION MAY RESULT, CAUSING PROPERTY DAMAGE, PERSONAL INJURY OR LOSS OF LIFE.

DUE TO HIGH SURFACE TEMPERATURES, KEEP CHILDREN, CLOTHING AND FURNITURE AWAY.

This appliance needs fresh air for safe operation and must be installed so there are provisions for adequate combustion and ventilation air. It is important to make sure the termination cap remains unobstructed at all times from snow, ice, leaves or other debris.

- This fireplace is equipped with an ignition device which automatically lights the pilot and main burner. The pilot and burner light automatically with the wall switch. **DO NOT** try to light the pilot by hand. Before lighting this fireplace, follow these instructions exactly.
- **BEFORE LIGHTING**, smell all around the appliance for gas. Be sure to smell next to the floor because some gas is heavier than air and will settle on the floor.
- Do not use this appliance if any part has been under water. Immediately call a qualified service technician to inspect the appliance and to replace any part of the control system which has been under water.

WHAT TO DO IF YOU SMELL GAS:

- Do not touch any electrical switches
- Do not try to light any appliance
- Do not use the phone in your building
- Immediately call your gas supplier from a neighbor's phone
- Follow the gas supplier's instructions
- If you cannot reach your gas supplier, call the fire department

DO NOT STORE OR USE GASOLINE OR OTHER FLAMMABLE VAPORS AND LIQUIDS IN THE VICINITY OF THIS OR ANY OTHER APPLIANCE



NOTE: A PAINT SMELL WILL OCCUR DURING THE FIRST FEW HOURS OF BURNING.



NOTE: THIS FIREPLACE MAY PRODUCE NOISES OF VARYING DEGREE AS IT HEATS AND COOLS DUE TO METAL EXPANSION AND CONTRACTION. THIS IS NORMAL AND DOES NOT AFFECT THE PERFORMANCE OR LONGEVITY OF THE FIREPLACE.

A. LIGHTING THE FIREPLACE - SEQUENCE OF EVENTS



STOP! Read safety information on previous page and front cover of this manual before continuing.



NOTE: This fireplace is equipped with an ignition device which automatically lights the pilot. DO NOT try to light the pilot by hand.



CAUTION: If fireplace will not operate, follow instructions TURNING OFF GAS TO FIREPLACE and call your service technician or the gas supplier.



NOTE: When fireplace is initially lit, condensation will appear on the glass; this is normal in all gas fireplaces and will disappear after several minutes.

12 - LIGHTING & SHUTDOWN

A. LIGHTING THE FIREPLACE - SEQUENCE OF EVENTS

To light the fireplace:

Activate the switch. The fireplace has a pre and post timer, set at the factory for 30 seconds. The power-vent and flame will not turn on for 30-60 seconds after the switch is activated and the power-vent will run for 30 seconds after the switch is shut off.

When the switch has been activated, the red light at the module will begin blinking.

At this time the mechanical intake damper will begin to slowly open and the powervent will turn on.

Once damper is completely open and the pitot tube has established there is a draft, the red light will turn solid and send voltage to the ignitor which will begin to glow and as the valve opens and gas flow



STOP! Read safety information on previous page and front cover of this manual before continuing.



NOTE: This fireplace is equipped with an ignition device which automatically lights the pilot. **DO NOT** try to light the pilot by hand.

B. IF THE FIREPLACE DOES NOT LIGHT

1. Turn off the fireplace at switch.
2. Turn off all electrical power to fireplace.
3. Wait five (5) minutes to allow any gas that may have accumulated inside firebox to escape. If you then smell gas, STOP! Follow safety information on front cover and on previous page of the installation manual. If you don't smell gas, go to next step.
4. Turn ON all electrical power to fireplace.
5. Turn fireplace on at switch.

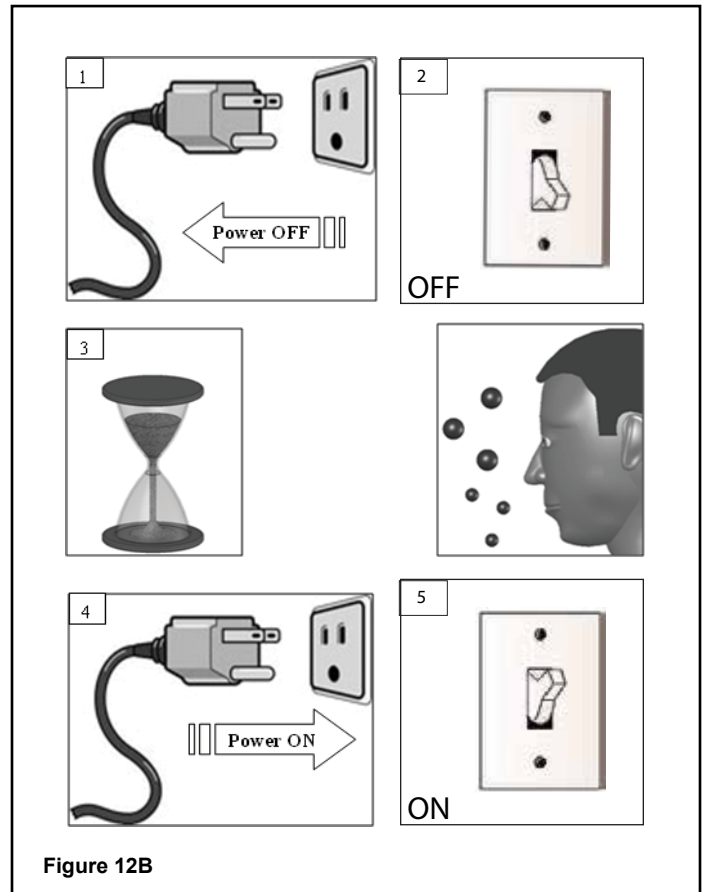

Figure 12B



CAUTION: If fireplace will not operate, follow instructions **TURNING OFF GAS TO FIREPLACE** and call your service technician or the gas supplier.



NOTE: When fireplace is initially lit, condensation may appear on the glass; this is normal in all gas fireplaces and will disappear after several minutes.

13 - PRESSURE TESTING



NOTE: The appliance and its individual shutoff valve must be disconnected from the gas supply piping system during any pressure testing of that system at pressures in excess of ½ psi. (3.5kPa)



NOTE: The appliance must be isolated from the gas supply piping system by closing its individual manual shut-off valve during any pressure testing of the gas line at test pressures equal to or less than ½ psi (3.5 kPa).

INLET PRESSURE TEST

1. The valve has an allen plug on the inlet and outlet.
2. Install a barb fitting on the tap you want to measure.
3. Light the fireplace, check the pressure.
4. Turn off fireplace; reinstall plug.
5. Check for leaks.



CAUTION: A LOW PRESSURE READING CAN CAUSE DELAYED IGNITION



NOTE: If inlet pressure reading is too high or too low, contact the gas company. Only a qualified gas service technician should adjust incoming gas pressure.

14 - FINALIZING THE INSTALLATION

A. INSTALLING THE MEDIA

Place the supplied glass media into the base tray.
Cover the base evenly. Do not use more than the supplied amount.

Do not get any glass media into the pilot area; a hazardous condition could result!

You should be able to see the burner slightly through the media. If you can't, push the media back from the burner. Smaller flames will result from too much media over the burner.

DO NOT COVER THE ROUND BURNERS; POOR FLAME APPEARANCE WILL RESULT.



Figure 14

NOTE: DO NOT SUBSTITUTE THE SUPPLIED MEDIA WITH ANY OTHER KIND OF MEDIA WITHOUT WRITTEN APPROVAL OF STELLAR HEARTH PRODUCTS.

B. FLAME APPEARANCE

Flame appearance is affected by several factors including altitude, venting configuration and fuel quality. Although the venturi setting has been factory set, adjustments may be necessary for optimal performance and visual aesthetics.

When fireplace is first lit, the flames will be blue. Flames will gradually turn yellowish-orange during first 15 minutes of operation. If flames remain blue, or become dark orange with evidence of sooting (black tips), the burner tube venturi may need adjustment. Contact Stellar Hearth.

15 - MAINTENANCE

A. VALVE AND ELECTRICAL ACCESS

The appliance is required to be inspected at least once a year by a professional service person. The compartment below firebox (behind lower access panel) must be cleaned at least once a year, more frequent cleaning may be required due to excessive lint from carpeting, bedding materials, or other fibrous materials. It is imperative that the burner be cleaned once a year.

There is an access panel under the floor of the firebox should more extensive service be needed. Remove the media on the screened section to the left (clockwise) of the pilot. Remove the screws and remove that section from the fireplace. Remove the three-sided wall that held the screen. Remove the rectangular panel below that to expose the valve.

Refer to Section 3 - Specifications for valve and electrical access schematic.



NOTE: INSTALLATION AND REPAIR SHOULD BE DONE ONLY BY QUALIFIED SERVICE PERSON. THE APPLIANCE SHOULD BE INSPECTED BEFORE USE AND ANNUALLY BY A QUALIFIED SERVICE PERSON. MORE FREQUENT CLEANING MAY BE REQUIRED DUE TO EXCESSIVE LINT FROM CARPETING, BEDDING MATERIALS, ETC. IT IS IMPERATIVE THAT CONTROL COMPARTMENTS, BURNERS AND CIRCULATION AIR PASSAGEWAYS OF THE APPLIANCE BE KEPT CLEAN.

B. VENT SYSTEM

- Annual examination of venting system by a qualified agency is required.
- IF VENT-AIR INTAKE SYSTEM IS DISASSEMBLED FOR ANY REASON, RE-INSTALL PER INSTRUCTIONS PROVIDED WITH INITIAL INSTALLATION.
- The flow of combustion air must not be obstructed.

C. GLASS CLEANING & REPLACEMENT



WARNING! RISK OF INJURY! DO NOT remove glass until it is cooled to room temperature. Glass breakage could occur. See Section 6 for glass installation and removal instructions.

- Clean glass only when cool and only with non-abrasive cleansers.
- Do not operate this fireplace with glass/frame assembly removed, cracked or broken.
- The glass assembly shall only be replaced as a complete unit.
- Replacement of glass & frame assembly, must only be performed by a licensed or qualified service person.
- **DO NOT SUBSTITUTE MATERIALS.**
- Do not strike or slam glass door assembly.

Refer to Section 7 - Glass Frame Assembly for more information.



CAUTION: LABEL ALL WIRES PRIOR TO DISCONNECTION WHEN SERVICING CONTROLS. WIRING ERRORS CAN CAUSE IMPROPER AND DANGEROUS OPERATION. VERIFY PROPER OPERATION AFTER SERVICING. KEEP APPLIANCE AREA CLEAR OF COMBUSTIBLE MATERIALS, SUCH AS GASOLINE AND OTHER FLAMMABLE VAPORS AND LIQUIDS. VAPORS AND LIQUIDS.

16 - REPLACEMENT PARTS

ROUND REPLACEMENT PARTS LIST

PART	PART NUMBER
Gas Valve	SV9501
Pilot	112-5000
Vacuum Switch	112-5003
Transformer, 24 VAC	112-5002
Orifice, NG #43	16400-2043
Orifice, Propane #55	16400-2055
Propane Conversion Kit	LPK-FDN
Timer Relay	112-5014
Solid State Relay	112-5009

PART	PART NUMBER
Energex External Chimney Fan	RS12
Replacement Capacitor - RS12	601.0400.0064
Energex In-line Chimney Fan	RSIF160
Replacement Capacitor - RSIF160	601.0800.0064

PART	PART NUMBER	QUANTITY
Crystal Rock, 5 lb. bag	2188-851	55 lbs

PART	PART NUMBER
10 Inch Intake/Exhaust Collar	16400-1550
LED Transformer	16400-1900
LED Controller	16400-1901
LED Remote Control	16400-1901R
Switch, 15 Amp Toggle	16400-3013
2-Gang Electrical Box	16400-3014
White Nylon 2-Gang Plate	16400-3015
Suction Cup	675-9605

MODEL	Horizontal Trim Pieces Between Glass		
	Part #	Qty	
3-RD-24-G	SRV20032-1044	2	
3-RD-36-G	SRV20032-1044	2	

Hearth & Home Technologies
LIMITED LIFETIME WARRANTY

Hearth & Home Technologies, on behalf of its hearth brands (“HHT”), extends the following warranty for HHT gas, wood, pellet and electric hearth appliances that are purchased from an HHT authorized dealer.

WARRANTY COVERAGE:

HHT warrants to the original owner of the HHT appliance at the site of installation, and to any transferee taking ownership of the appliance at the site of installation within two years following the date of original purchase, that the HHT appliance will be free from defects in materials and workmanship at the time of manufacture. After installation, if covered components manufactured by HHT are found to be defective in materials or workmanship during the applicable warranty period, HHT will, at its option, repair or replace the covered components. HHT, at its own discretion, may fully discharge all of its obligations under such warranties by replacing the product itself or refunding the verified purchase price of the product itself. The maximum amount recoverable under this warranty is limited to the purchase price of the product. This warranty is subject to conditions, exclusions and limitations as described below.

WARRANTY PERIOD:

Warranty coverage for consumers begins at the date of installation. In the case of new home construction, warranty coverage begins on the date of first occupancy of the dwelling or six months after the sale of the product by an independent, authorized HHT dealer/distributor, whichever occurs earlier. However, the warranty shall commence no later than 24 months following the date of product shipment from HHT, regardless of the installation or occupancy date. The warranty period for parts and labor for covered components is produced in the following table.

The term “Limited Lifetime” in the table below is defined as: 20 years from the beginning date of warranty coverage for gas appliances, and 10 years from the beginning date of warranty coverage for wood and pellet appliances. These time periods reflect the minimum expected useful lives of the designated components under normal operating conditions.

Warranty Period		HHT Manufactured Appliances and Venting					
Parts	Labor	Gas	Pellet	Wood	Electric	Venting	Components Covered
1 Year		X	X	X	X	X	All parts including handles, external enameled components and other material except as covered by Conditions, Exclusions, and Limitations listed
2 years			X	X			Igniters, Auger Motors, Electronic Components, and Glass
		X					Electrical components limited to modules, remotes/wall switches, valves, pilots, blowers, junction boxes, wire harnesses, transformers and lights (excluding light bulbs)
		X		X			Molded Refractory Panels, Glass Liners
3 years			X				Firepots, burnpots, mechanical feeders/auger assemblies
5 years	1 year	X					Vent Free Burners, Vent Free Logs
			X	X			Castings, Medallions and Baffles
6 years	3 years			X			Catalyst - Limitations Listed
7 years	3 years		X	X			Manifold tubes, HHT Chimney and Terminations
10 years	1 year	X					Burners, logs and refractory
Limited Lifetime	3 years	X	X	X			Firebox and heat exchanger, FlexBurn® System (engine, inner cover, access cover and fireback)
1 Year	None	X	X	X	X	X	All replacement parts beyond warranty period

WARRANTY CONDITIONS:

- This warranty only covers HHT appliances that are purchased through an HHT authorized dealer or distributor. A list of HHT authorized dealers is available on the HHT branded websites.
- This warranty is only valid while the HHT appliance remains at the site of original installation.
- This warranty is only valid in the country in which the HHT authorized dealer or distributor that sold the appliance resides.
- Contact your installing dealer for warranty service. If the installing dealer or distributor is unable to provide necessary parts, contact the nearest HHT authorized dealer or supplier. Additional service fees may apply if you are seeking warranty service from a dealer other than the dealer from whom you originally purchased the product.
- Check with your dealer in advance for any costs to you when arranging a warranty call. Travel and shipping charges for parts are not covered by this warranty.
- Limited Catalyst Warranty
 - For wood burning products containing a catalyst, the catalyst will be warranted for a six-year period to the original purchaser at the site of original installation. The purchaser must provide the name, address, and telephone number of the location where the product is installed, proof of original purchase date, date of failure, and any relevant information regarding the failure of the catalyst.

WARRANTY EXCLUSIONS:

This warranty does not cover the following:

- Changes in surface finishes as a result of normal use. As a heating appliance, some changes in color of interior and exterior surface finishes may occur. This is not a flaw and is not covered under warranty.
- Damage to printed, plated, or enameled surfaces caused by fingerprints, accidents, misuse, scratches, melted items, or other external sources and residues left on the plated surfaces from the use of abrasive cleaners or polishes.
- Repair or replacement of parts that are subject to normal wear and tear during the warranty period are not covered. These parts include: paint, wood and pellet gaskets, firebricks, grates, flame guides, batteries and the discoloration of glass.
- Expansion, contraction, or movement of certain parts causing noise. These conditions are normal and complaints related to this noise are not covered by this warranty.
- Damages resulting from: (1) failure to install, operate, or maintain the appliance in accordance with the installation instructions, operating instructions, and listing agent identification label furnished with the appliance; (2) failure to install the appliance in accordance with local building codes; (3) shipping or improper handling; (4) improper operation, abuse, misuse, continued operation with damaged, corroded or failed components, accident, or improperly/incorrectly performed repairs (5) environmental conditions, inadequate ventilation, negative pressure, or drafting caused by tightly sealed constructions, insufficient make-up air supply, or handling devices such as exhaust fans or forced air furnaces or other such causes; (6) use of fuels other than those specified in the operation instructions; (7) installation or use of components not supplied with the appliance or any other components not expressly authorized and approved by HHT; (8) modification of the appliance not expressly authorized and approved by HHT in writing; and/or (9) interruptions or fluctuations of electrical power supply to the appliance.
- Non-HHT venting components, hearth connections or other accessories used in conjunction with the appliance.
- Any part of a pre-existing fireplace system in which an insert or a decorative gas appliance is installed.
- HHT's obligation under this warranty does not extend to the appliance's capability to heat the desired space. Information is provided to assist the consumer and the dealer in selecting the proper appliance for the application. Consideration must be given to the appliance location and configuration, environmental conditions, insulation and air tightness of the structure.

This warranty is void if:

- The appliance has been over-fired, operated in atmospheres contaminated by chlorine, fluorine, or other damaging chemicals. Over-firing can be identified by, but not limited to, warped plates or tubes, deformation/warping of interior cast iron structure or components, rust colored cast iron, bubbling, cracking and discoloration of steel or enamel finishes.
- The appliance is subjected to prolonged periods of dampness or condensation.
- There is any damage to the appliance or other components due to water or weather damage which is the result of, but not limited to, improper chimney or venting installation.

LIMITATIONS OF LIABILITY

- The owner's exclusive remedy and HHT's sole obligation under this warranty, under any other warranty, express or implied, or in contract, tort or otherwise, shall be limited to replacement, repair, or refund, as specified above. In no event will HHT be liable for any incidental or consequential damages caused by defects in the appliance. Some states do not allow exclusions or limitation of incidental or consequential damages, so these limitations may not apply to you. This warranty gives you specific rights; you may also have other rights, which vary from state to state. EXCEPT TO THE EXTENT PROVIDED BY LAW, HHT MAKES NO EXPRESS WARRANTIES OTHER THAN THE WARRANTY SPECIFIED HEREIN. THE DURATION OF ANY IMPLIED WARRANTY IS LIMITED TO DURATION OF THE EXPRESSED WARRANTY SPECIFIED ABOVE.