

FIRESIDE

furnishings

20802 Kensington Blvd, Lakeville, Minnesota 55044 USA

ASSEMBLY INSTRUCTION

ITEM NO. :PCLY-4034W / 3530W

PARTS LIST

		QTY
A	Hearth	1
B	Leg assemblies	2
C	Breastboard assembly	1
D	Vertical inner frame assemblies	2
E	Horizontal inner frame assembly	1
F	Side returns	2
G	Cabinet top	1
H	Wooden dowels	15
I	Screws	11
J	Cam pins, double head	4
K	Cams	20
L	Ledger board	1
M	Utility Screws for Part L	3
N	Cam pins w/wood thread	12

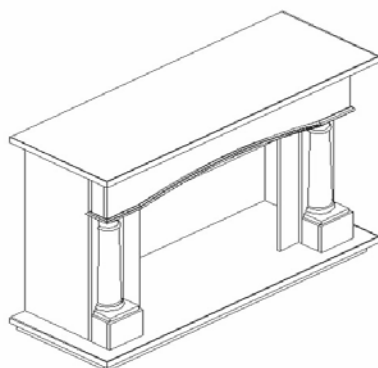
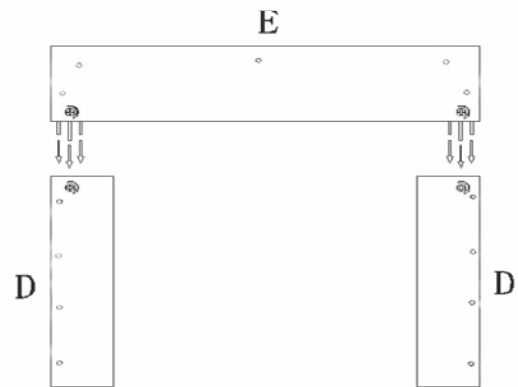
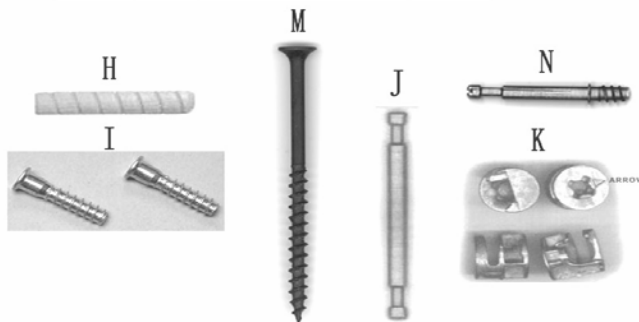
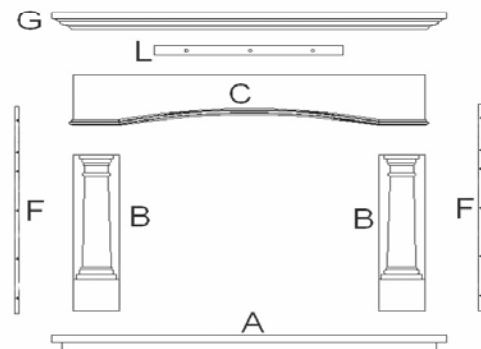

Please note:

This cabinet is for use with ELECTRIC fireplaces wired for 110/120 volts ONLY. This cabinet SHOULD NOT be used for 208/220/240 volt applications or with gas or woodburning fireplaces.

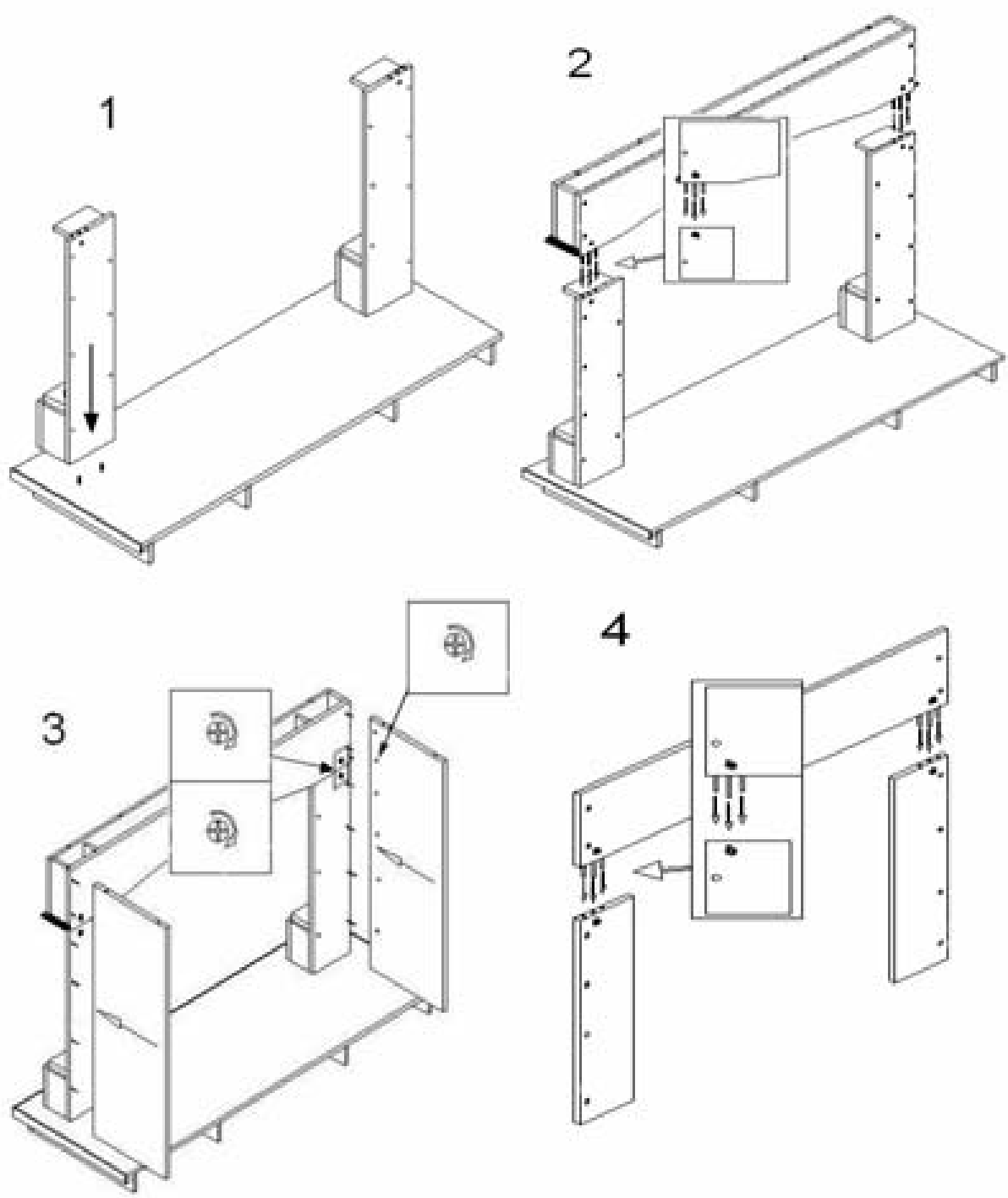

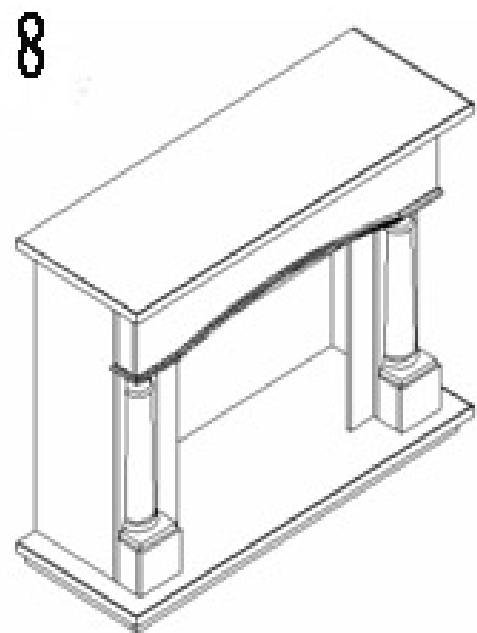
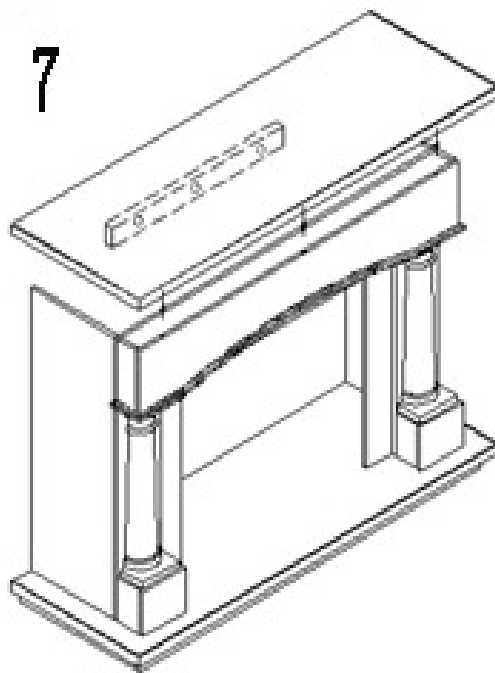
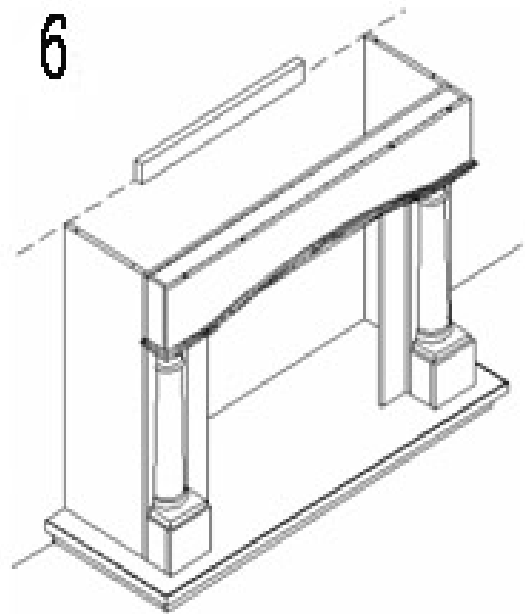
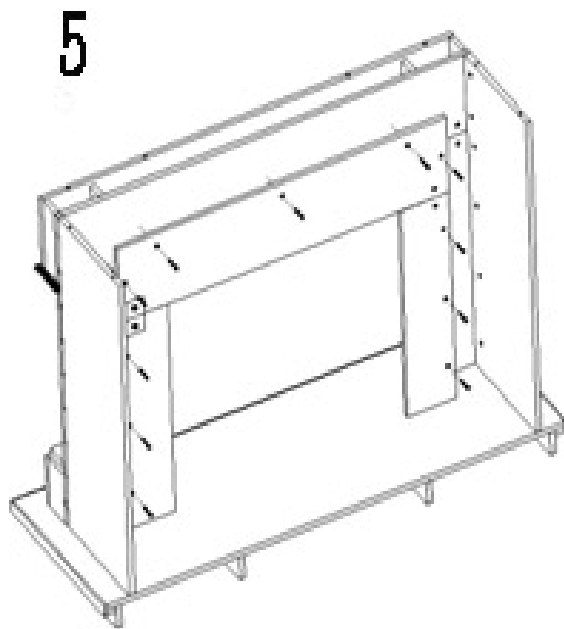

Nail top to ledgers, or use a few daubs of
construction adhesive on ledgers, etc