

Vent Components

CAUTION! Risk of Fire! DO NOT store instruction manuals inside fireplace cavity. High temperatures could cause a fire.

INSTALLER: Leave this manual with the appliance, not inside the appliance.

CONSUMER: Retain this manual for future reference. Do not store inside the appliance.

Hearth & Home Technologies Approved Vent Components



WARNING! Risk of Fire! DO NOT install unapproved vent components! Consult appliance Installation Manual for a list of approved vent components for the specific model being installed.

This is the list of vent components and termination caps that are approved for use with HHT gas appliances. All caps are not approved for all appliance models. Consult the Appliance Installation Manual for a complete list of vent components approved for the specific model being installed. Follow instructions included with vent components for proper installation.

Venting system components have been tested for use with approved HHT Direct Vent appliances. Check with your local building code agency before you begin installation to ensure compliance with local codes, including the need for permits and follow-up inspections. If you encounter any problems regarding code approvals, or if you need clarification of any of the instructions contained here, contact your Hearth & Home Technologies dealer. For the dealer nearest you, please visit www.hearthnhome.com.

Table of Contents

A. DVP Vent Components Diagrams	2
B. SLP Vent Components Diagrams.	7
C. Power Vent Components Diagrams.	11
D. Coaxial / Colinear Components Diagrams.	14
E. Decorative Terminations / Shrouds	14

A. DVP Vent Components Diagrams

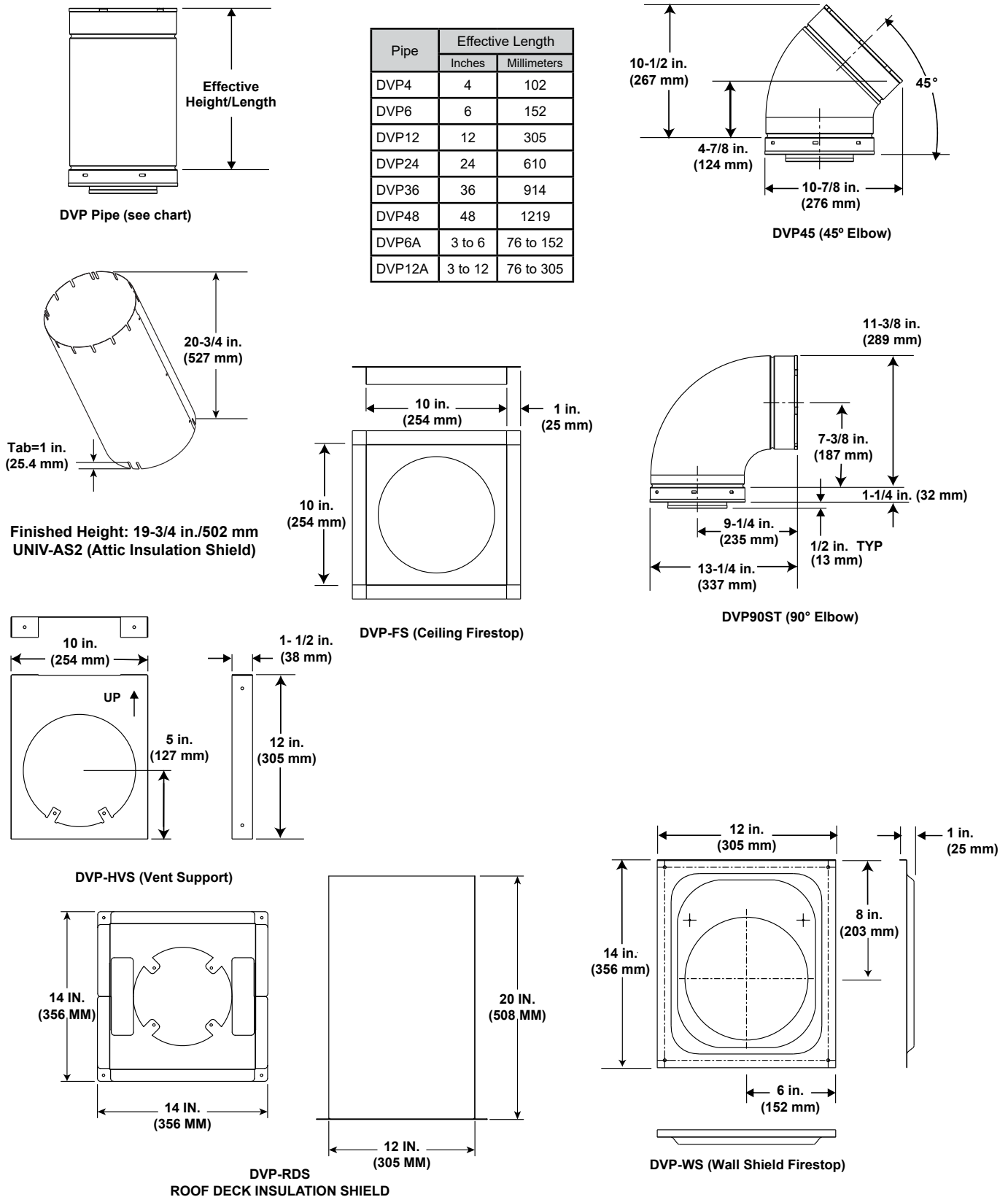
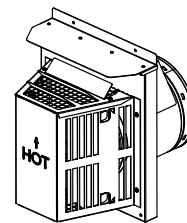
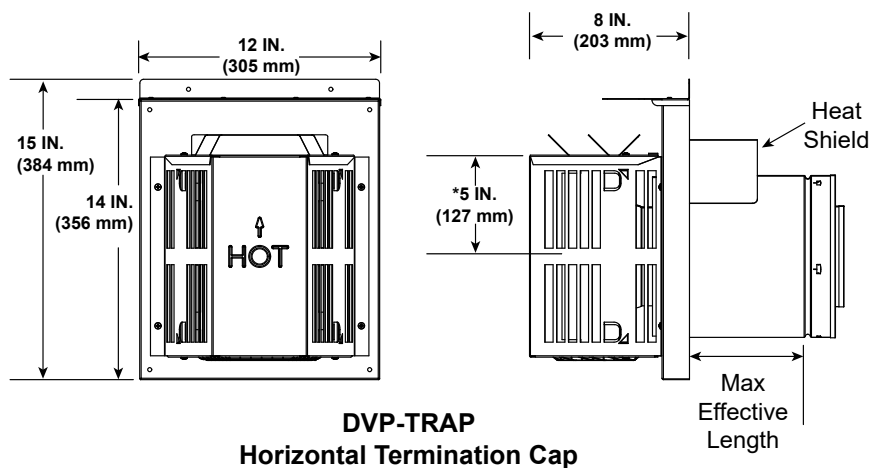

Figure 1 DVP Vent Components

A. DVP Vent Components Diagrams (*continued*)

Note: Heat shields **MUST** overlap by a minimum of 1-1/2 in. (38 mm). **The heat shield is designed to be used on a wall 4 in. to 7-1/4 in. (102 mm to 184 mm) thick.** If wall thickness is less than 4 in. (102 mm) the existing heat shields must be field trimmed. If wall thickness is greater than 7-1/4 in. (184 mm) a DVP-HSM-B will be required.



* Center of the horizontal vent pipe to the vertical measuring surface.

Term Cap	Minimum Effective Length	Maximum Effective Length
Trap1	3-1/8 in.	4-5/8 in.
	79 mm	117 mm
Trap2	5-3/8 in.	9-3/8 in.
	137 mm	238 mm

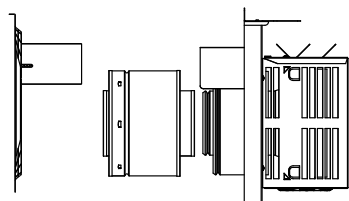

DVP-TRAP1

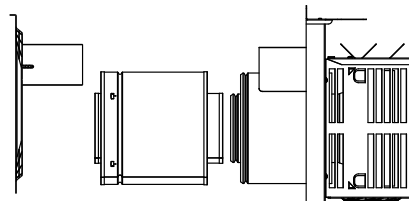

DVP-TRAP2

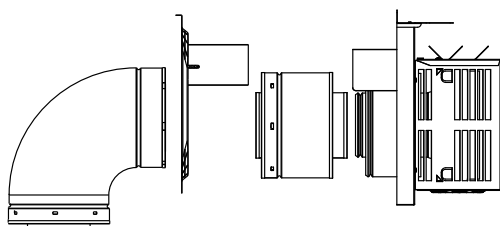

DVP-TRAPK1

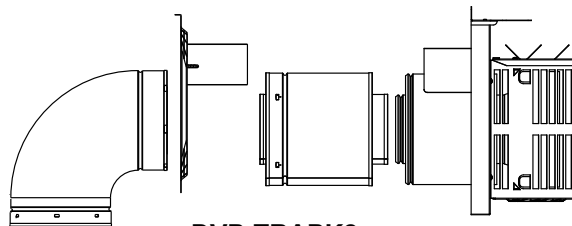

DVP-TRAPK2

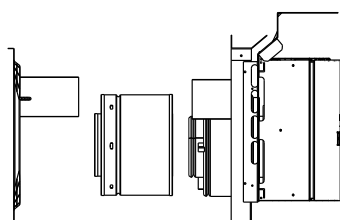

DVP-HPC1
Can adjust 2-1/8 in. (4-1/4 to 6-3/8)

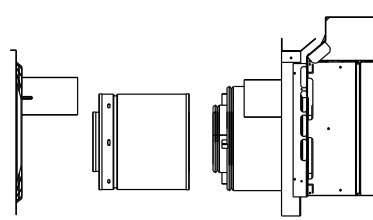

DVP-HPC2
Can adjust 4-1/8 in. (6-3/8 to 10-1/2)

Figure 2 DVP Vent Components

A. DVP Vent Components Diagrams (*continued*)

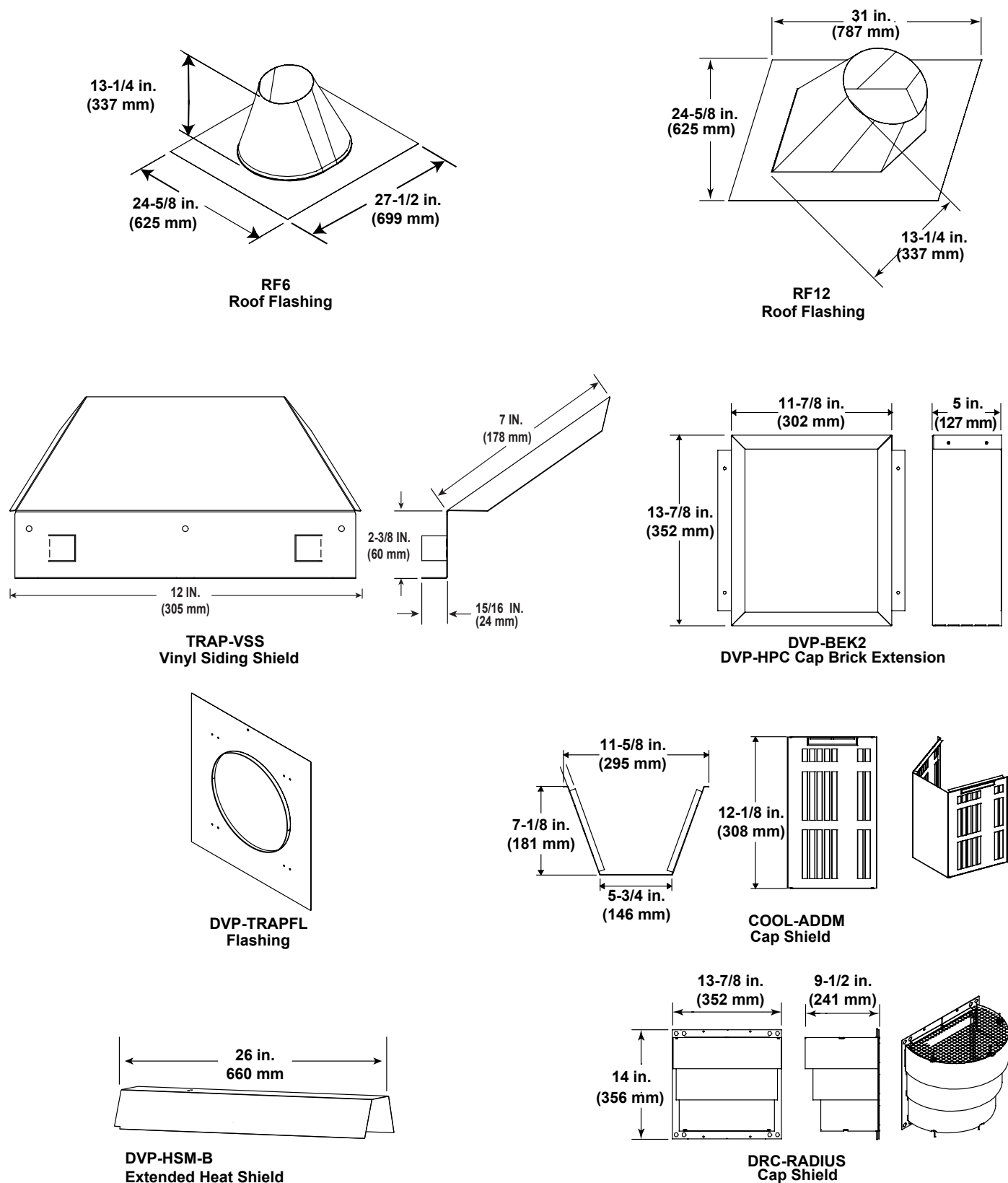
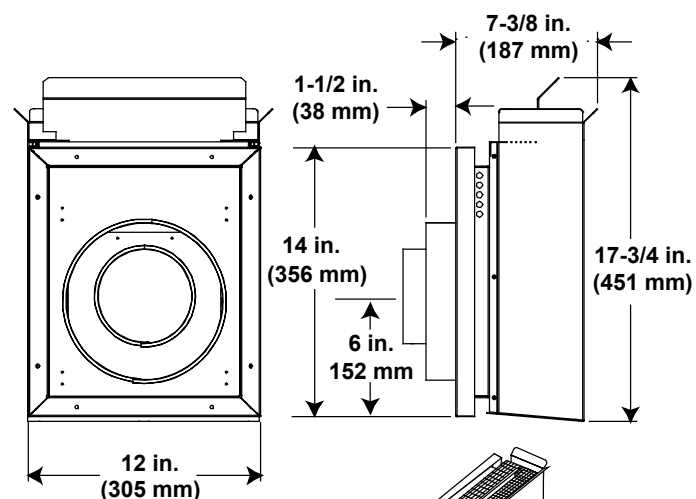
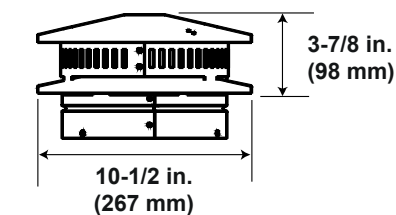

Figure 3 DVP Vent Components

A. DVP Vent Components Diagrams (*continued*)



DVP-TB1
Basement Vent Cap



DVP-TV
Vertical Termination Cap

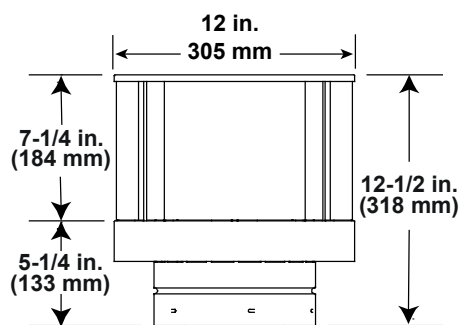
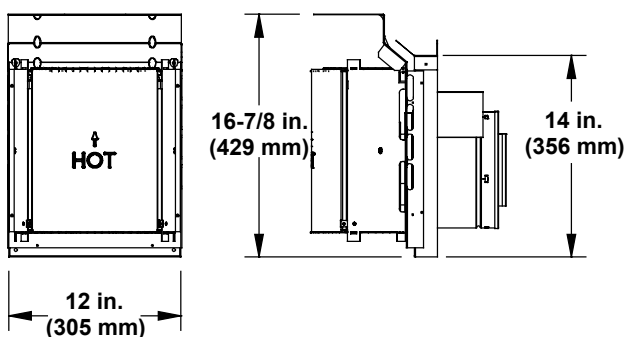

DVP-TVHW
Vertical Termination Cap (Highwind)

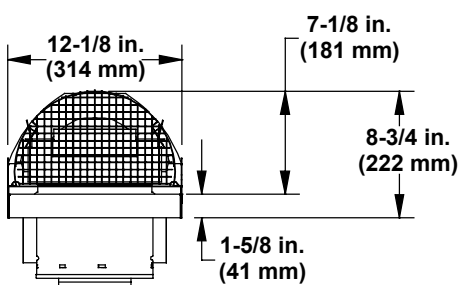

DVP-HPC
High Performance Cap

Figure 4 DVP Vent Components

A. DVP Vent Components Diagrams (*continued*)

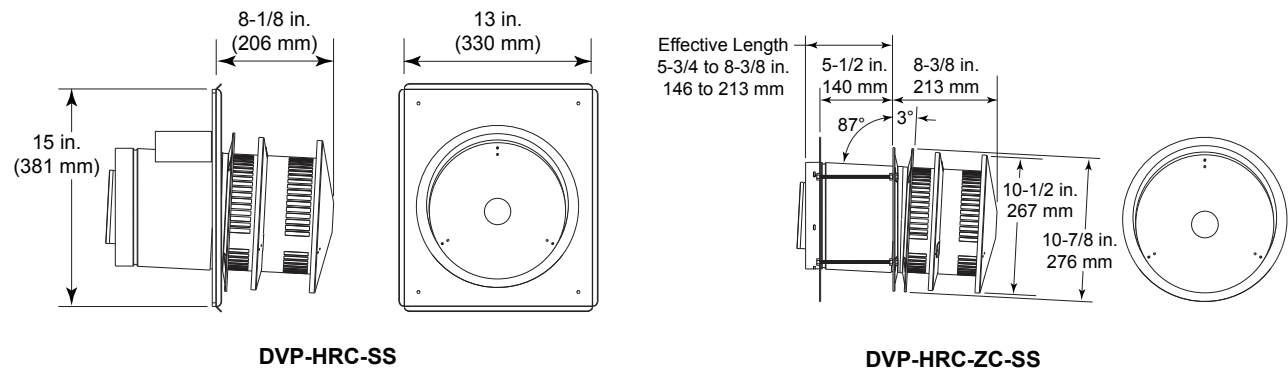

Figure 5 DVP Vent Components

B. SLP Vent Components Diagrams

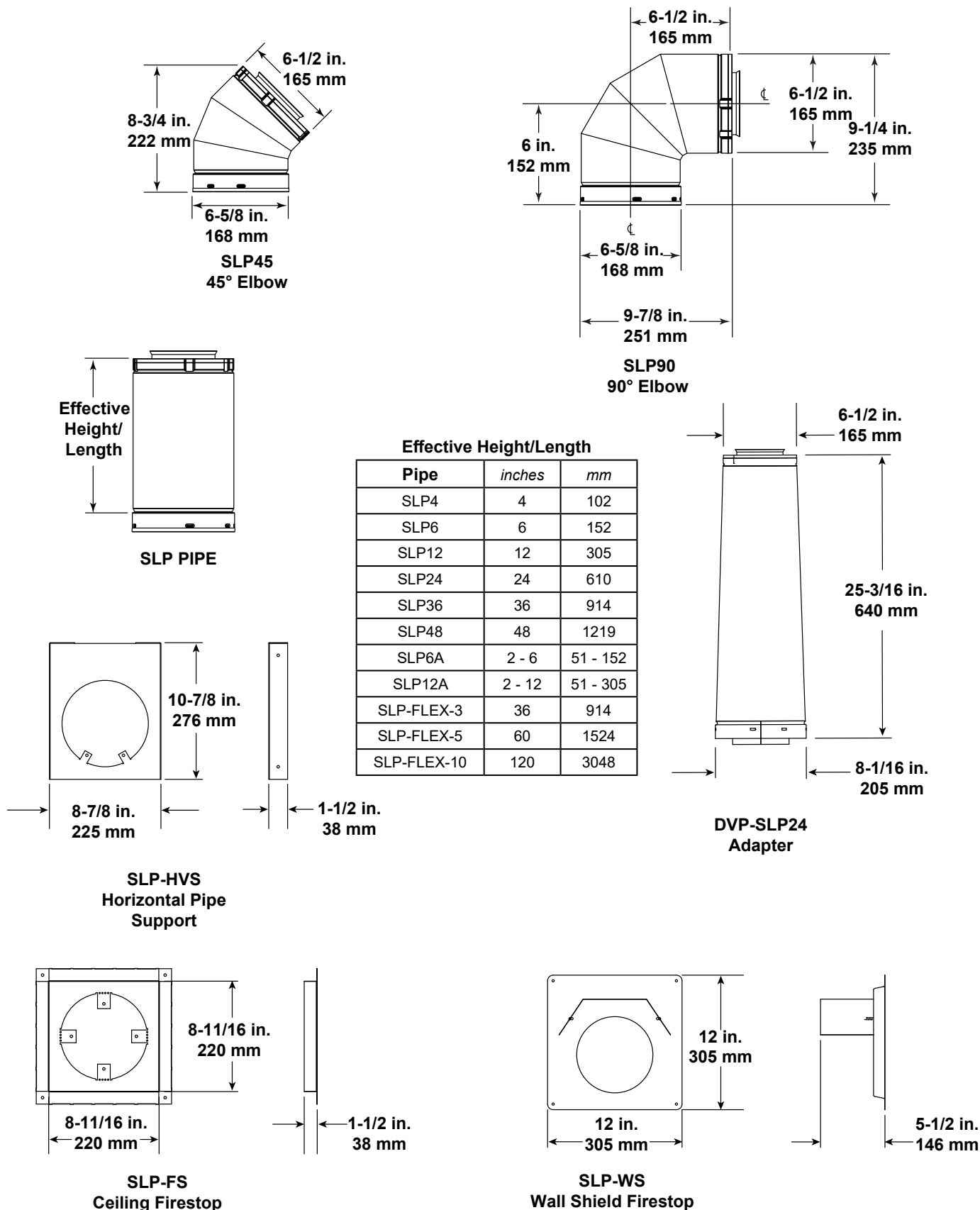
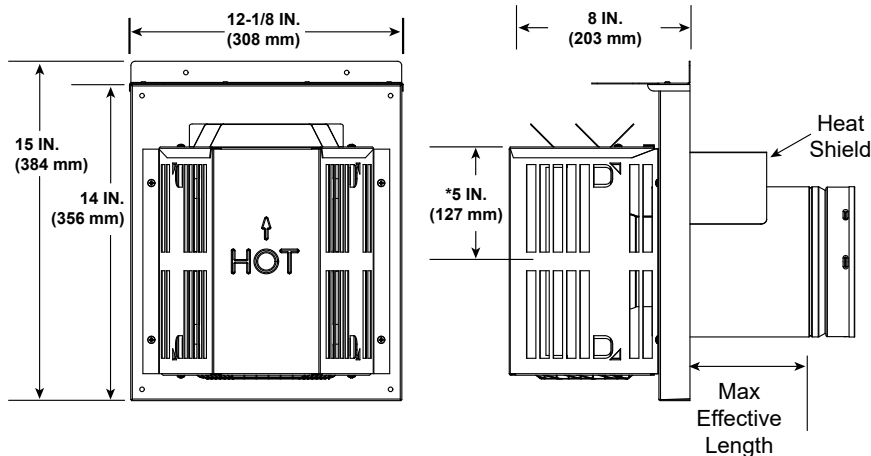

Figure 6 SLP Series Vent Components

B. SLP Vent Components Diagrams (continued)

Note: Heat shields **MUST** overlap by a minimum of 1-1/2 in. (38 mm). The heat shield is designed to be used on a wall 4 in. to 7-1/4 in. (102 mm to 184 mm) thick. If wall thickness is less than 4 in. (102 mm) the existing heat shields must be field trimmed. If wall thickness is greater than 7-1/4 in. (184 mm) a DVP-HSM-B will be required.



Term Cap	Minimum Effective Length	Maximum Effective Length
Trap1	3-1/8 in.	4-3/4 in.
	79 mm	121 mm
Trap2	5-1/4 in.	9-1/4 in.
	133 mm	235 mm

SLP-TRAP
Horizontal Termination Cap

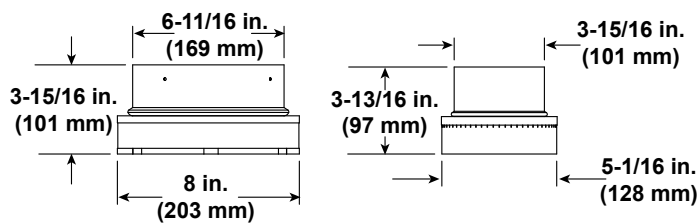

SL-2DVP
Adapter

DVP-2SL
Adapter

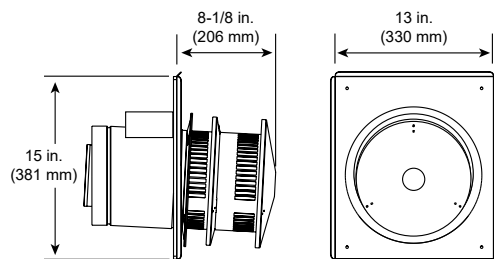

SLP-HRC-SS
Horizontal Termination Cap

DVP-HSM-B
Extended Heat Shield

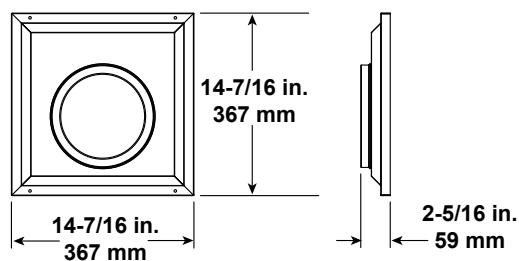

SLP-WT-BK
Wall Thimble-Black

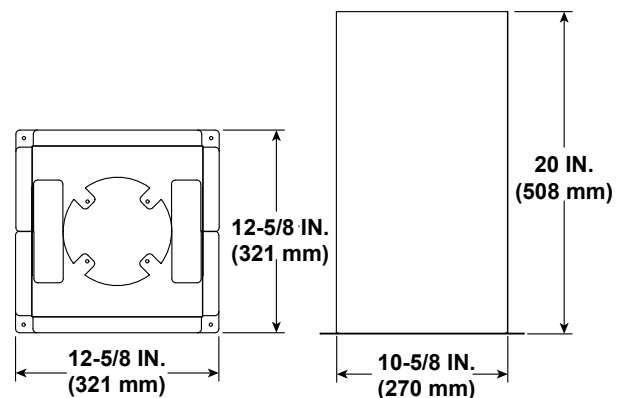

SLP-RDS
ROOF DECK INSULATION SHIELD

Figure 7 SLP Series Vent Components

B. SLP Vent Components Diagrams (*continued*)

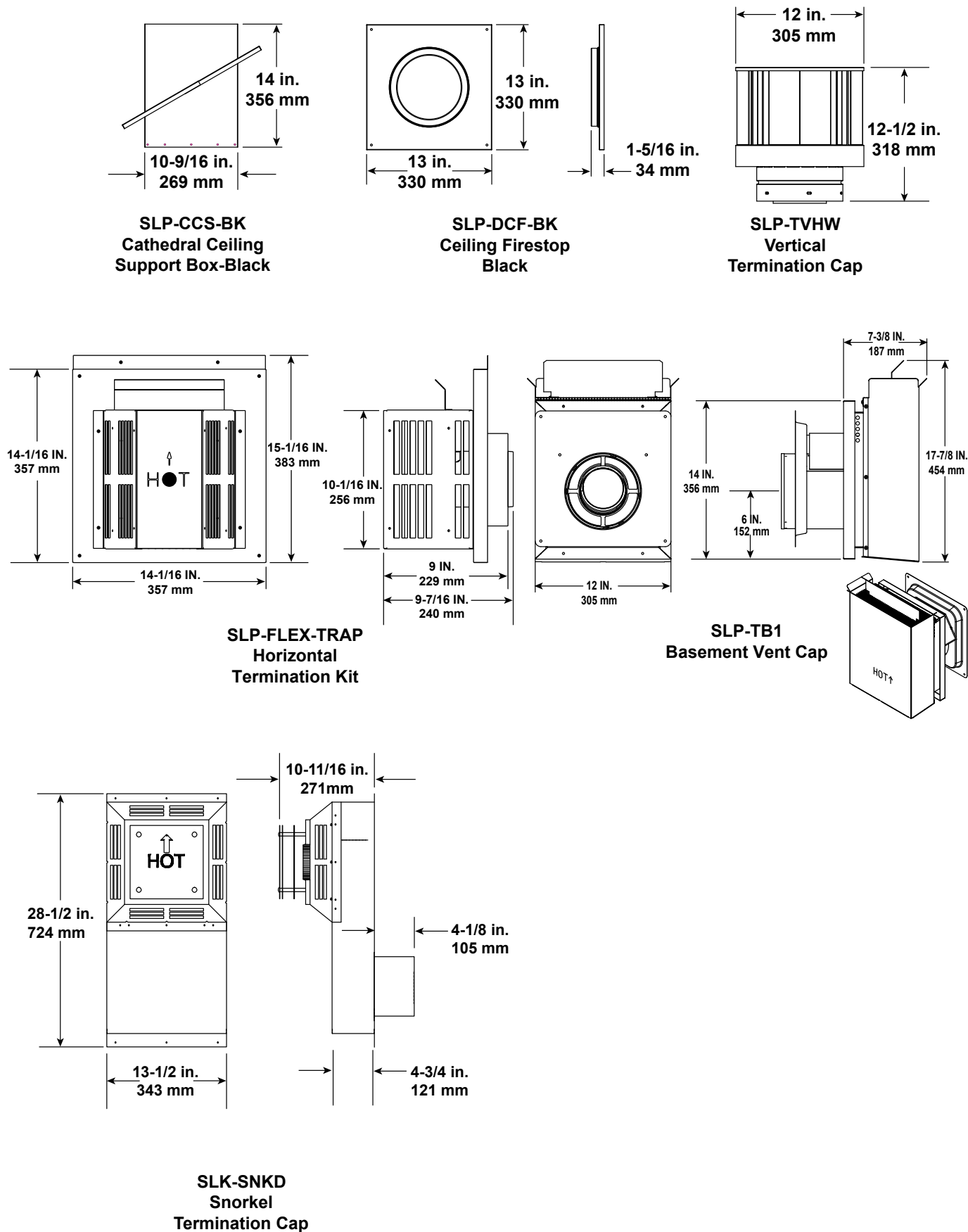
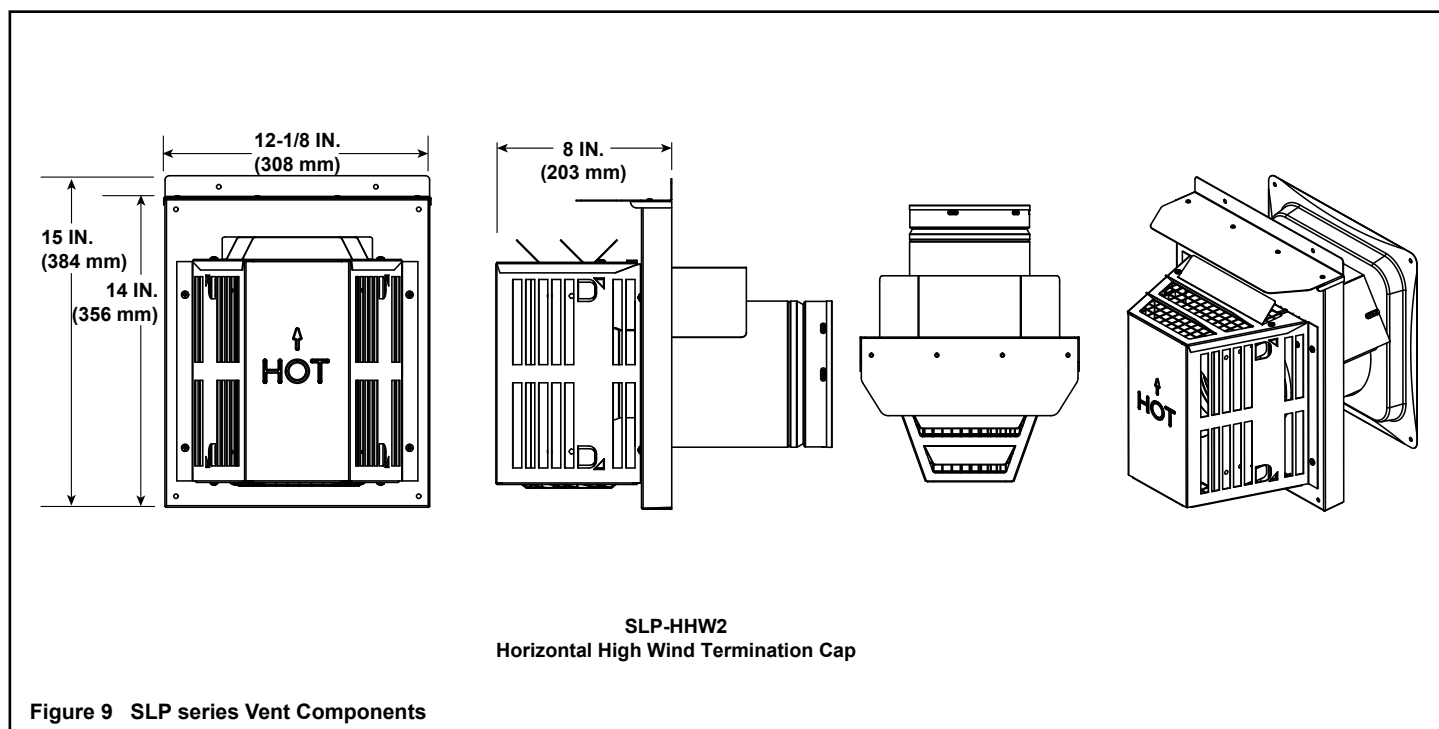
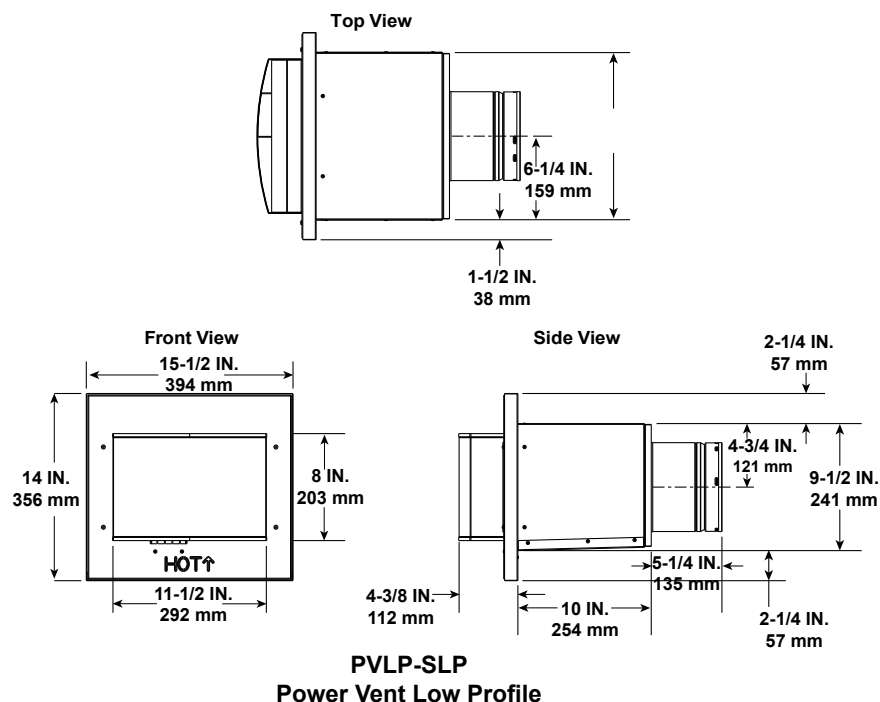

Figure 8 SLP Series Vent Components

B. SLP Vent Components Diagrams (*continued*)



C. Power Vent Components Diagrams



Note: A PVLP-HS heat shield is available and sold separately. Use if the PVLP-SLP is installed in a high traffic area.

Note: Wire harnesses required to power the PVLP-SLP connect to the appliance and are ordered separately from PVLP-SLP. Contact your dealer to order.

Depending on the control system of the appliance, requirements vary. See below. Components are ordered separately from the power vent. Contact your dealer to order.

For Appliances with an IntelliFire or IntelliFire Plus Control System:

A PV-IPI-CK be installed on this appliance.

For Appliances with an IntelliFire Touch Control System:

The PVLP-SLP requires one of the following options to be installed on this appliance.

Option A: IFT-RC400 and/or IFT-WFM, IFT-ACM and IntelliFire App that can be downloaded from the app store.

OR

Option B: IFT-RC150, IFT-ACM, IFT-WFM and an IntelliFire App that can be downloaded from the app store. These accessories are purchased separately from the PVLP-SLP. Contact your dealer to order.

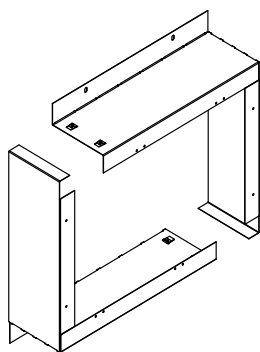

PVLP-BEK
Brick Kit

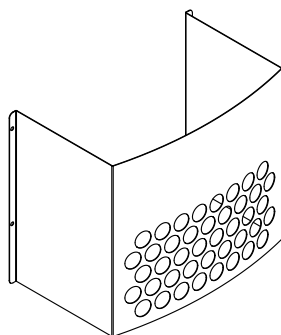

PVLP-HS
Heat Shield

Required Wire Harness	
DESCRIPTION	PART NUMBER
10 FT PV Wire Harness	PVI-WH10
20 FT PV Wire Harness	PVI-WH20
40 FT PV Wire Harness	PVI-WH40
60 FT PV Wire Harness	PVI-WH60
80 FT PV Wire Harness	PVI-WH80
100 FT PV Wire Harness	PVI-WH100

Figure 10 PVLP-SLP Vent Components

C. Power Vent Components Diagrams (*continued*)

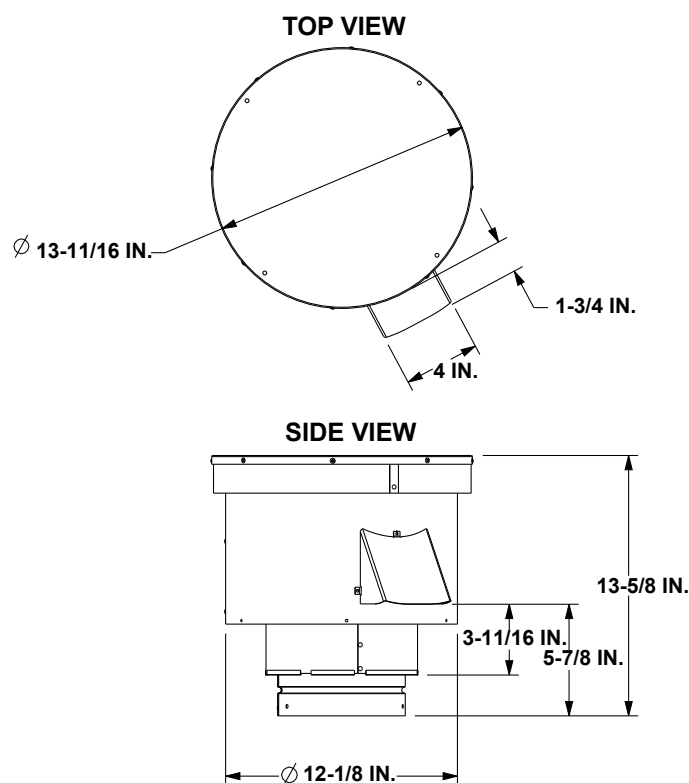

PVV-SLP
Vertical Power Vent

Required Wire Harness and PVV-SLEEVE	
Lengths Available	Part Number
10 ft. PV Wire Harness	PVI-WH10
20 ft. PV Wire Harness	PVI-WH20
40 ft. PV Wire Harness	PVI-WH40
60 ft. PV Wire Harness	PVI-WH60
80 ft. PV Wire Harness	PVI-WH80
100 ft. PV Wire Harness	PVI-WH100
Description	Part Number
12 in. Wire Harness Sleeve	PVV-SLEEVE-12
48 in. Wire Harness Sleeve	PVV-SLEEVE-48

Note: A wire harness is required to power the PVV-SLP and connect it to the appliance. It is ordered separately from the PVV-SLP. Contact your dealer to order.

Note: The PVV-SLEEVE-12 and/or PVV-SLEEVE-48 is required to be installed with the PVV-SLP. It is ordered separately from the PVV-SLP. Contact your dealer to order.

Depending on the control system of the appliance, requirements vary. See below. Components are ordered separately from the power vent. Contact your dealer to order.

For Appliances with an IntelliFire or IntelliFire Plus Control System:

Note: The PVV-SLP requires a PV-IPI-CK be installed on this appliance. The PV-IPI-CK is ordered separately from the PVV-SLP. Contact your dealer to order.

For Appliances with an IntelliFire Touch Control System:

Note: The PVV-SLP requires one of the following options to be installed on this appliance.

Option A: IFT-RC400 and/or IFT-WFM, IFT-ACM and IntelliFire App that can be downloaded from the app store.

OR

Option B: IFT-RC150, IFT-ACM, IFT-WFM and an IntelliFire App that can be downloaded from the app store. These accessories are purchased separately from the PVV-SLP. Contact your dealer to order.

Figure 11 PVV-SLP Vent Components

C. Power Vent Components Diagrams (*continued*)

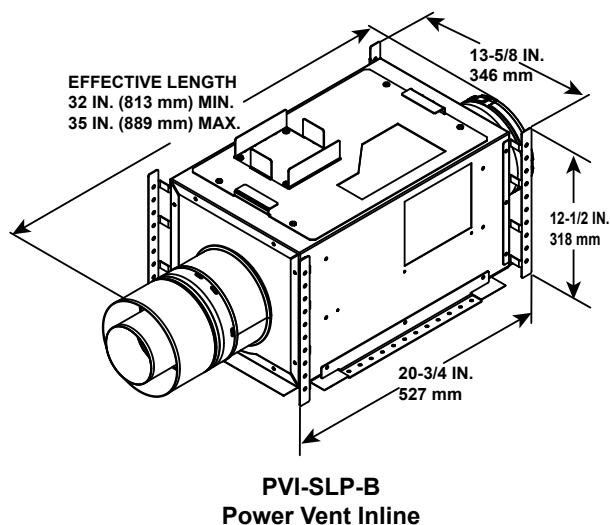

Optional Wire Harness	
DESCRIPTION	PART NUMBER
10 FT PV Wire Harness	PVI-WH10
20 FT PV Wire Harness	PVI-WH20
40 FT PV Wire Harness	PVI-WH40
60 FT PV Wire Harness	PVI-WH60
80 FT PV Wire Harness	PVI-WH80
100 FT PV Wire Harness	PVI-WH100

Note: Wire harnesses required to power the PVI-SLP-B connect to the appliance and are ordered separately from PVI-SLP-B. Contact your dealer to order.

Depending on the control system of the appliance, requirements vary. See below. Components are ordered separately from the power vent. Contact your dealer to order.

For Appliances with an IntelliFire or IntelliFire Plus Control System:

Note: The PVI-SLP-B requires a PV-IPI-CK be installed on this appliance. The PV-IPI-CK is ordered separately from the PVI-SLP-B. Contact your dealer to order.

For Appliances with an IntelliFire Touch Control System:

Note: The PVI-SLP-B requires one of the following options to be installed on this appliance.

Option A: IFT-RC400 and/or IFT-WFM, IFT-ACM and IntelliFire App that can be downloaded from the app store.

OR

Option B: IFT-RC150, IFT-ACM, IFT-WFM and an IntelliFire App that can be downloaded from the app store. These accessories are purchased separately from the PVI-SLP-B. Contact your dealer to order.

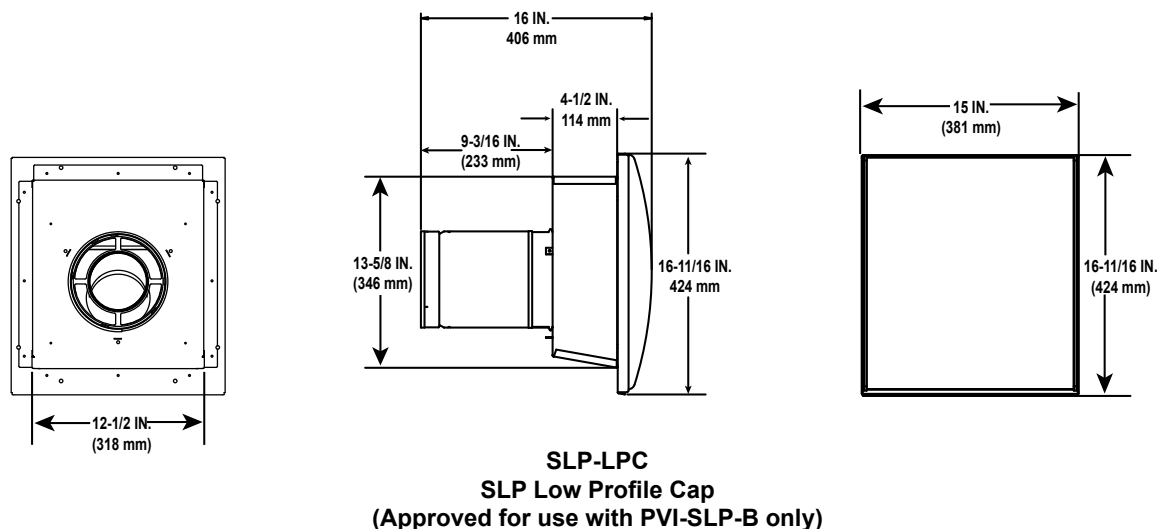
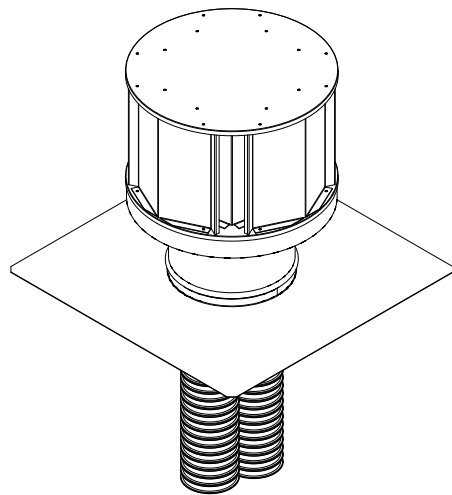

Figure 12 PVI-SLP-B Vent Components

D. Coaxial / Colinear Components Diagrams

COAXIAL to COLINEAR VENTING



LINK-DV30B
Flex Liner Kit



768-380A
Stainless Steel Flex Pipe

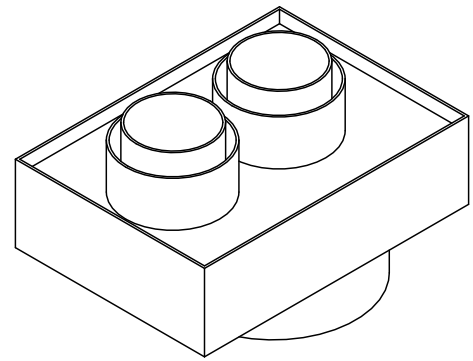

DV-46DVA-GCL
Coaxial/Colinear Appliance Connector

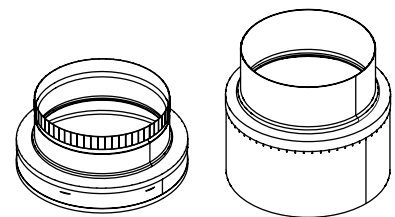

DVP-2SL
Adapter

Figure 13 Coaxial / Colinear Vent Components

E. Decorative Terminations / Shrouds

Only use listed decorative termination caps/shrouds with Hearth & Home Technologies approved venting systems. This applies to both DVP and SLP venting systems.

Decorative Terminations Caps/Shrouds

DTO134 Octagon Decor Cap
DTO146 Octagon Decor Cap

DTS134 Square Decor Cap
DTS146 Square Decor Cap

LDS33 Decor Shroud 36 x 36
LDS46 Decor Shroud 48 x 72
LDS-BV Decor Shroud 26 x 26