

POWER CORD KIT

Installation Instructions

CAUTION! Risk of Cuts, Abrasions or Flying Debris. Wear protective gloves and safety glasses during installation. Sheet metal edges are sharp.

KIT CONTENTS:

- (1) Power Cord Assembly
- (1) Ground Screw
- (1) Strain Relief

TOOLS NEEDED:

- Power Drill
- 1/4" Bit
- Pliers

Installation Instructions

1. Turn appliance off and ensure it is cool. Disconnect electrical power to appliance.

CAUTION! Risk of Burns! Appliance must be turned off and cooled prior to installation of this kit.

CAUTION! Risk of Shock! Disconnect electrical power prior to installation of this kit.

2. Remove cover plate and fans (6 screws). See Figure 1.

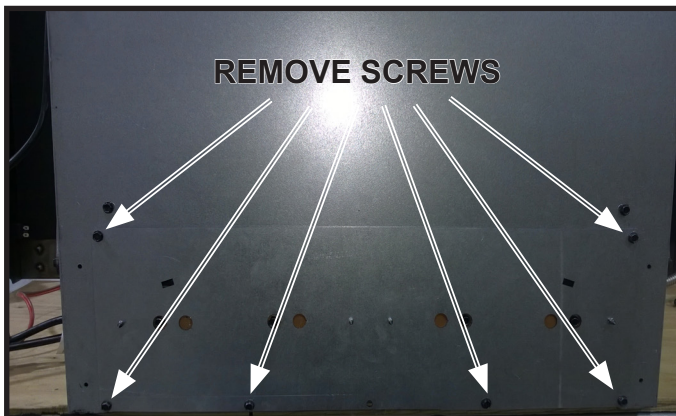

Figure 1. Removal of Cover Plate and Fans

3. Remove side plate (2 screws) on the left side of the unit. See Figure 2.

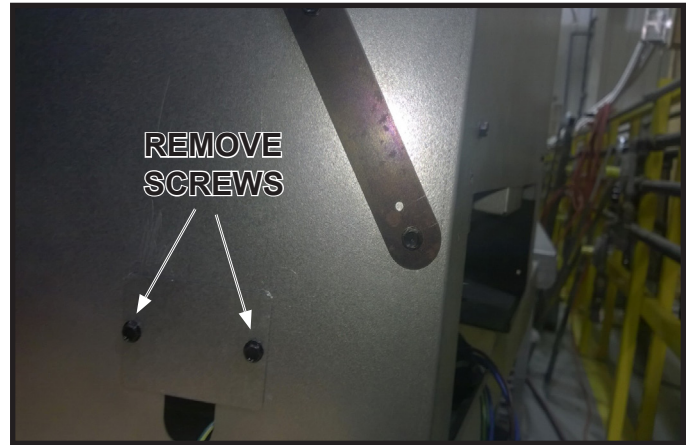

Figure 2. Remove Side Plate

3. Place the power cord assembly into the hole located on left side of unit.
4. Plug white connection (power cord assembly) into fan connection plug. See Figure 3.

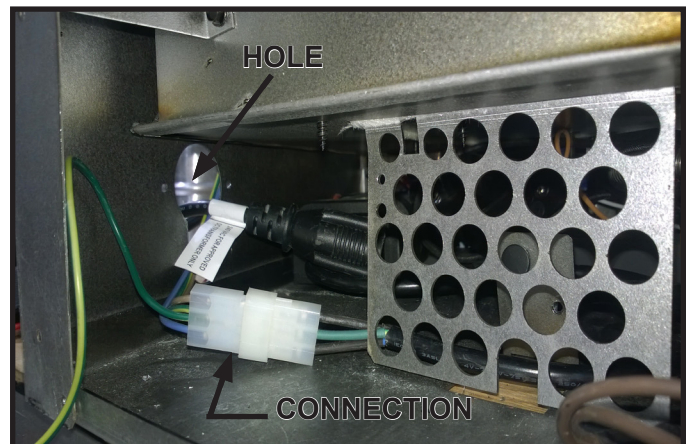

Figure 3. Plug Connection

5. Attach ground wire to upper bracket using ground screw (provided). See Figure 4.

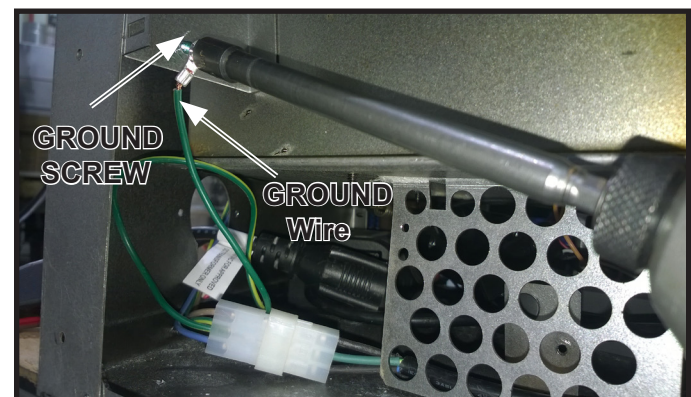

Figure 4. Attaching Ground Wire

6. Plug transformer into power cord. See Figure 5.

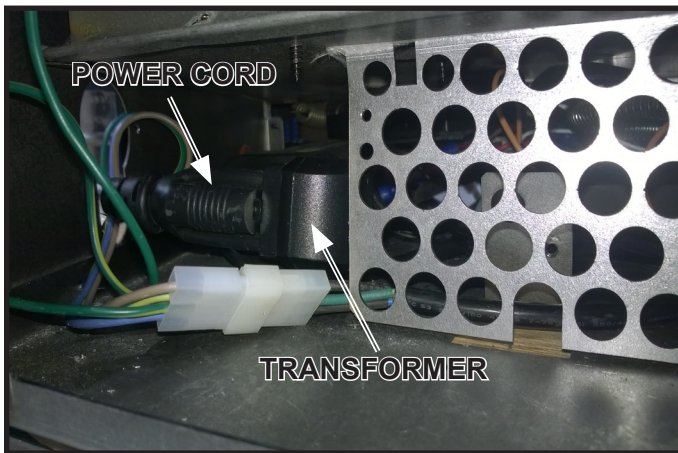

Figure 5. Plug Power Cord into Transformer

7. Push the transformer and cord to the front of the unit.
8. Replace fans and cover plate that was removed in Step 2. See Figure 1.

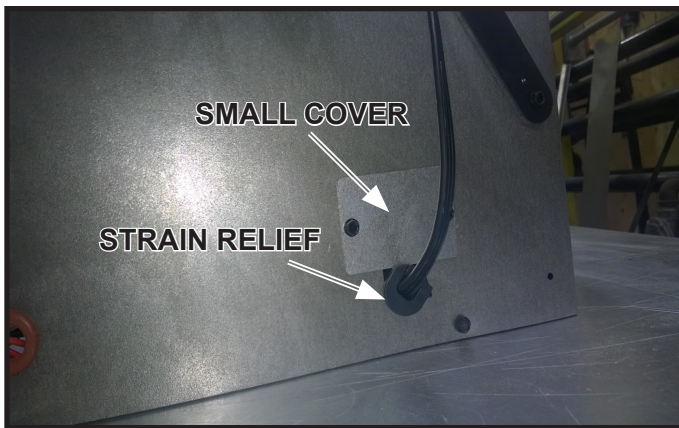

Figure 6. Small Cover and Strain Relief

9. Put the Strain Relief on power cord. Using a pliers, compress the Strain Relief and press into the hole on left side of unit.
10. Replace small cover plate to hold Strain Relief in place. See Figure 6.

Please contact your Hearth & Home Technologies dealer
with any questions or concerns.
For the location of your nearest Hearth & Home
Technologies dealer,
please visit www.hearthnhome.com.

Hearth & Home Technologies
7571 215th Street West, Lakeville, MN 55044
www.hearthnhome.com