

PRIMO CLEAN FACE FINISH

PRIMO48-CF, PRIMO48ST-CF, PRIMO60-CF, PRIMO60ST-CF, PRIMO72-CF, PRIMO72ST-CF

MODELS: PRIMO48, PRIMO48ST, PRIMO60, PRIMO60ST, PRIMO72, PRIMO72ST

Installation Instructions



Leave this manual with party responsible for use and operation.

CAUTION! Risk of Cuts, Abrasions or Flying Debris. Wear protective gloves and safety glasses during installation. Sheet metal edges are sharp.

This appliance comes standard with patented SafeSurface™ Glass which keeps the surface temperature of the barrier glass at a safe level and will still be hot to the touch when operated for long periods of time.

If the barrier glass is removed, the inner glass temperature will be very hot and cause burns.

DANGER



HOT GLASS WILL CAUSE BURNS.

DO NOT TOUCH GLASS UNTIL COOLED.

NEVER ALLOW CHILDREN TO TOUCH GLASS.

A barrier designed to reduce the risk of burns from the hot viewing glass is provided with this appliance and shall be installed for the protection of children and other at-risk individuals.

WARNING! Risk of Fire! Combustible materials **MUST NOT** overlap or be placed behind a decorative front.

CAUTION! Do not install damaged components.

WARNING! Risk of Fire! DO NOT apply combustible materials beyond the minimum clearances. Comply with all minimum clearances to combustibles as specified in appliance installation manual.

Note: To avoid potential damage to hearth pad or flooring, protect area in front of fireplace by laying cardboard or blanket down.

Clean Face Finish (Black Glass Interior)

**PRIMO48-CF PRIMO48ST-CF
PRIMO60-CF PRIMO60ST-CF
PRIMO72-CF PRIMO72ST-CF**

The PRIMO appliance can be finished with 1/2 inch sheetrock. Non-combustible finishing is not required. During operation, the sheetrock will remain cool to the touch.

Facing and Finishing - General Information

WARNING! Risk of Fire! Comply with all minimum clearances to combustibles as specified. Framing closer than the minimums listed must be constructed entirely of noncombustible materials (i.e., steel studs, concrete board, etc.).

Splatter Guard

The splatter guard is a piece of corrugated material used to protect the appliance during the installation process before finishing work on the whole hearth is complete. A splatter guard is factory-installed on PRIMO models. Splatter guards must be removed before appliance is fired.

WARNING! Risk of Fire! Remove the splatter guard before lighting the appliance. Shut off gas to the appliance when the splatter guard is in place to prevent accidental operation.

Finishing Instructions

It is important to follow the framing and finishing instructions to ensure proper placement of fireplace into the surrounding framing/finishing materials.

Wall sheathing materials 1/2 in. thick are specified

in this installation manual to properly align with the optional finishing methods offered with this appliance. The PRIMO may be finished to the appliance opening with 1/2 inch thick sheetrock.

- Ensure that the one inch back clearance and one inch side clearances are maintained.

WARNING! Risk of Fire! Maintain specified air space clearances to combustibles. Inadequate air space could cause overheating and fire.

WARNING! Risk of Fire, Explosion or Asphyxiation! **DO NOT** use screws more than 3/4 inch long on lower access cover panel. Longer screws may penetrate gas line or damage valve or electrical components.

The appliance is designed to be used with 1/2 in. wall sheathing materials such as drywall, plywood, wood composites, or non-combustible materials.

Note: It is acceptable to use a high temperature silicone sealant to adhere drywall to lower access cover panel.

Finish and Sealing Joints

All joints between the finished wall sheathing and the appliance must be sealed with non-combustible materials. Sealants, such as caulk or mastic used to seal the gap between the wall and the fireplace, should be rated at a minimum continuous exposure to 300°F.

Facing Material

- Facing and/or finishing materials must never overhang into the glass opening. See Figure 2.
- Facing materials may be combustible or non-combustible.

WARNING! Risk of Fire! DO NOT apply combustible materials beyond the minimum clearances. Comply with all minimum clearances to combustibles as specified in this manual. Overlapping materials could ignite and will interfere with proper operation.

Painting

If desired finishing includes a painted wall, 100% acrylic latex, oil-based or standard acrylic paints may be used. Follow paint manufacturer's instructions for paint and primer application.

WARNING! Risk of Injury! Risk of Explosion! Install fasteners as instructed.

- Gas train could be damaged causing a gas leak.
- Electrical components could be damaged causing electrical shock.
- LED'S could be damaged.
- Glass installation could be obstructed.

Note: It is acceptable to use a high temperature silicone sealant to adhere drywall to lower access cover panel.

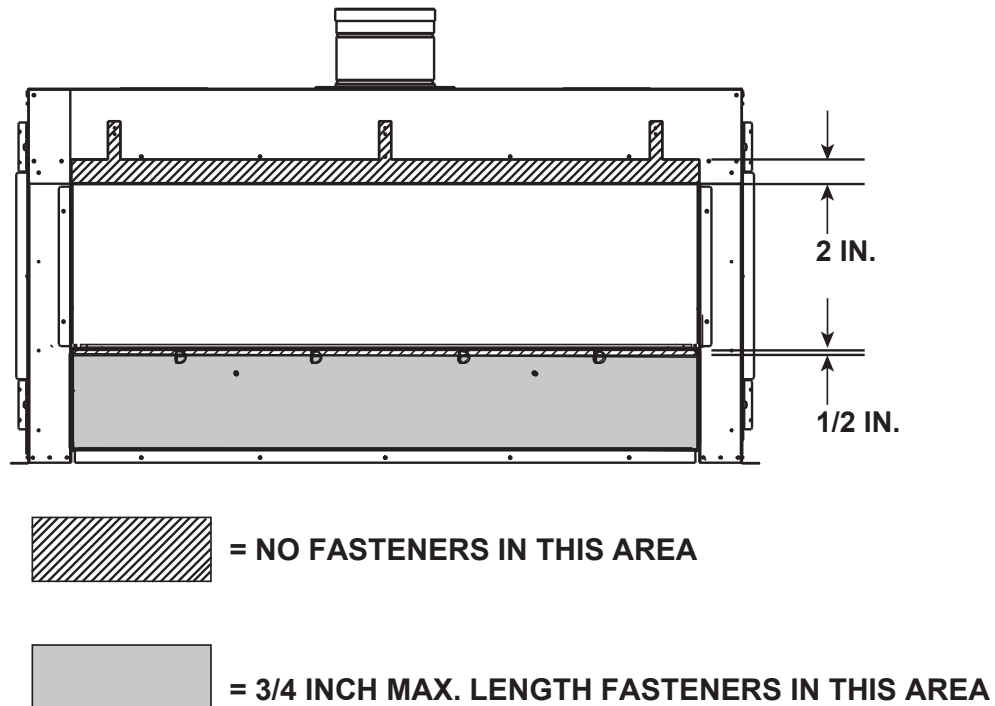

Figure 1. Screw Length Requirements

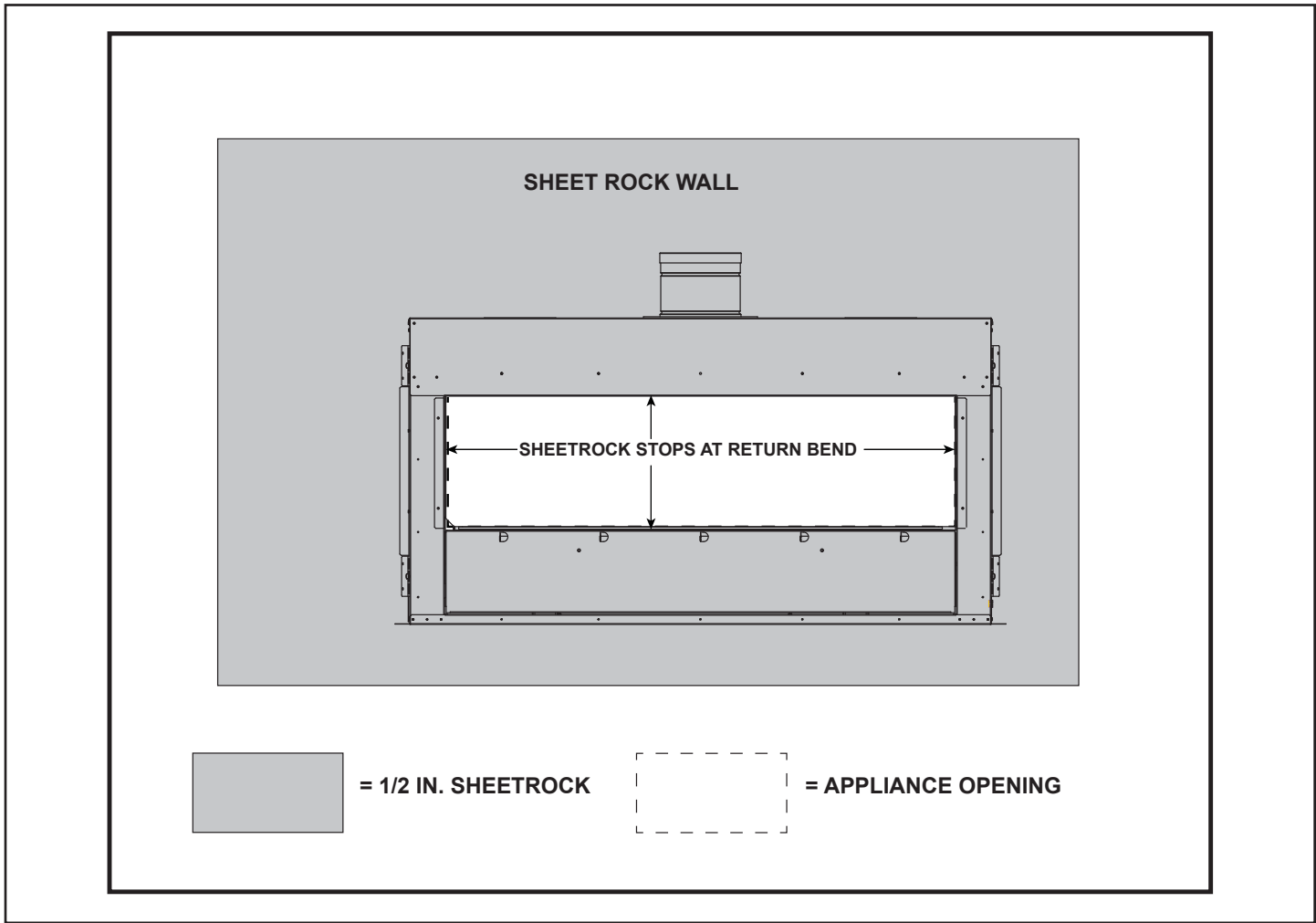

Figure 2. Sheetrock Detail for Both Finishing Methods

The PRIMO appliance can be finished with 1/2 inch sheetrock. Non-combustible finishing is not required.

Preparation

1. Install 1/2 inch sheetrock on wall. Figure 3 shows the PRIMO installed. Sheetrock (1/2 inch) has been installed up to the top, bottom and sides of appliance opening as shown in Figure 2 and 3. See the appliance installation manual for more details regarding facing material.

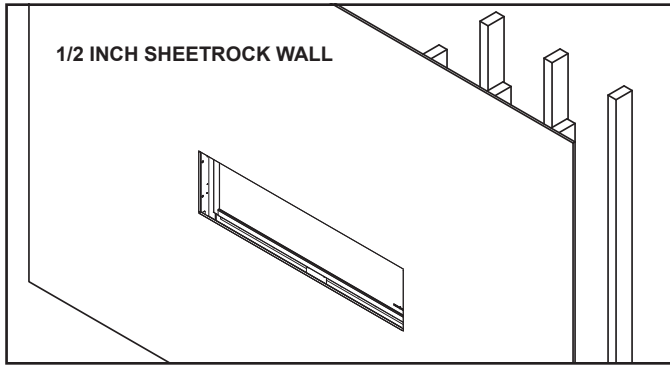

Figure 3.

2. Install sheetrock trim strips as shown in Figure 4 on all sides of appliance. Sheetrock trim strips are included with the appliance. Cut the strips to the required length and install them using staples. See Figure 4 for placement of trim strips.

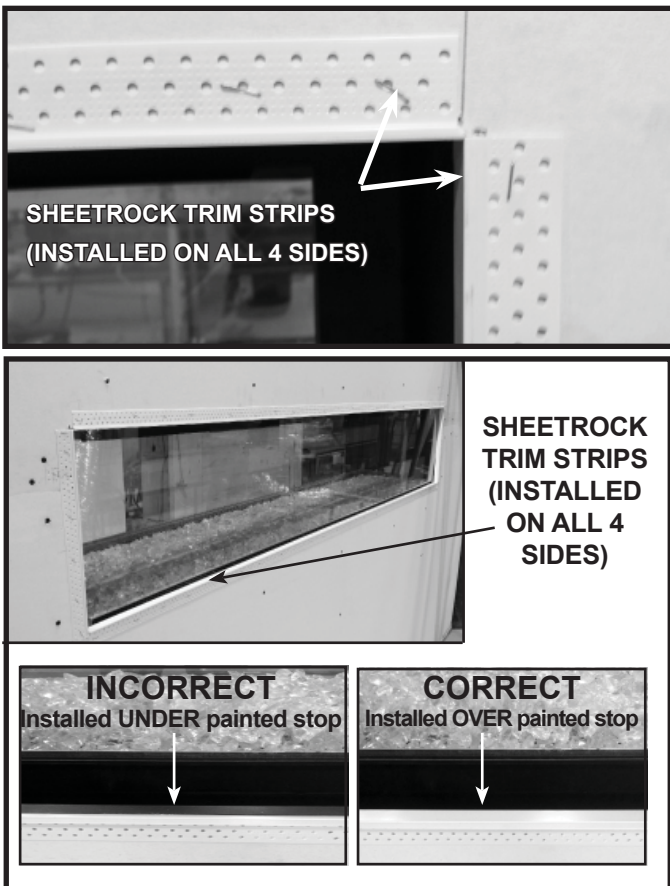

Figure 4. Install Sheetrock Trim Strips

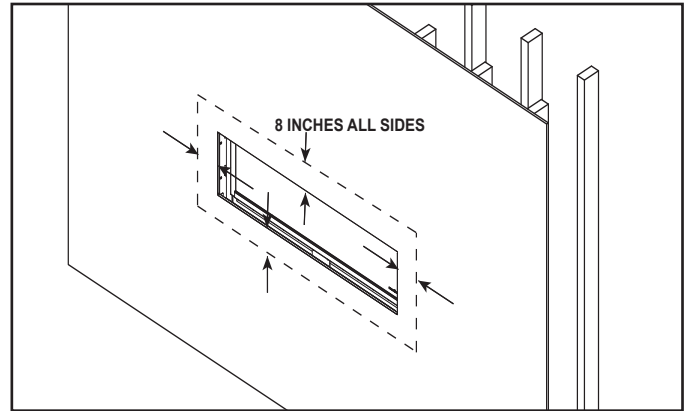

Figure 5. Feather Mud Evenly

4. Glass Panel Instructions

KIT COMPONENTS

- (1) Left Glass Panel
- (1) Right Glass Panel
- (1) Back Glass Panel (Single-sided models only)
- (3) Glass Retaining Brackets
- (2) Glass Clips
- (1) Barrier Glass* (Qty 2 on See-Through models)

*See appliance installation manual for barrier glass installation instructions.

Single-Sided Models:

Set back glass panel, in location A in Figure 6 into firebox. Back panel will sit on the heads of the screws holding the media tray in place. Set back glass panel against the back wall of the firebox with the smooth side of the glass facing outward. Place retaining bracket over panel so holes in the bracket are against the firebox back. Use two self-drilling screws to secure to the firebox back. Ensure glass panel is stationary. See Figure 7.

Position the glass clip as shown in Figure 8.

NOTICE: Fasteners are not used with glass clip.

Set left side glass panel, in location B in Figure 6, into firebox with the smooth side facing outward. Place retaining bracket over panel so holes in the bracket are against the firebox side. Use two self-drilling screws to secure to the firebox side. See Figure 7. Ensure glass panel is stationary.

Repeat for right side panel.

See-Through Models:

Position the glass clip as shown in Figure 8.

NOTICE: Fasteners are not used with glass clip.

Set left side glass panel, labeled B in Figure 6, into firebox with the smooth side facing outward. Place retaining bracket over glass panel so holes in the bracket are against the firebox side. Use two self-drilling screws to secure the bracket to the firebox side. See Figure 7. Repeat for right side panel.

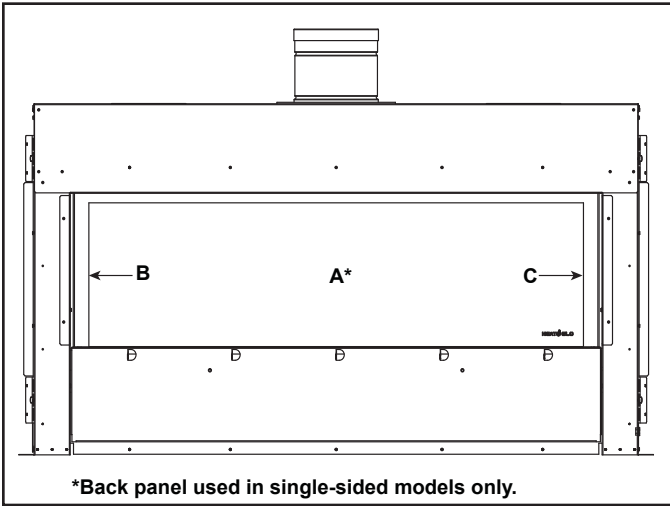

Figure 6. Placement of Panels

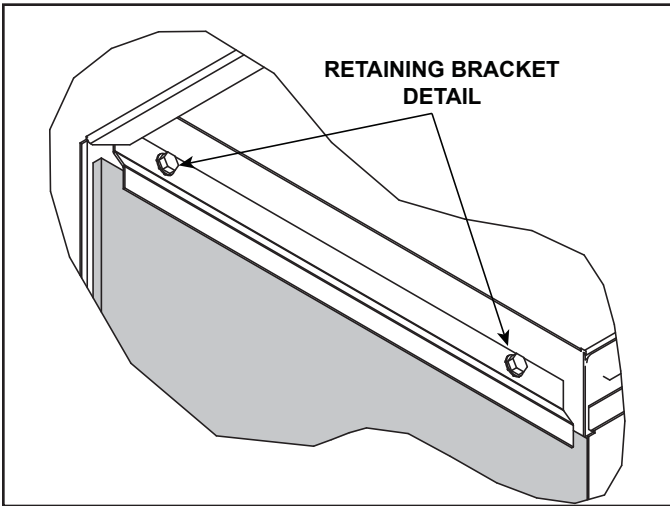

Figure 7. Retaining Bracket Installation

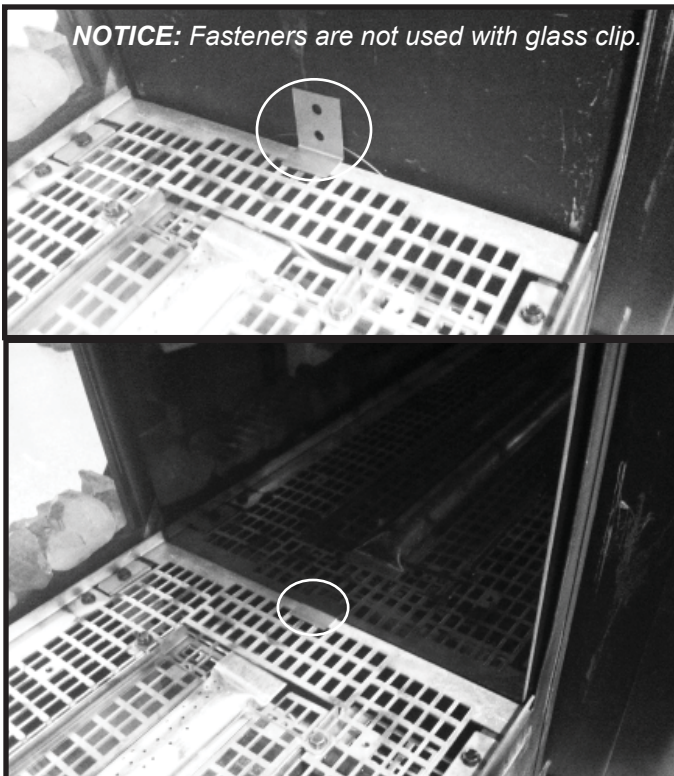

Figure 8. Position Glass Clip and Install Glass Panel

5. Break the barrier glass support into two pieces as shown in Figures 9 and 10. Make the hand bends as shown in Figure 11 to form the glass supports

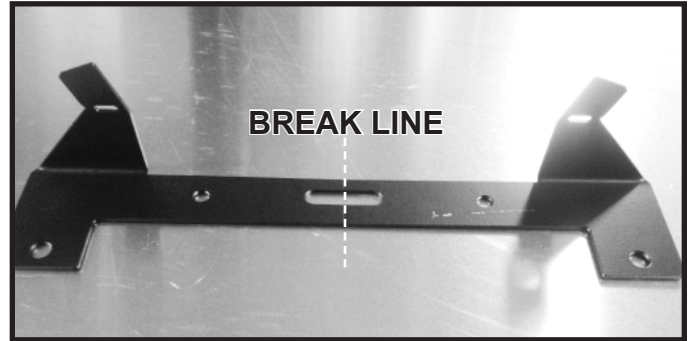

Figure 9. Barrier Glass Support

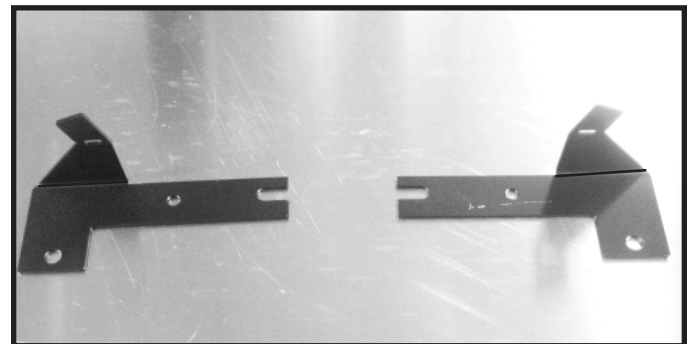

Figure 10. Break Barrier Glass Support

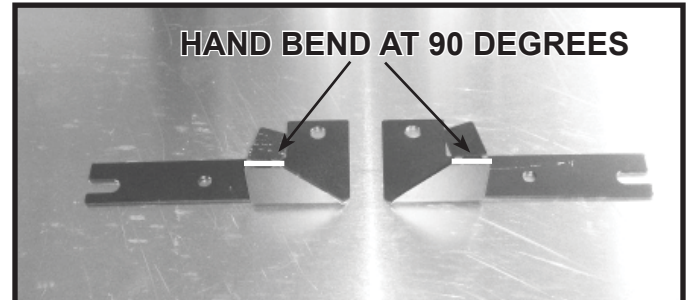

Figure 11. Form Barrier Glass Support

6. Install barrier glass supports on bottom left and right sides using an existing screw, a self-tapping screw, and shoulder bolt. See Figure 12 and 13. Install rubber bumpers as shown in Figure 12 to protect the barrier glass.



Figure 12. Install Barrier Glass Supports

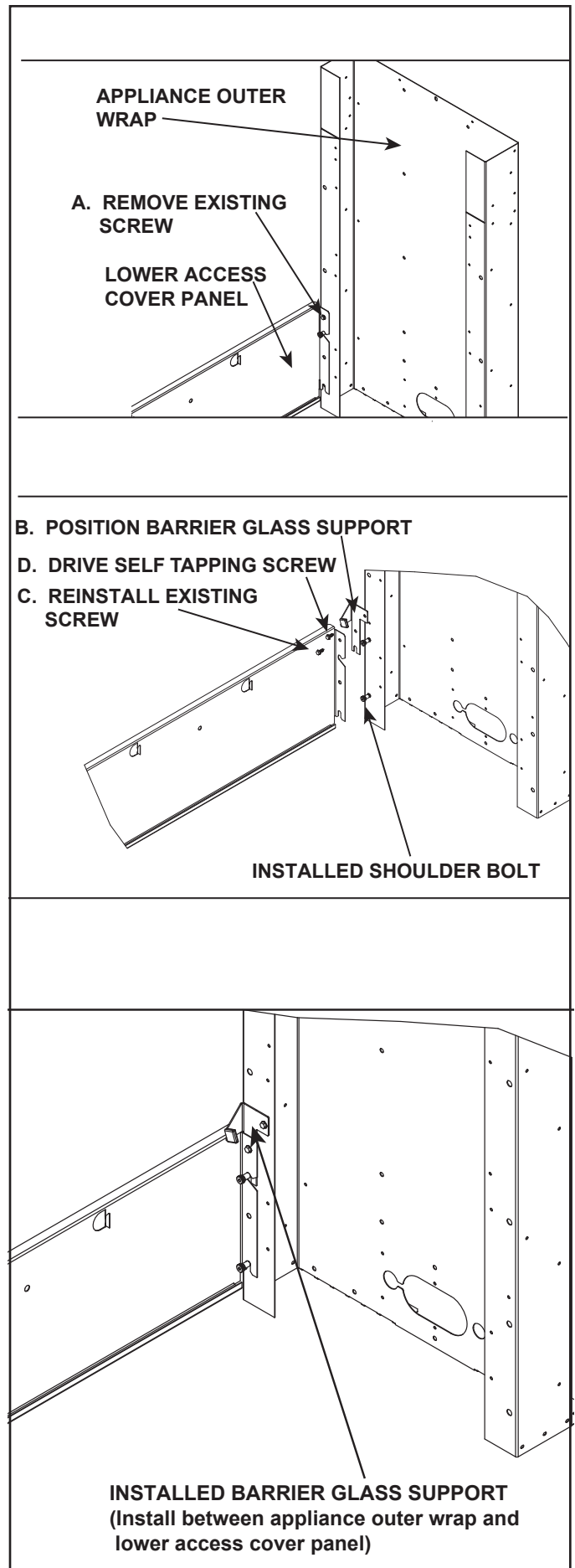

Figure 13. Install Barrier Glass Supports

- Set transition media tray into position as shown in Figure 16. The return bends are at the bottom of the tray. The rear return bend should be positioned in between the glass frame and the glass frame bracket. Ensure tray is positioned flush with appliance opening.

- Install glass transition panel bracket on left and right sides of appliance opening using two self-tapping screws. See Figures 14, 15 and 16 for details.
- Install transition glass panels by securing with tabs on left and right sides of appliance. See Figures 16 and 17.

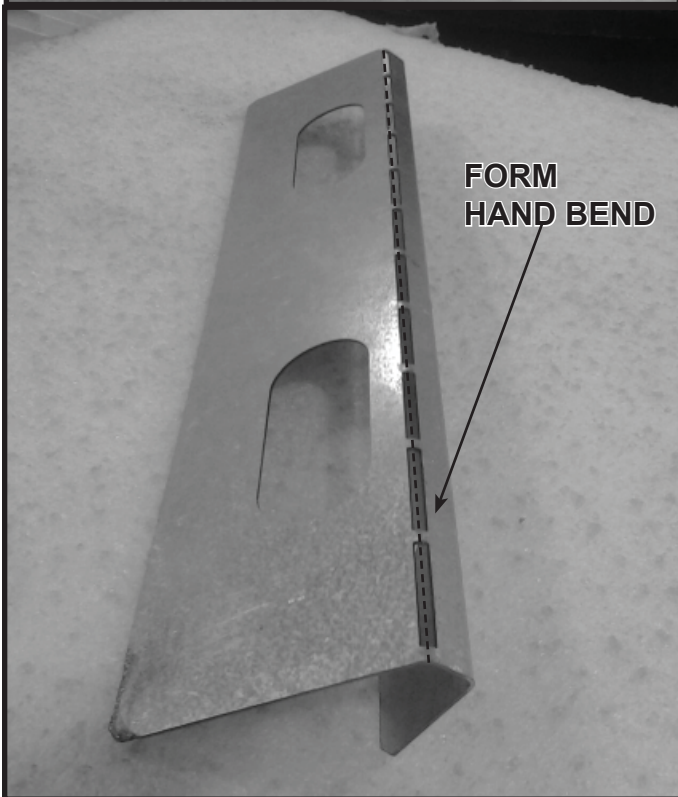

Figure 14. Form Transition Glass Panel Bracket

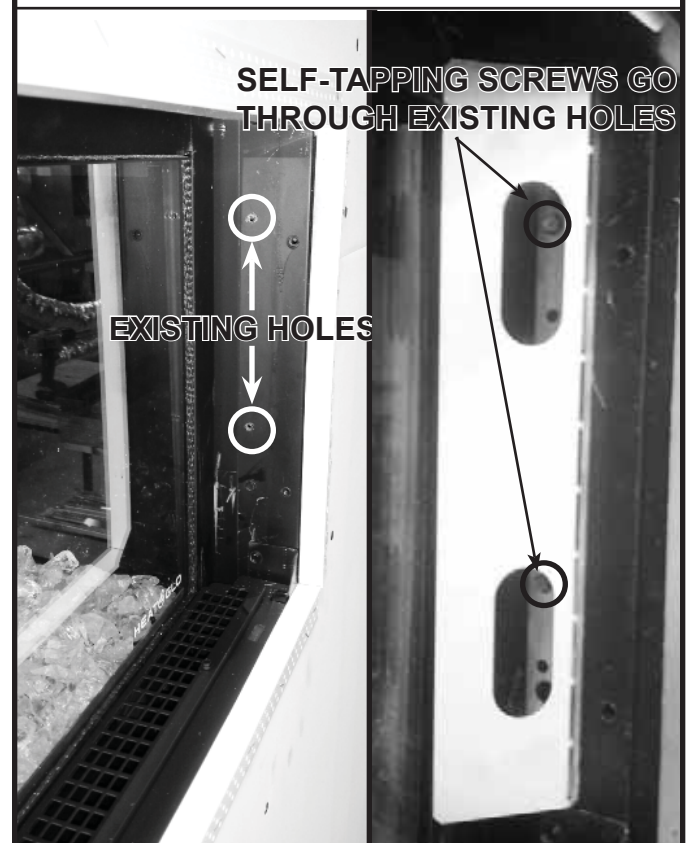
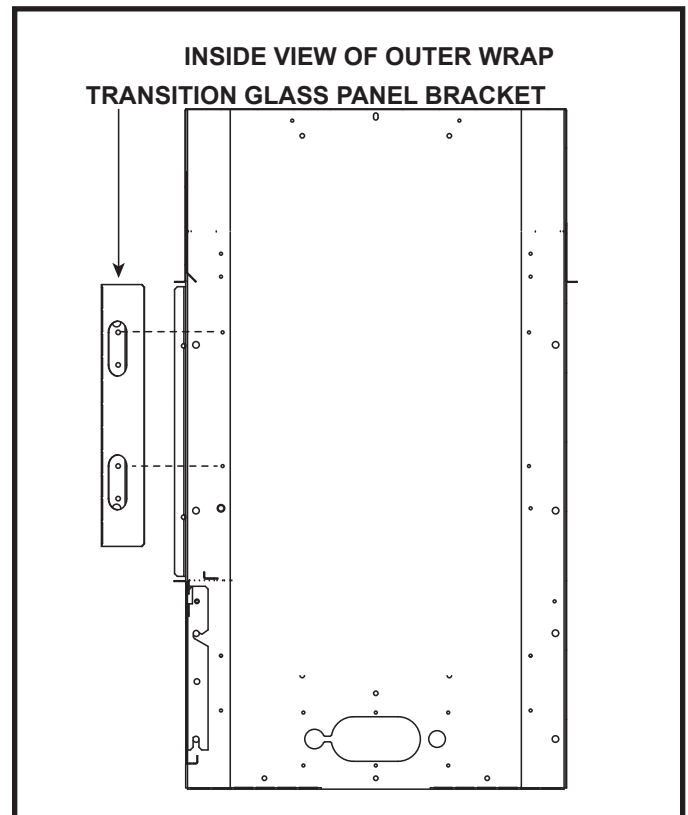

Figure 15. Install Transition Glass Panel Bracket

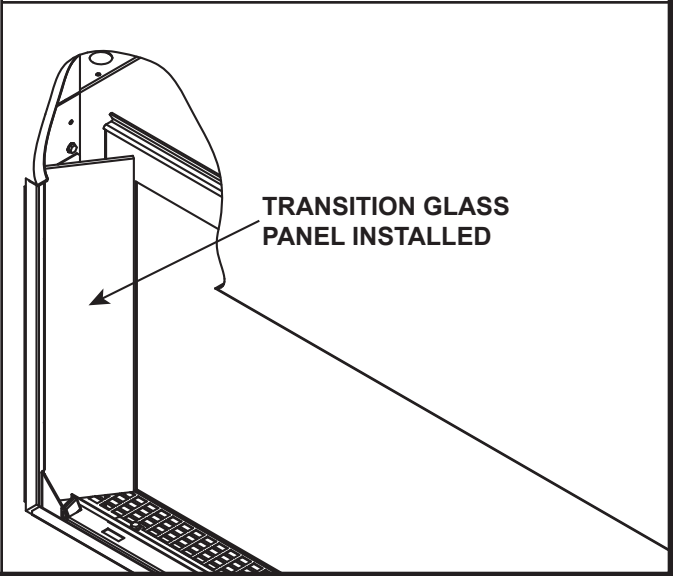
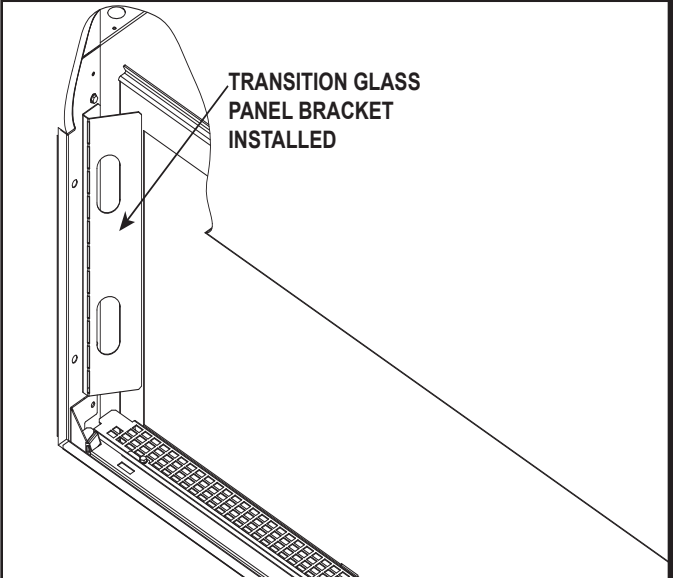
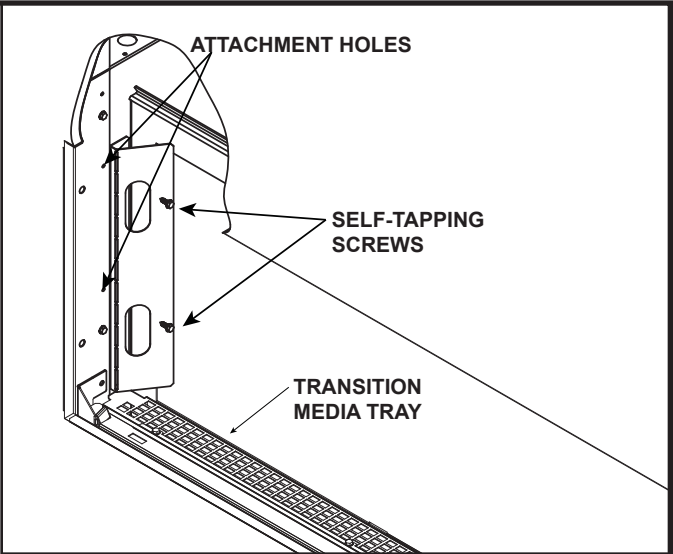
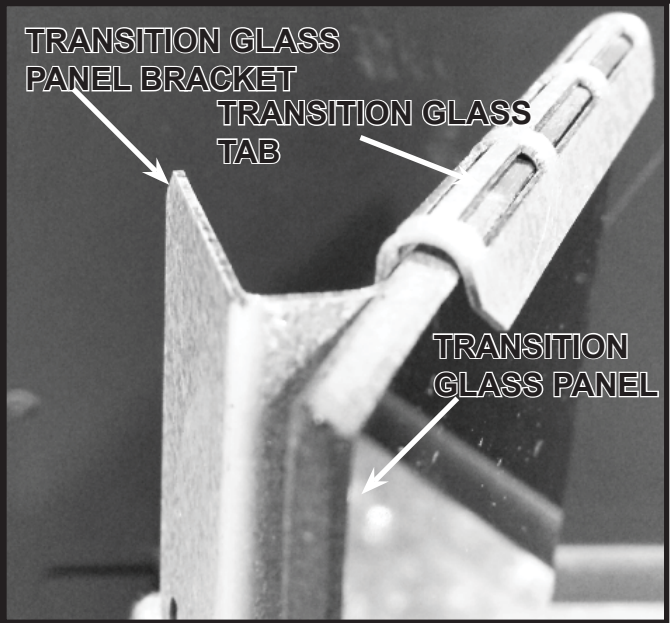
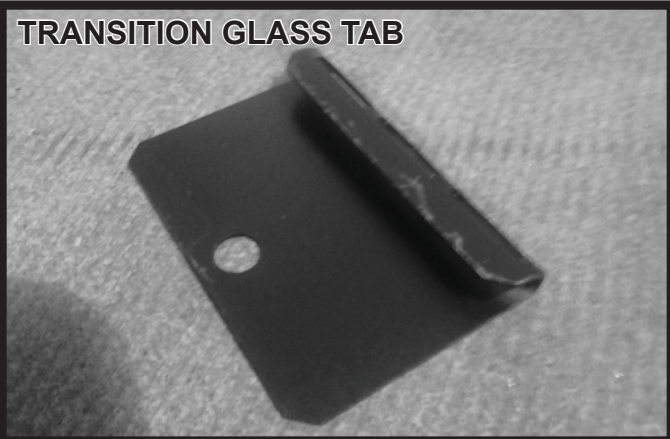
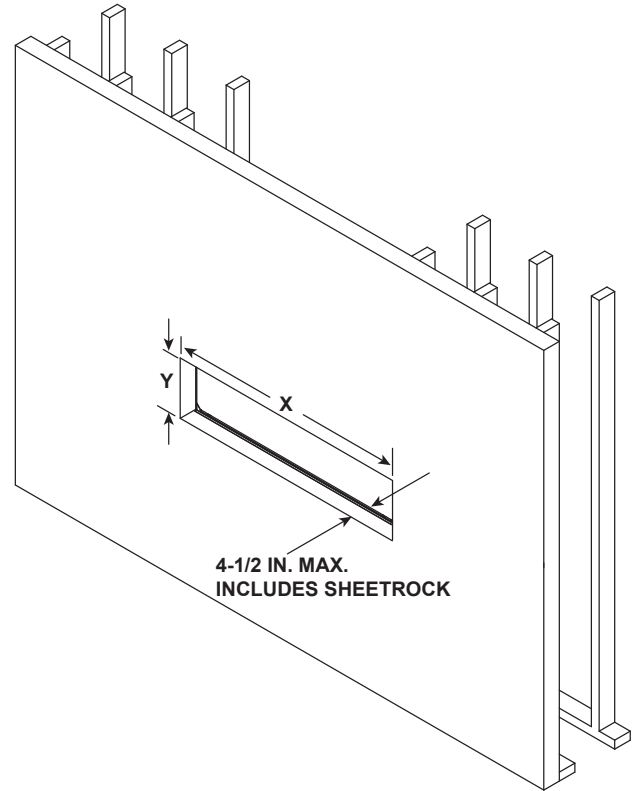

Figure 16. Install Transition Glass Panel

Clean Face Finishing Option

Combustible or Non-Combustible

NOTICE: Dimensions must be same as dimensions in Figure 3.3. If dimensions vary, barrier glass can not be removed.



NOTICE: Dimensions must be same as dimensions in Clean Face Finish Dimensions diagram (Section 3 of appliance Installation Manual) for Clean Face Finish. If dimensions vary, barrier glass cannot be removed.

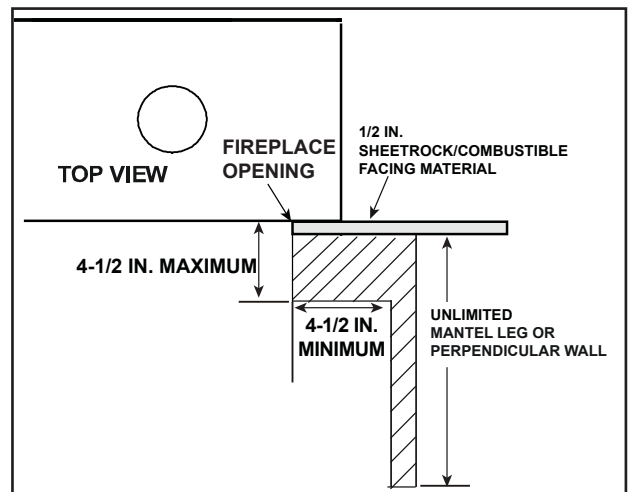

MODEL	X Min.	Y Min.
PRIMO48/48ST	51	13-3/8
PRIMO60/60ST	63	13-3/8
PRIMO72/72ST	75	13-3/8

Figure 18. Clean Face Finishing Option - Combustible or Non-Combustible (Recessed Wall)

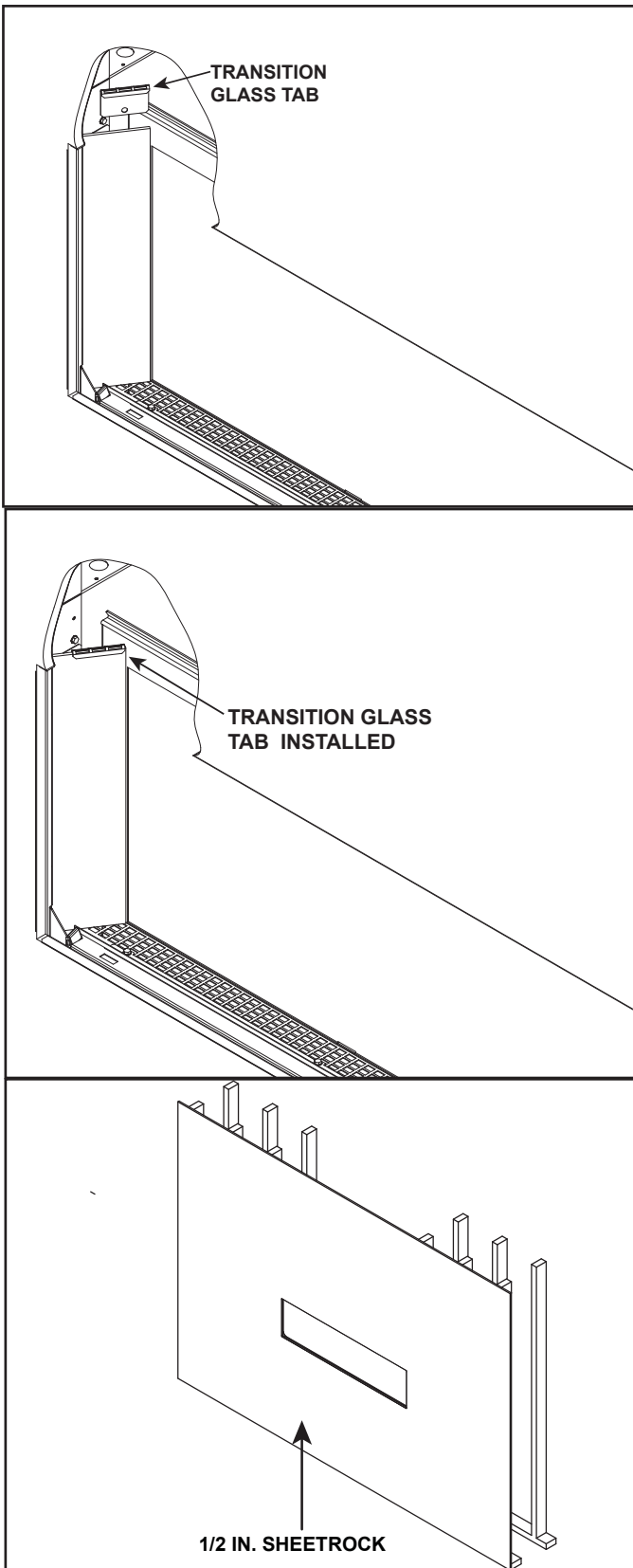

Figure 17. Transition Glass Tab Installation and Finished Wall

SERVICE PARTS

DESCRIPTION	PRIMO48	PRIMO48ST
KIT	PRIMO48-CF	PRIMO48ST-CF
Firebox Panel Glass Assembly	2300-060	2301-060
Transition Panel Glass Assembly	2310-032	2310-032
Glass Retaining Bracket	2300-133	2300-133
Barrier Glass Support	2310-134	2310-134
Rubber Bumper	2310-140	2310-140
Transition Glass Tab	2310-145	2310-145
Clean Face Barrier Glass	GLA2310-106	GLA2310-106
Transition Glass Panel Bracket	2310-120	2310-120

DESCRIPTION	PRIMO60	PRIMO60ST
KIT	PRIMO60-CF	PRIMO60ST-CF
Firebox Panel Glass Assembly	2321-060	2301-060
Transition Panel Glass Assembly	2310-032	2310-032
Glass Retaining Bracket	2300-133	2300-133
Barrier Glass Support	2310-134	2310-134
Rubber Bumper	2310-140	2310-140
Transition Glass Tab	2310-145	2310-145
Clean Face Barrier Glass	GLA2329-106	GLA2329-106
Transition Glass Panel Bracket	2310-120	2310-120

DESCRIPTION	PRIMO72	PRIMO72ST
KIT	PRIMO72-CF	PRIMO72ST-CF
Firebox Panel Glass Assembly	2331-060	2301-060
Transition Panel Glass Assembly	2310-032	2310-032
Glass Retaining Bracket	2300-133	2300-133
Barrier Glass Support	2310-134	2310-134
Rubber Bumper	2310-140	2310-140
Transition Glass Tab	2310-145	2310-145
Clean Face Barrier Glass	GLA2336-106	GLA2336-106
Transition Glass Panel Bracket	2310-120	2310-120

Please contact your Heat & Glo dealer with any questions or concerns.
For the location of your nearest Heat & Glo dealer, please visit www.heatnglo.com.

Heat & Glo, a brand of Hearth & Home Technologies
7571 215th Street West, Lakeville, MN 55044
www.heatnglo.com