

ARCHKIT-ESC42ST, FSA-ESC42ST, FSA-42STIFT

Arch Kit and Arched Fire Screen Front Installation Instructions



Leave this manual with party responsible for use and operation.

CAUTION! Sharp Edges! Wear protective gloves and safety glasses during installation.

Note: The ARCHKIT-ESC42ST is designed for use with the FSA-ESC42ST-XX or FSA-42STIFT-XX decorative arch. The ARCHKIT-ESC42ST, FSA-ESC42ST, and the FSA-42STIFT are sold separately.



HOT GLASS WILL CAUSE BURNS.

DO NOT TOUCH GLASS UNTIL COOLED.

NEVER ALLOW CHILDREN TO TOUCH GLASS.

A barrier designed to reduce the risk of burns from the hot viewing glass is provided with this appliance and shall be installed for the protection of children and other at-risk individuals.

WARNING! Risk of Fire! Combustible material must not overlap, or be placed, under a surround.

CAUTION! Do not install damaged components.

Kit Contents: ARCHKIT-ESC42ST

See Figure 1.

- Arch vanity panel
- Arch fill pieces (one left, one right)
- Arch finishing strip
- Replacement refractory panels (one left, one right)
- Also included: 16 screws

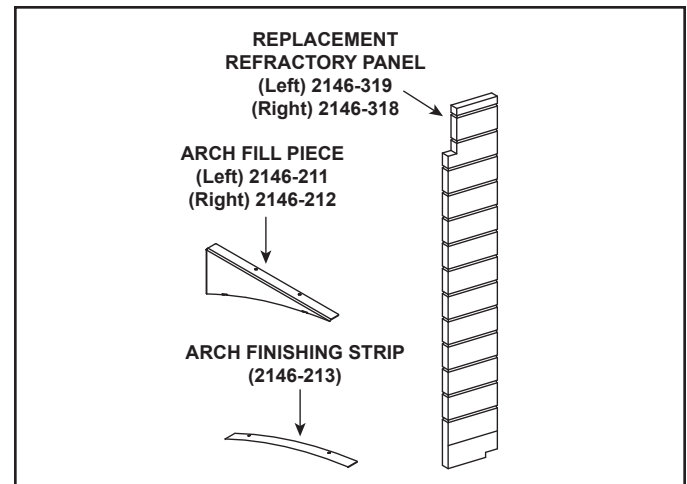

Figure 1. ARCHKIT-ESC42ST Contents

Kit Contents: FSA-ESC42ST and FSA-42STIFT

See Figure 2.

- Arched firescreen assembly (one)
- Bottom mounting brackets (two)
- Top mounting bracket (one)

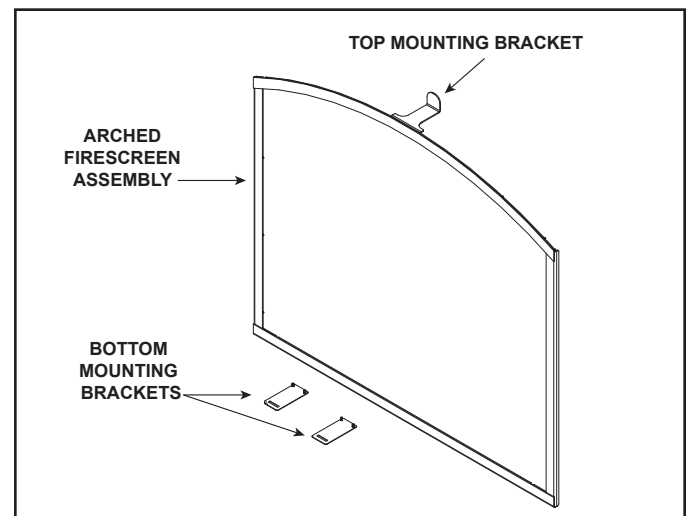

Figure 2. Kit Contents: FSA-ESC42ST and FSA-42STIFT

Installing ARCHKIT-ESC42ST

1. Install arch vanity panel by installing 4 screws into the top of the glass frame. The arch vanity panel should sit flush with the outside of the glass. See Figure 3, detail A.
2. Locate the four pilot holes located in the upper left and right corners of the fireplace opening. These pilot holes correspond to the four holes located on each arch fill piece. Install left and right arch fill pieces with the eight screws provided in the kit to each fill piece. See Figure 3, detail B.
3. To attach the arch finishing strip, bend in the two hand bend tabs away from the glass toward the arch fill pieces. Install the arch finishing strip to the arch fill pieces. Use the four screws provided in the kit.

Note: The finish edges are designed to provide a physical stop to prevent decorative finish material such as stone, brick, marble, etc. from being installed past the fireplace opening. This finish edge should be removed at a later date.

4. Install Outer Refractory Panels

- Install glass assembly according to instructions in fireplace installation manual.
 - The refractory brackets are shipped wire-tied to the right side support opposite the valve. See Figure 4. Install the two refractory brackets to the glass frame and secure, but do not tighten. One screw per bracket is required. See Figure 5.
 - Install both outer refractory panels. Adjust and tighten refractory brackets.
 - Install outer hearth. See Figure 6.
5. For installation instructions for the optional FSA-ESC-42ST or FSA-42STIFT, proceed to next page of this instruction.

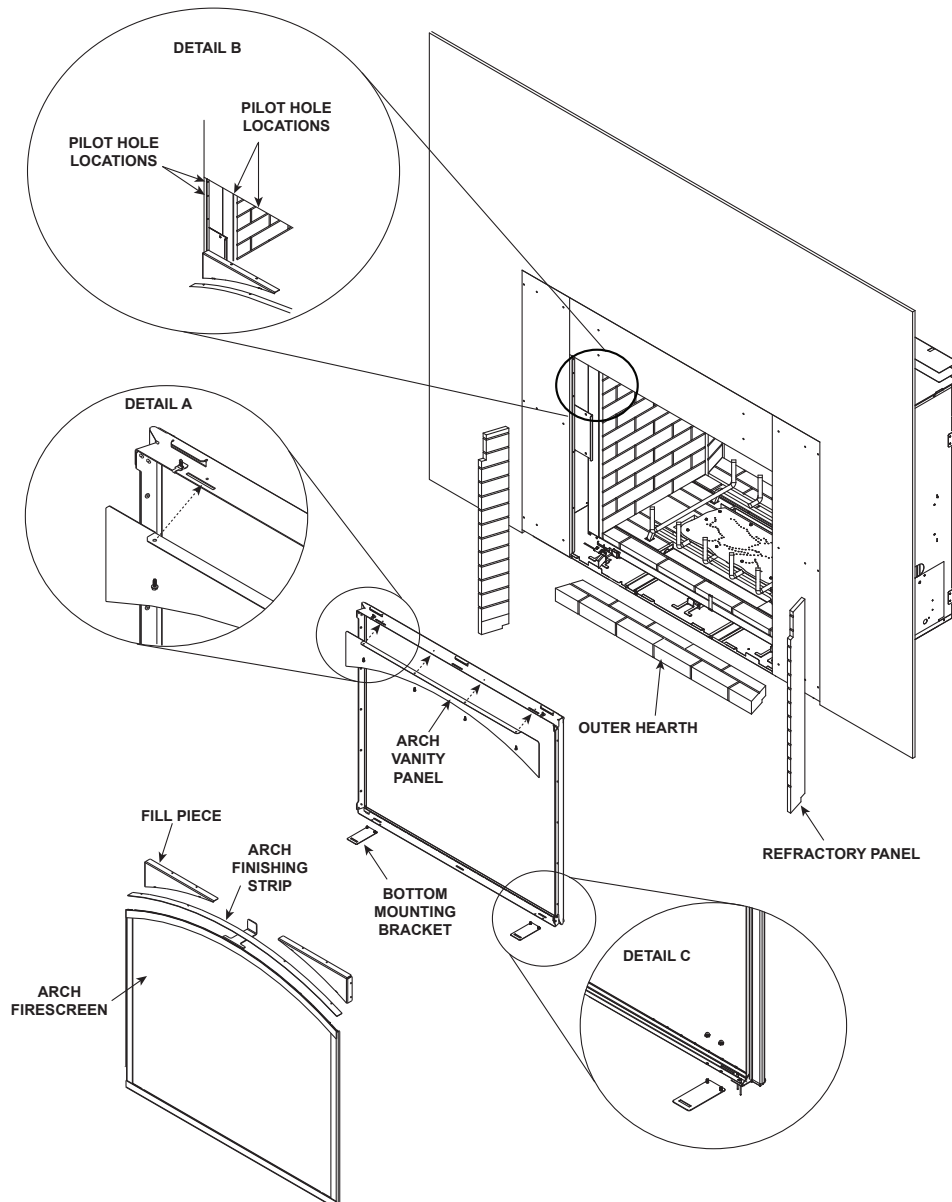

Figure 3



Figure 4. Shipping Location of Refractory Brackets



Figure 5. Installation of Refractory Brackets



Figure 6. Installation of Outer Hearth

Installing FSA-ESC42ST or FSA-42STIFT

1. Remove outer refractory hearth.
2. Install two bottom mounting brackets to the bottom of the glass frame. See Figure 3, detail C.

Note: When installing lower brackets, apply pressure to glass clip if more clearance is needed.

3. Reinstall the outer refractory hearth.
4. Remove the two top center nuts from the back side of the arched fire screen assembly and install the top mounting bracket and reattach the two nuts.
5. Install front by first engaging the top center slot in the top of the glass frame assembly and then push door in to engage the bottom left and right tabs in the front to the two slots located in the bottom mounting brackets installed in step 2.

IMPORTANT INFORMATION FOR TILE, BRICK OR STONE INSTALLATION. SEE FIGURE 7.

- The installed arch finishing strip provides a surface to prevent finishing materials (tile, brick or stone) from being installed incorrectly.
- The installed arch finishing strip ensures the required air space above the arch firescreen is maintained.
- The installed arch finishing strip may be removed once finishing materials have been installed.
- The bottom edge of the installed finishing material is a viewable finish edge and should be finished accordingly.

WARNING! Risk of Fire! The finishing materials must not extend past the arch finishing strip to prevent overheating.

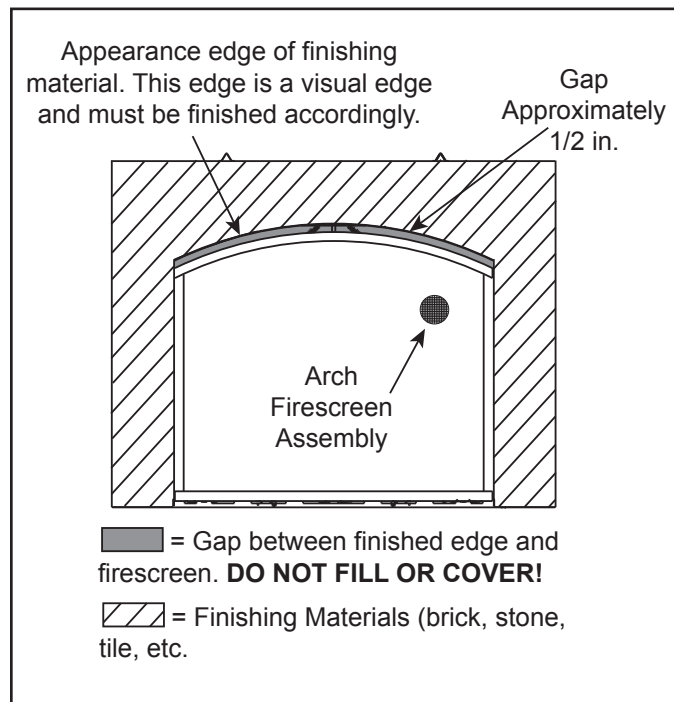

Figure 7. Finishing detail

Please contact your Heat & Glo dealer with any questions or concerns.
 For the location of your nearest Heat & Glo dealer, please visit www.heatnglo.com.

Heat & Glo, a brand of Hearth & Home Technologies
 7571 215th Street West, Lakeville, MN 55044
www.heatnglo.com