

TONIC-AU DECORATIVE FRONT

HEAT&GLO

No one builds a better fire

Model: XLR-PLUS

Installation Instructions



Leave this manual with party responsible for use and operation.

CAUTION! Risk of Cuts or Abrasions. Wear protective gloves and safety glasses during installation. Sheet metal edges are sharp.

CAUTION! Do not install damaged components.

⚠ WARNING



HOT SURFACES!

Glass and other surfaces are hot during operation AND cool down.

Hot glass will cause burns.

- **DO NOT** touch glass until it is cooled
- **NEVER** allow children to touch glass
- Keep children away

- **CAREFULLY SUPERVISE** children in same room as fireplace.
- Alert children and adults to hazards of high temperatures.

High temperatures may ignite clothing or other flammable materials.

- Keep clothing, furniture, draperies and other flammable materials away.
- Do **NOT** operate with protective barriers open or removed.
- These instructions are to be left with a person responsible for the use and operation of the fireplace.

WARNING! Risk of Fire. Under no circumstances can combustible material overlap decorative front.

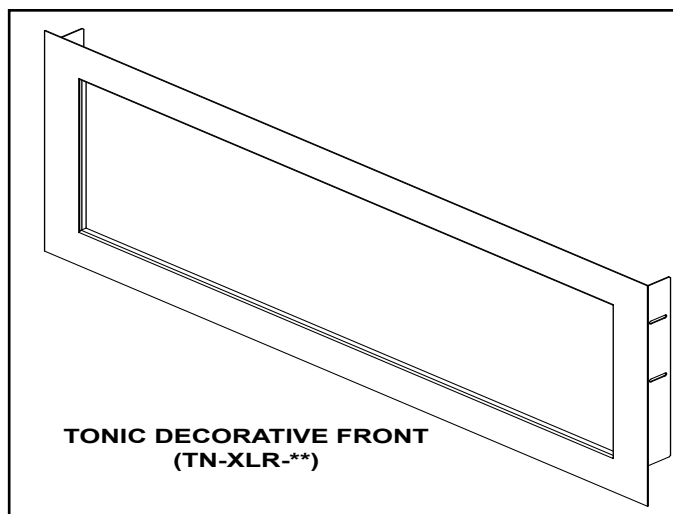

Figure 1. Tonic Decorative Front

CONTENTS:

- Decorative Front Assembly
- (4) 1 inch Phillips head screws
- Mesh screen and four mesh clips

Verify and remove contents from packaging before beginning installation.

Removing and Replacing Fixed Glass Assembly

WARNING! Risk of Asphyxiation! Handle fixed glass assembly with care. Inspect the gasket to ensure it is undamaged and inspect the glass for cracks, chips or scratches.

- **DO NOT** strike, slam or scratch glass.
- **DO NOT** operate fireplace with glass removed, cracked, broken or scratched.
- Replace as a complete assembly.

Removing Fixed Glass Assembly

1. Remove the decorative front.
2. Locate the two spring latches that are on the upper left and right of the fireplace.
3. Use both index fingers to release spring latches.
4. Allow glass to tilt forward. Grasp glass on the upper right and left sides and lift glass "up" and "out."

Replacing Fixed Glass Assembly

1. Grasp glass on upper right and left sides and tilt bottom of glass assembly toward fireplace.
2. Allow of the bottom gasketing of the glass assembly to touch the face of the fireplace.
3. Put pressure on the glass as you allow the glass assembly to drop into the two lower glass clips.
4. Tilt top of glass towards fireplace and engage both top spring latches.

Model: XLR-PLUS

Note: The heat shields and mesh brackets required for the installation instructions below are shipped with the appliance.

Installation Instructions

- 1. Install upper and lower glass heat shields in glass frame assembly as shown in Figure 2. Each heat shield will have “T” punched into it.

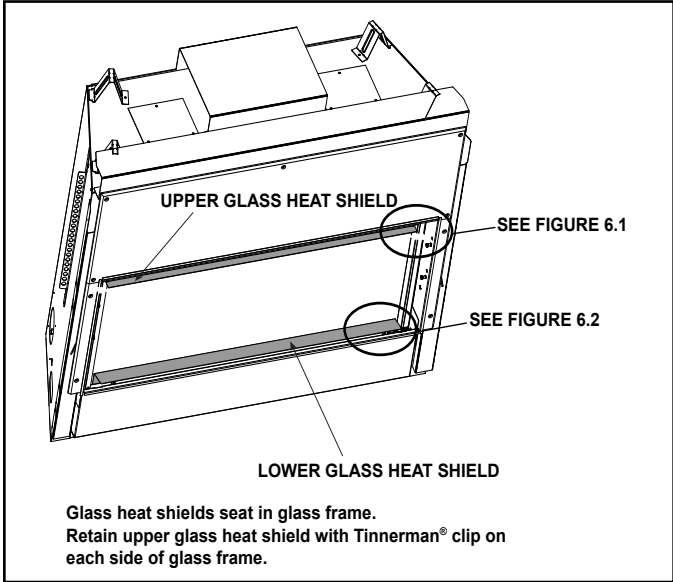

Figure 2. Heat Shield Installation

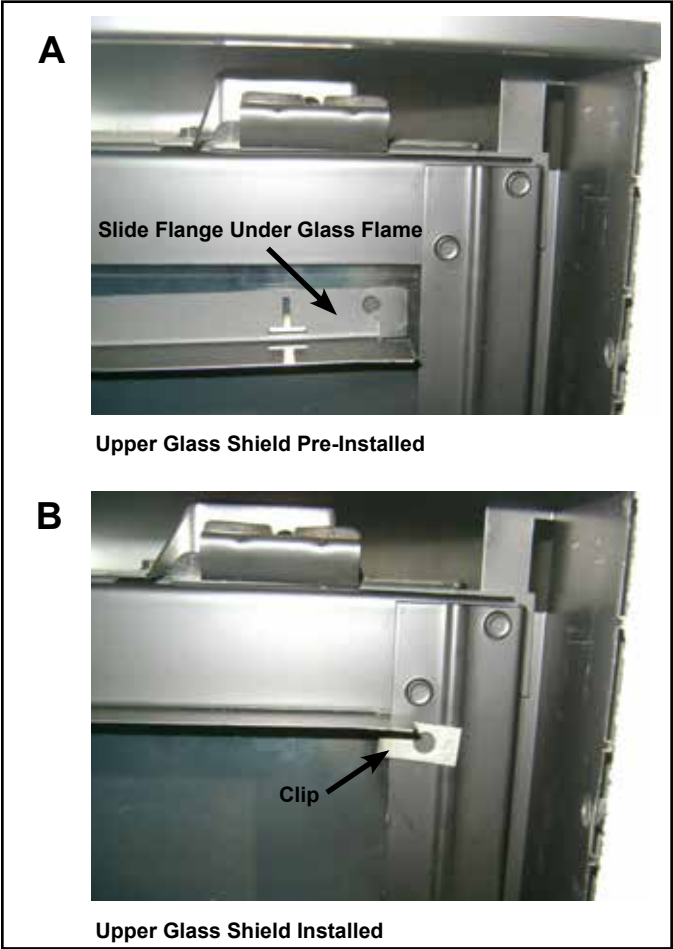

Figure 3

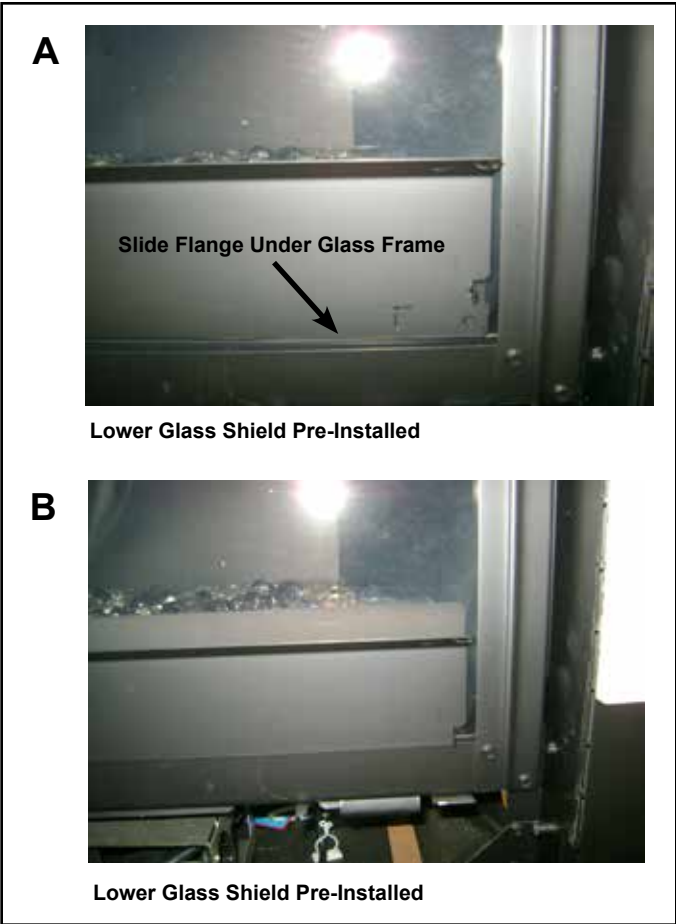

Figure 4

2. Remove 4 mesh clips from mesh frame. Discard.
3. Line up holes on mesh brackets with pilot holes on mesh. Install mesh brackets to "mesh" panel with 4 screws included as shown in Figure 5.

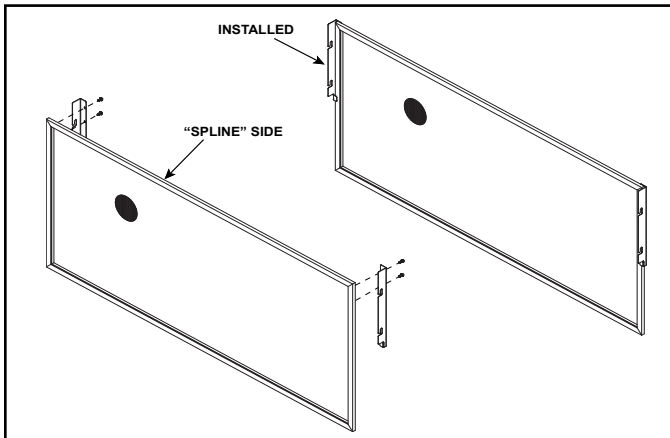

Figure 5. Install Mesh Bracket

4. Install mesh assembly into door opening such that it rests on the bottom two glass plates. See Figure 6.



Figure 6. Install Mesh Assembly

5. Place mesh into position with retaining screws removed. See Figure 7.
6. Install two Phillips screws into the two rivnut holes on the left and right sides of the fireplace opening. See Figure 7. Do not tighten screws. See Figure 6.

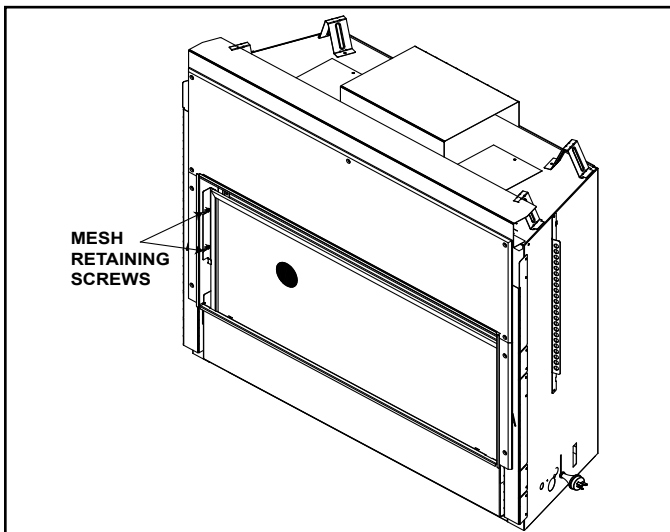

Figure 7. Mesh Installation

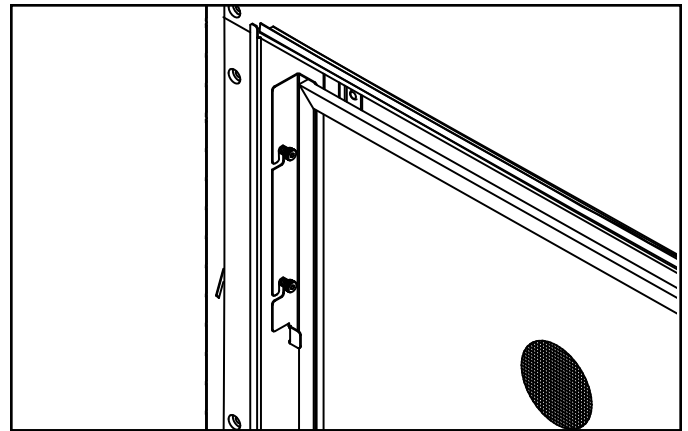

Figure 8. Do Not Tighten Screws

7. Install Tonic front as shown below. The mounting bracket on the Tonic door slide between the mesh brackets and the left and right side of the fireplace opening. See Figure 9.



Figure 9. Install Front on Mounting Bracket

8. Slide Tonic front towards the fireplace.



Figure 10. Front Installation

9. Tighten the 4 Phillips screws to secure the Tonic front to the fireplace Fig 11.



Figure 11. Tighten Phillips Screws

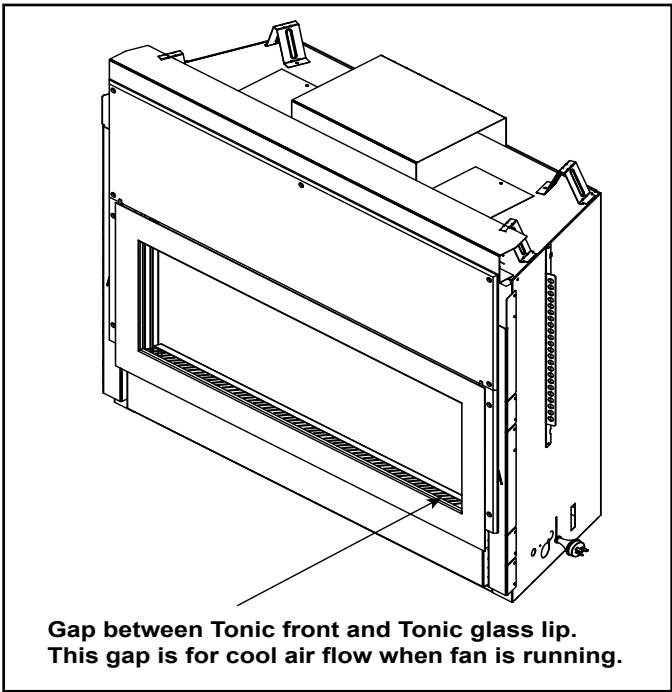

Figure 12. Tonic Front Gap

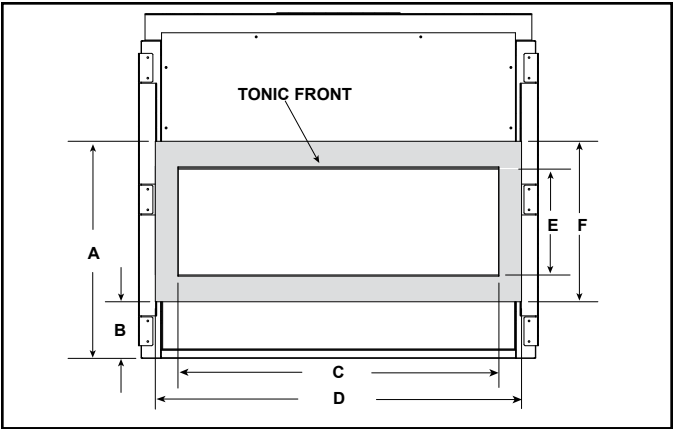

Figure 13. Dimensions of Tonic Decorative Front.

Table 1. Dimensions of Tonic Decorative Front.

A	Top of decorative front to bottom of appliance.	TN-SLR-**-AU	
		26-3/8 in.	670 mm
		TN-SLRL-**-	
		27-3/8 in.	695 mm
B	Bottom of decorative front to bottom of appliance.	TN-XLR-**-	
		27-1/8 in.	689 mm
		TN-SLR-**-AU/TN-XLR-**-	
C	Inside dimension of decorative front (width).	6-7/8 in.	175 mm
		TN-SLRL-**-	
		5-7/8 in.	149
D	Outside dimension of decorative front (width).	39 in.	991 mm
		TN-SLR-**-AU/TN-XLR-**-	
		44-1/2 in.	1130 mm
E	Inside dimension decorative front (height).	TN-SLRL-**-	
		46-1/2 in.	1181 mm
		TN-SLR-**-AU /TN-SLRL-**-	
F	Outside dimension of decorative front (height).	13 in.	330 mm
		TN-XLR-**-	
		13-3/4 in.	349 mm
		TN-SLR-**-AU	
		19-1/2 in.	495 mm
		TN-XLR-**-	
		20-1/4 in.	514 mm
		TN-SLRL-**-	
		21-1/2	546 mm

Cleaning Instructions for Fronts

Use a microfiber cloth and Windex® Original Glass Cleaner or 03M003 Stove Bright® Glass Cleaner to clean the front immediately after installation to remove acids deposited by the installer or technician. Spray the cleaner onto the microfiber cloth and carefully wipe the entire surface. The front should be cleaned in this manner annually by the homeowner to remove fingerprints or other contaminants. Once oxidation of the paint pigment has occurred, cleaning will not restore the original color.

Service Parts

PART #	DESCRIPTION
SRV-SLR-TN-RED	Tonic Replacement Front, Red
SRV-SLR-TN-NB	Tonic Replacement Front, New Bronze
SRV-SLR-TN-GY	Tonic Replacement Front, Grey
SRV-SLR-TN-GT	Tonic Replacement Front, Graphite
SRV-SLR-TN-EB	Tonic Replacement Front, Ebony
SRV-SLR-MESH	Tonic Replacement Front, Mesh
2143-901A	Manual Bag Assembly Hardware

Please contact your Heat & Glo dealer with any questions or concerns.
For the location of your nearest Heat & Glo dealer, please visit www.heatnglo.com.

Heat & Glo, a brand of Hearth & Home Technologies
7571 215th Street West, Lakeville, MN 55044
www.heatnglo.com