



Aladdin Hearth Products
401 N. Wynne
Colville, WA 99114
A Division of Hearth Technologies Inc.

AFFINITY 35

DIRECT VENT GAS-FIRED FIREPLACE INSERT ROOM HEATER MODEL: DVi35S OWNER'S MANUAL AND INSTALLATION INSTRUCTIONS

WARNING!

If the information in this manual is not followed exactly, a fire or explosion may result causing property damage, personal injury or loss of life.

-Do not store or use gasoline or other flammable vapors and liquids in the vicinity of this or any other appliance.

-WHAT TO DO IF YOU SMELL GAS

- Do not try to light any appliance.
- Do not touch any electrical switch.
- Do not use any phone in your building.
- Immediately call your gas supplier from a neighbor's phone. Follow the gas supplier's instructions.
- If you cannot reach your gas supplier, call the fire department.

-Installation and service must be performed by a qualified installer, service agency or the gas supplier.

WARNING!

Improper installation, adjustment, alteration, service or maintenance can cause injury or property damage. Refer to this manual. For assistance or additional information, consult a qualified installer, service agency or the gas supplier.



This manual must be used for installation of the DVi35S Direct Vent Gas Fired Fireplace Insert Room Heater and retained by the homeowner for operating and maintenance instructions.

FOR YOUR SAFETY

The appliance area must be kept clear and free from combustible materials, gasoline and other flammable vapors and liquids.



Table of Contents

I.	Listings and Code Approvals.....	3
II.	Description of the DVi35S System	3
III.	Appliance System Components	4
IV.	Pre-Installation Preparation	5
	A. Vent System Approvals	5
	B. Dimensional Requirements	5
	C. Gas Pressure	5
	D. High Altitude Installation.....	5
	E. Clearances	6
	F. Firebox Entry.....	6
V.	Step-By-Step Installation of the System	7
	A. Connecting the Vent Pipe.....	7
	B. Gas Line Installation.....	9
	C. Surround Installation	10
	D. Rock Wool and Lava Rock Placement.....	11
	E. Cleaning the Glass	11
	F. Installation of Glass	11
	G. Installation of Front Face	11
	H. Gold Trim Cleaning	13
	I. Blower.....	13
	J. Wiring.....	14
VI.	Operating Instructions	16
VII.	Maintenance Instructions.....	18
VIII.	Trouble Shooting	19
IX.	Replacement Parts	20

SAFETY PRECAUTIONS

- | | |
|---|--|
| 1. PLEASE READ THESE INSTALLATION INSTRUCTIONS COMPLETELY BEFORE BEGINNING INSTALLATION PROCEDURES. FAILURE TO FOLLOW THEM COULD CAUSE AN APPLIANCE MALFUNCTION RESULTING IN SERIOUS INJURY AND/OR PROPERTY DAMAGE. | REPLACED PRIOR TO OPERATING THE APPLIANCE. |
| 2. DUE TO HIGH TEMPERATURES THE APPLIANCE SHOULD BE LOCATED OUT OF TRAFFIC AND AWAY FROM FURNITURE AND DRAPERIES. | 7. WARNING: DO NOT OPERATE APPLIANCE WITH THE PANEL(S) REMOVED, CRACKED OR BROKEN. REPLACEMENT OF THE PANEL(S) SHOULD BE DONE BY A LICENSED OR QUALIFIED SERVICE PERSON. |
| 3. CHILDREN AND ADULTS SHOULD BE ALERT-ED TO THE HAZARDS OF HIGH SURFACE TEMPERATURES AND SHOULD STAY AWAY TO AVOID BURNS OR CLOTHING IGNITION. | 8. INSTALLATION AND REPAIR SHOULD BE DONE BY A QUALIFIED SERVICE PERSON. THE APPLIANCE SHOULD BE INSPECTED BEFORE USE AND AT LEAST ANNUALLY BY A QUALIFIED SERVICE PERSON. MORE FRE-QUENT CLEANING MAY BE REQUIRED DUE TO EXCESSIVE LINT FROM CARPETING, BED-DING MATERIAL, ETC. IT IS IMPERATIVE THAT CONTROL COMPARTMENTS, BURNERS AND CIRCULATING AIR PASSAGeways OF THE APPLIANCE BE KEPT CLEAN. |
| 4. YOUNG CHILDREN SHOULD BE CAREFULLY SUPERVISED WHEN THEY ARE IN THE SAME ROOM AS THE APPLIANCE. | 9. ENSURE THAT THE FLOW OF COMBUSTION AND VENTILATION AIR NOT BE OBSTRUCT-ED. |
| 5. CLOTHING OR OTHER FLAMMABLE MATERIAL SHOULD NOT BE PLACED ON OR NEAR THE APPLIANCE. | 10. ENSURE THAT ADEQUATE COMBUSTION AND VENTILATION AIR ARE PROVIDED. |
| 6. ANY SAFETY SCREEN OR GUARD REMOVED FOR SERVICING AN APPLIANCE MUST BE | |



I. LISTINGS AND CODE APPROVALS

U.S. Certification

The DVi35S has been tested in accordance with ANSI Z21.88-1998 and has been listed by Underwriters Laboratory (UL) for installation and operation as described in these Installation and Operating Instructions. All components are A.G.A. or UL safety certified.

Canada Certification

The DVi35S has been tested in accordance with CSA 2.33-M98 and has been listed by UL for installation and operation as described in these Installation and Operating Instructions. All components are C.G.A. or C.S.A. safety certified.

Local Codes

Check with your local building code agency prior to installing this appliance to ensure compliance with all local codes, including the need for permits and follow-

up inspections. This installation must conform with local codes or, in the absence of local codes, with the National Fuel Gas Code, ANSI Z223.1-latest edition, in the U.S.A. and the CANI-B149-latest edition, in Canada.

ARROW® is a registered trademark of Hearth Technologies, Inc.

Efficiency

The efficiency rating of the appliance is a product thermal efficiency rating determined under continuous operating conditions and was determined independently of any installed system.

If any assistance is required during installation please contact your local dealer or contact ARROW Customer Relations Department, Aladdin Hearth Products, 401 N. Wynne, Colville, WA 99114.

	ARROW ALADDIN HEARTH PRODUCTS 401 N. WYNNE COLVILLE, WA 99114		GAS TYPE ALTITUDE MAX. INPUT/DEBIT MIN. INPUT/DEBIT OUTPUT STEADY STATE THERMAL EFF. MANIFOLD PRESSURE PRESSION TUBULURE MIN. INLET PRESSURE FOR THE PURPOSE OF INPUT ADJUSTMENT PRESS. MIN. D'ALIMENTATION ORIFICE SIZE/DIAM. INJECTEUR LESS THAN/MOINS DE 3 AMPERES..		NATURAL 0-4500 FT/PI 35,000 BTUH 24,000 BTUH 27,300 BTUH 78% 3.5 IN. W.C. C. D'EAU 4.5 IN. W.C. C. D'EAU	PROPANE 0-4500 FT/PI 33,000 BTUH 27,000 BTUH 26,400 BTUH 80% 10.0 IN. W.C. C. D'EAU 11.0 IN. W.C. C. D'EAU	
	SERIAL NO. DE SERIE MODEL MODELE	* MFG. DATE DATE DE FAB.	ANSI Z21.88-1998 CSA 2.33 - M98 VENTED GAS FIREPLACE HEATER FOR USE AT HIGH ALTITUDES.		.115/2.92 DIA. 115V., 60Hz.	.070/1.78 DIA.	IN/mm

**DO NOT REMOVE OR
COVER THIS LABEL**

VENTED GAS FIREPLACE HEATER - NOT FOR USE WITH SOLID FUEL. FOYER A GAS VENTILE
- NE DOIT PAS ETRE UTILISE AVEC UN COMBUSTIBLE SOLID. THIS VENTED HEATER IS NOT FOR USE
WITH AIR FILTER. - NE PAS UTILISER DE FILTRE A AIR AVEC CE FOYER AU GAZ A EVACUATION.

II. DESCRIPTION OF THE APPLIANCE SYSTEM

The DVi35S is a Direct Vent Gas-Fired Fireplace Insert Room Heater. Combustion air is supplied from outside, not from inside the house as with other types of appliances.

This ARROW DVi35S system consists of the following:

1. Appliance
2. Venting System (must be purchased separately)
3. Termination (must be purchased separately)
4. Blower
5. Surround (must be purchased separately)
6. Front Face Kit (must be purchased separately)

Optional components include:

1. Remote Control
2. Surround Bottom
3. Rectangular Front Face Kit
4. Arched Front Face Kit
5. Bay Front Face Kit

Note: Illustrations throughout these instructions reflect typical installations and are for design purposes only. Actual installation may vary slightly due to individual design preferences. However, minimum and maximum clearances must be maintained at all times.

The illustrations and diagrams used throughout these installation instructions are not drawn to scale.

Note: Operation of a Direct Vent appliance may be sporadic in high wind situations.



III. APPLIANCE SYSTEM COMPONENTS

Catalog Number	Description
DVi35S	Direct Vent Gas Fired Insert - Natural Gas with-out Front Face
DVi35SL	Direct Vent Gas Fired Insert - Propane Gas with-out Front Face
RC6	Remote Control (Battery)
RC-STAT	Remote Thermostatic Control
DVIK33	Flex Kit includes 923K, 991, and Flex 3302.
Flex 3302	Flex Kit (Includes (2) 3"x30' Chimney Liner Flex)
923GK	3" Direct Vent Chimney Liner Termination Kit (Dura-Vent product)
710	3" Chimney Liner Flex 35' (Dura-Vent product)
980	Vertical Termination Cap with Wind Halo (Dura-Vent product)
991	High Wind Termination Cap
SR3544S	Small Surround (28-1/2"x 44") with Trim
SR3548S	Large Surround (33" x 48 1/2") with Trim
SRB44	Surround Bottom (4" x 45")
SRB48	Surround Bottom (4" x 49 1/2")
RF35	Rectangular Face Kit
AF35	Arched Face Kit
BF35	Bay Face Kit
SNCK35S	Natural Gas Conversion Kit
SPCK35S	Propane Conversion Kit

Factory Built Fireplace Termination Adapter Kit

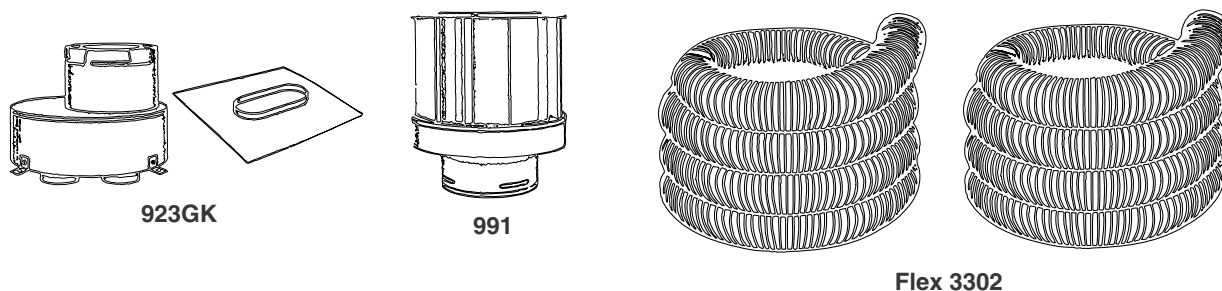

Part # DVIK33

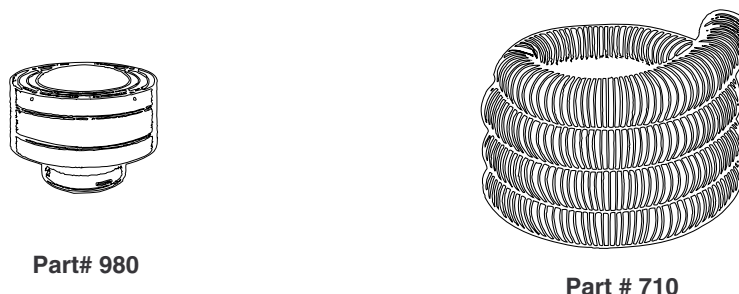



IV. PRE-INSTALLATION PREPARATION

WARNING!

This appliance may only use the Direct Vent Chimney System Required with the Unit and **MUST NOT** be connected to a chimney flue servicing a separate Solid Fuel or Gas Burning appliance.

A. VENT SYSTEM APPROVALS

Approved vent system terminations are labeled for identification. Two separate 3" diameter listed flexible aluminum or stainless steel gas vent is used for both exhaust and incoming combustion air and must be run up through the fireplace chimney and terminated vertically. Horizontal terminations **MUST NOT** be done. Follow the vent manufacturer's installation instructions in conjunction with this manual.



C. GAS PRESSURE

For natural gas, the minimum inlet gas supply pressure is 4.5 inches water column, and the maximum inlet gas pressure is 7.0 inches water column, for the purpose of input adjustment. Input rate is 35,000 - 24,000 Btu/hr. For Propane Gas, the minimum inlet gas supply pressure is 11.0 inches water column and a maximum 14.0 inches water column. Input rate is 33,000 - 27,000 Btu/hr. Manifold pressure for this Fireplace Insert Room Heater is 1.7 - 3.5 inches water column for natural gas and 6.3 - 10.0 inches water column for propane gas. This Heater has a variable adjust manifold.

Pressure taps are located on front of the valve for both inlet and outlet pressures.

B. DIMENSIONAL REQUIREMENTS

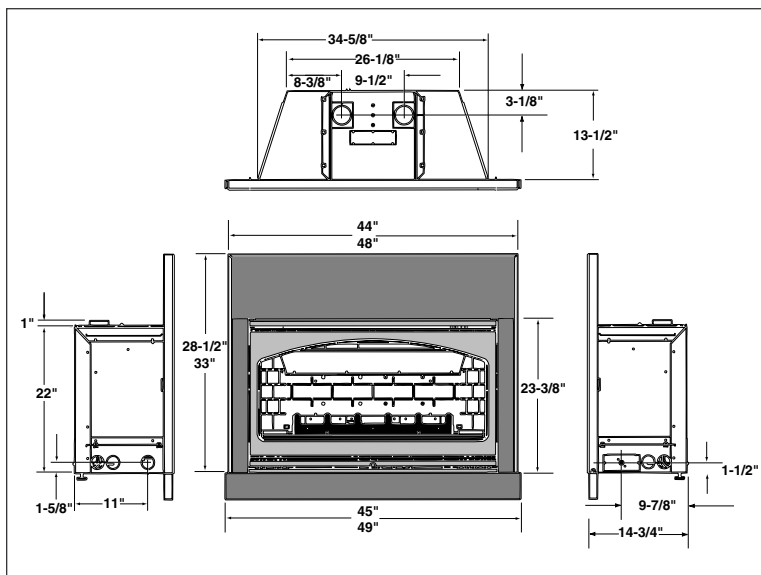
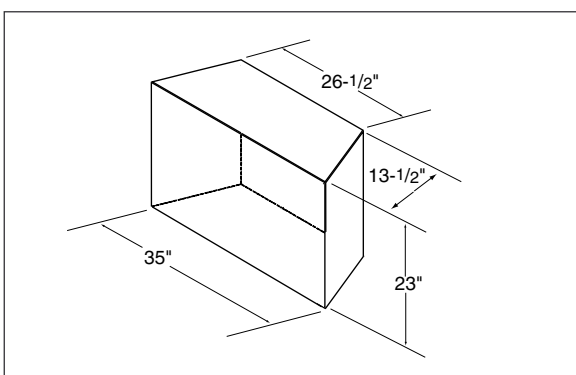

Diagram A - DVi35S Dimensions



DVi35S Minimum Firebox Opening

D. HIGH ALTITUDE INSTALLATION

For U.S. installation, this appliance has been tested and approved for elevations from 0-2000 feet.

When installing this appliance at an elevation above 2000 feet, it may be necessary to decrease the input rating by changing the existing burner Orifice to a smaller size. Input should be reduced 4 percent for each 1000 feet above sea level. Check with the local gas utility for proper Orifice size identification and to see if the gas in your area has been deregulated. This appliance is shipped with a .115"/2.291mm Orifice size on Natural Gas versions and a .070"/1.778 mm Orifice size on L.P. versions.

For Canadian installation, this appliance is certified for elevations from 0-4500 feet. When installing this appliance at an elevation between 0-4500 feet in Canada, the input rating does not need to be reduced.

When installing this appliance at an elevation above 4500 feet in Canada, check with local authorities.

Consult your local gas company for assistance in determining the proper Orifice for your location or refer to ANSI Z223.1-latest edition, Appendix F.

E. CLEARANCES TO UNIT

Diagram B shows the minimum vertical and corresponding maximum horizontal dimensions of mantels or other combustible projections above the gas fireplace of 12 inches.

When finishing the fireplace **NEVER OBSTRUCT OR MODIFY THE AIR INLET/OUTLET OPENINGS IN ANY MANNER.**

While a hearth extension may be desirable for aesthetic reasons, it is not required for gas wall heaters per ANSI or CAN/CGA testing standards.

Provide adequate accessibility clearances for servicing and proper operation.

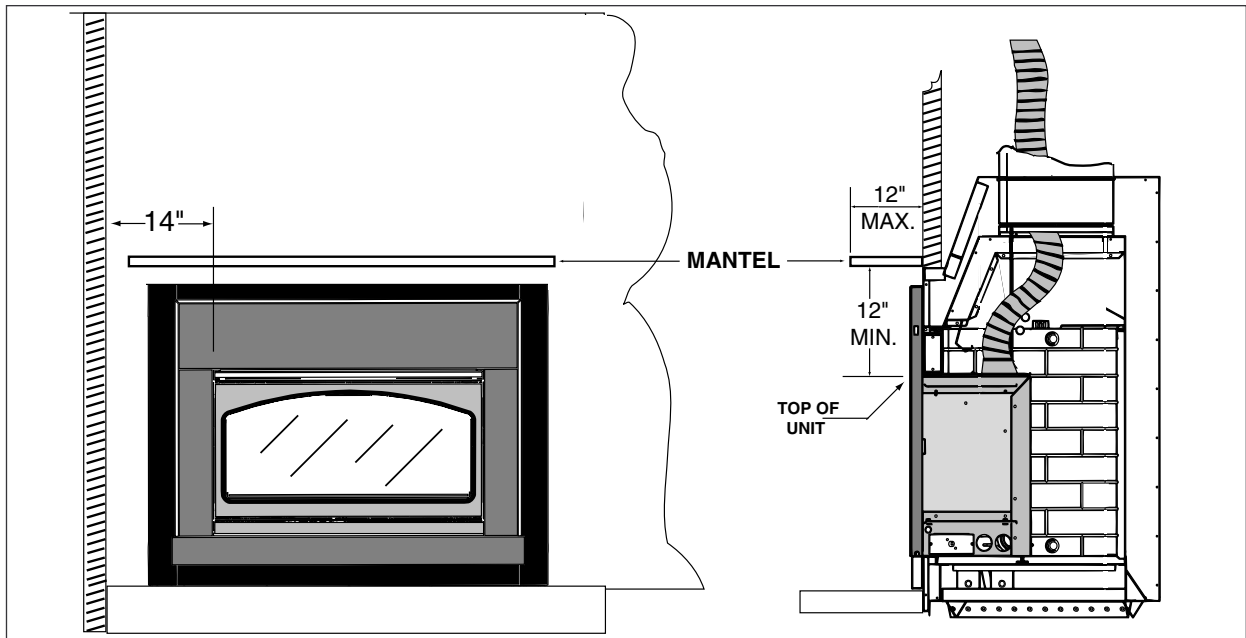

Diagram B - DVi35S Clearances

WARNING!

FAILURE TO POSITION THE PARTS IN ACCORDANCE WITH THESE DIAGRAMS OR FAILURE TO USE ONLY PARTS SPECIFICALLY APPROVED WITH THIS APPLIANCE MAY RESULT IN PROPERTY DAMAGE AND/OR PERSONAL INJURY.

F. FIREBOX ENTRY

Remove the glass by pulling out (3) Glass Retainer latches. See Figure 1. Lift the Glass Door Assembly up and remove from the bottom retainer. See Figure 2.

Place Glass in a safe place until installation is complete.



Figure 1 - Glass Retainer Latches



Figure 2 - Glass Removal



V. STEP-BY-STEP INSTALLATION OF THE DVi35S SYSTEM

WARNING!

BEFORE STARTING, DO THE FOLLOWING:

1. Wear gloves and safety Glasses for protection.
2. Keep hand tools in good condition. Sharpen cutting edges and make sure tool handles are secure.
3. Always maintain the minimum air space required to the Enclosure to prevent fire.
4. Read the following Installation Instructions.

INSTALLATION AND REPAIR SHOULD BE DONE BY A QUALIFIED SERVICE PERSON. THE HEATER SHOULD BE INSPECTED BEFORE USE AND AT LEAST ANNUALLY BY A QUALIFIED SERVICE PERSON. MORE FREQUENT CLEANING MAY BE REQUIRED DUE TO EXCESSIVE LINT FROM CARPETING, BEDDING MATERIAL, ETC. IT IS IMPERATIVE THAT CONTROL COMPARTMENTS, BURNERS AND CIRCULATING AIR PASSAGEWAYS OF THE HEATER BE KEPT CLEAN.

Tools and building supplies normally required for installation.

Tools

Pliers
Phillips screwdriver
Tape measure
Level
Electrical drill and bits
Square
High Temperature Sealant Material

High Temperature Sealant Material. Sealants that will withstand high temperatures (at least 350 degrees Fahrenheit); General Electric RTV103 (Black), or equivalent. Rutland, Inc. Fireplace Mortar #63, or equivalent; Dow Corning 732 or equivalent.

Note: Fireplace chimney systems must be cleaned thoroughly and inspected before installation of the appliance. If any portion of the chimney system shows signs of structural or mechanical weaknesses, such as cracks, leaky joints, corroded or warped surfaces, the faulty portion must be repaired or replaced.

A. CONNECTING THE VENT PIPE. The damper of the masonry or factory-built chimney may have to be removed to allow installation of the flexible-vent pipe. Before installing the 3" flex vent pipe, mark or label the exhaust pipe at both ends.

Install the 3-inch flexible vent pipes down through the chimney. Remove the starting collar bracket from the top of the unit. See Figure 3. Attach and secure the bottom ends of the flex pipes to the starting collar bracket with 3 sheet metal screws on each collar. Attach the labeled pipe to the exhaust collar on the starter collar bracket.



Figure 3
Removing the Starter Collar

Place the insert on the hearth and carefully slide it into the fireplace. Be sure the gas line enters the heater through the gas access opening and that the electrical cord is hanging out the front of the fireplace.

Position any excess flex vent pipe back up into the chimney. Slide the collar bracket under the lances. See Figure 4. Using handle on Collar Bracket, pull Collar Bracket and slide unit back. Secure the Collar Bracket with the [2] screws removed earlier.

Attach the pipe-to-cap adaptor to the termination cap and to the top of the flexible vent pipe and set the cap in place at the top of the chimney. Attach the labeled vent pipe to the labeled collar on the termination. See Figure 5.

Figures 6 and 7 show typical installations of the appliance.

NOTE: To avoid down drafts and/or cold air problems, it is recommended to seal off the area between the termination cap and the top of the solid-fuel chimney opening into which the vent cap has been installed.



Figure 4 - Reinstalling the Starter Collar

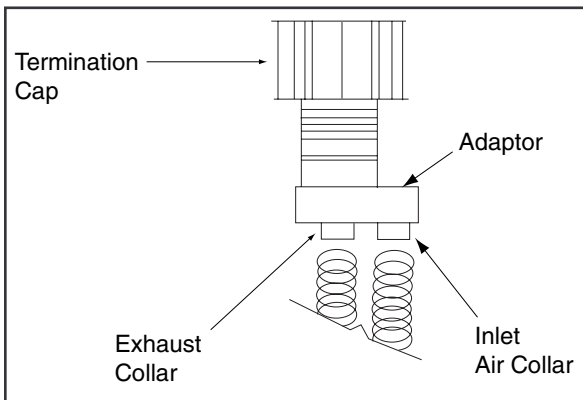

Figure 5

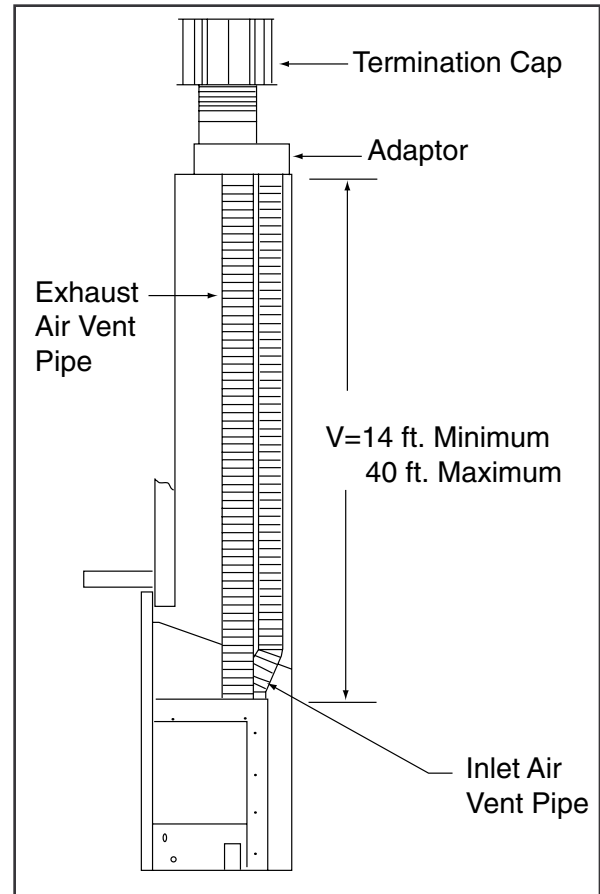

Figure 6

WARNING!

The exhaust pipe must only be connected to the exhaust starting collar of the unit and the center collar of the termination cap.

The inlet air pipe must only be connected to the inlet air collar of the unit and either attached to the inlet air collar of the termination cap or terminated in the chimney.

THIS FIREPLACE HAS BEEN ALTERED TO ACCOMMODATE AN INSERT AND SHOULD BE INSPECTED BY A QUALIFIED PERSON PRIOR TO RE-USE AS A CONVENTIONAL FIREPLACE.

Note: The above label, located in the instruction package, must be affixed to the existing fireplace prior to installation of the DVi35S Direct Vent Gas-Fired Heater.

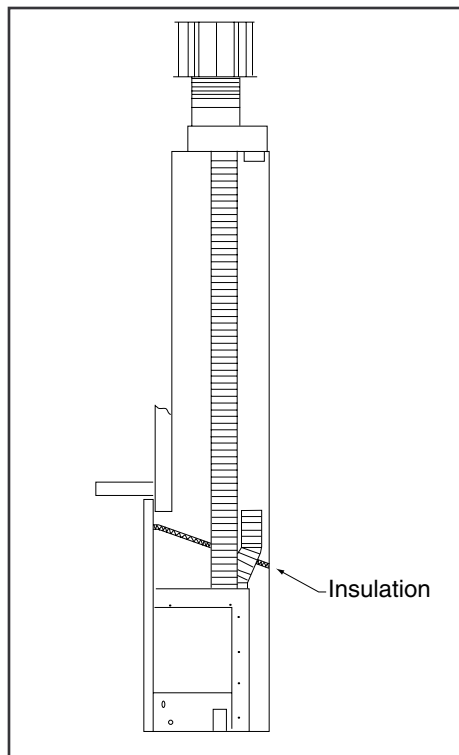

Figure 7

This option shows the air inlet not connected to the adapter at the top.

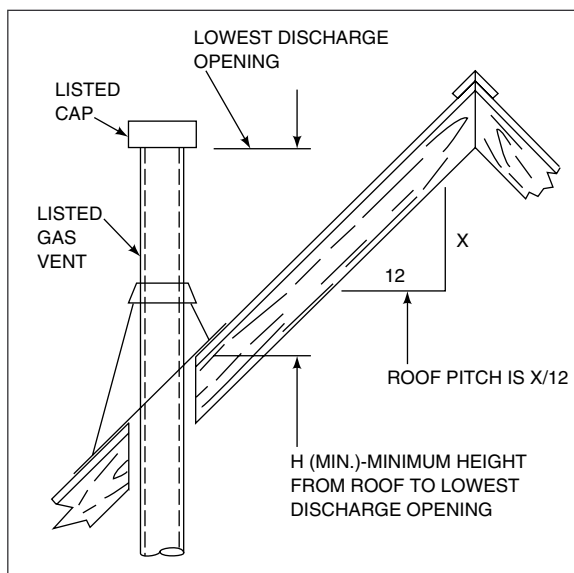

Figure 8
Termination Height

Roof Pitch	H (Min.) feet
Flat to 6/12	1.0
6/12 to 7/12	1.25
Over 7/12 to 8/12	1.5
Over 8/12 to 9/12	2.0
Over 9/12 to 10/12	2.5
Over 10/12 to 11/12	3.25
Over 11/12 to 12/12	4.0
Over 12/12 to 14/12	5.0
Over 14/12 to 16/12	6.0
Over 16/12 to 18/12	7.0
Over 18/12 to 20/12	7.5
Over 20/12 to 21/12	8.0

Table 1
Minimum Termination Height



B. GAS LINE INSTALLATION

A gas line must be run into the existing woodburning fireplace, for either a factory built fireplace or masonry. It is recommended that 1/2" inside diameter Black pipe be run into the fireplace through the left side. If the existing unit already has gas run to it, but through the right side, it is recommended that the gas line be rerouted to the left side. The gas supply line should be installed and connected to the shut-off valve by a qualified service person in accordance with all prevailing building codes.

A 3/8" flare adapter (not supplied) is necessary to connect the flex line (supplied) to the black pipe. Turn Gas Shut-off Valve to the "OFF" position.

Note: The appliance and its individual shutoff valve must be disconnected from the gas supply piping system during any pressure testing of that system at test pressures in excess of 1/2 psi (3.5 kPa). The appliance must be isolated from the gas supply piping system by closing its individual manual shutoff valve during any pressure testing of the gas supply piping system at test pressures equal to or less than 1/2 psi (3.5 kPa).

Check for leaks using a soap and water solution.

Seal with high temperature silicone the point where the gas line enters the existing fireplace firebox to prevent cold air infiltration.

CAUTION:

THE GAS SUPPLY LINE SHOULD BE PURGED OF ANY TRAPPED AIR PRIOR TO THE FIRST FIRING OF THE UNIT.

C. SURROUND INSTALLATION

NOTE: Remove the Front Face and Glass Door Assemblies from the Insert before beginning the Surround installation.

1. Assemble the surround top to the surround sides with the screws provided. See Figure 9. Assemble the gold trim kit with the corner brackets (provided) and slide trim around the surround. See Figure 10.
2. Remove and retain the four [4] attachment screws at the corners of the face of the unit.
3. Disconnect the "ON/OFF" Switch from the low voltage wire leads. Pull the wires through the surround and trim. Attach the wires to the "ON/OFF" Rocker Switch. Push the Rocker Switch into the hole. See Figures 11 and 12
4. Slide the surround against the face of the unit, aligning the holes in the upper and lower, right and left corners and secure the surround to the unit with the attachment screws. See Figure 13. If optional surround bottom is used, go to Step 5. If surround bottom is not used, slide the unit back until the surround is tight to the fireplace. Route power cord away from unit.

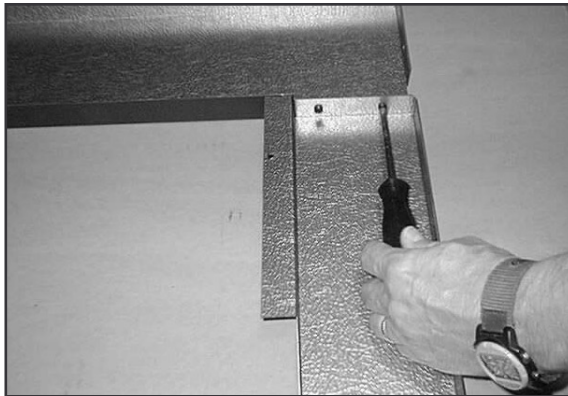

Figure 9 - Assembling Surround

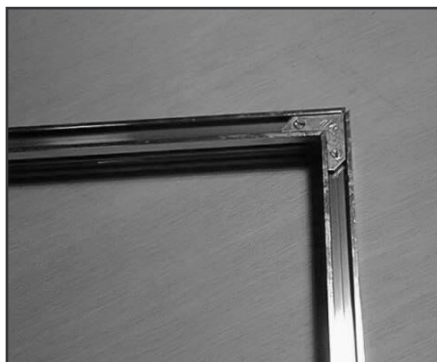

Figure 10 - Assembling Trim

5. Optional Surround Bottom

Remove surround bottom from carton. Place hooks on the surround bottom through the slots on bottom of the surround side. See Figure 14. Slide the surround bottom to the left. Slide the unit back until the surround is tight to the fireplace. Route power cord away from the unit.



Figure 11 - Attach ON/OFF Rocker Switch Wires



Figure 12 - "ON/OFF" Rocker Switch

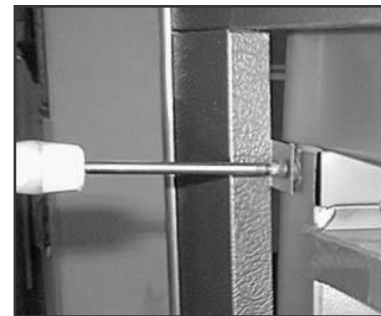

Figure 13 - Attaching Surround



Figure 14 - Optional Surround Bottom

D. ROCK WOOL AND LAVA ROCK PLACEMENT

The logs are shipped in place. If you have any questions regarding the logs, please contact your local dealer or the Arrow Customer Relations Department.

Note: Placement of the Rock Wool and Lava Rock should be done with care and time, as this will effect the look of the fire when burning.

1) Place the Lava Rock. Figure 15 shows the proper way to disperse the Lava Rock. It is not necessary to use the entire bag of Lava Rock.

Lightly sprinkle Vermiculite on top of the Lava Rock to complete the Ash Bed.

2) Placing the Rock Wool.

- a. Tear the Rock Wool into pieces no larger than 1/2" diameter.
- b. Lay the Rock Wool pieces on the top of the Burner so that the flame can touch the Rock Wool and create the glowing ember look.

Be sure not to pack the Rock Wool against the Gas Ports of the Burner. As with the Lava Rock, it is not necessary to use the entire bag of Rock Wool. See Figure 16.



Figure 15 - Placing Lava Rock



Figure 16 - Placing Rock Wool

E. CLEAN THE GLASS

When cleaning the glass, use only non-caustic, non-abrasive cleaners. **DO NOT ATTEMPT TO CLEAN HOT GLASS.** It is dangerous, and the glass is more

likely to be stained by the cleaning agent. Stubborn film can often be removed using Cook Top Cleaning Creme available at appliance centers.

F. INSTALLATION OF GLASS

After cleaning the glass, place the tabs on the glass frame into the slots on the glass retainer. Push the top edge of the glass frame against the unit and latch the glass frame.

WARNING!

Never operate this appliance with the Glass removed OR not sealed.

WARNING!

The Glass Door Assembly shall only be replaced as a complete unit. No substitute materials may be used.

G. INSTALLATION OF FRONT FACE.

Installation for the Arched and Rectangular Front Faces.

1. Remove Front Face from packaging.
2. Place the Hooks on the Front Face into the Slots in the side of the Insert. See Figure 1AF.
3. Let Front Face slide down into the Slots and check that the Hooks are locked into place.



Figure 1AF - Placing Front Face into Slots

Valve Access for the Arched and Rectangular Front Faces

The Valve Access Door, located at the base of the unit front, is opened by pulling forward and up on the Lower Bar or the Access Door Latch to expose the Gas Valve, Pilot Controls, Burner Controls, and Fan Controls. See Figures 2AF and 3AF, page 12.

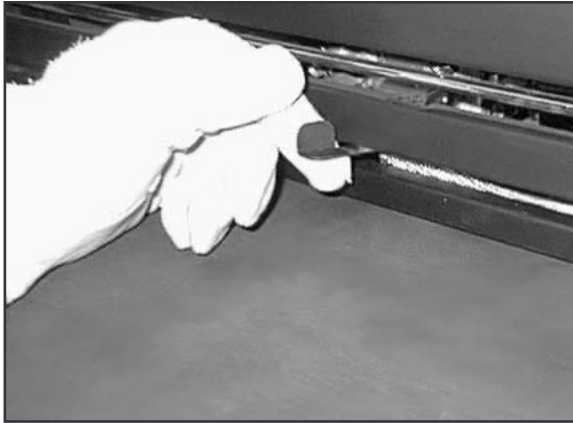

Figure 2AF
Access Door Catch



Figure 3AF
Access Door

Installation of the Bay Front Face.

1. **Turn off power to the Insert by shutting off the Circuit Breaker or unplugging the Power Cord.**
2. Remove Bay Front Face from the packaging.
3. Remove the Switch Bracket by unscrewing the [2] screws located on each side. See Figure 1BF.
4. **For the BF25:** Remove the wire from the Fan Control to the Thermostat. Using the Wire Assembly provided in the Kit, place the Female end of the Wire Assembly to the Thermostat and the Male end to the Black wire on the Fan Control.
- For the BF30/35, go to Step 5.**
5. Place Switch Extension Bracket under the Clip located on the Bottom Pan and slide the Bracket back until it is flush with the front of the Pan. See Figure 2BF.
6. Place the Switch Bracket onto the Extension Bracket using the [2] screws removed earlier in Step 3. See Figure 3BF. **(Make sure all Wires are on tight and NONE of them are touching the Firebox bottom.)**
7. Place Extension Knobs on the corresponding Knobs on the Valve. See Figure 4BF.
8. Place Lava Rock between the Glass and Flange, making sure not to block the Air Slot. See Figure 5BF.
9. Place Hooks on the Bay Front Face into the Slots on the side of the Insert. See Figure 6BF.
10. Let Bay Front Face slide down into the Slots. Check that the Hooks are locked.
11. **Turn Power Back on by turning on the Circuit Breaker or Plugging the Power Cord in.**

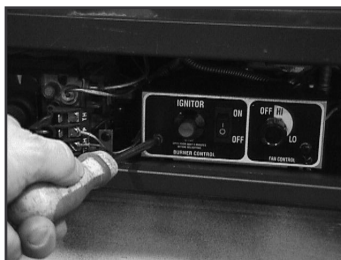

Figure 1BF
Removing the Switch Bracket

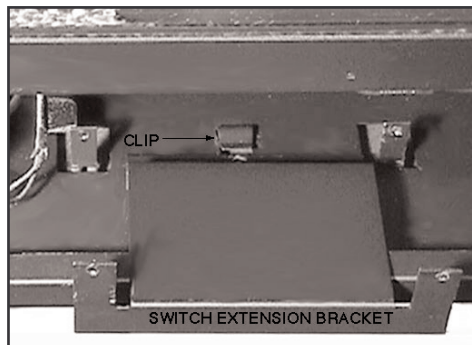

Figure 2BF
Extension Bracket/Clip



Figure 3BF
Replacing Switch onto
Bracket

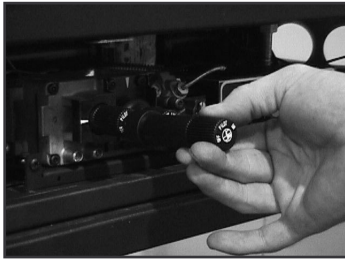

Figure 4BF
Extension Knob

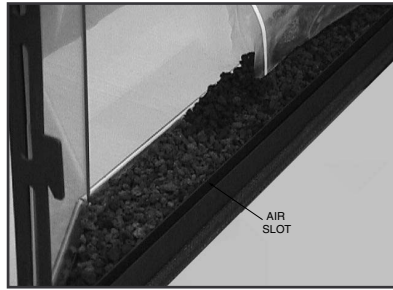

Figure 5BF
Placing Lava Rock Into Bay



Figure 6BF
Placing Bay into Slots

Valve Access for the Bay Front Face.

The Valve Access Door, located at the base of the Bay Front Face, is opened by lifting up on the Door Handle and then rotating downward. This will expose the Gas Valve, Pilot Controls, Burner Controls, and Fan Controls. See Figure 7BF.



Figure 7BF - Valve Access Door

H. GOLD TRIM CLEANING

All prints and smudges must be wiped clean from the gold trim prior to initial burn. If this is not done, these prints will be cured into the gold finish and set for the life of the heater. To keep the finish looking its best, gently wipe with a soft cloth. If desired, use a non-abrasive cleaner such as soap and water. Never use any solvent, thinner, or abrasive cleaner since these will damage the finish.

WARNING!

This appliance is equipped with a Three-prong (grounding) Plug for your protection against shock hazards and should be plugged directly into a properly grounded Three-prong Receptacle. Do not cut or remove the Grounding Prong from this plug.

I. BLOWER

This appliance has a factory installed Blower, Junction Box, variable speed Rheostat Control Switch and Temperature Sensor Switch for the Blower. The Blower, temperature sensor switch and junction box are located behind the lower grille. To provide the 110-120 VAC, 60 HZ are needed at the junction Box. Simply plug the 3-prong grounded cord into a 3-prong grounded 110-120 VAC, 60 HZ wall outlet. This cord exits the unit at the lower right hand front surround corner.

The Temperature Sensor Switch will automatically turn the Blower ON when the unit warms up. To install or service the Blower, this appliance must be removed from the fireplace. Remove the five sheet metal screws holding the Blower cover in place and slide the Blower cover out. Reverse to install the Blower.

WARNING!

DO NOT operate appliance with the Panel(s) removed, cracked or broken. Replacement of the Panel(s) should be done by a Licensed or Qualified Service Person.



J. WIRING

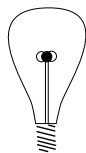

Note: This appliance must be electrically wired and grounded in accordance with local codes or, in the absence of local codes, with National Electric Code ANSI/NFPA 70-latest edition. This appliance can be used with a thermostat.

A 110-120 VAC outlet should be located close to the lower right side of the appliance to allow the Blower to be plugged in.

Note: This appliance **DOES** require a 110-120 VAC supply for operation of the Blower.

WARNING!

DO NOT connect 110 - 120 VAC to the Gas Control Valve or Control Wiring System of this unit.

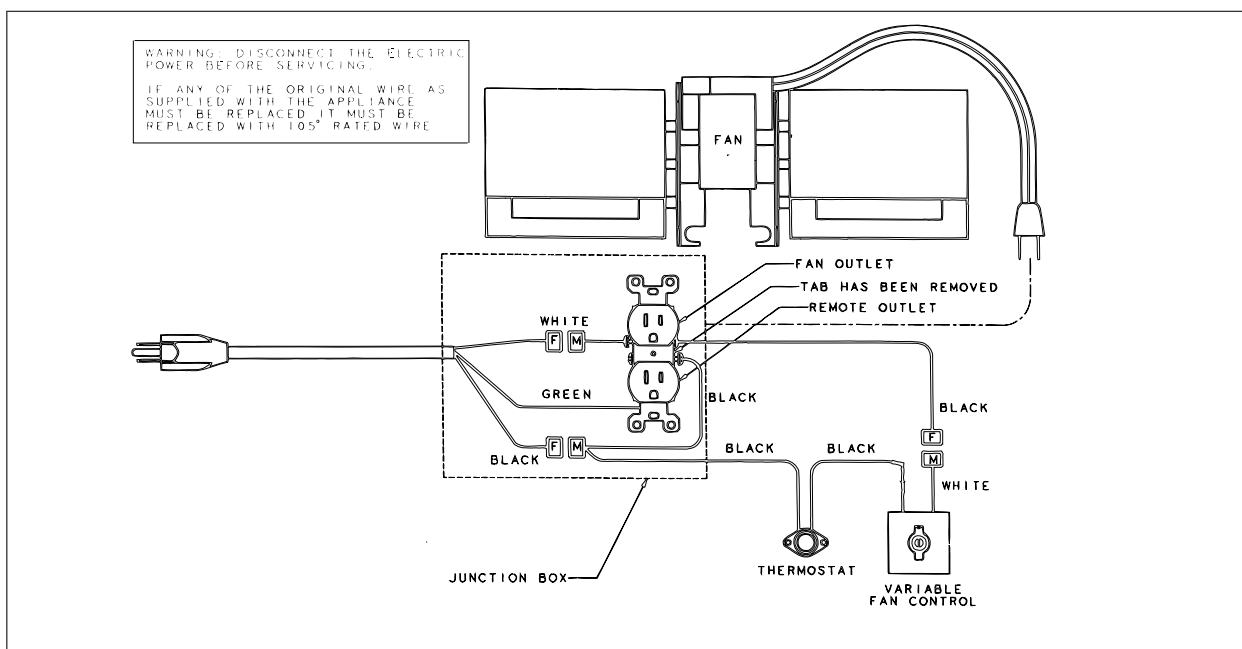

Wiring Diagram A

WIRING TROUBLE SHOOTING

TO TEST JUNCTION BOX ASSEMBLY FOR PROPER FUNCTION:

- I. Insert terminal ends of tester into "FAN" (LH) side of the outlet.
IT SHOULD NOT LIGHT UP.
 - If it does light up, disconnect power cord from power source.
 - Check that only the correct tab is removed.
 - Check that the receptacle is oriented correctly.
 - Retrace the wiring connections
- II. Insert terminal ends of tester into "REMOTE" (RH) side of the outlet.
IT SHOULD LIGHT UP, DESIGNATING THE "HOT" SIDE.

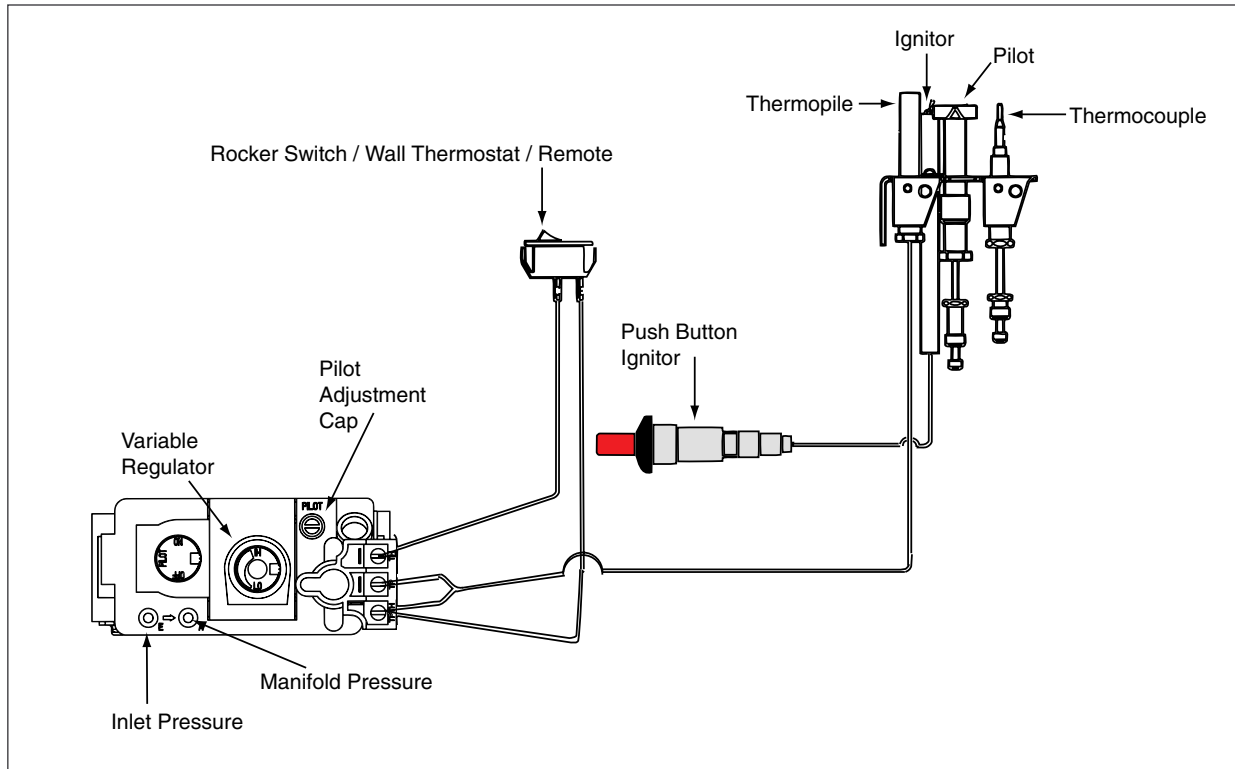

Wiring Diagram B



K. PRE-USE CHECK

Before operating this wall furnace, please review the safety precautions given on page 2 as well as the items listed below:

1. Check to make sure the logs and rock wool have all been placed correctly. See page 11.
2. Check to see that all wiring is correct and enclosed to prevent possible shock.
3. Check to ensure there are no gas leaks. This may be done with a soap and water solution or a gas detector.
4. Make sure the glass is sealed and in its proper position. Never operate this heater with the glass removed or not sealed.
5. Flex liners and terminal cap are properly installed.
6. Prints and smudges are wiped from gold trim.
7. Read and understand these Instructions thoroughly before attempting to operate this wall furnace.



VI. OPERATING INSTRUCTIONS

FOR YOUR SAFETY READ BEFORE LIGHTING



WARNING! If you do not follow these instructions exactly, a fire or explosion may result causing property damage, personal injury or loss of life.

A. This gas appliance has a manual ignition device that lights the pilot. When lighting the pilot, follow these instructions exactly.

B. STOP! BEFORE READING FURTHER, smell around the appliance area for gas. Be sure to smell next to the floor because some gas is heavier than air and will settle to the floor.

WHAT TO DO IF YOU SMELL GAS:

- *Do not try to light the appliance.
- *Do not touch any electric switch; do not use any telephone in your building.
- *Immediately call your gas supplier from a neighbor's telephone. Follow the instructions of your utility.
- *If you cannot reach your utility, call the fire department.

C. IF THE PILOT LIGHT AND BURNER WENT OUT DURING USE, YOU MUST TAKE THE GLASS OFF THE APPLIANCE AND WAIT TO CLEAR OUT ANY GAS. FOLLOW THE LIGHTING INSTRUCTIONS BELOW.

D. Use only your hand to push in or turn the gas control knob to light the pilot. Never use tools. If the knob will not push in or turn by hand, do not try to repair it; call a qualified service technician. Using a tool or attempting repairs may result in a fire or explosion.

E. Do not use this appliance if any part has been under water. Immediately call a qualified service technician to inspect the appliance and to replace any part of the control system and any gas control that has been under water.

LIGHTING INSTRUCTIONS

1. STOP! Read the safety information above.
2. Turn off all electric power to the appliance. If your appliance has a thermostat, set to lowest setting.
3. Open control access panel.
4. Find the pilot. The pilot is inside the combustion chamber next to the main burner.

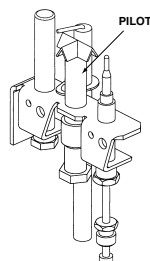

5. If the gas control knob is at the "OFF" position, go to step 7. If the gas control knob is at the "ON" position, go to step 6.

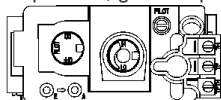

6. If the pilot light went out during normal use with the gas control knob at the "ON" position, turn the gas control knob to the "OFF" position. REMOVE THE FIXED GLASS PANEL. Wait ten (10) minutes to clear out any gas.

7. Smell for gas, including near the floor. If you don't smell gas, go to the next step. If you smell gas, wait another five (5) minutes or until the gas odor is no longer present before continuing. If the odor of gas does not disappear after fifteen (15) minutes, STOP! Follow "B" in the safety information above.

8. Replace glass panel if it has been removed.
9. Turn gas control knob counterclockwise to the "PILOT" position.
10. Push the gas control knob in all the way and hold. At the same time, push in red ignition button repeatedly until the pilot lights. Never hold the gas control knob in for more than ten (10) seconds if the pilot does not light. Once the pilot lights, continue to hold the gas control knob in for 15 seconds. Release the gas control knob and it will pop back up. If pilot does not remain lit, repeat steps 6 through 9.

*If gas control knob does not pop back up when released, turn the knob to "OFF" and call your service technician or gas supplier.

*If the pilot will not stay on after two attempts, turn the gas control knob to "OFF" and call your service technician or gas supplier.

11. Turn gas control knob counterclockwise to the "ON" position. The knob can be turned to the "ON" position only if it is popped out.
12. Close the access panel.
13. Turn on electrical power to the appliance. If equipped with a thermostat, set to the desired setting.

TO TURN OFF GAS TO APPLIANCE

1. Turn rocker switch to OFF or the wall thermostat to lowest setting if your unit is so equipped.
2. Turn off all electric power to the appliance if service is to be performed.
3. Open control access panel.
4. Turn gas control clockwise to "OFF".
5. Close control access panel.

Upon completing the gas line connection, a small amount of air will be in the lines. When first lighting the pilot light, it will take a few minutes for the lines to purge themselves of this air. Once the purging is complete, the pilot and burner will light and operate as indicated in the Instruction Manual.

Subsequent lightings of the appliance will not require such purging.

CAUTION: During the initial purging and subsequent lightings, NEVER allow the gas valve control knob to remain depressed in the “pilot” position without pushing the red ignitor button at least once every second.

When lit for the first time, the appliance will emit a slight odor for an hour or two. This is due to paint and lubricants used in the manufacturing process. Additionally, for the first few minutes after each lighting, vapor may condense and fog the glass and the flames may be blue. After a few minutes, this moisture will disappear and within 15-30 minutes the flames should become yellow.

AIR SHUTTER ADJUSTMENT

CAUTION: The Firebox bottom can get very hot during Air Shutter adjustment procedures. Allow the unit to cool before attempting to adjust the Air Shutter.

The Air Shutter adjusts the amount of air that mixes with the gas as it enters the Burner Pan. To adjust the Air Shutter, locate the Wing Nut underneath the Firebox bottom (see picture above). To Close the Air Shutter, turn the Wing Nut clockwise. To Open the Air Shutter, turn the Wing Nut counterclockwise. The Air Shutter is used to fine tune the flame as necessary for differences in altitude and Vent configuration. The Air Shutter is shipped fully Closed with Natural Gas units and fully Open with L.P. units.

Allow the unit to operate about 15 - 20 minutes. This will give the flame time to reach its height and color before making adjustments to the Air Shutter. As the Air Shutter is Closed, the flame should get taller and darker.

The fireplace may produce a noise, caused from metal expansion and contraction as it heats up and cools down. This noise is similar to one that a furnace or heat duct may produce and does not affect the operation or longevity of the fireplace.



AIR SHUTTER WING NUT

Keep the control compartment, logs, and burner area surrounding the logs clean by vacuuming or brushing at least twice a year.

CAUTION: The Logs can get very hot. - only handle them when they are cool.

SEASONAL SHUTDOWN

When the burning season comes to an end, the entire system should be shut down to prevent gas running to the appliance while it is not in use.

OPERATION PROCEDURE DURING REGULAR USE

Simply turn the switch/thermostat to the ON position. This will ignite the main burner.

SHUTDOWN DURING REGULAR USE

Simply turn the switch/thermostat to OFF. This will disengage the burner and the flames will extinguish.

VII. MAINTENANCE INSTRUCTIONS

CLEANING THE BURNER AND THE CONTROL COMPARTMENT:

Keep the burner and control compartment clean by using a clean, dry paint brush and vacuum at least once a year. Always turn off the gas valve and the switch before cleaning.

CHECKING THE FLAME PATTERN:

Visually check the flame of the burner periodically, making sure the flames are steady; not lifting or floating. The flame color should be blue with yellow tips. The thermopile tip should be covered with flame. See Figure 17.

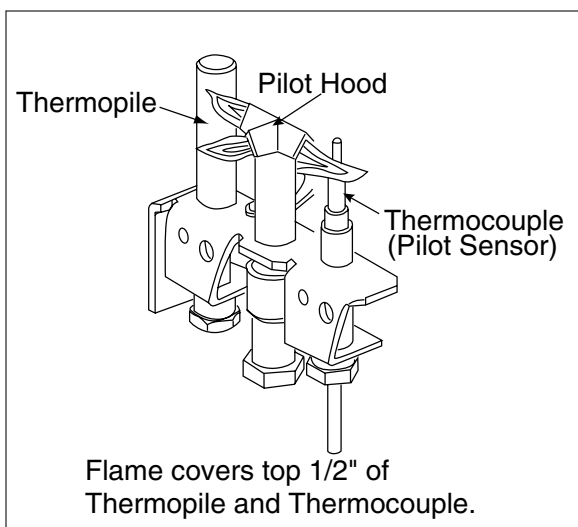

Figure 17 - Standing Pilot

If the vent configuration is installed incorrectly, the vent may cause the flames inside the appliance to lift or "ghost" - a dangerous situation. Inspect the flames after installation to ensure proper performance. If the vent configuration is correct, yet the flames are lifting or ghosting, shut off gas to the appliance and contact the dealer for information on remedying the problem.

The Heater and venting system should be inspected before use each season, and at least annually, by a qualified field service person, to ensure that the flow of combustion and ventilation air is not obstructed.

WARNING!

Do not use this Heater if any part has been under water. Immediately call a Qualified Service Technician to inspect the Heater and to replace any part of the Control System and any Gas Control which has been under water.

CLEANING THE GLASS:

Note: When cleaning the glass, NEVER use abrasive materials. NEVER clean glass when hot.

It is recommended to wear gloves while handling or removing the glass. **DO NOT REMOVE THE GLASS WHEN HOT.**

To gain entry to the firebox for cleaning, follow "Firebox Entry" on page 6.

To clean the glass, use a non-abrasive, mild cleaning solution. (For example, a glass cleaner or for stubborn film, an oven cleaner.) Simply apply an adequate amount to the glass and wipe off with a damp cloth. Please be sure all cleaner is thoroughly rinsed from the glass.

Never operate this appliance without the glass properly secured in place or if the glass is broken.

In the event of glass breakage, follow glass removal instructions. This will allow the removal of all glass fragments and sheet metal edge protection strips. Vacuum all remaining glass pieces with a shop vac. **DO NOT VACUUM IF PIECES ARE HOT.** Replace glass only with ARROW part number ordered direct or through your local distributor. Never use substitute material. Only ceramic glass may be used on this appliance.

LOG CLEANING:

DO NOT REMOVE THE LOG ASSEMBLY WHEN THE APPLIANCE IS HOT. The logs are shipped in position. **DO NOT** remove individual logs to clean. Remove the log assembly by removing [4] screws, [2] located in front and [1] located on each side of the Log Support. Carefully remove the log assembly so that the logs do not shift. Carbon build-up can be removed with a vacuum cleaner.

Caution: Label all wires prior to disconnection when servicing controls. Wiring errors can cause improper and dangerous operation. Verify proper operation after servicing.



VIII. TROUBLE SHOOTING

Problem	Cause	Corrective Action
1. Pilot will not ignite.	A. Gas control knob isn't turned to "PILOT".	Turn knob to PILOT and push in on the valve (see lighting instructions on page 16).
	B. Gas control knob isn't pushed in.	Check the shutoff valve.
	C. Gas is not turned on.	Check the shutoff valve.
	D. Ignitor isn't working.	Check wiring between piezo button and ignitor. Check for cracked ceramic on the electrode. Check spacing of ignitor tip and pilot hood. Spark should be extending approximately 1/8" to the bottom of the pilot hood. Adjust gap as necessary to give proper spark.
2. Pilot will not stay lit.	A. Defective thermocouple.	Check pilot flame. See Figure 17, page 18. Adjust flame if necessary. Be sure thermocouple is constantly in contact with pilot flame. Be sure thermocouple line is attached to valve.
3. Main burner will not light.	A. Pilot has gone out.	Relight pilot (see page 16).
	B. Gas control knob isn't turned to "ON".	Turn valve to "ON".
	C. ON/OFF switch.	Turn switch to "ON". Check wiring connections at the valve and switch.
	D. Thermostat is set too high or is disconnected.	Set thermostat to a lower temperature.
	E. Bad Thermopile.	Check wiring connections and wiring diagram. Not heated up enough (takes about a minute to get up to correct temperature).
4. Glass Fogs up.	A. A normal result of gas combustion.	No action is necessary. After the heater has warmed up, the glass will clear.
5. Blue flames.	A. A normal result during the first 20 minutes of burning.	No action is necessary. Flames will begin to turn more yellowish after about 20 minutes of burning.
6. Flames too short.	Valve on low. Air shutter too wide.	Turn variable head to "HI". Close down air shutter; it is not recommended to close it unless absolutely necessary.
7. Glass soots.	Flame impingement on logs.	Adjust the log set so that the flame does not excessively impinge on it.

IX. REPLACEMENT PARTS

Replacement parts are available from your distributor/dealer, or through ARROW/DOVRE Customer Relations, Aladdin Hearth Products, 401 N.Wynne, Colville, WA 99114.

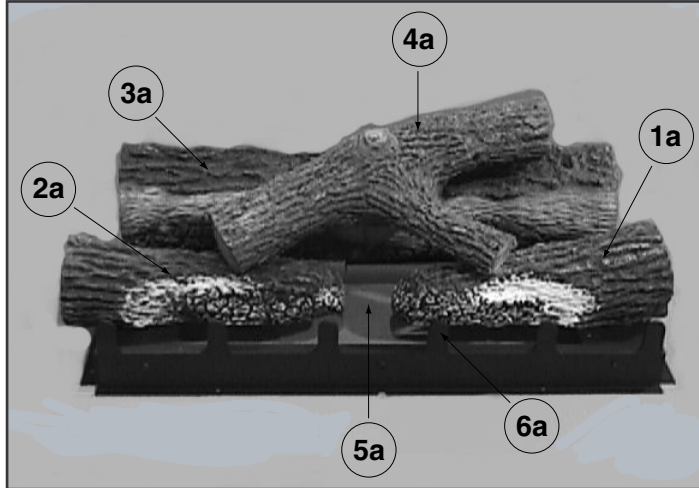

Figure A - DVi35S Log Assembly

ITEM	PART #	DESCRIPTION
A	28297	DVi35S Log Assembly
1a	28423	Right Front Log
2a	28424	Left Front Log
3a	28425	Back Log
4a	28426	Top Log
5a	29716	Log Pan
6a	28281	Grate
7a	14333	Mineral Wool
8a	23509	Lava Rock
9a	28911	Vermiculite

ITEM	PART #	DESCRIPTION
1b	13416	Push Button Ignitor
2b	29478	Pilot Assembly - Natural Gas
	29479	Pilot Assembly - L.P.
3b	17245	SS Flex Gas Line
4b	19641	Brass Fitting - 1/2" - 3/8"
5b	15697	"ON/OFF" Valve
6b	16564	Valve Connector
7b	29850	Valve Bracket
8b	12387	#10-32 x 3/16 Screw
9b	29484	Valve - Natural Gas
	29485	Valve - L.P.
10b	17524	Brass Elbow
11b	26203	Wire Assembly
12b	25398	"ON/OFF" Rocker Switch
13b	25702	Flex Line
14b	26457	Bulkhead
15b	26617	.115"/2.92mm Orifice - Natural Gas
	18678	.070"/1.778 mm Orifice - L.P.

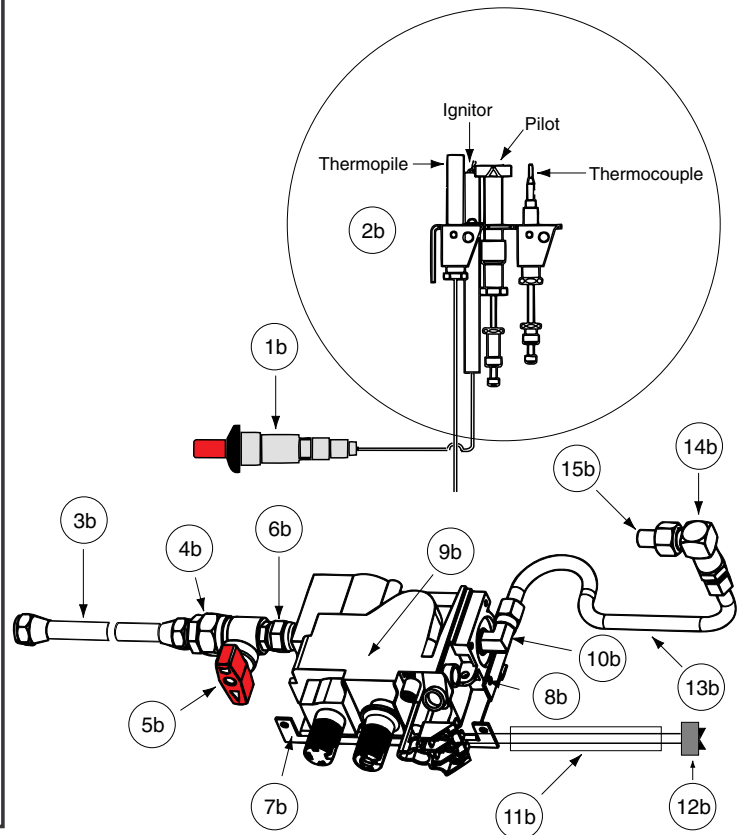
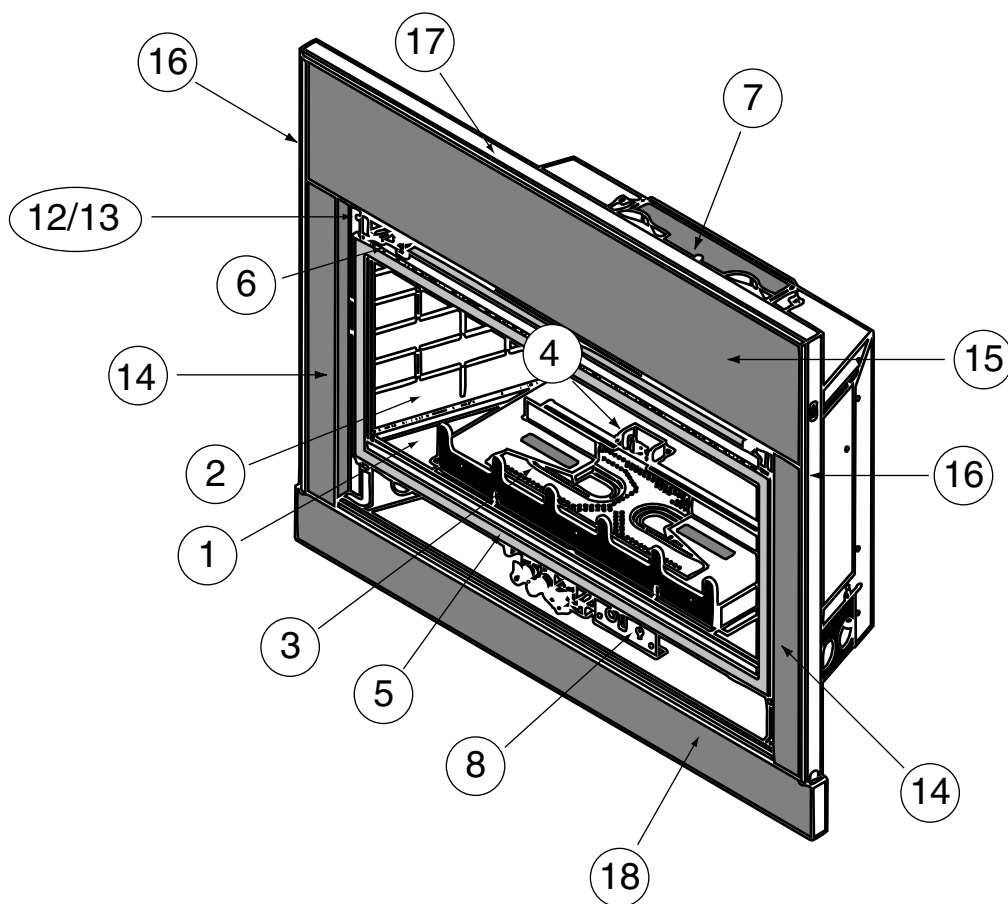

Figure B - Burner/Pilot Assembly

REPLACEMENT PARTS CONTINUED

ITEM	PART#	DESCRIPTION
1	28280	Hearth Plate
2	28448	Refractory
3	29712	Burner Assembly
4	28456	Pilot Shield
5	28270	Door Frame Assembly
	28271	Door Frame
	28284	Glass Assembly
6	27895	Latch Assembly
7	29718	Termination Plate Assembly
8	28457	Switch Bracket
9	20613	Fan Var. Speed Cont. (Not Shown)
10	27234	Thermostat Assembly (Not Shown)
11	27097	Fan Assembly (Not Shown)
12	27710	Tinnerman Clip

ITEM	PART#	DESCRIPTION
13	27711	#10 x 3/4 Black Screw
14	28434	Side Surround (RH) - 44
	28435	Side Surround (RH) - 48
	28432	Side Surround (LH) - 44
	28433	Side Surround (LH) - 48
15	28436	Top Surround - 44
	28437	Top Surround - 48
16	26997	Side Trim (RH) - 44/48
	26994	Side Trim (LH) - 44/48
17	19178	Top Trim - 44
	28439	Top Trim - 48
18	28429	Bottom Surround Assembly - 44
	28430	Bottom Surround Assembly - 48



REPLACEMENT PARTS CONTINUED

RF35 - Rectangular Face Kit

ITEM	PART #	DESCRIPTION
R	28450	Rectangular Front Face Ass.
	28449	Front Face
	28274	Front Face Top and Bottom
	28275	Decorative Rod - Gold
	27071	Hair Pin Cotter
	28276	Door Frame Trim
	28743	Access Tab

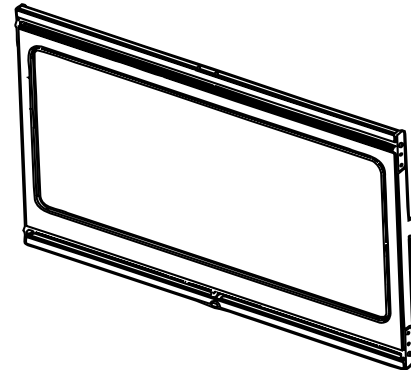

AF35 - Arched Face Kit

ITEM	PART #	DESCRIPTION
A	28272	Arched Front Face Assembly
	28273	Front Face
	28274	Front Face Top and Bottom
	28275	Decorative Rod - Gold
	27071	Hair Pin Cotter
	28277	Door Frame Trim - Top
	28276	Door Frame Trim - Bottom
	28743	Access Tab

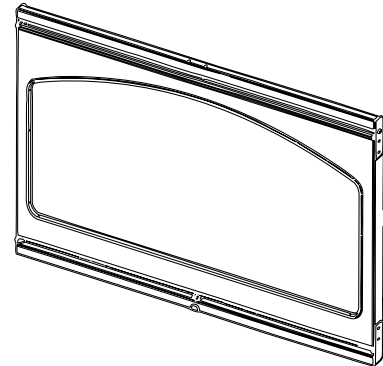

BF35 - Bay Face Kit

ITEM	PART #	DESCRIPTION
B	29601	Bay Front Face Assembly
	29600	Top Face
	29598	Upper Front Face
	29597	Front Face
	29599	Lower Front Face
	29605	Lower Access Cover
	29607	Access Tab
	29603	Hearth Insert
	29711	Hearth Channel
	29604	Glass Retainer
	29609	Glass Panel - Side
	29608	Glass Panel - Front
	29606	Door Frame Trim Bay
	29602	Decorative Trim
2	23509	Lava Rock - 1lb.
3	28278	Switch Bracket Extension
4	28746	Vermiculite
5	29475	Valve Extension Knob - Pilot
6	29480	Valve Extension Knob - HI/LO
7	27807	Wire Assembly

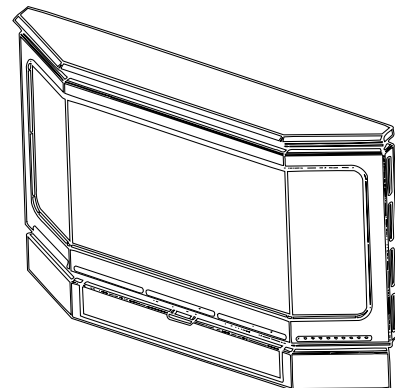



LIFETIME WARRANTY

LIFETIME WARRANTY

The Aladdin Hearth Products limited Lifetime Warranty guarantees that the following components will work as designed for the lifetime of the stove or Aladdin Hearth Products will repair or replace them. These items include but are not limited to steel and cast iron components, flame plate, firebox reflector, combustion chambers, heat exchanger systems, stainless steel firebox components, burners, gas logs, gold plating, doors, glass damaged by thermal breakage, steel baffles and manifold tubes.

THREE YEAR WARRANTY

Our EZ Clean and ceramic firepots are both covered under Aladdin's three-year warranty program.

ONE YEAR WARRANTY

All electrical components such as but not limited to blowers, wiring vacuum switches, speed controls, control boxes, thermocouple switches, pilot assembly, ignitors and gas valves are covered under Aladdin's one-year warranty program. Carburetors are covered under Aladdin's one-year warranty. Labor to repair or replace these parts is covered for one year, reimbursed per our warranty service fee schedule.

CONDITIONS

This warranty is non-transferable and is made to the original retail price purchaser only, provided that the purchase was made through an authorized dealer of Aladdin Hearth Products. This Aladdin product must be installed by a competent, authorized service contractor. It must be installed and operated at all times in accordance with the Installation and Operating Instructions furnished with this product, as well as any applicable local and national codes. Any alteration, willful abuse, accident, or misuse of the product shall nullify this warranty.

Labor to repair or replace items covered under the limited Lifetime Warranty will be covered for the first five years per our warranty service fee reimbursement schedule. Parts covered under the limited Lifetime Warranty will be covered for the lifetime of the appliance up to a maximum of five years after Aladdin Hearth Products discontinues the model. Adjustments, regular maintenance and cleaning, and temporary repairs do not qualify for a service call fee and will not be covered. The replacement of consumer replaceable items and installation of upgraded component parts do not qualify for a service call fee, and will not be covered.

This limited Lifetime Warranty does not extend to or include surface finish of the stove, door gasketing, glass gasketing, thermocouple covers, firebrick, kaowool or other ceramic insulating materials. It does not cover installation or operational-related such as overfiring, use of corrosive driftwood, downdrafts or spillage caused by environmental conditions, nearby trees, building, hilltops, mountains, inadequate venting or ventilation, excessive offsets, or negative air pressures caused by mechanical systems such as furnaces, fans, clothes dryers, etc.

Any installation, construction, transportation or other related costs or expenses arising from defective part(s), repair, replacement, etc., will not be covered by this warranty, nor will Aladdin Hearth Products assume responsibility for them. Further, Aladdin Hearth Products will not be responsible for any incidental, indirect, or consequential damages, except as provided by law. Aladdin Hearth Products will not be responsible for any alteration to the unit which causes sooting that results in damage to the interior or exterior of the building in which this appliance is installed. This limited Lifetime Warranty does not apply to venting components, hearth components or other accessories used in conjunction with the installation of this product not manufactured by Aladdin Hearth Products.

This warranty is void if the stove has been operated in atmospheres contaminated by chlorine, fluorine, or there is any damage to the stove or other components due to water or weather damage which is the result of, but not limited to, improper chimney or venting installation. Aladdin Hearth Products may, at its discretion, fully discharge all obligations with respect to this warranty by either repairing or replacing the unit, or refunding the wholesale price of the defective part(s).

This limited Lifetime Warranty is effective on all Dovre and Arrow stoves sold at point of purchase after July 1, 1998, and all Quadra-Fire stoves sold after September 1, 1996, and supersedes any and all warranties currently in existence.

Attention

INSTALLER

***Please return these
Operating & Installation
Instructions to the
Consumer***



Aladdin Hearth Products
401 N Wynne
Colville, WA 99114
A Division of Hearth Technologies Inc.