

Halston, Folio and Forge Doors

Model: HE36CLX-S

Installation & Operating Instructions



Leave this manual with party responsible for use and operation.

CAUTION! Risk of Cuts, Abrasions or Flying Debris. Wear protective gloves and safety glasses during installation. Sheet metal edges are sharp.

⚠ WARNING



HOT SURFACES!

Glass and other surfaces are hot during operation AND cool down.

Hot glass will cause burns.

- **DO NOT** touch glass until it is cooled
- NEVER allow children to touch glass
- Keep children away

- CAREFULLY SUPERVISE children in same room as fireplace.
- Alert children and adults to hazards of high temperatures.

High temperatures may ignite clothing or other flammable materials.

- Keep clothing, furniture, draperies and other flammable materials away.
- Do NOT operate with protective barriers open or removed.
- The doors must remain closed if children will be present during the operation of the fireplace.
- Halston doors may be made operable per these instructions. This may be done only upon request of a person responsible for the use and operation of the fireplace.
- Halston doors can be returned to the locked position following these instructions.
- These instructions are to be left with a person responsible for the use and operation of the fireplace.

WARNING! Risk of Fire! Combustible materials **MUST NOT** overlap or be placed behind a decorative front.

CAUTION! Do not install damaged components.

A. Finishing Material

It's very important to know what kind of finishing material is going to be used on the fireplace. Table 1 shows the door models and the corresponding dimensions of the finishing material opening. Doors can be installed within finishing materials or can overlap finishing materials with a maximum thickness of 1 inch. See Figure 1 and Figure 2.

HE36CLX-S					
DOOR	FIT	FINISH MATERIAL THICKNESS (INCHES)	SEE FIGURE	X (INCHES)	Y (INCHES)
Halston	Inside	4	2	38-1/4	34-3/8
	Overlap	1	1	NA	NA
Forge	Inside	4	2	38-1/4	34-3/8
	Overlap	1	1	NA	NA
Folio	Inside	4	2	38-1/4	34-3/8
	Overlap	1	1	NA	NA

Table 1.

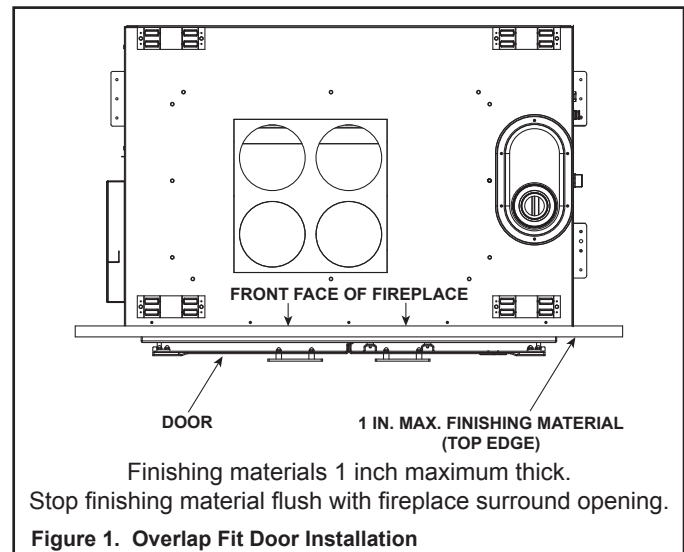

B. Door Preparation

1. Remove door from the package.
2. Remove mounting brackets and screws from package.
3. It will be necessary to partially separate the firebox from the outer shell of the appliance. Use a Phillips screwdriver to loosen the 1/4 turn fasteners on the two latches on the lower front face of the appliance and carefully pull the firebox out approximately two inches using both hands.

WARNING! Risk of injury! Support firebox with support wheels. Firebox may tip when pulled away from outer shell.

CAUTION! Risk of injury! Avoid pinch points by grasping only front and side of appliance door when pushing back into place.

NOTICE! Appliance is heavy. Slide out and in carefully to avoid scratching floor or hearth.

4. Engage support wheels. This appliance is fitted with linear motion slide mechanisms to provide guidance and support of the appliance as it is separated from the outer shell. These slide mechanisms will deflect under the weight of the firebox. This deflection presents the possibility of the firebox contacting flooring materials as it is transferred in and out of the outer shell. The appliance is equipped with support wheel assemblies to carry the load and to reduce the possibility of damage to flooring.

There is one adjustable support wheel on both the left and right sides of the firebox to help support the weight of the firebox when it is being pulled out. Pull appliance out approximately four inches to access the support wheels. To utilize the support wheel, loosen the nuts and adjust the wheel to the desired height. Use care when pulling appliance out to avoid scratching the floor or hearth. Rest the slide in the slot at the appropriate height and tighten the nuts. If the firebox will be extended to a point where the wheel does not touch the surface, an additional means of support will be needed.

5. Attach door brackets to appliance glass frame using the four mounting screws (see Figure 4). The flat front of the bracket needs to sit flush with the desired depth of the door. For example: If the door is to fit tight against the appliance, install the brackets flush with the face of the appliance. If the door is to sit up tight against a finishing material with maximum thickness of one inch, the brackets should be flush with the face of the material.
6. When finished with door bracket installation, push the firebox back to within four inches of closing, adjust the support wheels to the original stowed position and secure in place. Engage the 1/4 turn fasteners on the latches on the lower front face of the appliance, to secure it within the outer shell.

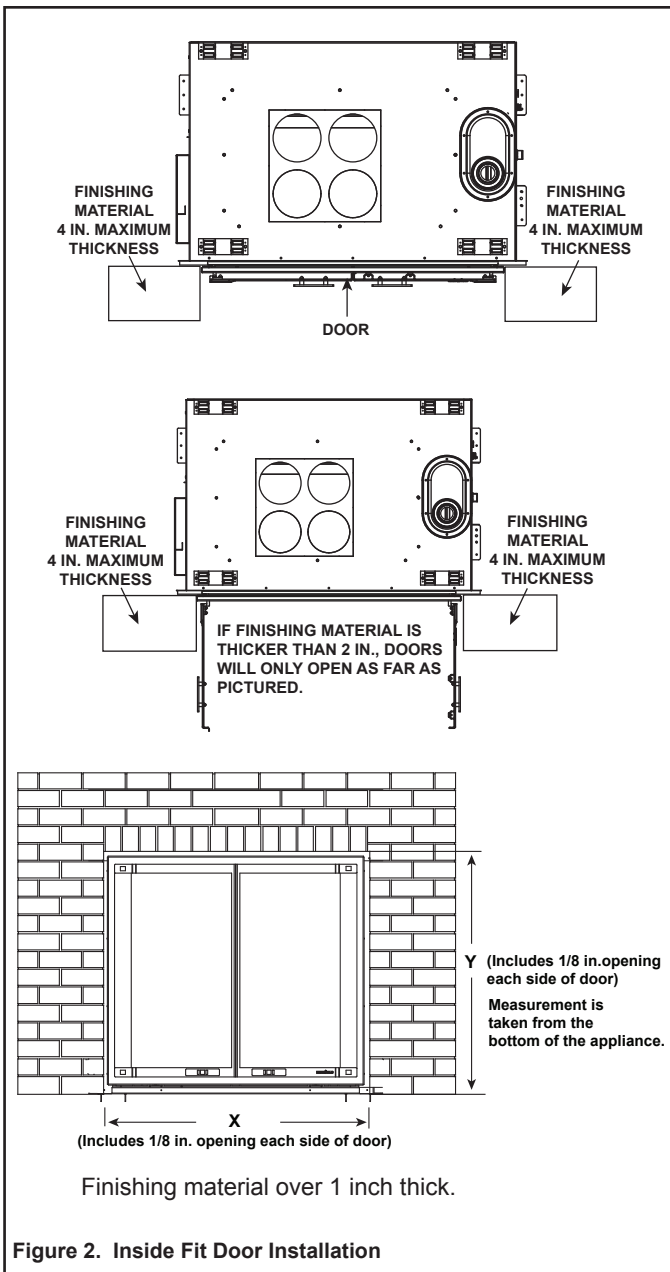

Figure 2. Inside Fit Door Installation

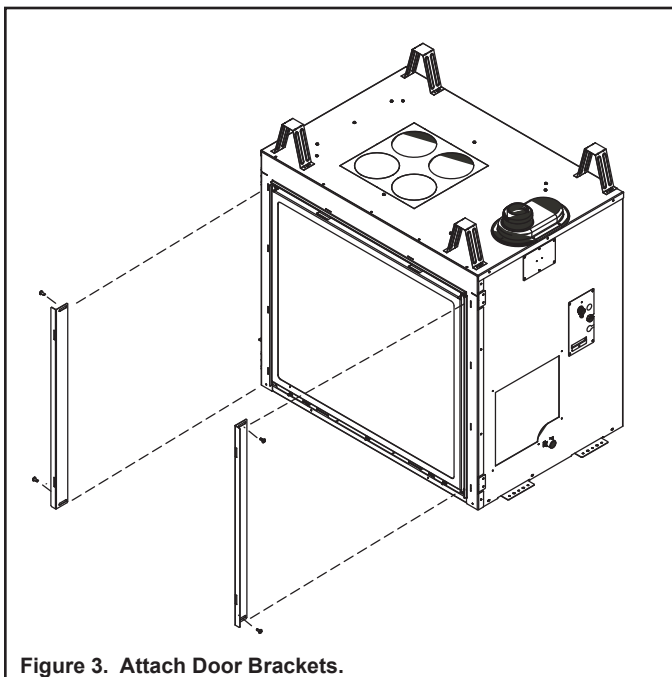

Figure 3. Attach Door Brackets.

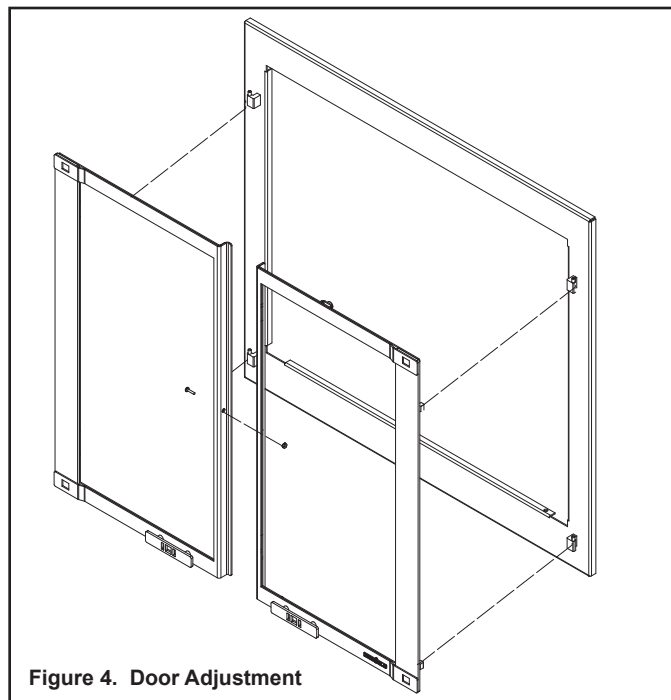

Figure 4. Door Adjustment

C. Operable Door Installation - HALSTON

1. The doors are shipped with a child safety locking bolt. To lock the doors, a Phillips screw driver and a 3/8 in. wrench will be needed. After hanging the doors on the frame, place the bolt through the back of the doors. The bolt goes through both doors in the middle, and is retained by a nut to prevent them from operating. See Figure 4.
2. If the bolt and nut used as a child safety lock are removed, store them in the bottom return bend for future use. See Figure 5.
3. Mount door frame onto the mounting brackets previously attached to this appliance by latching the door J-hooks onto the receiving brackets on the fireplace. Ensure that door frame is secure.

CAUTION! Glass is hot during operation and cool down. These doors are supplied from the factory with parts to lock them shut for child safety.

- To avoid burns or clothing ignition the doors must remain closed if children will be present during the operation and cool down of the fireplace.
- These doors may be assembled in locked or operable condition. They must only be made operable upon request of a person responsible for the use and operation of the fireplace. They may be returned to the locked position following these instructions.
- These instructions are to be left with a person responsible for the use and operation of the fireplace.

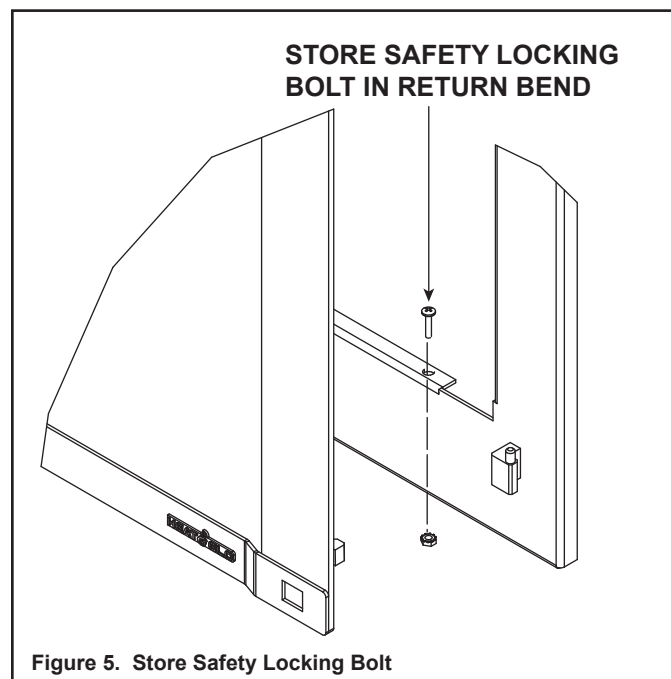

Figure 5. Store Safety Locking Bolt

D. Inoperable Door Installation

Folio and Forge

1. Mount door onto the mounting brackets previously attached to this appliance by latching the door J-hooks onto the receiving brackets on the fireplace. Ensure door is secure.

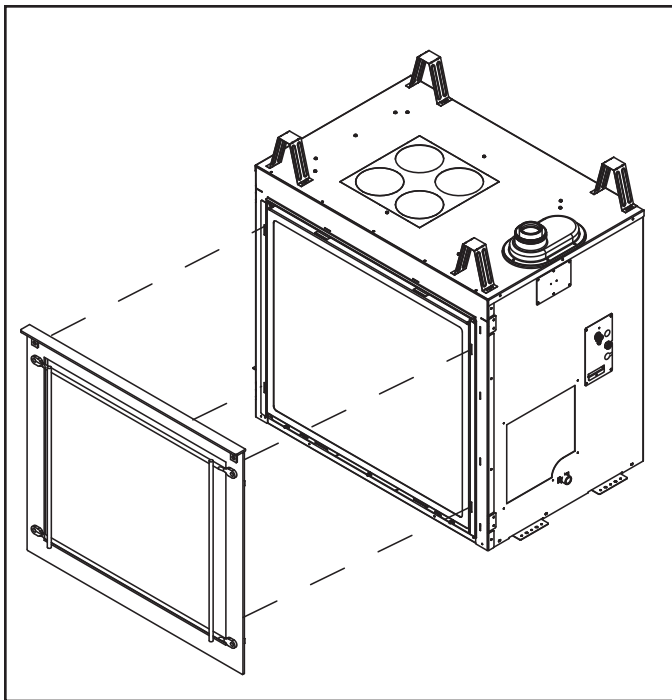

Figure 6. Door Installation

Note: To avoid potential damage to hearth pad or flooring, protect area in front of fireplace by laying cardboard or blanket down.

Cleaning Instructions for Doors

Use a microfiber cloth and Windex® Original Glass Cleaner or 03M003 Stove Bright® Glass Cleaner to clean the door immediately after installation to remove acids deposited by the installer or technician. Spray the cleaner onto the microfiber cloth and carefully wipe the entire surface. The door should be cleaned in this manner annually by the homeowner to remove fingerprints or other contaminants. Once oxidation of the paint pigment has occurred, cleaning will not restore the original color.

Please contact your Heat & Glo dealer with any questions or concerns.

For the location of your nearest Heat & Glo dealer, please visit www.heatnglo.com.

Heat & Glo, a brand of Hearth & Home Technologies Inc.
7571 215th Street West, Lakeville, MN 55044
www.heatnglo.com