

MEDIA AND REFRACTORY INSTALLATION MODELS: RED40, RED40ST

This instruction includes information for installing media and refractory options for the RED40 and RED40ST models.

CAUTION! Risk of Burns! The fireplace shall be turned off and cooled before refractory or rock media is installed.

WARNING



HOT SURFACES!

Glass and other surfaces are hot during operation AND cool down.

Hot glass will cause burns.

- **DO NOT** touch glass until it is cooled
- NEVER allow children to touch glass
- Keep children away

- CAREFULLY SUPERVISE children in same room as fireplace.
- Alert children and adults to hazards of high temperatures.

High temperatures may ignite clothing or other flammable materials.

- Keep clothing, furniture, draperies and other flammable materials away.

This appliance has been supplied with an integral barrier to prevent direct contact with the fixed glass panel. DO NOT operate the appliance with the barrier removed.

Contact your dealer or Hearth & Home Technologies if the barrier is not present or help is needed to properly install one.

CAUTION! Risk of Cuts, Abrasions or Flying Debris. Wear protective gloves and safety glasses during installation. Sheet metal edges are sharp.

Preparation

The appliance should be turned off and cooled and the glass removed before installing any of these components. See appliance installation manual for instructions on removing the glass assembly.

Remove any refractory or media currently on appliance. After removing these items, the base pan will be visible on the inside of the firebox. Base Pan will look like Figure 1.A.8, 1.B.5, or 2.C.7 in this instruction. Proceed to appropriate accessory installation instruction.

Table of Contents

1 Porcelain Installation

A. RED40 Model Without Media or Lights	2
B. RED40 Model With Media or Media/Lights	6
C. RED40ST Model Without Media or Lights	8
D. RED40ST Model With Media or Media/Lights	11

2 Granite Installation

A. RED40 Model	13
B. RED40ST Model	16

3 Sheet Metal Refractory Installation

A. RED40	18
B. RED40ST	21

4 Rock Media

A. Installation	23
-----------------	----

1 Porcelain Installation

Install Porcelain according to these instructions.

CAUTION! Risk of Burns! The fireplace should be turned off and cooled before refractory is installed.

CAUTION! Risk of Cuts or Abrasions. Wear protective gloves and safety glasses during installation. Sheet metal edges are sharp.

Note: Optional Porcelain or Granite Kits used with lighted and non-lighted media models must be placed in appliance before placing glass media in the appliance.

A. RED40 Model Without Media or Lights

This kit contains the components necessary to install the porcelain on single sided RED40 models that do not have media or lights installed. For installation on other models, refer to the instructions included with the appropriate kit.

Kit Contents:

- (1) Back panel. See Figure 1.A.1.
- (2) Side panels. See Figure 1.A.2.
- (2) Corner Panels. See Figure 1.A.3.
- (5) Angle tabs and (5) Sheet metal screws. See Figure 1.A.4.
- (1) Inner Back Panel. See Figure 1.A.5.
- (1) Inner Front Panel. See Figure 1.A.6.
- (1) Outer Bottom Panel. See Figure 1.A.7.

Tools Required:

- Cordless Drill
- 1/4 inch hex head driver tip



Figure 1.A.1. Back Panel



Figure 1.A.2. Side Panels

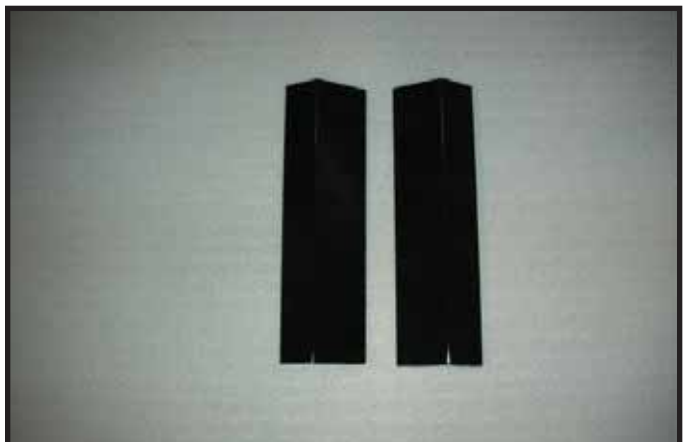

Figure 1.A.3. Corner Panels



Figure 1.A.4. Angle Tabs with Screws



Figure 1.A.5. Inner Back Panel



Figure 1.A.6. Inner Front Panel



Figure 1.A.7. Outer Bottom Panel

Installation

1. Verify the correct base pan is in the appliance before proceeding with the porcelain installation. The base pan required for this application has the letters “NNN” and “NNP” stamped in it. See Figure 1.A.8. If the base pan does not have these letters stamped in it, contact your dealer.



Figure 1.A.8. Location of Base Pan Identification

2. Begin by placing the back panel into the firebox, bottom side first, then tilt top backward into position. Secure with angle tabs and screws in the three pilot holes that are located on the top of the firebox. See Figure 1.A.9.
3. Place each side panel into firebox, bottom side first, then tilt top backward into position. Secure with angle tabs and screws in the pilot holes that have are located on the top of the firebox. See Figure 1.A.10.



Figure 1.A.9. Fastening Angle Tab to Secure Back Panel



Figure 1.A.10. Fastening Angle Tab to Secure Side Panel

4. Place inner back panel into bottom of fireplace with tabs facing the burner. Center from front to back. There will be a gap between the front edge of the inner back panel and the burner area and also a gap between the back of the inner back panel and the back panel. These two gaps should be equal. See Figure 1.A.11.
5. Install inner front panel. Position into bottom of fireplace with tabs facing the outside edge of the firebox. Center from front to back. There will be a gap between the front edge of the inner front panel and the front of the firebox and also a gap between the back of the inner front panel and the burner rail. These two gaps should be equal. See Figure 1.A.11.

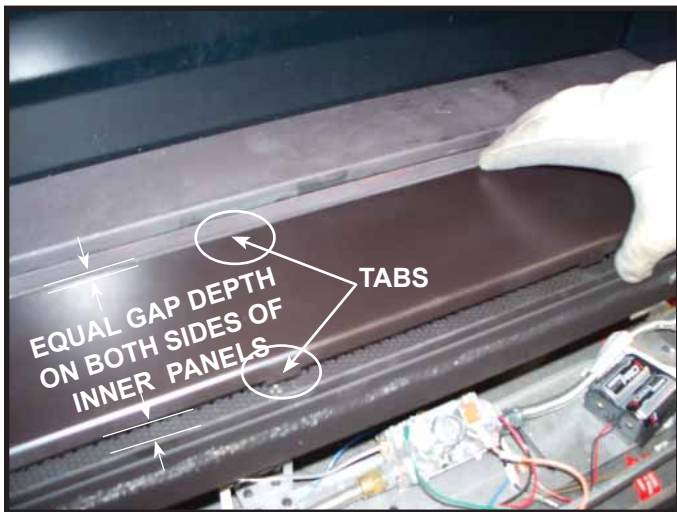

Figure 1.A.11. Placing Inner Panels

6. Install glass frame assembly per the instructions in the installation manual. Set access panel assembly into position.
7. Position access panel assembly so tabs are facing the glass assembly. Insert into glass frame. See Figure 1.A.12.

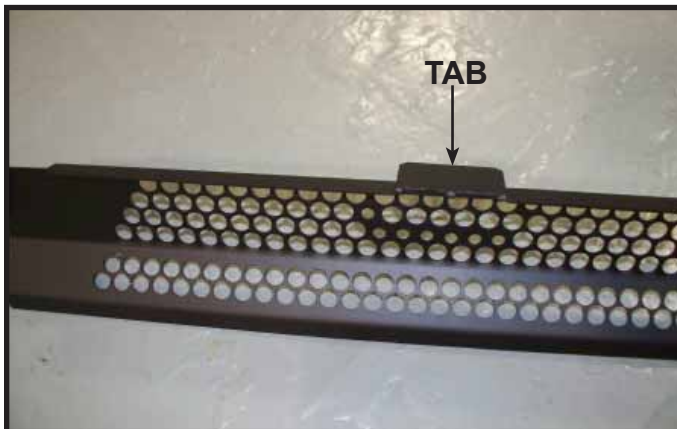

Figure 1.A.12. Positioning Access Panel Assembly



Figure 1.A.13. Access Panel Assembly Installed

8. Place outer bottom panel onto shelf. Place so the cutouts are in line with the outside edges of the glass frame. See Figure 1.A.14.



Figure 1.A.14. Outer Bottom Panel Installed

9. Attach one end of chain to the tab on the back side of both corner panels. See Figure 1.A.15.



Figure 1.A.15. Attaching Chain

10. Remove screw from inside wall behind face of fireplace in front of glass and to the side. Attach chain to fireplace using this screw. Corner panel will hang from appliance until installed. The chain is a safety feature and should remain connected at all times.

CAUTION! DO NOT operate appliance without safety chains attached. Safety chains retain corner panels in event of delayed ignition.

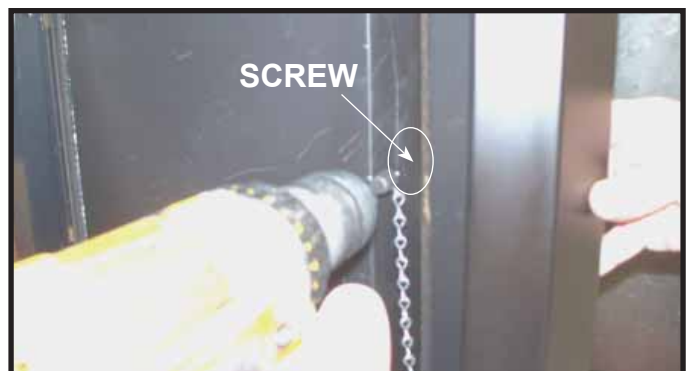

Figure 1.A.16. Attaching Chain

11. Install four hood clips (included) as shown in Figure 1.A.17. Outside corner trim panel will be forced into clip on front of appliance. Put any chain slack inside the appliance and then install corner trim panels. See Figure 1.A.18 and Figure 1.A.19.

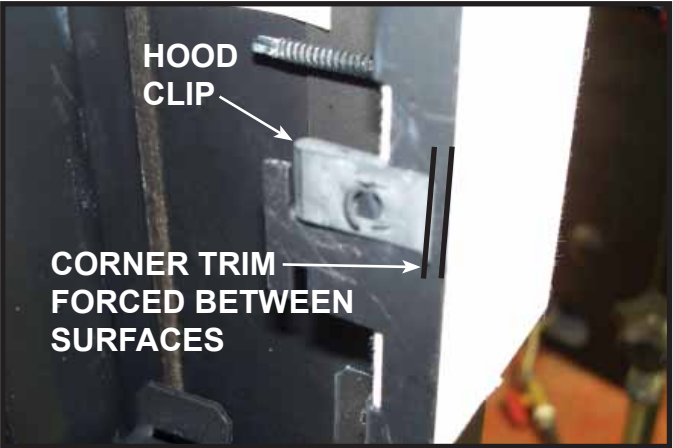

Figure 1.A.17. Clip Location



Figure 1.A.18. Installing Corner Panel onto Clip



Figure 1.A.19. Corner Panel Installed

Service Parts

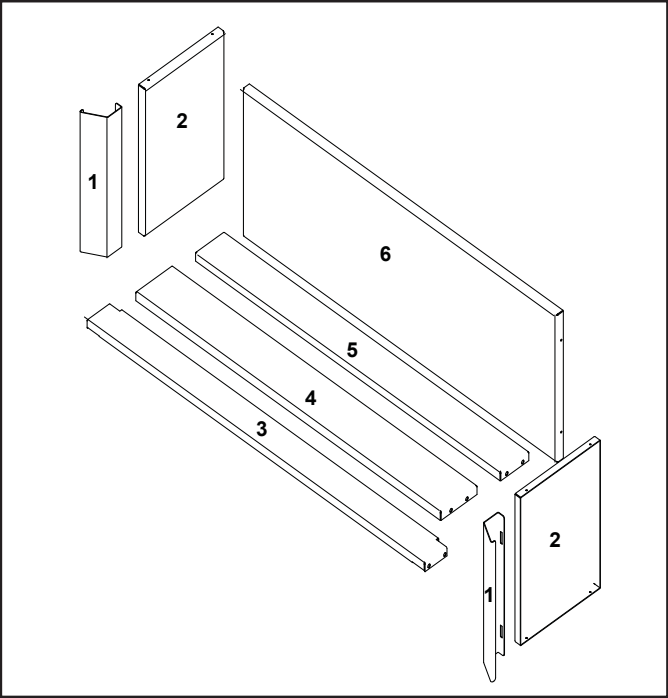

Figure 1.A.20. Service Parts Diagram

ITEM	DESCRIPTION	COMMENTS	PART NUMBER
	Refractory Kit		POR40-F
1	Refractory, Corner (Qty 2 req)		2155-230
2	Refractory, Side (Qty 2 req)		2155-223
3	Refractory,Outer Bottom		2155-226
4	Refractory, Inner Front		2155-224
5	Refractory, Inner		2155-225
6	Refractory, Back		2155-222

B. RED40 Model With Media or Media/Lights

This kit contains the components necessary to install the porcelain on single sided model RED40 models that have media or media/lights installed. For installation on other models, refer to the instructions included with the appropriate kit.

Kit Contents:

- (1) Back Panel. See Figure 1.B.1
- (2) Side Panels. See Figure 1.B.2
- (2) Corner Panels. See Figure 1.B.3.
- (5) Angle tabs and (5) Sheet metal screws. See Figure 1.B.4.

Tools Required

Cordless Drill

1/4 inch hex head driver tip



Figure 1.B.1. Back Panel



Figure 1.B.2. Side Panels



Figure 1.B.3. Corner Panels.



Figure 1.B.4. Angle Tabs with Screws

Installation

1. Verify the correct base pan is in the appliance before proceeding with the porcelain installation. The base pan required for this application has the letter "M" stamped in it. See Figure 1.B.5. If the base pan does not have the letter "M" stamped in it, contact your dealer.



Figure 1.B.5. Base Pan

2. Install back panel by placing bottom in first and then tilting the top backward carefully until it touches the back wall. Secure with angle tabs and screws in the three pilot holes that are located on the top of the firebox.



Figure 1.B.6. Installing Angle Tab to Secure Back Panel

3. Install side panels. Place bottom in first and tilt top backward carefully until it touches the side wall. Secure with angle tabs and screws in the pilot holes that are located on the top of the firebox.



Figure 1.B.7. Installing Angle Tab to Secure Side Panel

4. Install glass rocks in base of firebox according to glass media installation instructions.
5. Install glass frame assembly according to instructions in installation manual.

6. Install access panel assembly.
7. Attach one end of chain to the tab on the back side of both corner panels. See Figure 1.B.8.



Figure 1.B.8. Attaching Chain

8. Remove screw from inside wall behind face of fireplace in front of glass and to the side. Attach chain to fireplace using this screw. Corner panel will hang from appliance until installed. The chain is a safety feature and should remain connected at all times.

CAUTION! DO NOT operate appliance without safety chains attached. Safety chains retain corner trim panels in event of delayed ignition.



Figure 1.B.9. Attaching Chain

9. Install four hood clips (included) as shown in Figure 1.B.10. Outside corner trim panel will be forced into clip on front of appliance. Put any chain slack inside the appliance and then install corner trim panels. See Figure 1.B.11 and Figure 1.B.12.

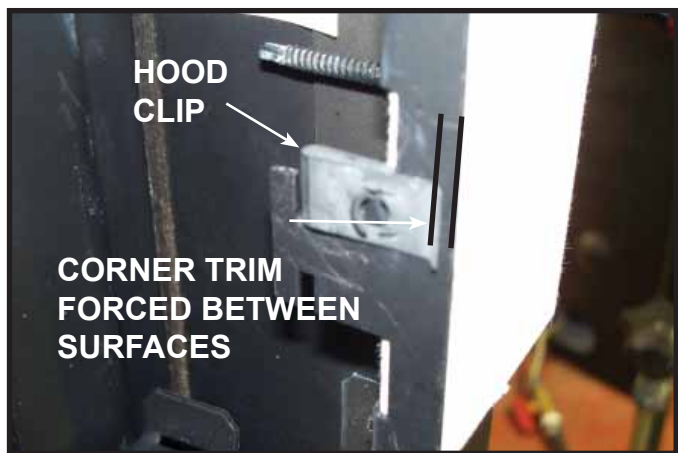

Figure 1.B.10. Clip Location



Figure 1.B.11. Installing Corner Panel onto Clip



Figure 1.B.12. Corner Panel Installed

Service Parts

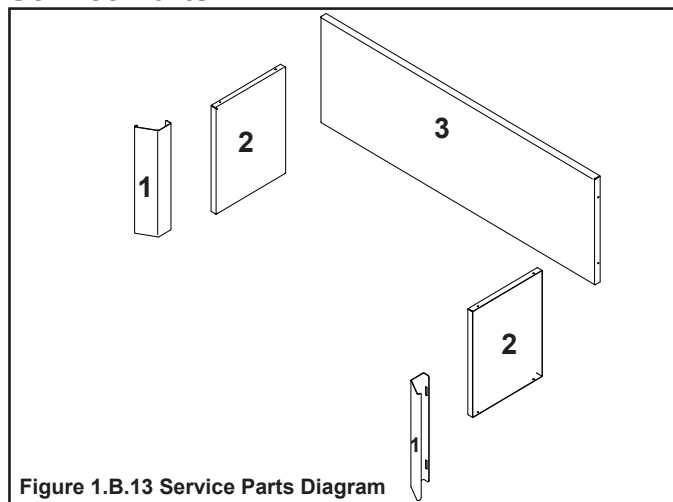

Figure 1.B.13 Service Parts Diagram

ITEM	DESCRIPTION	PART NUMBER
	Refractory Kit	POR40-L
1	Refractory, Corner (Qty 2 req)	2155-219
2	Refractory, Side (Qty 2 req)	2155-223
3	Refractory, Back	2155-222

C. RED40ST Model Without Media or Lights

This kit contains the components necessary to install the porcelain on RED40ST models that do not have media or lights installed. For installation on other models, refer to the instructions included with the appropriate kit.

Kit Contents:

- (2) Side Panels. See Figure 1.C.1.
- (4) Corner Panels. See Figure 1.C.2
- (2) Angle tabs and (2) Sheet metal screws.
See Figure 1.C.3.
- (2) Inner Front Panels. See Figure 1.C.4.
- (2) Outer Bottom Panels. See Figure 1.C.5.

Tools Required:

Cordless Drill
1/4 inch hex head driver tip



Figure 1.C.5. Outer Bottom Panels

Installation

1. Verify that the correct base pan is in the appliance before proceeding with the porcelain installation. The base pan required for this application has the letters “NNN” and “NNP” stamped in it. See Figure 1.C.6. If the base pan does not have these letters stamped in it, contact your dealer.



Figure 1.C.6. Base Pan

2. Begin by placing side panels into the firebox, bottom side first, then tilt top backward into position. Secure with angle tabs and screws in the pilot holes that are located on the top of the firebox as shown in Figure 1.C.7.



Figure 1.C.7. Fastening Side Panel with Angle Tab

3. Place inner front panels into bottom of fireplace with tabs facing the outside edges. Center from front to back. There will be a gap between the front edge of the inner front panels and the burner area and also a gap between the inner front panel and the outside edge of the firebox. These two gaps should be equal. See Figure 1.C.8.



Figure 1.C.1. Side Panels

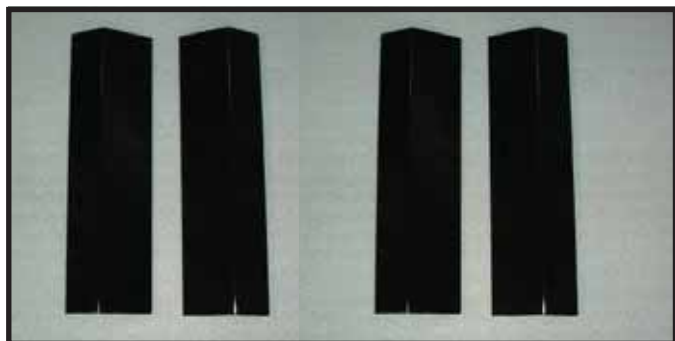

Figure 1.C.2. Corner Panels



Figure 1.C.3. Angle Tabs with Screws



Figure 1.C.4. Inner Front Panels

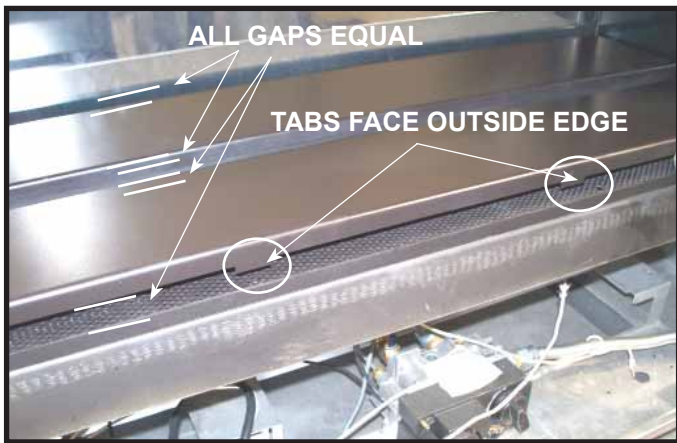

Figure 1.C.8. Inner Front Panels Installed.

4. Install glass frame assemblies according to instructions in appliance installation manual.
5. Install access panel assembly in front of glass. Position the access panel assembly so that the tabs are facing the glass and insert into glass frame.

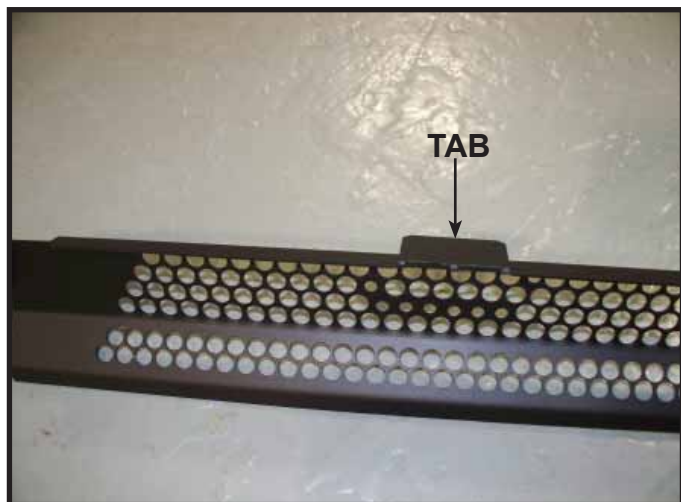

Figure 1.C.9. Positioning Access Panel Assembly



Figure 1.C.10. Access Panel Assembly Installed

6. Place outer bottom panel onto access panel assembly. Position it so the cut-outs are lined up with the outside edges of the glass frame.



Figure 1.C.11. Install Outer Bottom Panel

7. Attach one end of chain to the tab on the back side of all corner panels. See Figure 1.C.12.



Figure 1.C.12. Attaching Chain

8. Remove screw from inside wall behind face of fireplace in front of glass and to the side. Attach chain to fireplace using this screw. Corner panel will hang from appliance until installed. The chain is a safety feature and should remain connected at all times.

CAUTION! DO NOT operate appliance without safety chains attached. Safety chains retain corner panel sides in event of delayed ignition.

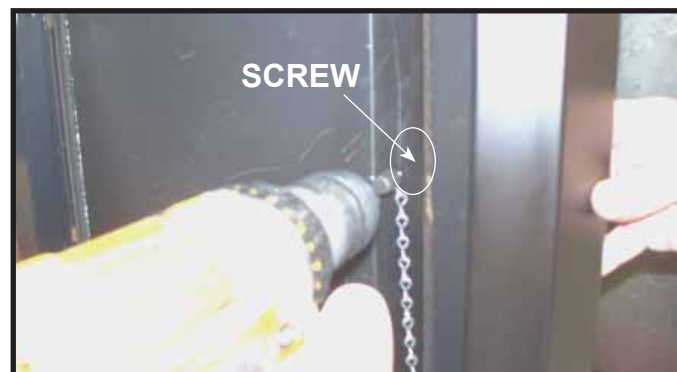

Figure 1.C.13. Attaching Chain

9. Install eight hood clips (included) as shown in Figure 1.C.14. There will be four clips on each side of the appliance. The corner trim panel will be forced into clip on each side of the appliance. Put any chain slack inside the appliance and then install corner trim panels. See Figure 1.C.15.

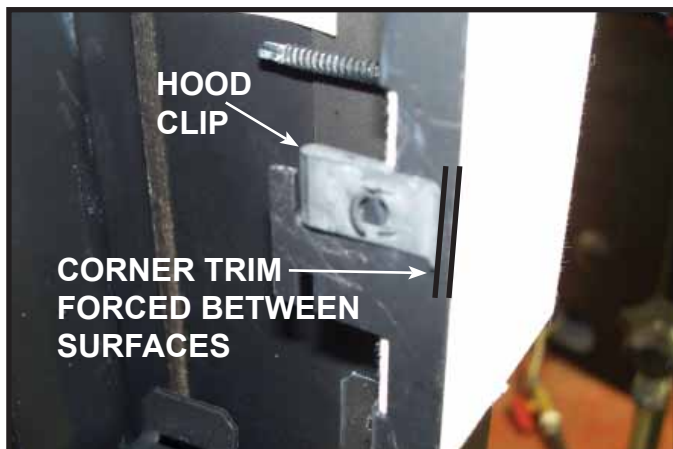

Figure 1.C.14. Clip Location



Figure 1.C.15. Installing Corner Panel onto Clip.

Service Parts

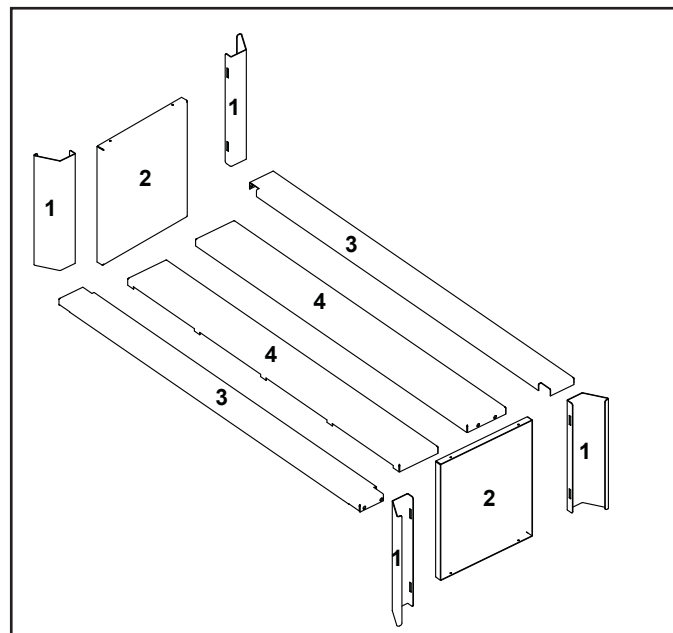

Figure 1.C.16. Service Parts Diagram

ITEM	DESCRIPTION	PART NUMBER
	Refractory Kit	POR40ST-F
1	Refractory, Corner (Qty 4 req)	2155-230
2	Refractory, Side (Qty 2 req)	2175-223
3	Refractory, Outer Btm (Qty 2 req)	2155-226
4	Refractory, Inner Front (Qty 2 req)	2155-224

D. RED40ST Model With Media or Media/Lights

This kit contains the components necessary to install the porcelain on RED40ST models that have media or media/lights installed. For installation on other models, refer to the instructions included with the appropriate kit.

Kit Contents:

- (2) Side Panels. See Figure 1.D.1.
- (4) Corner Panels. See Figure 1.D.2.
- (2) Angle tabs and (2) Sheet metal screws. See Figure 1.D.3.

Tools Required

Cordless Drill
1/4 inch hex head driver tip



Figure 2.D.1. Side Panels.

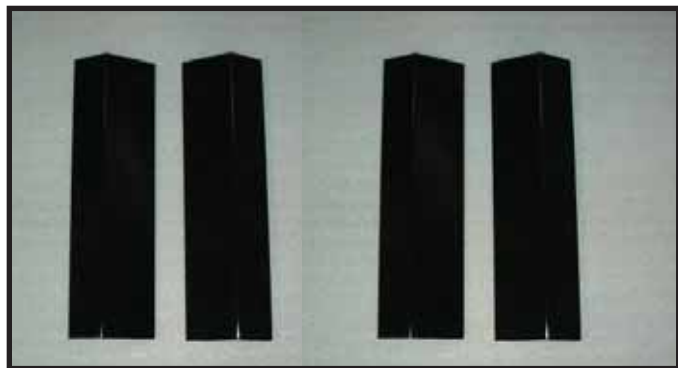

Figure 1.D.2. Corner Panels



Figure 1.D.3. Angle Tabs with Screws

Installation

1. Verify that the correct base pan is in the appliance before proceeding with the porcelain installation. The base pan required for this application has the letter "M" stamped in it. See Figure 1.D.4. If the base pan does not have the letter "M" stamped in it, contact your dealer.



Figure 1.D.4. Base Pan

2. Place side panels into firebox, bottom side first, then tilt top backward into position. Secure with angle tabs and screws in the pilot holes that are located on the top of the firebox.



Figure 1.D.5. Fastening Side Panel with Angle Tab

3. Install glass media inside fireplace according to glass media installation instructions.
4. Install glass frame assemblies on both sides of appliance according to instructions in installation manual.
5. Install access panel assembly on both sides of appliance. Position so that tabs are facing glass and insert into glass frame.
6. Attach one end of chain to the tab on the back side of all corner panels. See Figure 1.D.6.



Figure 1.D.6. Attaching Chain

- Remove screw from inside wall behind face of fireplace in front of glass and to the side. Attach chain to fireplace using this screw. Corner panel will hang from appliance until installed. The chain is a safety feature and should remain connected at all times.

CAUTION! DO NOT operate appliance without safety chains attached. Safety chains retain corner panel sides in event of delayed ignition.



Figure 1.D.7. Attaching Chain

- Install eight hood clips (included) as shown in Figure 1.D.8. There will be four clips on each side of the appliance. The corner trim panel will be forced into clip on each side of the appliance. Put any chain slack inside the appliance and then install corner trim panels. See Figure 1.D.9.

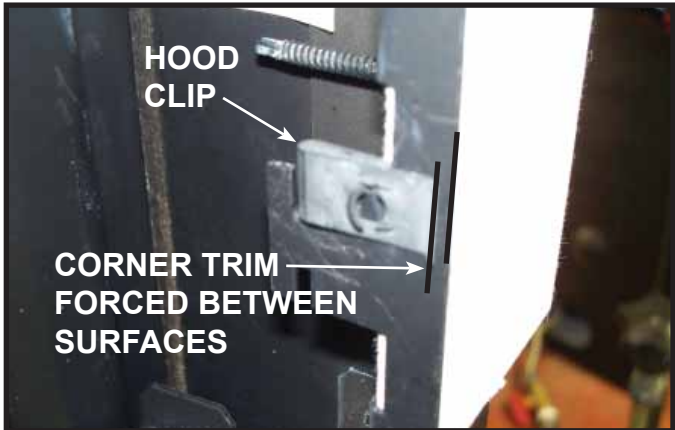

Figure 1.D.8. Clip Location



Figure 1.D.9. Install Corner Panel onto Clip

- Place glass rock media in access panel assembly according to instructions provided with glass rock media kit.

Service Parts

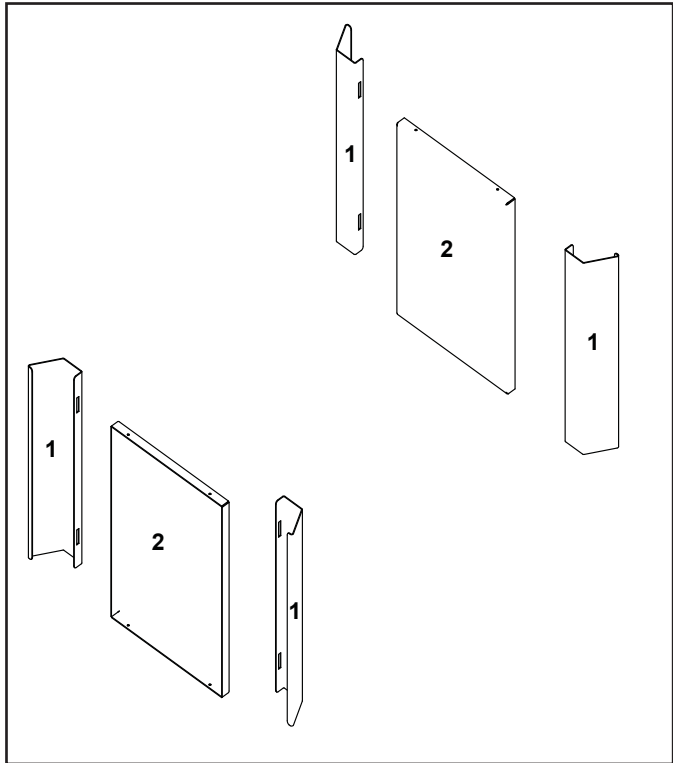

Figure 1.D.10. Service Parts Diagram

ITEM	DESCRIPTION	PART NUMBER
	Refractory Kit	POR40ST-L
1	Refractory, Corner (Qty 4 req)	2155-219
2	Refractory, Side (Qty 2 req)	2155-223

2 Granite Installation

Install Granite according to these instructions.

CAUTION! Risk of Burns! The fireplace should be turned off and cooled before refractory is installed.

CAUTION! Risk of Cuts or Abrasions. Wear protective gloves and safety glasses during installation. Sheet metal edges are sharp.

NOTICE: Handle granite pieces with care. Granite may chip or crack if dropped or impacted.

Note: Optional Porcelain or Granite Kits used with lighted and non-lighted media models must be placed in appliance before placing glass media in the appliance.

A. RED40 Model

Kit Contents:

- (3) Back panel pieces 13-3/16 inches wide x 12-7/8 inches tall. See Figure 2.A.1.
- (2) Inner side wall pieces 10 inches wide x 12-7/8 inches tall. See Figure 2.A.2.
- (2) Outside corner trim pieces. See Figure 2.A.3.
- (7) Securing tabs. See Figure 2.A.4.
- (7) Sheet metal screws. See Figure 2.A.4.

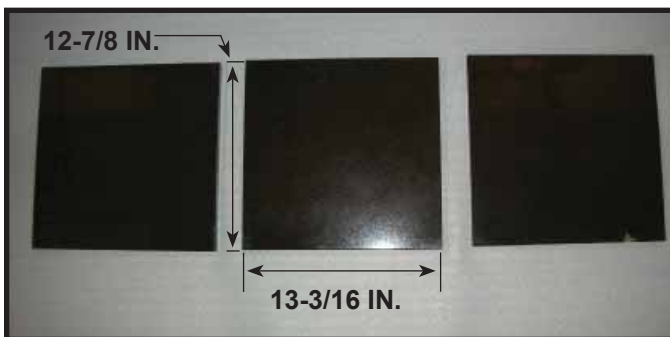

Figure 2.A.1. Back Panel Pieces.

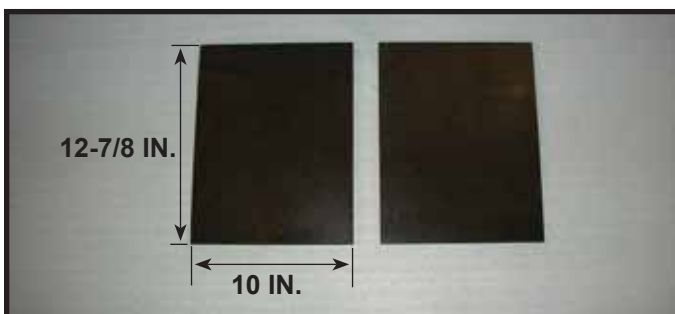

Figure 2.A.2. Inner Side Wall Pieces.



Figure 2.A.3. Outside Corner Trim Pieces.



Figure 2.A.4. Securing Tabs and Sheet Metal Screws.

Tools Required:

Cordless Drill
1/4 inch hex head driver tip
Pry Bar and Hammer for opening shipping crate.

Installation

1. Verify base pan in appliance is similar to the one shown in Figure 2.A.5. The base pan required for this application has the letter "M" stamped in it. See Figure 2.A.5. If the base pan does not have the letter "M" stamped in it, contact your dealer. Remove screws from base pan. See Figure 2.A.5 for screw locations.



Figure 2.A.5. Removing Screws from Basepan.

2. Measure granite to ensure you are installing the pieces in the right orientation. Back panel pieces are to be placed first. These pieces are wider than they are tall. Install so that width is 13-3/16 inches. Begin installing pieces left to right. Place granite into firebox, bottom side first, then tilt top backward into position. Place the first piece on the left and move to right as you add the other pieces. See Figure 2.A.6.

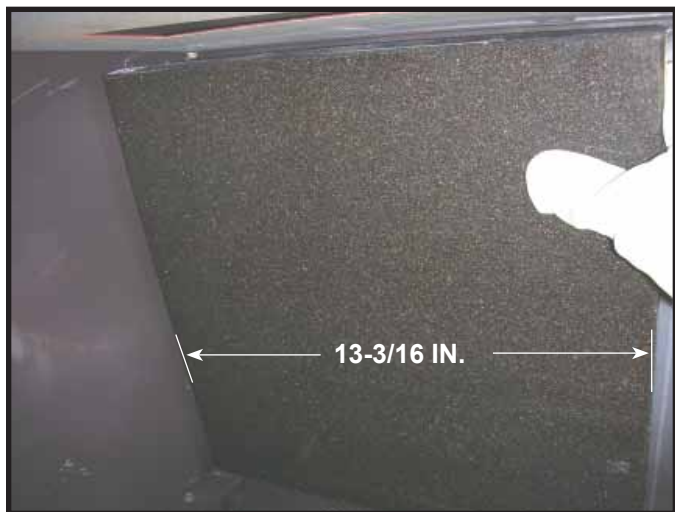

Figure 2.A.6. Placing Back Panel Piece.

3. Secure granite pieces using angle tabs and screws provided. See Figure 2.A.7. Secure each piece as it is placed into position to keep it from falling while placing next piece into firebox. Continue with back middle piece and then back right side.



Figure 2.A.7. Fastening Angle Tabs to Secure Granite in Place

4. Install side pieces using same method with tabs and screws. Measure to be sure that the pieces are placed in the correct orientation. For the side pieces, the width is the 10 inch dimension.



Figure 2.A.8. View of Back and Side Piece Installed

5. **For models with rock media only:** Install media in base of firebox according to media installation instructions in Section 4 of this instruction. Install glass frame assembly according to instructions in appliance installation manual.

WARNING



Delayed Ignition Risk

- Place media according to instructions.
- Do NOT place media in area in front of pilot or between burner tracks.
- Do NOT place media in a position that they may fall into area in front of pilot.
- Do NOT use any media other than the media supplied with this fireplace.

Fireplace will not function properly.
Delayed ignition may occur.

6. **For models with rock media only:** Install front media tray. Do not place media at this time.
7. Install outer corner granite trim pieces. Slowly slide into position as shown in picture. Use securing tabs to hold in place. Tabs attach at the top using sheet metal screws and pilot holes located above the granite. See Figure 2.A.9 and Figure 2.A.10.

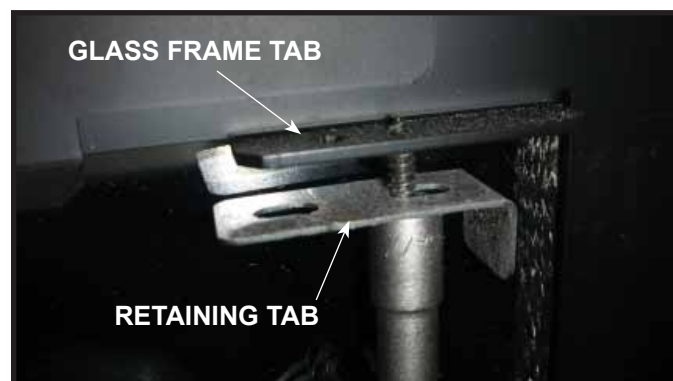

Figure 2.A.9. Attaching Retaining Tab to Glass Frame Tab



Figure 2.A.10. Placing Outer Corner Granite Trim Piece

8. **For models with rock media only:** Place media in front media tray according to media installation instructions.

Service Parts

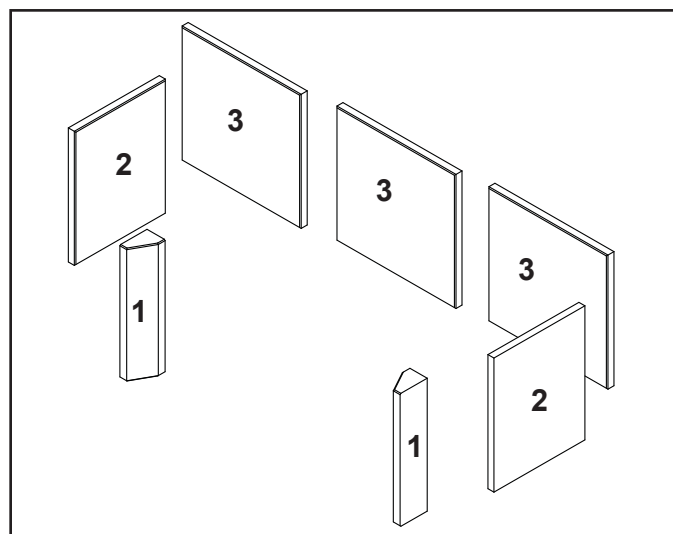

Figure 2.A.11. Service Parts Diagram

ITEM	DESCRIPTION	PART NUMBER
	Refractory Kit	GR40-L
1	Refractory, Corner (Qty 2 req)	2175-225
2	Refractory, Side (Qty 2 req)	2155-210
3	Refractory, Back (Qty 3 req)	2155-209

B. RED40ST Model

Kit Contents:

- (2) Inner Side Pieces. See Figure 2.B.1.
- (4) Outside Corner Trim Pieces. See Figure 2.B.2.
- (6) Angle tabs with (6) sheet metal screws. See Figure 2.B.3.

Tools Required

Cordless Drill
1/4 inch hex head driver tip
Pry Bar and Hammer for opening shipping crate.



Figure 2.B.4. Removing Screws from Base Pan

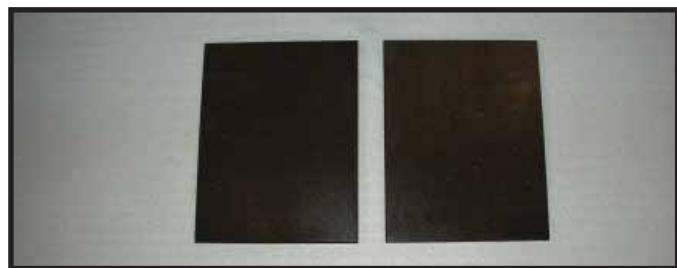

Figure 2.B.1. Inner Side Pieces



Figure 2.B.2. Outside Corner Trim Pieces



Figure 2.B.3. Angle Tabs and Sheet Metal Screws

Installation

1. Verify base pan in appliance is similar to the one shown in Figure 2.B.4. The base pan required for this application has the letter "M" stamped in it. See Figure 2.B.4. If the base pan does not have the letter "M" stamped in it, contact your dealer. Remove screws from base pan. See Figure 2.B.4 for screw locations.

2. Set side granite pieces into place. Put bottom into place first and then tilt the top into position against the side wall. Secure granite pieces using angle tabs and screws provided. Pilot holes are located in top of firebox.



Figure 2.B.5. Secure Granite Sides with Angle Tabs

3. **For models with rock media only:** Install media in base of firebox according to media installation instructions in Section 4 of this instruction.

⚠ WARNING



Delayed Ignition Risk

- Place media according to instructions.
- Do NOT place media in area in front of pilot or between burner tracks.
- Do NOT place media in a position that they may fall into area in front of pilot.
- Do NOT use any media other than the media supplied with this fireplace.

Fireplace will not function properly.
Delayed ignition may occur.

4. Install glass frame assembly on both sides of fireplace, according to installation instructions.
5. **For models with rock media only:** Install front media tray. Position tabs so they are facing glass and insert tabs into glass frame. Do not install media at this time.

6. Install outside corner trim granite pieces as shown in Figure 6. Slide into place and attach with angle tabs and sheet metal screws. Attach tabs above granite using pilot holes. See Figure 2.B.6 and Figure 2.B.7.
7. **For models with rock media only:** Place rock media in outside media tray according to installation instructions.

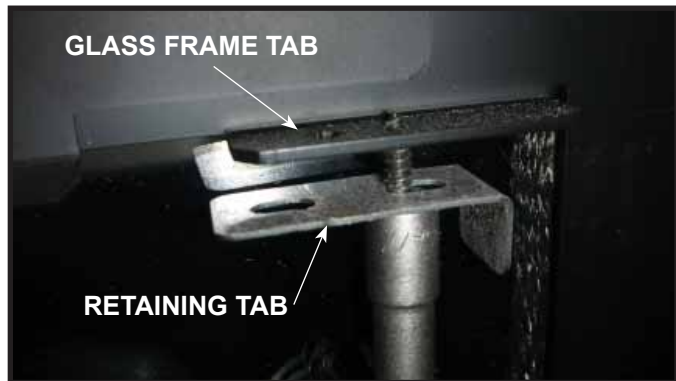

Figure 2.B.6. Attaching Retaining Tab to Glass Frame Tab



Figure 2.B.7. Placing Outer Corner Granite Trim Piece

Service Parts

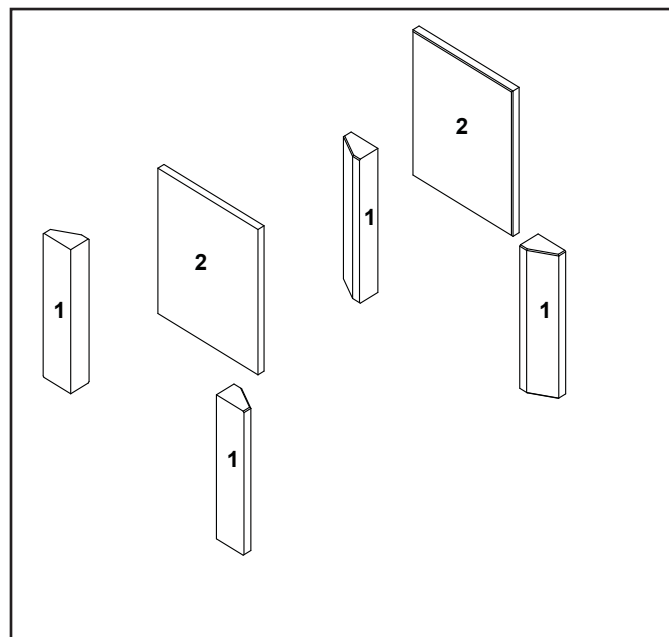

Figure 2.B.8. Service Parts

ITEM	DESCRIPTION	PART NUMBER
	Refractory Kit	GR40ST-L
1	Corner Panel (Qty 4 req)	2175-225
2	Side Panel (Qty 2 req)	2175-224

3 Sheet Metal Refractory Installation

Install Sheet Metal Refractory kit according to these instructions.

CAUTION! Risk of Burns! The fireplace should be turned off and cooled before refractory is installed.

CAUTION! Risk of Cuts or Abrasions. Wear protective gloves and safety glasses during installation. Sheet metal edges are sharp.

NOTICE: The installation of the porcelain kit may require the air shutter setting to be changed. See the appliance installation manual to ensure the shutter gap is set correctly before firing the appliance.

A. RED40

This kit contains the components necessary to install metal refractory on single sided RED40-NNN models.

Kit Contents:

- (2) Outside corner trim pieces. See Figure 3.A.1.
- (1) Front Inside base. See Figure 3.A.2.
- (1) Rear Inside base. See Figure 3.A.2.
- (1) Outside front trim base. See Figure 3.A.3.

Tools Required

- Cordless Drill
- 1/4 inch hex head driver tip

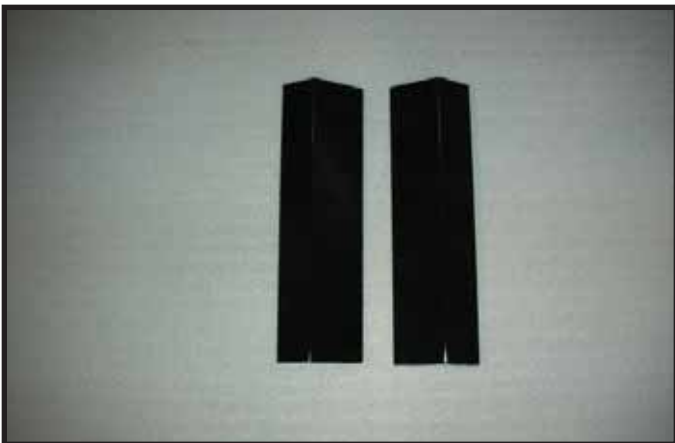

Figure 3.A.1. Outside Corner Trim Panels



Figure 3.A.2. Front and Rear Inside Base Piece



Figure 3.A.3. Outside Front Trim Base Piece

1. Install rear inside base piece. Position piece into bottom of fireplace with tabs facing the burner. Center piece from front to back. There will be a gap between the front edge of the base piece and the burner area and also a gap between the back of the base piece and the rear firebox panel. These two gaps should be equal. See Figure 3.A.4.
2. Install front inside base piece. Position piece into bottom of fireplace with tabs facing the outside edge of the firebox. Center from front to back. There will be a gap between the front edge of the base piece and the front of the firebox and also a gap between the back of the base piece and the burner rail. These two gaps should be equal. See Figure 3.A.4.

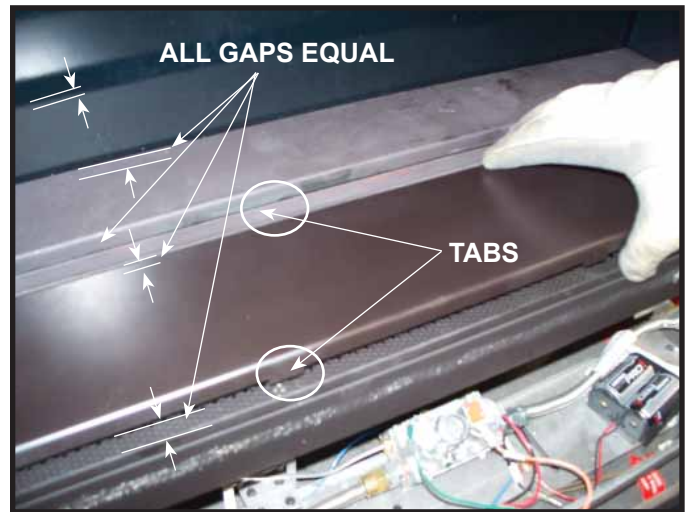

Figure 3.A.4. Placing Base Pieces

3. Install glass frame assembly and spring lock into position according to instructions in appliance installation manual.
4. Position access panel so tabs are facing the glass assembly. Insert into glass frame. See Figure 3.A.5.

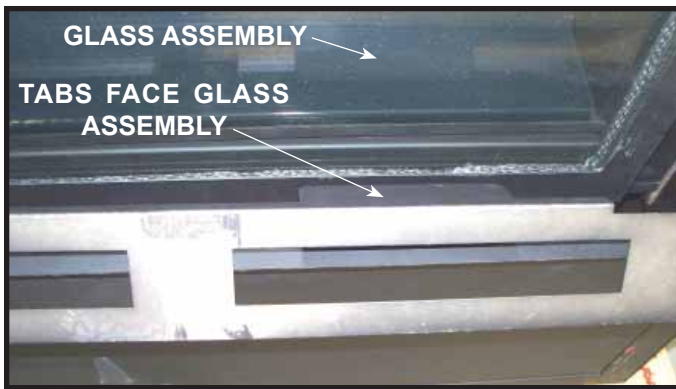

Figure 3.A.5. Positioning Access Panel

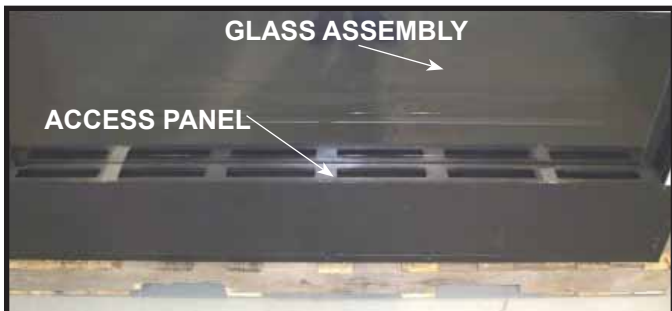

Figure 3.A.6. Access Panel Installed

5. Place outside front trim base onto access panel. Place so the cutouts are in line with the outside edges of the glass frame. See Figure 3.A.7.



Figure 3.A.7. Outside Front Trim Base Installed

6. Attach one end of chain to the tab on the back side of both corner trim panel. See Figure 3.A.8.



Figure 3.A.8. Attaching Chain

7. Remove screw from inside wall behind face of fire-place in front of glass and to the side. Attach chain to fireplace using this screw. See Figure 3.A.9. Corner trim panel will hang from appliance until installed. The chain is a safety feature and should remain connected at all times.

CAUTION! DO NOT operate appliance without safety chains attached. Safety chains retain corner trim panels in event of delayed ignition.



Figure 3.A.9. Attaching Chain

8. Install four hood clips (included) as shown in Figure 3.A.10. Outside corner trim panel will be forced into clip on front of appliance. Put any chain slack inside the appliance and then install corner trim panels. See Figure 3.A.11 and Figure 3.A.12.

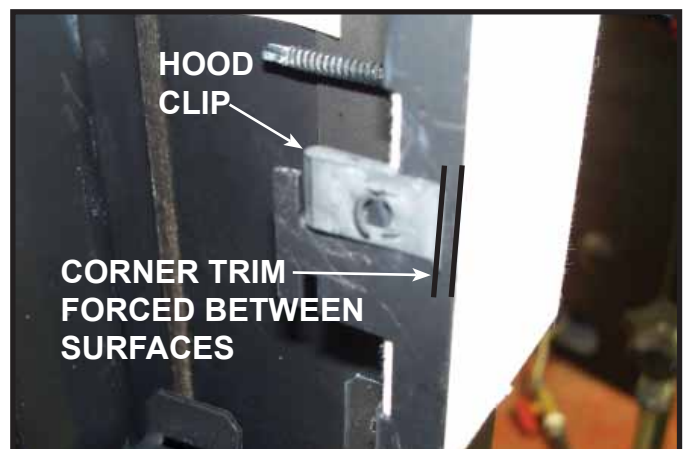

Figure 3.A.10. Clip Location



Figure 3.A.11. Installing Outside Corner Trim Panel onto Clip



Figure 3.A.12. Outside Corner Trim Panel Installed

Service Parts

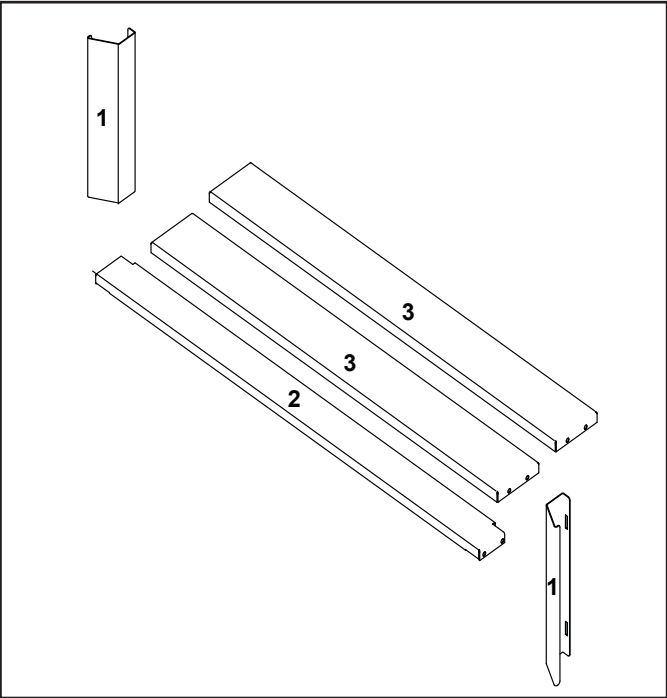

Figure 3.A.13. Service Parts Diagram

ITEM	DESCRIPTION	COMMENTS	PART NUMBER
	Metal Refractory Kit (RED40)		SMR-40NL
1	Panel Side No Lights		2155-237
2	Exterior Panel Cover		2155-239
3	Interior No Light Base		2155-238

B. RED40ST

This kit contains the components necessary to install the metal refractory on model RED40ST-NNN.

Kit Contents:

- (4) Outside corner trim pieces. See Figure 3.B.1.
- (2) Inside Base Pieces. See Figure 3.B.2.
- (2) Outside front trim base pieces. See Figure 3.B.3.

Tools Required:

Cordless Drill
1/4 inch hex head driver tip

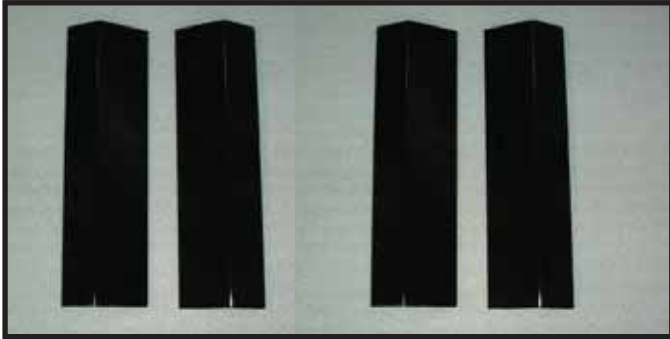

Figure 3.B.1. Outside Corner Trim Panels



Figure 3.B.2. Inside Base Pieces



Figure 3.B.3. Outside Front Trim Base Pieces

INSTALLATION

1. Install inside base pieces. Position pieces into bottom of fireplace with tabs facing the outside edges. Center from front to back. There will be a gap between the back edge of the base piece and the burner area and also a gap between the front of the base piece and the outside edge of the firebox. These two gaps should be equal. See Figure 3.B.4. Duplicate this process on both sides of the appliance.

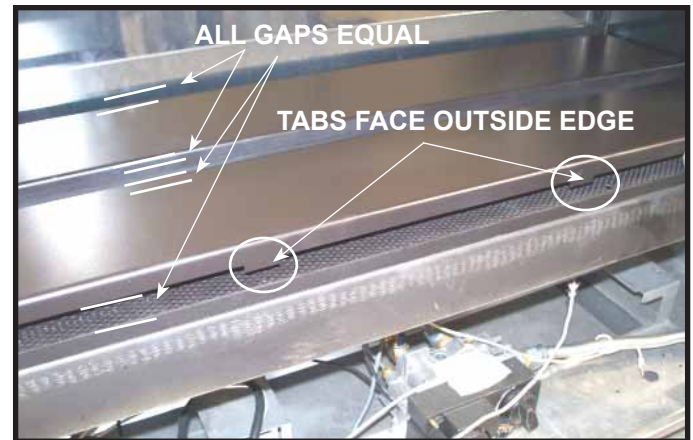

Figure 3.B.4. Inside Base Pieces Installed

3. Install glass frame assemblies and spring lock into position according to instructions in appliance installation manual.
4. Install access panel in front of glass. Position the access panel so that the tabs are facing the glass and insert into glass frame. Duplicate this process on both sides of the appliance. See Figure 3.B.5 and Figure 3.B.6.



Figure 3.B.5. Positioning Access Panel

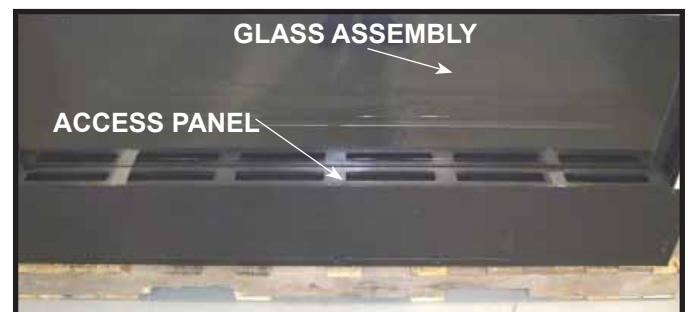

Figure 3.B.6. Access Panel Installed

- Place outside front trim base onto access panel. Position it so the cut-outs are lined up with the outside edges of the glass frame. See Figure 3.B.7.



Figure 3.B.7. Install Outside Front Trim Base onto Access Panel

- Attach one end of chain to the tab on the back side of both corner panels. See Figure 3.B.8.



Figure 3.B.8. Attaching Chain

- Remove screw from inside wall behind face of fire-place in front of glass and to the side. Attach chain to fireplace using this screw. See Figure 3.B.9. Corner trim panel will hang from appliance until installed. The chain is a safety feature and should remain connected at all times.

CAUTION! DO NOT operate appliance without safety chains attached. Safety chains retain corner trim panels in event of delayed ignition.



Figure 3.B.9. Attaching Chain

- Install eight hood clips (included) as shown in Figure 3.B.9. There will be four clips on each side of the appliance. The corner trim panel will be forced into clip on each side of the appliance. Put any chain slack inside the appliance and then install corner trim panels. See Figure 3.B.10.

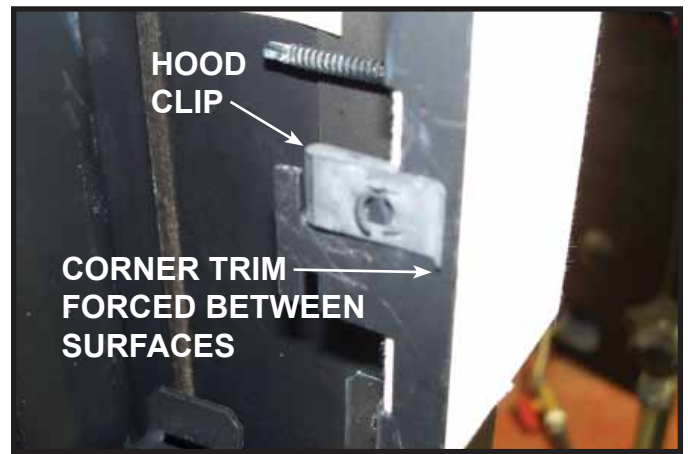

Figure 3.B.9. Clip Location

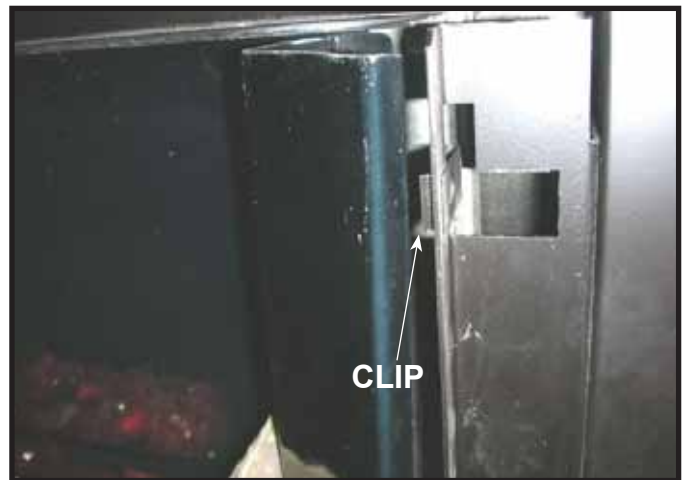

Figure 3.B.10. Installing Outside Corner Trim Panel onto Clip

Service Parts

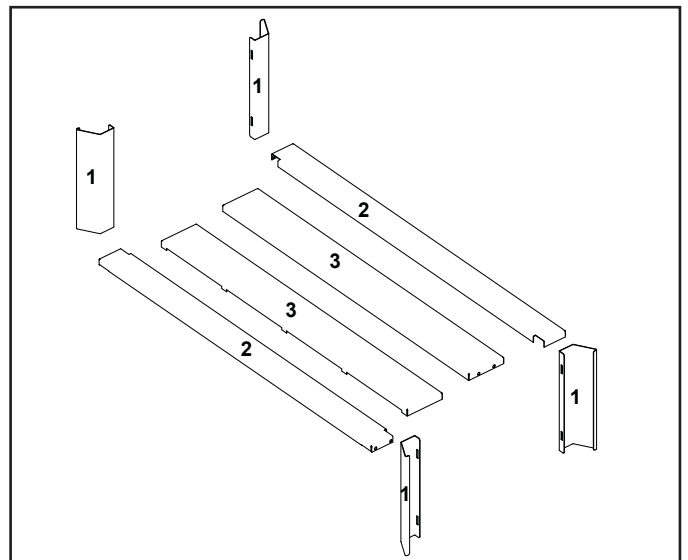

Figure 3.B.11. Service Parts Diagram

ITEM	DESCRIPTION	PART NUMBER
	Metal Refractory Kit	SMR-40STNL
1	Panel Side No Lights (Qty 4)	included in kit
2	Exterior Panel Cover (Qty 2)	included in kit
3	Interior No Light Base (Qty 2)	included in kit

4 Rock Media

Install rock media according to these instructions.

WARNING! Choking Hazard! Keep rock media out of reach of children.

CAUTION! Risk of Burns! The fireplace should be turned off and cooled before rock media is installed.

CAUTION! Risk of Cuts, Abrasions or Flying Debris. Wear protective gloves and safety glasses during installation. Sheet metal edges are sharp.

Note: Optional Porcelain or Granite Kits used with lighted and non-lighted media units must be placed in unit before placing rock media in the unit.

Cleaning the Rock Media

During shipment of the rock media, dust and debris can accumulate. It is recommended that the rock media be rinsed thoroughly with water to remove dust and small particles. An easy method to clean the rock media is to place the rock media into a pail and rinse thoroughly. Spread the rock media out over paper towels and allow the rock media to dry before installing them into the fireplace.

A. Installation

1. Choose 7 - 10 flat, quarter-sized, pieces of rock media and set them aside. These will be used later to conceal the pilot cover. Reference Figure 4.A.1 for choosing flat pieces of glass.





Figure 4.A.1. Selecting Flat Rock Media for Pilot Cover

2. The included stone placement jig MUST be used any time rock media is placed on the burner to ensure that none end up in the burner lighting area. Verify that the stone placement jig is correctly installed in place in the appliance.
3. The stone placement jig must remain in place while rock media is placed on the basepan and around the pilot bracket.
4. Place an even layer of rock media around the base pan as shown in Figure 4.A.2 and Figure 4.A.3. Do not place rock media in the slot over the burner ports.

See Figures 4.A.2 and 4.A.3. Figure 4.A.2 shows an outline of the burner tracks and the area in front of the pilot assembly. No rock media may be placed in the outlined area. Continue to place an even amount of rock media over the entire base pan. **DO NOT** install rock media in between the tracks over the entire length of the burner. This may cause lighting issues, undesirable burner flame, or delayed ignition.

5. Remove the stone placement jig by removing the screw as noted in Figure 4.A.2.

**WARNING**



- Delayed Ignition Risk
- Place rock media according to instructions.
- Do NOT place rock media in area in front of pilot or between burner tracks.
- Do NOT place rock media in a position that they may fall into area in front of pilot.
- Do NOT use any media other than the rock media supplied with this fireplace.
- Do NOT exceed one layer of rock on base pan.

Fireplace will not function properly.
Delayed ignition may occur.

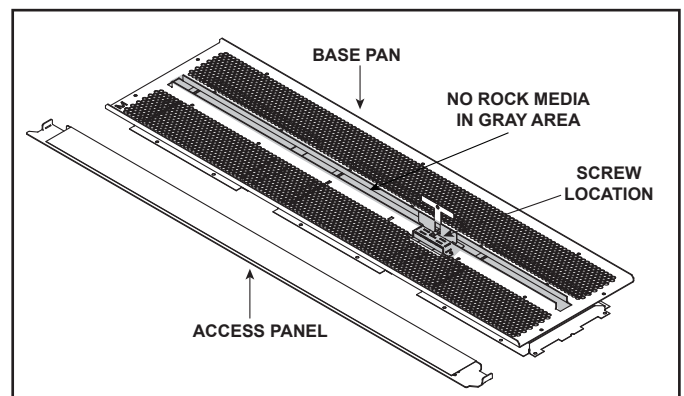

Figure 4.A.2. Location of Stone Placement Jig

WARNING! Risk of Fire. DO NOT place rock media directly in front of the pilot assembly or between the burner tracks over the burner ports.



Figure 4.A.3. Place Rock Media

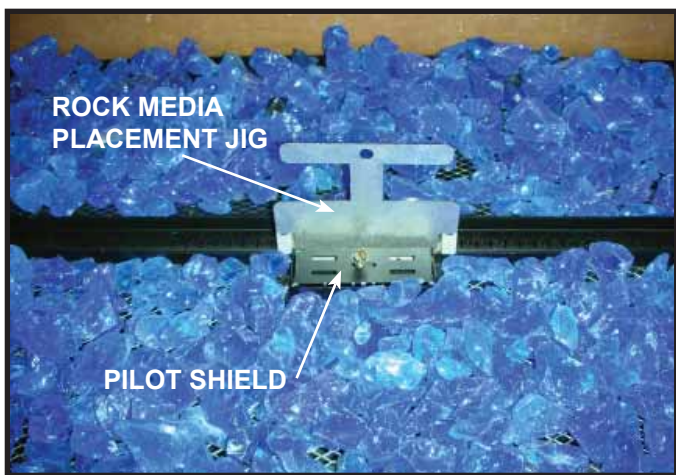

Figure 4.A.4. Placing Rock Media in Base Pan on Top of Mesh

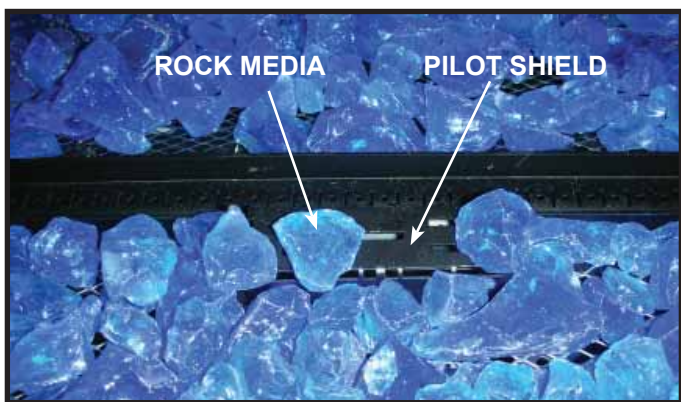

Figure 4.A.5. Placing Rock Media Over Pilot Shield

6. Using the flat media pieces that were sorted out in Step 1, place one layer over the pilot shield. See Figure 4.A.5.
7. Place the glass frame assembly back on the appliance. Assure that there is no rock media between the glass and the firebox. Rock media in this area will prevent the glass gasket from sealing.



Figure 4.A.6. Front Access Media Tray

8. Position the front tabs of the front access media tray toward the glass and then place in the groove of the glass frame. Line up the media tray so that the left and right cut-outs fit within the glass frame.



Figure 4.A.7. Location of Clear Tape

CAUTION! DO NOT remove clear tape located on bottom of media tray. Appliance will overheat and shut down.



Figure 4.A.8. Placing Rock Media in Front Tray

9. Place rock media in the front tray. For an “Infinity” look, the rock media may be placed up against the glass and tray.

⚠ WARNING	
	Risk of Asphyxiation or Fumes.
	• Place rock media according to instructions.
	• Do NOT place rock media in area between glass and firebox.
	• Do NOT place rock media in a position that they may fall into area between glass and firebox.
	• Do NOT use any media other than the rock media supplied with this fireplace.
	• Do NOT use more than one 10 lb. bag of rock media per fireplace.
	Fireplace will not function properly. Gas leak may occur.

10. Replace side panels and secure in place by using clips on the side of the appliance.
11. The “Infinity” look of the rock media provides a perception that there is no glass on the appliance, while maintaining the sealed combustion of the appliance.



Figure 4.A.9. Rock Media Installed

Please contact your Heat & Glo dealer with any questions or concerns.

For the location of your nearest Heat & Glo dealer, please visit www.heatnglo.com.

Heat & Glo, a brand of Hearth & Home Technologies
7571 215th Street West, Lakeville, MN 55044
www.heatnglo.com