

RED40 PORCELAIN KIT

Models:

- Installation Instructions -



Leave this manual with party responsible for use and operation.

CAUTION! Risk of Cuts or Abrasions. Wear protective gloves and safety glasses during installation. Sheet metal edges are sharp.

Note: Optional Porcelain or Granite Kits used with lighted and non-lighted media models must be placed in appliance before placing glass media in the appliance.

Instruction Page Reference

- A. Page 1 RED40 Without Media or Lights
- B. Page 5 RED40 With Media or Media/Lights
- C. Page 8 RED40ST Without Media or Lights
- D. Page 10 RED40ST With Media or Media/Lights

A. RED40 Model Without Media or Lights

This kit contains the components necessary to install the porcelain on single sided RED40 models that do not have media or lights installed. For installation on other models, refer to the instructions included with the appropriate kit.

Kit Contents:

- (1) Back panel. See Figure 1.
- (2) Side panels. See Figure 2.
- (2) Corner Panels. See Figure 3.
- (5) Angle tabs and (5) Sheet metal screws. See Figure 4.
- (1) Inner Back Panel. See Figure 5.
- (1) Inner Front Panel. See Figure 6.
- (1) Outer Bottom Panel. See Figure 7.

Tools Required

- Cordless Drill
- 1/4 inch hex head driver tip



Figure 1. Back Panel.



Figure 2. Side Panels.

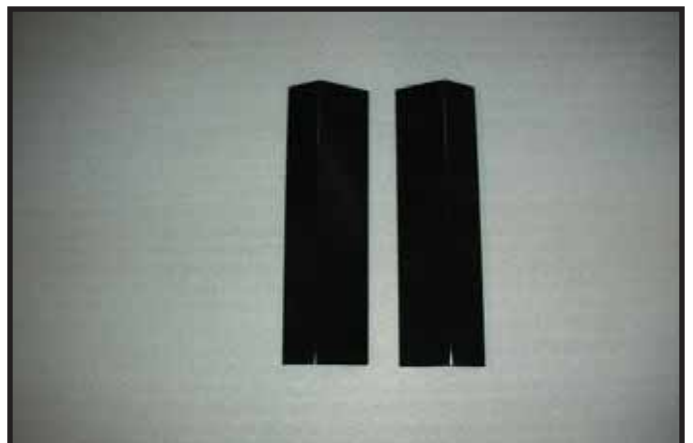

Figure 3. Corner Panels.



Figure 4. Angle Tabs with Screws.



Figure 5. Inner Back Panel.



Figure 6. Inner Front Panel.



Figure 7. Outer Bottom Panel.

Installation

1. Verify the correct base pan is in the appliance before proceeding with the porcelain installation. The base pan required for this application has the letters “NNN” and “NNP” stamped in it. See Figure 8. If the base pan does not have these letters stamped in it, contact your dealer.



Figure 8. Location of Base Pan Identification

2. Begin by placing the back panel into the firebox, bottom side first, then tilt top backward into position. Secure with angle tabs and screws in the three pilot holes that are located on the top of the firebox. See Figure 9.
3. Place each side panel into firebox, bottom side first, then tilt top backward into position. Secure with angle tabs and screws in the pilot holes that have are located on the top of the firebox. See Figure 10.



Figure 9. Fastening Angle Tab to Secure Back Panel.



Figure 10. Fastening Angle Tab to Secure Side Panel.

4. Place inner back panel. Place into bottom of fireplace with tabs facing the burner. Center from front to back. There will be a gap between the front edge of the inner back panel and the burner area and also a gap between the back of the inner back panel and the back panel. These two gaps should be equal. See Figure 11.
5. Install inner front panel. Position into bottom of fireplace with tabs facing the outside edge of the firebox. Center from front to back. There will be a gap between the front edge of the inner front panel and the front of the firebox and also a gap between the back of the inner front panel and the burner rail. These two gaps should be equal. See Figure 11.

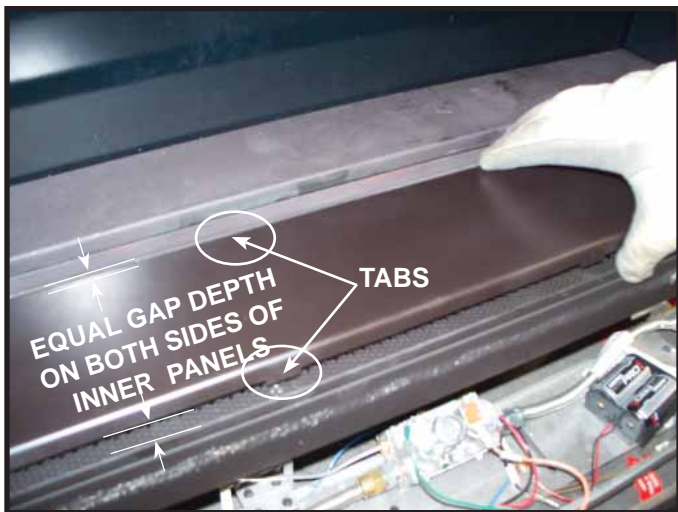

Figure 11. Placing Inner Panels.

6. Install glass frame assembly and spring lock into position. Set access panel assembly into position.
7. Position access panel assembly so tabs are facing the glass assembly. Insert into glass frame. See Figure 12.

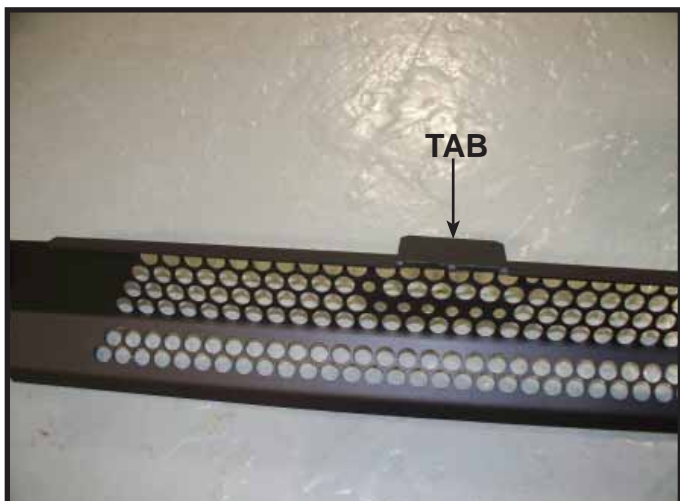

Figure 12. Positioning Access Panel Assembly.



Figure 13. Access Panel Assembly Installed.

8. Place outer bottom panel onto shelf. Place so the cutouts are in line with the outside edges of the glass frame. See Figure 14.



Figure 14. Outer Bottom Panel Installed.

9. Attach one end of chain to the tab on the back side of both corner panels. See Figure 15.



Figure 15. Attaching Chain.

10. Remove screw from inside wall behind face of fireplace in front of glass and to the side. Attach chain to fireplace using this screw. Once chain is attached, slide corner panel into position. The chain is a safety feature and should remain connected at all times.

CAUTION! DO NOT operate appliance without safety chains attached. Safety chains retain corner panels in event of delayed ignition.



Figure 16. Attaching Chain.

11. Install four retainer clips (included) as shown in Figure 17. Outside corner trim piece will be forced into clip on front of appliance. See Figure 18 and Figure 19.

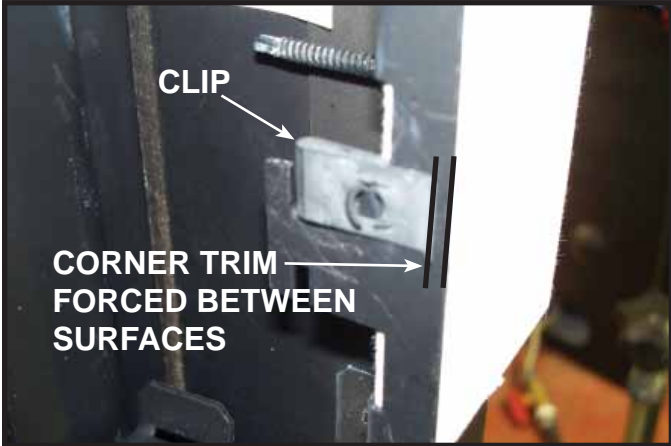

Figure 17. Clip Location.



Figure 18. Installing Corner Panel onto Clip.



Figure 19. Corner Panel Installed.

Service Parts

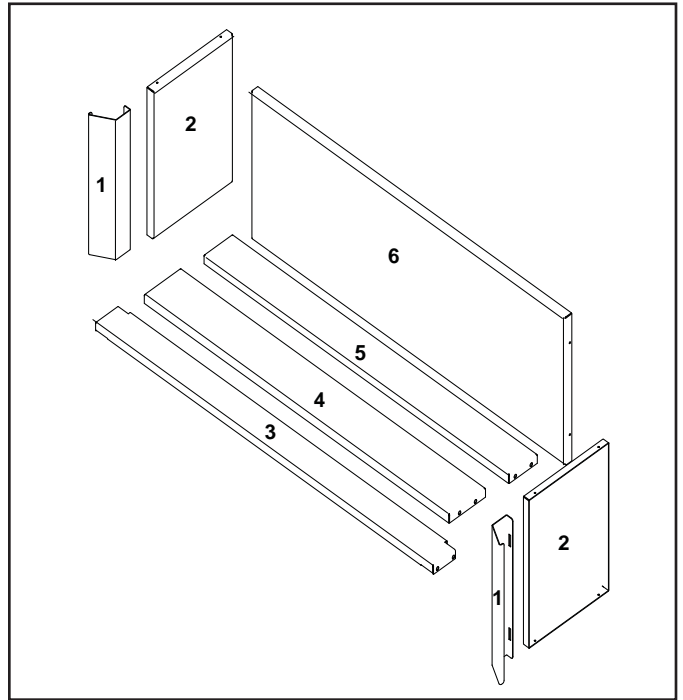

Figure 20. Service Parts Diagram.

| ITEM | DESCRIPTION | COMMENTS | PART NUMBER |
|------|--------------------------------|----------|-------------|
| | Refractory Kit | | POR40-F |
| 1 | Refractory, Corner (Qty 2 req) | | 2155-230 |
| 2 | Refractory, Side (Qty 2 req) | | 2155-223 |
| 3 | Refractory, Outer Bottom | | 2155-226 |
| 4 | Refractory, Inner Front | | 2155-224 |
| 5 | Refractory, Inner | | 2155-225 |
| 6 | Refractory, Back | | 2155-222 |

B. RED40 Model With Media or Media/Lights

This kit contains the components necessary to install the porcelain on single sided model RED40 models that have media or media/lights installed. For installation on other models, refer to the instructions included with the appropriate kit.

Kit Contents:

- (1) Back Panel. See Figure 1.
- (2) Side Panels. See Figure 2.
- (2) Corner Panels. See Figure 3.
- (5) angle tabs and (5) Sheet metal screws. See Figure 4.

Tools Required

Cordless Drill

1/4 inch hex head driver tip



Figure 1. Back Panel.



Figure 2. Side Panels.



Figure 3. Corner Panels.



Figure 4. Angle Tabs with Screws.

Installation

1. Verify the correct base pan is in the appliance before proceeding with the porcelain installation. The base pan required for this application has the letter "m" stamped in it. See Figure 5. If the base pan does not have the letter "M" stamped in it, contact your dealer.

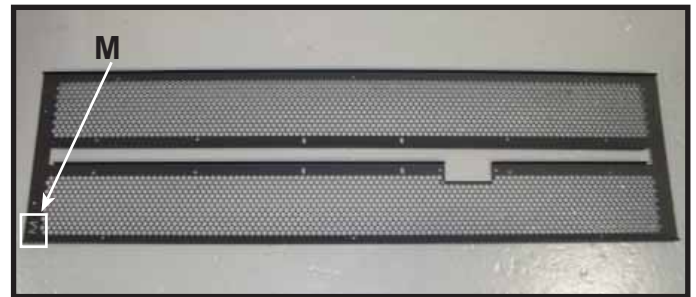

Figure 5. Base Pan

2. Begin by placing back panel. Place bottom in first and tilt top backward carefully until it touches the back wall. Secure with angle tabs and screws in the three pilot holes that are located on the top of the firebox.



Figure 6. Installing Angle Tab to Secure Back Panel.

3. Install side panels. Place bottom in first and tilt top backward carefully until it touches the side wall. Secure with angle tabs and screws in the pilot holes that are located on the top of the firebox.



Figure 7. Installing Angle Tab to Secure Side Panel.

4. Install glass rocks in base of firebox according to glass media installation instructions.
5. Install glass frame assembly according to instructions in installation manual.

6. Install access panel assembly.
7. Attach one end of chain to the tab on the back side of both corner panels. See Figure 8.



Figure 8. Attaching Chain.

8. Remove screw from inside wall behind face of fireplace in front of glass and to the side. Attach chain to fireplace using this screw. Once chain is attached, slide corner panel into position. The chain is a safety feature and should remain connected at all times.

CAUTION! DO NOT operate appliance without safety chains attached. Safety chains retain corner trim panels in event of delayed ignition.

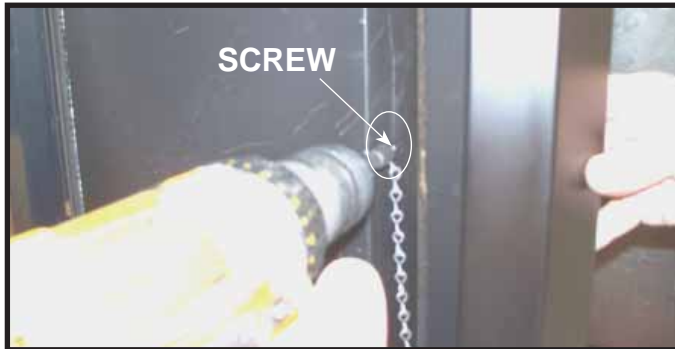

Figure 9. Attaching Chain.

9. Install four retainer clips (included) as shown in Figure 10. Outside corner trim piece will be forced into clip on front of appliance. See Figure 11 and Figure 12.

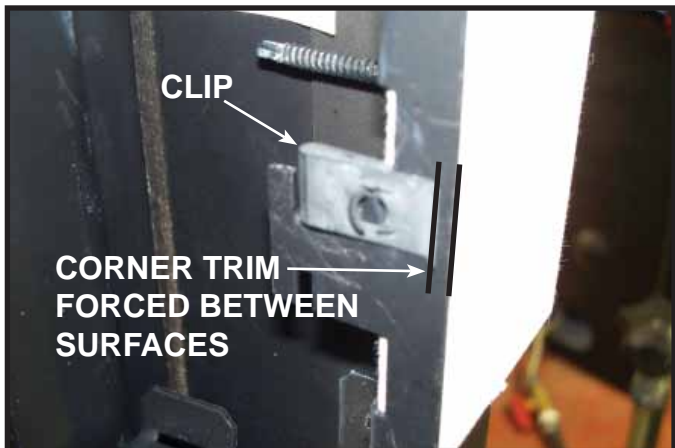

Figure 10. Clip Location.



Figure 11. Installing Corner Panel onto Clip.



Figure 12. Corner Panel Installed.

Service Parts

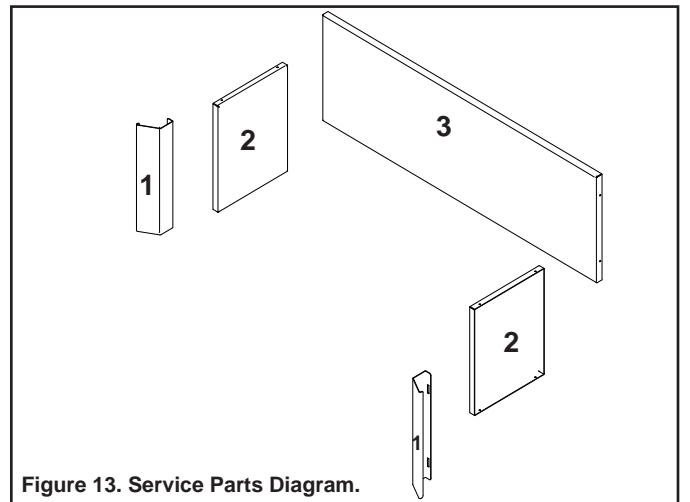

Figure 13. Service Parts Diagram.

| ITEM | DESCRIPTION | PART NUMBER |
|------|--------------------------------|-------------|
| | Refractory Kit | POR40-L |
| 1 | Refractory, Corner (Qty 2 req) | 2155-219 |
| 2 | Refractory, Side (Qty 2 req) | 2155-223 |
| 3 | Refractory, Back | 2155-222 |

C. RED40ST Model Without Media or Lights

This kit contains the components necessary to install the porcelain on RED40ST models that do not have media or lights installed. For installation on other models, refer to the instructions included with the appropriate kit.

Kit Contents:

- (2) Side Panels. See Figure 1.
- (4) Corner Panels. See Figure 2.
- (2) Angle tabs and (2) Sheet metal screws.
See Figure 3.

- (2) Inner Front Panels. See Figure 4.
- (2) Outer Bottom Panels. See Figure 5.

Tools Required:

- Cordless Drill
- 1/4 inch hex head driver tip



Figure 1. Side Panels.

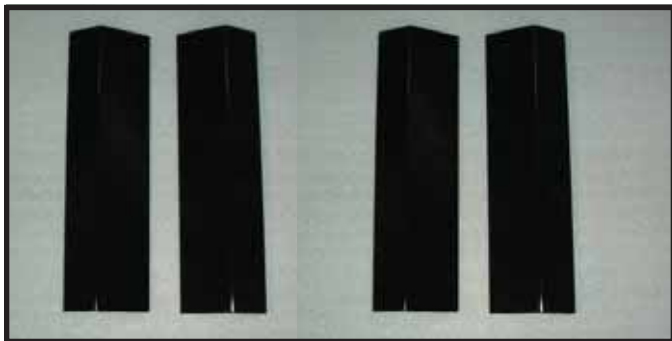

Figure 2. Corner Panels.



Figure 3. Angle Tabs with Screws.



Figure 4. Inner Front Panels.



Figure 5. Outer Bottom Panels.

Installation

1. Verify that the correct base pan is in the appliance before proceeding with the porcelain installation. The base pan required for this application has the letters “NNN” and “NNP” stamped in it. See Figure 6. If the base pan does not have these letters stamped in it, contact your dealer.

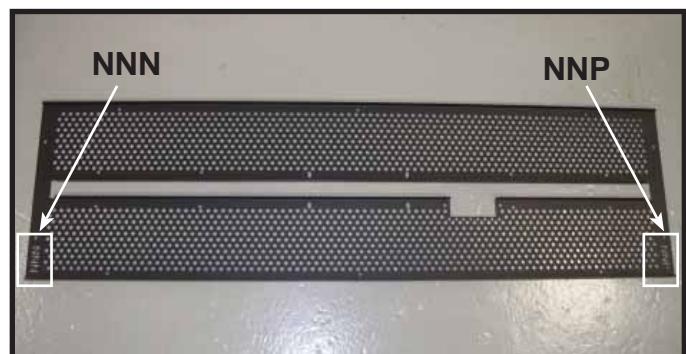

Figure 6. Base Pan

2. Begin by placing side panels into the firebox, bottom side first, then tilt top backward into position. Secure with angle tabs and screws in the pilot holes that are located on the top of the firebox as shown in Figure 7.



Figure 7. Fastening Side Panel with Angle Tab.

3. Place inner front panels. Place into bottom of fireplace with tabs facing the outside edges. Center from front to back. There will be a gap between the front edge of the inner front panels and the burner area and also a gap between the inner front panel and the outside edge of the firebox. These two gaps should be equal. See Figure 8.

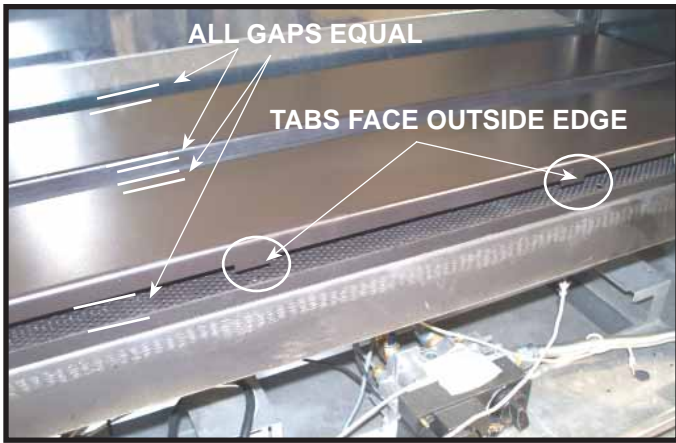

Figure 8. Inner Front Panels Installed.

4. Install glass frame assemblies according to instructions in appliance installation manual.
5. Install access panel assembly in front of glass. Position the access panel assembly so that the tabs are facing the glass and insert into glass frame.

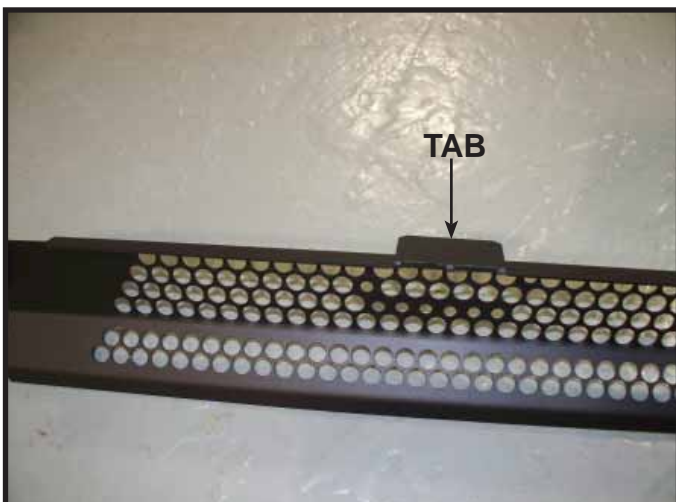

Figure 9. Positioning Access Panel Assembly.



Figure 10. Access Panel Assembly Installed.

6. Place outer bottom panel onto access panel assembly. Position it so the cut-outs are lined up with the outside edges of the glass frame.



Figure 11. Install Outer Bottom Panel.

7. Attach one end of chain to the tab on the back side of all corner panels. See Figure 12.



Figure 12. Attaching Chain.

8. Remove screw from inside wall behind face of fireplace in front of glass and to the side. Attach chain to fireplace using this screw. Once chain is attached, slide corner panel into position. The chain is a safety feature and should remain connected at all times.

CAUTION! DO NOT operate appliance without safety chains attached. Safety chains retain corner panel sides in event of delayed ignition.



Figure 13. Attaching Chain.

- Install eight retainer clips (included) as shown in Figure 14. There will be four clips on each side of the appliance. The corner trim piece will be forced into clip on each side of the appliance.

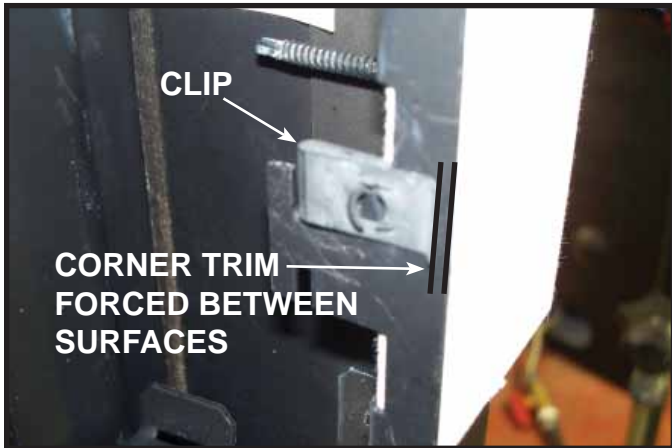

Figure 14. Clip Location.



Figure 15. Installing Corner Panel onto Clip.

Service Parts

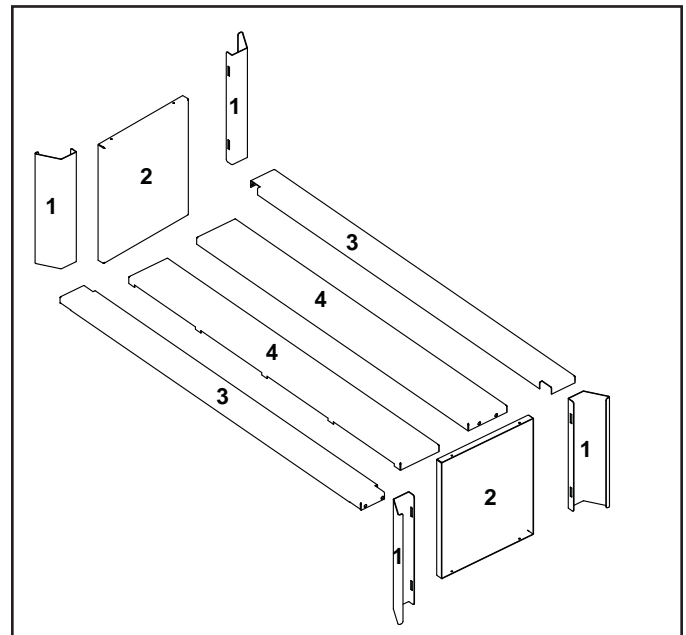

Figure 16. Service Parts Diagram

| ITEM | DESCRIPTION | PART NUMBER |
|------|-------------------------------------|-------------|
| | Refractory Kit | POR40ST-F |
| 1 | Refractory, Corner (Qty 4 req) | 2155-230 |
| 2 | Refractory, Side (Qty 2 req) | 2175-223 |
| 3 | Refractory, Outer Btm (Qty 2 req) | 2155-226 |
| 4 | Refractory, Inner Front (Qty 2 req) | 2155-224 |

D. RED40ST Model With Media or Media/Lights

This kit contains the components necessary to install the porcelain on RED40ST models that have media or media/lights installed. For installation on other models, refer to the instructions included with the appropriate kit.

Kit Contents:

- (2) Side Panels. See Figure 1.
- (4) Corner Panels. See Figure 2.
- (2) Angle tabs and (2) Sheet metal screws. See Figure 3.

Tools Required

- Cordless Drill
- 1/4 inch hex head driver tip



Figure 1. Side Panels.

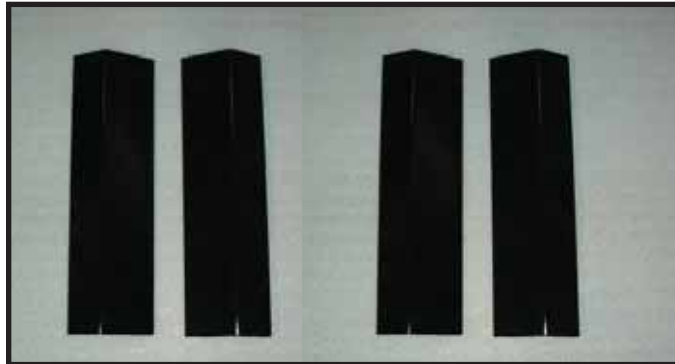

Figure 2. Corner Panels.



Figure 3. Angle Tabs with Screws.

Installation

1. Verify that the correct base pan is in the appliance before proceeding with the porcelain installation. The base pan required for this application has the letter "M" stamped in it. See Figure 4. If the base pan does not have the letter "M" stamped in it, contact your dealer.

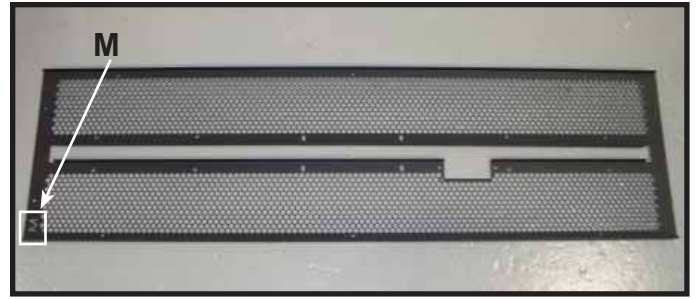

Figure 4. Base Pan.

2. Place side panels into firebox, bottom side first, then tilt top backward into position. Secure with angle tabs and screws in the pilot holes that are located on the top of the firebox.



Figure 5. Fastening Side Panel with Angle Tab.

3. Install glass media inside fireplace according to glass media installation instructions.
4. Install glass frame assemblies on both sides of appliance according to instructions in installation manual.
5. Install access panel assembly on both sides of appliance. Position so that tabs are facing glass and insert into glass frame.
6. Attach one end of chain to the tab on the back side of all corner panels. See Figure 6.



Figure 6. Attaching Chain.

- Remove screw from inside wall behind face of fire-place in front of glass and to the side. Attach chain to fireplace using this screw. Once chain is attached, slide corner panel into position. The chain is a safety feature and should remain connected at all times.

CAUTION! DO NOT operate appliance without safety chains attached. Safety chains retain corner panel sides in event of delayed ignition.



Figure 7. Attaching Chain.

- Install eight retainer clips (included) as shown in Figure 8. There will be four clips on each side of the appliance. The corner trim piece will be forced into clip on each side of the appliance. See Figure 9.

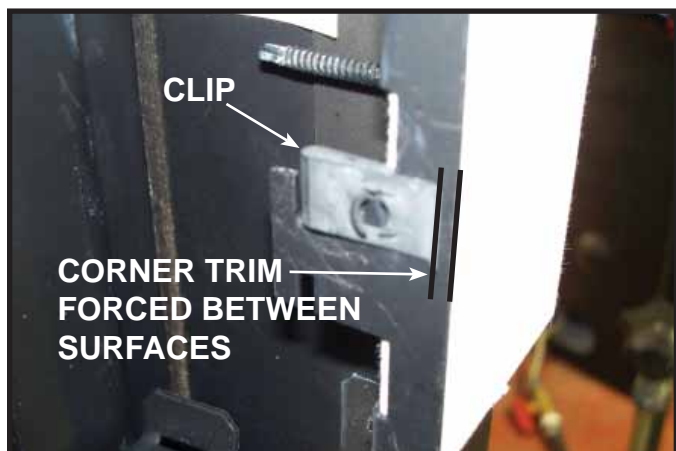

Figure 8. Clip Location.



Figure 9. Install Corner Panel onto Clip.

- Place glass rock media in access panel assembly according to instructions provided with glass rock media kit.

Service Parts

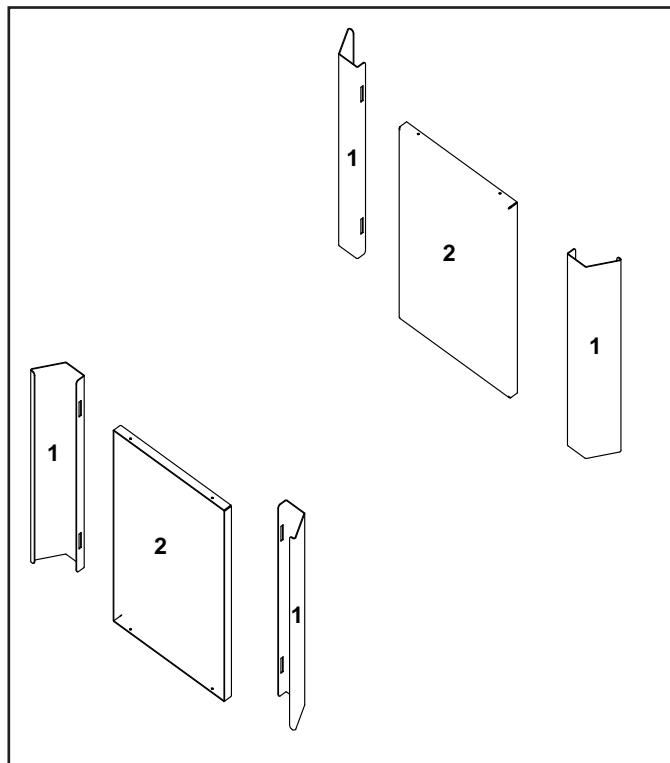

Figure 10. Service Parts Diagram.

| ITEM | DESCRIPTION | PART NUMBER |
|------|--------------------------------|-------------|
| | Refractory Kit | POR40ST-L |
| 1 | Refractory, Corner (Qty 4 req) | 2155-219 |
| 2 | Refractory, Side (Qty 2 req) | 2155-223 |

Please contact your Heat & Glo dealer with any questions or concerns.

For the location of your nearest Heat & Glo dealer, please visit www.heatnglo.com.

Heat & Glo, a brand of Hearth & Home Technologies Inc.
7571 215th Street West, Lakeville, MN 55044
www.heatnglo.com