

Optional Refractory Upgrade Kit PORC-750TR-E, PORC-550TR-E

- Installation Instructions -

CAUTION! Risk of Cuts or Abrasions. Wear protective gloves and safety glasses during installation. Sheet metal edges are sharp.

Step 1.

Remove hood, front, glass, logs and base pan from appliance. To remove base pan, lift and rotate back of base pan toward you.



Step 2.

Remove the glass baffle and the exhaust baffle for easier installation of side refractory. The glass baffle is attached with 2 screws, located on the top of the fire box. See Figure 1. The exhaust baffle is attached with two wing nuts, located on the ceiling of the fire box.

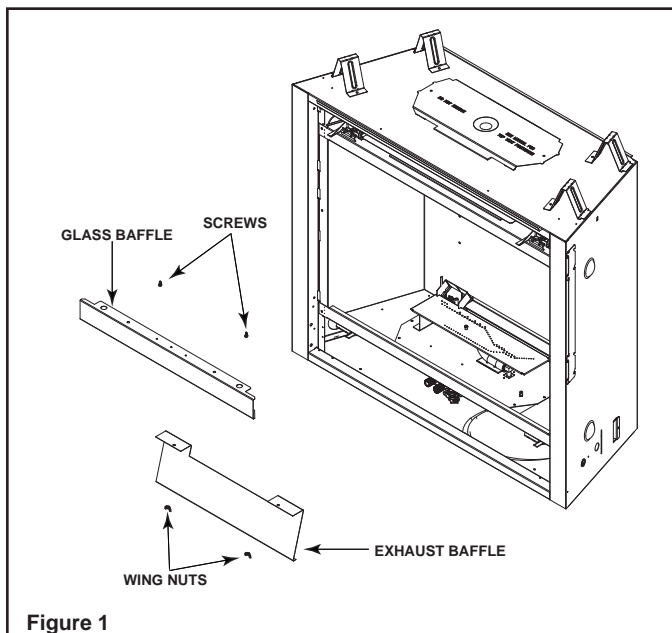

Figure 1

Step 3.

Install back refractory as shown below.



Step 4.

Install the left refractory panel as shown below.



Step 5.

Secure left refractory panel with a self tapping screw, as shown below.

Note: Drive a self tapping screw using the clearance hole located in the top of the refractory panel.



Step 6.

Install the right refractory panel as shown below.



Step 7.

Secure right refractory panel with a self tapping screw, as shown below.

Note: Drive a self tapping screw using the clearance hole located in the top of the refractory panel.



Step 8.

Reinstall base pan. The base pan will secure the bottom of the refractory panels.

Step 9.

Reinstall the glass baffle and the exhaust baffle using the two wing nuts and two screws. See figure 2.

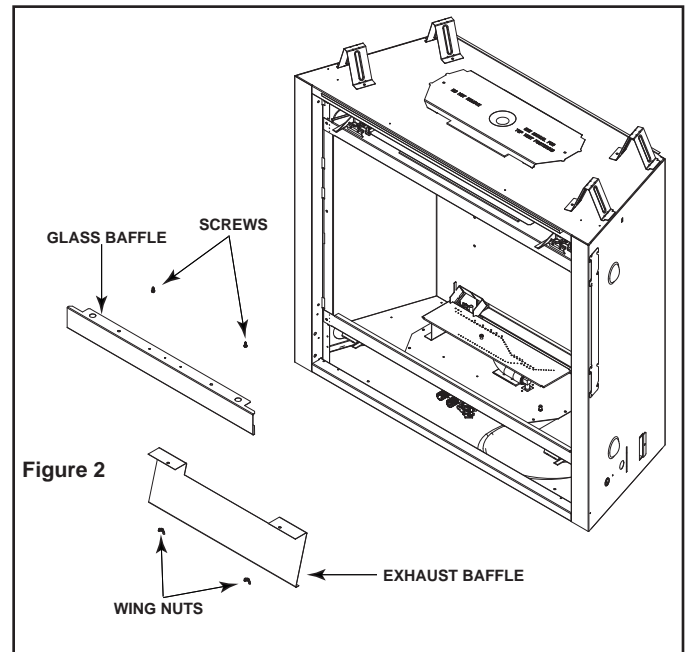

Step 10.

Reinstall logs, glass, front, and hood.

Heat & Glo, a brand of Hearth & Home Technologies Inc.
7571 215th Street West, Lakeville, MN 55044
www.heatnglo.com

Please contact your Heat & Glo dealer with any questions or concerns.
For the location of your nearest Heat & Glo dealer, please visit www.heatnglo.com.