

Halston Doors Installation & Operating Instructions

CAUTION! Risk of Cuts or Abrasions. Wear protective gloves and safety glasses during installation.

⚠ WARNING



HOT SURFACES!

Glass and other surfaces are hot during operation AND cool down.

Hot glass will cause burns.

- **DO NOT** touch glass until it is cooled
- NEVER allow children to touch glass
- Keep children away

- CAREFULLY SUPERVISE children in same room as fireplace.
- Alert children and adults to hazards of high temperatures.

High temperatures may ignite clothing or other flammable materials.

- Keep clothing, furniture, draperies and other flammable materials away.
- Do NOT operate with protective barriers open or removed.
- The doors must remain closed if children will be present during the operation of the fireplace.
- The doors may be made operable per these instructions. This may be done only upon request of a person responsible for the use and operation of the fireplace.
- The doors can be returned to the locked position following these instructions.
- These instructions are to be left with a person responsible for the use and operation of the fireplace.
- When the doors are in an operable state, the door-locking screw must be retained in the threaded nut behind doors.

WARNING! Risk of Fire! Combustible materials **MUST NOT** overlap or be placed under a surround.

CAUTION! Do not install damaged components.

A. Finishing Material

It's very important to know what kind of finishing material is going to be used on the fireplace. The table below shows the door models and the finishing material thickness allowed. Halston door can be installed within finishing materials or can overlap finishing materials. For an inside fit there is an available template to assist with sizing the finishing material. See Figures 1 and 2.

UNITS AND TEMPLATE PART #		BE-41C (6000-Template) 6000G (6000-Template) 6000GL (6000-Template) 6000GLX (6000-Template) SL-350TRS-D (350-Template) SL-36-Ultimate (6000-Template) SL-550TR-E, SL-550TRS-IPi-E (550-Template) SL-750TR-E, SL-750TRS-IPi-E (750-Template) SL-950TR-E, SL-950TR-IPi-E (950-Template)			
DOOR	FIT	FINISH MATERIAL THICKNESS	SEE Figure	X	Y
Halston-28E	Overlap	1 inch Max.	1	N/A	N/A
Halston-28E	Inside	1-4 inches	2	29-3/8 in.	28-3/8 in.
Halston-32E	Overlap	1 inch max.	1	N/A	N/A
Halston-32E	Inside	1-4 inches	2	32-3/8 in.	30-3/8 in.
Halston-36E	Overlap	1 inch max.	1	N/A	N/A
Halston-36E	Inside	1-4 inches	2	37-1/4 in.	34 in.
Halston-42E	Overlap	1 inch max.	1	N/A	N/A
Halston-42E	Inside	1-4 inches	2	44-3/8 in.	38 in.

Table 1. Halston Front Finishing Dimensions

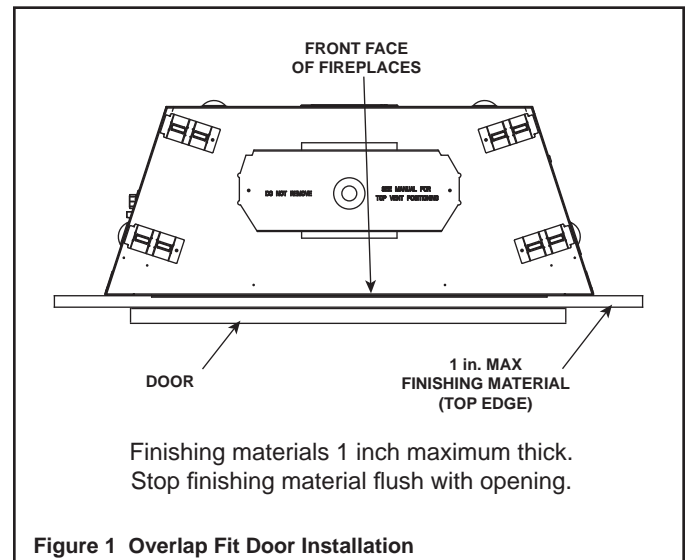

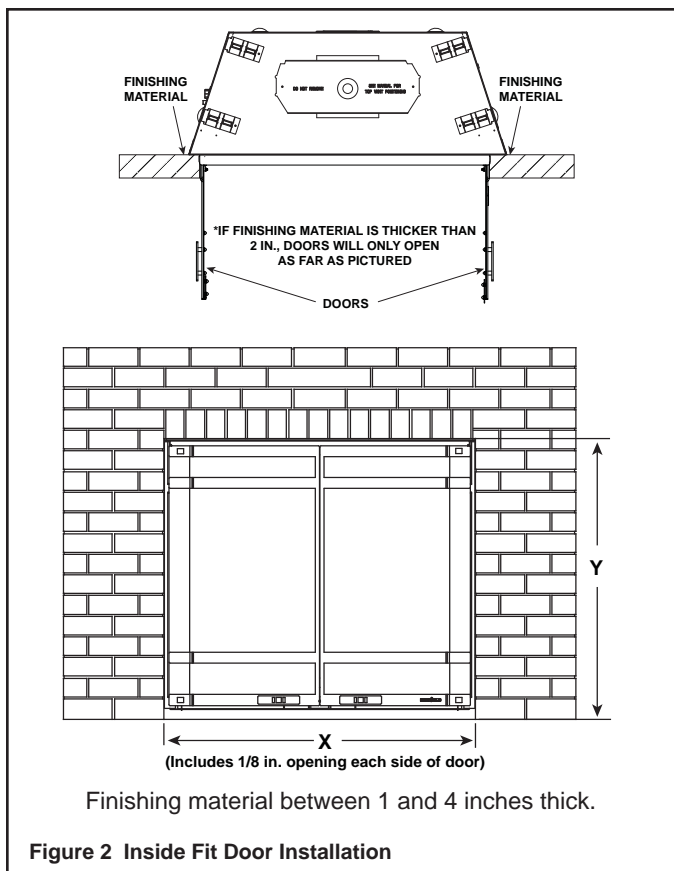

(Refer to Table 1 for X and Y dimensions on page 1.)

B. Door preparation

1. Remove all components from the package. See Figure 3.

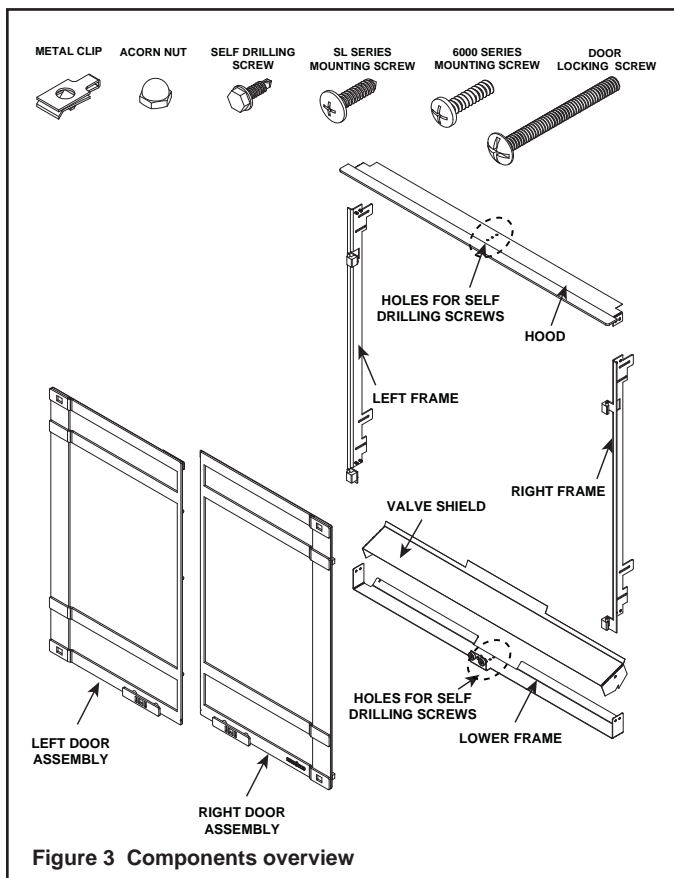

2. Assemble door frame.

- a) Bend outer tabs on the hood component and the lower frame component. See Figures 3 and 4.
- b) Assemble lower frame and hood to left and right frame components using Qty 8 Acorn nuts supplied. See Figure 5.

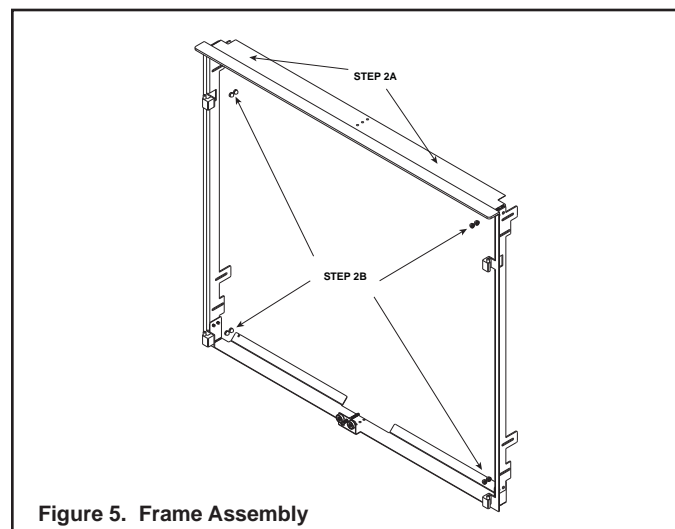
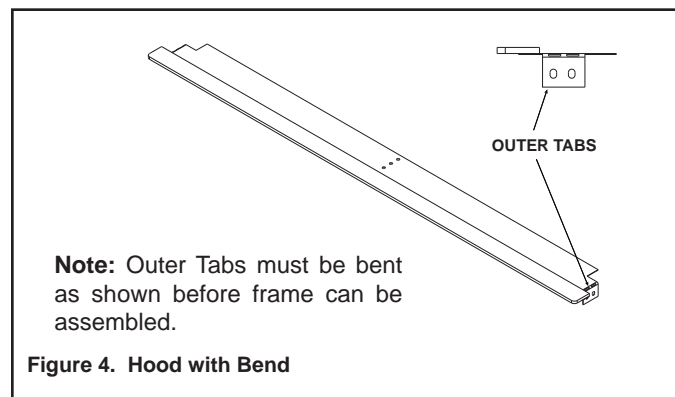

C. Door Installation

6000 Series and SL-36-Ultimate (move to the next section for SL series)

1. Place frame into fireplace opening. See Figure 6.

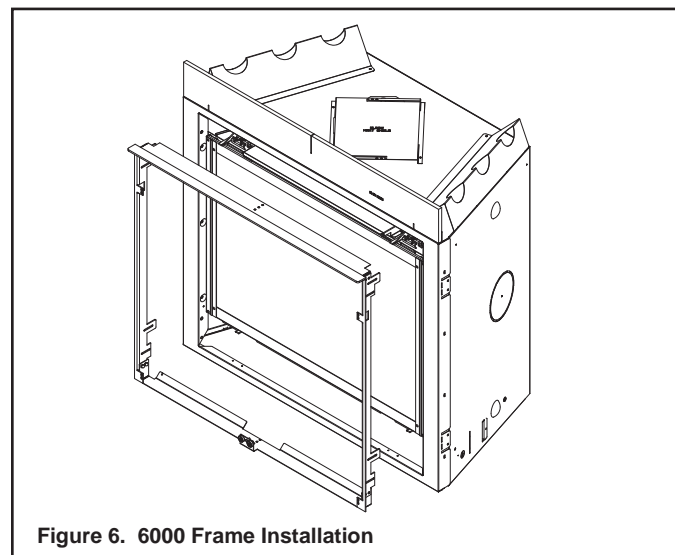

2. Push frame flush to finishing material. There are four threaded rivnuts located in the left and right sides of the fireplace surround. These rivnuts will line up with slots in the left and right frame components. Use the 4 supplied 6000 Series Mounting Screws shown in Figure 3 to secure the frame in place. See Figure 7.

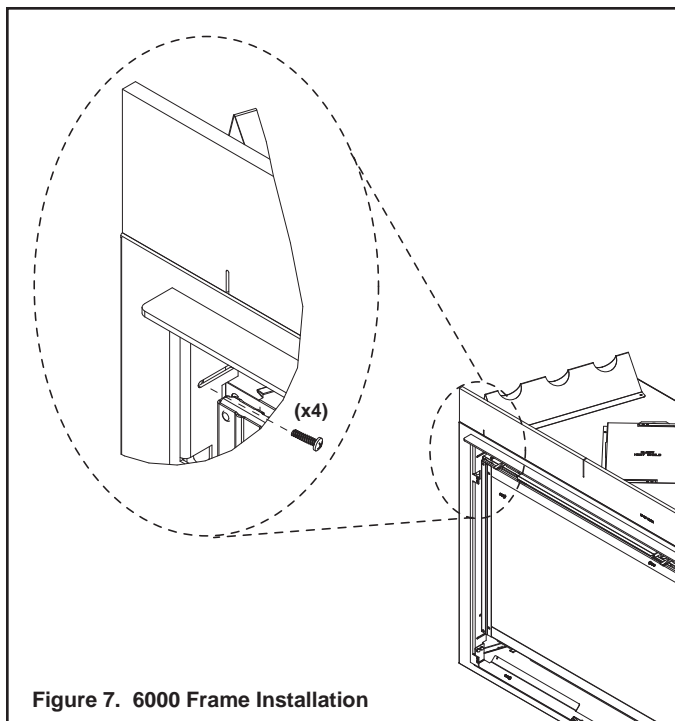

Figure 7. 6000 Frame Installation

Slim Line Series

1. Hood clips located in the upper corners of fireplace opening must be removed prior to door installation. Remove the hood clips using pliers. Slide them toward the outside and back into the fireplace. See Figure 8.

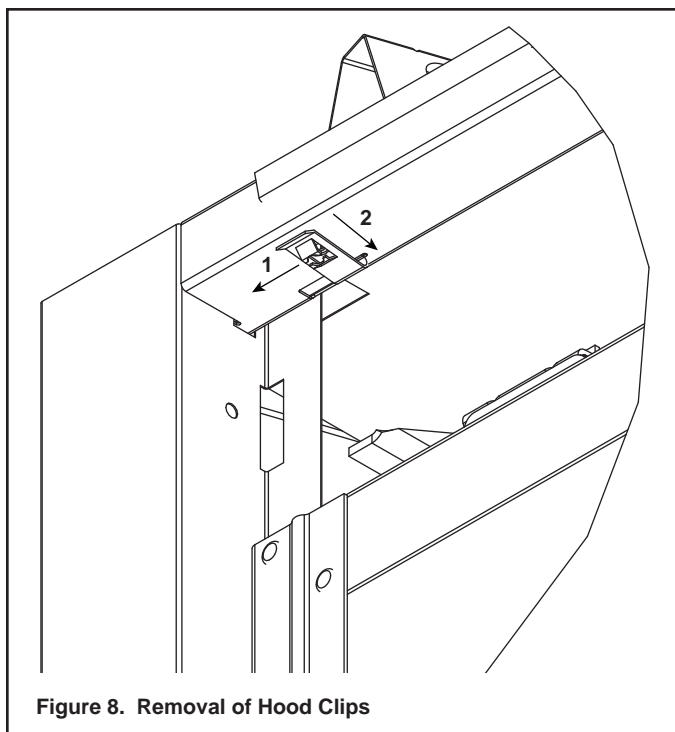

Figure 8. Removal of Hood Clips

2. When installing a door on an SL-950 fireplace the gussets must be removed. These gussets are located on the lower left and right corners of the fireplace opening. Each gusset is held in place by four screws. See Figure 9.

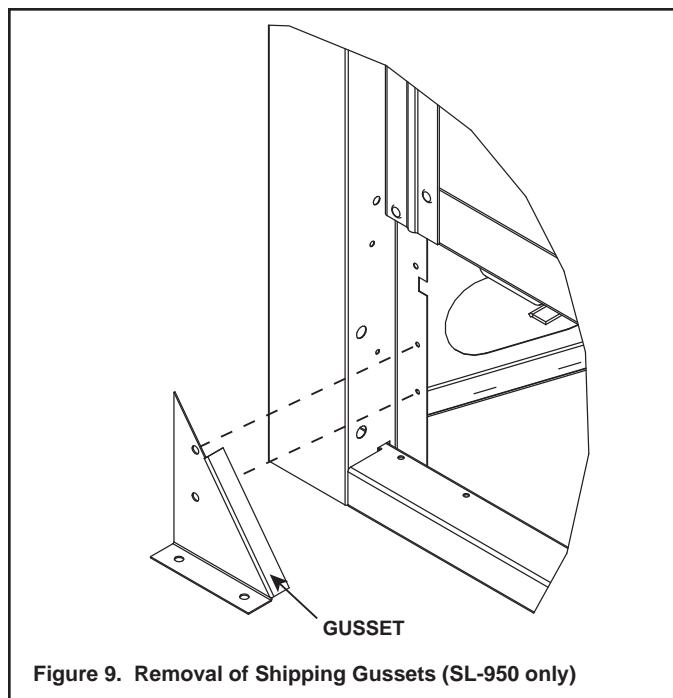

Figure 9. Removal of Shipping Gussets (SL-950 only)

3. Remove glass assembly prior to frame installation.
4. Slide 4 metal clips into location on the left and right side of the fireplace opening. See figure 10 for locations. Clips are installed by sliding them into location from the back side of the fireplace surround. Hole in clip will line up with a pilot hole in the fireplace surround. See Figure 10.

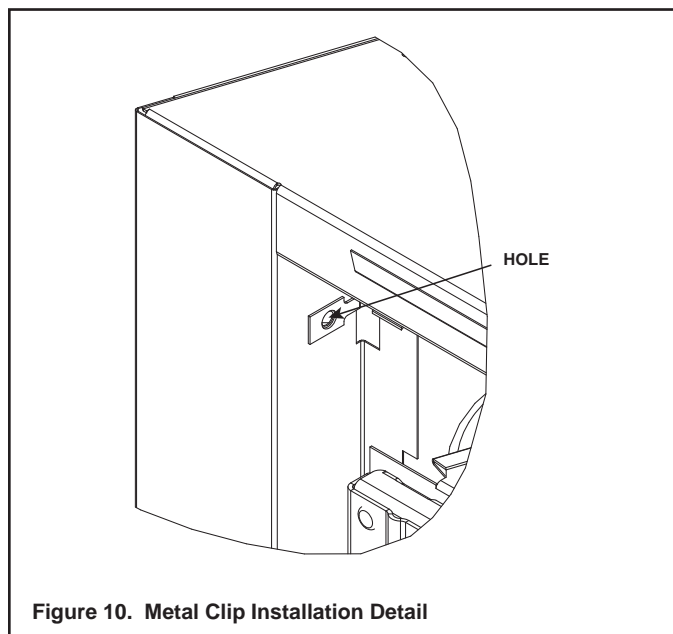

Figure 10. Metal Clip Installation Detail

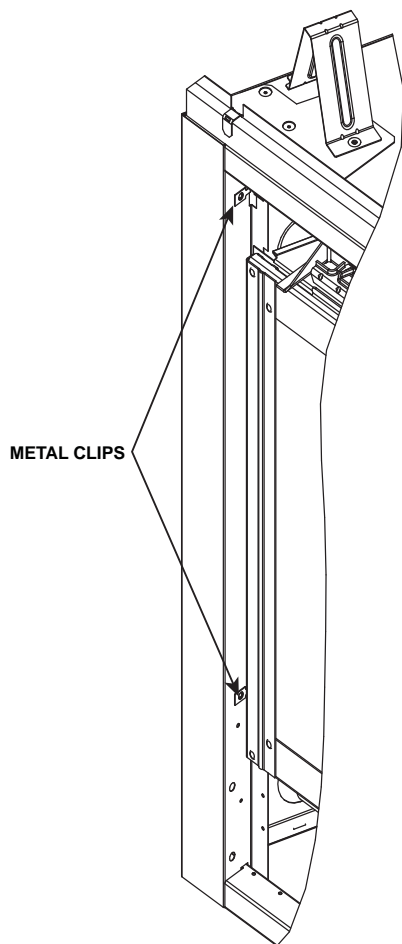

Figure 11. Metal Clip Installation Location
Left Side of Fireplace Opening Shown

5. Place frame into fireplace opening. See Figure 12. Use caution when placing frame into fireplace surround, so that Metal Clips installed in Step 4 are not pushed out of location.

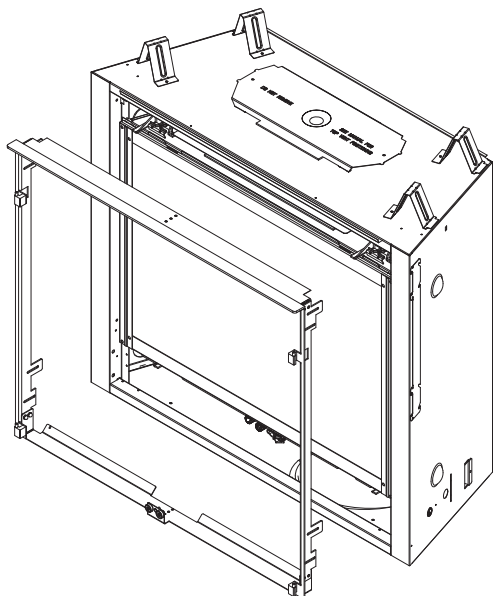

Figure 12. SL Frame Installation

6. Push frame flush to finishing material. Four slots in the frame will align with metal clips previously installed. Use the 4 supplied SL Series Mounting Screws Shown in Figure 3 to secure the frame in place. See Figure 13.

Note: When installing a Halston door on an SL 750TR-E or SL-750TRS-E in which the non-combustible finishing material does not cover the front of the fireplace surround, there will be a 3/8 inch offset between the side frame brackets and the front of the fireplace surround.

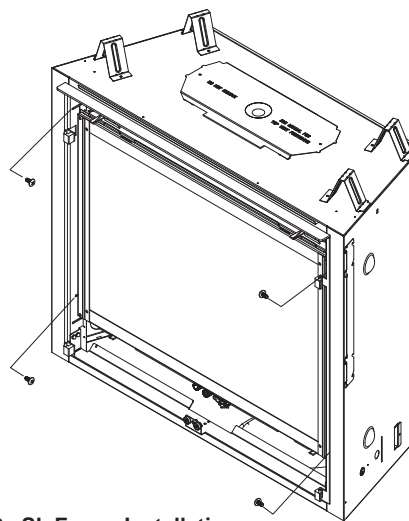

Figure 13. SL Frame Installation

7. Install glass frame back onto the unit by placing the top of the glass frame behind the upper hinges and sliding the frame upward into location.

Door Installation

1. Place the left door on the hinges by sliding the door down onto the surround's hinge pins. See Figure 14.

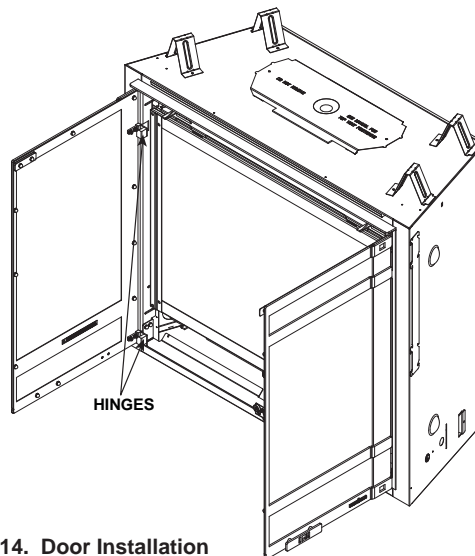

Figure 14. Door Installation

2. Place the right door on the hinges by sliding the door down onto the surround's hinge pins.
3. Swing the doors shut, making sure to engage top latches as shown in Figure 15. The doors should now be latched shut.

⚠ WARNING



Burn Risk.

- Keep doors shut and locked.
- Doors may only be opened during appliance maintenance.
- Do not discard locking screw.

Failure to follow these instructions may result in severe burns.

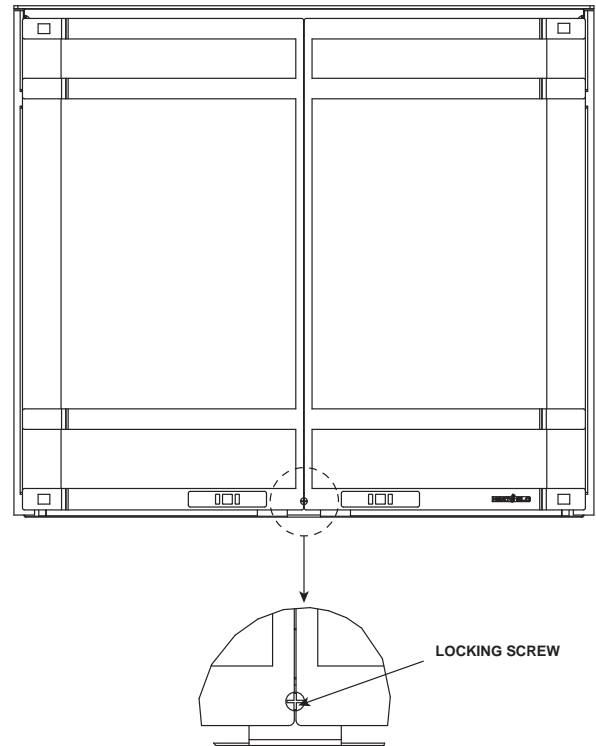

Figure 17. Locking Screw

Cleaning Instructions for Doors

Use a microfiber cloth and Windex® Original Glass Cleaner or 03M003 Stove Bright® Glass Cleaner to clean the door immediately after installation to remove acids deposited by the installer or technician. Spray the cleaner onto the microfiber cloth and carefully wipe the entire surface. The door should be cleaned in this manner annually by the homeowner to remove fingerprints or other contaminants. Once oxidation of the paint pigment has occurred, cleaning will not restore the original color.

Please contact your Heat & Glo dealer with any questions or concerns.

For the location of your nearest Heat & Glo dealer, please visit www.heatnglo.com.

Heat & Glo, a brand of Hearth & Home Technologies Inc.
7571 215th Street West, Lakeville, MN 55044
www.heatnglo.com

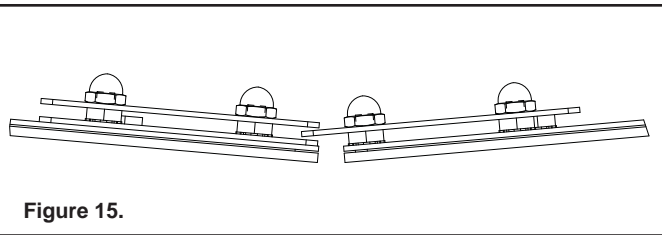

Figure 15.

- If the gap between the doors is not consistent, it is possible to adjust the doors by loosening the nuts on the door hinges and sliding them slightly to the left or right. Retighten the nuts once the doors have been adjusted.
- Once the doors have been secured and leveled. Self drilling screws, supplied, can be used to secure center of hood and bottom frame components. Install screws through clearance holes in the bottom frame and hood components and into the fireplace surround. Be sure not to hit finishing material with screws. See Figure 16.
- Open doors and insert valve shield. Notches in valve will align with notches in frame bottom.

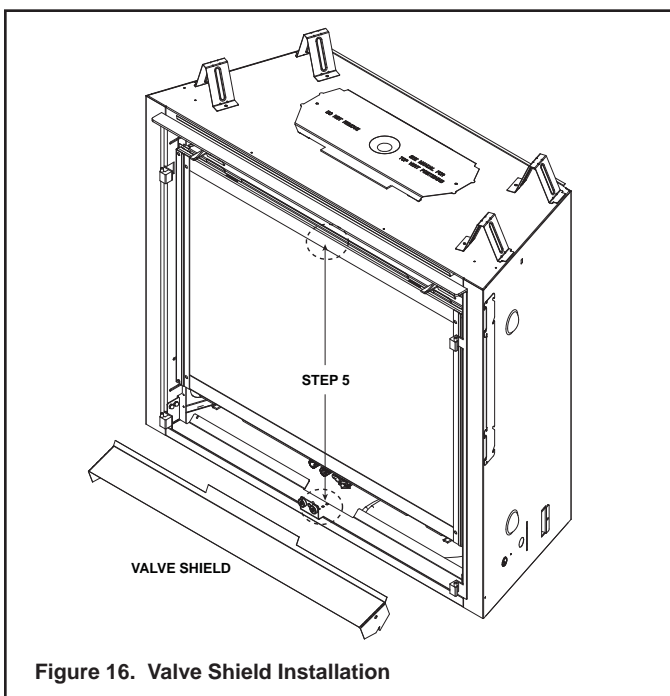

Figure 16. Valve Shield Installation

- Open the doors and remove the door locking screw, which is fastened in the door locking nut. Close the doors and thread the door locking screw through the doors and into the door locking nut. The doors are now locked shut. To make the doors operable, remove the screw, open the doors and then replace the screw. See Figure 17.