

QUADRA-FIRE®

Instructions for the Installation of New Handle Kit for Explorer III Cast Griddle Lid

Part: EXPLR-III-KIT

To install your new handle kit simply follow these instructions.

Note: Kit is to be installed with the cast griddle lid in the upright open position.

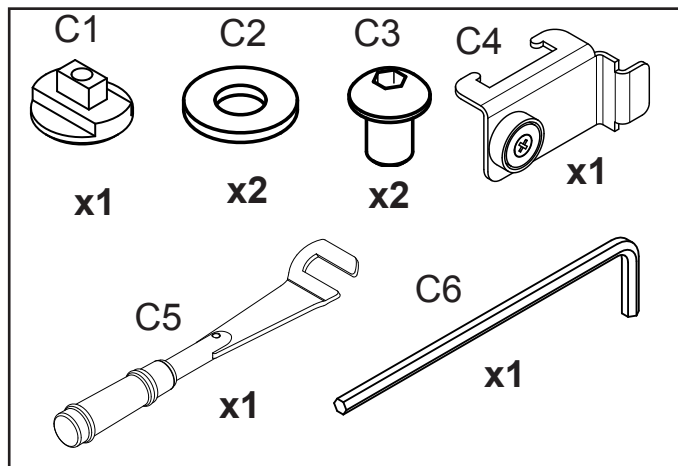

Step 1 Installing New Receiver

Open the cast griddle lid with current handle, and then ensure current handle is discarded. Place receiver button (C1) in slot from topside of the cast griddle lid. Hold the receiver button (C1) in place while threading in the allen head screw (C3) with x1 washer (C2) (Figure 1).

Note: Make sure the appliance is cool before attempting to install Receiver kit.

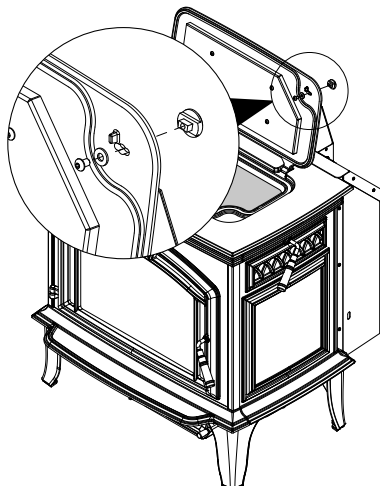

Figure 1



CAUTION

Injury Risk.



- Cast griddle top is heavy.
- When griddle top is open; pinch points exist.
- Keep body parts away from pinch points.

Step 2 Tighten Receiver

Tighten the allen head screw (C3) with allen wrench (C6) as tight as possible by hand (Figure 2).

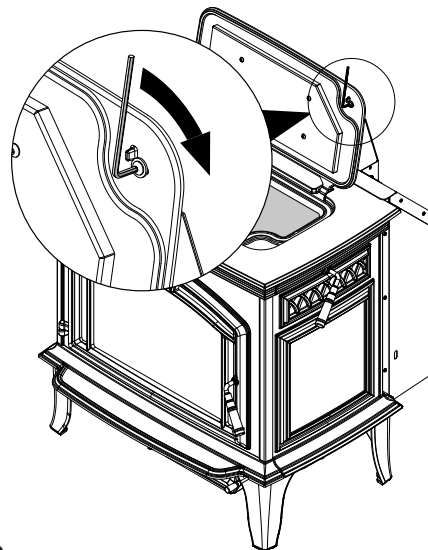

Figure 2

Step 3 Close Cast Griddle Top

Attach griddle handle (C5) to receiver (C1) by sliding handle ensuring that the griddle handle is securely engaged (Figure 3 on page 2). Carefully lower cast griddle lid.

QUADRA-FIRE®

Instructions for the Installation of New Handle Kit for Explorer III Cast Griddle Lid (CONTINUED)

Part: EXPLR-III-KIT

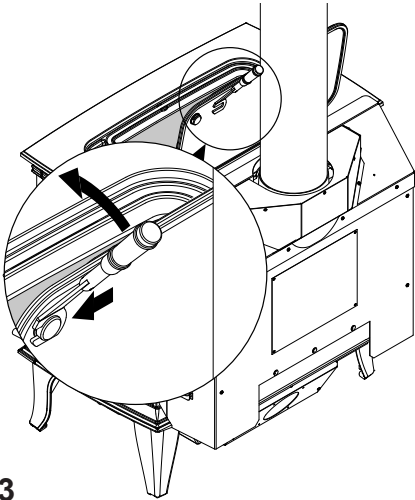

Figure 3

Step 4 Install Handle Storage Hanger

Locate the slot on the lower right backside of the appliance (**figure 4**). Slide the handle storage hanger (**C4**) into slot.

Step 5

After handle storage hanger (**C4**) is in slot lay bracket against appliance; the magnet will hold this in place (**Figure 4**).

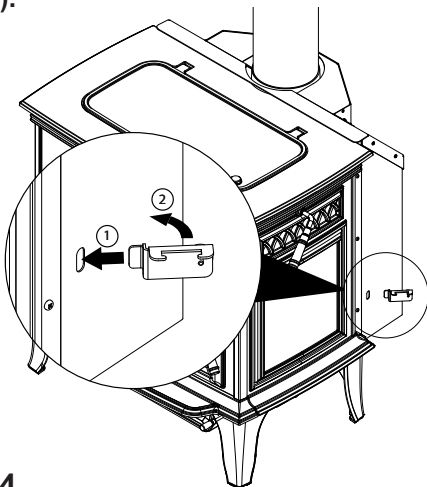

Figure 4

Step 6

When not in use, place griddle handle (**C5**) on storage bracket (**C4**) as shown in **Figure 5**.

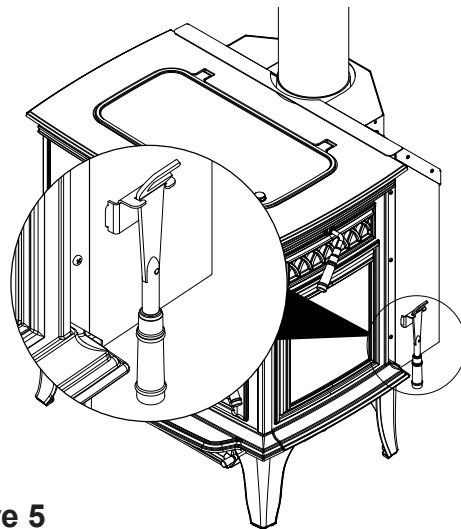

Figure 5



WARNING



Fire Risk

- Do not leave top load door open unless loading for fuel

Description	Service Part Number
Steel Griddle Handle Assembly	SRV7060-055
Top Load Receiver (w/ fasteners & allen wrench)	SRV7060-257
Griddle Handle Holder	SRV7060-056