



HEAT & GLO™

DESIGNED | to inspire

ESCAPE SERIES

Direct Vent Gas Fireplaces

ESCAPE SERIES

We started with the best in mind,
then made it even better.

Although Escape is the first gas fireplace in the world to remove all visible firebox sheet metal, what makes it even more exceptional is what we've added: innovative accent lights, mood-setting controls, and the inspired craftsmanship of a masonry fireplace, only better. The Escape 36" and 42" features our patented FireBrick technology, which has an authentic cantilevered brick design. Quite simply, it's our best. Also available in our See-Through model.



Cover: Escape-42 shown with Firescreen front in Bronze and Prairie Ridge companions and Sierra log shelf.

Above: Escape-ST shown with Firescreen front in Black.

ESCAPE SERIES



ESCAPE

The only gas fireplace in the world with absolutely no exposed sheet metal, the Escape features your choice of a 36" or 42" viewing area, and is full of innovations: our patented direct vent technology, accent lighting, multi-function wall switch and high thermal efficiency. Its FireBrick® technology reveals a seamless firebox with the incredible realism of dry-stacked brick and excellent radiant heat. The result is a stunningly beautiful look previously available only from a mason. Escape-42 shown with Firescreen front in Bronze and Prairie Ridge companions and Sierra log shelf.



ESCAPE SEE-THROUGH

Like its single-sided counterpart, the Escape See-Through has absolutely no exposed sheet metal, designed to provide all the latest trends in gas fireplaces. Apart from its clean see-through design, the Escape-ST features patented direct vent technology, a full 42" viewing area, accent lighting, multi-function wall switch and high thermal efficiency. Escape-ST shown above with Firescreen front in Black.



FIREBRICK TECHNOLOGY®

Featured in the 36" and 42" single-sided models, FireBrick technology provides the warmth and glow of a real wood-burning fire. Our patented Firebrick technology uses heat and compression to seamlessly mold ceramic fiber material into uniquely shaped fireboxes with authentic brick patterns. FireBrick technology also generates, retains, and radiates significantly more heat into the room than a metal fireplace and eliminates noise associated with the heating and cooling of metal. All Heat & Glo products featuring FireBrick technology are AFUE*rated, energy-efficient, and offer an airtight seal, for peace of mind and comfort.

FULLY-FEATURED

First class & second to none.

The Escape series offers an array of features and options that create a truly unique fireplace. While standard features include accent lighting, FireBrick® technology, IntelliFire™ ignition system and many more, you also have the ability to customize the look and feel of the Escape with firescreens and decorative companions. Marvel at the design and experience why the Escape series is in a class by itself.



ESCAPE SERIES



ESCAPE FEATURES

- Available in 36" & 42" size models
- 36": 27,000 - 41,000 (NG) BTU/hr input
- 42": 35,000 - 52,000 (NG) BTU/hr input
- 36": up to 1,600 sq. ft. heating capacity
- 42": up to 2,200 sq. ft. heating capacity
- Accent lighting
- Stratford FireBrick firebox
- Standard WSK-MLT wall switch
- Standard mesh curtain
- IntelliFire ignition system
- High definition oak-style logs (11-piece)
- Optional firescreen and companions
- Escape-36 shown above with Avalon cast mantel



ESCAPE SEE-THROUGH FEATURES

- Available in 42" size only
- 43,500 - 57,500 (NG) BTU/hr input
- Up to 2,700 sq. ft. heating capacity
- Accent lighting
- Electric ember bed
- IntelliFire Plus ignition system
- Standard RC-300 wall/remote control
- Standard mesh curtain
- High definition oak-style logs (9-piece)
- Optional firescreen and companions
- Optional arched firescreen
- Optional andirons
- Escape-ST shown above with Arched Firescreen

OPTIONAL FIRESCREENS & ACCESSORIES

Customize your Escape with a firescreen and decorative companions.

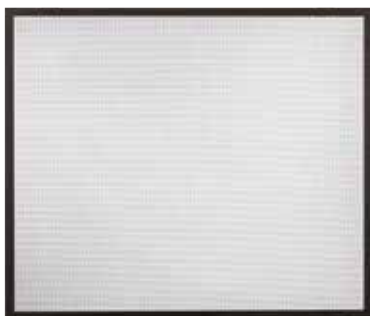

Firescreen Front
Available in black, bronze and pewter

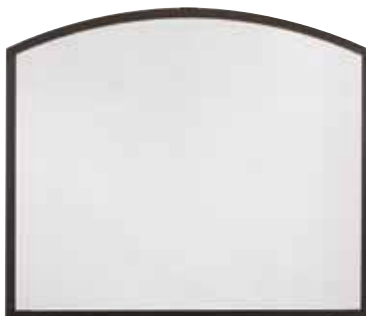

Arched Firescreen Front
Available in black, graphite and new bronze
(Available for the Escape See-Through only)



Black (BK)



Graphite (GT)



Bronze (BZ)



New Bronze (NB)



Pewter (PT)

FIRESCREEN COMPANIONS

The Firescreen front can be enjoyed unadorned; or you can purchase the Prairie Ridge Firescreen companions to attach to the front's exterior, adding a distinctive touch of corner detail. Available in black, bronze and pewter.

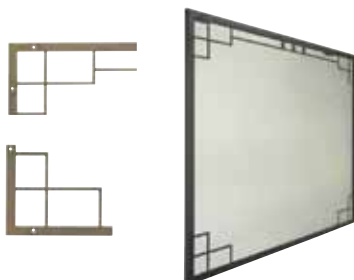

ANDIRONS

Optional andirons are available in black on the Escape See-Through only.



ESCAPE SERIES

CONTROLS

Heat at your fingertips—the warmth of home, at your control. All Escape Series fireplaces feature intermittent pilot ignition and a standard control.

ESCAPE 36" & 42"



Featured in Escape 36" and 42" single-sided fireplaces, our exclusive, state-of-the-art IntelliFire ignition system reduces gas consumption and thermogenerator wear by providing a pilot flame only when needed. It also supplies a back-up battery system to run the fireplace during a power outage.



TOTALSWITCH Command of both comfort and ambiance.

Model: WSK-MLT

Features: Thermostat Mode, Room Temperature Readout, Auxiliary Function, Flame High/Low, Pilot Activation, Fan Speed, On/Off

ESCAPE SEE-THROUGH



Featured in the Escape See-Through, the IntelliFire Plus ignition system saves fuel, improves efficiency and makes your fire easier to use. The IntelliFire Plus Ignition System is an "intelligent" control system providing energy conservation and the comfort of a roaring fire, all at your fingertips! IntelliFire Plus features intermittent-pilot ignition (IPI) allowing you to conserve fuel and money when the fireplace is not in use. Optional constant pilot mode allows you to leave the pilot flame on in cold climates. In addition, the system offers seamless transition from AC to battery backup in a power outage, as well as built-in safety features and memory settings. Lastly, our new family of IntelliFire Plus wireless and ergonomic controls provides stylish and fully featured benefits that make controlling your heat easier than ever.



INTELLIFIRE PLUS RC300 The RC300 comes standard with all Heat & Glo FireBrick inserts and incorporates an LCD screen, intuitive menus and large control buttons in a sleek and modern design. This wireless control gives you the flexibility to use as a remote only or mount on the wall anywhere in the room.

Model: RC300-HNG

Features: Auto Battery Backup, Pilot Activation, On/Off, 5 Step Flame Height, Fan Speed (Auxiliary 1), Two Additional Auxiliary Functions, Room Temperature Readout, Thermostat Mode, Timer Mode, Child Lock, Wall Docking Station



ESCAPE SPECIFICATIONS

MODEL	FRONT WIDTH		BACK WIDTH		HEIGHT		DEPTH		VIEWING AREA BTU/HOUR INPUT	
	UNIT	FRAMING	UNIT	FRAMING	UNIT	FRAMING	UNIT	FRAMING		
ESCAPE-36	50-7/8	51-1/2	50-7/8	51-1/2	35-1/2	46	21	22	36 x 30	31,000-40,000 (NG)
ESCAPE-42	56-7/8	57-1/2	48	57-1/2	41-3/8	52-1/2	21	22	42 x 36	35,000-52,000 (NG)
ESCAPE-ST	59-15/16	60-1/4	59-15/16	60-1/4	46-3/8	46-1/2	30	30	39-7/16 x 35-1/8	43,500 - 57,500 (NG)

ESCAPE-36

TOP VIEW

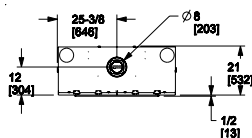

SIDE VIEW

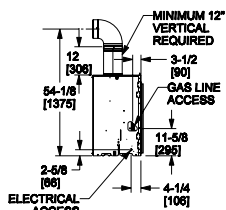

FRONT VIEW

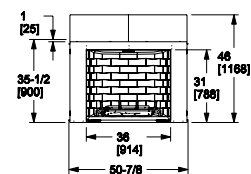

ESCAPE-42

TOP VIEW

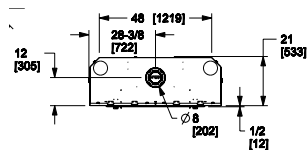

SIDE VIEW

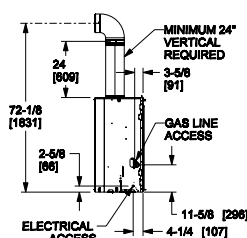

FRONT VIEW

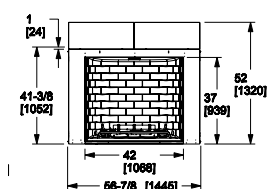

ESCAPE-ST

TOP VIEW

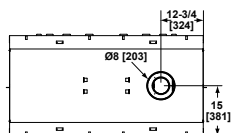

SIDE VIEW

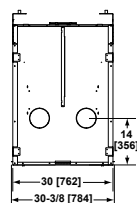

FRONT VIEW

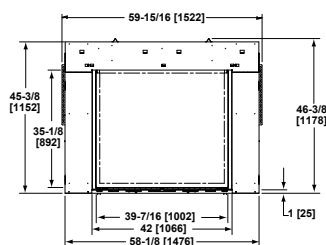

SIDE VIEW

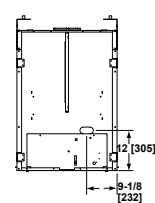

Dimensions in diagrams are in inches and millimeters. Dimensions in table are in inches. Product information is not complete and is subject to change without notice. Product installation must adhere strictly to instructions shipped with product. We recommend measuring individual units at installation. Assumes the use of 1/2" sheetrock. NOTE: Combustible material should not cover the face. Make sure you do NOT cover the decorative door opening.

Refer to installation manual for detailed specifications on installing this product. Heat & Glo reserves the right to update units periodically. The flame and ember appearance may vary based on the type of fuel burned and the venting configuration used. Actual product appearance, including flame, may differ from product images.

U.S. EFFICIENCIES

Steady State - Since most homeowners use their fireplaces for an extended time while they are in the room, Steady State measures how efficiently your fireplace converts fuel to heat once it is warmed up and running in a "steady state".

AFUE - AFUE rating is more typically used with appliances, like your furnace, that continually cycle on and off to maintain a constant temperature.

RATING	ESCAPE-36	ESCAPE-42	ESCAPE-ST
STEADY STATE	56.8% (NG), 56.8% (LP)	64.2% (NG), 64.2% (LP)	69.3% (NG), 69.3 (LP)
AFUE	50.3% (NG), 54.6% (LP)	52.8% (NG), 57.0% (LP)	60.5% (NG), 63.9% (LP)

CANADA EFFICIENCIES

EnerGuide (CSA P.4.1-02) - EnerGuide is a rating used in Canada to measure annual fireplace efficiency.

RATING	ESCAPE-36	ESCAPE-42	ESCAPE-ST
ENERGUIDE (CSA P.4.1-02)	54.5% (NG), 56.3% (LP)	59.0% (NG), 60.7% (LP)	62.5% (NG), 64.9% (LP)

For complete information on this model,
please contact us at:

HEAT&GLO

No one builds a better fire

A brand of Hearth & Home Technologies Inc.*

7571 215th Street West, Lakeville, MN 55044

Web: heatnglo.com

Phone: (888) 427-3973 (952) 985-6000

E-mail: info@heatnglo.com

 facebook.com/HeatandGlo

 twitter.com/HeatandGlo

 youtube.com/HeatandGlo

LIMITED LIFETIME WARRANTY*

The strongest in the industry, Heat & Glo provides a limited lifetime warranty on the most important aspects: firebox and heat exchanger.

*For full warranty details, go to www.heatnglo.com.



HNG-1019U-0711

