

IMPORTANT: THIS IS DATED INFORMATION. Parts must be ordered from a dealer or distributor. **Hearth and Home Technologies does not sell directly to consumers.** Provide model number and serial number when requesting service parts from your dealer or distributor.

Stocked at Depot

| ITEM | DESCRIPTION | COMMENTS | PART NUMBER |
|------|-----------------------------|---------------------|---------------------------|
| 1 | Non-combustible Board, Top | | SRV2331-460 |
| 2 | Standoff, Top | No longer available | 2321-199 |
| 3 | Non-combustible Board, Side | Qty 2 req | 2300-461 |
| 4 | Bottom glass | | 2331-018 |
| 5 | Burner | | 2331-007 |
| 6 | Pilot Assembly | | See Following Page |
| 7 | Shield, Pilot | | 2300-195 |
| 8 | Glass Assembly | | GLA-72-HNG |
| 9 | Shield., Bottom Glass | | 2331-179 |
| 10 | Panel, Bottom | | 2331-147 |
| 11 | Rock Tray | | 2331-151 |
| 12 | Rail, Burner | No longer available | 2331-338 |

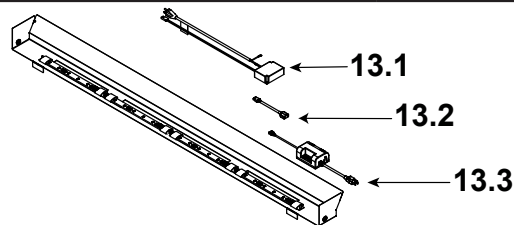

| | | | | |
|------|----------------------|--|-------------|---|
| 13 | LED Light Assembly | | ALK-72 | |
| 13.1 | LED 12V Power Supply | | 2273-308 | Y |
| 13.2 | Cord Assembly | | 2101-084 | Y |
| 13.3 | AUX RC300 | | SRV2166-335 | Y |

Additional service part numbers on following page.

#6 Pilot Assembly

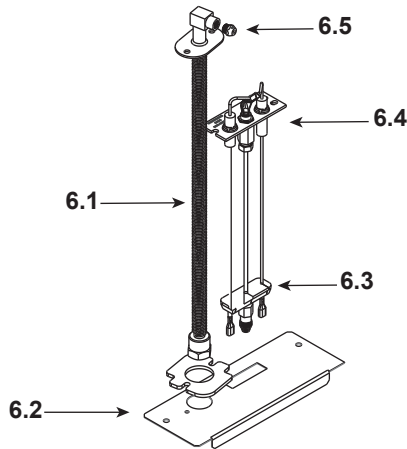

#14 Valve Assembly

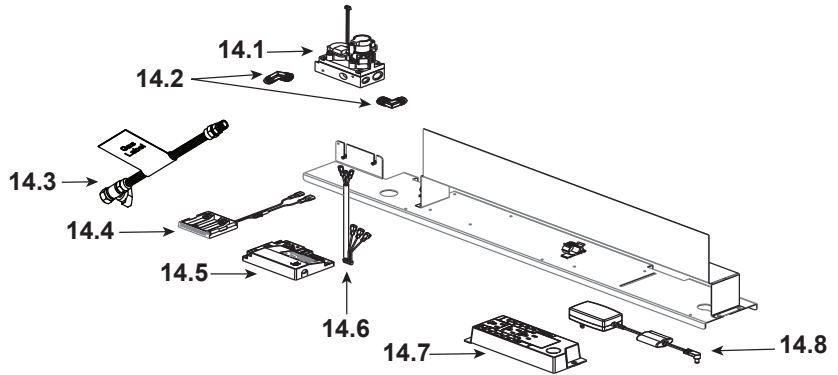

IMPORTANT: THIS IS DATED INFORMATION. Parts must be ordered from a dealer or distributor. **Hearth and Home Technologies does not sell directly to consumers.** Provide model number and serial number when requesting service parts from your dealer or distributor.

Stocked at Depot

| ITEM | DESCRIPTION | COMMENTS | PART NUMBER | Stocked at Depot |
|------|--------------------------|-----------|-------------|------------------|
| 6.1 | Bulkhead W/Flex tube | | SRV2166-119 | Y |
| 6.2 | Plate Flex and Pilot | | 2300-163 | |
| 6.3 | 3-Hole Grommet | | SRV2118-420 | |
| 6.4 | Pilot Assembly, NG | | SRV2090-012 | Y |
| | Pilot Assembly, LP | | 2090-013 | Y |
| 6.5 | Orifice, NG #23C | | 582-823 | Y |
| | Orifice, LP #45C | | SRV582-845 | Y |
| 14.1 | Valve, NG | | SRV2166-302 | Y |
| | Valve, LP | | 2166-303 | Y |
| 14.2 | Elbow | Qty 2 req | SRV4021-045 | |
| 14.3 | Flex Ball Valve Assembly | | SRV302-320 | Y |
| 14.4 | Battery Pack** | | SRV2166-323 | Y |
| 14.5 | Module | | 2166-347 | Y |
| 14.6 | Wire Harness | | 2166-304 | Y |
| 14.7 | Junction Box | | SRV4021-013 | Y |
| 14.8 | Transformer, 6 Volt Wall | | SRV2326-131 | Y |

**Fuse for battery pack can be sourced locally, not a warranty item. Specs are 250v, 1A fuse, 3/4" long

Additional service part numbers on following page.

No one builds a better fire

Beginning Manufacturing Date: Nov 2014
Ending Manufacturing Date: May 2016

IMPORTANT: THIS IS DATED INFORMATION. Parts must be ordered from a dealer or distributor. **Hearth and Home Technologies does not sell directly to consumers.** Provide model number and serial number when requesting service parts from your dealer or distributor.

**Stocked
at Depot**

| ITEM | DESCRIPTION | COMMENTS | PART NUMBER | |
|------------------------|--|-------------|-----------------|---|
| | Cable, Linear | | 2300-754 | Y |
| | Flue Restrictor | | 385-128 | |
| | Fiber Glass Rope | | 060-455 | |
| | Gasket Assembly Contains: Vent, Burner Neck, Seal Cap, Air Passage, Drawn Air Passage, and Flex and Pilot | | 2300-080 | |
| | Glass Latch Assembly | Qty. 4 req. | 2146-413 | Y |
| | Log Assembly (Optional) | | LOGS-72 | |
| | Light Kit, Ambient | | ALK-72 | |
| | Black Glass Kit (Includes Manual Bag Assembly for kit and Refractory Assembly, Optional) | | BGK-72 | |
| | Remote RC300-HNG | | 2166-330 | Y |
| | Touch Up Paint | | TUP-GBK-12 | |
| | Vinyl Siding Shield | | TRAP-VSS | |
| | Clean Face Front | Black | CFT-72-BK-C | |
| Media Options | | | | |
| | Media Kit, Red | | MEDIA-RED-72 | |
| | Media Kit, Fog | | MEDIA-FOG-72 | |
| | Media Kit, Ebony | | MEDIA-EBONY-72 | |
| | Media Kit, Cobalt | | MEDIA-COBALT-72 | |
| | Media Kit, Clear | | MEDIA-CLEAR-72 | |
| | Media Kit, Amber | | MEDIA-AMBER-72 | |
| | | | | |
| | | | | |
| | | | | |
| | | | | |
| | | | | |
| | | | | |
| | | | | |
| | | | | |
| | | | | |
| | | | | |
| | | | | |
| | | | | |
| | | | | |
| | | | | |
| Conversion Kits | | | | |
| | Conversion Kit NG | | NGK-MC-C | |
| | Conversion Kit LP | | LPK-8472 | |
| | Pilot Orifice, NG | | SRV593-528 | Y |
| | Pilot Orifice, LP | | SRV593-527 | Y |
| | Regulator, NG | | NGK-DXV-50 | Y |
| | Regulator, LP | | SRVLPK-DXV-50 | Y |