

IMPORTANT: THIS IS DATED INFORMATION. Parts must be ordered from a dealer or distributor. **Hearth and Home Technologies does not sell directly to consumers.** Provide model number and serial number when requesting service parts from your dealer or distributor.



**Stocked  
at Depot**

| ITEM | DESCRIPTION                 | COMMENTS  | PART NUMBER               |  |
|------|-----------------------------|-----------|---------------------------|--|
| 1    | Non-combustible Board, Top  |           | SRV2331-460               |  |
| 2    | Standoff, Top               | Qty 4 req | 2300-283                  |  |
| 3    | Side Trim                   | Qty 2 req | 2300-281                  |  |
| 4    | Non-combustible Board, Side | Qty 2 req | 2300-461                  |  |
| 5    | Bottom glass                |           | 2331-018                  |  |
| 6    | Burner                      |           | 2331-007                  |  |
| 7    | Pilot Assembly              |           | <b>See Following Page</b> |  |
| 8    | Shield, Pilot               |           | 2300-195                  |  |
| 9    | Glass Assembly              |           | GLA-72-HTL                |  |
| 10   | Shield., Bottom Glass       |           | 2331-179                  |  |
| 11   | Panel, Bottom               |           | 2331-147                  |  |
| 12   | Rock Tray                   |           | 2331-151                  |  |

Additional service part numbers on following page.

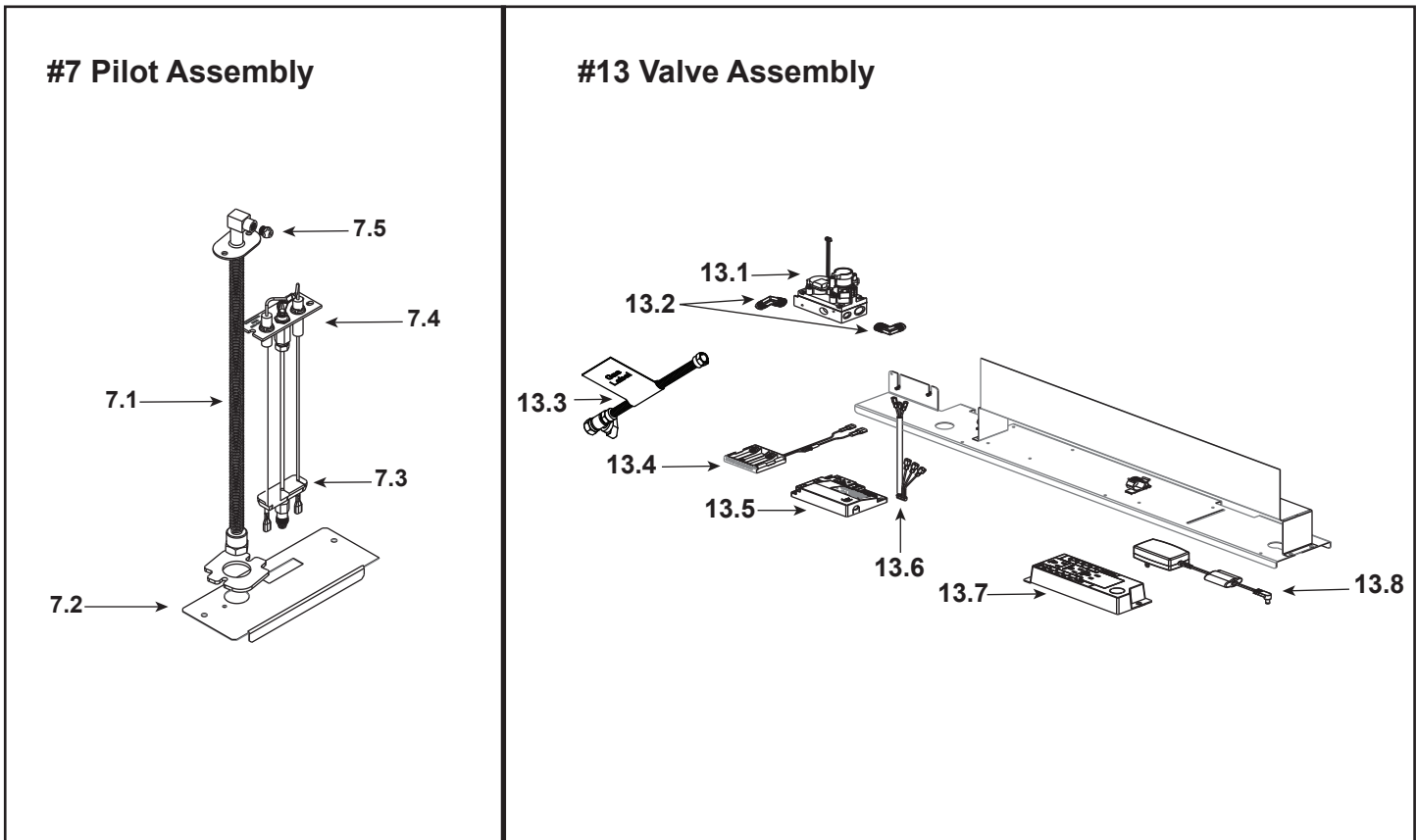

IMPORTANT: THIS IS DATED INFORMATION. Parts must be ordered from a dealer or distributor. **Hearth and Home Technologies does not sell directly to consumers.** Provide model number and serial number when requesting service parts from your dealer or distributor.



**Stocked at Depot**

| ITEM | DESCRIPTION              | COMMENTS  | PART NUMBER |   |
|------|--------------------------|-----------|-------------|---|
| 7.1  | Bulkhead W/Flex tube     |           | SRV2166-119 | Y |
| 7.2  | Plate Flex and Pilot     |           | 2300-163    |   |
| 7.3  | 3-Hole Grommet           |           | SRV2118-420 |   |
| 7.4  | Pilot Assembly, NG       |           | SRV2090-012 | Y |
|      | Pilot Assembly, Propane  |           | 2090-013    | Y |
| 7.5  | Orifice, NG #23C         |           | 582-823     | Y |
|      | Orifice, Propane #45C    |           | SRV582-845  | Y |
| 13.1 | Valve, NG                |           | SRV2166-302 | Y |
|      | Valve, Propane           |           | 2166-303    | Y |
| 13.2 | Elbow                    | Qty 2 req | SRV4021-045 |   |
| 13.3 | Flex Ball Valve Assembly |           | 302-323     | Y |
| 13.4 | Battery Pack**           |           | SRV2166-323 | Y |
| 13.5 | Module                   |           | 2166-347    | Y |
| 13.6 | Wire Harness             |           | 2166-304    | Y |
| 13.7 | Junction Box             |           | SRV4021-013 | Y |
| 13.8 | DC Regulator             |           | SRV2326-131 | Y |

\*\*Fuse for battery pack can be sourced locally, not a warranty item. Specs are 250v, 1A fuse, 3/4" long

Additional service part numbers on following page.

IMPORTANT: THIS IS DATED INFORMATION. Parts must be ordered from a dealer or distributor. **Hearth and Home Technologies does not sell directly to consumers.** Provide model number and serial number when requesting service parts from your dealer or distributor.



**Stocked  
at Depot**

| ITEM                   | DESCRIPTION  | COMMENTS  | PART NUMBER     | Stocked at Depot |
|------------------------|--|-----------|-----------------|------------------|
|                        | Flue Restrictor  |           | 385-128         |                  |
|                        | Fiber Glass Rope   |           | 060-455         |                  |
|                        | Gasket Assembly<br>Contains: Vent, Burner Neck, Seal Cap, Air Passage, Drawn Air Passage, and Flex and Pilot |           | 2300-080        |                  |
|                        | Glass Latch Assembly   | Qty 4 req | 2146-413        | Y                |
|                        | Log Assembly (Optional)  |           | LOGS-72         |                  |
|                        | Light Kit, Ambient (Optional)  |           | ALK-72          |                  |
|                        | Black Glass Kit ( Includes Manual Bag Assembly for kit and Refractory Assembly, Optional)                    |           | BGK-72          |                  |
|                        | Remote RC300-HTL   |           | 2166-331        | Y                |
|                        | Touch Up Paint   |           | TUP-GBK-12      |                  |
|                        | Vinyl Siding Shield  |           | TRAP-VSS        |                  |
|                        | Clean Face Front   | Black     | CFT-72-BK-C     |                  |
| <b>Media Options</b>   |  |           |                 |                  |
|                        | Media Kit, Red   |           | MEDIA-RED-72    |                  |
|                        | Media Kit, Ebony   |           | MEDIA-EBONY-72  |                  |
|                        | Media Kit, Cobalt  |           | MEDIA-COBALT-72 |                  |
|                        | Media Kit, Clear   |           | MEDIA-CLEAR-72  |                  |
|                        | Media Kit, Amber   |           | MEDIA-AMBER-72  |                  |
| <b>Conversion Kits</b> |  |           |                 |                  |
|                        | Conversion Kit NG  |           | NGK-MC-C        |                  |
|                        | Conversion Kit Propane   |           | LPK-8472        |                  |
|                        | Pilot Orifice, NG  |           | SRV593-528      | Y                |
|                        | Pilot Orifice, Propane   |           | SRV593-527      | Y                |
|                        | Regulator, NG  |           | NGK-DXV-50      | Y                |
|                        | Regulator, Propane   |           | SRVLPK-DXV-50   | Y                |