

IMPORTANT: THIS IS DATED INFORMATION. Parts must be ordered from a dealer or distributor. **Hearth and Home Technologies does not sell directly to consumers.** Provide model number and serial number when requesting service parts from your dealer or distributor.



Stocked at Depot

ITEM	DESCRIPTION	COMMENTS	PART NUMBER	
1	Non-Combustible Board		2170-136	
2	Refractory Bracket	Qty 2 req	2241-115	
3	Rock Fixture Assembly		2241-040	Y
4	Base Pan Assembly		2242-015	
4.1	Base Pan Back		2242-114	
4.2	Base Pan Front		2242-101	
4.3	Pilot Hood		2241-117	
4.4	Pilot Shield	Stainless	2241-116	
5	Burner Assembly	NG	SRV2242-007	Y
		LP	SRV2242-008	Y
6	Surround Assembly	No longer available	2170-019	
7	Glass Assembly		GLA-950TR	Y
8	Junction box		SRV4021-013	Y

Additional service part numbers on following page.

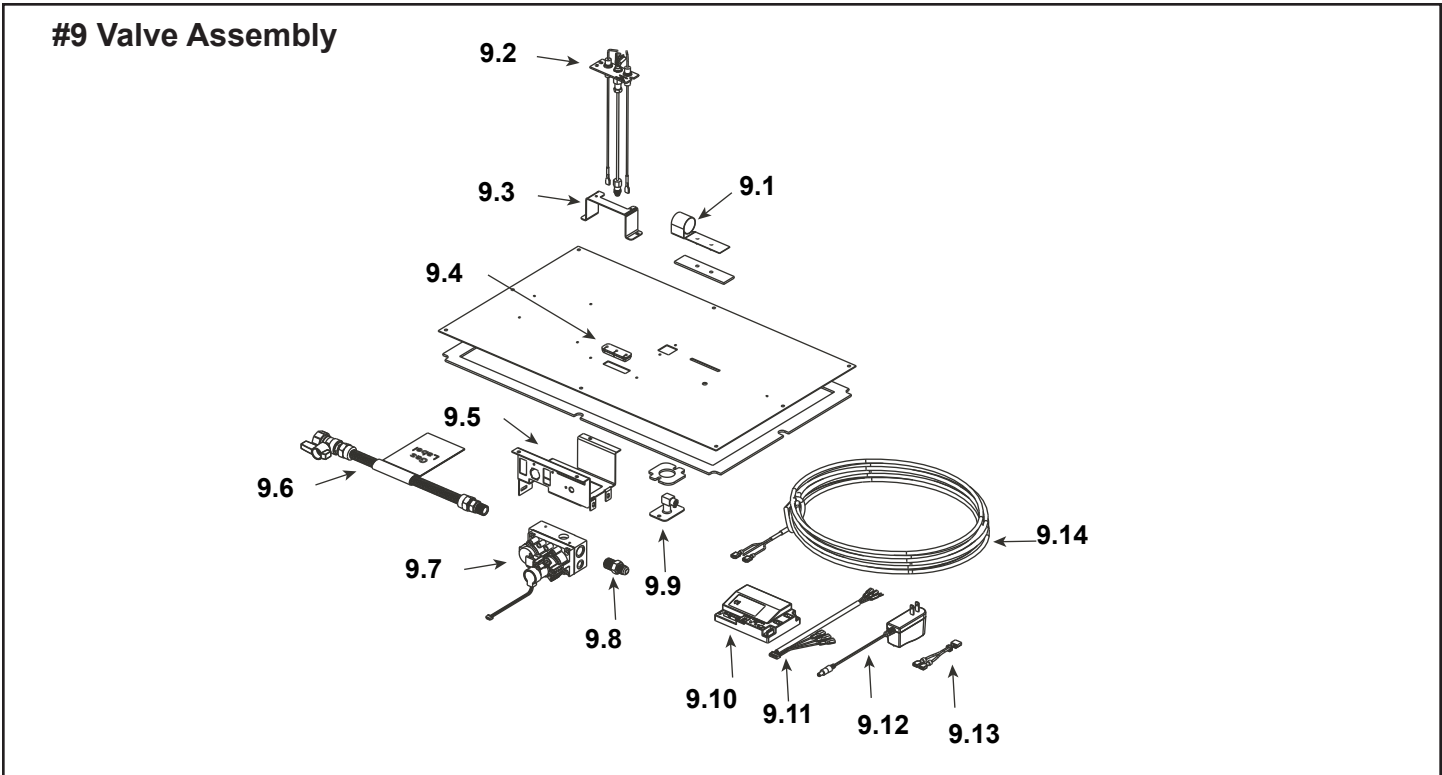

IMPORTANT: THIS IS DATED INFORMATION. Parts must be ordered from a dealer or distributor. **Hearth and Home Technologies does not sell directly to consumers.** Provide model number and serial number when requesting service parts from your dealer or distributor.



Stocked at Depot

ITEM	DESCRIPTION	COMMENTS	PART NUMBER	
9.1	Shutter Bracket Assembly		2118-121	Y
9.2	Pilot Assembly, NG		2090-012	Y
	Pilot Assembly, LP		2090-013	Y
9.3	Pilot Bracket		SRV2241-109-BK	
9.4	3-Hole Grommet		2118-420	
9.5	Valve Bracket		2118-104	
9.6	Flex Ball Valve Assembly		SRV302-320	Y
9.7	Valve, NG		SRV2166-302	Y
	Valve, LP		2166-303	Y
9.8	Male Connector	Pkg of 5	303-315/5	Y
9.9	Bulkhead w/FlexTube		7000-156	Y
9.10	Control Module		SRV2166-338	Y
9.11	Wire Harness		2166-304	Y
9.12	Switched DC Regulator		2326-131	Y
9.13	Jumper Wire		2187-198	Y
9.14	Thermostat Wire Assembly		2118-170	Y
	Orifice, NG (#35C)		582-835	Y
	Orifice, LP (#54C)		582-854	Y

Additional service part numbers on following page.

