

### 1. Positioning the back log #1: (SRV487-701)

The back log is the biggest log. Set the log behind the two back brackets with the split look toward the front. The back log should be brought forward until it comes in contact with the brackets. The log hangs 4" over the right grate bar and 3" over the left grate bar.

For Liquid Propane (LP) unit bend the back two brackets located on the right and left along the cut slots toward the back at 90° angle.

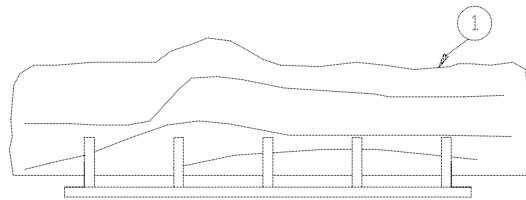
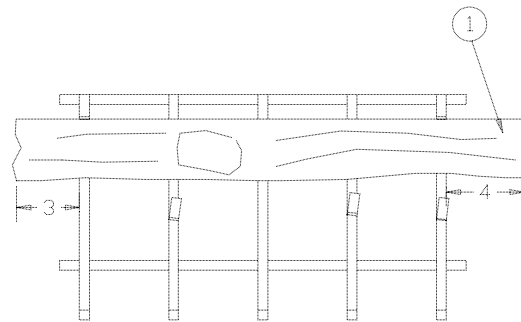

### 2. Positioning the left log #2: (SRV446-703)

Identify the log and then hold it with pointed end toward the right. Set the log on the grate and bring the left end towards the front until it comes in contact with the grate bar. Push the right end back against the bracket. The left end of the log should hang 2 1/2" over the left grate bar.

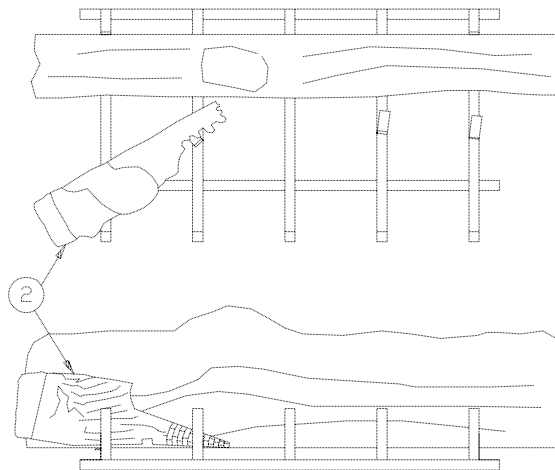

### 3. Positioning the right log #3: (SRV446-702)

Identify the log and then hold it with pointed end toward the left. Set the log on the grate and push it back against the two right front brackets. The pointed end should come in contact with the middle bar.

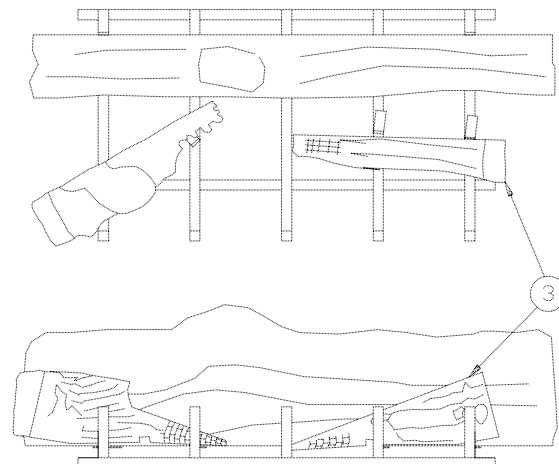

**4. Positioning the right middle log (split log) #4: (SRV487-703)**

Hold the log with the split towards the front and the burned area towards the back. Set the front end of the log between the second left and middle grate bar and lay the log onto the back log. Maintain the 8 1/2" dimension for locating this log with respect to the back log.

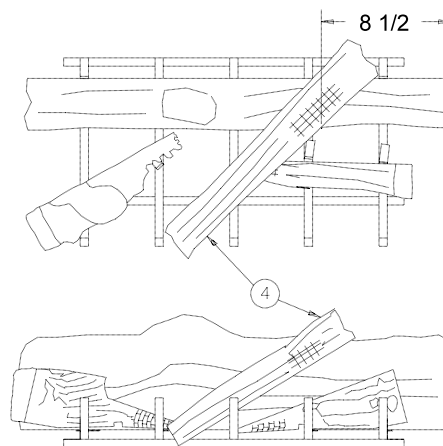

**5. Positioning the left middle log #5: (SRV487-702)**

This log is the second biggest log. Hold the log with the detail toward the top and the log curving towards the left. Set the end on the top of the front end of the right middle log (between the second left bar and the middle bar) and then lay the back end onto the back log. Maintain the 5 1/2" dimension for locating this log with respect to the back log.

**NOTE:** Fasten Logs #4 and #5 to the back log (#1) with two screws provided with the owner's manual.

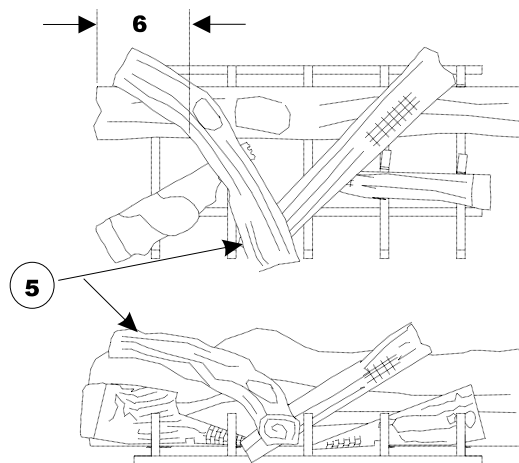

**6. Locating the right front log #6: (SRV402-701)**

This log is shaped like "Y". Hold the log with the pointed end towards the top and the detail towards the front. Set the branched end around the front end of the right bar on the grate and lay the pointed end until it comes in contact with the burned area on the right middle log.

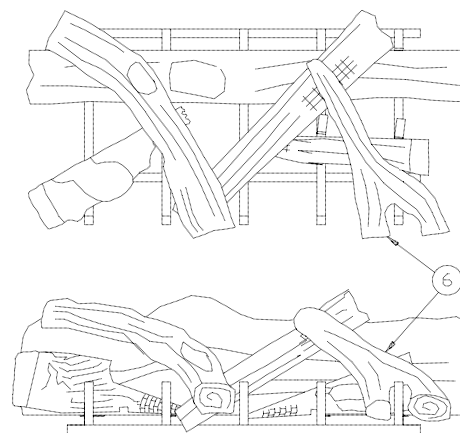

**7. Positioning the outer left log #7: (SRV446-714)**

Identify the log and then hold it with the pointed end towards the top. This log sits right behind the left log outside the grate and it lays towards the back log (this log sits outside the burner area).

