

heatilator®

AMERICA'S LEADING FIREPLACE SYSTEMS

installation directions

3138 E.P.
Heat Circulating
FIREPLACE

U.S. PATENT NOS. 3762391 and 374477
CANADIAN PATENT 942148

INDEX

GENERAL INFORMATION 2
PLANNING YOUR INSTALLATION 2
MAKING YOUR FIREPLACE SAFE 3

COMPONENTS & ACCESSORIES 4, 5
USE OF OFFSETS & RETURNS 7

STEP BY STEP INSTALLATION 8 THRU 15
FINISHING YOUR FIREPLACE 16

BUILDING AUTHORITIES, REFER TO THE FOLLOWING: UNDERWRITERS' LABORATORIES, INC. NO. MH5850 (LOOK FOR THE LABEL).

These directions are based on the NATIONAL BUILDING CODE recommended by the American Insurance Association.

CAUTION: Read the directions completely (including directions packed with component parts) BEFORE beginning installation.

WARNING: A safe installation of this fireplace requires proper use of authorized (listed) components ONLY, and careful attention to details and workmanship when installing each component. **INSTALLER NOTE:** A fireplace rendered unsafe through use of unauthorized items, insufficient clearances to combustible construction, or poor practices of any description can cause a building fire. FOLLOW DIRECTIONS TO AVOID CREATION OF HAZARDOUS INSTALLATION.

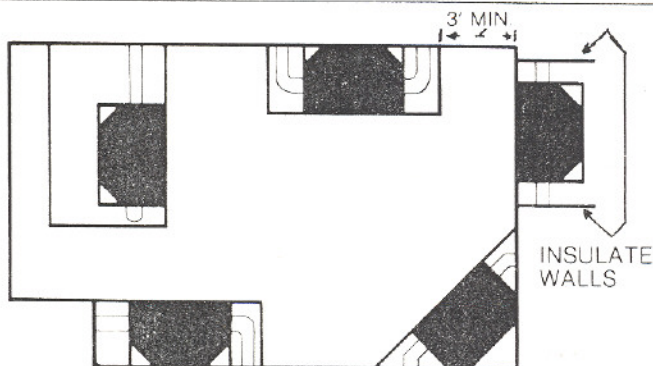

If the fireplace is in outside chase, it is strongly recommended that the fireplace cavity be insulated up to a height of six feet with either mineral wool or vermiculite type insulation. Do not use fiberglass, polystyrene, or cellulose insulation for this purpose.

Install it almost anywhere

The Heatilator EP Fireplace offers greater versatility, with a list of features that allow you to install it almost anywhere: (1) Outdoor air used to support combustion can be vented into the firebox from below, above, the rear, or sides. (2) Zero-clearance design allows placement on or next to combustible surfaces and materials. (3) The EP Fireplace weighs less than traditional fireplaces and needs no special floor supports. So, you can plan your Heatilator Fireplace for a corner, against any wall (inside or outside), almost anywhere, above or below basement grade. A Heatilator EP Fireplace is a comforting supplementary or emergency heat source—anywhere.

CONTROLLABLE HEAT CIRCULATION WHEN AND WHERE DESIRED

Individually controllable left and right DUCTS from fireplace to wall OUTLETS carry clean warm air which was heated in special chambers inside the fireplace. One outlet only may be used from each side. The outlets are not, however, required to be in the same room (see diagram B). Outlets may be installed in the fireplace room, or in another room, or one outlet per room. The warm air rises naturally, or may be assisted by the fan-equipped INLETS. Heat circulation through OUTLETS may be stopped (when heat is not needed) by use of the pull-chain controls. Internal air circulation within the fireplace does not stop, however, but continues in order to maintain safe temperatures on all metal parts and of combustible construction of the building. ALL AIR FLOW CEASES when fire is completely out and damper has been closed.

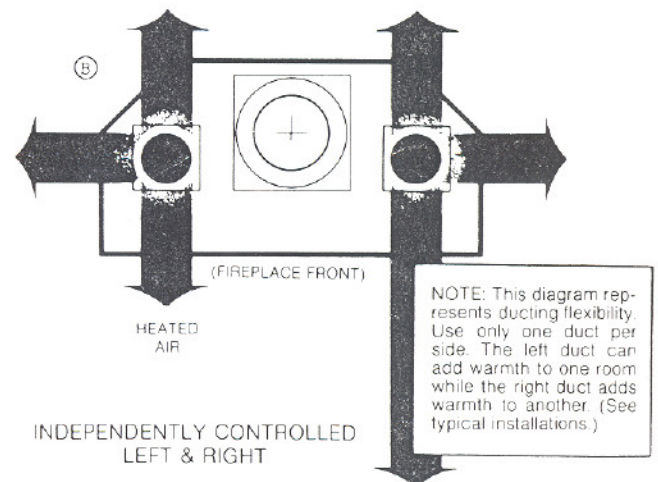
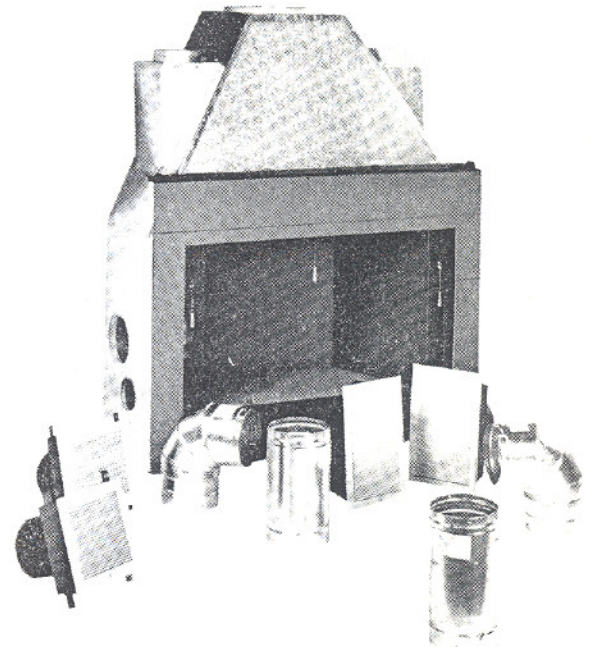

The Model 3138EP is intended for supplementary and emergency heating in year-round homes, NOT full-time sole-source heating. Vacation homes may be adequately served by the Model 3138EP used alone, depending on size, insulation, and area.

GENERAL INFORMATION

Congratulations on your purchase of the most efficient fireplace ever produced by Heatilator Fireplace. By carefully following these installation instructions and using your fireplace as outlined in the Care & Operations Manual, you may be assured of a safe installation.

Please read through these directions, paying very close attention to the section on fireplace safety before you begin work. If you have any questions, consult your Heatilator Fireplace dealer.

PLANNING YOUR INSTALLATION

Before you begin, it is important that you carefully plan your installation to make certain you have all the components and accessories required.

THE BASIC FIREPLACE

Included in the 3138 E.P. package are the following items: -

1. Fireplace
 2. Fan Kits (with grilles) (2)
 3. Outlet boxes (with grilles) (2)
 4. Adjustable elbows (2)
 5. Double wall duct (2)
 6. Grate
 7. Metal safety strip.
- If any of these parts are missing, notify your dealer at once.

TOOLS REQUIRED FOR INSTALLATION

The following tools are required. Depending on your particular installation, others might be needed.

1. Hammer
2. Electric drill
3. 5/32" drill bit
4. Safety glasses
5. Gloves
6. Saw (for cutting through ceiling and roof)
7. Plumb line
8. Regular and Phillips screwdriver
9. Carpenter's square
10. Tape measure
11. Level
12. Ladders

ADDITIONAL MATERIALS

You will also need the following locally purchased materials. Quantities depend on your particular installation.

1. Framing lumber
2. Duct tape
3. 4" dia. duct and fittings, single wall galvanized .018 minimum thickness or UL Listed air duct material, installed per manufacturer's instructions.
4. #10 x 1/2" long sheet metal screws
5. Insulation - 1" thick or better (glass - wool)
6. Caulking material
7. Finish materials (paneling, brick, stone, wall covering, etc.)
8. Framing and roofing nails

HEATILATOR BRAND COMPONENTS

The following components manufactured by Heatilator Fireplace are required. Again, quantities of certain components are dependent on your installation.

1. Insulated chimney and fittings (Catalog No.'s. 906, 912, 913)
2. Firestop spacers for each floor penetrated (Catalog No.'s. 3938, 3940, and 3942 should be used.) Use Catalog No.'s 3932, 3916 or 3931 for other levels.
3. Starter Section (Catalog No.'s 912, 3915, 3930).
4. Roof termination (Three different chimney terminations available):
 - (a) Simulated brick (metal) housing panels and housing top
Catalog No.'s Panels (1441M, 1442M, 1461M, 1462M, etc.)
Housing Top (1842M or 1862M)
 - (b) Terminal Cap, Flashing & Storm Collar
 - (c) Terminal Cap (Catalog No.'s 725, 925)
Used with locally constructed chase
5. Firescreen or glass door
6. Hearth extension

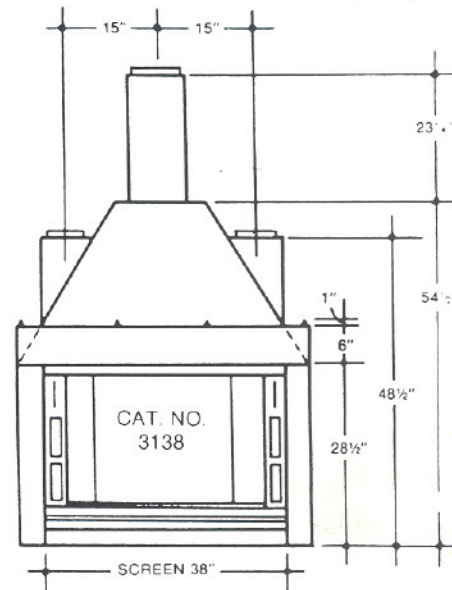
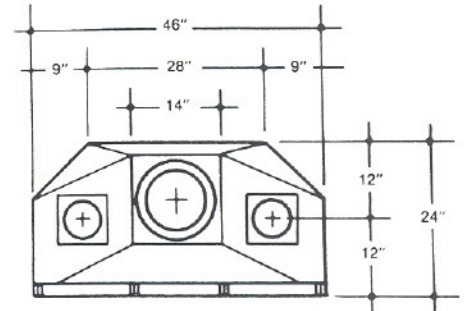
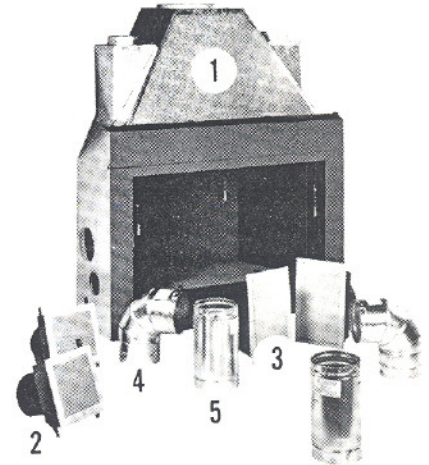

HEATILATOR BRAND ACCESSORIES

You may choose to install one or more of the following optional accessories for your fireplace.

1. Outside air kit (Catalog No. 3140 AK)
 2. Glass door (Catalog No. 2138)
-

MAKING YOUR FIREPLACE SAFE

1. Use only Heatilator brand components and accessories except where otherwise specified. Do not modify any Heatilator components.
2. Do not block or alter air entries at top of fireplace opening and below hearth. These are required for proper cooling of the fireplace.
3. Consult local building codes for their requirements regarding installation of a built-in factory-built fireplace.
4. Wear gloves and safety glasses during installation.
5. Maintain a 2" clearance from chimney sections to combustible materials (including insulation), and a 1" clearance from the heat circulating duct to combustibles.
6. Use a firestop spacer whenever you penetrate a floor or ceiling. Firestopping is not allowed on installations under 14'. Installations between 12' and 14' must pass directly through the roof without passing through an attic. An example might be a flat roof, single story building, an "A" frame or an outside chase.
7. Only 2 bends are allowed per installation (one offset and one return or 2 elbows). Amount of angle is limited to 30° off the vertical.
8. If mantle is installed, it must be at least 12" above fireplace opening.
9. A hearth extension is required. A factory-built hearth extension, Catalog No. 3900, has been tested and listed with Underwriters' Laboratories for use with this fireplace. Seal crack between fireplace and hearth extension with a non-combustible material.
10. This fireplace cannot be connected to an existing flue system nor can it be installed with chimney components made by another manufacturer. Doing so may create a fire hazard.
11. Do not install a lightning rod on the chimney.
12. Insulated chimney must rise at least 2" above top of locally constructed chase. A slip section or housing top should never be used in connection with a wood chase. A Catalog No. 925TC terminal cap is specified.
13. Do not install combustible materials on the face of the fireplace.
14. An outside air source is recommended for proper combustion.
15. Outlet boxes and grilles must be installed no closer than 6" to a combustible ceiling or side wall and no closer than 24" to combustibles directly in front of the outlet grille.
16. Either a screen (Catalog No. 3139) or glass door (Catalog No. 2138) is required to complete the installation.
17. Each component has packaged with it, its own installation directions. Follow these carefully.
18. Fan Kits must be installed. Fireplace may, however, be operated with fans not running.
19. Fan kits must **never** be installed in hot air outlets.
20. The chimney should extend at least 3' above the highest point where it passes through the roof and at least 2' higher than any portion of a building within 10'.
21. Total height of installation from floor or platform fireplace rests on to the chimney top (rain cap) must be at least 12'.
22. Never employ ordinary piping of single wall type for ducting to hot air outlets.

COMPONENTS & ACCESSORIES



Cat. No. 906
6" Chimney Section
(Sometimes needed with
Offsets, or with Chase
installations using
Terminal Caps.)



Cat. No. 913
3' Chimney Section

Cat. No. 912
2' Chimney Section

--WARNING--

The **INSTALLER** is reminded again, that only parts which are authorized (as shown on these pages), received undamaged at site, properly employed, and installed with care will result in a safe installation. (The only locally-fabricated part permitted is the CHASE TOP, page 6; the inlet duct for outside air may be locally purchased.)

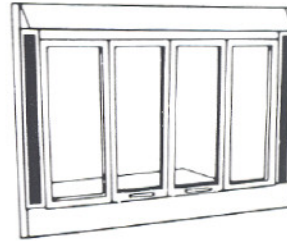

Cat. No. 2138
Glass Door

FIRESTOP SPACERS

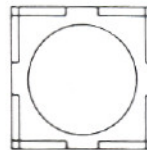

Cat. No. 3938
(Opening: 18" x 18")
For Vertical Chimney

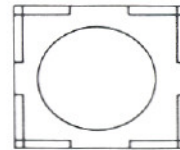

Cat. No. 3940
(Opening: 18" x 21 1/2")
Use with 15° Inclined
Chimney

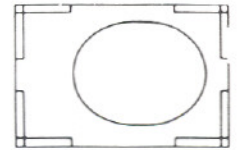

Cat. No. 3942
(Opening: 18" x 26 1/2")
Use with 30° Inclined
Chimney

INCLINED CHIMNEYS AT VARIOUS ANGLES				
Using 15° or 30° Offsets				
	EACH 2' CHIM. SEC.		EACH 3' CHIM. SEC.	
	Adds To Shift	Adds To Ht.	Adds To Shift	Adds To Ht.
15°	6"	22-7/16"	9 1/8"	34"
30°	11 1/8"	20 1/8"	17 1/8"	30 1/2"

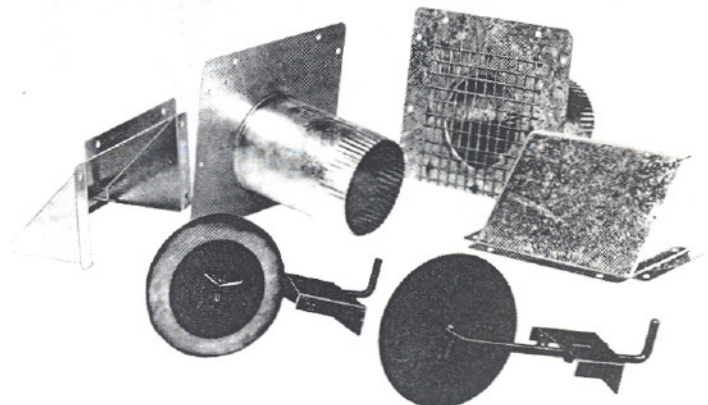

Cat No. 3140 AK
Outside Air Kit

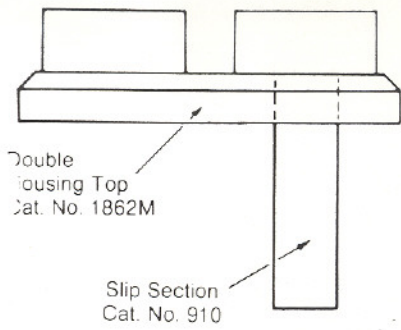

Available in:
Cat. No. 941 LP 0/12-6/12 pitch
Cat. No. 942 MP 6/12-12/12 pitch
Cat. No. 943 HP 12/12-24/12 pitch

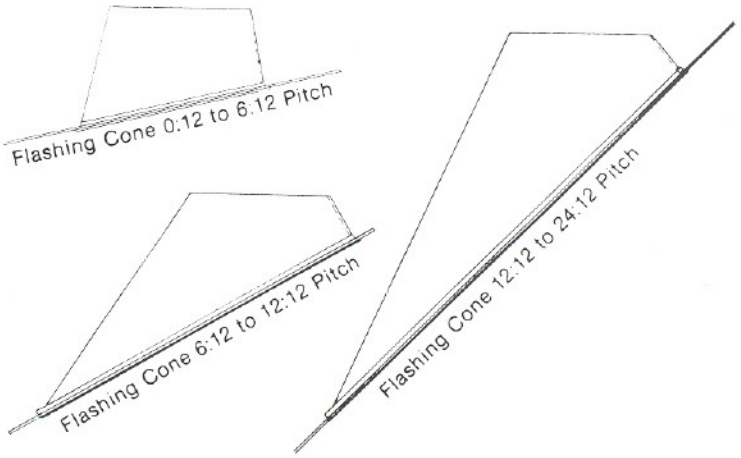

DOUBLE HOUSING TOP - Cat. No. 1862M

NOTE: The Mark 123-38C Fireplace can be installed in combination with other kinds of fireplaces or appliances. With DOUBLE HOUSING, a 7" or 9" Slip Section will be required for the second chimney, depending on the appliance to be vented (Adapter included with 7" size). DOUBLE HOUSING may also be used with only ONE chimney - cover disc for unused half is included with DOUBLE TOP. Order ONE (if required) for second chimney:

- 9" Slip Section - Cat. No. 910
- 7" Slip Section - Cat. No. 710



When the terminal cap is used it is necessary to purchase the appropriate roof flashing and a storm collar. Two foot and/or three foot chimney sections (ordered separately).

Terminal Cap may be substituted for the Single or Double Housing Panels & Tops. ONE OF THESE TERMINATIONS OF THE CHIMNEY ABOVE THE ROOF MUST BE USED. When ordering, be sure to specify catalog number according to roof pitch, so correct flashing type will be included.

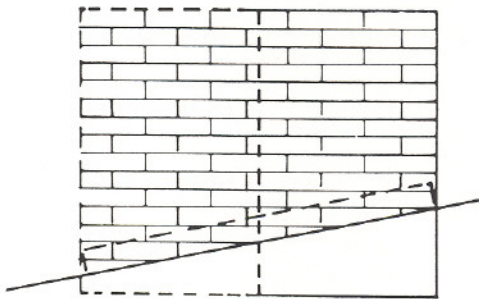

- | | |
|---|---|
| SINGLE
18" x 18" | DOUBLE
18" x 36" |
| 3' HOUSING PANELS
(White) Cat. No. 1441
(Red) Cat. No. 1442 | 5' HOUSING PANELS
(White) Cat. No. 1641
(Red) Cat. No. 1642 |
| 5' HOUSING PANELS
(White) Cat. No. 1461
(Red) Cat. No. 1462 | 5' HOUSING PANELS
(White) Cat. No. 1661
(Red) Cat. No. 1662 |

All panel sets include Roof Flashing

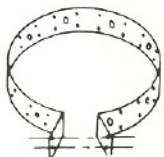

JOINT BAND - Cat. No. 922 (3 per carton) Required for reinforcing joint between Chimney Sections ONLY when sections are inclined or are exposed above roof.

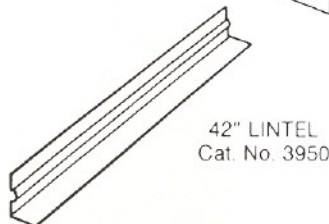
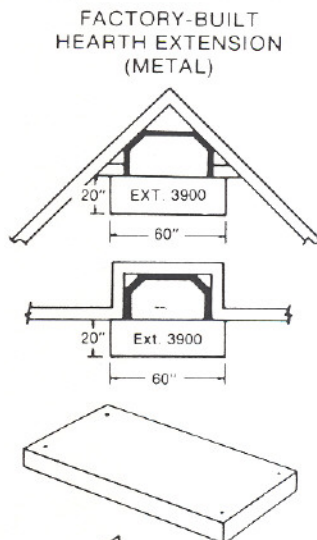

SELF-LOCKING FIREPLACE OUTLET DUCT PARTS

- Wall Thimble
Cat. No. 3680EP
(Adjusts for 3 1/2" to 6" walls)
- 6 1/2" OD
0°-90° Adj. Elbow
Cat. No. 3690EP
- 6 1/2" OD
12" Nom. Adjustable Length
Cat. No. 3670EP
(Telescopes from 9 1/2" max. true to 1 1/2" min. true)
- 6 1/2" OD
18" Nom. Length
Cat. No. 3618EP
(16 1/2" true)
- 6 1/2" OD
18" Nom. Length
Cat. No. 3612EP
(10 1/2" true)
- 6 1/2" OD
6" Nom. Length
Cat. No. 3606EP
(4 1/2" true)

MARK 123 CHIMNEY TERMINAL CAP

9" Size---CAT. NO. 925 TC

DEFINITIONS:

The **TERMINAL CAP** (Cat. No. 925 TC) is a factory-built chimney cap used to complete the Mark 700 Chimney, in conjunction with ; locally-constructed **CHASE TOP** which is installed on top of the built-on-the-site **CHASE**. The **CAP** includes a Chimney Cover which protects the uppermost chimney top end.

The **CHASE TOP** is a non-combustible, weatherproof, permanent cover, constructed locally (not supplied by Vega Industries, Inc.) to specifications shown herein, and installed on top of the **CHASE**. The metal **CHASE TOP** has a Collar of 2" height for each chimney which will be contained within the **CHASE**, each Collar located accurately relative to each chimney.

The **CHASE** is a hollow vertical enclosure, constructed as a permanent part of the building. The **CHASE** may be relatively simple and small box-like construction for installation on a roof, as shown above--containing only the upper ends of chimneys. The **CHASE** however, may alternatively be located outside the general exterior walls of the building, be sized to contain one or more fireplaces as well as their chimneys, and be of a height which will satisfy the requirements of the building design and code requirements for chimney height-above-roof.

GENERAL INFORMATION

1. The **TERMINAL CAP** completes the upper end of the Mark 700 Chimney. The topmost Chimney Section **MUST** end within the 6" height range of the Terminal Cap collar, as shown in Fig. 1. (It is necessary to utilize 3', 2' and 6" Chimney Sections in appropriate quantity to insure that the topmost Chimney Section ends within this range.)
2. The **CHIMNEY SECTIONS** must be installed so as to maintain a 2" minimum clearance to combustible (including insulation) construction.
3. "Chimney should extend at least 3' above the highest point where it passes through the roof and at least 2' higher than any portion of a building within 10 ft." Consult local codes for requirements in your area.
4. The **CHASE TOP** is constructed as a flat or contoured cover, of metal or other non-combustible material, with width and length to suit the Chase dimensions. Its outer edge must have a down-turned flange of not less than 2" height. Careful attention to collar size in Fig. 2 is recommended--note 2" collar height and collar diameter. (Detailed drawings for local fabrication of single or multiple chimney **CHASE TOPS** are available. Write for Vega Drawing Package #5.)
5. Never use single wall flue inside a wood frame or other combustible construction type chase.
6. Continue chimney sections up through chase, maintaining 2" minimum clearance to combustibles. Also the top of the chimney (rain cap) must terminate at least 3' above the highest point where it passes through the roof and at least 2' higher than any portion of a building within 10'.

The fireplace maybe installed directly on a combustible floor and the fireplace sides and rear may be in contact with combustible walls or wall framing members. **WARNING: PROVIDE COMPLETE FULL-AREA SUPPORT BENEATH FIREPLACE TO BEAR WEIGHT OF UNIT AND ITS CHIMNEY—DO NOT SUPPORT FIREPLACE AT A FEW POINTS ONLY WITH BLOCKS OR FLOOR JOINTS.** (To raise fireplace above floor, construct a sturdy platform with full wood covering.)

---WARNING---

These Directions (for **CHASE**, **CHASE TOP**, and **TERMINAL CAP**) have been carefully established to permit wide latitude in the employment of chase construction and location. However, safety and permanence demand adherence to **REQUIREMENTS** clearly stated herein and utilization of good materials installed with care.

ASSEMBLY AND CONSTRUCTION DETAILS

One typical installation is illustrated below. A Sketch, an End View and a Curb Detail define the methods used--in this instance, the **CHASE** is constructed of ordinary 2 x 4 lumber, covered with an exterior-grade sheathing material, and mounted on a typical curb for flat roof. One or several chimneys might be involved.

Terminal Cap is installed after Chimney Cover (see below). With Cap in position on Chase Top Collar, tighten the locking bolt on Cap Collar. Install the two 1" screws supplied so that they penetrate Cap, Chase Top Collar and Chimney Section. If Collar on Terminal Cap will not fit down over flange on chase top, install storm collar (Cat. 933 SC) over flange and attach cap to flue.

CHASE TOP of 24-ga. galvanized steel, or heavier, has collar and corners soldered watertight. Fasten by nailing down into Chase, using appropriate flashing nails with waterproof-sealed heads. There should be a slight crown built into large Chase Tops.

CURB DETAIL will vary for roof types and local practice. For sloped roof, or for installation straddling ridge, curb may be omitted and conventional flashing practice employed.

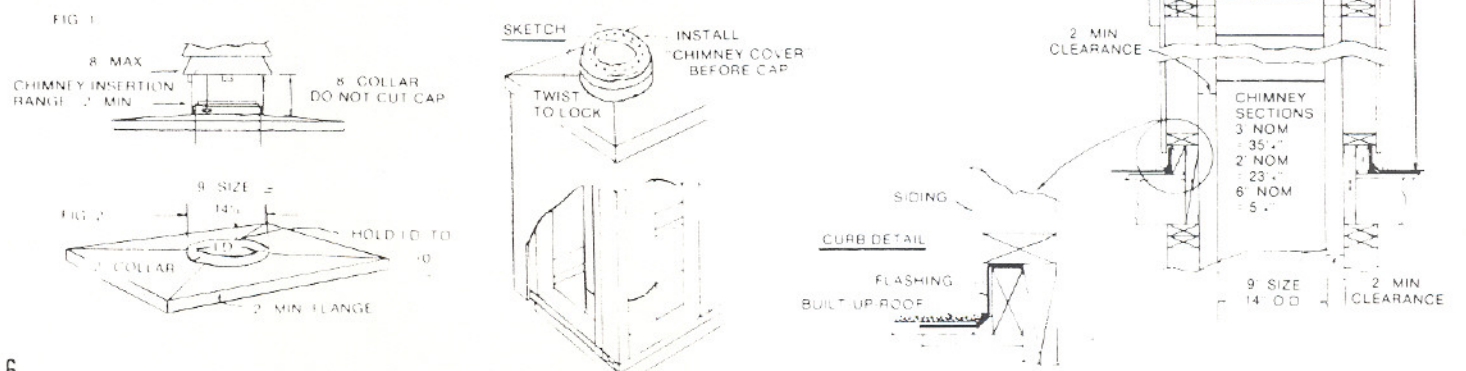

USE OF FIREPLACE OFFSET AND OVAL FIRESTOP SPACER

OBSERVE—LIMITATIONS ON OFFSET USE

LIMITATIONS:

1. **OFFSET** may incline chimney 15° or 30° **ONLY** (purchase correct factory-assembled sets)
2. Chimney may **INCLINE** to left, right, rear, or front--as viewed from front of fireplace.
3. **MAXIMUM** inclined chimney length is 8.
4. **FIRESTOP-SPACER** must be installed whenever the chimney penetrates a ceiling.
5. **JOINT BANDS** must be used to reinforce every joint at bottom of an inclined chimney section, except for screw-fastened Starter Section.
6. **HANGER STRAPS** of the Return Offset must be securely fastened on all four sides to substantial construction to safely carry the weight of all chimney sections above.

Chart #1			Chart #2		
VERTICAL INSTALLATION HT. TO CHIMNEY TOP			HT.—CHIMNEY ONLY (ABOVE OFFSET)		
					
2 ft. Sec.	3 ft. Sec.	Height	2 ft. Sec.	3 ft. Sec.	Height
2	0	8'5"	1	0	1'11"
1	1	9'5"	0	1	2'11"
3	0	10'4"	2	0	3'10"
2	1	11'4"	1	1	4'10"
1	2	12'4"	0	2	5'10"
3	1	13'3"	2	1	6'10"
2	2	14'3"	1	2	7'10"
1	3	15'3"	0	3	8'10"
3	2	16'3"	2	2	9'9"
2	3	17'3"	1	3	10'9"
1	4	18'3"	0	4	11'9"
3	3	19'2"	2	3	12'8"
2	4	20'2"	1	4	13'8"
1	5	21'2"	0	5	14'8"
3	4	22'1"	2	4	15'7"
2	5	23'1"	1	5	16'7"
1	6	24'1"	0	6	17'7"
3	5	25'0"	2	5	18'7"
2	6	26'0"	1	6	19'7"
1	7	27'0"	0	7	20'7"
3	6	28'0"	2	6	21'6"
2	7	29'0"	1	7	22'6"
1	8	30'0"	0	8	23'6"
3	7	30'11"	2	7	24'5"
2	8	31'11"	1	8	25'5"
1	9	32'11"	0	9	26'5"
3	8	33'10"	2	8	27'4"
2	9	34'10"	1	9	28'4"
1	10	35'10"	0	10	29'4"
3	9	36'10"	2	9	30'4"
2	10	37'10"	1	10	31'4"
1	11	38'10"	0	11	32'4"
3	10	39'9"	2	10	33'3"
2	11	40'9"	1	11	34'3"
1	12	41'9"	0	12	35'3"
3	11	42'8"	2	11	36'2"
2	12	43'8"	1	12	37'2"
1	13	44'8"	0	13	38'2"
3	12	45'7"	2	12	39'1"
2	13	46'7"	1	13	40'1"
1	14	47'7"	0	14	41'1"
3	13	48'7"	2	13	42'1"
2	14	49'7"	1	14	43'1"
			0	15	44'1"
			2	14	45'0"
			1	15	46'0"
			0	16	47'0"

Chart #3		
USE OF 15° & 30° OFFSETS		
	"A" TOTAL SHIFT	"B" HT. FROM TOP OF FIREPLACE TO TOP OF THE SUPPORT OFFSET
15°		
Offset + One 2' Chim.	7"	29½"
Offset + Two 2' Chim.	13"	51¾"
Offset + One 2' Chim. + One 3' Chim.	16"	63¼"
Offset + Three 2' Chim.	19"	74"
Offset + Two 2' Chim. + One 3' Chim.	22"	85¾"
Offset + One 2' Chim. + Two 3' Chim.	25"	97¼"
30°		
Offset + One 2' Chim.	15"	33¾"
Offset + Two 2' Chim.	27"	53¾"
Offset + One 2' Chim. + 3' Chim.	33"	64"
Offset + Three 2' Chim.	39"	73¾"
Offset + Two 2' Chim. + One 3' Chim.	45"	84¼"
Offset + One 2' Chim. + Two 3' Chim.	51"	94½"



OFFSET USE

FIREPLACE OFFSETS are fixed at 15° or 30° at the factory, and cannot be used to incline the chimney at any other angle. CHART gives exact data for planning at 15° and 30°.

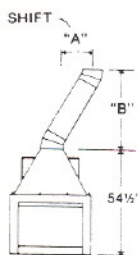
Maximum degree of offset allowed is once 30° off the vertical and once 30° back to the vertical.

HEIGHT LIMITATIONS

"Height of chimney **SUPPORTED BY FIREPLACE** to be not more than 45 ft." (Chart #1)

"When a Chimney Offset is employed, the height of chimney **SUPPORTED BY OFFSET** to be not more than 47 ft." (Chart #2)

FRAMING CONSIDERATIONS:

FIREPLACE LOCATION will be influenced by such factors as room plan and size, traffic in rooms and door and window openings.

CHIMNEY and DUCT installation (including OUTLET and INLET location) must be carefully considered.

FLOOR which must support installation need not be reinforced unless sizable facings of heavy material are intended.

OVERHEAD CONSTRUCTION (joists, trusses, rafters, pipes, etc.) may indicate best location of fireplace, chimney and ducts.

FRAMEWORK around the fireplace may be planned to include bookshelves, woodbins, closets, or other flues from floors beneath. Such built-ins may be made accessible from front, sides, or rear.

FIREPLACE OPENING FRAMING will be governed by flush or projecting facing materials and how far above or to sides of opening these will extend. See FACING MATERIALS.

STEP-BY-STEP INSTALLATION PROCEDURE

The following step-by-step installation directions are keyed to the straight up installation shown in Figure 1. If your installation calls for an offset and return, such as in Figure 2, be sure to follow the alternate directions as called for in Steps 3, 4, 5, and 6.

Each component used in your fireplace installation that is manufactured by Heatilator Fireplace will contain separate installation directions. Read and follow these instructions carefully. All components used in installing your fireplace with the exception of locally procured duct and insulation for air inlets should be Heatilator brand to insure a safe fireplace installation.

The height of total fireplace installation as measured from the bottom of the fireplace to the top of the chimney termination must not exceed 50 feet and it must not be shorter than 14 feet unless the installation does not require a firestop (see Step 5) in which case it must not be shorter than 12 feet.

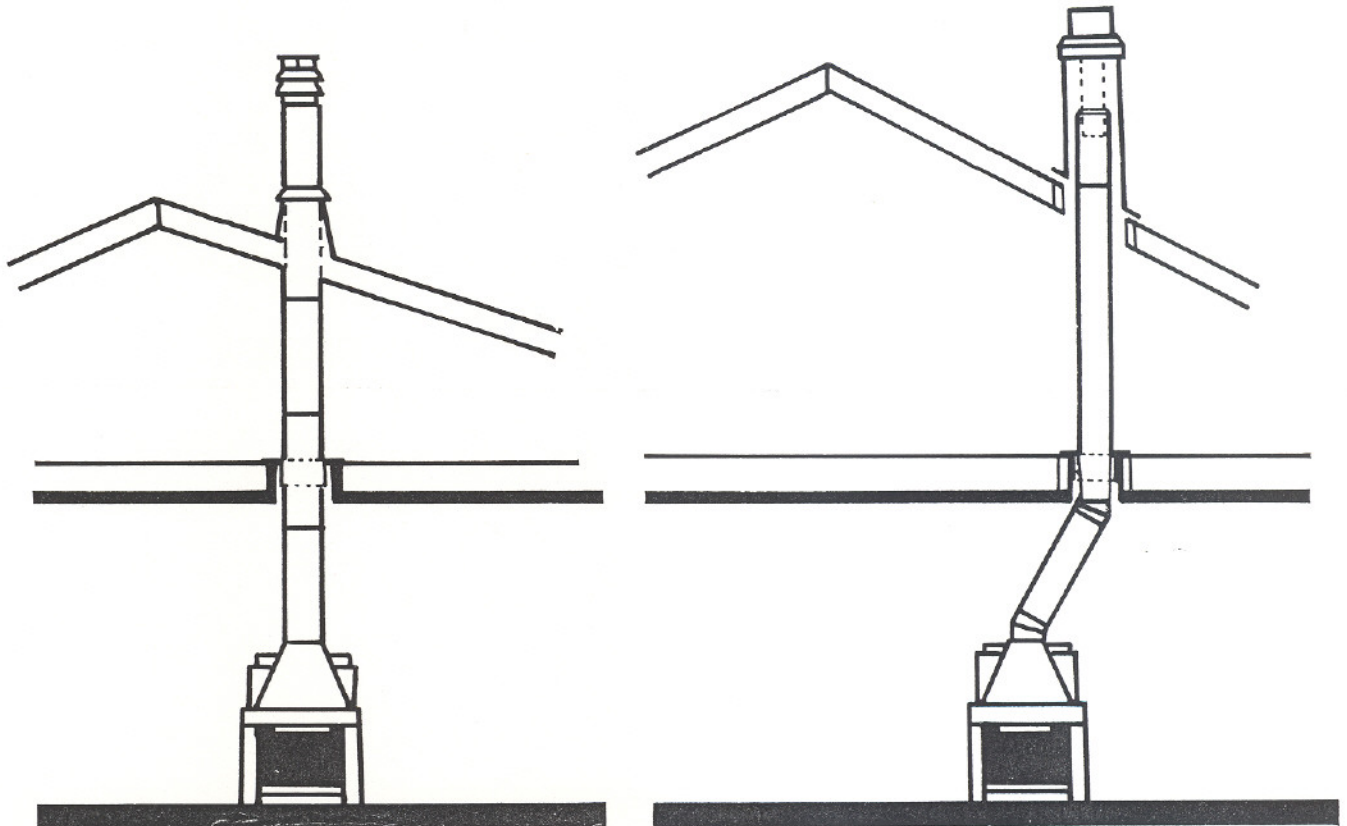

THE STRAIGHT INSTALLATION
Figure 1

THE OFFSET INSTALLATION
Figure 2

STEP 1

If you have not already done so, carefully read through these installation directions paying close attention to clearances to combustible materials, and factors contributing to a safe installation.

STEP 2

Position fireplace (be sure insulation pad beneath fireplace is in place) and nail wood blocks at rear and sides to hold fireplace from shifting during installation. (A minimum clearance of 3' must be maintained from the fireplace opening to any combustible wall which projects at 90° to fireplace opening.) These blocks will later be removed. If fireplace is against a wall, blocks at rear are not required. Be certain that fireplace has complete full area support beneath fireplace. Do not support fireplace at few points with blocks or floor joists. After fireplace is positioned, insert metal safety strip 1" under front of fireplace.

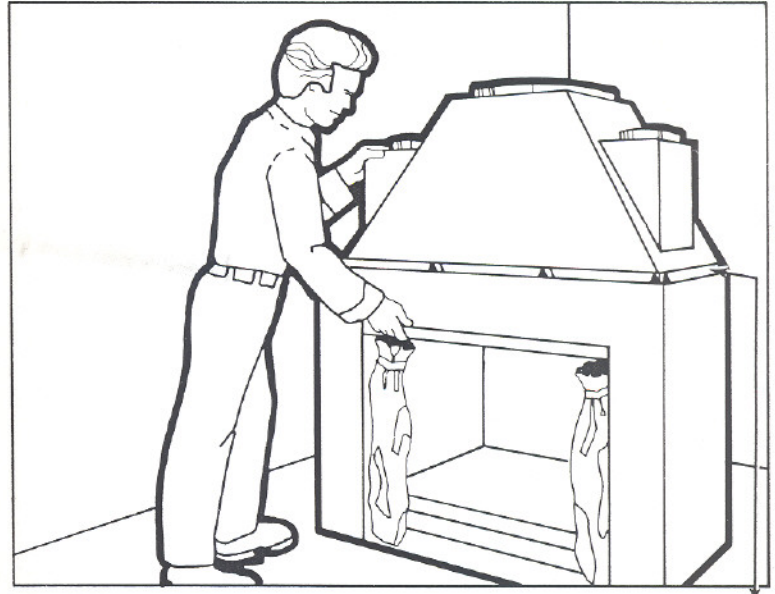

IMPORTANT: Do Not Use Loose Fill Insulation In Cavity Above Fire Chamber.

Step 3 (For offset installation see Step 3A)

Attach the starter chimney section (Catalog No. 912) to fireplace with four #8 x 1" screws provided in hardware packet.

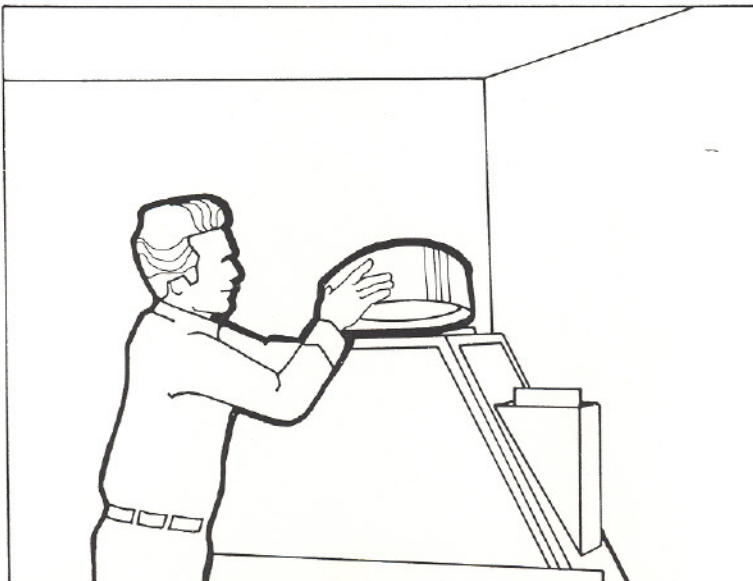
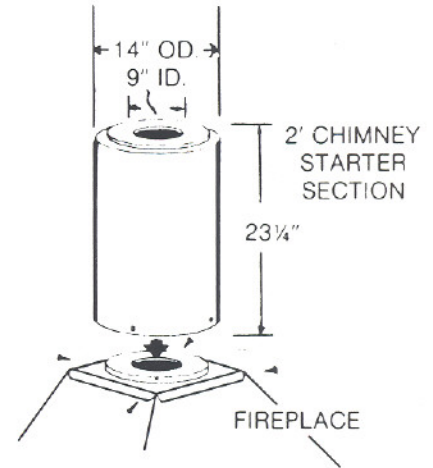

STEP 3A (Offset only)

Determine amount of offset required and by referring to Chart No. 3 in the offset and return section, select those components needed.

Attach offset to top of fireplace through predrilled holes using four #8 x 1" screws provided with the offset.

STEP 5 (For offset installation see Step 4A)

Install firestop spacer as shown, nailing through flanges into frame members. DO NOT PACK INSULATION INTO AREAS BETWEEN FIRESTOP SPACER AND JOISTS.

Use a firestop spacer whenever you penetrate a floor or ceiling. Firestopping is not allowed on installations under 14'. Installations between 12' and 14' must pass directly through the roof without passing through an attic. An example might be a flat roof, single story building, an "A" frame or an outside chase.

Installation shown is between attic and ceiling. If building has more than one level, the firestop must be installed opposite from that shown with nailing flanges at the ceiling level and the shield pointing upward for all levels except attic level. The first or lowest level penetrated must use firestop Catalog Nos. 3938, 3940, or 3942.

The firestop is to be installed from the bottom of the opening unless the area above the opening is an attic, in which case the firestop is to be installed from the top of the opening.

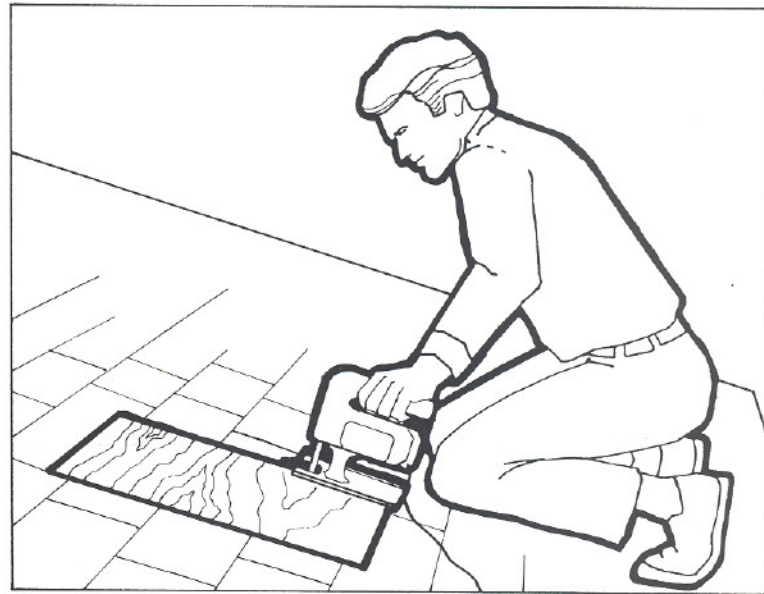
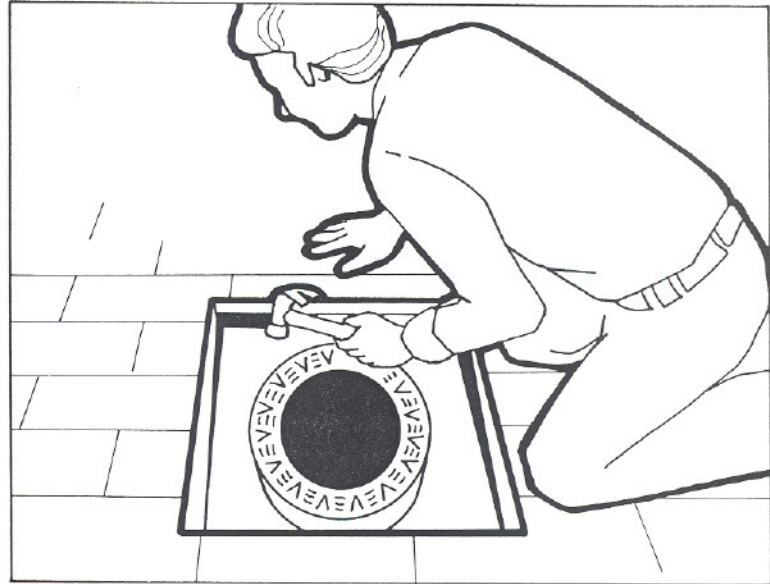
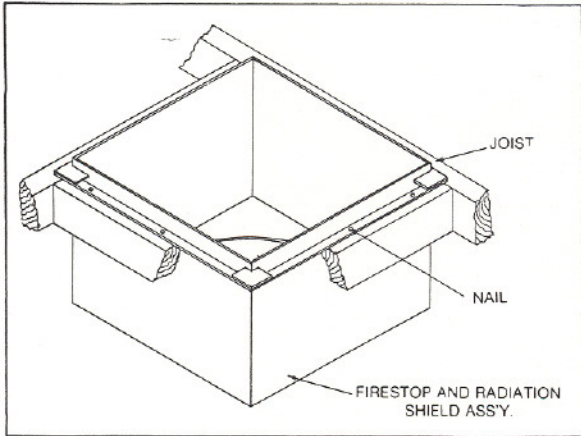

STEP 6

Locate point where chimney will exit roof by again plumbing down to center of the last chimney section. Drive a nail through the roof at this point. To determine the upper and lower bounds of the roof opening, plumb down to the edges of the firestop spacer and drive nails up through roof. Measure over 9" on each side of nail to determine sides of opening. Mark opening on roof and cut out.

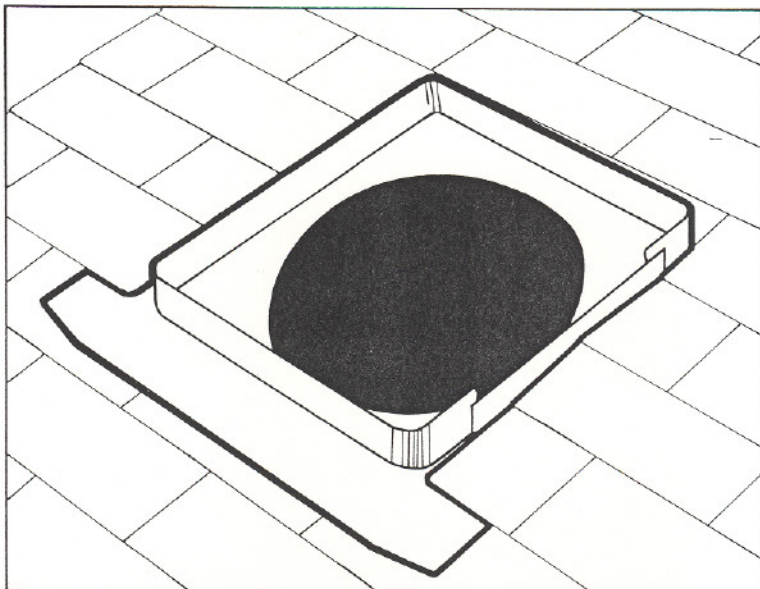

STEP 7

Install roof flashing under shingles as shown. NOTE: Refer to directions included with termination for detailed instructions.



STEP 8

Continue chimney sections up through roof, maintaining 2" clearance to combustibles. Also, the top of the chimney (rain cap) must terminate at least 3' above the highest point where it passes through the roof and at least 2' higher than any portion of a building within 10'.

Insulated flue must extend a minimum of 6" above the high side of the roof.

STEP 9

Assemble housing panels and set down over installed flashing. Mark panels for cutting to pitch using a level as shown.

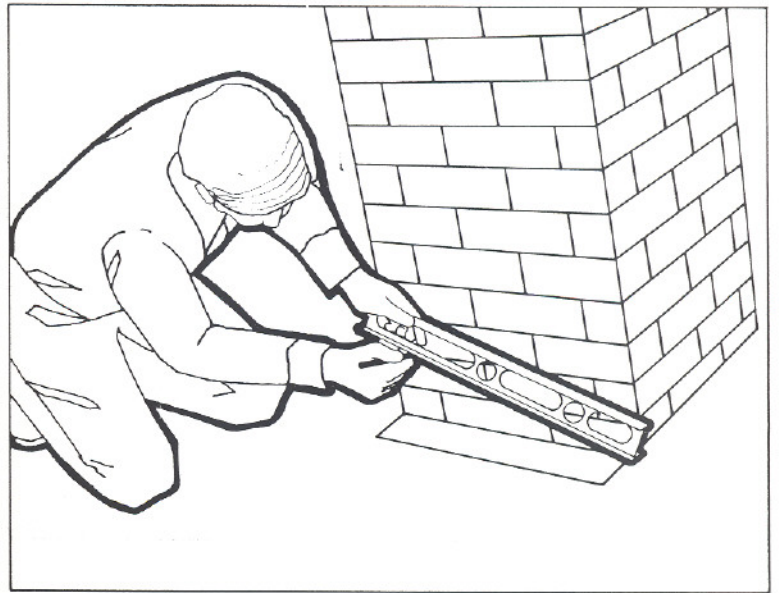
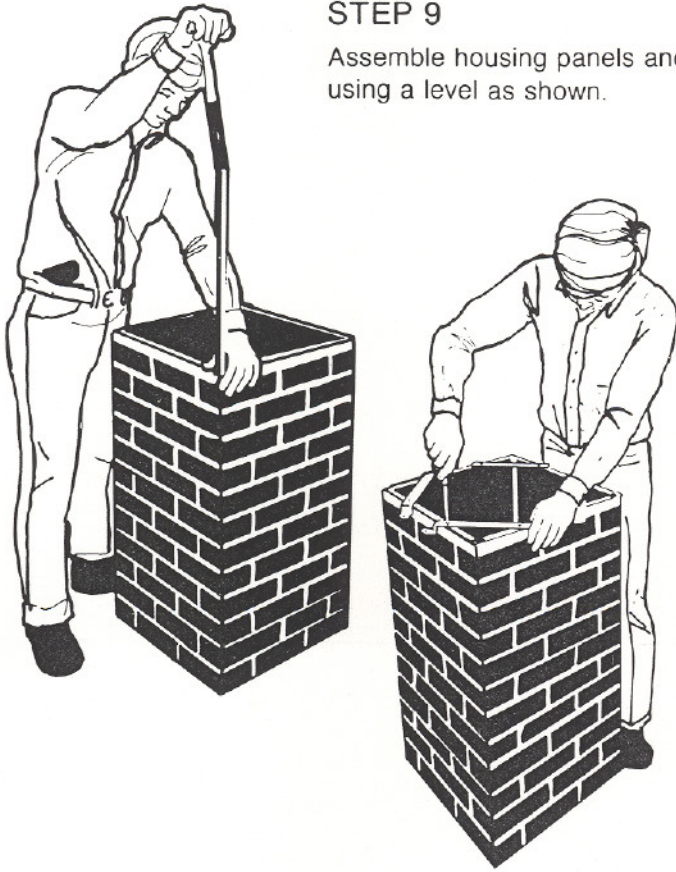

STEP 10

Cut both sides of housing panels as marked with level in Step 9.

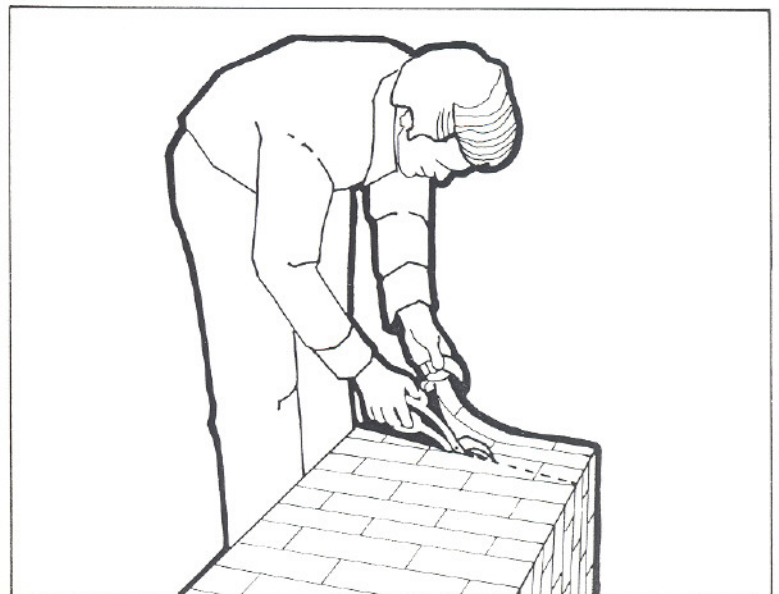

STEP 11

BEND the lower section of the high side panel up in line with the two side cuts to match the roof pitch.

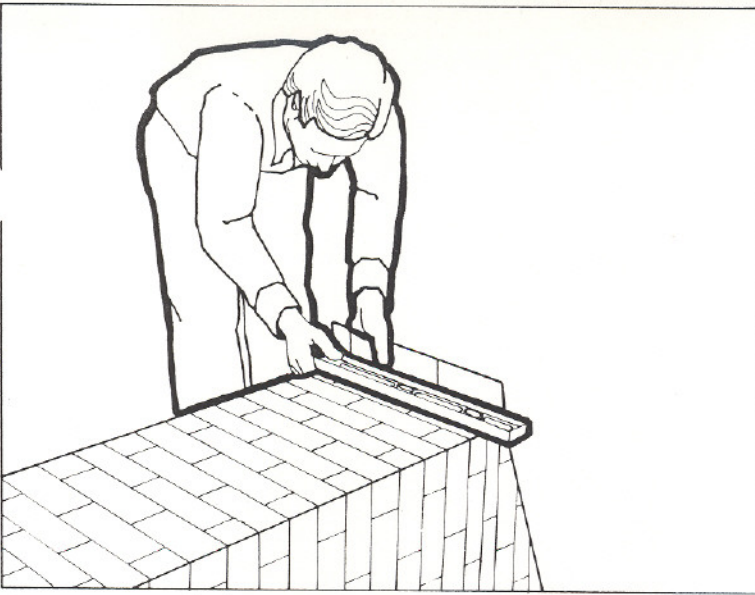

STEP 12

Slide the high side panel under the roof shingles and fasten the low end and side panels to the flashing with the sheet metal screws provided. Using a minimum of 3 screws per side equally spaced. Drill an 1/8" pilot hole for all screws.

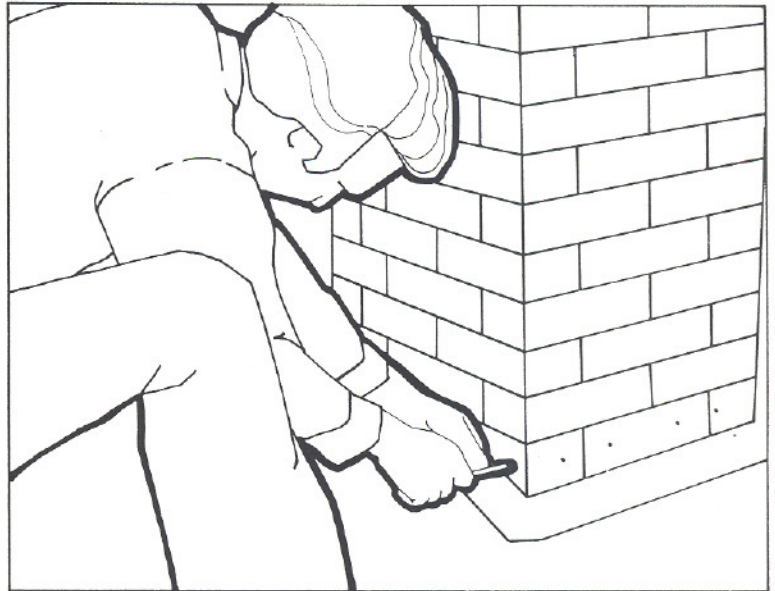

STEP 13

Install housing top on panels with sheet metal screws provided, through appropriate hole in brackets, as shown below. See Step 9.

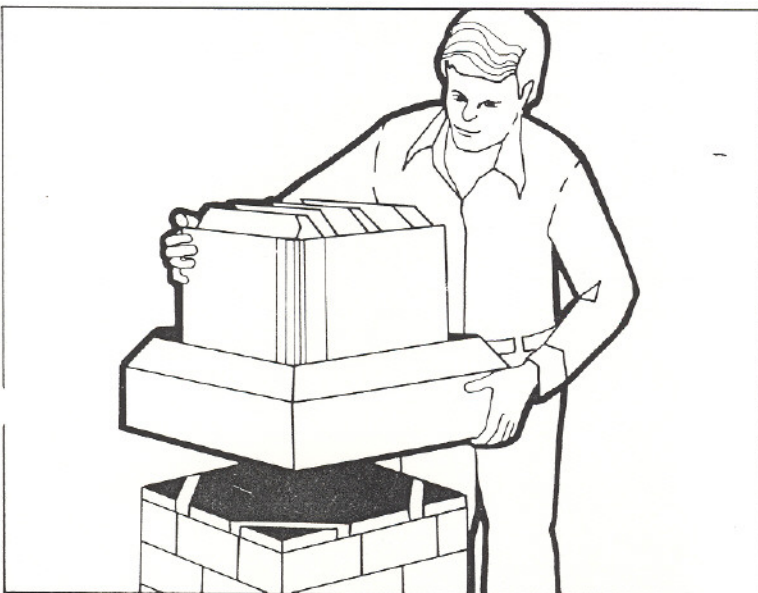

STEP 14

Remove rain cap as shown from housing top. Install slip section making certain it engages insulated flue by at least 2". Replace rain cap.

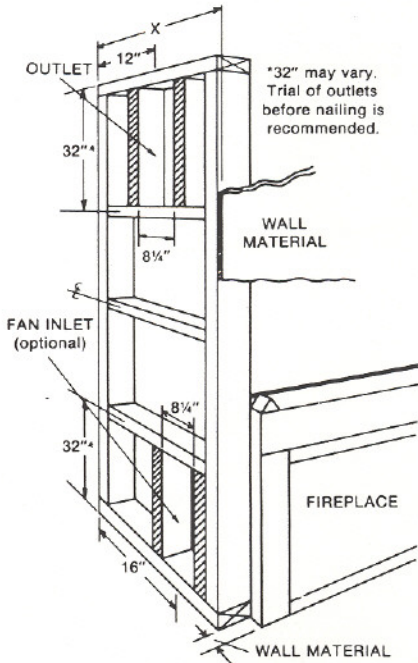
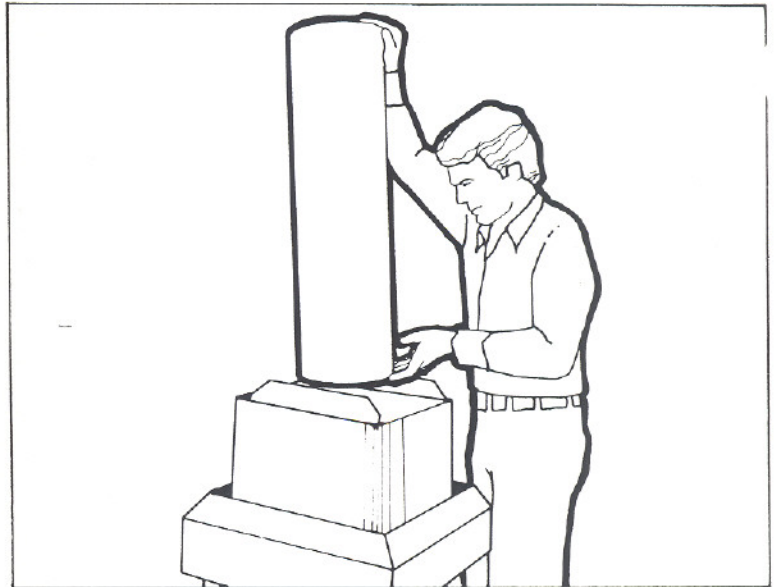
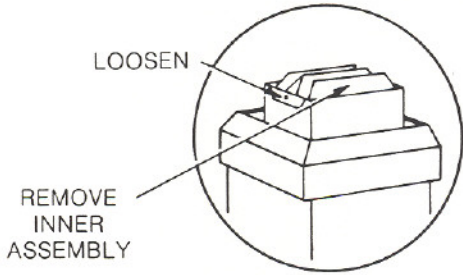

STEP 15

You are now ready to frame around the fireplace. If installing the outside air kit (Catalog No. 3140 AK) remember to leave room along both sides of the fireplace for the 4" diameter duct.

Framing is completed after a trial assembly of duct parts and outlets on fireplace; this procedure indicates where 2 x 4 members should be placed and allows a check of minimum clearances (grille must be at least 6" from any ceiling, wall, or floor; grille must not be direct warmed air towards an opposite wall which is closer than 2'). If outlets are in another room, or if ducts penetrate a partition, frame these areas first. Frame around the fireplace last.

Easiest procedure to construct "end walls" first, as shown at left--varying dimensions to suit your requirements. When end walls are in place, nail in horizontal 2 x 4 headers. Short vertical 2 x 4 members are for nailing of outlet and inlet

assemblies. Dimension "X" will be 24", equal to fireplace depth, but note this includes thickness of wall material; the framing is 24" minus wall material thickness. (Illustrated here is a typical installation being prepared for "no facing" or for such facings, as brick or stone which will project in front of finished wall surface; fireplace front will be flush with finished wall surface.

IMPORTANT: Maintain 1" clearance to combustibles with hot air circulating duct.

If you plan to install your fan inlets and circulating air outlets to the front, frame as shown here. Avoid lengthy horizontal runs of hot air ducts. 3' maximum is recommended.

Both Inlet and outlet air circulating ducts must be wrapped with insulation to prevent heat loss and cold air transfer.

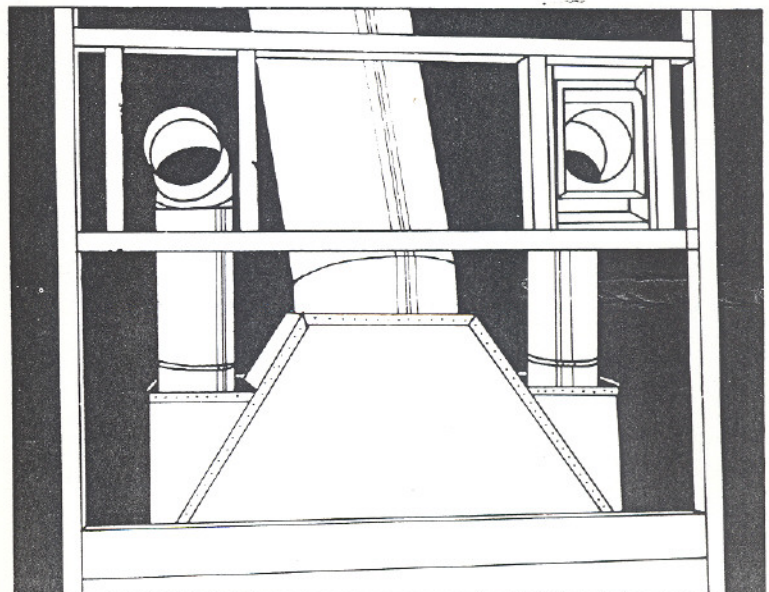
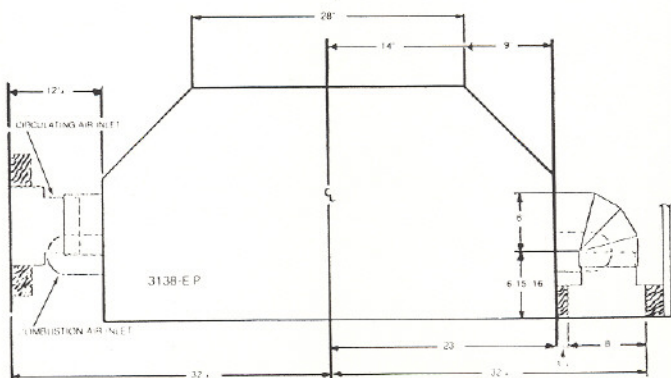

STEP 16

To install outlet boxes, first remove inner liner (B) from box (D) as shown.

Before final installation of hot air ducts and outlet boxes, inspect the heating chamber for foreign debris (bits of insulation, wood scraps, etc.). We recommend you vacuum clean both sides of the heating chamber.

Both inlet and outlet air circulating ducts must be wrapped with insulation to prevent heat loss and cold air transfer.

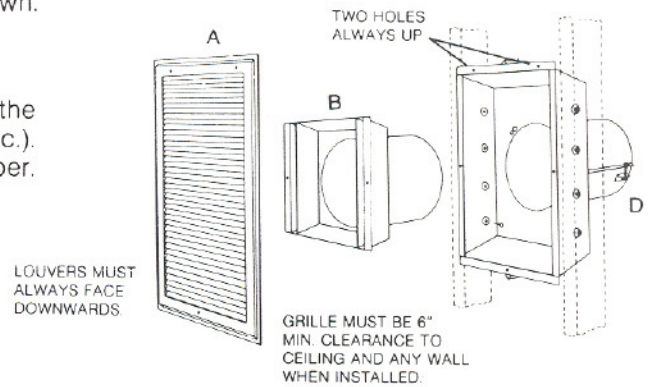

STEP 17

Nail box to framing members and replace liner. Repeat for other side. **NOTE:** If additional double wall pipe is needed, see your Heatilator Fireplace dealer. Do not substitute single wall galvanized pipe. Maintain a 1" clearance to combustibles.

STEP 17A

Untwist retaining wire and remove protective cap and insulation. Add duct sections as shown.

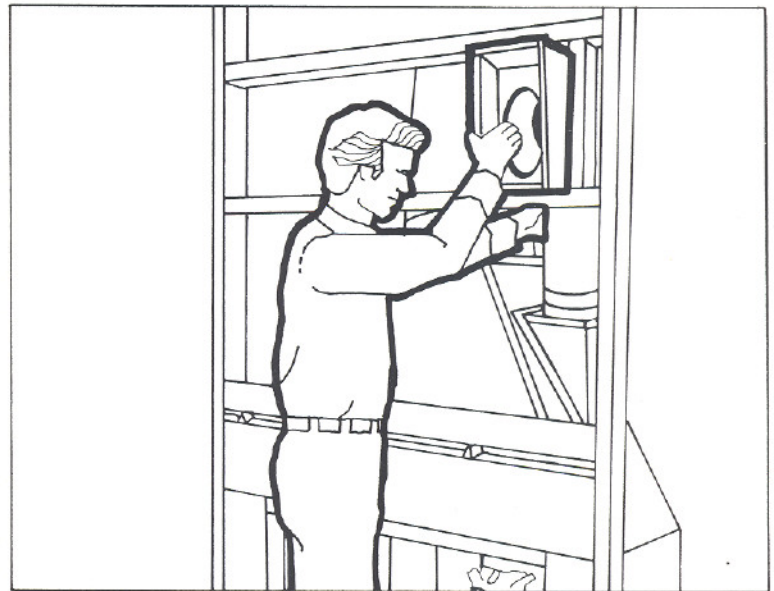
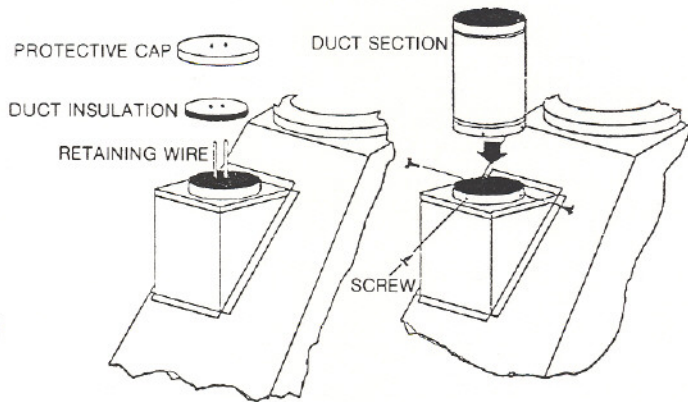

STEP 18

Connect the fan inlet kits to the fireplace with 6" diameter UL listed air duct. Remove the 6" diameter knockout and the insulation pad in the fireplace side and bend the tabs out. Insert the duct collar into the hole and secure it through the tabs to the fireplace with 3/8" long sheet metal screws provided in the hardware package. All joints must be secured with screws or metal strapping. Tape to prevent leaks using duct tape, as required by the air duct manufacturer.

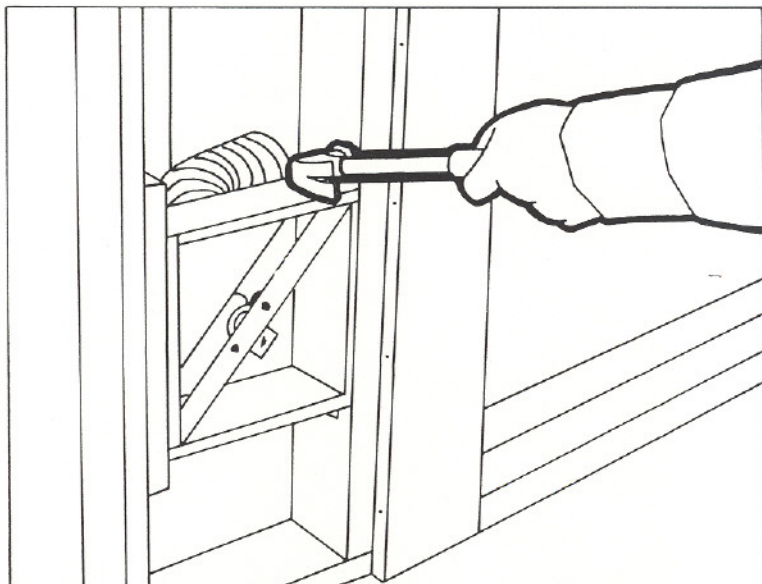

Prior to installation check assembly for loose screws. See inlet box detail below.

Both inlet and outlet air circulation ducts must be wrapped with insulation to prevent heat loss and cold air transfer.

INLET PROTRUDES FROM 2 x 4 EQUAL TO FINISHED WALL MATERIAL THICKNESS.

BEFORE FINAL INSTALLATION CHECK FAN BLADE AND MOTOR MOUNT SCREWS FOR TIGHTNESS.

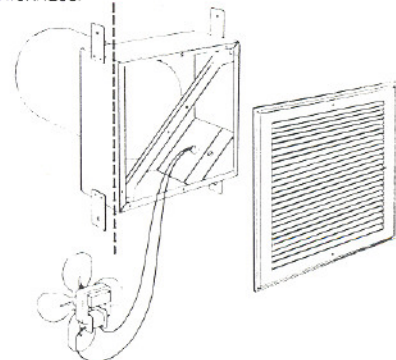

IMPORTANT

If you are planning to install the optional outside air kit (Catalog No. 3140), this must be done before proceeding with the framing and finish work.

FINISHING YOUR FIREPLACE:

You are now ready to finish your fireplace with the materials of your choice.

Combustible materials may not be used on the face of the fireplace. If you plan on installing a glass door, refer to following illustration for proper placement of noncombustible facing material.

NOTE: FACING MATERIAL MUST NOT PROJECT WITHIN THE SCREEN OPENING AREA. ALSO DO NOT COVER THE SCREEN COVER.

HEARTH EXTENSIONS:

A hearth extension must be used. Catalog No. 3900 is available for this purpose. The hearth extension must extend at least 20" in front of an 8" on either side of fireplace opening. Make certain safety strip is in place. (See page 9)

WHEN THE FIREPLACE IS INSTALLED ON A COMBUSTIBLE FLOOR, a Hearth Extension must be employed to protect the floor in front of and on either side of the opening. See Item 9 - Making Your Fireplace Safe.

HEARTH EXTENSION and entire fireplace may be recessed into the floor, installed on the sub-floor or finished floor, or raised on a suitable platform. If recessed or raised, provide a level surface strong enough to support the fireplace, chimney and Hearth Extension.

FACING MATERIALS:

It is not a requirement that facing be used. When preferred, the black-painted front surfaces of fireplace may be left exposed; a "picture frame" molding is usually employed to conceal the joint between the fireplace and the finished wall. Molding should overlap not more than 1/4" of metal fireplace front.

NON-COMBUSTIBLE FACING MATERIAL (glass, marble, brick, tile, stone, etc.) may be applied to the face of the installed fireplace, but should not project into the screened opening area. Combustible materials should not cover the face of the fireplace with the exception that a molding may cover the opening between framing and facing. The fireplace may be elevated on its own platform above the hearth extension area to permit the use of additional facing material below the fireplace opening. CAUTION: Do not use facing material in a manner which will block special cooling air entries at top or bottom of the fireplace opening.

FACING MATERIAL may be flush, or projecting in front of, the finished wall surface. for FLUSH facing material, the FIREPLACE is recessed behind surface of finished wall a distance equal to facing thickness; for PROJECTING facing material, the FIREPLACE is flush with finished wall surface. (Flush installation is recommended for smooth or thin facings, with a "picture frame" molding used to conceal joint between facing and finished wall. Projecting installation permits a shallower cavity to enclose the fireplace and enhances the appearance of massive natural materials, with side joints between facing and finished wall concealed by caulking and top of projecting material concealed by a mantel installed across the top.) A mantel, if used, must be at least 12" above the fireplace opening.

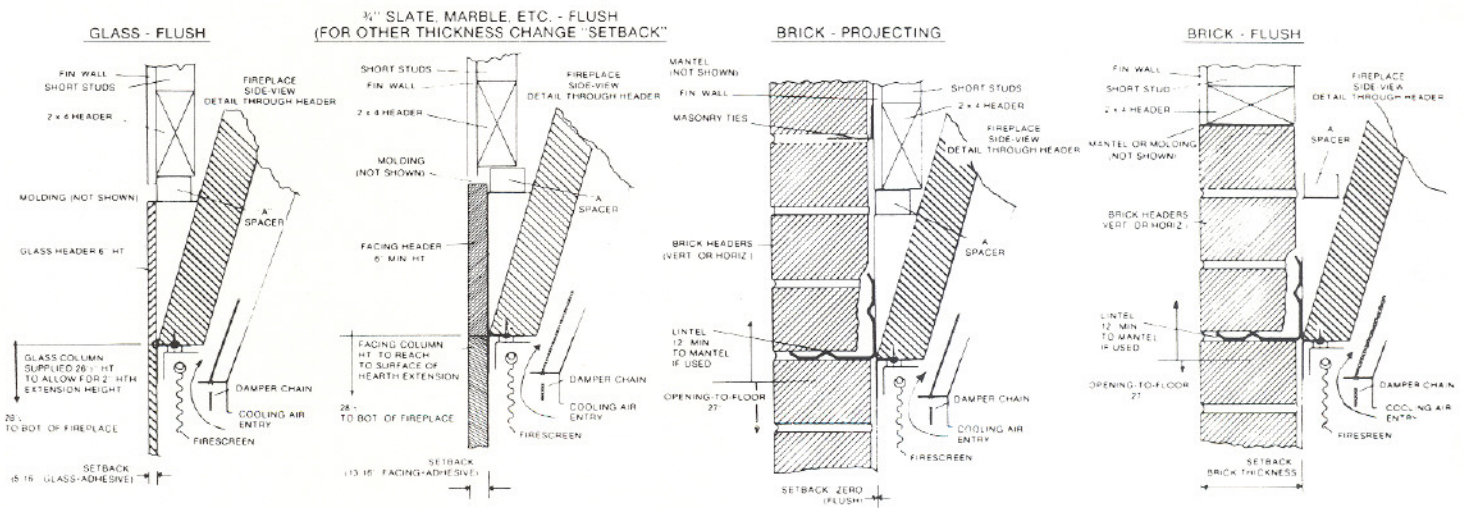

NOTE: "GLASS" may be 1/4" mirror, opaque colored glass, or thin tile. Adjust SETBACK distance to accommodate thickness of material.

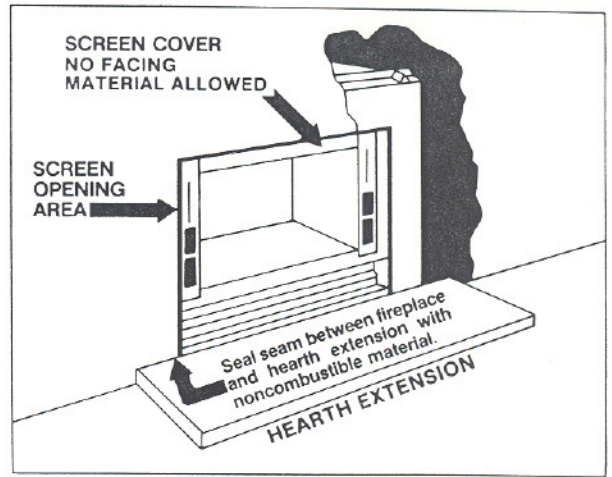

3138 ENERGY PACKAGE INSTALLATION INSTRUCTION REVISIONS

- Page 1 - Refer to first paragraph "Building Authorities" — Should read as follows: "BUILDING AUTHORITIES, REFER TO THE FOLLOWING: UNDERWRITERS' LABORATORIES, INC. NO. MH5850 (LOOK FOR THE LABEL)"
- Item 2 - Should read "Firestop Spacers for First Floor Penetrated catalog numbers 3938, 3940 and 3942 should be used. Use 3932, 3916 or 3931 for other levels".
- Page 4 - Under Firestop Spacers, add "Model numbers 3940 for use at first floor ceiling with 15° offset, and model 3942 for use with 30° offset."
- Page 10 - Step 4A (Offset Only)
Paragraph one should read "Determine point where chimney will penetrate ceiling. If chimney is inclined (slanted) where it passes through the ceiling, a special firestop is required. Catalog number 3940 at the first floor ceiling, or catalog 3916 above the first floor ceiling for a 15° offset. Catalog number 3942 at the first floor ceiling, catalog number 3931 above the first floor ceiling for a 30° offset. 15° offsets will require an 18" by 21.75" opening, and 30° offsets will require an 18" x 27" opening. Cut the necessary opening and frame.
- Page 14 - Step 15
Second paragraph "If Outlets are in an Upper Room" should read "If Outlets are in Another Room"; third paragraph "As Shown at Right" should read "As Shown at Left".
- Page 15 - ADD STEP 17A
"Untwist Retaining Wire and Remove Protective Cap and Insulation. Add Duct Sections As Shown."
- Last Page.
Under facing materials, paragraph titled "Non-Combustible Facing Material" should read "(Glass, Marble, Brick, Tile, Stone, etc.) may be applied to the face of the installed fireplace, but should not project into the screened opening area. Combustible materials should not cover the face of the fireplace with the exception that a molding may cover the opening between framing and facing."
- Disregard the following references to elbows.
- Page 3 - Under Making Your Fireplace Safe, Item 7 should read "Only 2 bends are allowed per installation (one offset and one return). Amount of angle is limited to 30° off the vertical.
- Page 4 - Disregard all reference to catalog number 916 or elbows.
- Page 7 - under "Use of Fireplace Offset and Oval Firestop Spacer".
First paragraph should read "Offsets are adjustable from 0° to 15° catalog number 3915 and 16° to 30° catalog number 3930, and can be used anyplace within the flue system as long as the offset does not exceed 30°, the system does not offset more than once, and the inclined length does not exceed eight feet (8'). Joint bands must be used to reinforce all joints in the incline, and screws provided with the offsets must be used to secure the sections after the proper angle has been achieved. The topmost section of the offset has (4) metal straps to secure it to the surrounding framing. These allow the section to support up to 47 feet of additional chimney and must be carefully secured to prevent open joints in the flue system.

Refer to the table on page four for height and shift dimensions at various angles for offsets and disregard all other text with reference to offsets on page 7.

Page 8 - under "Step-By-Step Installation Procedure" add the following:

The height of total fireplace installation as measured from the bottom of the fireplace to the top of the chimney termination must not exceed 50 feet and it must not be shorter than 14 feet unless the installation does not require a firestop (see Step 5) in which case it must not be shorter than 12 feet.

Page 11 - Step 5 (for Offset Installation see Step 4A)

Add "Installation shown is between attic and ceiling. If building has more than one level, the firestop must be installed opposite from that shown with nailing flanges at the ceiling level and the shield pointing upward for all levels except attic level. The first or lowest level penetrated must use firestop catalog numbers 3938, 3940, or 3942".

Page 15 - Step 8 should read:

"Connect the fan inlet kits to the fireplace with 6" diameter UL listed air duct. Remove the 6" diameter knockout and the insulation pad in the fireplace side and bend the tabs out. Insert the duct into the hole and secure it through the tabs to the fireplace with 3/8" long sheet metal screws provided in the hardware package. All joints must be secured with screws or metal strapping. Tape to prevent leaks using standard duct tape."

Page 15 - Step 16, second paragraph, should read:

Before final installation of hot air ducts and outlet boxes, inspect the heating chamber for foreign debris (bits of insulation, wood scraps, etc.). We recommend you vacuum clean both sides of the heating chamber.

(PAGE 14 — STEP 15)

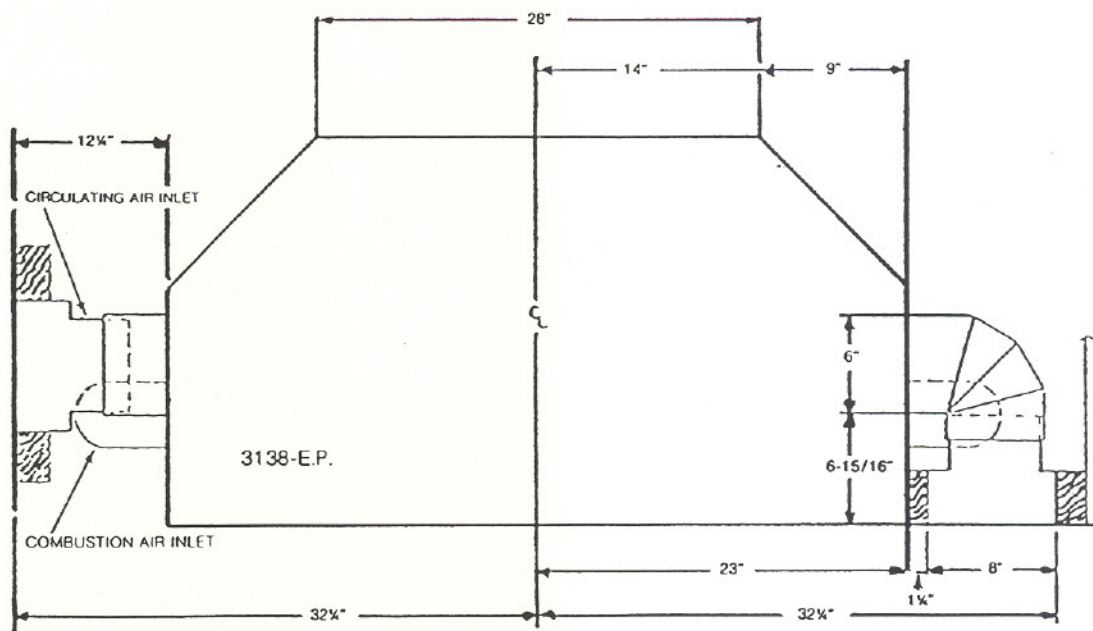

(MINIMUM CLEARANCE FOR AIR INLET)

DISREGARD PARAGRAPH 4, PAGE 8. THIS FIREPLACE HAS NO PROVISIONS FOR OPTIONAL GAS DEVICES.