

# QUADRA-FIRE®

## Pellet Firepot and Igniter Replacement MT. VERNON AE STOVE & INSERT and EDGE 60 FIREPLACE

Part: SRV7034-072

**Included in Kit:** (1) firepot, (1) firepot gasket, (2) riv nuts, (2) 1/4-20 Bolts, (2) washers, (1) igniter and (1) wing nut

**Tools Required:** 7/16" socket wrench, Phillips screwdriver and flat head screwdriver

3. The igniter is fastened to the igniter chamber with a wing nut. Loosen the wing nut until the igniter slides free and gently remove from the igniter chamber. **Figure 2.**

### PROPER SHUTDOWN PROCEDURE



#### CAUTION

##### Shock and Smoke Hazard

- Set wall control to OFF on AUTOMATIC / MANUAL SETTING screen.
- Wall control screen will scroll through the following messages after setting to OFF.
  1. Shutdown
  2. Auto-Clean
  3. Off
- Smoke spillage into the room can occur if the appliance is not cool before unplugging.
- There is a risk of shock if the appliance is not unplugged before servicing the appliance.
- After servicing, restart with the AUTO/MANUAL SETTINGS screen.

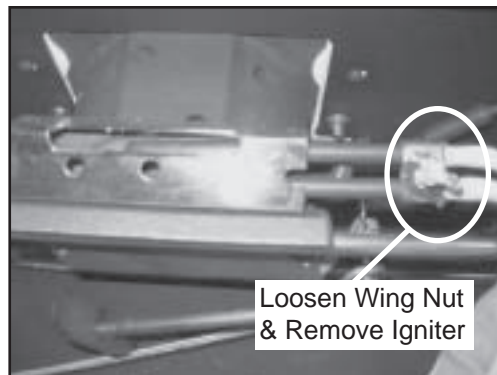

Figure 2

### GENERAL INSTRUCTIONS

1. Follow proper shutdown procedures above.
2. To access the igniter you will first need to remove the ash pan.

**NOTE:** On the Mt. Vernon AE Stove the ash pan is visible from the front of the stove. On the Mt. Vernon AE Insert and EDGE 60 Fireplace you will need to open the cast face/decorative front and remove the ash pan.



Figure 1

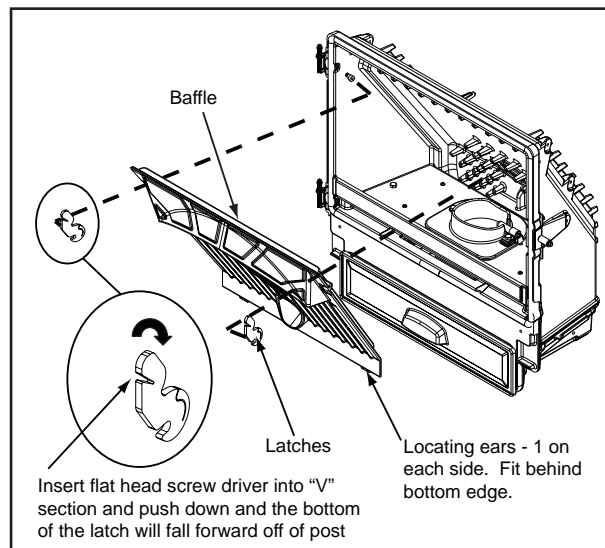
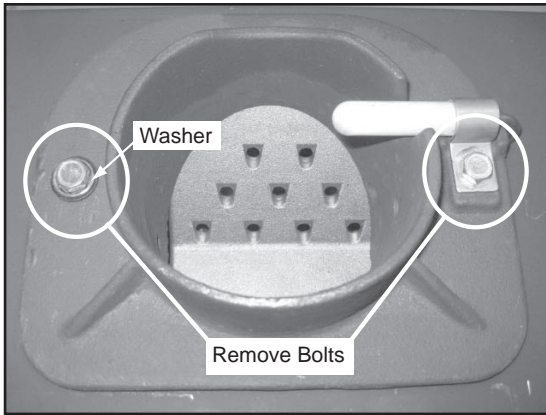

Figure 3

4. It is easier to remove the bolts on the firepot with the baffle removed. To remove the baffle, place a flat head screwdriver into the slot of the latches located in the upper corners and push down. The bottom of the latch will fall forward off the post. Lift the baffle up and then out toward you. **Figure 3.**



**Figure 4**

- Using a 7/6" socket wrench, remove the bolts.

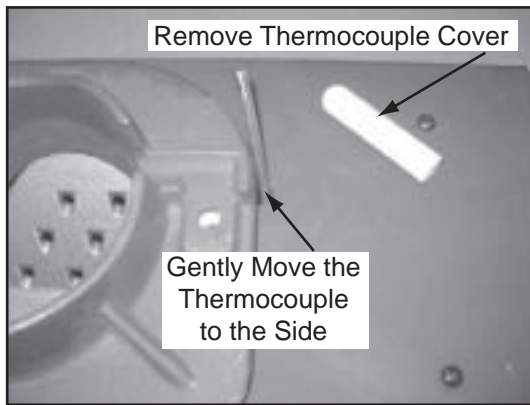

**Figure 5**

- Gently move the thermocouple and ceramic tube off to the side, being careful not to damage the parts. Remove the firepot from the firepot riser assembly.

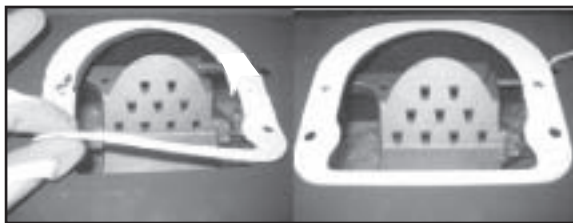

**Figure 6**

- Remove the old firepot gasket and discard. Replace it with the new firepot gasket included in the kit.
- Install the new firepot using the washer and bolts provided. **Note:** The washer goes on the left hand side of the firepot - opposite of the thermocouple bracket. Refer to **Figure 4** on page 2.
- On the Mt. Vernon AE Stove remove the right side panel to be able to access the wires. On the Mt. Vernon AE Insert remove the right cast side to access the wires.

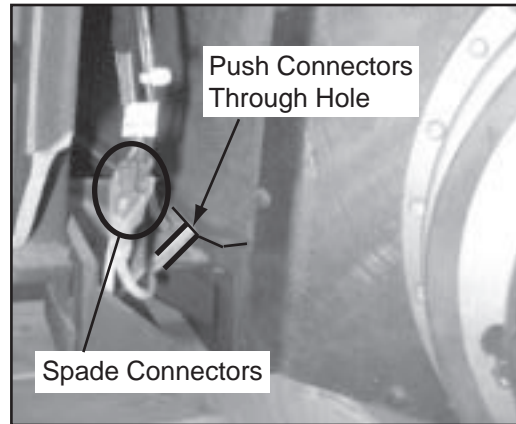

**Figure 7**

- The wire leads to the igniter are connected to the wire harness with 1/4 inch male / female spade connectors. Disconnect the male/female spade connectors. Push the connectors through the cast firebox opening in the back of the appliance into the ash pan opening. Remove the igniter from the ash pan opening in the front of the appliance. **Figure 7.**

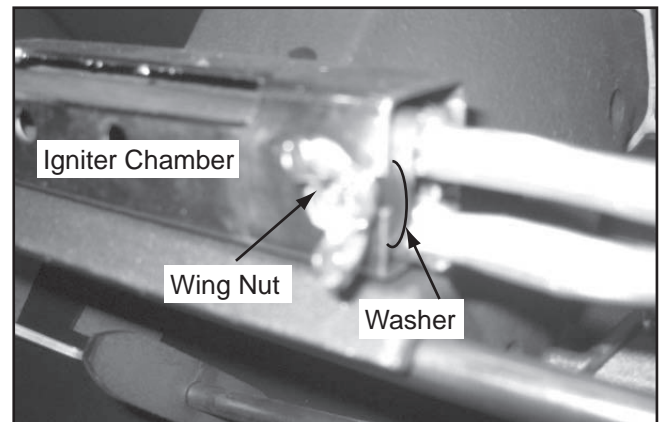

**Figure 8**

- Install the new igniter into the chamber and place the washer between the igniter base and the inside of the igniter chamber. **Figure 8.**

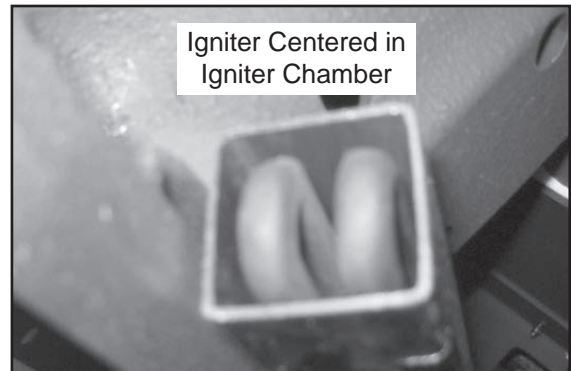

**Figure 9**

**NOTE: Make sure the igniter is centered in the igniter chamber.**

### **NOTICE**

The thermocouple and igniter wires must be routed correctly to avoid:

- Damage to the wires by the firepot floor or auto-clean rails
- Igniter could short out

**DO NOT route any wires around the auto-clean system.**

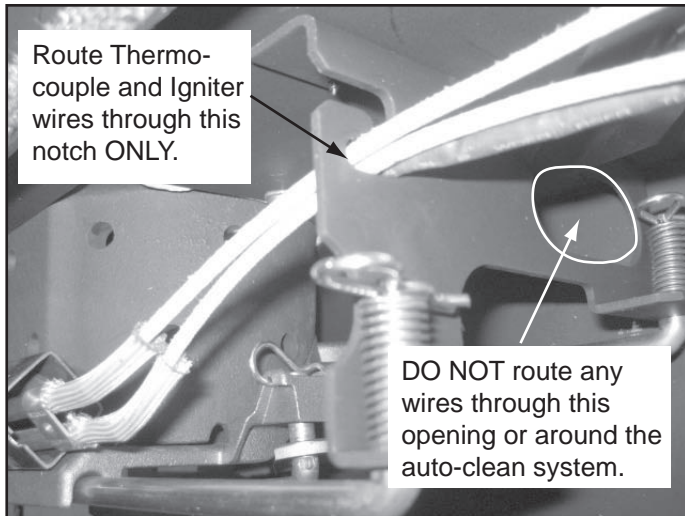

**Figure 10**

12. The igniter wires need to be routed through a notch in the firepot riser assembly. **Figure 10.**



**Figure 11**

13. Feed the wires through the right corner opening in the cast. **Figure 11.**
14. Re-connect the wires to the 2 leads with the spade connectors. Refer to **Figure 7** on page 2.

15. Replace the baffle:

- a. Place the 2 locating ears behind the bottom edge and tilt the baffle up and into place. Refer to **Figure 3** on page 1.
- b. Center the baffle in the firebox before latching it in place. If it is not centered the latch is trapped between the baffle and sides of the firebox instead of latching properly.
- c. Fit the bottom of the latches over the posts. Push the top of the latch forward to lock the latch into place.

16. Re-install the right side panel or right cast side depending on the model.