

&
INSERTS

BALANCED FLUE GAS FIREPLACE INSERTS



HEAT & GLO

INSERTS

SUPREME INSERT

No more drafty, dated fireplaces. No more messy maintenance. No more soot and smoke. It's time for an immediate upgrade, with interest.

The Supreme delivers. Traditional ambiance. Full log sets. Efficient warmth. A simple and classic upgrade to your existing wood fireplace.

COSMO INSERT

Ditch the logs completely. Go modern. A ribbon of flame and glistening glass interior take your fireplace transformation to the next level. We created the fire, now it's yours to enjoy.

COSMO INTERIOR OPTIONS



ABOVE: COSMO I30 shown with standard front in black and white ceramic stones.
COVER: SUPREME I30 shown with standard front in black.

GAS INSERT TECHNOLOGIES

INTELLIFIRE™ IGNITION SYSTEM



The IntelliFire™ Ignition System (IPI) is an advanced intermittent pilot ignition system. IPI constantly monitors ignition, ensures safe functioning and conserves up to \$10/month in energy costs.

BALANCED FLUE TECHNOLOGY



Balanced Flue fireplaces remove 100% of combustion exhaust and odors outside of the home. These sealed fireplaces provide optimal heat, conserve energy and ensure clean, safe indoor air quality.

GAS INSERT SPECIFICATIONS

MODEL	FRONT WIDTH		BACK WIDTH		HEIGHT		DEPTH		GLASS SIZE	mJh INPUT	EFFICIENCY	FUEL TYPE/IGNITION SYSTEM
	UNIT	MIN. FIREBOX OPENING	UNIT	MIN. FIREBOX OPENING	UNIT	MIN. FIREBOX OPENING	UNIT	MIN. FIREBOX OPENING				
SUPREME I30	775	775	513	514	521	521	352	371	697 x 325	N - 31.9, P - 30.9	76%	Gas, IntelliFire Plus
COSMO I30	775	775	513	514	521	521	352	371	697 x 325	N - 26.5, P - 24.0	76%	Gas, IntelliFire Plus

LEFT SIDE VIEW

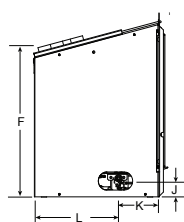

FRONT VIEW

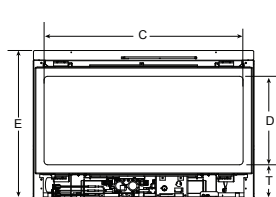

RIGHT SIDE VIEW

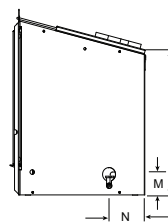

TOP VIEW

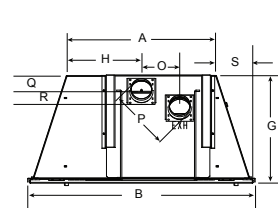

Model	A	B	C	D	E	F	G	H	I	J	K	L	M	N	O	P	Q	R	S	T
SUPREME I30	513	775	697	325	521	448	352	257	432	44	122	229	57	100	132	203	44	57	113	114
COSMO I30	513	775	697	325	521	448	352	257	432	44	122	229	57	100	132	203	44	57	113	114

Dimensions above are in millimeters. Reference dimensions only. We recommend measuring individual units at installation. NOTE: Combustible material should not be installed over the face. Make sure you do NOT cover the decorative door opening.

Refer to installation manual for detailed specifications on installing this product. Heat & Glo reserves the right to update units periodically. The flame and ember appearance may vary based on the type of fuel burned and the venting configuration used. Pictures in this brochure are not a true representation of the fireplace and/or flames.

For complete information on this model, please contact us at:



No one builds a better fire

www.heatnglo.com