

**Home Heating** with  
**Biomass** Alternative Energy:

- Renewable
- Clean-burning
- Carbon neutral
- Your CHOICE



 **heatilator**  
**ECOCHOICE**<sup>™</sup>  
elite central heat



Wood Pellet Furnace  
BA100



Wood Pellet Boiler  
BH60



Wood Pellet Boiler  
BH105

For over 80 years, homeowners have depended  
on **heatilator** for **secure home comfort.**

HEAT CLEAN

# Live Green™

With so many traditional and alternative ways to heat your home today, how do you know if you are making the right choice? Simple, Heatilator Eco-Choice Elite!

When considering a replacement, supplementary, or new home heating system, there are many options. But if lowering your home heating costs with an environmentally friendly product is what you value, from a brand that stands for dependable warmth and comfort, then turn to biomass central heating solutions from Heatilator Eco-Choice Elite

## Q: What is Biomass Fuel?

**A:** Cord wood, wood pellets, wood chips, waste paper along with dozens of agricultural products and by-products capable of being used for energy, are all examples of biomass fuel. The most compelling principle of heating with biomass is that it is a renewable resource.

## Q: What is Pellet Fuel?

**A:** Pellet fuel is a clean-burning and cost stable home heating alternative currently used throughout North America. It is a biomass product made of renewable substances – generally recycled wood waste – that allows remarkable consistency and burn efficiency at a fraction of the particulate emissions of raw biomass. In short, home heating with pellet fuel diverts millions of tons of waste from landfills annually, turning it into energy.

## Q: What are the environmental benefits of heating my home with a pellet fuel compared to traditional fossil fuels?

**A:** Pellet fuel has been proven to provide the cleanest burn of any solid fuel. A Heatilator Eco-Choice Elite biomass central heating system exhausts an average of 2.0 particulate grams per hour—well below the United States EPA wood burning limit of 7.5 grams. Pellet fuel is carbon neutral and does not contribute to global warming. When heating with biomass, carbon dioxide is released into the atmosphere. Trees absorb carbon dioxide in equal amounts as they grow, so burning

pellets does not increase the amount of this greenhouse gas in the atmosphere. Arsenic, carbon monoxide, sulphur and the green house gas carbon dioxide are just a few of the air and water pollutants resulting from the use of all nonrenewable fossil fuels as a heating and energy source. As a matter of fact, heating your home with a Heatilator Eco-Choice Elite central heating system has roughly the same environmental benefit as driving 5 hybrid cars!



heatilator  
**ECOCHOICE™**  
elite central heat



Over **8 Million barrels** of oil energy equivalent is displaced in North America with pellet fuel annually.

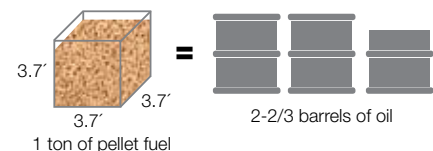

**Q:** How much money can I save heating with a Heatilator Eco-Choice Elite biomass central heating system?

**A:** Many factors need to be considered when calculating potential fuel cost savings, and are dependent on the type of fuel you are currently using, the climate where you live and current fuel costs. However, on average, consumers can expect to save \$500 - \$1500+ annually\*. \*Avg. US Home 100M BTU/yr. 12/08 Minneapolis, MN heating with LP, Fuel Oil, Electricity

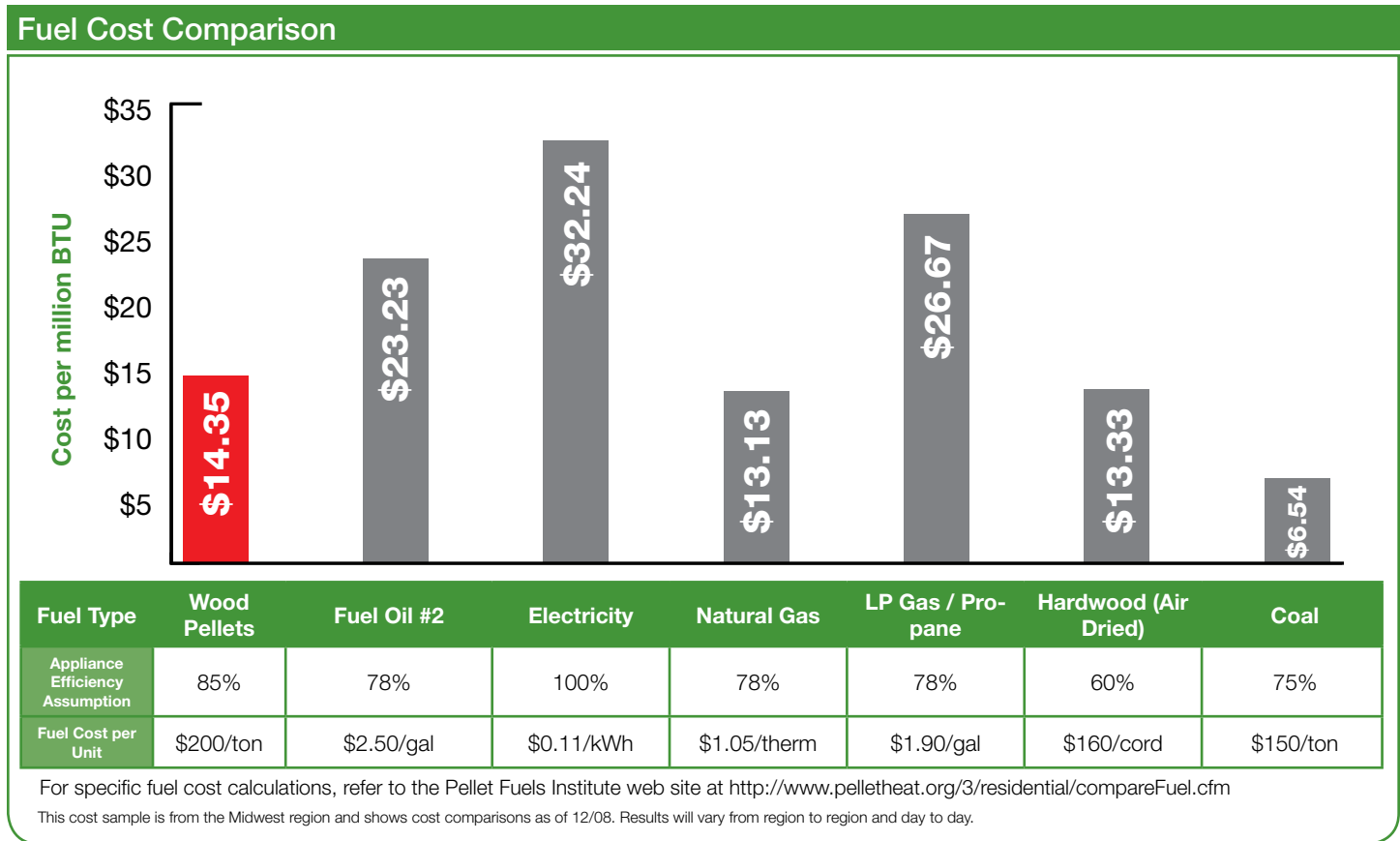

**Q:** Will pellet fuel prices increase, just as prices on the fossil fuels that I currently use to heat my home increased?

**A:** Pellet fuel costs have been virtually constant when compared to the of price volatile fossil fuels. A crisis or an international event that chokes fossil fuel supplies can cause spikes in traditional home heating fuel costs. More pellet mills are being built every year in response to the demand for pellet fuel. It is estimated that over 95% of the pellet fuel produced today is for home heating use. In other words, the historical price of this fuel has not seen the wide "price swings" that traditional home heating fuels have. Why is this? Since pellet fuels are not dependent on the price of a barrel of oil, or impacted by other industries using the fuel, prices remain more stable and are impacted to a lesser extent by the economy.

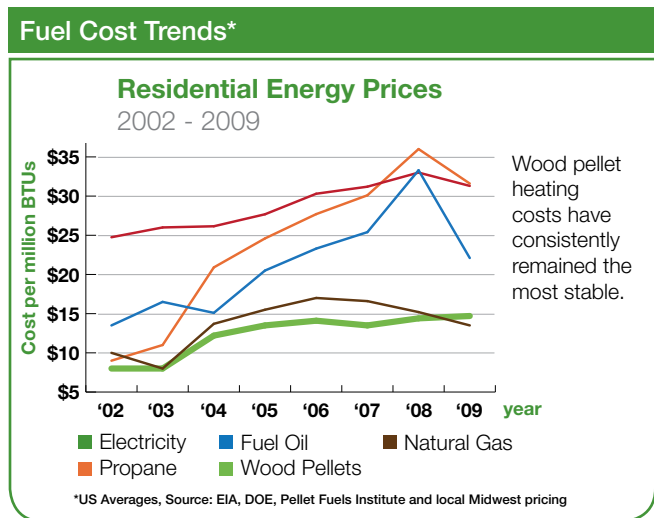



## Q: Where can I buy wood pellet fuel?

**A:** Pellet fuel can typically be found for purchase at fireplace and stove retailers, building supply stores, feed and garden supply stores and home discount merchandisers. Additionally, pellet mills (producers) may be able to refer you to a dealer within their network. For a directory of mills, visit the Pellet Fuels Institute at [www.pelletheat.org](http://www.pelletheat.org).

## Q: What will the availability of pellet fuel be in the future?

**A:** Without a doubt, the awareness of alternative energies has never been higher in the U.S. than it is now. As a result, the demands on pellet producers will continue to grow. Every year, more and more pellet mills are being started, adding to the availability of this fuel for future needs. According to the Pellet Fuels Institute, given the proper sustainable forest initiatives and agricultural management, biomass is virtually a limitless fuel source.

heatilator  
**ECOCHOICE™**  
elite central heat

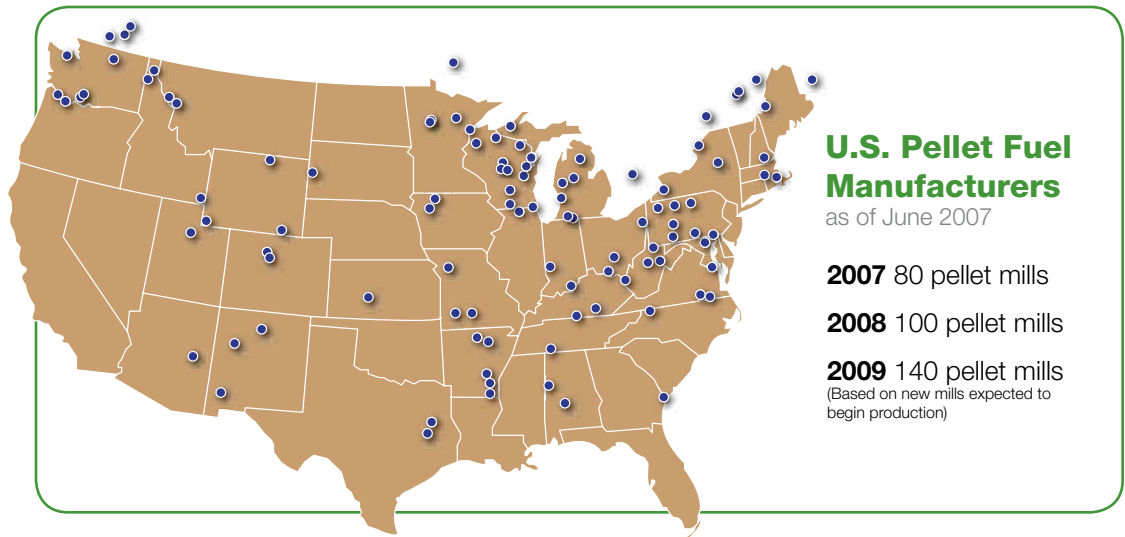

## Q: What is the difference between a Pellet Furnace and Pellet Boiler?

**A:** A pellet furnace relies on a home's ductwork to distribute the heated air via a distribution fan. A pellet boiler is a hydronic system that heats water that is distributed throughout the home via in-floor heating systems, wall radiators, etc. A pellet boiler can also be integrated into an existing force-air furnace system through the use of a water-to-air heat exchanger placed inside the plenum/duct. Pellet fueled boilers can also assist in supplying your domestic hot water needs. Consult your HVAC expert on proper application and installation.

**Q:** How does a Heatilator Eco-Choice Elite central heating system work?

**A:** Heatilator Eco-Choice Elite biomass central heating systems work much like traditional forced-air furnaces and boilers, with the exception that wood pellets are being burned instead of traditional fossil fuels. Heatilator Eco-Choice Elite heating systems take pellet fuel heating to its optimum level, operating automatically to give you warm, comfortable temperatures throughout your home. Simply fill the hopper with pellets and set the temperature control to the desired setting. Heatilator Eco-Choice Elite will do the rest. If heat is required, the fire will automatically light and burn at the proper rate to produce just the right amount of heat. If heating demand is reduced, Heatilator Eco-Choice Elite will reduce the fire. If no heat is required, the fire will go out and light again automatically when more heat is needed.

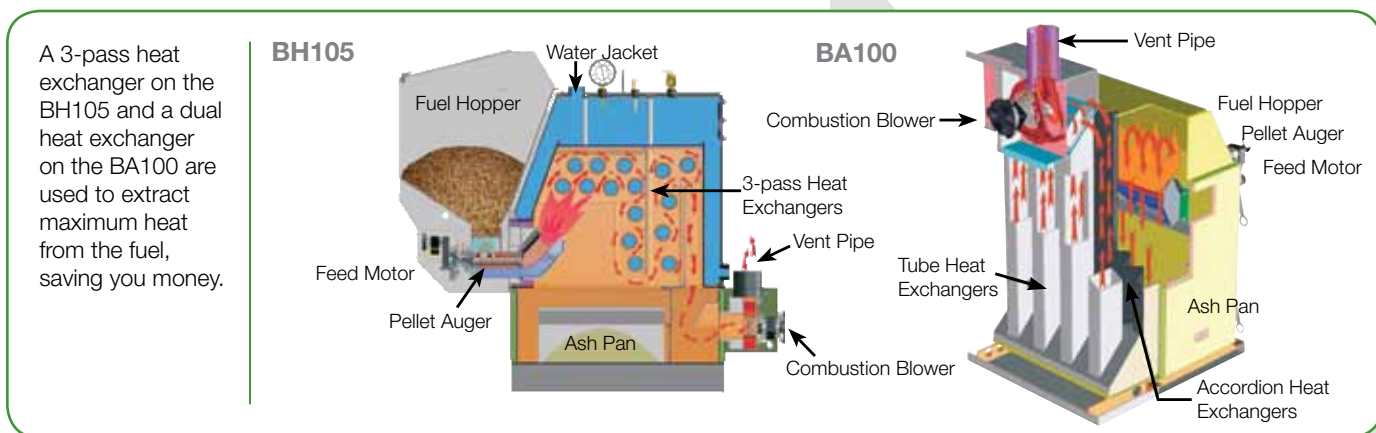

**Q:** Where can I install an Heatilator Eco-Choice Elite Pellet Furnace or Boiler?

**A:** Heatilator Eco-Choice Elite central heating systems are designed to be installed inside of your home, typically in a mechanical room where they interface with the existing heating system's ductwork or plumbing. Garage or shop applications are also possible, but special considerations need to be made, so consult your local HVAC expert. The furnace and boiler systems are "direct-vent" which means that they can be supplied with combustion air from outside the structure. Also, Heatilator Eco-Choice Elite biomass central heating systems must be installed with Type "L" or "PL" vent pipe, which can be terminated vertically or horizontally (or combination) depending on specific application.

**Q:** Do I need to replace my existing central heating system when considering the purchase of an Heatilator Eco-Choice Elite Pellet Furnace or Boiler?

**A:** If you are considering replacing an older, less efficient furnace or boiler, you can choose to keep your existing unit in place (forced-air furnace or boiler), or remove the old system and use the biomass appliance as your sole heating



**BH60** Pellet Boiler installed with a water-to-air heat exchanger in an existing forced-air furnace.

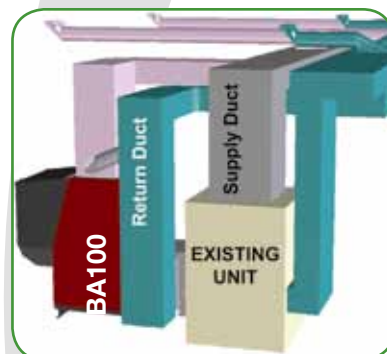

**BA100** Pellet Furnace installation using home's existing duct system.

system. The advantage of keeping your existing system in place (and adding the biomass heating system) is the ability to alternate between the two systems, should heating costs drop for traditional fossil fuels.



### Q: Is a Pellet Furnace or Boiler right for me?

**A:** While homeowners choose biomass heating for different reasons, it is safe to say that most share the desire to heat their homes more cost effectively while having a positive impact on the environment, as well as reducing dependence on "big oil companies."

### Q: Is an Heatilator Eco-Choice Elite Furnace or Boiler easy to maintain?

**A:** Beyond adding fuel to the standard appliance hopper (160 lb. to 205 lb. capacity, depending on appliance), or the bulk hopper option (additional 1500 lb. capacity), there is a required weekly, monthly, and annual maintenance in order to keep your appliance working properly and operating at its highest level of efficiency. Weekly maintenance and cleaning can be done in a matter of minutes, but is required to ensure peak performance of the appliance.

Heatilator  
**ECOCHOICE™**  
elite central heat

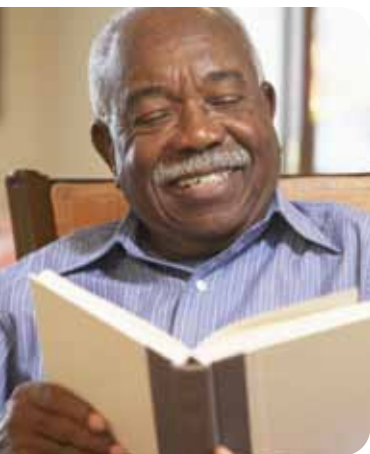

### Q: How much pellet fuel will I use?

**A:** Many factors will impact the amount of fuel consumption such as: desired temperature setting, outside temperature, area being heated, and energy efficiency of dwelling. However, under "normal" winter conditions, you can expect your pellet heating system with a full hopper to last 2 to 3 days before needing to re-fuel. This is equivalent to approximately 1 ton\*\* of pellets a month.     \*\*(1 ton equals fifty 40 lb. bags of pellet fuel)

### Q: Can I burn corn, or other types of biomass fuel, in my boiler or furnace?

**A:** Heatilator Eco-Choice Elite central heating systems have been tested for use with wood pellets only. Use of other biomass fuels will impede the normal functioning and efficiency of the appliance and should not be used.

### Q: Do Heatilator Eco-Choice Elite products qualify for an Alternative Energy Tax Credit?

**A:** Because biomass central heating systems can be part of the solution for national energy policy, incentives and tax credits are available. Heatilator Eco-Choice Elite biomass central heating systems can qualify for up to \$1500 in tax credits under the 2009 Economic Stimulus legislation. Check with your tax professional to find out specifically what incentives/credits you may qualify for.

### Q: What kind of warranty do Heatilator Eco-Choice Elite products have?

**A:** For residential applications, Heatilator Eco-Choice Elite by Heatilator warrants its product to be free from defects in material or workmanship, in normal use and service, for a period of 6 years from the date of sales invoice and for mechanical and electrical failures, in normal use and service, for a period of 3 years. Optional extended warranties are available. Consult your local HVAC expert for further information.

### Wood Pellet Furnace BA100

BA100	Efficiency	BTU Range	Heating Capacity†	Hopper Capacity	Outside Air Size	Fuse Rating	Venting Size	Feed Rate	Fuel	Weight
	89%	0 - 100,000	2,500 sq. ft.	160 lbs.	2.75 inches	10 amp circuit breaker	4-inch pellet vent pipe	1 - 13 lbs/hr	Biomass wood pellets	450 lbs.

The **BA100 Wood Pellet Furnace** takes pellet fuel heating to its optimum level, operating automatically to give you warm, comfortable temperatures throughout your home. Simply fill the hopper with pellets and set the temperature dial on the wall mounted control to the desired setting. The BA100 will do the rest. The fire will automatically light and burn at the proper rate to produce just the right amount of heat. If heating demand is reduced, the BA100 will reduce the fire. If no heat is required, the fire will go out and light again automatically if more heat is needed.

#### Features

- Automatic Ignition
- Total Automatic Operation
- Patented Pellet Pro Feeder
- Patented Pellet Pro Burn Pot
- Dual Heat Exchangers
- 160 Pound Hopper
- Large Ash Door
- Extra Large Ash Pan
- Fire Viewing Glass
- Wall Mounted Temperature Control
- 89% Efficient
- Shaker Cleaning Handle

#### Options

- Outside air
- 1638 cfm 4-speed distribution blower
- 1000 cfm distribution blower
- AC Double Pole Relay
- Bulk hopper

### Wood Pellet Boiler BH60

BH60	Efficiency	BTU Range	Heating Capacity†	Hopper Capacity	Outside Air Size	Fuse Rating	Venting Size	Feed Rate	Fuel	Weight
	90%	0 - 60,000	1,500+ sq. ft.	160 lbs.	2-3/8"	10 amp circuit breaker	3-inch pellet vent pipe	1 - 8lbs/hr	Biomass wood pellets	460 lbs.

Green heating at its best! The **BH60 Pellet Boiler** easily connects into any existing hot air or hot water system, becoming the primary or secondary form of heat for the air and water. And since this unit is installed using existing ductwork, the BH60 entails minimal cost with maximum benefits. The low maintenance BH60 features our patented Pellet Pro Feeder & Burnpot, a refractory-lined firebox, 14 stainless steel exhaust tubes, one full inch of closed cell foam insulation on the water jacket, and fiberglass insulation surrounding the entire unit. The small footprint of the BH60 allows it to be installed in tight places.

#### Features:

- 3-Pass, 14-tube heat exchanger design maintains maximum efficiency
- 13 gallon insulated water jacket
- Electronic temperature control
- 120 VAC
- 90% efficiency

#### Included Accessories

- Water temperature sensor
- Outside air temperature sensor
- Dual boiler water temperature and pressure gauge
- Well for water sensor
- Pressure relief valve
- Boiler water drain valve

#### Options

- Outside air
- Battery back-up
- Bulk hopper
- AC 165 kit  
(required for installation in Massachusetts)

### Wood Pellet Boiler BH105

BH105	Efficiency	BTU Range	Heating Capacity†	Hopper Capacity	Outside Air Size	Fuse Rating	Venting Size	Feed Rate	Fuel	Weight
	86%	0 - 105,000	2,500+ sq. ft.	205 lbs.	2.75 inches	6 amp circuit breaker	4-inch pellet vent pipe	1 - 13 lbs/hr	Bio-mass wood pellets	900lbs.

The **BH105 Wood Pellet Boiler** has automatic ignition, automatic temperature control, and our patented Pellet Pro Feeder & Burn Pot. Designed for easy access to the burn pot, the entire hopper component swings open for performing maintenance and cleaning. The BH105 packs up to 105,000 BTU and has a 205 lb. hopper capacity with an extra large ash pan.

#### Features:

- 3 pass heat exchanger for maximum efficiency
- 30 gallon insulated water jacket
- Electronic temperature control
- 120 VAC
- 86% efficiency
- Front door with window for easy burn pot access and fire viewing

#### Included Accessories

- Water temperature sensor
- Outside air temperature sensor
- Dual boiler water temperature and pressure gauge
- Well for water sensor
- Pressure relief valve
- Boiler water drain valve
- 3 heat exchanger cleaning rods

#### Options

- Domestic hot water coil
- Outside air
- Bulk hopper
- AC 165 kit  
(required for installation in Massachusetts)

†Each installation is unique. Efficiencies, heating capacity and fuel consumption estimates will vary upon specific installations and application. Consult your local HVAC expert.

## BA100 Wood Pellet Furnace



Side View

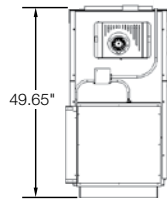

Front View

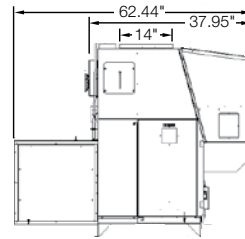

Side View

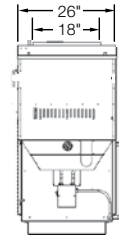

<b>BA100</b> Clearances	Front Side (Ash Pan Side)	Left Side (Air Return Side)	Right Side (Hopper End)
	12"	1"	1"

## BH60 Wood Pellet Boiler



Front View

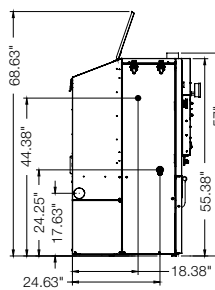

Side View

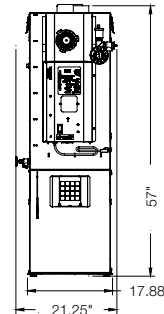

Top View

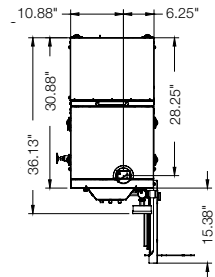

<b>BH60</b> Clearances	Front Side (Ash Pan Side)	Sides	Back Side (Hopper End)	Top Side (To Ceiling)
	48"	6"	6"	16"

## BH105 Wood Pellet Boiler



Front View

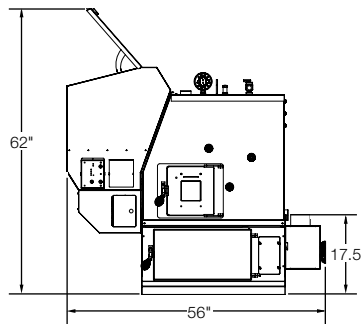

Side View

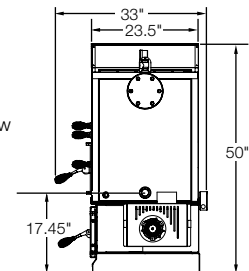

<b>BH105</b> Clearances	Front Side (Fire Door and Ash Pan Door)	Left side (Hopper End)	Right side (Exhaust End)	Back side (Opposite Doors)
	36"	18"	1"	6" (16.5" recommended for access)

### Available From:



a brand of *Hearth & Home Technologies Inc.*<sup>®</sup>  
1915 West Saunders St • Mt. Pleasant, IA 52641

\*\*Each installation is unique. Efficiencies, heating capacity and fuel consumption estimates will vary depending upon specific installations and application. Consult your local HVAC expert. Illustrations within this brochure are for reference only. The information provided in this literature is for planning purposes only and subject to change. Please consult the installation manual for actual installation. Actual product appearance may differ from product images.